

STATE OF ILLINOIS
DEPARTMENT OF TRANSPORTATION
DIVISION OF HIGHWAYS

**PROPOSED
HIGHWAY PLANS**

FAP ROUTE 770 (IL 128)
SECTION D7 HMA SAFETY SHLD 2011-1
PROJECT HSIP-0770(015)
SAFETY IMPROVEMENTS
SHELBY COUNTY

C-97-015-11

F.A.P. RTE.	SECTION	COUNTY	TOTAL SHEETS	SHEET NO.
770		Shelby	24	1
		ILLINOIS	CONTRACT NO. 74504	

D7 HMA SAFETY SHLD 2011-1

D-97-004-11

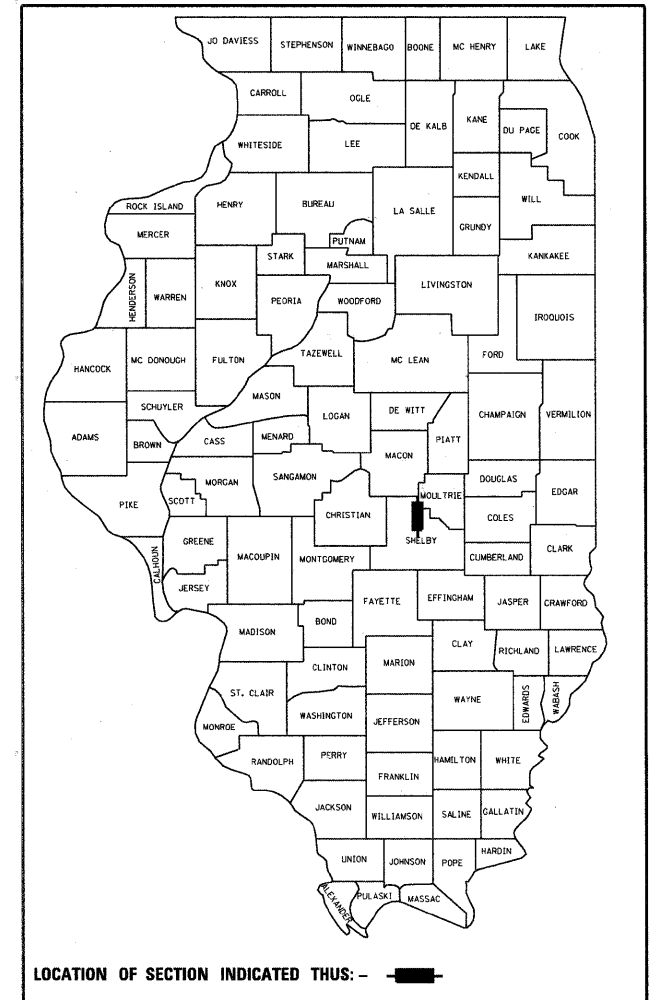

FOR INDEX OF SHEETS, SEE SHEET NO. 2

OMISSIONS

STR. NO. 087-9900
STA 305+97 TO STA 346+23
STR. NO. 087-0017
STA 405+60 TO STA 412+99

ADT (2009) = 3265

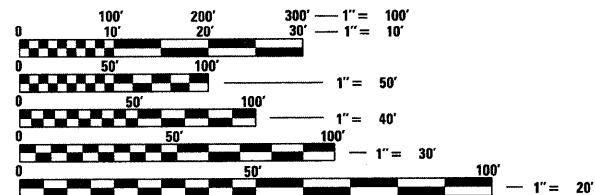

FULL SIZE PLANS HAVE BEEN PREPARED USING STANDARD ENGINEERING SCALES. REDUCED SIZED PLANS WILL NOT CONFORM TO STANDARD SCALES. IN MAKING MEASUREMENTS ON REDUCED PLANS, THE ABOVE SCALES MAY BE USED.

J.U.L.I.E.
JOINT UTILITY LOCATION INFORMATION FOR EXCAVATION
1-800-892-0123
OR 811

PROJECT ENDS
STA 420+08

PROJECT BEGINS
STA 48+29

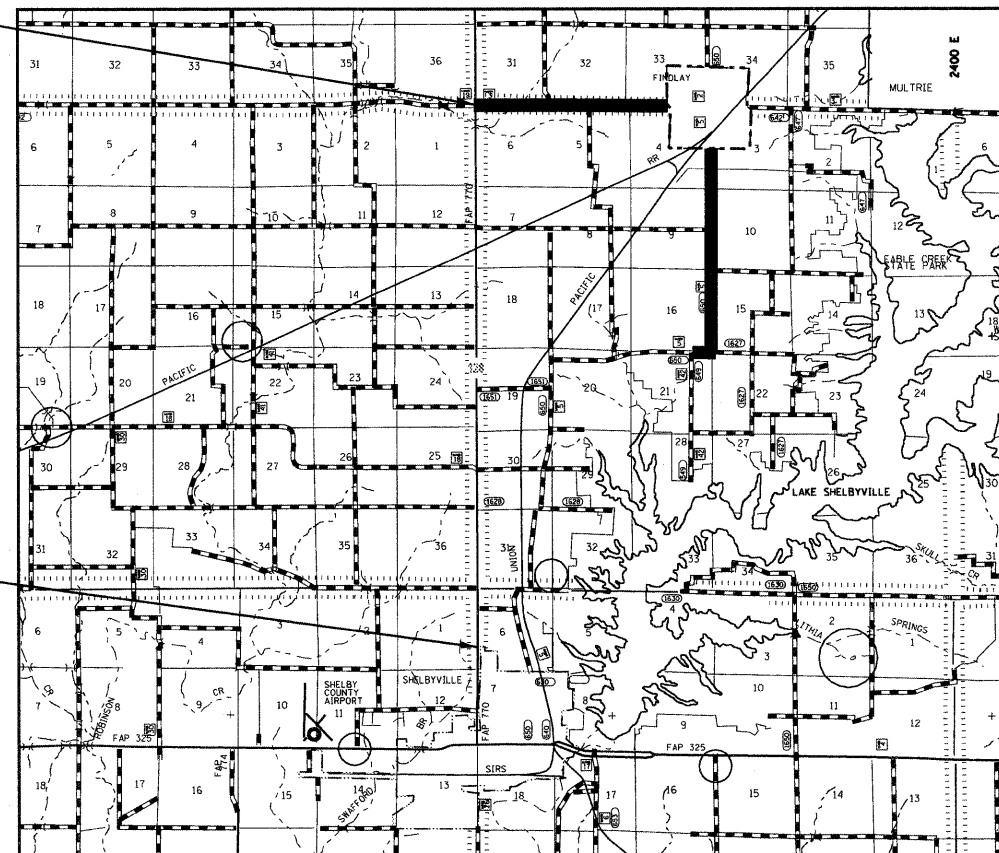

PROJECT ENGINEER: MARK DAUGHERTY
PROJECT MANAGER: KALEB HIRTZEL

CONTRACT NO. 74504

GROSS LENGTH = 37,179 FT. = 7.04 MILE
NET LENGTH = 32,414 FT. = 6.14 MILE

STATE OF ILLINOIS
DEPARTMENT OF TRANSPORTATION
DIVISION OF HIGHWAYS

SUBMITTED DECEMBER 14 2010
Regan Z. Dinkel
DEPUTY DIRECTOR OF HIGHWAYS, REGION ENGINEER

February 4 2011
Scott E. Stitt, P.E.
acting ENGINEER OF DESIGN AND ENVIRONMENT

February 4 2011
Christine M. Reed
DIRECTOR OF HIGHWAYS, CHIEF ENGINEER

**PRINTED BY THE AUTHORITY
OF THE STATE OF ILLINOIS**