

SEE DETAIL SHEET NO. 60 & 61 FOR SIDEROAD AND ENTRANCE TRANSITIONS.

EXIST. CURVE C2
 PI STA. = 480+71.78
 $\Delta = 18^\circ 25' 07''$ (LT)
 $D = 1^\circ 29' 39''$
 $R = 3,834.59'$
 $T = 621.71'$
 $L = 1,232.70'$
 $E = 50.07'$
 $e = \text{-----}$
 $T.R. = \text{-----}$
 $S.E. \text{ RUN} = \text{-----}$
 $P.C. \text{ STA.} = 474+50.07$
 $P.T. \text{ STA.} = 486+82.76$

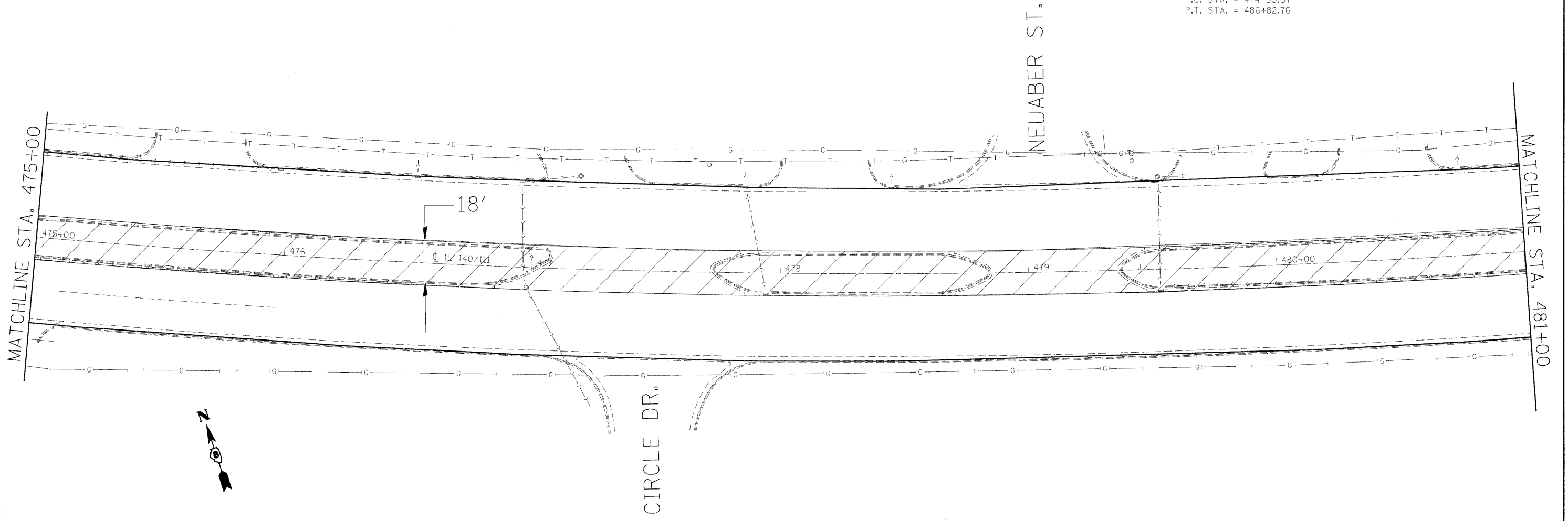

SEE SCHEDULES FOR STORM SEWER RELATED QUANTITIES.

REMOVAL
 CURB, MEDIAN, &
 PAVEMENT REMOVAL
 PROPOSED
 PCC PAVEMENT 10" (JOINTED)
 4" AGGREGATE SUBBASE

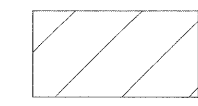

REVISOR'S MARK: Δ REVISED SHEET 4/13/11

SCALE 1"=20'

FILE NAME =	USER NAME = #USER#	DESIGNED -	REVISOR -	STATE OF ILLINOIS DEPARTMENT OF TRANSPORTATION	PLAN SHEET	F.A.P. RTE.	SECTION	COUNTY	TOTAL SHEETS	SHEET NO.	
#FILE#	PLOT SCALE = #SCALE#	DRAWN -	REVISOR -			785	(132-2,3,4, 133-1)RS	MADISON	122	48	
	PLOT DATE = #DATE#	CHECKED -	REVISOR -			CONTRACT NO. 76B80					
		DATE -	REVISOR -			FED. ROAD DIST. NO. ILLINOIS FED. AID PROJECT					