

BENCHMARK: I.B.M. CUT SQUARE ON CONC. HEADWALL
 STA. 198+95.46, 89.3' LT.
 EL. 200+00

DATE	
BY	
PLAN	
NO.	
DATE	
BY	
PROFILE	
NO.	

DATE	
BY	
PROFILE	
NO.	
DATE	
BY	
PLAN	
NO.	

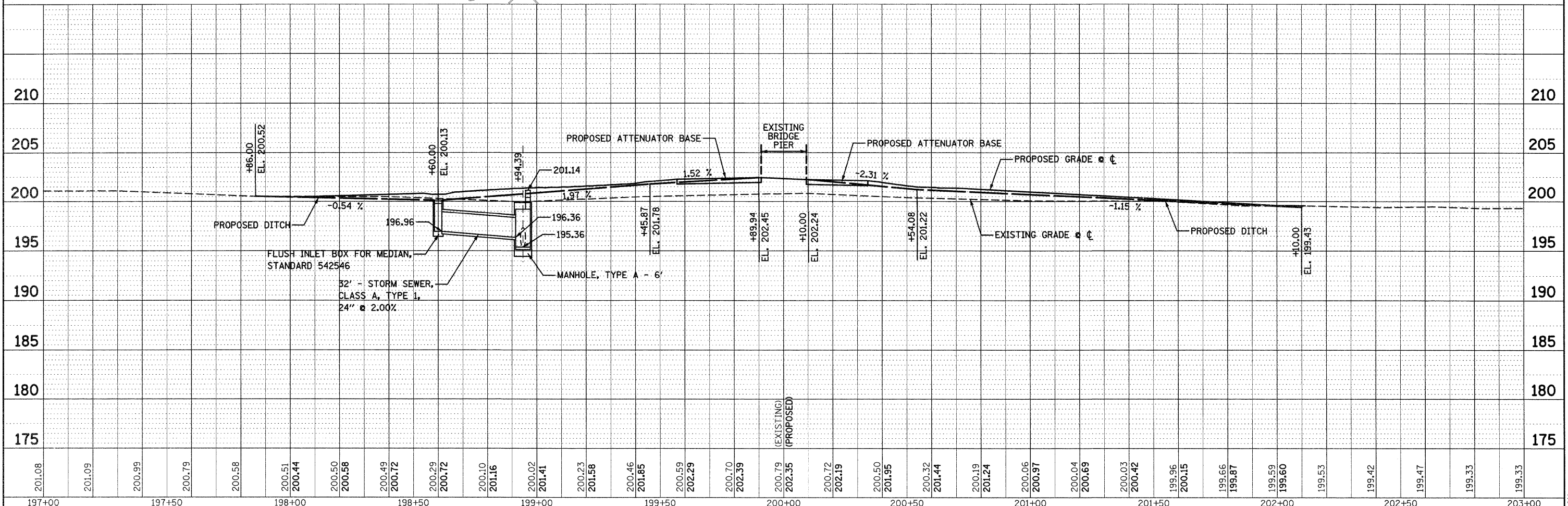
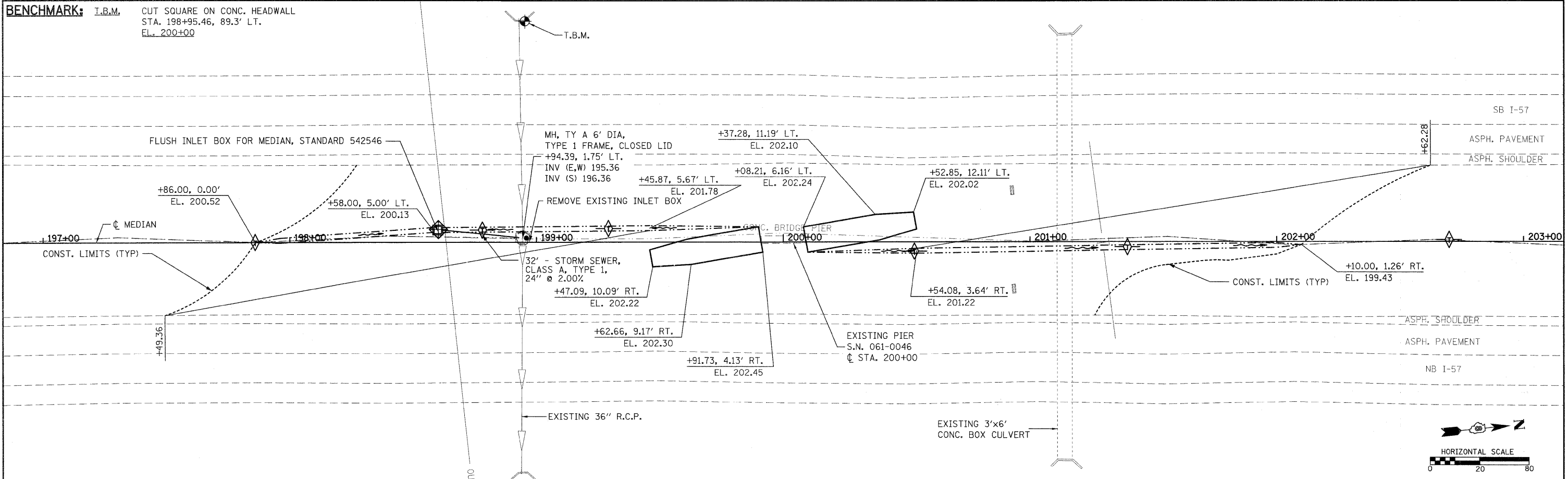

FILE NAME =	USER NAME = keplercj	DESIGNED - KMM	REVISED -	STATE OF ILLINOIS DEPARTMENT OF TRANSPORTATION	PLAN & PROFILE ▲ REVISED SHEET 41211	F.A.T. RTE. 57	SECTION 61-(1,2,3,4,5,6)-I	COUNTY MARION	TOTAL SHEETS 86	SHEET NO. 13	
PLT SCALE = 24,0000' / IN.	CHECKED - BGH	REVISOR -	SCALE: _____			SHEET NO. 1 OF 1 SHEETS	STA. 197+00 TO STA. 203+00	CONTRACT NO. 76E30			
PLT DATE = 3/16/2011	DATE	REVISOR -	FED. ROAD DIST. NO. - ILLINOIS FED. AID PROJECT								
HENRY, MEISENHEIMER & GENDE, INC. LAKE RD., P.O. BOX 70 CARLYLE, ILL. 62231 (618) 594-3711 WWW.HMGENGINEERS.COM											

HMG NO. 6513.01