

BENCHMARK: T.B.M. CUT SQUARE ON BRIDGE PIER
 STA. 299+89.91, 73.7' LT.
 EL. 200.00

T.B.M.  CONC. BRIDGE PIER

PLAN	SURVEYED	BY	DATE
	NOTED		
	CHECKED		
	RT. OF WAY CHECKED		
	NO. _____		
	PAID FILE NAME		

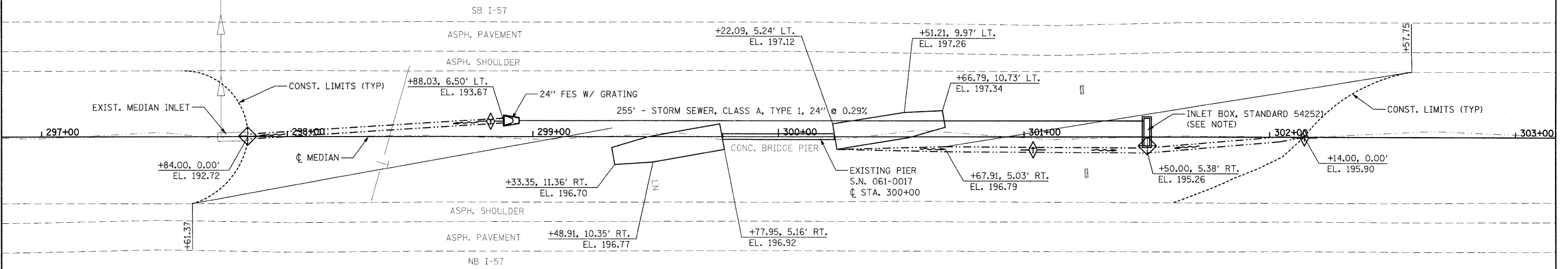

NOTE:

FLOW LINE OF 24" RCP SHALL BE SET 3" ABOVE BOTTOM OF INLET AND INLET SHALL BE GROUTED TO PROVIDE POSITIVE FLOW TO PIPE.

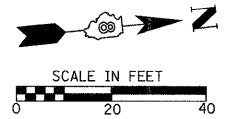

PROFILE	SURVEYED	BY	DATE
	NOTED		
	CHECKED		
	RT. OF WAY CHECKED		
	NO. _____		
	STRUCTURE NOTATION CHKD		

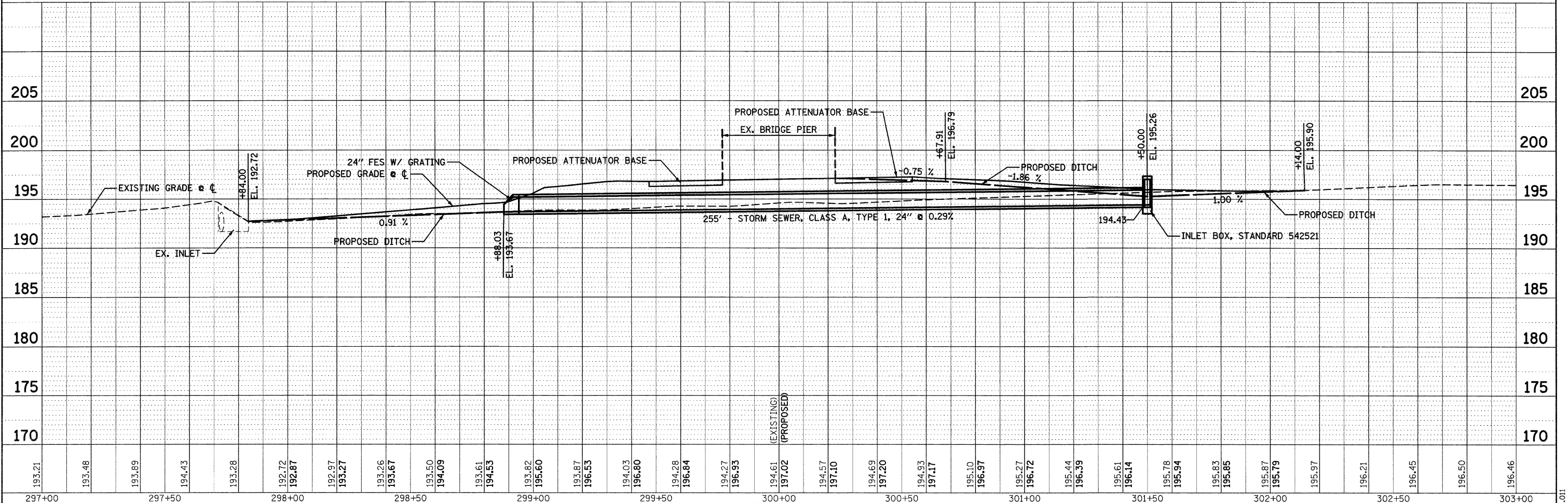

FILE NAME =	USER NAME = keplerc1	DESIGNED - KMM	REVISED -	STATE OF ILLINOIS DEPARTMENT OF TRANSPORTATION	PLAN & PROFILE REVISED SHEET 4/12/11	F.A.I. RTE. 57	SECTION 61-(1,2,3,4,5,6)-I	COUNTY MARION	TOTAL SHEETS 86	SHEET NO. 14	
ca:\pw\work\p\dot\keplerc1\d0263834\d087652	0-shht-plnprf-0610017-14.dgn	DRAWN - KHL	REVISED -			S.N. 061-0017		CONTRACT NO. 76E30			
	PLOT SCALE = 20.0000' / IN.	CHECKED - BGH	REVISED -			SCALE: _____		SHEET NO. 1 OF 1 SHEETS		STA. 297+00 TO STA. 303+00	
	PLOT DATE = 3/16/2011	DATE -	REVISED -			FED. ROAD DIST. NO. _____		ILLINOIS FED. AID PROJECT		CONTRACT NO. 76E30	