

OVERHEAD SIGN STRUCTURE - STA 36+000

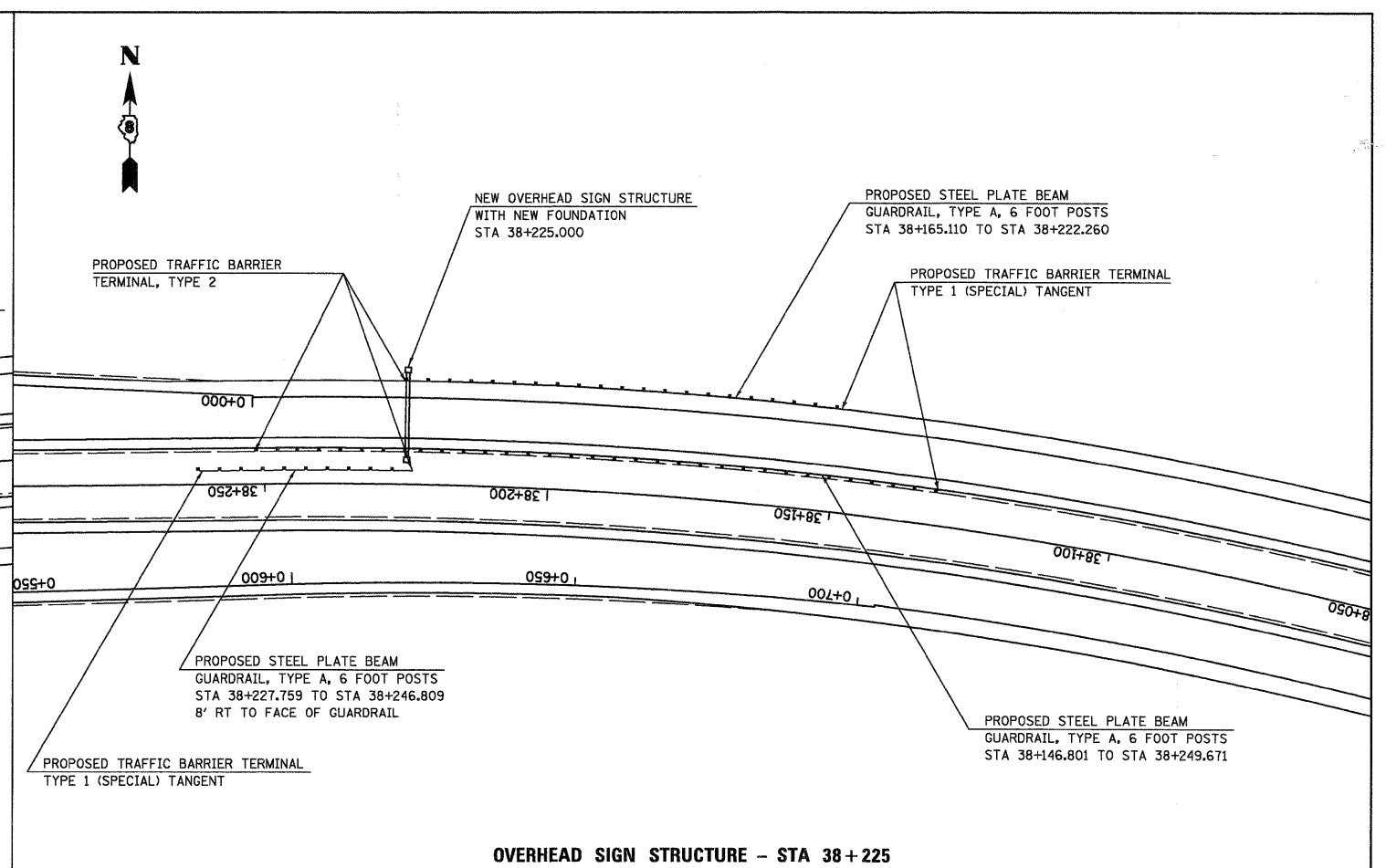

OVERHEAD SIGN STRUCTURE - STA 38+225

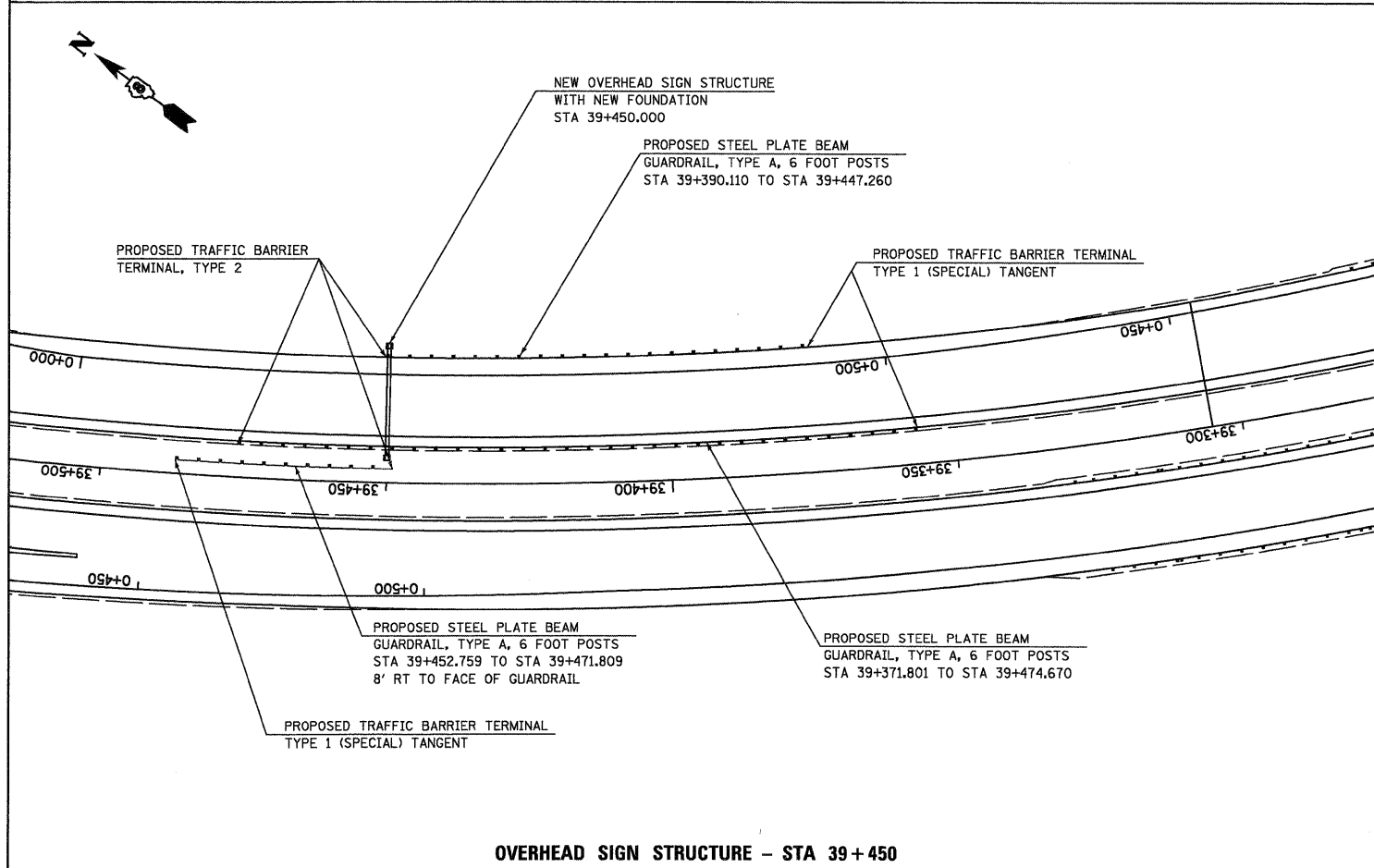

OVERHEAD SIGN STRUCTURE - STA 39+450

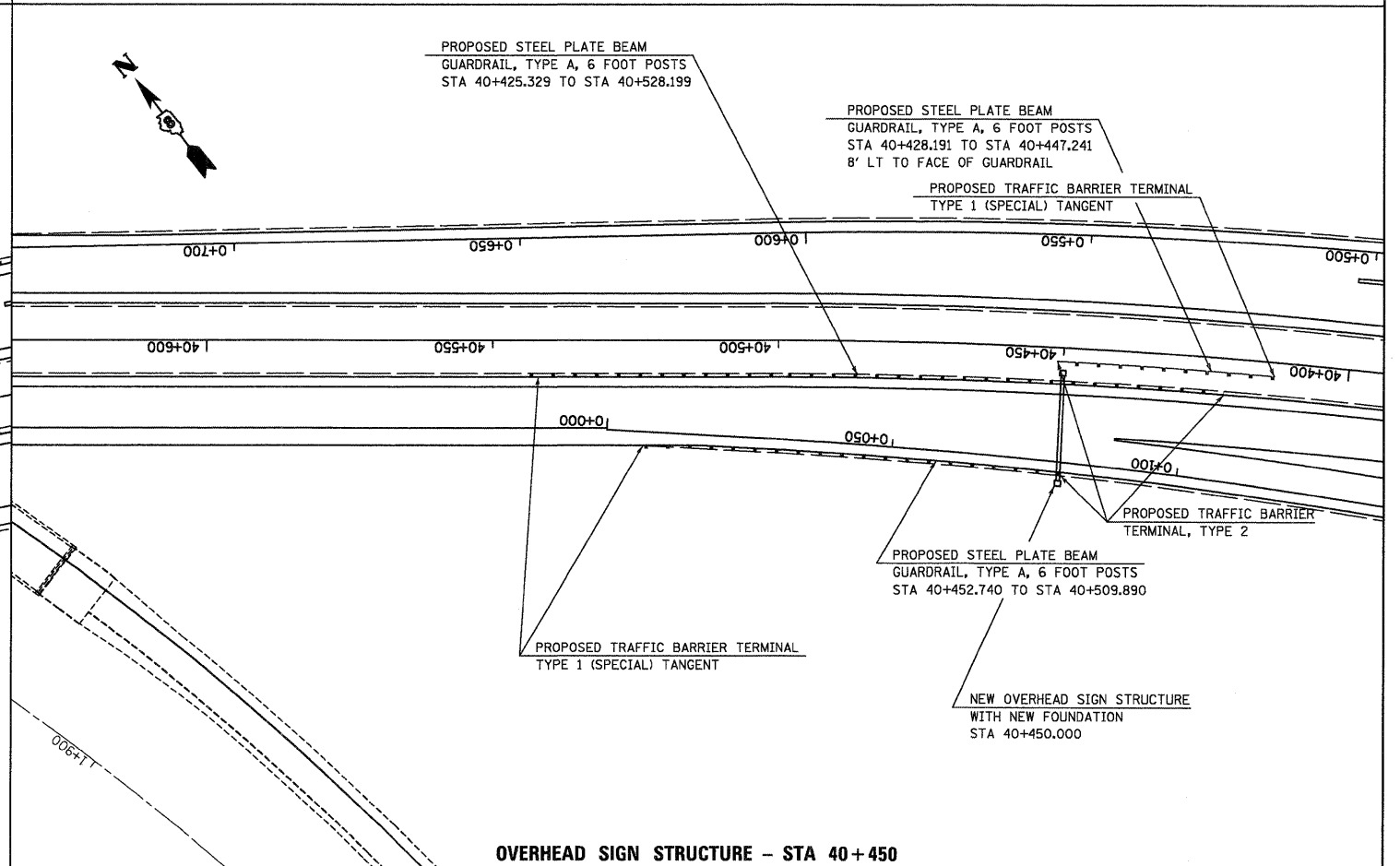

OVERHEAD SIGN STRUCTURE - STA 40+450

FILE NAME =  
... \DB76E76-Sht-P1en.dgn

USER NAME = CFC...  
PLOT SCALE = 50.00000' / IN.  
PLOT DATE = 2/1/2011

DESIGNED -	REVISED -
DRAWN -	REVISED -
CHECKED -	REVISED -
DATE -	REVISED -

**STATE OF ILLINOIS  
DEPARTMENT OF TRANSPORTATION**

**GUARDRAIL LAYOUT FOR OVERHEAD SIGN STRUCTURES**

SCALE: 1"=50'      SHEET NO. 1 OF 1 SHEETS      STA.      TO STA.

F.A.P. RTE. 310	SECTION 60-155G	COUNTY MADISON	TOTAL SHEETS 54	SHEET NO. 7
ILLINOIS FED. AID PROJECT			CONTRACT NO. 76E76	