

STAGE 1 NOTES

1. REMOVE EXISTING SHOULDER AND PAVEMENT. PLACE EMBANKMENT, HMA PAVEMENT AND SHOULDERS.
2. CLOSE IL 13 OUTSIDE EB ACCORDING TO STD 701422 AND WB OUTSIDE THROUGH LANE ACCORDING TO STD 701701.
3. FOR EACH PARTIAL OR FULL DAY IL 13 RESTRICTED TO ONE THROUGH LANE, A LANE RENTAL WILL BE CHARGED.
4. AS SOON AS POSSIBLE MOVE BARRICADES BACK TO ALLOW TWO THROUGH LANES OF TRAFFIC ON IL 13.

STAGE 1

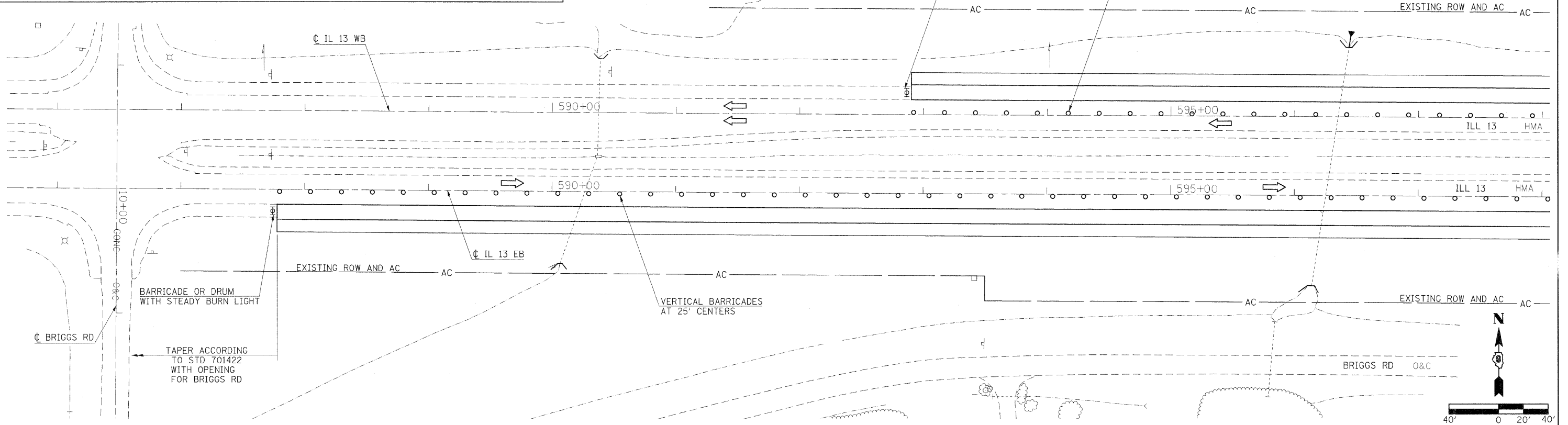

STAGE 1

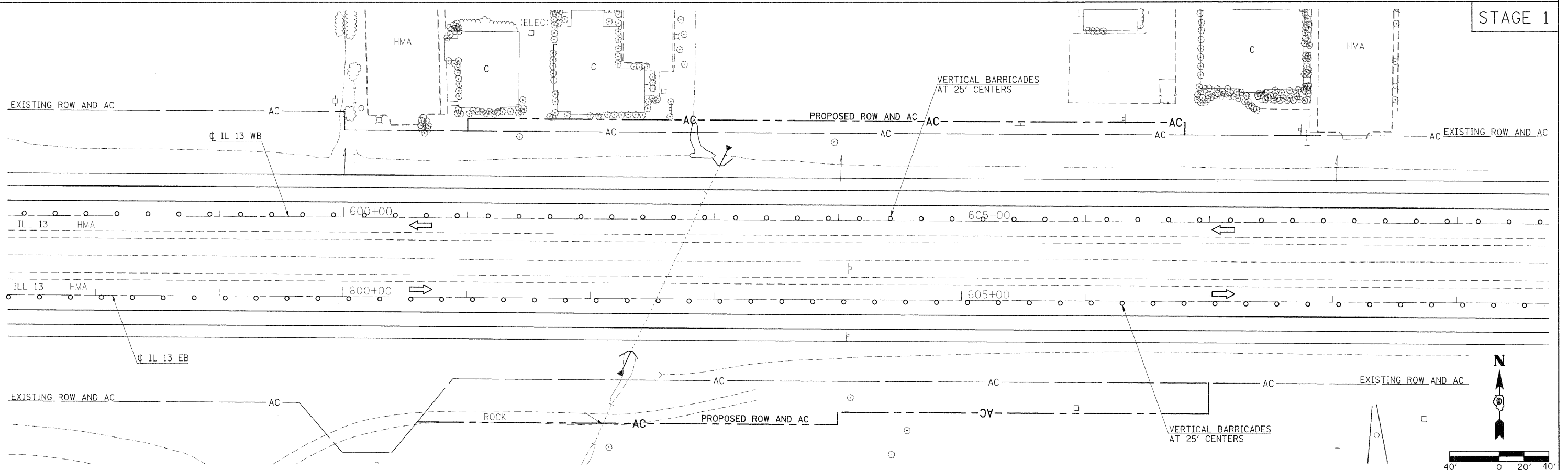

FILE NAME = c:\pwwork\knightm\135592\78133-shr-staging.dgn

USER NAME = knightm	DESIGNED -	REVISED -
PLOT SCALE = 48,0000 "/>		

**STATE OF ILLINOIS
DEPARTMENT OF TRANSPORTATION**

**STAGING SHEET
STAGE 1**

SCALE: 1"=40' SHEET NO. OF SHEETS STA. TO STA.

F.A.P. RTE.	SECTION	COUNTY	TOTAL SHEETS	SHEET NO.
331	(I-3,I-2)N-I,TS-2	WILLIAMSON	251	72
CONTRACT NO. 78133				
ILLINOIS FED. AID PROJECT				