

STAGE 1 NOTES

1. REMOVE EXISTING SHOULDER AND PAVEMENT. PLACE EMBANKMENT, HMA PAVEMENT AND SHOULDERS.
2. PUSH PROPOSED 18" STORM SEWER UNDER IL 13 EXISTING LANES PRIOR TO PLACING HMA PAVEMENT/SHOULDER.
3. CLOSE IL 13 OUTSIDE EB AND WB OUTSIDE THROUGH LANE ACCORDING TO STD 701701.
4. FOR EACH PARTIAL OR FULL DAY IL 13 RESTRICTED TO ONE THROUGH LANE, A LANE RENTAL WILL BE CHARGED.
5. AS SOON AS POSSIBLE MOVE BARRICADES BACK TO ALLOW TWO THROUGH LANES OF TRAFFIC ON IL 13.

STAGE 1

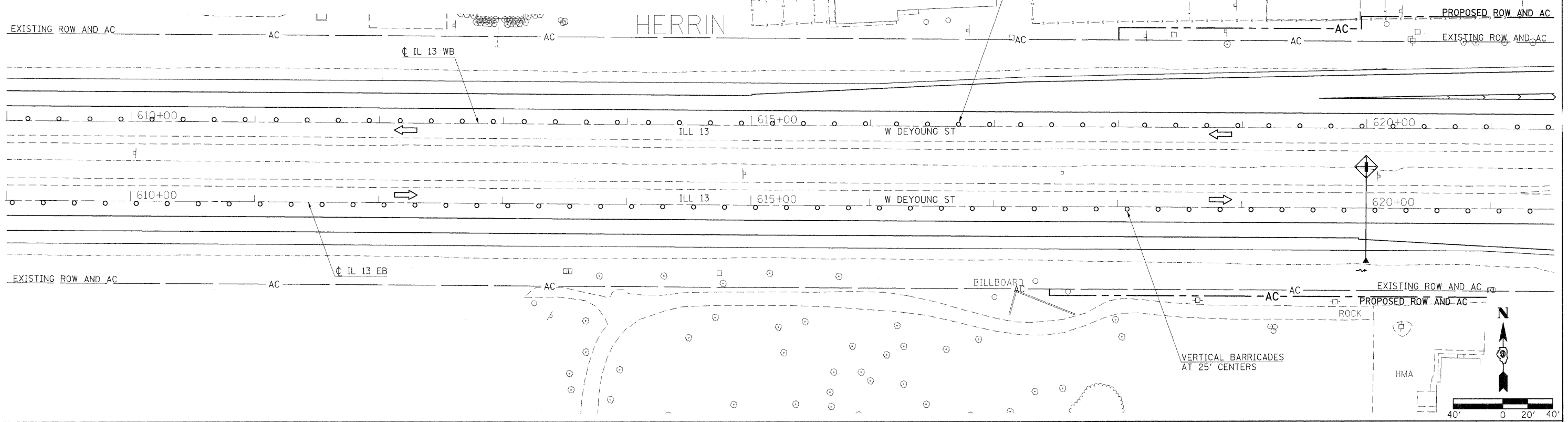

STAGE 1

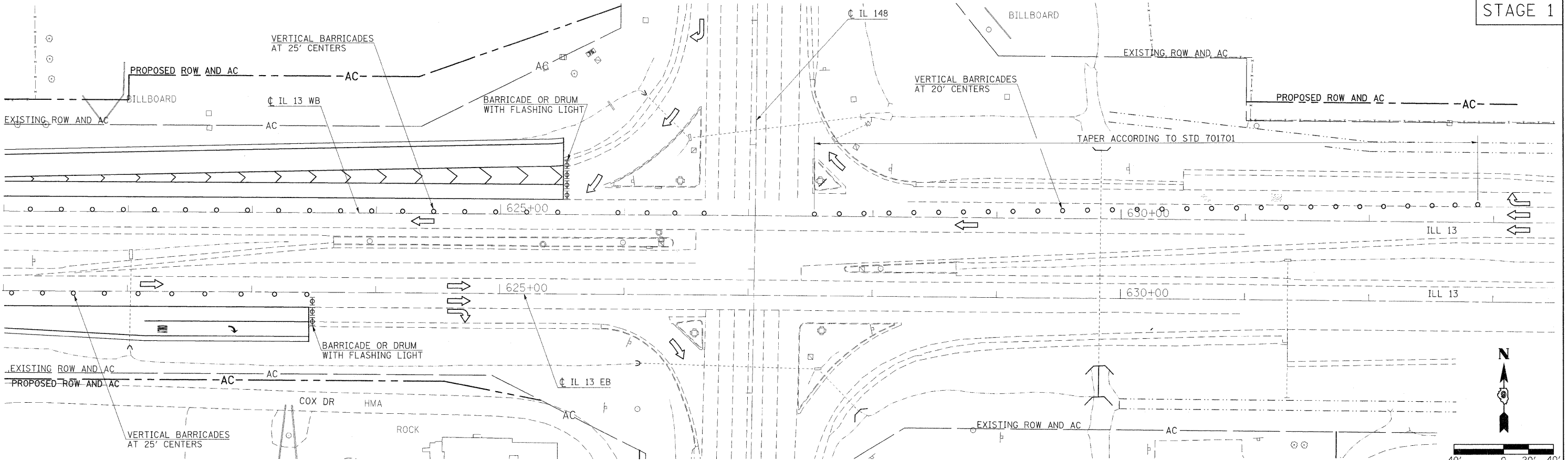

FILE NAME = c:\pwworkh\pawdot\knighteam\0135592.78133.sht-astaging.dgn

USER NAME = knighteam	DESIGNED -	REVISED -
PLOT SCALE = 40,0000' / IN.	DRAWN -	REVISED -
PLOT DATE = 1/3/2011	CHECKED -	REVISED -
	DATE -	REVISED -

**STATE OF ILLINOIS
DEPARTMENT OF TRANSPORTATION**

STAGING SHEET STAGE 1	
SCALE: 1"=40'	SHEET NO. OF SHEETS STA. TO STA.

F.A.P. RTE. 331	SECTION (I-3,I-2)N-1,TS-2	COUNTY WILLIAMSON	TOTAL SHEETS 251	SHEET NO. 73
CONTRACT NO. 78133				
ILLINOIS FED. AID PROJECT				