

LEGEND

- EXISTING CONDUIT
- ⊠ EXISTING TRAFFIC SIGNAL CONTROLLER
- ⊕ EXISTING SIGNAL HEAD
- ⊙ EXISTING SIGNAL POST
- ⊗ EXISTING LIGHT POLE AND LUMINAIRE
- T CONDUIT IN TRENCH
- P CONDUIT, PUSHED
- " PVC SIZE OF CONDUIT
- ⊠ PROPOSED TYPE IV CABINET, TRAFFIC SIGNAL CONTROLLER, HIGHWAY LIGHTING CONTROLLER, AND SERVICE INSTALLATION
- ⊕ PROPOSED STEEL COMBINATION MAST ARM ASSEMBLY AND POLE
- ⊙ PROPOSED TRAFFIC SIGNAL POST AND SIGNAL HEAD
- ⊕ PROPOSED SIGNAL HEAD WITH BACKPLATE, MAST ARM MOUNTED
- ⊙ PROPOSED GULFBOX JUNCTION
- ⊠ PROPOSED CONCRETE HANDHOLE
- " PVC PROPOSED PVC CONDUIT

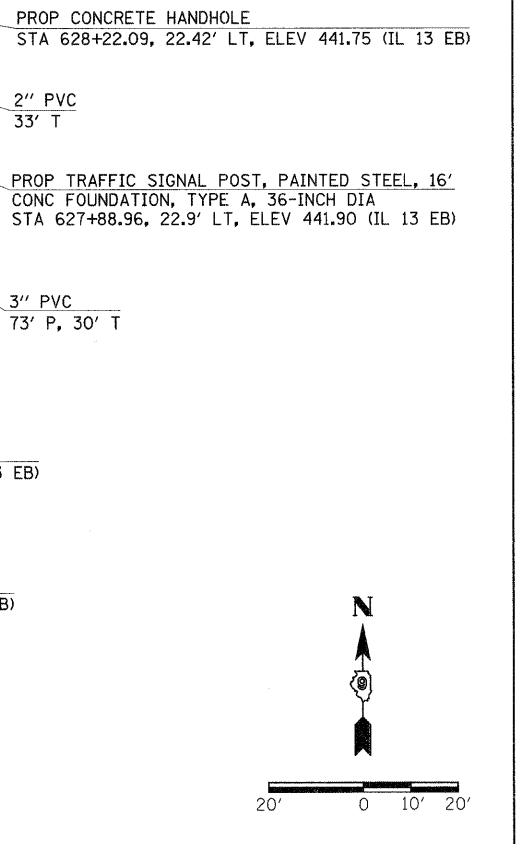

FILE NAME =	USER NAME = knightm	DESIGNED -	REVISED -	STATE OF ILLINOIS DEPARTMENT OF TRANSPORTATION	PROPOSED TRAFFIC SIGNALS AND LIGHTING			F.A.P. RTE.	SECTION	COUNTY	TOTAL SHEETS	SHEET NO.
ca:\pw_work\p1dot\knightsm\d0135592\78133-sh1-ta.dgn	DRAWN -	REVISED -	REVISED -					331	(I-3,I-2)N-1,TS-1	WILLIAMSON	251	103
PLOT SCALE = 20,0000 "/> <td>CHECKED -</td> <td>REVISED -</td> <td>REVISED -</td> <td colspan="4" style="text-align: center;">CONTRACT NO. 78133</td>	CHECKED -	REVISED -	REVISED -		CONTRACT NO. 78133							
PLOT DATE = 1/3/2011	DATE -	REVISED -	REVISED -		ILLINOIS FED. AID PROJECT							