

DATE	
BY	
FINAL SURVEY	
SCREENED	
PLOTTED	
NOTE BOOK	
TEMPLATE	
AREAS	
CHECKED	
NO.	

DATE	
BY	
ORIGINAL SURVEY	
SCREENED	
PLOTTED	
NOTE BOOK	
TEMPLATE	
AREAS	
CHECKED	
NO.	

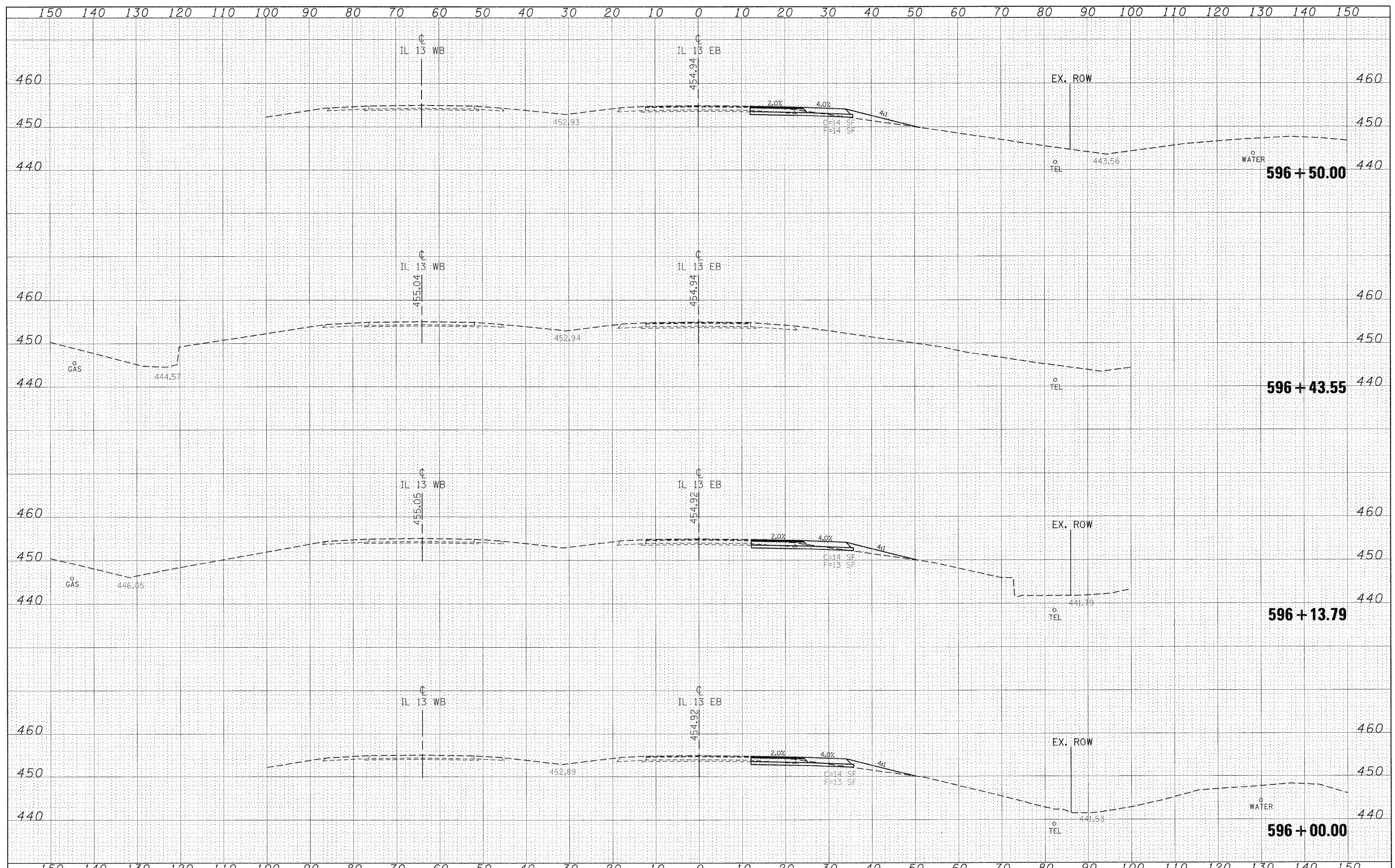

FILE NAME =	USER NAME = knightcm	DESIGNED -	REVISED -	STATE OF ILLINOIS DEPARTMENT OF TRANSPORTATION	IL 13 EASTBOUND CROSS SECTIONS	F.A.P. RTE.	SECTION	COUNTY	TOTAL SHEETS	SHEET NO.
cs:\px_work\pwidot\knightcm\0135592\78133-shr-sec.rtl3eb.dgn		DRAWN -	REVISED -			331	(I-3, I-2N-1, TS-1)	WILLIAMSON	151	119
PLOT SCALE = 10,000.00' / IN.		CHECKED -	REVISED -			CONTRACT NO. 78133				
PLOT DATE = 1/3/2011		DATE -	REVISED -			ILLINOIS FED. AID PROJECT				
SCALE: 1"=10'						SHEET NO. OF SHEETS		STA. 596+00.00 TO STA. 596+50.00		