

STATE OF ILLINOIS
DEPARTMENT OF TRANSPORTATION
DIVISION OF HIGHWAYS

**PROPOSED
HIGHWAY PLANS**

FAP ROUTE 331 (IL13)
SECTION D9 PAVT PRESERVATION 2011-1

MICROSURFACING
SALINE & WILLIAMSON COUNTIES

C-99-077-10

F.A.P. RTE.	SECTION	COUNTY	TOTAL SHEETS	SHEET NO.
331	D9 PAVT PRESERV. 2011-1	ILLINOIS	21	1
			CONTRACT NO. 78218	
•Saline/Williamson Counties				

FOR INDEX OF SHEETS, SEE SHEET NO. 3

ADT (2009) 9100
PV = 8475
MU = 375
SU = 250
TRUCK = 6.8%

Townships: Brushy and
Crab Orchard

EO. STA. 724+21.21 (BK.) =
STA. 725+01.02 (AH.)

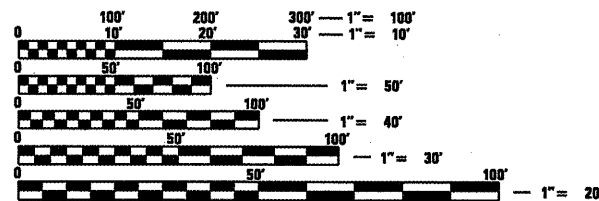

FULL SIZE PLANS HAVE BEEN PREPARED USING STANDARD
ENGINEERING SCALES. REDUCED SIZED PLANS WILL NOT
CONFORM TO STANDARD SCALES. IN MAKING MEASUREMENTS
ON REDUCED PLANS, THE ABOVE SCALES MAY BE USED.

J.U.L.I.E.
JOINT UTILITY LOCATION INFORMATION FOR EXCAVATION
1-800-892-0123
OR 811

PROJECT ENGINEER CHARLES STEIN (618) 351-5210
PROJECT MANAGER KATHI MCCORD (618) 351-5319

CONTRACT NO. 78218

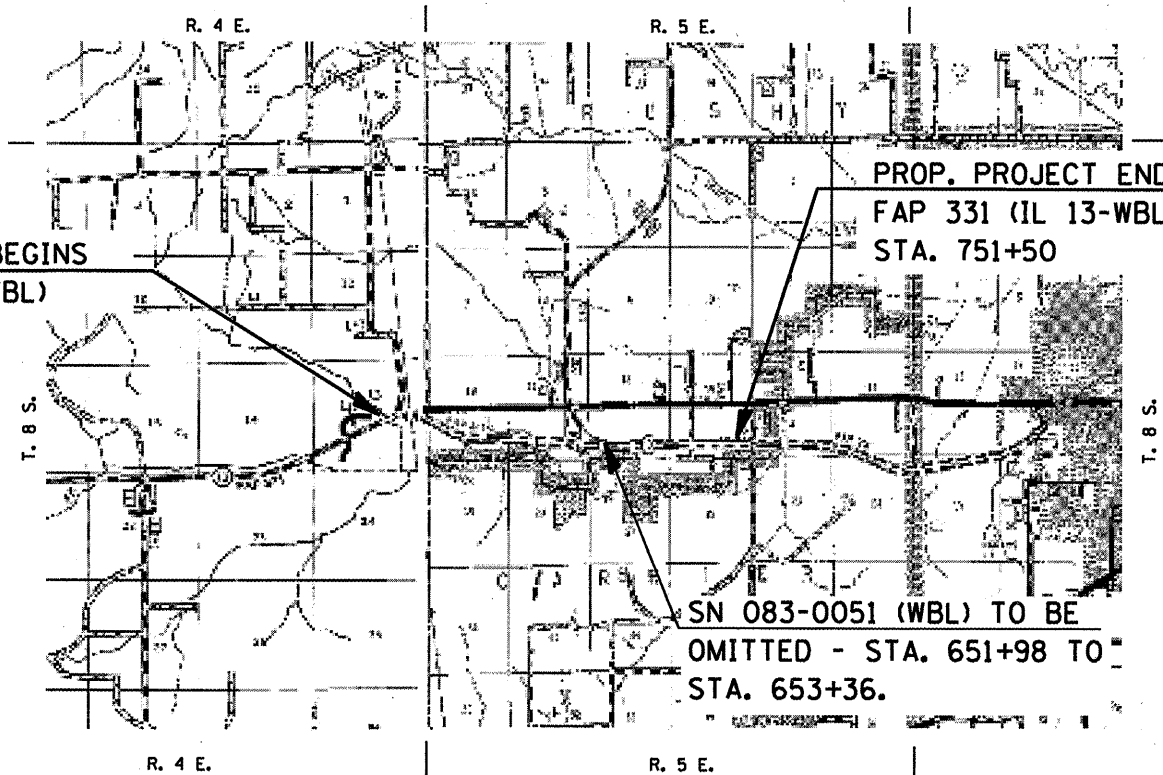

GROSS LENGTH = 23706.19 FT. = 4.49 MILE
NET LENGTH = 23568.19 FT. = 4.46 MILE

D-99-074-10

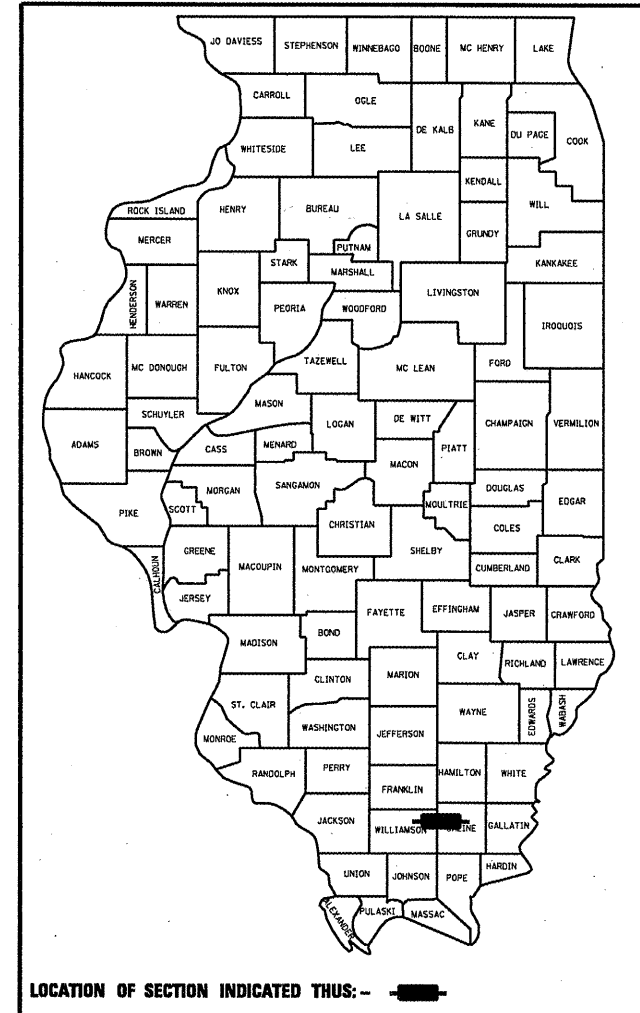

LOCATION OF SECTION INDICATED THUS: - [black rectangle] -

STATE OF ILLINOIS
DEPARTMENT OF TRANSPORTATION
DIVISION OF HIGHWAYS

SUBMITTED Feb 1 20 11

Mary C. Jamis
DEPUTY DIRECTOR OF HIGHWAYS, REGION ENGINEER

March 05 20 11
Scott E. Stitt, P.E.
actg. ENGINEER OF DESIGN AND ENVIRONMENT

March 05 20 11
Christine M. Leader
DIRECTOR OF HIGHWAYS, CHIEF ENGINEER

PRINTED BY THE AUTHORITY
OF THE STATE OF ILLINOIS