

STATE OF ILLINOIS
DEPARTMENT OF TRANSPORTATION
DIVISION OF HIGHWAYS

**PROPOSED
HIGHWAY PLANS**

FAP ROUTE 869 (IL 14)
SECTION D9 PAVT PRESERVATION 2011-2

PERRY COUNTY
C-99-006-11

F.A.P. RTE.	SECTION	COUNTY	TOTAL SHEETS	SHEET NO.
869	D9 PAVT PRESERV 2011-2	PERRY	11	1
ILLINOIS			CONTRACT NO. 78227	

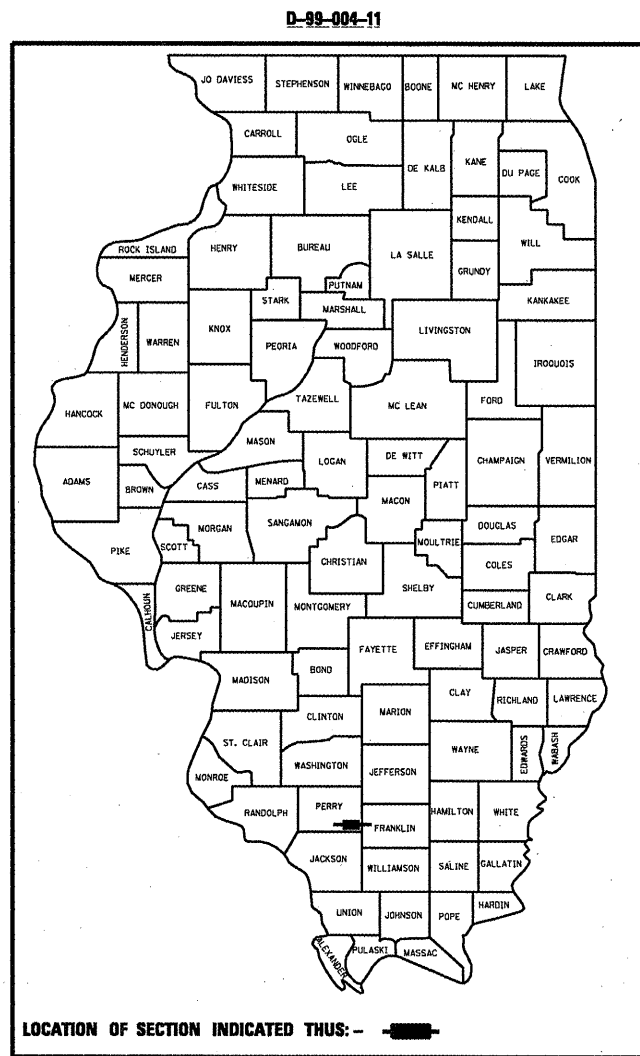

FOR INDEX OF SHEETS, SEE SHEET NO. 3

ADT (2009) 3300
MU = 250
SU = 175
TRUCK = 12.8%

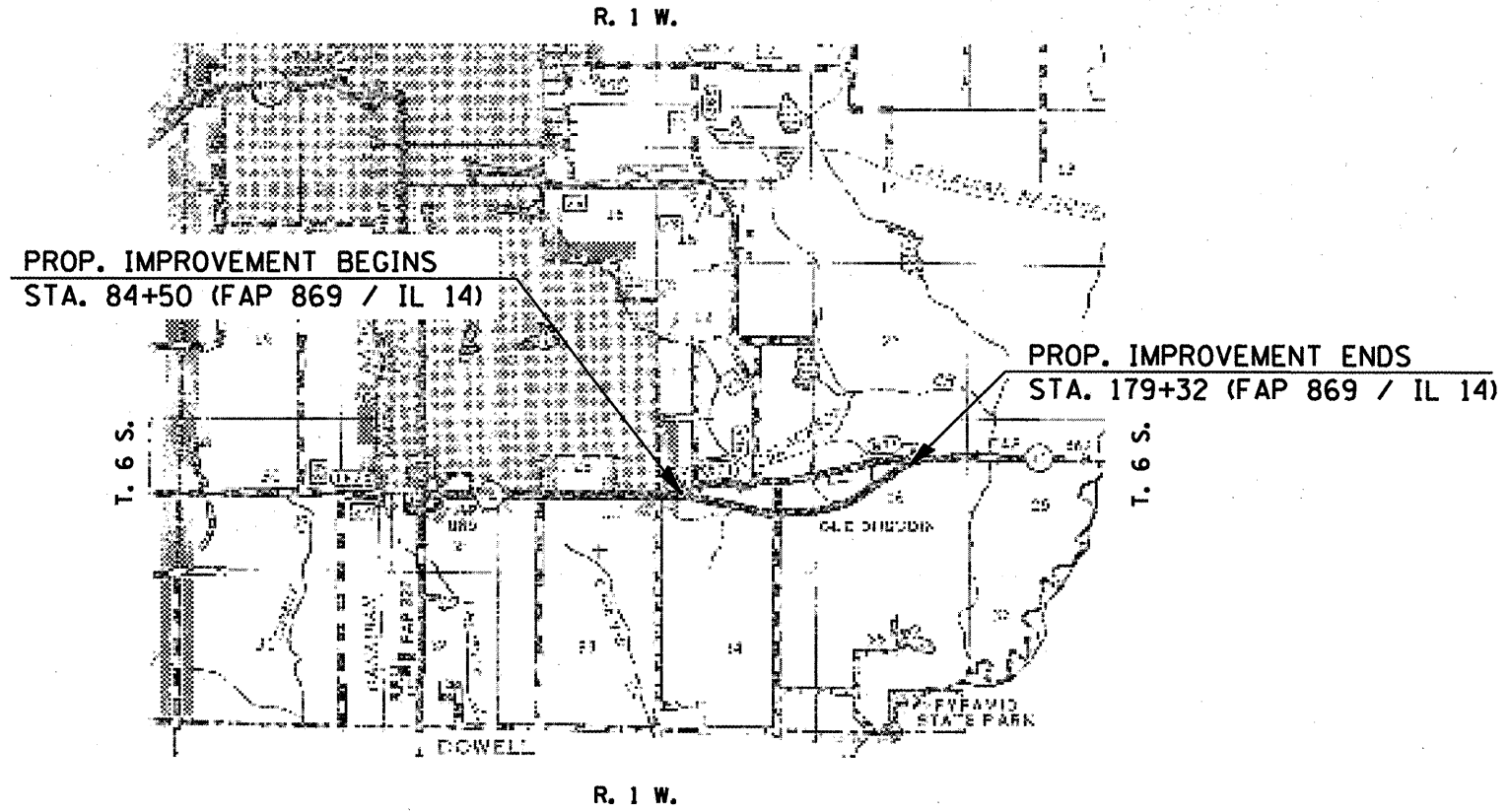

TOWNSHIP: DUQUOIN

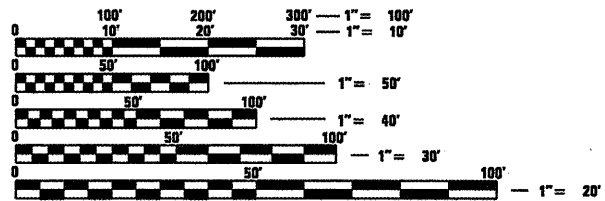

FULL SIZE PLANS HAVE BEEN PREPARED USING STANDARD ENGINEERING SCALES. REDUCED SIZED PLANS WILL NOT CONFORM TO STANDARD SCALES. IN MAKING MEASUREMENTS ON REDUCED PLANS, THE ABOVE SCALES MAY BE USED.

J.U.L.I.E.
JOINT UTILITY LOCATION INFORMATION FOR EXCAVATION
1-800-892-0123
OR 811

PROJECT ENGINEER CHARLES STEIN - (618) 351-5210
PROJECT MANAGER KATHI MCCORD - (618) 351-5319

GROSS LENGTH = 9482 FT. = 1.79 MILE
NET LENGTH = 9482 FT. = 1.79 MILE

CONTRACT NO. 78227

STATE OF ILLINOIS
DEPARTMENT OF TRANSPORTATION
DIVISION OF HIGHWAYS

SUBMITTED Jan 31 2011

Mary C. Zarnia
DEPUTY DIRECTOR OF HIGHWAYS, REGION ENGINEER

March 26 2011
Scott E. Stitt, P.E.
Acting ENGINEER OF DESIGN AND ENVIRONMENT

March 25 2011
Christine M. Reed
DIRECTOR OF HIGHWAYS, CHIEF ENGINEER

**PRINTED BY THE AUTHORITY
OF THE STATE OF ILLINOIS**