







EROSION CONTROL NOTES

1. THE CONTRACTOR WILL BE REQUIRED TO IMPLEMENT AND MAINTAIN EROSION CONTROL MEASURES IMMEDIATELY AFTER STRIPPING OF EXISTING VEGETATION.
2. STOCKPILES OF SOIL AND OTHER BUILDING MATERIALS TO REMAIN IN PLACE MORE THAN THREE (3) DAYS SHALL BE FURNISHED WITH EROSION AND SEDIMENT CONTROL MEASURES (I.E. PERIMETER SILT FENCE). STOCKPILES TO REMAIN IN PLACE FOR 14 DAYS OR MORE SHALL RECEIVE TEMPORARY SEEDING. COST INCLUDED IN PERIMETER EROSION BARRIER.
3. THE CONTRACTOR SHALL TAKE ALL PRECAUTIONS TO PREVENT POLLUTION OF STORM WATER AND SHALL FOLLOW IEPA REGULATIONS & IDOT CONSTRUCTION MEMORANDUM NO. 06-60.
4. STABILIZATION MEASURES SHALL BE INITIATED WITHIN 7 DAYS OF CONSTRUCTION ACTIVITY TEMPORARILY OR PERMANENTLY CEASING IN AREAS WHERE IT WILL NOT OCCUR FOR A PERIOD OF 14 OR MORE CALENDAR DAYS.
5. THE SOIL EROSION AND SEDIMENT CONTROL PRACTICES WILL BE INSPECTED WEEKLY AND AFTER 1/2 INCH OF RAIN OR MORE BY THE INDIVIDUAL ON SITE IN CHARGE OF SOIL EROSION AND SEDIMENT CONTROL DURING THE CONSTRUCTION OF THE PROJECT.
6. INLET AND PIPE PROTECTION SHALL BE INSTALLED FOLLOWING THE COMPLETION AND STABILIZATION OF THE STORMWATER FACILITIES AND WILL REMAIN IN PLACE UNTIL THE CONTRIBUTING AREA IS STABILIZED.
7. ALL ADJACENT STREETS MUST BE KEPT CLEAR OF DEBRIS, INSPECTED DAILY AND CLEANED WHEN NECESSARY OR AS DIRECTED BY THE ENGINEER.
8. ALL SOIL EROSION AND SEDIMENT CONTROL PRACTICES ARE REFERENCED FROM THE ILLINOIS URBAN MANUAL.
9. PROTECTION AND STABILIZATION OF THE STREAMBED IN CONFORMANCE WITH THE ARMY CORPS OF ENGINEERS'S PERMIT SHALL BE INCLUDED IN THE COST OF STONE RIP RAP CLASS A4.

LEGEND

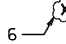
	PERIMETER EROSION BARRIER		FINAL RESTORATION OF DISTURBED AREAS - TOPSOIL FURNISH AND PLACE, 4" - SEEDING CLASS 2A - EROSION CONTROL BLANKET
	EXISTING R.O.W.		INLET AND PIPE PROTECTION
	DIRECTION OF FLOW		TREE REMOVAL OF GIVEN SIZE (PAID AS TREE REMOVAL, 6 TO 15 UNITS DIAMETER, OR TREE REMOVAL, OVER 15 UNITS DIAMETER)
	TREE ROOT PRUNING		

TEMPORARY EROSION CONTROL SEQUENCE OF CONSTRUCTION

1. ESTABLISH TEMPORARY EROSION CONTROL MEASURES AND ERECT PERIMETER EROSION BARRIER ALONG SITE BOUNDARIES PRIOR TO EARTHWORK.
2. INSTALL FINAL RESTORATION OF DISTURBED AREAS.

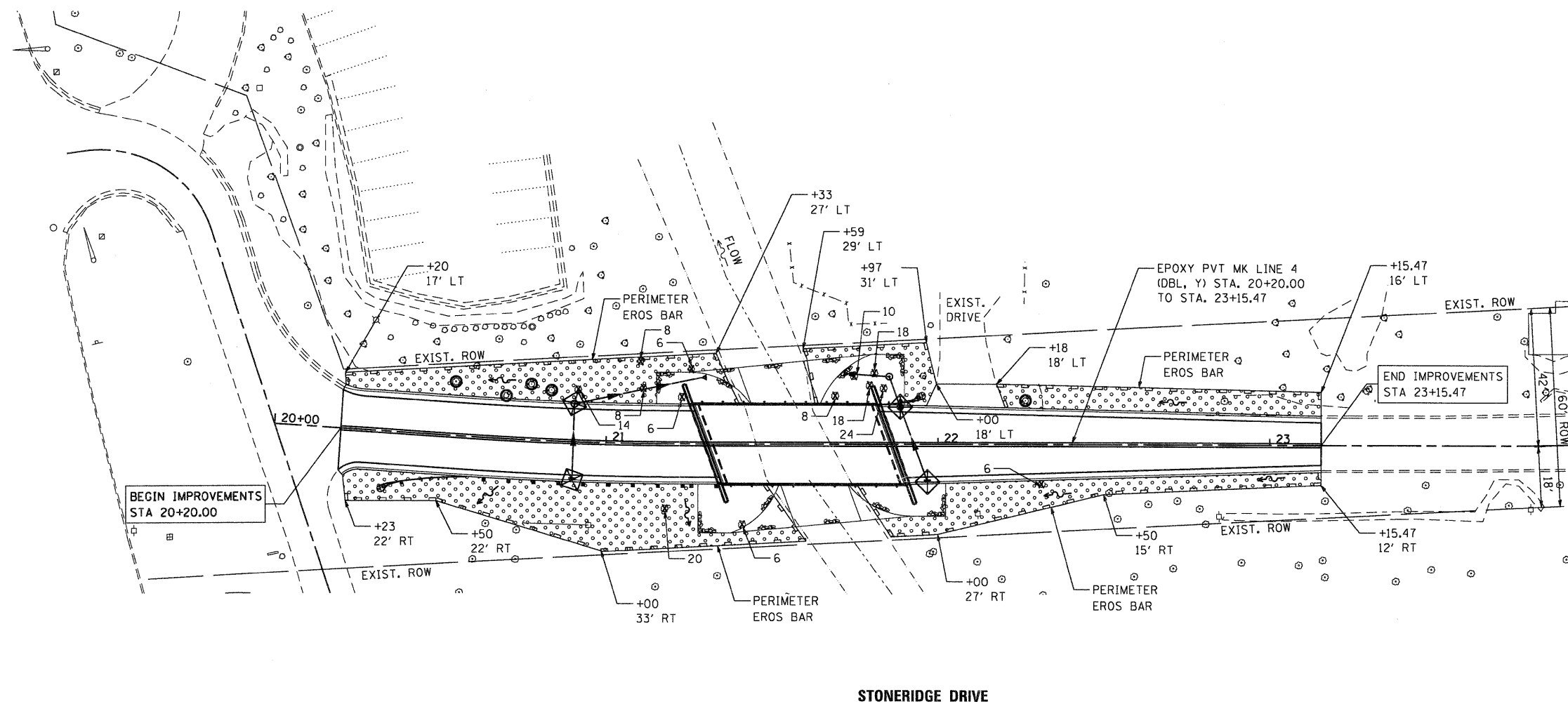

COMPANY NAME: SEC GROUP, INC.
 PROJECT CONTACT: Kevin Arft
 CLIENT: City of Rockford
 DATE PLOTTED: 12/16/2010 10:55:55 PM
 FILE NAME: 86100020-Eros.dgn
 PLOT DRIVER: pdf.plt
 PLOT TABLE: STANDARD-TRANS.TBL

SEC Group, Inc.
 An IFC Group Company
 420 N. First Street
 Rockford, IL 61101-1128
 1-815-395-1778 F 815-395-1781
 www.secgroupinc.com
 262000125 - 2000125 - New Lenox, IL - Chicago, IL

USER NAME = whood	DESIGNED - JMW	REVISED -
FILE NAME = 86100020-Eros.dgn	DRAWN - RCB	REVISED -
PLOT SCALE = 1"=20'	CHECKED - RGD	REVISED -
PLOT DATE = 12/16/2010	DATE - 12/16/10	REVISED -

CITY OF ROCKFORD

STRIPING, EROSION CONTROL AND RESTORATION PLAN
STONERIDGE DRIVE

SCALE: 1"=20' SHEET NO. OF SHEETS STA. TO STA.

F.A.U. RTE.	SECTION	COUNTY	TOTAL SHEETS	SHEET NO.
	09-00559-00-BR	WINNEBAGO	21	7
CONTRACT NO. 85528			FED. ROAD DIST. NO. 2 [ILLINOIS] FED. AID PROJECT	