

SECTION A-A
(Dimensions are at Rt. L's)

Notes:
All concrete wearing surfaces shall be placed prior to casting a backwall.
See sheet S-6 for fabric bearing pad details.

* = For end of Steel Railing, Type SM at end of deck See Railing Details on Sheet S-9.

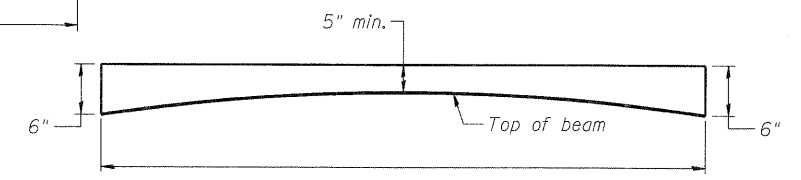
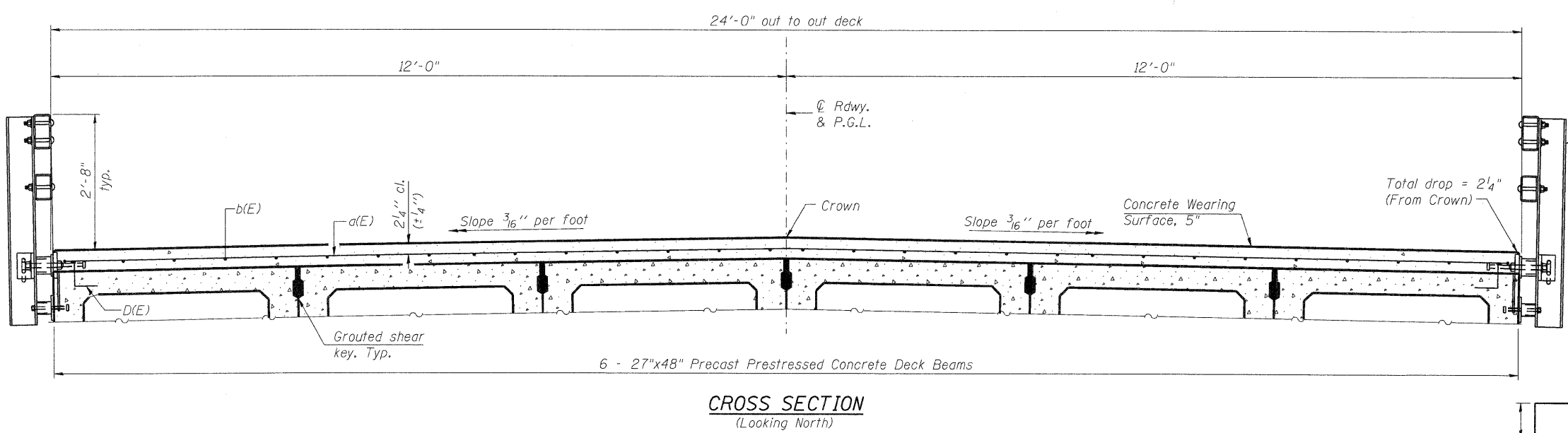

ANTICIPATED CONCRETE WEARING SURFACE PROFILE
(For information only)

Thickness is based on calculated camber minus dead load deflection of PPC Deck Beams. Actual camber of individual units may vary up to ± 1/2". Adjust thickness to match PGL and cross slope.

Notes:
See sheet S-4 through S-6 for Superstructure Details and Bill of Material.
Bars indicated thus 20 x 2-#4 etc. indicates 20 lines of bars with 2 lengths per line.
Spacing of a(E) bars shall be measured along the © of structure.

MINIMUM BAR LAP
#4 bar = 2'-1"

SEC GROUP, INC.
PROJECT CONTACT: [Name]
CLIENT: City of Rockford
DATE PLOTTED: 12/16/2010 10:15:41 AM
FILE NAME: 86100020-das-01.dgn
PLOT DRIVER: PLOT.plt
STANDARD: Trans.tbl

SEC Group, Inc.
1000 Professional Design Firm # 184-000108
2014 N. First Street, Rockford, IL 61102-2139
L: 815.395.1779 F: 815.395.1781
www.secgroupinc.com

USER NAME = whood	DESIGNED - JMW	REVISIONS
PLOT SCALE = N.T.S.	CHECKED - RGD	REVISIONS
PLOT DATE = 12/16/2010	DRAWN - RCB	REVISIONS
	CHECKED - 12/16/10	REVISIONS

STATE OF ILLINOIS
DEPARTMENT OF TRANSPORTATION

DECK PLAN AND CROSS SECTION
STONERIDGE DRIVE - S.N. 101-6011

SHEET NO. S-3 OF 5-12 SHEETS

F.A. RTE.	SECTION	COUNTY	TOTAL SHEETS	SHEET NO.
	09-00559-00-BR	WINNEBAGO	21	10
CONTRACT NO. 85528			ILLINOIS FED. AID PROJECT	