

LEGEND
TBR - TO BE RELOCATED

BM #18 STA. 110+22, 4.5' RT.
CHISELED "+" TOP OF N BOLT
OF FIRE HYDRANT
ELEV. 579.15

* PASSING SPACE - SEE SIDEWALK TYPICAL SECTIONS (SHEET 9).
PROVIDE 5'x10' PASSING SPACE AT APPROXIMATE LOCATIONS
SHOWN. MINOR ADJUSTMENTS MAY BE MADE IN THE FIELD.
200' MAX. BETWEEN PASSING SPACES.

PLAN	DATE
REVISIONS	BY
NOTED	
CHECKED	
FILE NAME	
NO.	

PROFILE	DATE
REVISIONS	BY
NOTED	
CHECKED	
FILE NAME	
NO.	

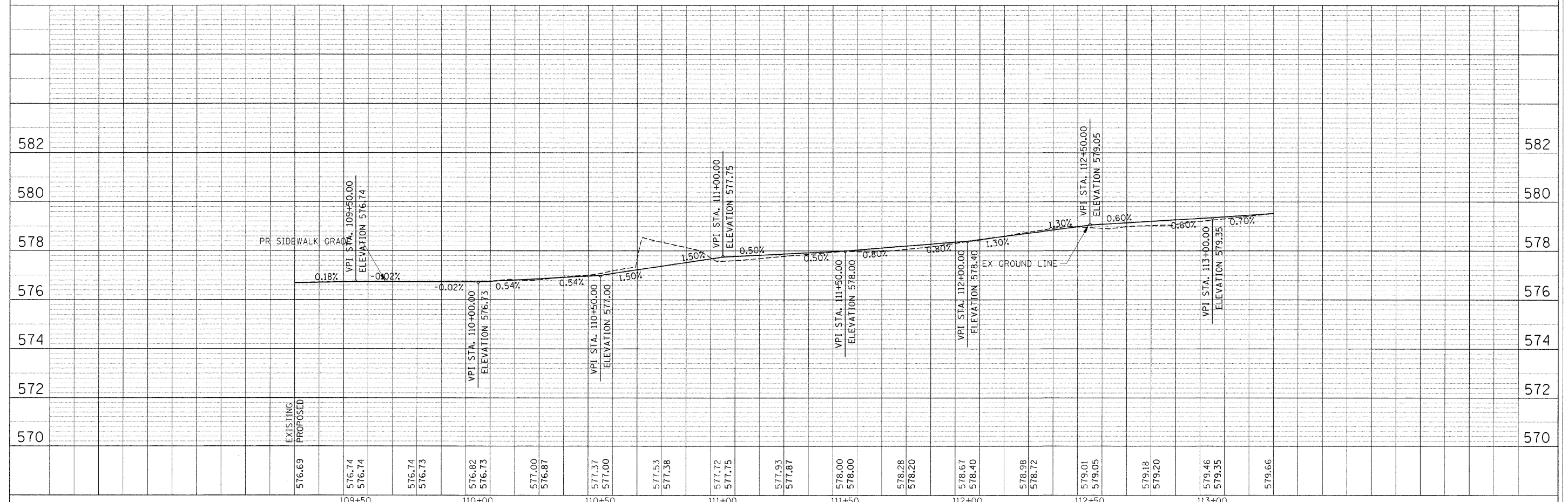

FILE NAME = G:\S07009-01\cadd\2010\7209PP03.SHT	USER NAME = IE Consultants	DESIGNED -	REVISED -	VILLAGE OF SHERMAN				FIRST / SOUTH STREET - PLAN & PROFILE STA 109 + 25 TO STA 113 + 25				F.A. RTE.	SECTION	COUNTY	TOTAL SHEETS	SHEET NO.
		DRAWN -	REVISED -									08-00014-00-SW	SANGAMON	26	12	
		CHECKED -	REVISED -	SCALE:				SHEET NO. OF SHEETS STA. TO STA.				CONTRACT NO. 93486				
		DATE -	REVISED -									FED. ROAD DIST. NO. ILLINOIS FED. AID PROJECT				