

The existing structure, S.N. 084-9916, originally built in 1933 is a 21 span reinforced concrete bridge on both pile supported and spread footings. The existing bridge is 1394'-0" end to end, with a 22'-0" roadway face to face of curbs. The bridge width varies from 36'-10" o.-o. deck at the end spans to 34'-10" o.-o. deck on the main spans.

The existing structure will be renovated. The contractor shall repair the bridge deck and sidewalk and complete all structure repairs. The stone railing shall be renovated by removing and resetting necessary stonework, replacing damaged stones and installing new balusters. New lighting conduits will be installed and light poles erected at the piers as shown in the plans. The bridge deck will be blasted and a new polymer overlay wearing surface shall be applied to the deck.

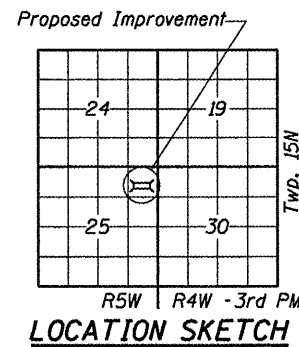
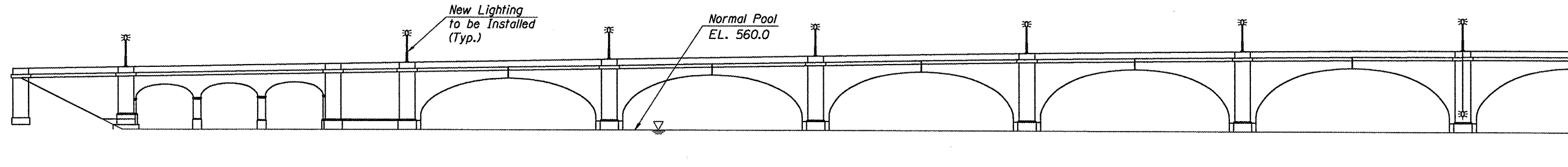
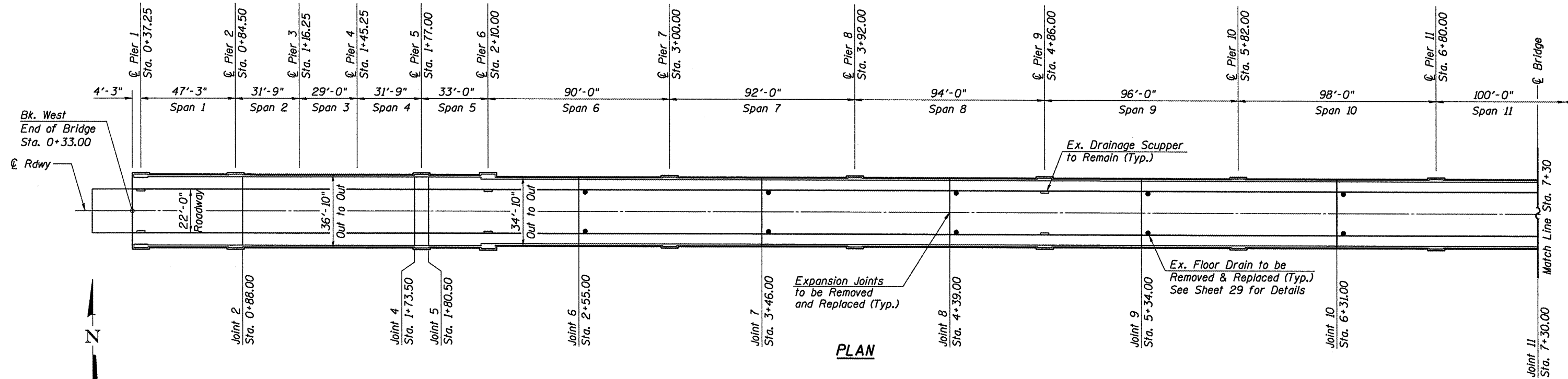

**GENERAL PLAN & ELEVATION
 VACHEL LINDSAY BRIDGE REHABILITATION
 LONG BAY DRIVE OVER LAKE SPRINGFIELD
 SPRINGFIELD, ILLINOIS
 STATION 7+30
 STRUCTURE NO. 084-9916**

CEC Cummins
 Engineering
 Corporation
 Civil and Structural Engineering

JOB = 2207	DESIGNED M.D.C.
FILE = 2207gpe.dgn	CHECKED A.A.M.
DATE = 2/9/2011	DRAWN T.S.H.
	CHECKED M.D.C.

F.A.U. RTE.	SECTION	COUNTY	TOTAL SHEETS	SHEET NO.
8003	09-00469-00-BR	SANGAMON	36	6
CITY OF SPRINGFIELD		CONTRACT NO.		
FED. ROAD DIST. NO.		ILLINOIS FED. AID PROJECT		

03546