

F.A.U. RTE.	SECTION	COUNTY	TOTAL SHEETS	SHEET NO.
8979	05-00017-00-PV	MADISON	37	20
STA. N.A.		TO STA. N.A.		
FED. ROAD DIST. NO.	ILLINOIS	FEDERAL AID PROJECT		

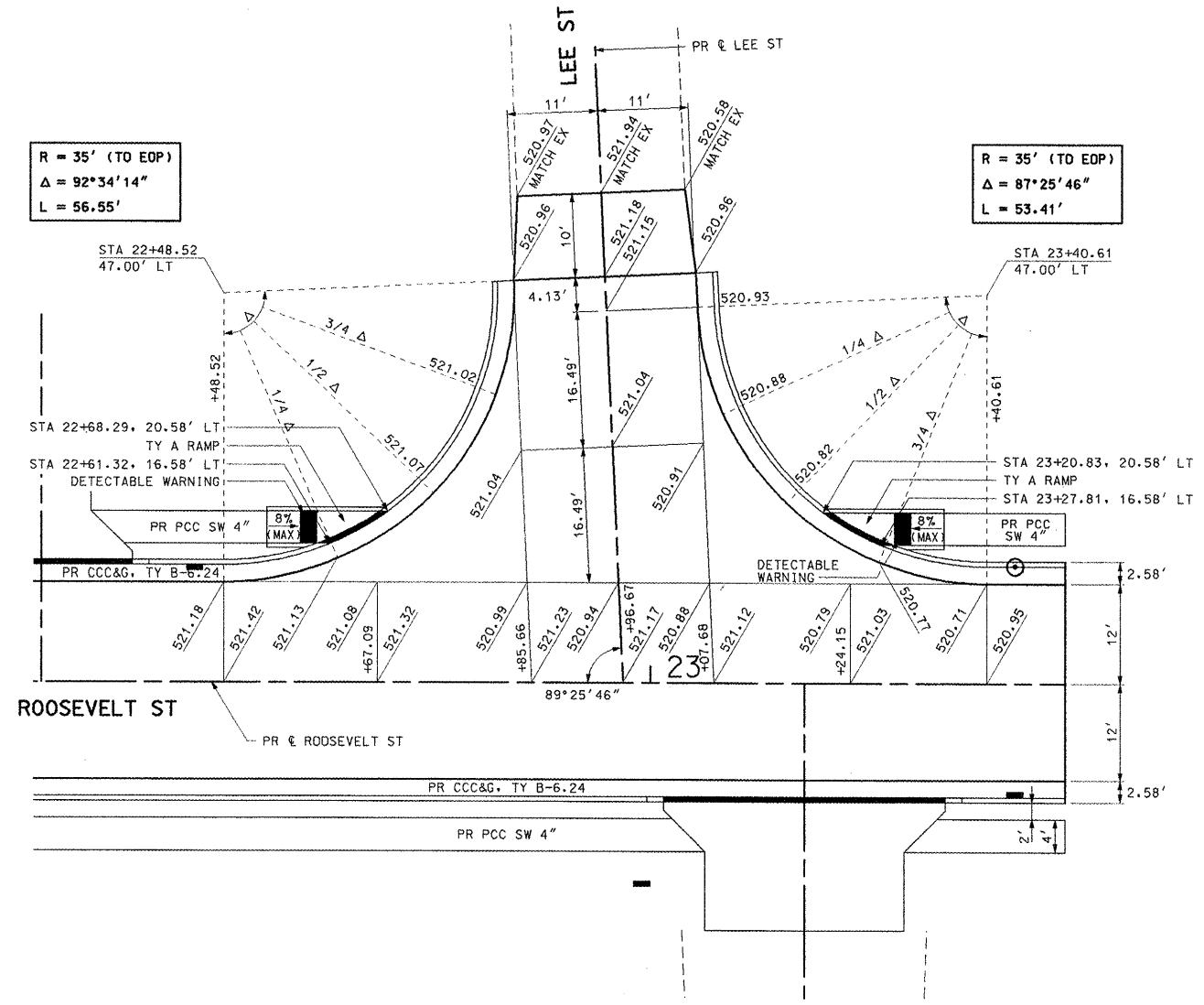
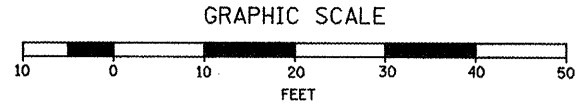

Roosevelt St and Lee St

REVISIONS	
NAME	DATE

ILLINOIS DEPARTMENT OF TRANSPORTATION

INTERSECTION DETAILS

SCALE: VERT. N.A.
 HORIZ. 1"=10'
 DATE 1/27/2011

DRAWN BY RJM, AJK
 CHECKED BY JWB

PLOT DATE = 1/27/2011
 FILE NAME = I:\projects\8979\draw\sheet\8979\8979-05-00017-00-PV\8979-05-00017-00-PV-20.dwg
 PLOT SCALE = 21.75 / 1" IN.
 USER NAME = Rusty Hillenbine