

DATE = 1/27/2011
USER NAME = Raulj.McLennan

SECTION SURVEYED
PLOT TO
NO.

DATE
BY

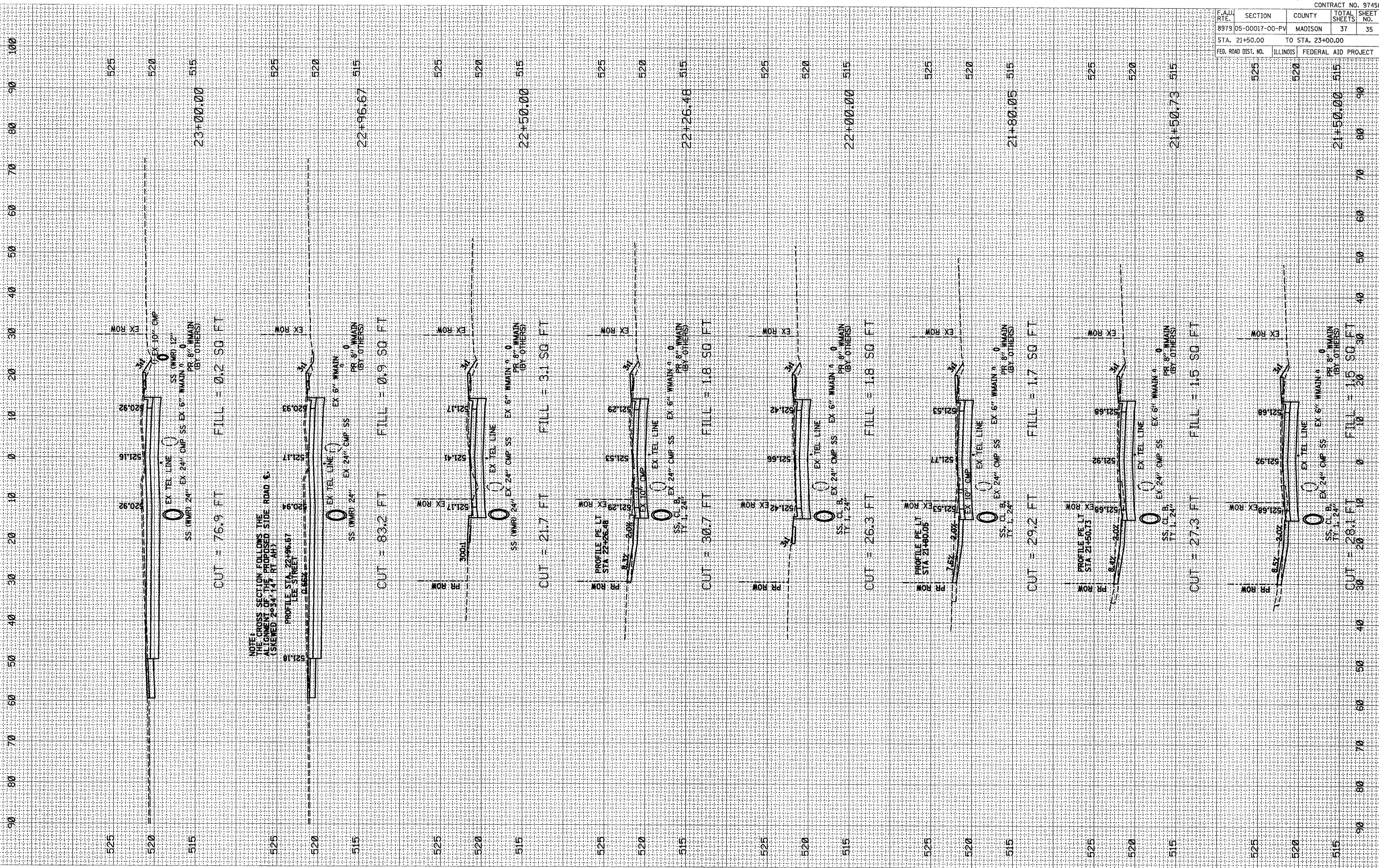

NOTE: CROSS SECTION FOLLOWS THE EXISTING GROUND WITH A 2.0% SLOPE (SIGNED) 2.0% 14' RT. RT. RT.

CONTRACT NO. 97458				
F.A. RTE.	SECTION	COUNTY	TOTAL SHEETS	SHEET NO.
8979	05-00017-00-PV	MADISON	37	35
STA. 21+50.00	TO STA. 23+00.00			
FED. ROAD DIST. NO.	ILLINOIS	FEDERAL AID PROJECT		
525	520	515	90	90
520	515	90	90	90
21+50.00	515	90	90	90
21+50.73	515	90	90	90