

SUMMARY OF QUANTITIES			TOTAL QUANTITIES URBAN	CONSTRUCTION TYPE CODE				
CODE NO	ITEM	UNIT		80% FED 20% STATE 0005	100% STATE 0005			
20100110	TREE REMOVAL (6 TO 15 UNITS DIAMETER)	UNIT	83.4	83.4				
20101300	TREE PRUNING (1 TO 10 INCH DIAMETER)	EACH	7	7				
20101350	TREE PRUNING (OVER 10 INCH DIAMETER)	EACH	2	2				
20101400	NITROGEN FERTILIZER NUTRIENT	POUND	5	5				
20101500	PHOSPHORUS FERTILIZER NUTRIENT	POUND	5	5				
20101600	POTASSIUM FERTILIZER NUTRIENT	POUND	5	5				
20200100	EARTH EXCAVATION	CU YD	187	187				
21101615	TOPSOIL FURNISH AND PLACE, 4"	SO YD	1623	1623				
25200110	SODDING, SALT TOLERANT	SO YD	1623	1623				
25200200	SUPPLEMENTAL WATERING	UNIT	5	5				
40600290	BITUMINOUS MATERIALS (TACK COAT)	POUND	66954	66954				
40600370	LONGITUDINAL JOINT SEALANT	FOOT	35162	35162				
40600400	MIXTURE FOR CRACKS, JOINTS, AND FLANGEWAYS	TON	299	299				
40600982	HOT-MIX ASPHALT SURFACE REMOVAL - BUTT JOINT	SO YD	1158	1158				

SUMMARY OF QUANTITIES			TOTAL QUANTITIES URBAN	CONSTRUCTION TYPE CODE				
CODE NO	ITEM	UNIT		80% FED 20% STATE 0005	100% STATE 0005			
40601005	HOT-MIX ASPHALT REPLACEMENT OVER PATCHES	TON	536	536				
40603200	POLYMERIZED HOT-MIX ASPHALT BINDER COURSE, 1L-4.75, N50	TON	4479	4479				
40605026	POLYMERIZED HOT-MIX ASPHALT SURFACE COURSE, STONE MATRIX ASPHALT, 9.5, MIX "F", N80	TON	10080	10080				
42001300	PROTECTIVE COAT	SO YD	1335	1335				
42300200	PORTLAND CEMENT CONCRETE DRIVEWAY PAVEMENT, 6 INCH	SO YD	350	350				
42300400	PORTLAND CEMENT CONCRETE DRIVEWAY PAVEMENT, 8 INCH	SO YD	291	291				
42400200	PORTLAND CEMENT CONCRETE SIDEWALK 5 INCH	SO FT	11122	11122				
42400800	DETECTABLE WARNINGS	SO FT	1014	1014				
44000159	HOT-MIX ASPHALT SURFACE REMOVAL, 2 1/2"	SO YD	73619	73619				
44000161	HOT-MIX ASPHALT SURFACE REMOVAL, 3"	SO YD	25575	25575				
44000200	DRIVEWAY PAVEMENT REMOVAL	SO YD	641	641				
44000600	SIDEWALK REMOVAL	SO FT	12588	12588				

FILE NAME =	USER NAME = Bllgramiso	DESIGNED -	REVISED -
pw\N\dot-pw\benley.com\PI\DOT\Documents\1007 - Office\District\Projects\157720\CAD\Drawn\Design\157720-sh-5		DRAWN -	REVISED -
	PLOT SCALE = 100,0000' / 1in	CHECKED -	REVISED -
	PLOT DATE = 2/4/2022	DATE -	REVISED -

**STATE OF ILLINOIS
DEPARTMENT OF TRANSPORTATION**

**OAKTON STREET (BUSSE HWY TO WAUKEGAN RD.)
SUMMARY OF QUANTITIES**

SCALE: SHEET NO. OF SHEETS STA. TO STA.

F.A.U. RTE.	SECTION	COUNTY	TOTAL SHEETS	SHEET NO.
1332	2020-158-R5&SW	COOK	43	3
FED. ROAD DIST. NO. 1 ILLINOIS FED. AID PROJECT			CONTRACT NO. 62M46	

△ REVISÉD SHEET 4/8/2022
* = SPECIALTY ITEM

SCHEDULE OF QUANTITIES

SHEET NO.	LOCATION		20101400	20101500	20101600	20200100	21101615	25200110	25200200	42001300	42400200	42400800	44000600	60252800	60255500	89502376	X4400501	Z0004562
	CROSS STREET	CORNER	NITROGEN FERTILIZER NUTRIENT	PHOSPHORUS FERTILIZER NUTRIENT	POTASSIUM FERTILIZER NUTRIENT	EARTH EXCAVATION	TOPSOIL FURNISH AND PLACE, 4"	SODDING, SALT TOLERANT	SUPPLEMENTAL WATERING	PROTECTIVE COAT	PORTLAND CEMENT CONCRETE SIDEWALK 5 INCH	DETECTABLE WARNINGS	SIDEWALK REMOVAL	CATCH BASINS TO BE RECONSTRUCTED	MANHOLES TO BE ADJUSTED	REBUILD EXISTING HANDHOLE	COMBINATION CURB AND GUTTER REMOVAL AND REPLACEMENT LESS THAN OR EQUAL TO 10 FEET	COMBINATION CONCRETE CURB AND GUTTER REMOVAL AND REPLACEMENT (FOOT)
			POUND	POUND	POUND	CU YD	SQ YD	SQ YD	UNIT	SQ YD	SQ FT	SQ FT	SQ FT	EACH	EACH	EACH	FOOT	FOOT
ADA-01	BUSS HWY	NW				1.9				17.1	135.9	13	135.9					12
ADA-01	BUSS HWY	SW				2.9				26.4	170.9	35	170.9					44.6
ADA-02	BUSS HWY	SE				3.0				27.2	183.1	22	183.1					41
ADA-03	FORTUNA AVE	NW	0.2	0.2	0.2	1.9	9.6	9.6		17.5	157.8	10	230.2				9	
ADA-03	FORTUNA AVE	NE	0.2	0.2	0.2	2.1	8.8	8.8		19.2	156.6	10	222.3					19.3
ADA-04	SEELEY AVE	SE	0.2	0.2	0.2	1.9	8.8	8.8		16.8	139.4	10	207.8					14.9
ADA-04	WILKINSON PKWY	SW	0.2	0.2	0.2	1.9	8	8		16.8	128	9	199.6					15.3
ADA-05	WILKINSON PKWY	SE	0.2	0.2	0.2	1.0	8.4	8.4		8.9	67.5	10	132.2					18.8
ADA-05	PARKSIDE PKWY	NW	0.2	0.2	0.2		8.2	8.2				11	73.7					
ADA-06	PARKSIDE PKWY	NE	0.2	0.2	0.2	1.4	7.4	7.4		15.1	122.4		188.9				10	
ADA-06	WESTERN AVE	NE	0			1.7				15.0	196.6	11	114					14.1
ADA-07	KNIGHT AVE	SW	0.2	0.2	0.2	2.0	9.5	9.5		17.9	145.2	10	230.8					10.3
ADA-07	KNIGHT AVE	SE	0.1	0.1	0.1	2.3	2.8	2.8		20.6	144.1	10	169.7					10.9
ADA-08	LINCOLN AVE	NW				2.8				24.8	199.4	16	199.4					16.4
ADA-08	LINCOLN AVE	NE				4.1				36.6	294.6	21	294.6	1				43.1
ADA-09	LINCOLN AVE	SW				1.7				22.2	166.8	25	166.8					32.5
ADA-09	LINCOLN AVE	SE				2.2				20.0	146.6	18	146.6					31.2
ADA-10	DELPHIA AVE	SE				1.7				15.5	107.8	13	107.8			1		21.3
ADA-10	GREENWOOD AVE	SW				3.7				33.2	246.7	32	246.7	1		1		34.6
ADA-11	GRACE AVE	SW	0.2	0.2	0.2	2.3	6.3	6.3		21.0	151.2	13	203.8					29
ADA-11	CLIFTON AVE	NE				1.7				15.4	112.8	11	112.8					17.1
ADA-12	CUMBERLAND AVE	NE				2.8				25.5	191.9	23	191.9			1		25.3
ADA-12	CUMBERLAND AVE	SE				1.3				11.8	84.5	10	82.1					15.9
ADA-13	FAIRVIEW AVE	SW	0.1	0.1	0.1	1.9	0.9	0.9		17.0	122.5	12	130.3					20.2
ADA-13	GREENDALE AVE	NW				1.4				12.2	76.4	14	76.4					22.1
ADA-14	PROSPECT ST	SE				2.3				20.7	155.6	21	151.7					25.4
ADA-14	WASHINGTON AVE	NW				1.5				49.6	403.8	13	403.8					28.5
ADA-15	WASHINGTON AVE	NE				2.0				17.6	135	19	135					22.4
ADA-15	WASHINGTON AVE	SW	0.2	0.2	0.2	1.7	7.1	7.1		15.5	123.1	10	174.2					19.1
ADA-16	WASHINGTON AVE	SE	0.2	0.2	0.2	1.8	7.6	7.6		16.0	128.8	10	184.7					18.7
ADA-16	WISNER ST	NW		0		3.6		0		32.3	258.2	10	258.2			1		26.5
ADA-17	ELMORE ST	NW	0.2	0.2	0.2	2.0	8.2	8.2		18.1	145.3	10	211.8			1		16.9
ADA-17	ELMORE ST	NE	0.2	0.2	0.2	1.9	7	7		16.8	134.4	10	187.2					17.7
ADA-18	MERRILL ST	NW			0	1.8				16.2	146.7	10	135.2				7	
ADA-18	MERRILL ST	NE				2.4				21.8	194.4	10	182.4				9.4	
ADA-19	OZANAM AVE	NW	0.2	0.2	0.2	1.8	7.2	7.2		15.9	129.7	10	185.5					14.8
ADA-19	OZANAM AVE	NE	0.2	0.2	0.2	1.6	6.4	6.4		14.8	127.6	10	176.4				9.8	
ADA-20	OZARK AVE	NW	0.2	0.2	0.2	1.8	7.2	7.2		16.3	131.1	10	186.7			1		16.3
ADA-20	OVERHILL AVE	NW	0.4	0.4	0.4	2.0	17.1	17.1		18.3	143.2	10	290.3					18.4
ADA-21	OVERHILL AVE	NE	0.2	0.2	0.2	1.9	7	7		17.4	141.8	10	194.1					16.8
ADA-21	ORIOLE AVE	NW	0.3	0.3	0.3	1.8	11.5	11.5		15.9	125.9	10	229.1			1		11.7
ADA-22	ORIOLE AVE	NE	0.2	0.2	0.2	2.9	6.4	6.4		26.4	224.5	21	282.5					30.91
ADA-22	OKETO AVE	SE	0.2	0.2	0.2	1.9	7.6	7.6		17.5	140.8	10	203.4					14.7
ADA-23	OKETO AVE	NW	0.3	0.3	0.3	2.4	13.8	13.8		21.8	172.7	10	291.7					18.9
ADA-23	OCONTO AVE	NE				1.7				15.4	120.2	20	115.6			1	1	24.9
TOTAL			5	5	5	93	193	193	5	877.8	6932	613	8398	2	5	4	45.2	853

REVISED SHEET 4/8/2022

OAKTON ST.

BUSSE HWY

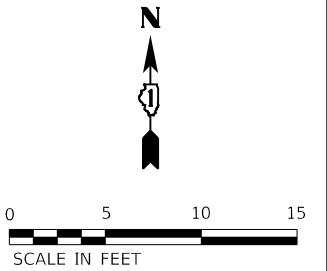

	STATION	OFFSET	ELEVATION
1	15+60.17	27.34' RT	(633.49)
2	15+62.61	29.73' RT	633.73
3	15+68.95	35.00' RT	633.75
4	15+74.46	39.79' RT	633.85
5	15+78.12	42.40' RT	(633.94)
6	15+81.58	45.72' RT	(633.96)
7	15+85.81	49.03' RT	(633.94)
8	15+88.74	45.38' RT	(633.87)
9	15+85.34	42.44' RT	633.96
10	15+92.46	42.67' RT	633.5
11	15+95.58	42.64' RT	(633.28)
12	15+84.79	42.02' RT	633.97
13	15+80.94	38.80' RT	633.87
14	15+79.45	37.54' RT	633.83
15	15+85.70	37.58' RT	633.53
16	15+88.71	37.74' RT	(633.32)
17	15+77.65	36.22' RT	633.81
18	15+72.19	31.71' RT	633.74
19	15+68.95	29.02' RT	(633.49)

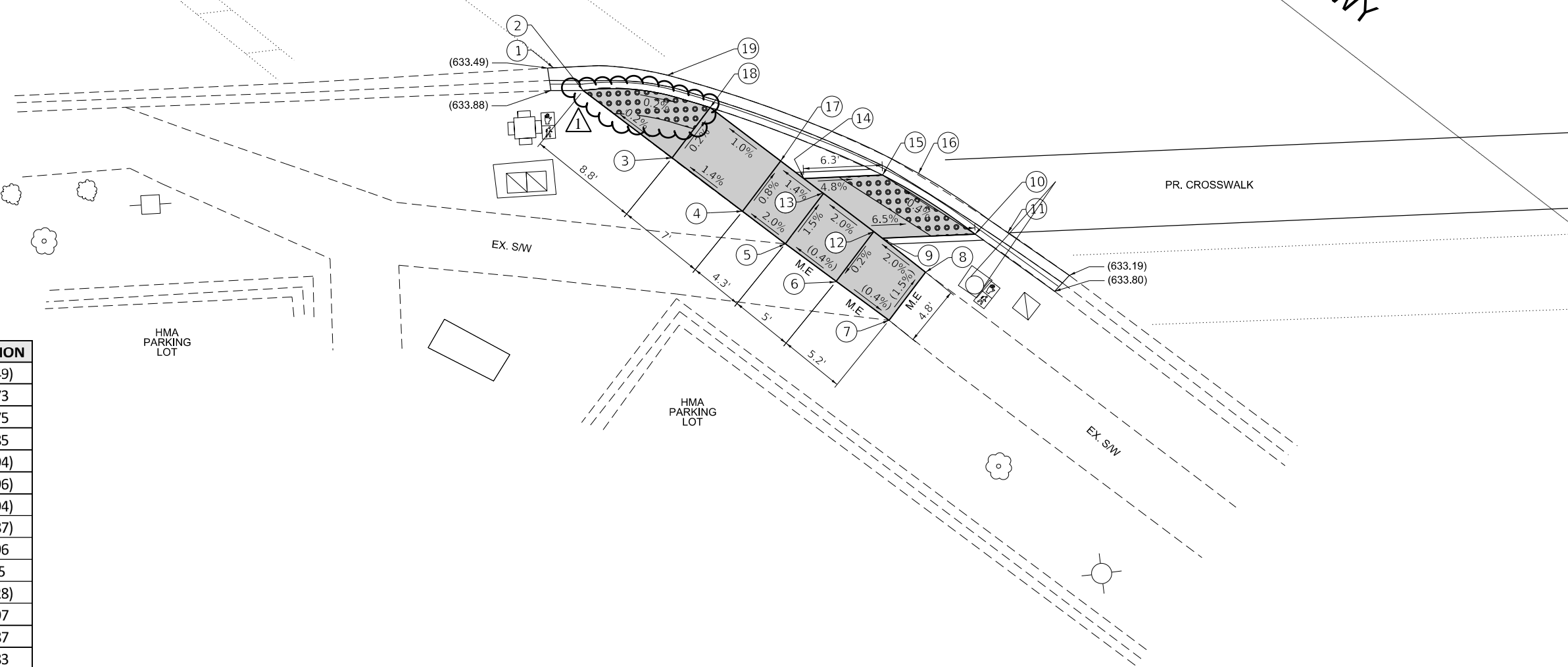

REFERENCE BENCHMARK ELEV 634.83

BENCHMARK : CUT SQUARE IN SOUTH FACE OF T.S BASE

LOCATION : NW CORNER OF BUSSE HWY & OAKTON ST.

LEGEND

- PROPOSED SIDE CURB
- EXISTING ELEVATION/SLOPE
- M.E. MEET EXISTING

- PORTLAND CEMENT CONCRETE SIDEWALK 5 INCH
- DETECTABLE WARNINGS
- SIDEWALK REMOVAL REPLACE W/TOPSOIL F&P 4

REFERENCE BENCHMARK ELEV 634.83

BENCHMARK : CUT SQUARE IN SOUTH FACE OF T.S BASE

LOCATION : NW CORNER OF BUSSE HWY & OAKTON ST.

ADA-02

REVISED SHEET 4/8/2022



USER NAME = JosephKuzdal	DESIGNED - AS/JK	REVISED ADDENDUM A 04/07/22
	DRAWN - AS/JK	REVISED -
PLOT SCALE = 10.0000' / in.	CHECKED - YK/JK	REVISED -
PLOT DATE = 4/4/2022	DATE - 03/10/2022	REVISED -

STATE OF ILLINOIS
DEPARTMENT OF TRANSPORTATION

SIDEWALK DETAIL PLAN
OAKTON STREET - BUSSE HIGHWAY TO IL 43

SCALE: 1"=10' SHEET 2 OF 23 SHEETS STA. TO STA.

F.A.U. RTE.	SECTION	COUNTY	TOTAL SHEETS	SHEET NO.
1332	2020-158-R57SW	COOK	43	15B
CONTRACT NO. 62M46			ILLINOIS FED. AID PROJECT	

N CUMBERLAND AVE.

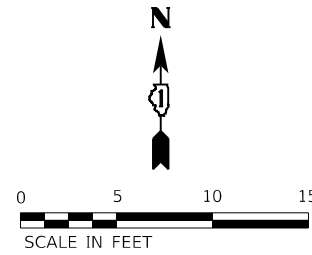
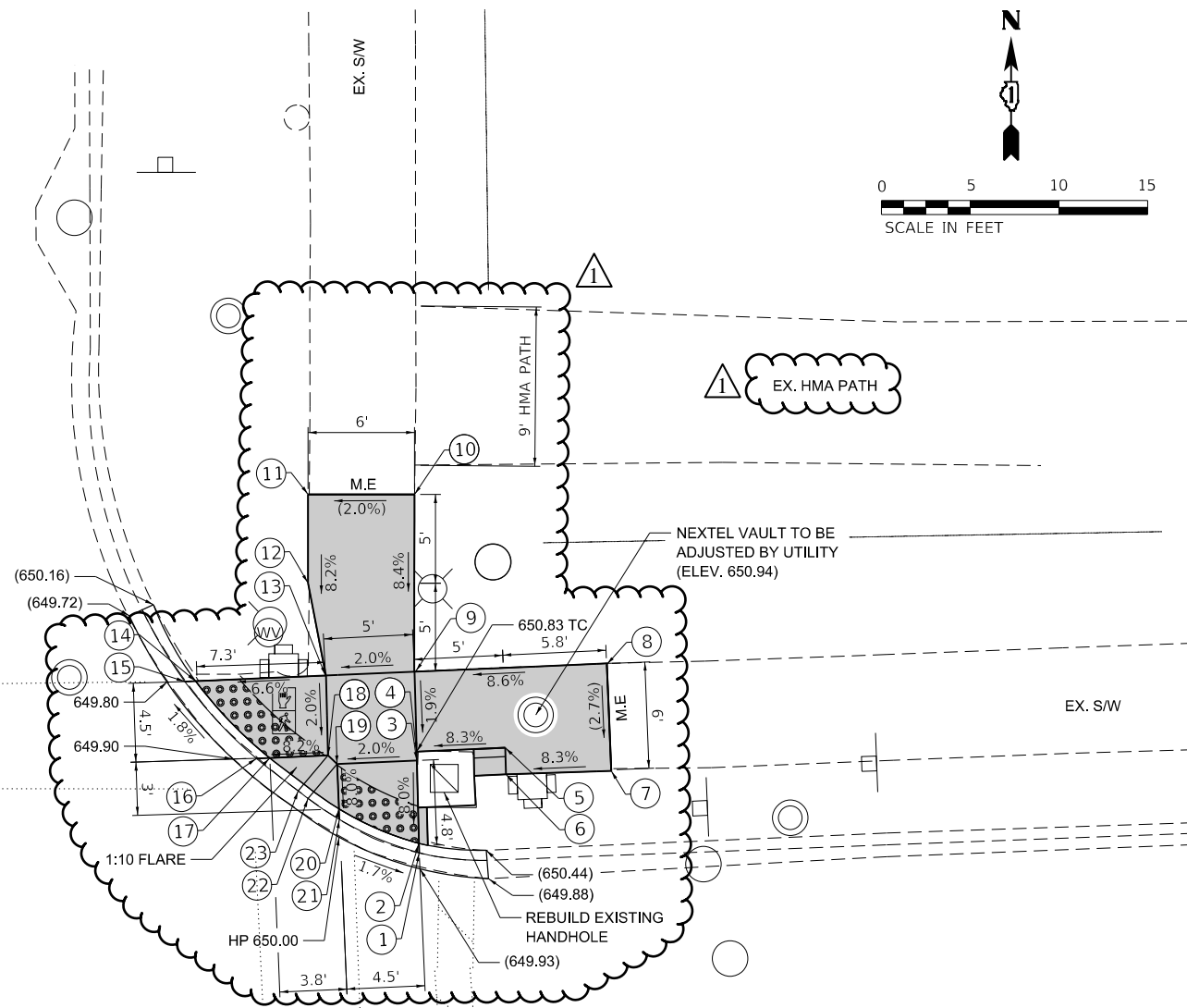

OAKTON ST.

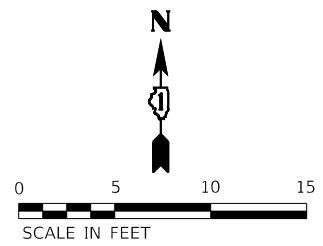
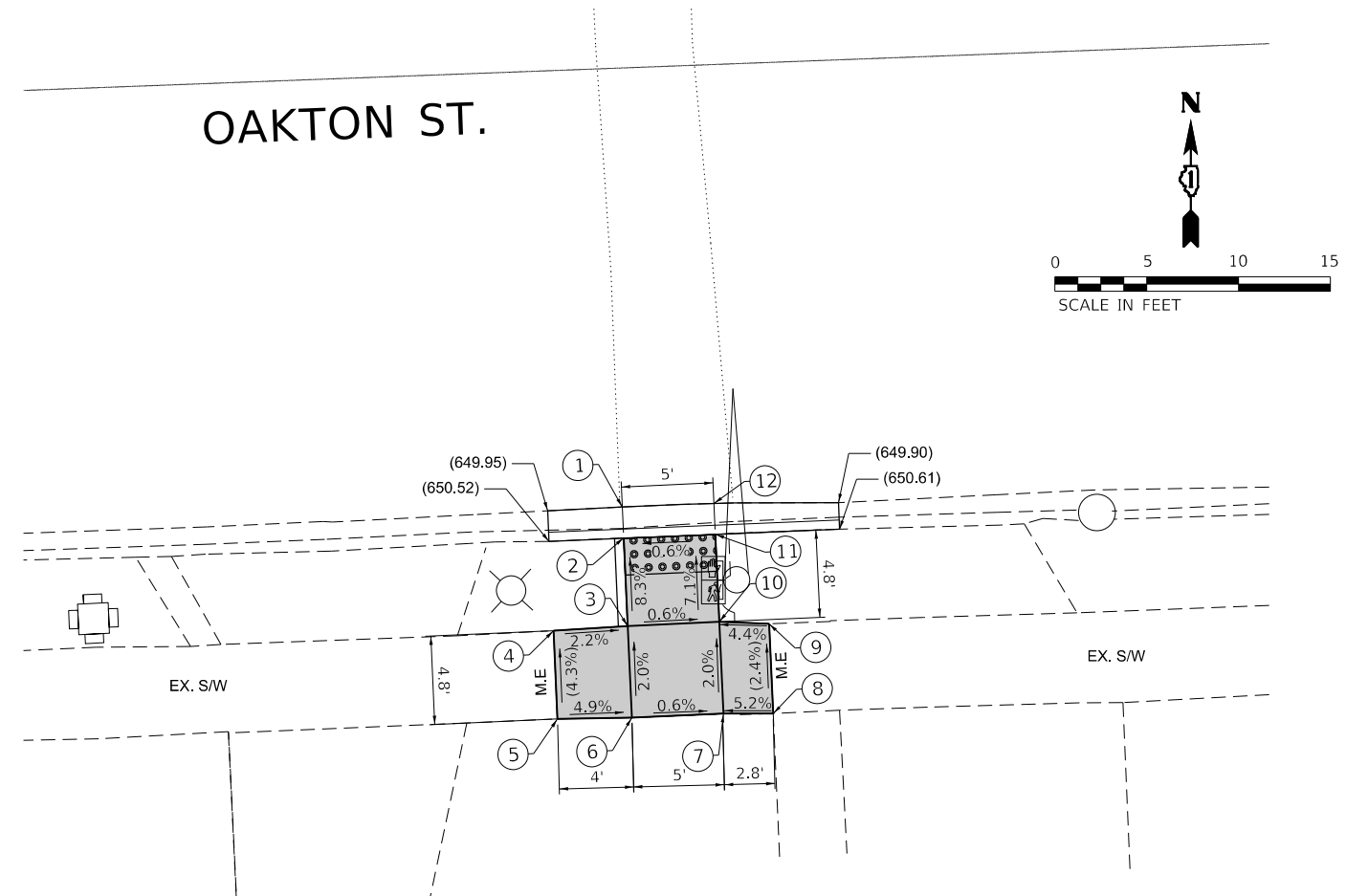

	STATION	OFFSET	ELEVATION
1	72+46.43	26.30' LT	649.91
2	72+46.44	26.83' LT	649.94
3	72+49.59	31.50' LT	650.32
4	72+46.50	32.00' LT	650.33
5	72+51.50	32.03' LT	650.75
6	72+51.50	30.53' LT	650.71
7	72+57.43	30.50' LT	651.19
8	72+57.39	36.50' LT	651.35
9	72+46.53	36.50' LT	650.42
10	72+46.92	46.48' LT	651.26
11	72+40.93	46.71' LT	651.13
12	72+40.73	41.71' LT	650.72

OAKTON ST.

	STATION	OFFSET	ELEVATION
13	72+41.55	36.47' LT	650.32
14	72+34.20	36.42' LT	649.83
15	72+33.60	36.42' LT	649.79
16	72+37.47	31.94' LT	649.89
17	72+38.22	31.95' LT	649.96
18	72+41.50	31.97' LT	650.23
19	72+42.00	31.47' LT	650.23
20	72+42.01	28.94' LT	650.03
21	72+42.02	28.34' LT	649.98
22	72+40.19	29.58' LT	650.22
23	72+39.64	29.91' LT	650.22

	STATION	OFFSET	ELEVATION
1	72+38.02	23.18' RT	649.98
2	72+38.04	24.86' RT	650.1
3	72+38.08	29.67' RT	650.5
4	72+34.03	29.78' RT	650.59
5	72+34.08	34.60' RT	650.80
6	72+38.12	34.67' RT	650.6
7	72+43.12	34.63' RT	650.57
8	72+45.82	34.74' RT	650.71
9	72+45.78	29.84' RT	650.59
10	72+43.08	29.63' RT	650.47
11	72+43.04	24.86' RT	650.13
12	72+43.09	23.23' RT	650.01

REFERENCE BENCHMARK ELEV 651.36
 BENCHMARK : SQUARE ON BASE OF TRAFFIC SIGNAL POLE
 LOCATION : NW CORNER OF OAKTON ST & CUMBERLAND AVE

LEGEND

- PROPOSED SIDE CURB
- () EXISTING ELEVATION/SLOPE
- M.E. MEET EXISTING

- PORTLAND CEMENT CONCRETE SIDEWALK 5 INCH
- DETECTABLE WARNINGS
- SIDEWALK REMOVAL REPLACE W/TOPSOIL F&P 4

REFERENCE BENCHMARK ELEV 652.14
 BENCHMARK : SW BOLT ON HYDRANT
 LOCATION : SW CORNER OF OAKTON ST & FAIRVIEW AVE

ADA-12

REVISD SHEET 4/8/2022



USER NAME : JosephKuzdal	DESIGNED - AS/JK	REVISED - ADDENDUM A 04/07/22
PLOT SCALE = 10.0000' / in.	DRAWN - AS/JK	REVISED -
PLOT DATE = 4/4/2022	CHECKED - YK/JK	REVISED -
	DATE - 03/10/2022	REVISED -

STATE OF ILLINOIS
 DEPARTMENT OF TRANSPORTATION

SIDEWALK DETAIL PLAN
OAKTON STREET - BUSSE HIGHWAY TO IL 43

SCALE: 1"=10' SHEET 12 OF 23 SHEETS STA. TO STA.

F.A.U. RTE.	SECTION	COUNTY	TOTAL SHEETS	SHEET NO.
1332	2020-158-R57SW	COOK	43	15L
CONTRACT NO. 62M46				
ILLINOIS FED. AID PROJECT				