

STATE OF ILLINOIS  
DEPARTMENT OF TRANSPORTATION

|            |         |          |                    |           |
|------------|---------|----------|--------------------|-----------|
| F.A.P. RTE | SECTION | COUNTY   | TOTAL SHEETS       | SHEET NO. |
| 889        | 101TS-2 | MASSAC   | 15                 | 1         |
|            |         | ILLINOIS | CONTRACT NO. 78857 |           |

FOR INDEX OF SHEETS, SEE SHEET NO. 3  
FOR SUMMARY OF QUANTITIES, SEE SHEET NO. 4-5

**PROPOSED  
HIGHWAY PLANS**

FAP ROUTE 889 (US 45)  
SECTION 101TS-2  
PROJECT HSIP-FEL6(598)

TRAFFIC SIGNAL MODIFICATION, FLASHING YELLOW ARROW  
MASSAC COUNTY

D-99-034-21

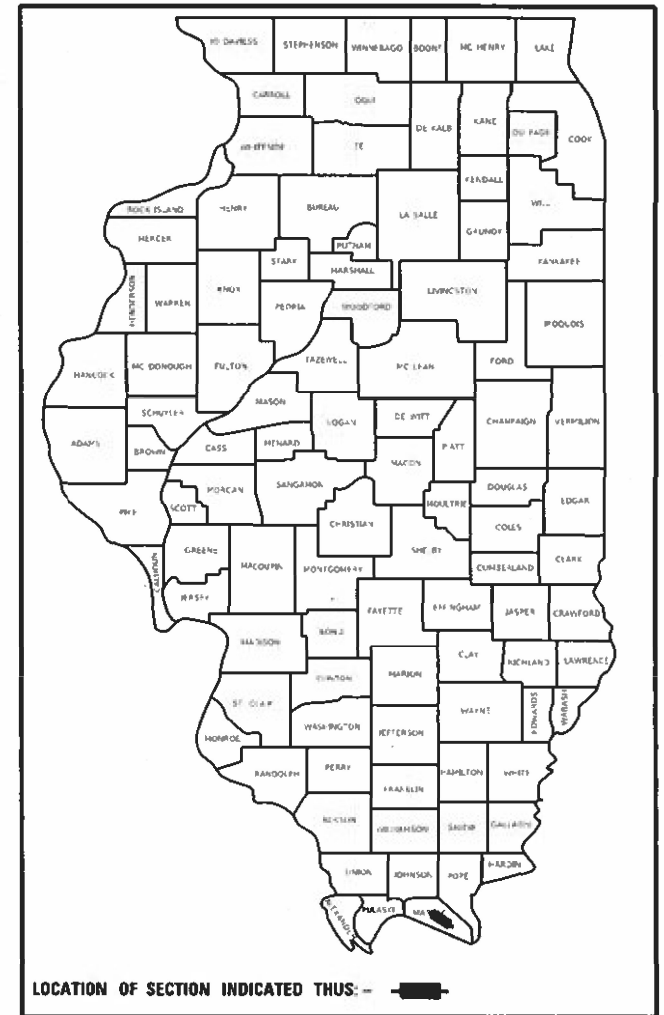

LOCATION OF SECTION INDICATED THUS: —■—

**TRAFFIC DATA (2021)**

ADT: 15,400 %TRUCKS: 12.1%

C-99-045-21

**TOWNSHIPS**  
MASSAC CO. UNIT ROAD DISTRICT

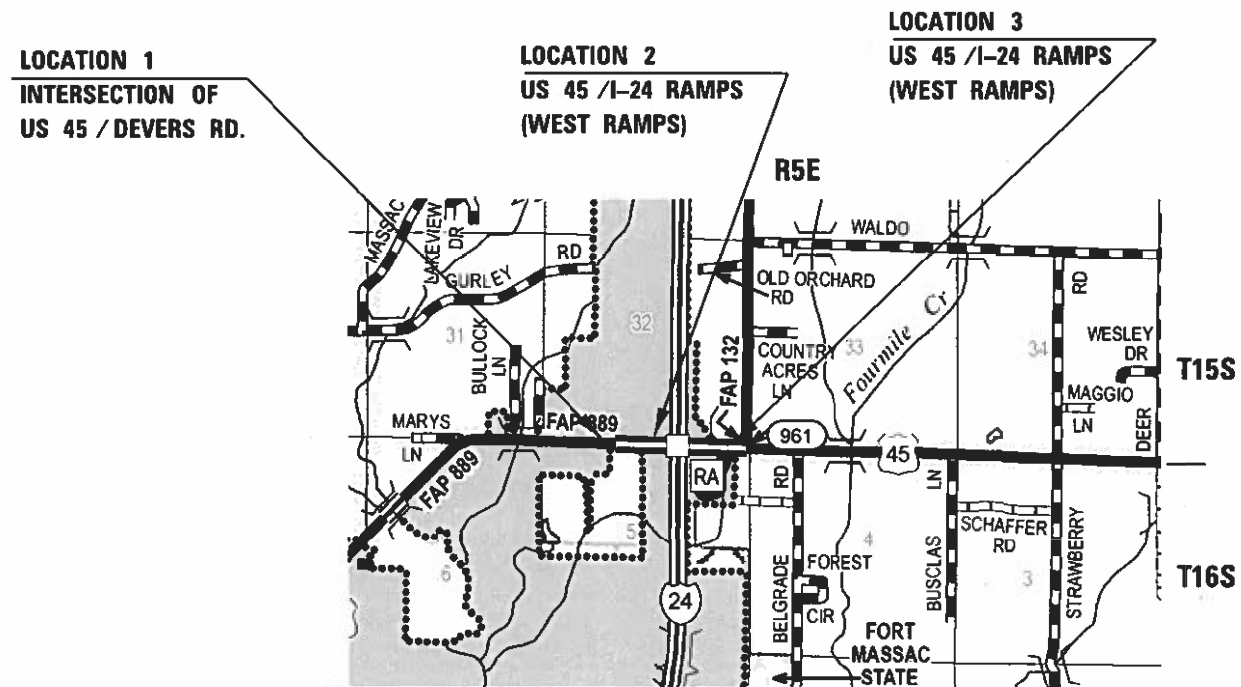

POSTED SPEED : 45 MPH (US 45 AT DEVERS RD.)  
55 MPH (US 45 AT I-24 RAMPS)

J.U.L.I.E.  
JOINT UTILITY LOCATION INFORMATION FOR EXCAVATION  
1-800-892-0123  
OR 811

PROJECT MANAGER: SUSAN POE  
PROJECT ENGINEER: SEAN GREENLEE

CONTRACT NO. 78857

STATE OF ILLINOIS  
DEPARTMENT OF TRANSPORTATION

SUBMITTED Jan 19 2022  
Stephen M. Navia  
REGION FIVE ENGINEER

March 25 2022  
[Signature]  
ENGINEER OF DESIGN AND ENVIRONMENT

March 23 2022  
Stephen M. Navia  
DIRECTOR OF HIGHWAYS PROJECT IMPLEMENTATION

**PRINTED BY THE AUTHORITY  
OF THE STATE OF ILLINOIS**

MODEL: PerQuil  
FILE NAME: \\ms-wildcat\pml\benley.com\PI\DOT\Des\mtrn\DOT-Office\Districts\op\mtrn\28852\CAD\Drawings\CAD\Sheet\28852 Streets.dwg

Prepared By: Charles Steen  
DISTRICT STUDIES & PLANS ENGINEER

Examined By: Randy Steen  
DISTRICT LAND ACQUISITION ENGINEER

Examined By: Carrie Nelson  
DISTRICT PROGRAM DEVELOPMENT ENGINEER

Examined By: Randy Steen  
DISTRICT OPERATIONS ENGINEER

Examined By: Daglar J. Helms  
DISTRICT PROJECT IMPLEMENTATION ENGINEER

Examined By: Daglar J. Helms  
DISTRICT CONSTRUCTION ENGINEER

Examined By: Randy Steen  
DISTRICT MATERIALS ENGINEER

|                               |            |           |
|-------------------------------|------------|-----------|
| USER NAME = greenleesm        | DESIGNED - | REVISED - |
|                               | DRAWN -    | REVISED - |
| PLOT SCALE = 100 0000 ' / in. | CHECKED -  | REVISED - |
| PLOT DATE = 1/19/2022         | DATE -     | REVISED - |

**STATE OF ILLINOIS  
DEPARTMENT OF TRANSPORTATION**

**SIGNATURE SHEET**

SCALE: SHEET OF SHEETS STA. TO STA.

| F.A.P. RTE.               | SECTION | COUNTY | TOTAL SHEETS | SHEET NO. |
|---------------------------|---------|--------|--------------|-----------|
| 889                       | 101TS-2 | MASSAC | 15           | 2         |
| CONTRACT NO. 78857        |         |        |              |           |
| ILLINOIS FED. AID PROJECT |         |        |              |           |

# INDEX OF SHEETS

| SHEET NO | DESCRIPTION   |
|----------|---|
| 1        | COVER SHEET   |
| 2        | SIGNATURE SHEET   |
| 3        | INDEX OF SHEETS, HIGHWAY STANDARDS,<br>GENERAL NOTES, COMMITMENTS |
| 4-5      | SUMMARY OF QUANTITIES   |
| 6        | EXISTING SIGNALS - DEVERS ROAD                                    |
| 7        | PROPOSED SIGNALS - DEVERS ROAD                                    |
| 8        | WIRING DIAGRAM - DEVERS ROAD                                      |
| 9        | EXISTING SIGNALS - WEST RAMP                                      |
| 10       | PROPOSED SIGNALS - WEST RAMP                                      |
| 11       | WIRING DIAGRAM - WEST RAMP  |
| 12       | EXISTING SIGNALS - EAST RAMP                                      |
| 13       | PROPOSED SIGNALS - EAST RAMP                                      |
| 14       | WIRING DIAGRAM - EAST RAMP  |
| 15       | DETAIL: MAST ARM EXTENSION  |

# HIGHWAY STANDARDS

- 000001-08\_STANDARDSYMBOLSABBREVIATIONS-PATTERNS-001
- 001006\_DECIMALOFINCH-FOOT
- 701101-05\_OFFRDOP-MULTILN-LESSTHAN15FTTOEOP
- 701106-02\_OFFRDOP-MULTILN-MORETHAN15FTAWAY
- 701601-09\_URBANLNCLOSUREMULTILN1W2WWITHNONTRVSABLEMED
- 701701-10\_URBANLNCLOSUREMULTILNINTERSECTION
- 701901-08\_TRAFCNTRLDEVICES
- 720016-04\_MASTARMMOUNTEDSTNAMESIGNS
- 805001-01\_ELECSRVCINSTALLDETAILS
- 814001-03\_HANDHOLES
- 825001-04\_LIGHTINGCONTROLLERPOLEMOUNT240V
- 838001-01\_BREAKAWAYDEVICES
- 857001-01\_STDPHASEDESIGNATIONDIAGRAMS-PHASESEQ
- 862001-01\_UPS
- 877011-10\_STEELCOMBOMASTARMASSEMBLY-POLE16'THRU55'
- 878001-11\_CONCRETEFOUNDATIONDETAILS
- 880006-01\_TRAFFIC SIGNAL MOUNTING DETAILS

# GENERAL NOTES

THE CONTRACTOR SHALL NOTIFY THE ENGINEER OF TRAFFIC OPERATIONS 72 HOURS PRIOR TO THE SHUT-DOWN OR CUTTING OF EXISTING DETECTOR LOOPS.

# COMMITMENTS

NONE

REV. - MS

MODEL: Default  
 FILE: \\mailes-pw.bentley.com:PLM\DOT\Documents\DOT\_Offices\Dir\drt\_@Project\78857\CADD\Drawn\CAD\Sheet\0978857\_Sheets.dgn

|                              |            |           |   |   |                    |                 |              |                           |           |
|------------------------------|------------|-----------|---|---|--------------------|-----------------|--------------|---------------------------|-----------|
| USER NAME = greenleesm       | DESIGNED - | REVISED - | <b>STATE OF ILLINOIS<br/>DEPARTMENT OF TRANSPORTATION</b> | <b>INDEX OF SHEETS, HIGHWAY STANDARDS,<br/>GENERAL NOTES, COMMITMENTS</b> | F.A.P. RTE.        | SECTION         | COUNTY       | TOTAL SHEETS              | SHEET NO. |
| PLOT SCALE = 100.0000' / in. | DRAWN -    | REVISED - |   |   | 889                | 101TS-2         | MASSAC       | 15                        | 3         |
| PLOT DATE = 1/24/2022        | CHECKED -  | REVISED - |   |   | CONTRACT NO. 78857 |                 |              |                           |           |
|                              | DATE -     | REVISED - |   |   | SCALE:             | SHEET OF SHEETS | STA. TO STA. | ILLINOIS FED. AID PROJECT |           |

# SUMMARY OF QUANTITIES

|             |  |        | COUNTY:        | MASSAC CO                | MASSAC CO                | MASSAC CO                |
|-------------|--|--------|----------------|--------------------------|--------------------------|--------------------------|
|             |  |        | ROUTE:         | US 45 (LOCATION 1)       | US 45 (LOCATION 2)       | US 45 (LOCATION 3)       |
|             |  |        | FUNDING:       | 90% FED 10% STATE (HSIP) | 90% FED 10% STATE (HSIP) | 90% FED 10% STATE (HSIP) |
|             |  |        | LOCATION:      | RURAL                    | RURAL                    | RURAL                    |
| CODE NUMBER | ITEM DESCRIPTION   | UNIT   | TOTAL QUANTITY | ROADWAY 0021             | ROADWAY 0021             | ROADWAY 0021             |
| 67100100    | MOBILIZATION   | L SUM  | 1              | 0.33                     | 0.33                     | 0.33                     |
| 70102630    | TRAFFIC CONTROL AND PROTECTION, STANDARD 701601                    | L SUM  | 1              | 0.33                     | 0.33                     | 0.33                     |
| 70102635    | TRAFFIC CONTROL AND PROTECTION, STANDARD 701701                    | L SUM  | 1              | 0.33                     | 0.33                     | 0.33                     |
| 70107025    | CHANGEABLE MESSAGE SIGN  | CAL DA | 28             | 14                       |                          | 14                       |
| * 72000100  | SIGN PANEL - TYPE 1  | SQ FT  | 36             | 12                       | 12                       | 12                       |
| * 72400720  | RELOCATE SIGN PANEL - TYPE 2                                       | SQ FT  | 15             | 15                       |                          |                          |
| 80300100    | LOCATING UNDERGROUND CABLE   | FOOT   | 40             | 20                       | 10                       | 10                       |
| 80400100    | ELECTRIC SERVICE INSTALLATION                                      | EACH   | 3              | 1                        | 1                        | 1                        |
| 81028350    | UNDERGROUND CONDUIT, PVC, 2" DIA.                                  | FOOT   | 90             | 30                       | 30                       | 30                       |
| 81028390    | UNDERGROUND CONDUIT, PVC, 4" DIA.                                  | FOOT   | 30             | 30                       |                          |                          |
| 85700300    | FULL-ACTUATED CONTROLLER AND TYPE V CABINET                        | EACH   | 3              | 1                        | 1                        | 1                        |
| 87301255    | ELECTRIC CABLE IN CONDUIT, SIGNAL NO. 14 7C                        | FOOT   | 764            | 764                      |                          |                          |
| 87301900    | ELECTRIC CABLE IN CONDUIT, EQUIPMENT GROUNDING CONDUCTOR, NO. 6 1C | FOOT   | 3,580          | 1,070                    | 1,290                    | 1,220                    |
| 87700320    | STEEL MAST ARM ASSEMBLY AND POLE, 55 FT.                           | EACH   | 1              | 1                        |                          |                          |

\* SPECIALTY ITEM

MODEL: Default  
FILE: M:\MSR\p\11\11001\11001\Documents\DOT\_Offices\Dir\dir\_01\Project\78857\CADD\DATA\CAD\Sheet\0978857-Sheets.dgn

|                              |            |           |   |                              |                    |                 |                           |                 |             |  |  |
|------------------------------|------------|-----------|---|------------------------------|--------------------|-----------------|---------------------------|-----------------|-------------|--|--|
| USER NAME = greenleesm       | DESIGNED - | REVISED - | <b>STATE OF ILLINOIS<br/>DEPARTMENT OF TRANSPORTATION</b> | <b>SUMMARY OF QUANTITIES</b> | F.A.P. RTE. 889    | SECTION 101TS-2 | COUNTY MASSAC             | TOTAL SHEETS 15 | SHEET NO. 4 |  |  |
| PLOT SCALE = 100.0000' / In. | CHECKED -  | REVISED - |   |                              | CONTRACT NO. 78857 |                 | ILLINOIS FED. AID PROJECT |                 |             |  |  |
| PLOT DATE = 1/24/2022        | DATE -     | REVISED - |   |                              | SCALE:             | SHEET OF SHEETS | STA. TO STA.              |                 |             |  |  |
|                              |            |           |   |                              |                    |                 |                           |                 |             |  |  |

# SUMMARY OF QUANTITIES - CONT

| CODE NUMBER | ITEM DESCRIPTION                                      | UNIT | TOTAL QUANTITY | COUNTY:   | MASSAC CO                | MASSAC CO                | MASSAC CO                |
|-------------|---|------|----------------|-----------|--------------------------|--------------------------|--------------------------|
|             |   |      |                | ROUTE:    | US 45 (LOCATION 1)       | US 45 (LOCATION 2)       | US 45 (LOCATION 3)       |
|             |   |      |                | FUNDING:  | 90% FED 10% STATE (HSIP) | 90% FED 10% STATE (HSIP) | 90% FED 10% STATE (HSIP) |
|             |   |      |                | LOCATION: | RURAL ROADWAY<br>0021    | RURAL ROADWAY<br>0021    | RURAL ROADWAY<br>0021    |
| 87800415    | CONCRETE FOUNDATION, TYPE E 36-INCH DIAMETER          | FOOT | 15             |           | 15                       |                          |                          |
| 87900200    | DRILL EXISTING HANDHOLE                               | EACH | 1              |           | 1                        |                          |                          |
| 88030020    | SIGNAL HEAD, LED, 1-FACE, 3-SECTION, MAST-ARM MOUNTED | EACH | 2              |           | 2                        |                          |                          |
| 88030070    | SIGNAL HEAD, LED, 1-FACE, 4-SECTION, BRACKET MOUNTED  | EACH | 6              |           | 2                        | 2                        | 2                        |
| 88030080    | SIGNAL HEAD, LED, 1-FACE, 4-SECTION, MAST ARM MOUNTED | EACH | 2              |           | 2                        |                          |                          |
| 88200510    | TRAFFIC SIGNAL BACKPLATE, RETROREFLECTIVE             | EACH | 22             |           | 6                        | 8                        | 8                        |
| 89502375    | REMOVE EXISTING TRAFFIC SIGNAL EQUIPMENT              | EACH | 3              |           | 1                        | 1                        | 1                        |
| X0320023    | CLOSED CIRCUIT TELEVISION DOME CAMERA, HD             | EACH | 2              |           |                          | 1                        | 1                        |
| X0325810    | WIRELESS ETHERNET RADIO                               | EACH | 4              |           | 1                        | 2                        | 1                        |
| X0325922    | CELLULAR MODEM  | EACH | 1              |           |                          |                          | 1                        |
| X0326266    | ETHERNET SWITCH                                       | EACH | 3              |           | 1                        | 1                        | 1                        |
| X0326812    | CAT 5 ETHERNET CABLE                                  | FOOT | 400            |           |                          | 200                      | 200                      |

MODEL: Default  
 FILE: \\mailes-pw-bentley.com\FW\DOT\Documents\DOT Office\Dir\rdet @Project\78857\CAD\Drawings\CAD\Sheets\078857-Sheets.dgn

|                              |            |           |
|------------------------------|------------|-----------|
| USER NAME = greenleesm       | DESIGNED - | REVISED - |
| DRAWN -                      | REVISOR -  |           |
| PLOT SCALE = 100.0000' / in. | CHECKED -  | REVISOR - |
| PLOT DATE = 1/24/2022        | DATE -     | REVISOR - |

**STATE OF ILLINOIS**  
**DEPARTMENT OF TRANSPORTATION**

**SUMMARY OF QUANTITIES**

SCALE: SHEET OF SHEETS STA. TO STA.

| F.A.P. RTE.        | SECTION | COUNTY | TOTAL SHEETS              | SHEET NO. |
|--------------------|---------|--------|---------------------------|-----------|
| 889                | 101TS-2 | MASSAC | 15                        | 5         |
| CONTRACT NO. 78857 |         |        | ILLINOIS FED. AID PROJECT |           |

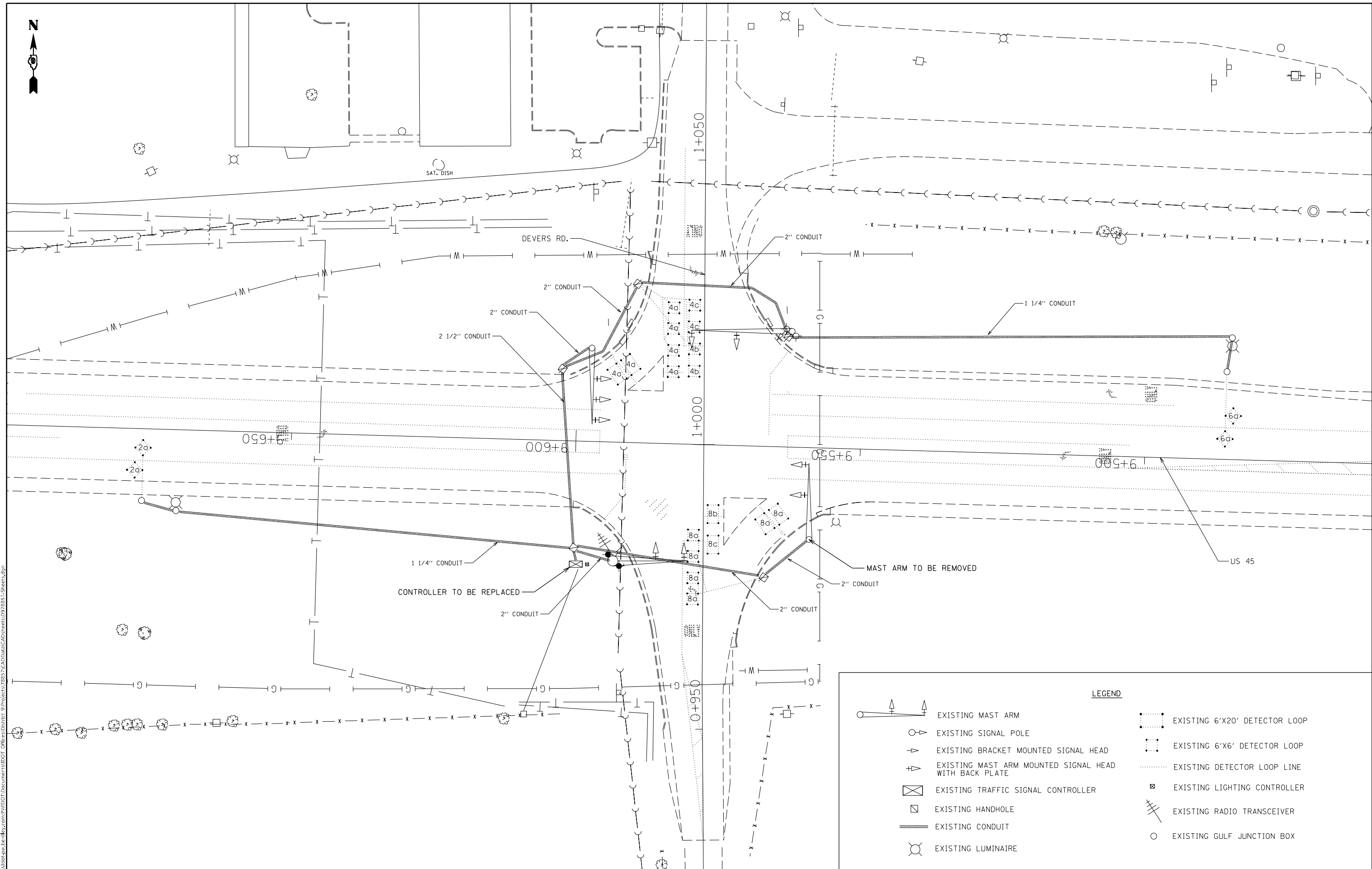
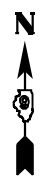

**LEGEND**

|  |   |  |                               |
|--|---|--|-------------------------------|
|  | EXISTING MAST ARM                                     |  | EXISTING 6'x20' DETECTOR LOOP |
|  | EXISTING SIGNAL POLE                                  |  | EXISTING 6'x6' DETECTOR LOOP  |
|  | EXISTING BRACKET MOUNTED SIGNAL HEAD                  |  | EXISTING DETECTOR LOOP LINE   |
|  | EXISTING MAST ARM MOUNTED SIGNAL HEAD WITH BACK PLATE |  | EXISTING LIGHTING CONTROLLER  |
|  | EXISTING TRAFFIC SIGNAL CONTROLLER                    |  | EXISTING RADIO TRANSCEIVER    |
|  | EXISTING HANDHOLE                                     |  | EXISTING GULF JUNCTION BOX    |
|  | EXISTING CONDUIT                                      |  |                               |
|  | EXISTING LUMINAIRE                                    |  |                               |

MODEL: 75 scale  
 FILE NAME: p:\build\aw-beadefy.com\PIV\DOT\Documents\DOT Office\Drawings\Project\78857\CADD\Drawings\CAD\Drawings\78857-Sheets.dgn

|                              |            |           |
|------------------------------|------------|-----------|
| USER NAME = greenleesm       | DESIGNED - | REVISED - |
|                              | DRAWN -    | REVISED - |
| PLOT SCALE = 50,0000 * / in. | CHECKED -  | REVISED - |
| PLOT DATE = 1/24/2022        | DATE -     | REVISED - |

**STATE OF ILLINOIS  
DEPARTMENT OF TRANSPORTATION**

**EXISTING SIGNALS US 45 /DEVERS RD.**

SCALE: SHEET OF SHEETS STA. TO STA.

|                           |         |        |              |           |
|---------------------------|---------|--------|--------------|-----------|
| F.A.P. RTE.               | SECTION | COUNTY | TOTAL SHEETS | SHEET NO. |
| 889                       | 101TS-2 | MASSAC | 15           | 6         |
| CONTRACT NO. 78857        |         |        |              |           |
| ILLINOIS FED. AID PROJECT |         |        |              |           |

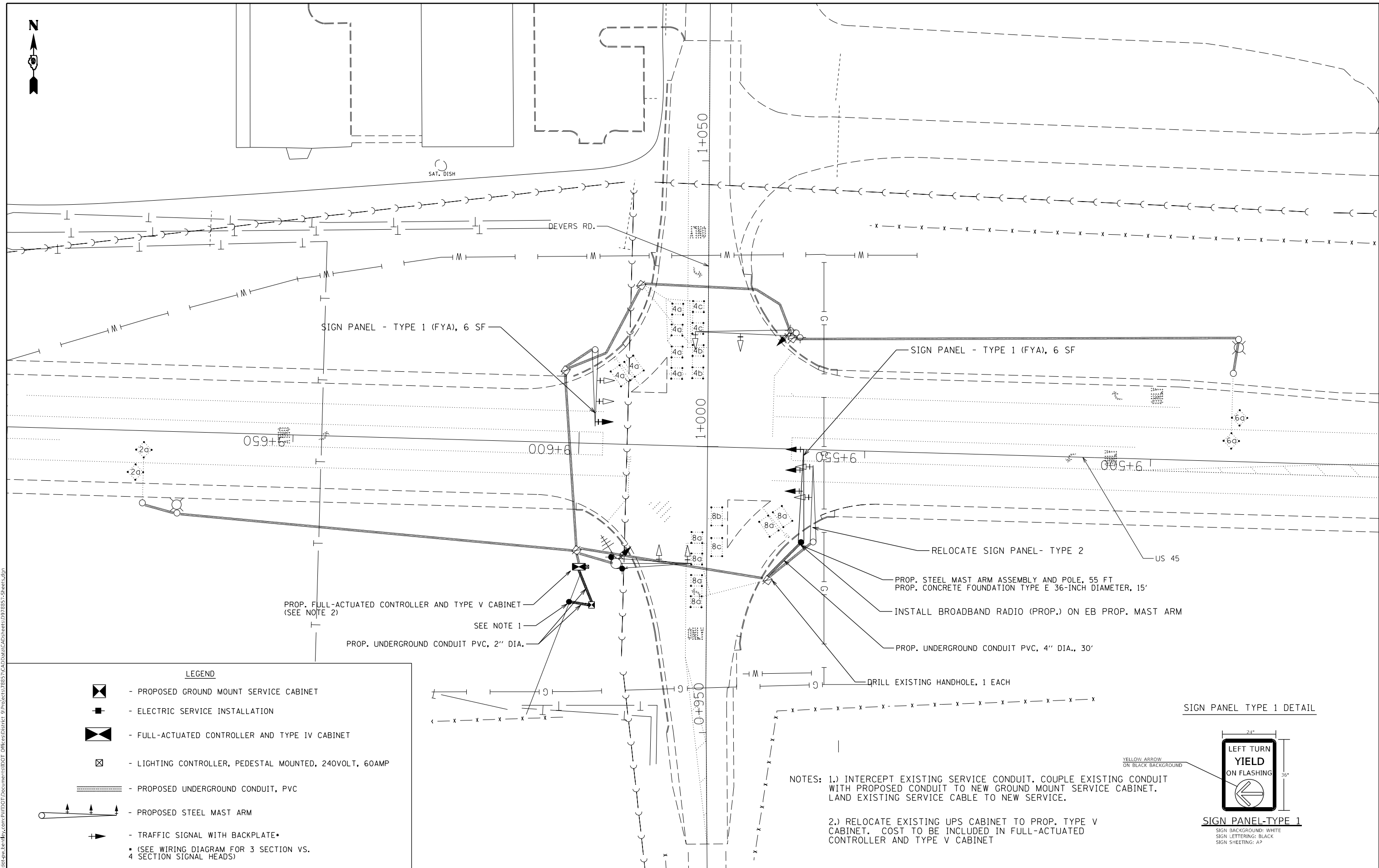

**LEGEND**

- PROPOSED GROUND MOUNT SERVICE CABINET
  - ELECTRIC SERVICE INSTALLATION
  - FULL-ACTUATED CONTROLLER AND TYPE IV CABINET
  - LIGHTING CONTROLLER, PEDESTAL MOUNTED, 240VOLT, 60AMP
  - PROPOSED UNDERGROUND CONDUIT, PVC
  - PROPOSED STEEL MAST ARM
  - TRAFFIC SIGNAL WITH BACKPLATE
- (SEE WIRING DIAGRAM FOR 3 SECTION VS. 4 SECTION SIGNAL HEADS)

**SIGN PANEL TYPE 1 DETAIL**

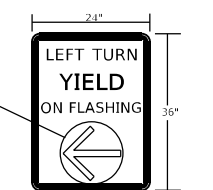

**SIGN PANEL-TYPE 1**  
SIGN BACKGROUND: WHITE  
SIGN LETTERING: BLACK  
SIGN SHEETING: AP

- NOTES: 1.) INTERCEPT EXISTING SERVICE CONDUIT. COUPLE EXISTING CONDUIT WITH PROPOSED CONDUIT TO NEW GROUND MOUNT SERVICE CABINET. LAND EXISTING SERVICE CABLE TO NEW SERVICE.
- 2.) RELOCATE EXISTING UPS CABINET TO PROP. TYPE V CABINET. COST TO BE INCLUDED IN FULL-ACTUATED CONTROLLER AND TYPE V CABINET

MODEL: 75 scale  
FILE NAME: p:\projects\78857\CADD\Drawings\DOT\Office\Drawings\DOT\78857\CADD\Drawings\DOT\78857-Sheets.dgn

|                              |            |           |
|------------------------------|------------|-----------|
| USER NAME = greenleesm       | DESIGNED - | REVISED - |
|                              | DRAWN -    | REVISED - |
| PLOT SCALE = 50,0000 * / in. | CHECKED -  | REVISED - |
| PLOT DATE = 1/24/2022        | DATE -     | REVISED - |

**STATE OF ILLINOIS  
DEPARTMENT OF TRANSPORTATION**

**PROPOSED SIGNALS US 45 / DEVERS RD.**

SCALE: SHEET OF SHEETS STA. TO STA.

|                           |                 |               |                 |             |
|---------------------------|-----------------|---------------|-----------------|-------------|
| F.A.P. RTE. 889           | SECTION 101TS-2 | COUNTY MASSAC | TOTAL SHEETS 15 | SHEET NO. 7 |
| CONTRACT NO. 78857        |                 |               |                 |             |
| ILLINOIS FED. AID PROJECT |                 |               |                 |             |





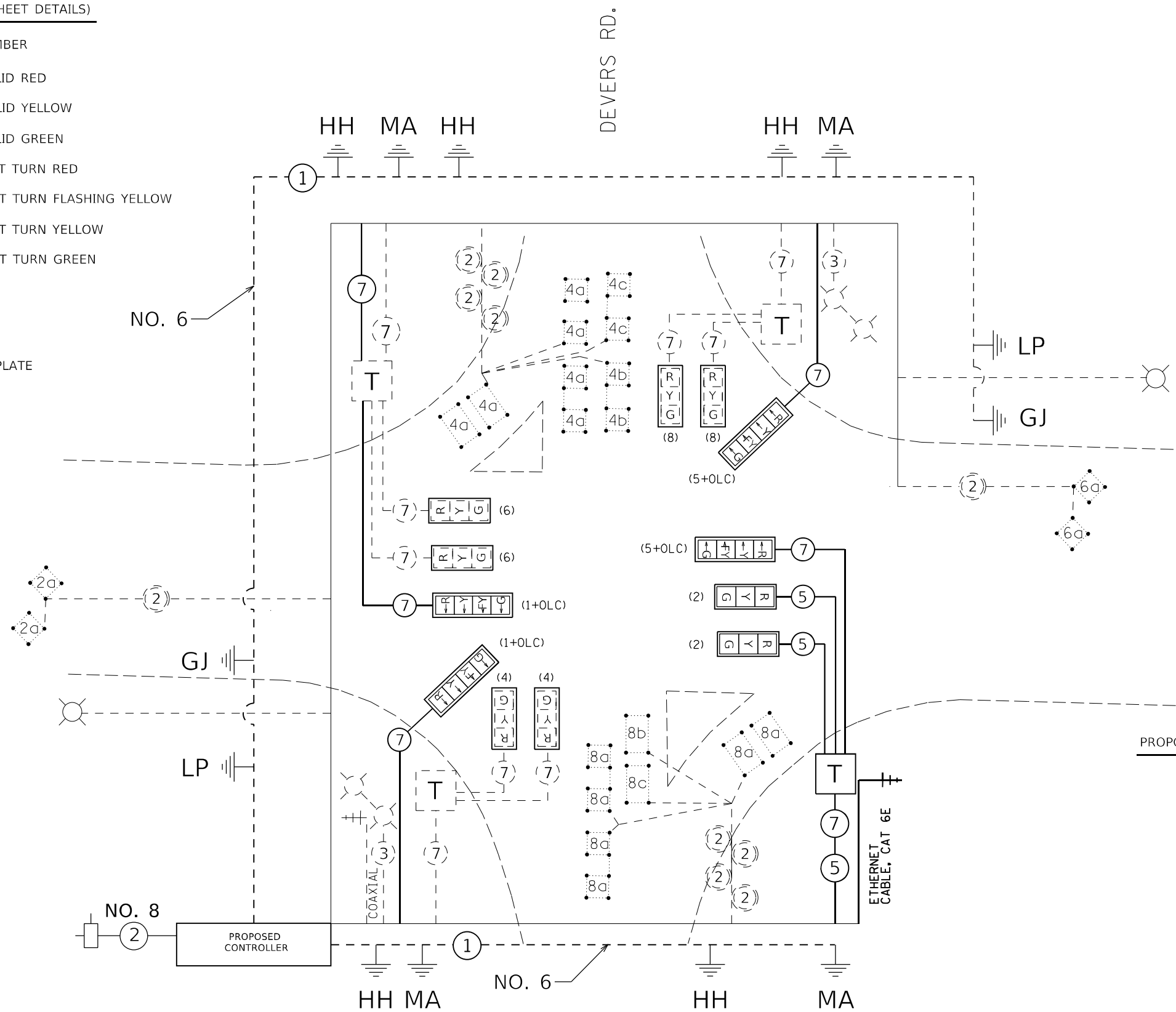

PROPOSED TRAFFIC SIGNALS LEGEND (SHEET DETAILS)

- ⊛ PROPOSED CABLE NUMBER  
\* = CABLE NUMBER
- R SIGNAL SECTION - SOLID RED
- Y SIGNAL SECTION - SOLID YELLOW
- G SIGNAL SECTION - SOLID GREEN
- ←R SIGNAL SECTION - LEFT TURN RED
- ←FY SIGNAL SECTION - LEFT TURN FLASHING YELLOW
- ←Y SIGNAL SECTION - LEFT TURN YELLOW
- ←G SIGNAL SECTION - LEFT TURN GREEN
- (6)
-  TRAFFIC SIGNAL BACKPLATE

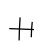

PROPOSED TRAFFIC SIGNALS LEGEND (SHEET DETAILS)

-  MAST ARM
- MA
-  HANDHOLE
- HH
-  SIGNAL POLE
- SP
-  GULF JUNCTION BOX
- GJ
-  TERMINAL BLOCK
- T
-  BROADBAND RADIO
- ++

MODEL: 75 scale  
 FILE NAME: p:\bulletect-pw-bentley.com\p\1\1\DOT\Documents\1\DOT Office\Drawings\Project\78857\CADD\Drawings\CAD\Sheet\0978857-Sheets.dgn

|                              |            |           |
|------------------------------|------------|-----------|
| USER NAME = greenleesm       | DESIGNED - | REVISED - |
| DRAWN -                      | REVISOR -  |           |
| PLOT SCALE = 50,0000 * / in. | CHECKED -  | REVISOR - |
| PLOT DATE = 1/24/2022        | DATE -     | REVISOR - |

**STATE OF ILLINOIS**  
**DEPARTMENT OF TRANSPORTATION**

**WIRING DIAGRAM US 45 /DEVERS RD.**  
 SCALE: SHEET OF SHEETS STA. TO STA.

| F.A.P. RTE.               | SECTION | COUNTY | TOTAL SHEETS | SHEET NO. |
|---------------------------|---------|--------|--------------|-----------|
| 889                       | 101TS-2 | MASSAC | 15           | 8         |
| CONTRACT NO. 78857        |         |        |              |           |
| ILLINOIS FED. AID PROJECT |         |        |              |           |



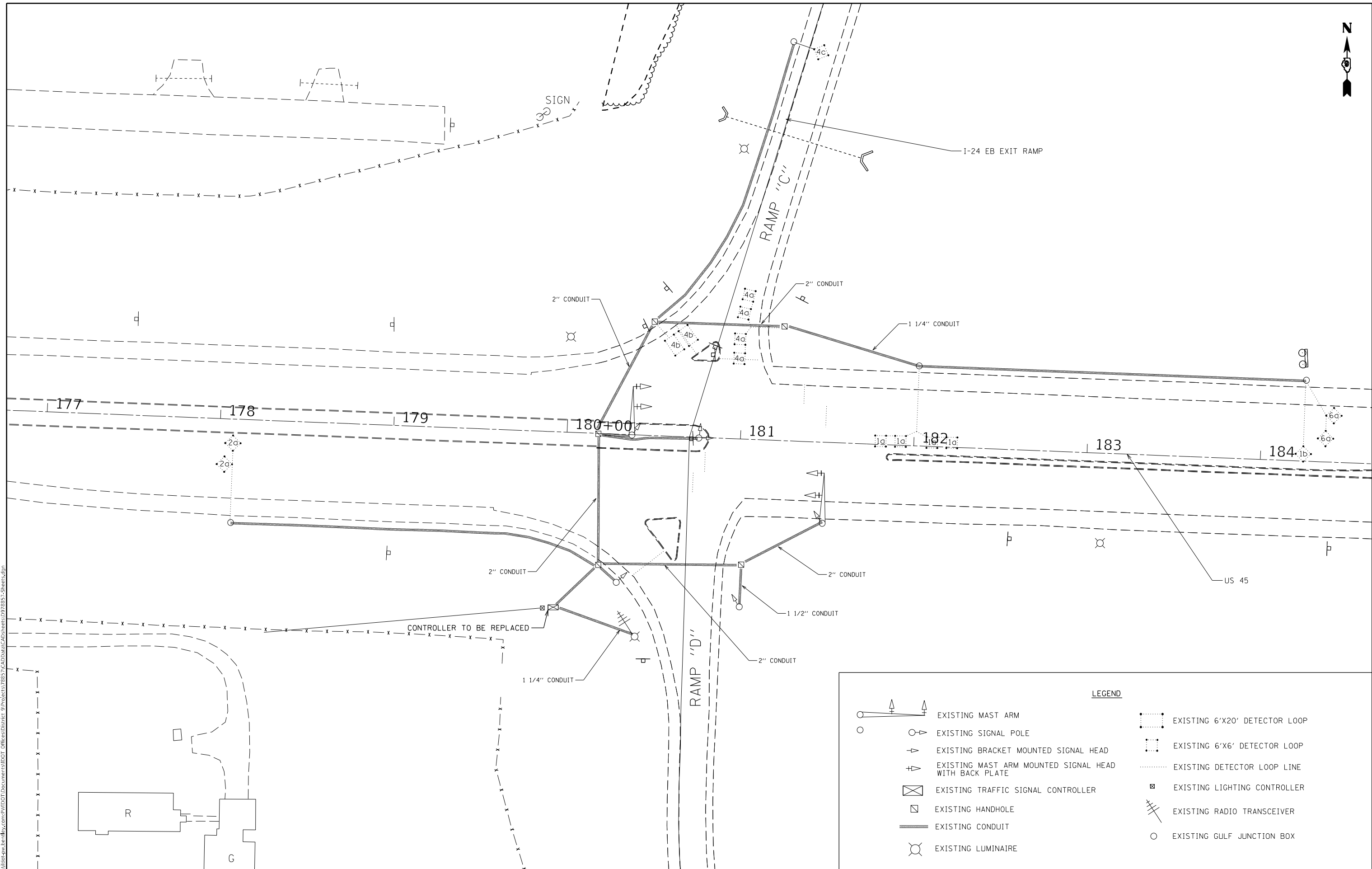

| LEGEND |   |
|--------|---|
|        | EXISTING MAST ARM                                     |
|        | EXISTING SIGNAL POLE                                  |
|        | EXISTING BRACKET MOUNTED SIGNAL HEAD                  |
|        | EXISTING MAST ARM MOUNTED SIGNAL HEAD WITH BACK PLATE |
|        | EXISTING TRAFFIC SIGNAL CONTROLLER                    |
|        | EXISTING HANDHOLE                                     |
|        | EXISTING CONDUIT                                      |
|        | EXISTING LUMINAIRE                                    |
|        | EXISTING 6'x20' DETECTOR LOOP                         |
|        | EXISTING 6'x6' DETECTOR LOOP                          |
|        | EXISTING DETECTOR LOOP LINE                           |
|        | EXISTING LIGHTING CONTROLLER                          |
|        | EXISTING RADIO TRANSCEIVER                            |
|        | EXISTING GULF JUNCTION BOX                            |

MODEL: 75 scale  
 FILE NAME: p:\projects\78857\CADD\Drawings\DOT\Office\Drawings\DOT\78857-Sheets.dgn

|                              |            |           |
|------------------------------|------------|-----------|
| USER NAME = greenleesm       | DESIGNED - | REVISED - |
|                              | DRAWN -    | REVISED - |
| PLOT SCALE = 50,0000 * / in. | CHECKED -  | REVISED - |
| PLOT DATE = 1/24/2022        | DATE -     | REVISED - |

**STATE OF ILLINOIS**  
**DEPARTMENT OF TRANSPORTATION**

**EXISTING SIGNALS US 45 / I-24 WEST RAMP**

SCALE:      SHEET      OF      SHEETS      STA.      TO      STA.

| F.A.P. RTE.        | SECTION | COUNTY | TOTAL SHEETS | SHEET NO. |
|--------------------|---------|--------|--------------|-----------|
| 889                | 101TS-2 | MASSAC | 15           | 9         |
| CONTRACT NO. 78857 |         |        |              |           |

ILLINOIS FED. AID PROJECT

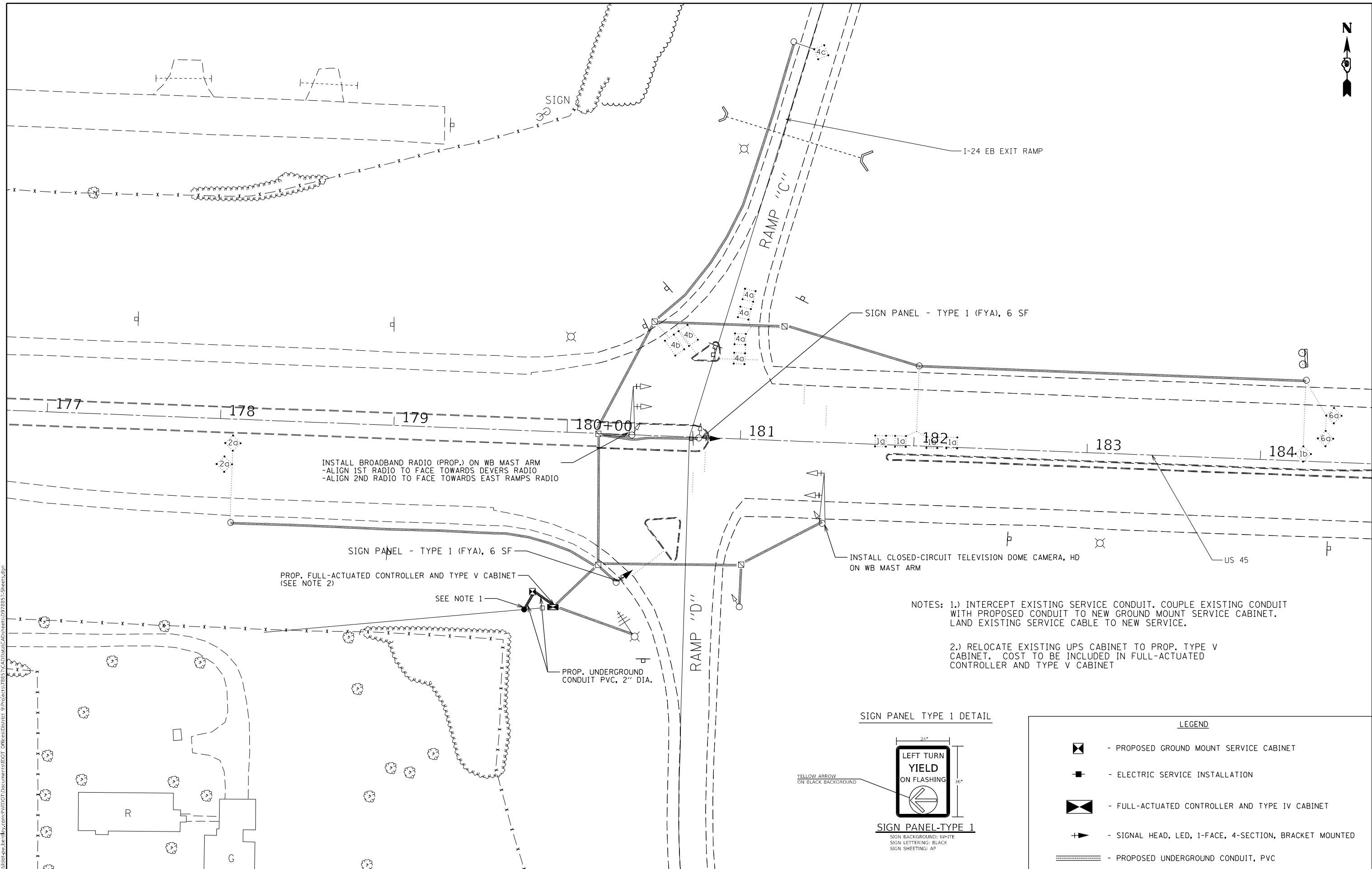

INSTALL BROADBAND RADIO (PROP.) ON WB MAST ARM  
 -ALIGN 1ST RADIO TO FACE TOWARDS DEVERS RADIO  
 -ALIGN 2ND RADIO TO FACE TOWARDS EAST RAMP'S RADIO

SIGN PANEL - TYPE 1 (FYA), 6 SF  
 PROP. FULL-ACTUATED CONTROLLER AND TYPE V CABINET  
 (SEE NOTE 2)

SEE NOTE 1

PROP. UNDERGROUND  
 CONDUIT PVC, 2" DIA.

INSTALL CLOSED-CIRCUIT TELEVISION DOME CAMERA, HD  
 ON WB MAST ARM

NOTES: 1.) INTERCEPT EXISTING SERVICE CONDUIT. COUPLE EXISTING CONDUIT WITH PROPOSED CONDUIT TO NEW GROUND MOUNT SERVICE CABINET. LAND EXISTING SERVICE CABLE TO NEW SERVICE.

2.) RELOCATE EXISTING UPS CABINET TO PROP. TYPE V CABINET. COST TO BE INCLUDED IN FULL-ACTUATED CONTROLLER AND TYPE V CABINET

SIGN PANEL TYPE 1 DETAIL

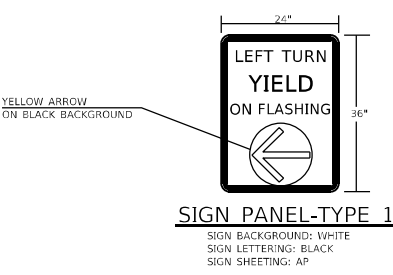

LEGEND

- PROPOSED GROUND MOUNT SERVICE CABINET
- ELECTRIC SERVICE INSTALLATION
- FULL-ACTUATED CONTROLLER AND TYPE IV CABINET
- SIGNAL HEAD, LED, 1-FACE, 4-SECTION, BRACKET MOUNTED
- PROPOSED UNDERGROUND CONDUIT, PVC

MODEL: 75 scale  
 FILE NAME: p:\projects\78857\CADD\Drawings\DOT\Office\Drawings\Project\78857\CADD\Drawings\DOT\78857-Sheets.dgn

|                              |            |           |
|------------------------------|------------|-----------|
| USER NAME = greenleesm       | DESIGNED - | REVISED - |
|                              | DRAWN -    | REVISED - |
| PLOT SCALE = 50,0000 * / in. | CHECKED -  | REVISED - |
| PLOT DATE = 1/24/2022        | DATE -     | REVISED - |

**STATE OF ILLINOIS  
 DEPARTMENT OF TRANSPORTATION**

**PROPOSED SIGNALS US 45 / I-24 WEST RAMP**

SCALE: SHEET OF SHEETS STA. TO STA.

| F.A.P. RTE.               | SECTION | COUNTY | TOTAL SHEETS | SHEET NO. |
|---------------------------|---------|--------|--------------|-----------|
| 889                       | 101TS-2 | MASSAC | 15           | 10        |
| CONTRACT NO. 78857        |         |        |              |           |
| ILLINOIS FED. AID PROJECT |         |        |              |           |

PROPOSED TRAFFIC SIGNALS LEGEND (SHEET DETAILS)



- ⊛ PROPOSED CABLE NUMBER  
\* = CABLE NUMBER
- Ⓡ SIGNAL SECTION - SOLID RED
- Ⓢ SIGNAL SECTION - SOLID YELLOW
- Ⓜ SIGNAL SECTION - SOLID GREEN
- ⓇⓈ SIGNAL SECTION - LEFT TURN RED
- ⓈⓈ SIGNAL SECTION - LEFT TURN FLASHING YELLOW
- ⓈⓈ SIGNAL SECTION - LEFT TURN YELLOW
- ⓇⓈ SIGNAL SECTION - LEFT TURN GREEN
- (6) TRAFFIC PHASE
- TRAFFIC SIGNAL BACKPLATE

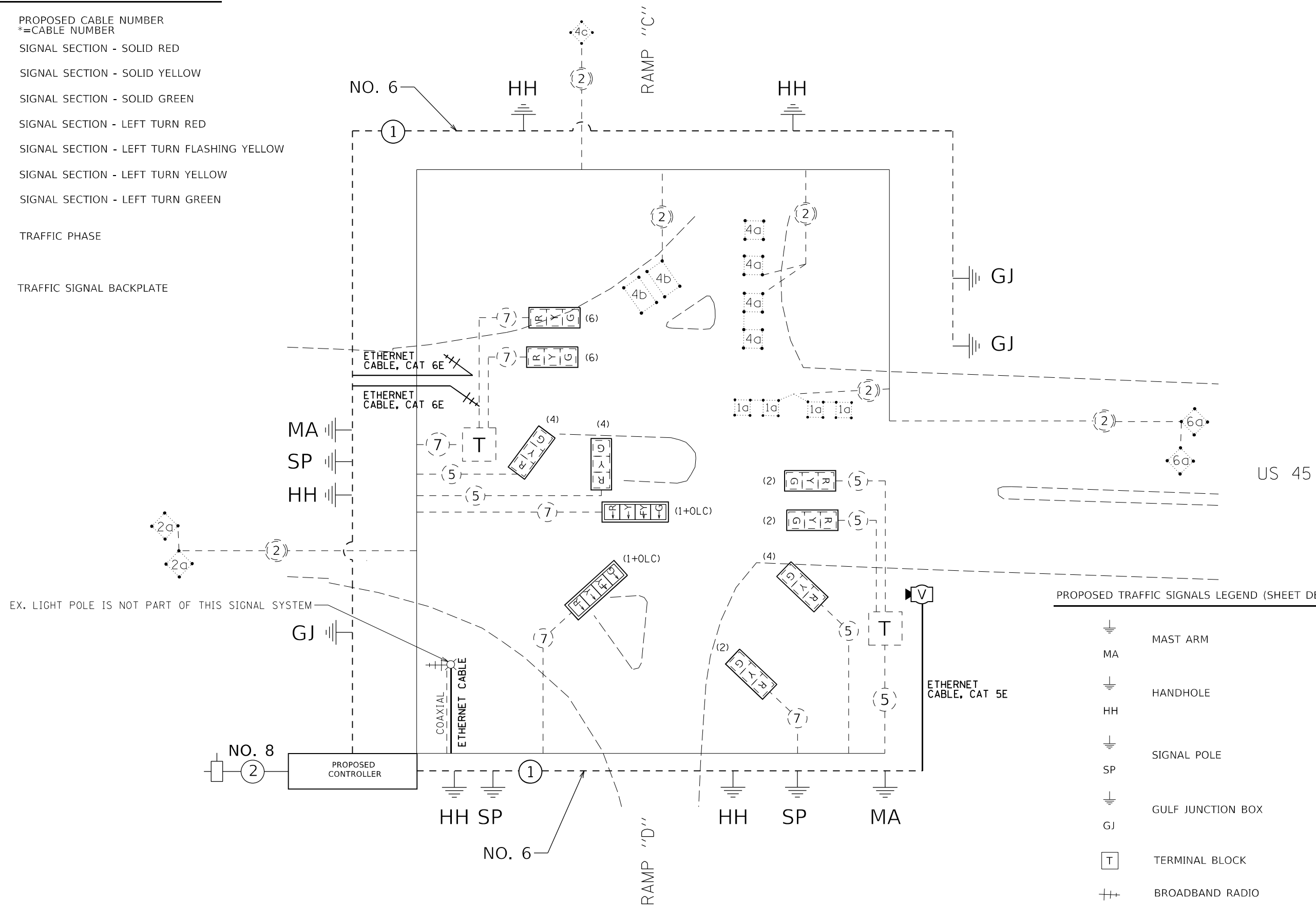

EX. LIGHT POLE IS NOT PART OF THIS SIGNAL SYSTEM

PROPOSED TRAFFIC SIGNALS LEGEND (SHEET DETAILS)

- MAST ARM
- HANDHOLE
- SIGNAL POLE
- GULF JUNCTION BOX
- TERMINAL BLOCK
- BROADBAND RADIO
- CLOSED-CIRCUIT TELEVISION DOME CAMERA, HD

MODEL: 75 scale  
FILE NAME: p:\project-aw-beadefy.com\p\indot\documents\indot\_offices\dir\dir: @\project\78857\CADD\data\CAD\sheet\0978857-Sheets.dgn

|                              |            |           |
|------------------------------|------------|-----------|
| USER NAME = greenleesm       | DESIGNED - | REVISED - |
| DRAWN -                      | REVISED -  |           |
| PLOT SCALE = 50,0000 * / in. | CHECKED -  | REVISED - |
| PLOT DATE = 1/24/2022        | DATE -     | REVISED - |

**STATE OF ILLINOIS  
DEPARTMENT OF TRANSPORTATION**

**WIRING DIAGRAM US 45 / I-24 WEST RAMP**

SCALE:      SHEET      OF      SHEETS      STA.      TO      STA.

| F.A.P. RTE.               | SECTION | COUNTY | TOTAL SHEETS | SHEET NO. |
|---------------------------|---------|--------|--------------|-----------|
| 889                       | 101TS-2 | MASSAC | 15           | 11        |
| CONTRACT NO. 78857        |         |        |              |           |
| ILLINOIS FED. AID PROJECT |         |        |              |           |

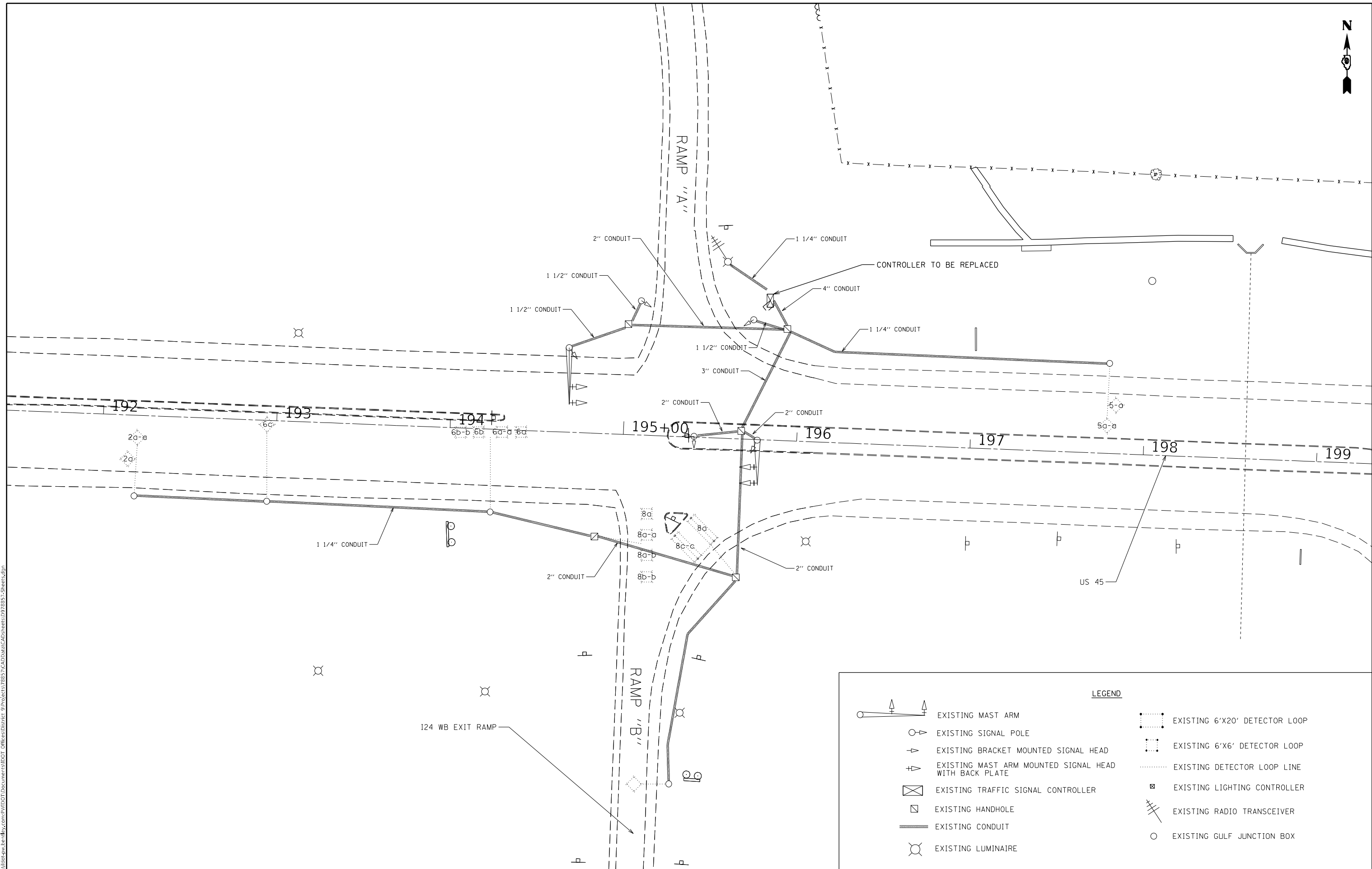

**LEGEND**

|  |   |  |                               |
|--|---|--|-------------------------------|
|  | EXISTING MAST ARM                                     |  | EXISTING 6'x20' DETECTOR LOOP |
|  | EXISTING SIGNAL POLE                                  |  | EXISTING 6'x6' DETECTOR LOOP  |
|  | EXISTING BRACKET MOUNTED SIGNAL HEAD                  |  | EXISTING DETECTOR LOOP LINE   |
|  | EXISTING MAST ARM MOUNTED SIGNAL HEAD WITH BACK PLATE |  | EXISTING LIGHTING CONTROLLER  |
|  | EXISTING TRAFFIC SIGNAL CONTROLLER                    |  | EXISTING RADIO TRANSCEIVER    |
|  | EXISTING HANDHOLE                                     |  | EXISTING GULF JUNCTION BOX    |
|  | EXISTING CONDUIT                                      |  |                               |
|  | EXISTING LUMINAIRE                                    |  |                               |

MODEL: 75 - scale  
 FILE NAME: p:\project-aw-beadefy.com\p\INDOT\Documents\INDOT Office\Dir\dir: @\Project\78857\CADD\Drawn\CAD\Sheets\078857-Sheets.dgn

|                              |            |           |
|------------------------------|------------|-----------|
| USER NAME = greenleesm       | DESIGNED - | REVISED - |
|                              | DRAWN -    | REVISED - |
| PLOT SCALE = 50,0000 * / in. | CHECKED -  | REVISED - |
| PLOT DATE = 1/24/2022        | DATE -     | REVISED - |

**STATE OF ILLINOIS  
DEPARTMENT OF TRANSPORTATION**

**EXISTING SIGNALS US 45 / I-24 EAST RAMP**

|                           |                 |               |                 |              |
|---------------------------|-----------------|---------------|-----------------|--------------|
| F.A.P. RTE. 889           | SECTION 101TS-2 | COUNTY MASSAC | TOTAL SHEETS 15 | SHEET NO. 12 |
| CONTRACT NO. 78857        |                 |               |                 |              |
| ILLINOIS FED. AID PROJECT |                 |               |                 |              |

SCALE: SHEET OF SHEETS STA. TO STA.

NOTES: 1.) INTERCEPT EXISTING SERVICE CONDUIT. COUPLE EXISTING CONDUIT WITH PROPOSED CONDUIT TO NEW GROUND MOUNT SERVICE CABINET. LAND EXISTING SERVICE CABLE TO NEW SERVICE.

2.) RELOCATE EXISTING UPS CABINET TO PROP. TYPE V CABINET. COST TO BE INCLUDED IN FULL-ACTUATED CONTROLLER AND TYPE V CABINET

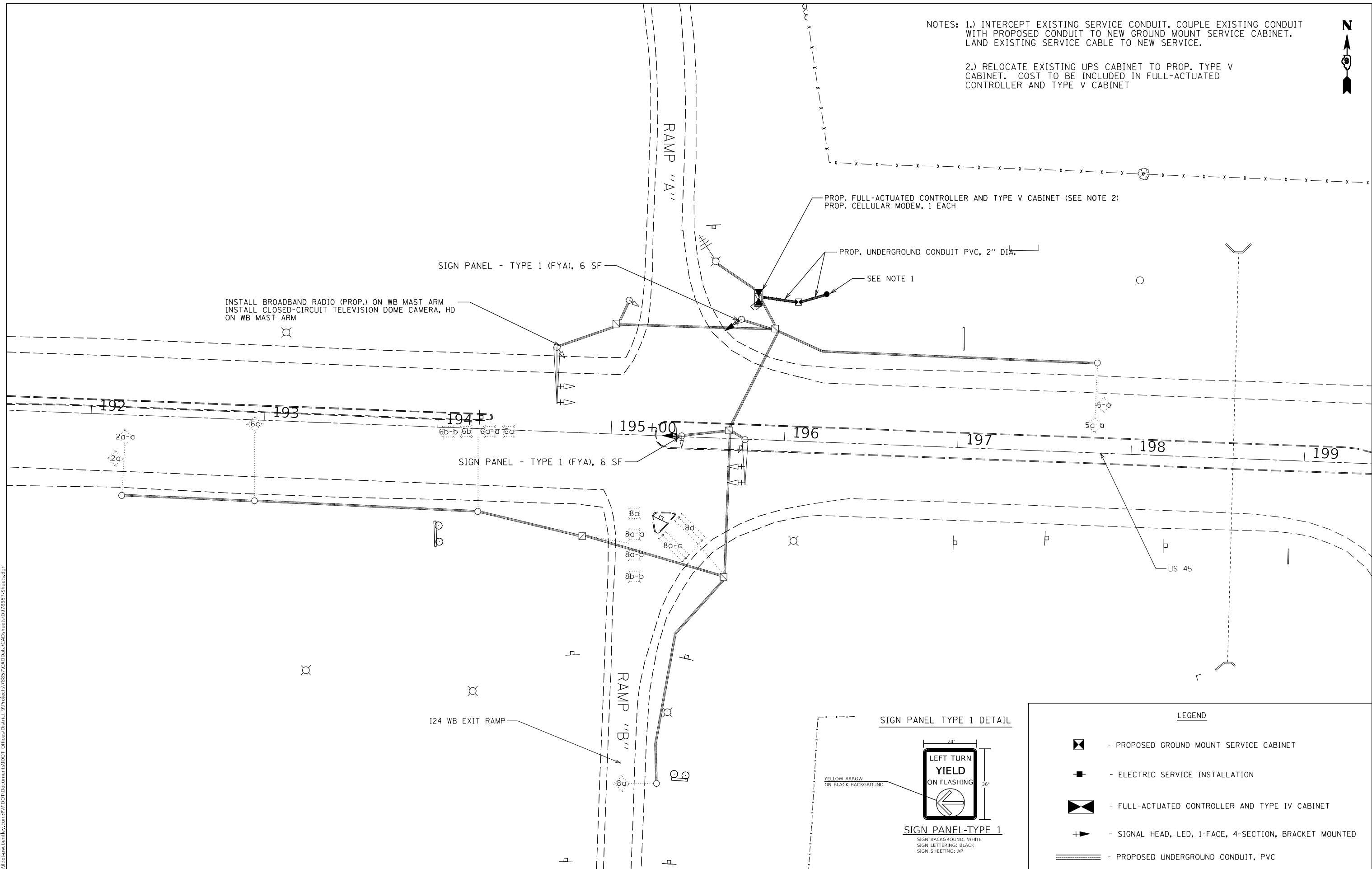

INSTALL BROADBAND RADIO (PROP.) ON WB MAST ARM  
INSTALL CLOSED-CIRCUIT TELEVISION DOME CAMERA, HD ON WB MAST ARM

PROP. FULL-ACTUATED CONTROLLER AND TYPE V CABINET (SEE NOTE 2)  
PROP. CELLULAR MODEM, 1 EACH

PROP. UNDERGROUND CONDUIT PVC, 2" DIA.

SEE NOTE 1



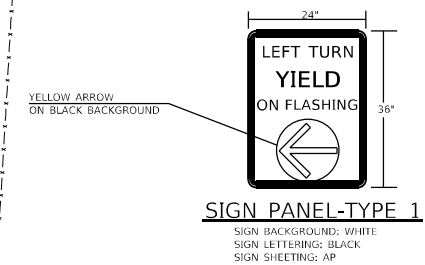

SIGN PANEL - TYPE 1 (FYA), 6 SF

SIGN PANEL - TYPE 1 (FYA), 6 SF

SIGN PANEL TYPE 1 DETAIL

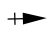

LEGEND

-  - PROPOSED GROUND MOUNT SERVICE CABINET
-  - ELECTRIC SERVICE INSTALLATION
-  - FULL-ACTUATED CONTROLLER AND TYPE IV CABINET
-  - SIGNAL HEAD, LED, 1-FACE, 4-SECTION, BRACKET MOUNTED
-  - PROPOSED UNDERGROUND CONDUIT, PVC

MODEL: 75 scale  
FILE NAME: p:\ultra\paw\benefy.com\PIV\DOT\Documents\DOT Office\Dir\rdt @\Project\78857\CADD\DATA\CAD\Sheets\0978857-Sheets.dgn

|                              |            |           |
|------------------------------|------------|-----------|
| USER NAME = greenleesm       | DESIGNED - | REVISED - |
|                              | DRAWN -    | REVISED - |
| PLOT SCALE = 50,0000 * / in. | CHECKED -  | REVISED - |
| PLOT DATE = 1/24/2022        | DATE -     | REVISED - |

**STATE OF ILLINOIS  
DEPARTMENT OF TRANSPORTATION**

**PROPOSED SIGNALS US 45 / I-24 EAST RAMP**

SCALE: SHEET OF SHEETS STA. TO STA.

| F.A.P. RTE.               | SECTION | COUNTY | TOTAL SHEETS | SHEET NO. |
|---------------------------|---------|--------|--------------|-----------|
| 889                       | 101TS-2 | MASSAC | 15           | 13        |
| CONTRACT NO. 78857        |         |        |              |           |
| ILLINOIS FED. AID PROJECT |         |        |              |           |



PROPOSED TRAFFIC SIGNALS LEGEND (SHEET DETAILS)

- \* PROPOSED CABLE NUMBER  
\* = CABLE NUMBER
- R SIGNAL SECTION - SOLID RED
- Y SIGNAL SECTION - SOLID YELLOW
- G SIGNAL SECTION - SOLID GREEN
- ←R SIGNAL SECTION - LEFT TURN RED
- ←FY SIGNAL SECTION - LEFT TURN FLASHING YELLOW
- ←Y SIGNAL SECTION - LEFT TURN YELLOW
- ←G SIGNAL SECTION - LEFT TURN GREEN
- (6) TRAFFIC PHASE
- ┌  
└ TRAFFIC SIGNAL BACKPLATE

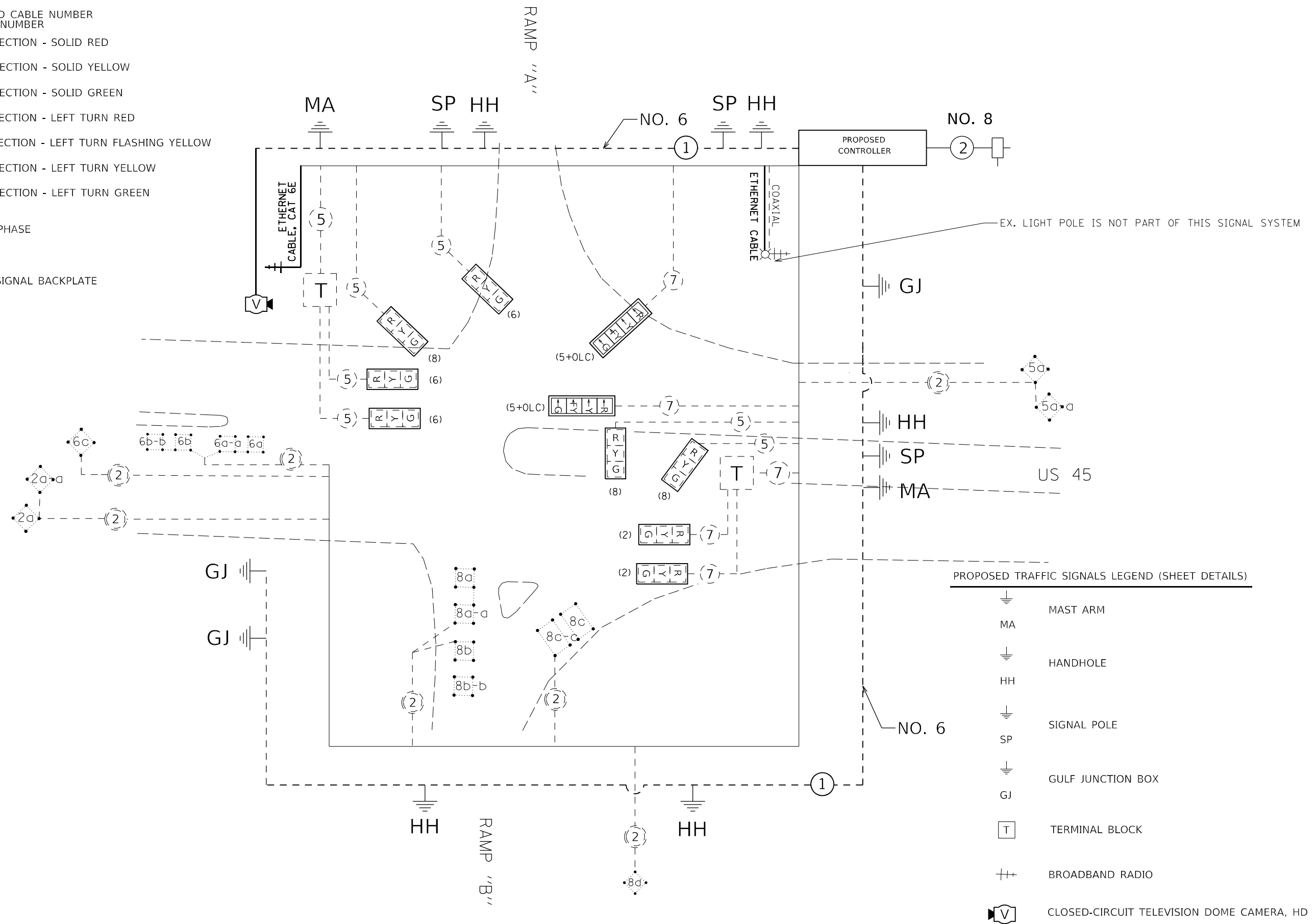

MODEL: 75 scale  
 FILE NAME: p:\project-aw-beadefy.com\p\windot\documents\DOT Office\Dir\dir: @Project\78857\CADD\DATA\CAD\sheet\0978857-Sheets.dgn

|                              |            |           |
|------------------------------|------------|-----------|
| USER NAME = greenleesm       | DESIGNED - | REVISED - |
|                              | DRAWN -    | REVISED - |
| PLOT SCALE = 50,0000 * / in. | CHECKED -  | REVISED - |
| PLOT DATE = 1/24/2022        | DATE -     | REVISED - |

**STATE OF ILLINOIS  
DEPARTMENT OF TRANSPORTATION**

**WIRING DIAGRAM US 45 / I-24 EAST RAMP**

SCALE: SHEET OF SHEETS STA. TO STA.

|                           |                 |               |                 |              |
|---------------------------|-----------------|---------------|-----------------|--------------|
| F.A.P. RTE. 889           | SECTION 101TS-2 | COUNTY MASSAC | TOTAL SHEETS 15 | SHEET NO. 14 |
| CONTRACT NO. 78857        |                 |               |                 |              |
| ILLINOIS FED. AID PROJECT |                 |               |                 |              |

MODEL: Default  
 FILE: \\naufc-pw-bufile.com\P\INDOT\Documents\DOT Office\District 8\Project\78857\CADD\Drawings\CAD\Drawings\078857-Sheets.dgn

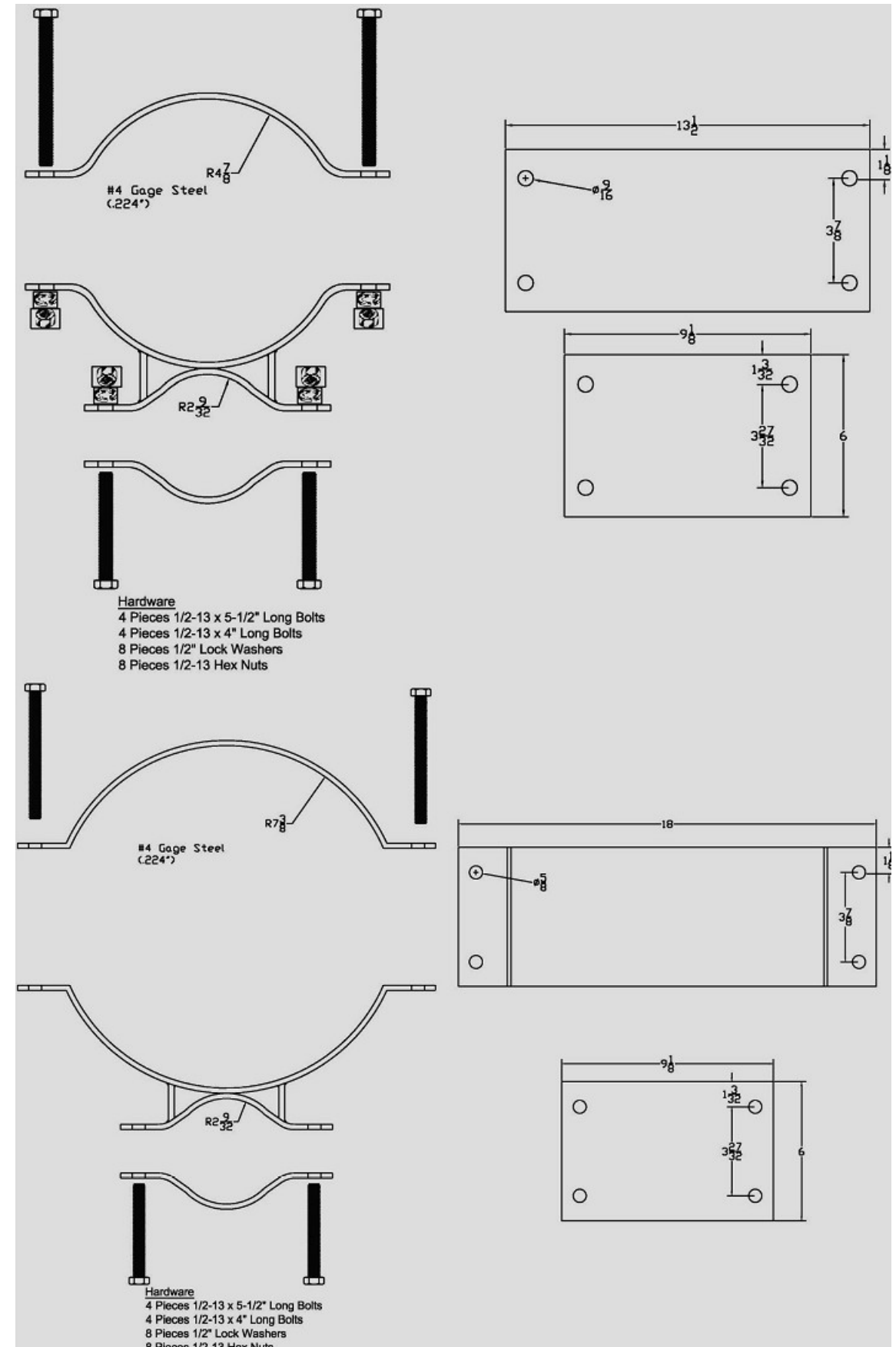
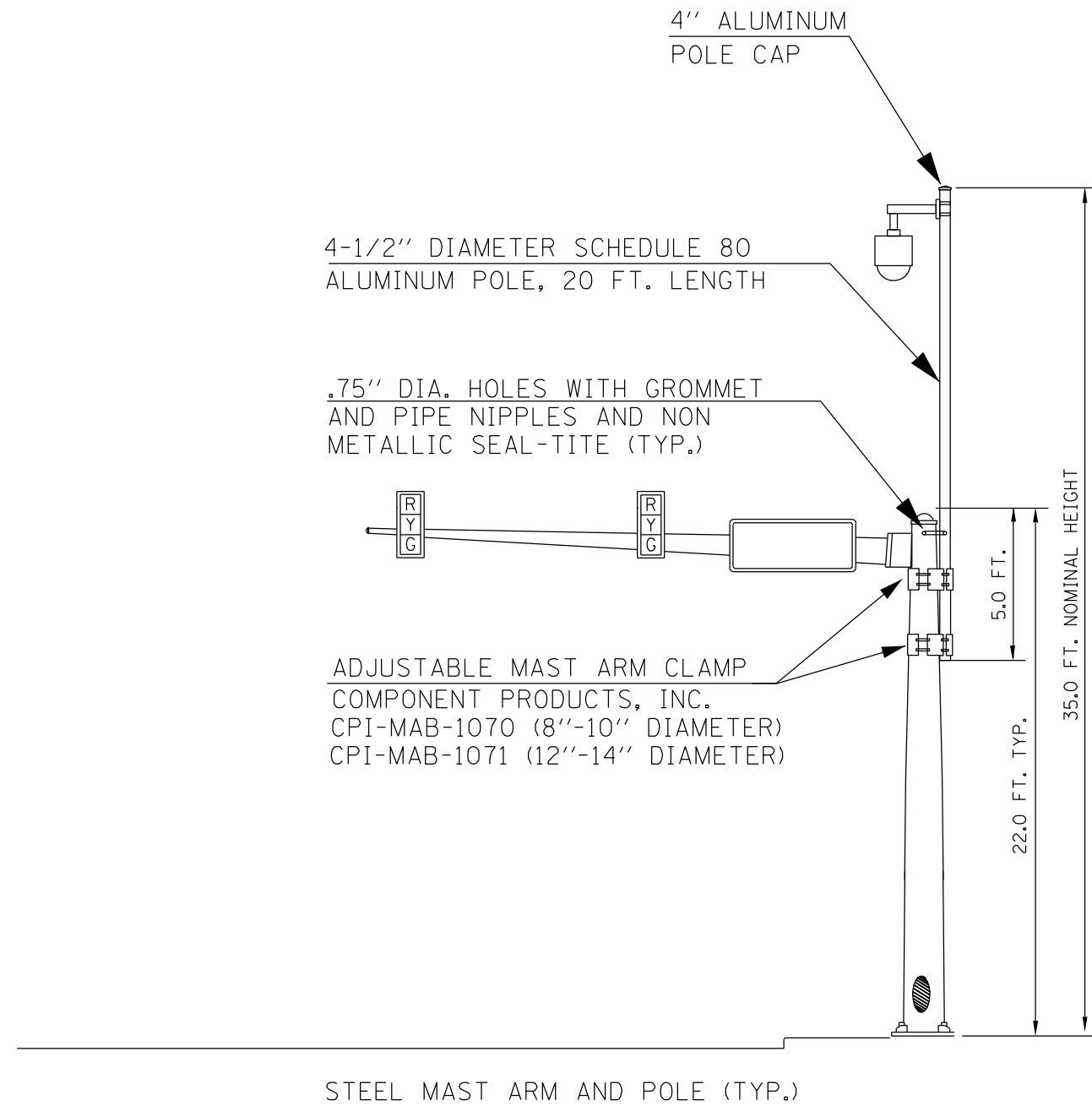

|                               |            |           |
|-------------------------------|------------|-----------|
| USER NAME = greenleesm        | DESIGNED - | REVISED - |
| PLOT SCALE = 100,0000 ' / in. | DRAWN -    | REVISED - |
| PLOT DATE = 1/24/2022         | CHECKED -  | REVISED - |
|                               | DATE -     | REVISED - |

**STATE OF ILLINOIS  
 DEPARTMENT OF TRANSPORTATION**

**DETAIL: MAST ARM EXTENSION**

SCALE: SHEET OF SHEETS STA. TO STA.

|                           |         |        |              |           |
|---------------------------|---------|--------|--------------|-----------|
| F.A.P. RTE.               | SECTION | COUNTY | TOTAL SHEETS | SHEET NO. |
| 889                       | 10ITS-2 | MASSAC | 15           | 15        |
| CONTRACT NO. 78857        |         |        |              |           |
| ILLINOIS FED. AID PROJECT |         |        |              |           |