

STATE OF ILLINOIS
DEPARTMENT OF TRANSPORTATION

PROPOSED HIGHWAY PLANS

FAP 742 & 553 (IL 2 & 72)
SECTION: (37BR-2)BP & (119B-1)BP
PROJECT: STP-ZZRD(583)
TYPE of IMPROVEMENT: BRIDGE PAINTING
OGLE COUNTY

FOR INDEX OF SHEETS, SEE SHEET NO. 2
FOR STATE STANDARDS, SEE SHEET NO. 2

F.A.P. RTE.	SECTION	COUNTY	TOTAL SHEETS	SHEET NO.
742 & 553	(37BR-2)BP & (119B-1)BP	OGLE	12	1
		ILLINOIS	CONTRACT NO. 64R38	

D-92-003-22

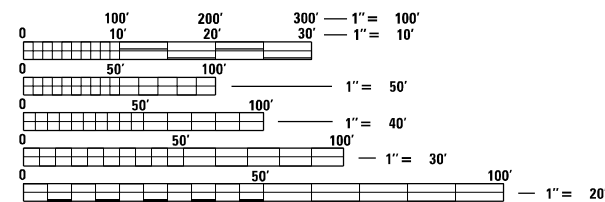
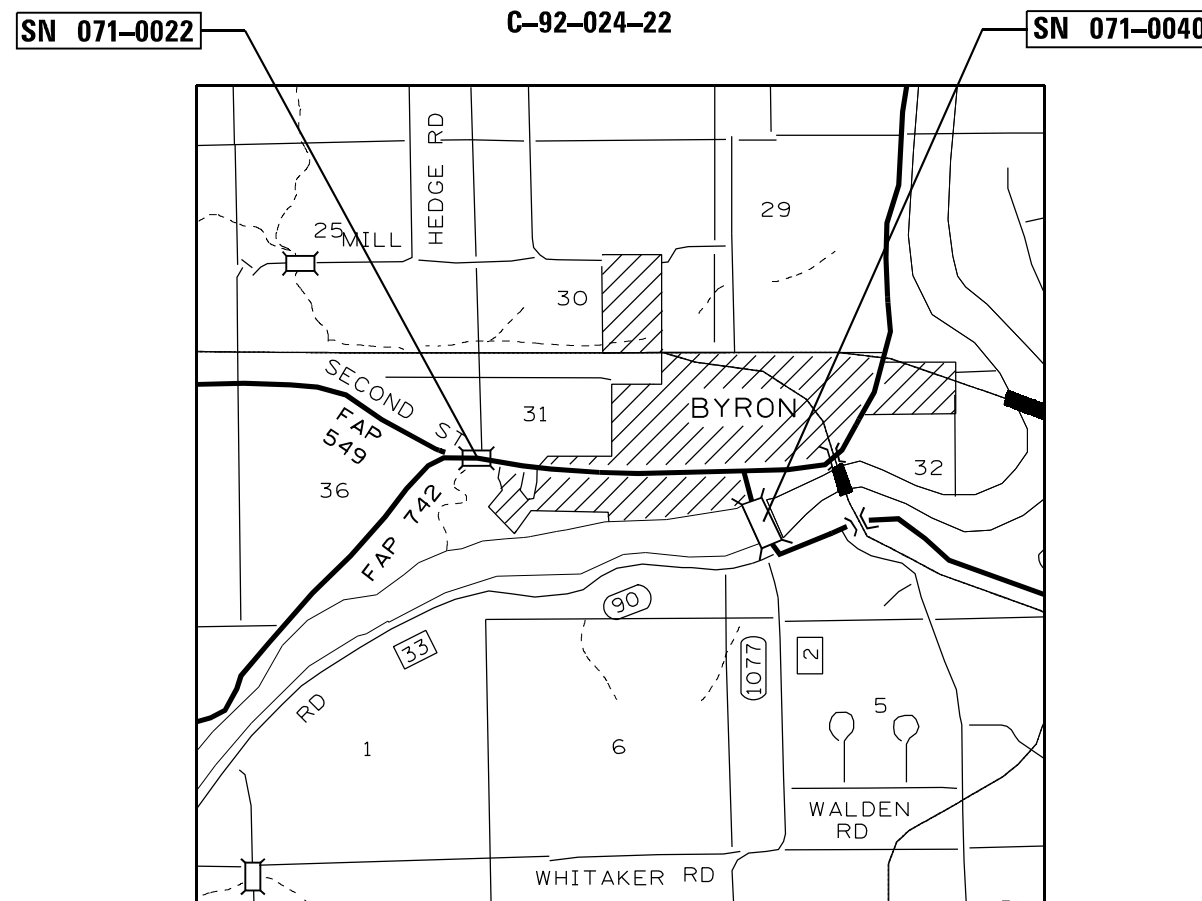
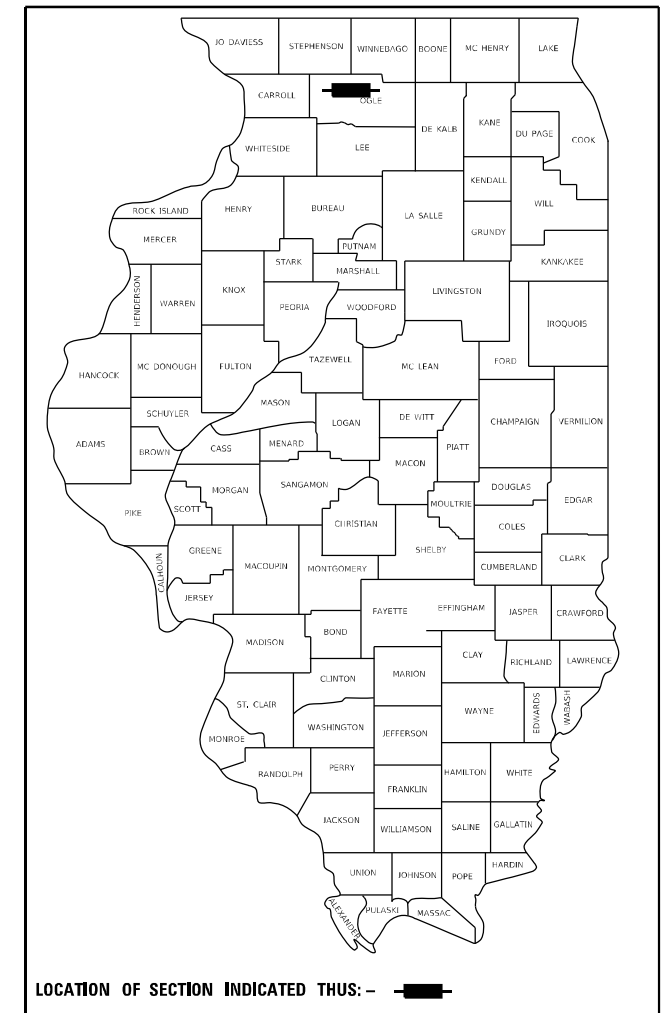

FULL SIZE PLANS HAVE BEEN PREPARED USING STANDARD ENGINEERING SCALES, REDUCED SIZED PLANS WILL NOT CONFORM TO STANDARD SCALES. IN MAKING MEASUREMENTS ON REDUCED PLANS, THE ABOVE SCALES MAY BE USED.

J.U.L.I.E.
JOINT UTILITY LOCATION INFORMATION FOR EXCAVATION
1-800-892-0123
OR 811

PROJECT ENGINEER: DAVID DOSS (815) 284-5416
PROJECT MANAGER: MAHMOUD ETEMADI (815) 284-5393

CONTRACT NO. 64R38

STATE OF ILLINOIS
DEPARTMENT OF TRANSPORTATION

SUBMITTED February 01, 20 22

David Doss
REGIONAL ENGINEER

March 25, 20 22
[Signature]
ENGINEER OF DESIGN AND ENVIRONMENT

March 23, 20 22
Stephen M. Farris
DIRECTOR OF HIGHWAYS PROJECT IMPLEMENTATION

PRINTED BY THE AUTHORITY
OF THE STATE OF ILLINOIS

INDEX OF SHEETS

1	COVER SHEET
2	INDEX OF SHEETS / STATE STANDARDS / GENERAL NOTES
3	SUMMARY OF QUANTITIES
4	STAGING TYPICAL SN 071-0022
5-7	STAGING PLAN SN 071-0022
8	STAGING TYPICAL SN 071-0040
9-11	STAGING PLAN SN 071-0040
12	TEMPORARY TRAFFIC SIGNAL INSTALLATION PLAN SN 071-0040

STATE STANDARDS

701101-05	OFF-ROAD OPERATIONS, MULTILANE, 15' (4.5m) TO 24" (600mm) FROM PAVEMENT EDGE
701201-05	LANE CLOSURE, 2L, 2W, DAY ONLY, FOR SPEEDS \geq 45 MPH
701206-05	LANE CLOSURE, 2L, 2W, NIGHT ONLY, FOR SPEEDS \geq 45 MPH
701301-04	LANE CLOSURE, 2L, 2W, SHORT TIME OPERATIONS
701306-04	LANE CLOSURE, 2L, 2W, SLOW MOVING OPERATIONS DAY ONLY, FOR SPEEDS \geq 45 MPH
701321-18	LANE CLOSURE, 2L, 2W, BRIDGE REPAIR WITH BARRIER
701901-08	TRAFFIC CONTROL DEVICES
704001-08	TEMPORARY CONCRETE BARRIER
720011-01	METAL POSTS FOR SIGNS, MARKERS & DELINEATORS
728001-01	TELESCOPING STEEL SIGN SUPPORT
729001-01	APPLICATIONS OF TYPES A & B METAL POSTS (FOR SIGNS & MARKERS)
701501-06	URBAN LANE CLOSURE, 2L, 2W, UNDIVIDED

GENERAL NOTES

LOCATION 1 - SN 071-0022

THE CONTRACTOR SHALL SEED ALL DISTURBED AREAS WITHIN THE PROJECT LIMITS. SEEDING CLASS 2A SHALL BE USED. THIS WORK WILL BE INCLUDED IN THE CONTRACT UNIT PRICE PER LUMP SUM FOR CLEANING AND PAINTING STEEL BRIDGE NO. 1.

FERTILIZER SHALL BE APPLIED TO ALL DISTURBED AREAS AND INCORPORATED INTO THE SEEDBED PRIOR TO SEEDING OR PLACEMENT OF SOD AT THE RATE SPECIFIED IN SECTIONS 250 AND 252 OF THE STANDARD SPECIFICATIONS. THIS WORK SHALL BE INCLUDED IN THE COST OF CLEANING AND PAINTING STEEL BRIDGE NO. 1.

MULCH METHOD II SHALL BE APPLIED OVER ALL SEEDED AREAS. THIS SHALL BE INCLUDED IN THE COST OF THE CLEANING AND PAINTING STEEL BRIDGE NO. 1.

LOCATION 2 - SN 071-0040

THE CONTRACTOR SHALL SEED ALL DISTURBED AREAS WITHIN THE PROJECT LIMITS. SEEDING CLASS 2A SHALL BE USED. THIS WORK WILL BE INCLUDED IN THE CONTRACT UNIT PRICE PER LUMP SUM FOR CLEANING AND PAINTING STEEL BRIDGE NO. 2.

FERTILIZER SHALL BE APPLIED TO ALL DISTURBED AREAS AND INCORPORATED INTO THE SEEDBED PRIOR TO SEEDING OR PLACEMENT OF SOD AT THE RATE SPECIFIED IN SECTIONS 250 AND 252 OF THE STANDARD SPECIFICATIONS. THIS WORK SHALL BE INCLUDED IN THE COST OF CLEANING AND PAINTING STEEL BRIDGE NO. 2.

MULCH METHOD II SHALL BE APPLIED OVER ALL SEEDED AREAS. THIS SHALL BE INCLUDED IN THE COST OF THE CLEANING AND PAINTING STEEL BRIDGE NO. 2.

LOCATION 1 & 2 - SN 071-0022 & SN 071-0040

ALL BORROW/WASTE/USE SITES MUST BE APPROVED BY THE DEPARTMENT PRIOR TO REMOVING ANY MATERIAL FROM THE PROJECT OR INITIATING ANY EARTHMOVING ACTIVITIES, INCLUDING TEMPORARY STOCKPILING OUTSIDE THE LIMITS OF CONSTRUCTION.

TEMPORARY IMPACT ATTENUATORS WILL BE MEASURED AS EACH FOR EACH ATTENUATOR SUPPLIED ON THE JOB AS SPECIFIED IN THE PLANS, AND SHALL INCLUDE THE COST OF RENTING/OWNING THE ATTENUATOR FOR THE TIME REQUIRED ON THE JOB PLUS HAULING TO AND FROM THE PROJECT SITE, AS WELL AS ONE PLACEMENT AND REMOVAL FROM THE ROADWAY. THIS SHALL BE PAID FOR AT THE CONTRACT UNIT PRICE PER EACH FOR IMPACT ATTENUATORS, TEMPORARY OF THE TYPE SPECIFIED.

RELOCATE TEMPORARY IMPACT ATTENUATOR WILL BE PAID FOR AS EACH AND WILL BE PAID FOR EACH TIME THE ATTENUATOR IS REQUIRED BY STAGING TO BE PICKED UP AND MOVED TO A DIFFERENT LOCATION ON THE PROJECT, WHETHER IT IS TO ANOTHER LOCATION ON THE ROADWAY OR TO A STORAGE/STAGING LOCATION FOR THE PROJECT. THIS SHALL BE PAID FOR AT THE CONTRACT UNIT PRICE PER EACH FOR IMPACT ATTENUATORS, RELOCATE OF THE TYPE SPECIFIED.

THIS WORK SHALL BE DONE IN ACCORDANCE WITH SECTION 704 OF THE STANDARD SPECIFICATIONS. TEMPORARY CONCRETE BARRIER WILL BE MEASURED IN FEET ALONG THE CENTERLINE OF THE BARRIER AND SHALL INCLUDE THE COST OF RENTING/OWNING THE BARRIER FOR THE TIME REQUIRED ON THE JOB PLUS HAULING TO AND FROM THE PROJECT SITE, AS WELL AS ONE PLACEMENT AND REMOVAL FROM THE ROADWAY IN ACCORDANCE WITH SECTION 704 OF THE STANDARD AND SPECIFICATION. THIS SHALL BE PAID FOR AT THE CONTRACT UNIT PRICE PER FOOT FOR TEMPORARY CONCRETE BARRIER.

RELOCATE TEMPORARY CONCRETE BARRIER WILL BE PAID FOR IN FEET ALONG THE CENTERLINE OF THE BARRIER, AND WILL BE PAID FOR EACH TIME THE BARRIER IS REQUIRED BY STAGING TO BE PICKED UP AND MOVED TO A DIFFERENT LOCATION ON THE PROJECT, WHETHER IT IS TO ANOTHER LOCATION ON THE ROADWAY OR TO A STORAGE/STAGING LOCATION FOR THE PROJECT. THIS SHALL BE PAID FOR AT THE CONTRACT UNIT PRICE PER FOOT FOR RELOCATE TEMPORARY CONCRETE BARRIER.

THE CONTRACTOR SHALL BE RESPONSIBLE FOR PROTECTING UTILITY PROPERTY DURING CONSTRUCTION OPERATIONS AS OUTLINED IN ARTICLE 107.31 OF THE STANDARD SPECIFICATIONS. A MINIMUM OF 48 HOURS ADVANCE NOTICE IS REQUIRED FOR NON-EMERGENCY WORK. THE JULIE NUMBER IS 800-892-0123.

THE SSPC QP1 & QP2 CONTRACT CERTIFICATIONS WILL BE REQUIRED FOR THIS CONTRACT.

MODEL: Default
FILE: \\nailes-pw-bentley.com\PW\DOT\Documents\Bridg Section\071-0040\483838\CADD\64838-shc-cover.dgn

USER NAME = dossed	DESIGNED - _____	REVISED - _____	STATE OF ILLINOIS DEPARTMENT OF TRANSPORTATION	INDEX OF SHEETS, STATE STANDARDS & GENERAL NOTES	F.A.P. RTE. 742 & 553	SECTION (378R-2)BP & (119B-1)BP	COUNTY OGLE	TOTAL SHEETS 12	SHEET NO. 2
	DRAWN - _____	REVISED - _____			CONTRACT NO. 64R38		ILLINOIS	FED. AID PROJECT	
PLOT SCALE = 40.0000' / in.	CHECKED - _____	REVISED - _____	SCALE: _____	SHEET _____ OF _____ SHEETS	STA. _____ TO STA. _____				
PLOT DATE = Feb-01-2022 01:52:28 PM	DATE - _____	REVISED - _____							

SUMMARY OF QUANTITIES

CODE NUMBER	ITEM	UNIT	0047 80% STP 20% STATE	0047 80% STP 20% STATE	URBAN
			OGLE COUNTY SN 071-0022	OGLE COUNTY SN 071-0040	
67100100	MOBILIZATION	L SUM	0.50	0.50	1
70100405	TRAFFIC CONTROL AND PROTECTION, STANDARD 701321	EACH	1	1	2
70100450	TRAFFIC CONTROL AND PROTECTION, STANDARD 701201	L SUM	1		1
70100455	TRAFFIC CONTROL AND PROTECTION, STANDARD 701206	L SUM	0.5	0.5	1
70100460	TRAFFIC CONTROL AND PROTECTION, STANDARD 701306	L SUM	0.5	0.5	1
70102620	TRAFFIC CONTROL AND PROTECTION, STANDARD 701501	L SUM		1	1
70106500	TEMPORARY BRIDGE TRAFFIC SIGNALS	EACH	1	1	2
70106700	TEMPORARY RUMBLE STRIPS	EACH	3	-	3
70107004	PAVEMENT MARKING BLACKOUT TAPE, 4"	FOOT	750	-	750
70300150	SHORT TERM PAVEMENT MARKING REMOVAL	SQ FT	218	875	1093
70307120	TEMPORARY PAVEMENT MARKING - LINE 4" - TYPE IV TAPE	FOOT	660	2650	3310
70400100	TEMPORARY CONCRETE BARRIER	FOOT	300	900	1200
70600240	IMPACT ATTENUATORS, TEMPORARY (NON-REDIRECTIVE, NARROW), TEST LEVEL 2	EACH	-	2	2
70600250	IMPACT ATTENUATORS, TEMPORARY (NON-REDIRECTIVE), TEST LEVEL 3	EACH	2	-	2
X5067501	BRIDGE CLEANING AND PAINTING WARRANTY NUMBER 1	L SUM	-	1	1
Z0007101	CONTAINMENT AND DISPOSAL OF LEAD PAINT CLEANING RESIDUES NO. 1	L SUM	1	-	1
Z0007102	CONTAINMENT AND DISPOSAL OF LEAD PAINT CLEANING RESIDUES NO. 2	L SUM	-	1	1
Z0010501	CLEANING AND PAINTING STEEL BRIDGE NO. 1	L SUM	1	-	1
Z0010502	CLEANING AND PAINTING STEEL BRIDGE NO. 2	L SUM	-	1	1

MODEL: Default
 FILE: Mainfile: p:\w\dot-cw-bentley.com\p\w\dot\Documents\DOT Offices\District: 2\Projects\Operations\Bridg Section\071-2040\64R38\CADD\64R38-shc-cover.dgn

USER NAME = dossdd	DESIGNED - _____	REVISED - _____
PLOT SCALE = 40.0000' / in.	CHECKED - _____	REVISED - _____
PLOT DATE = Feb-01-2022 01:52:41 PM	DATE - _____	REVISED - _____

**STATE OF ILLINOIS
DEPARTMENT OF TRANSPORTATION**

SUMMARY OF QUANTITIES

SCALE: _____ SHEET _____ OF _____ SHEETS STA. _____ TO STA. _____

F.A.P. RTE. 742 & 553	SECTION (378R-2)BP & (119B-1)BP	COUNTY OGLE	TOTAL SHEETS 12	SHEET NO. 3
CONTRACT NO. 64R38			ILLINOIS FED. AID PROJECT	

STAGING TYPICAL SN 071-0022

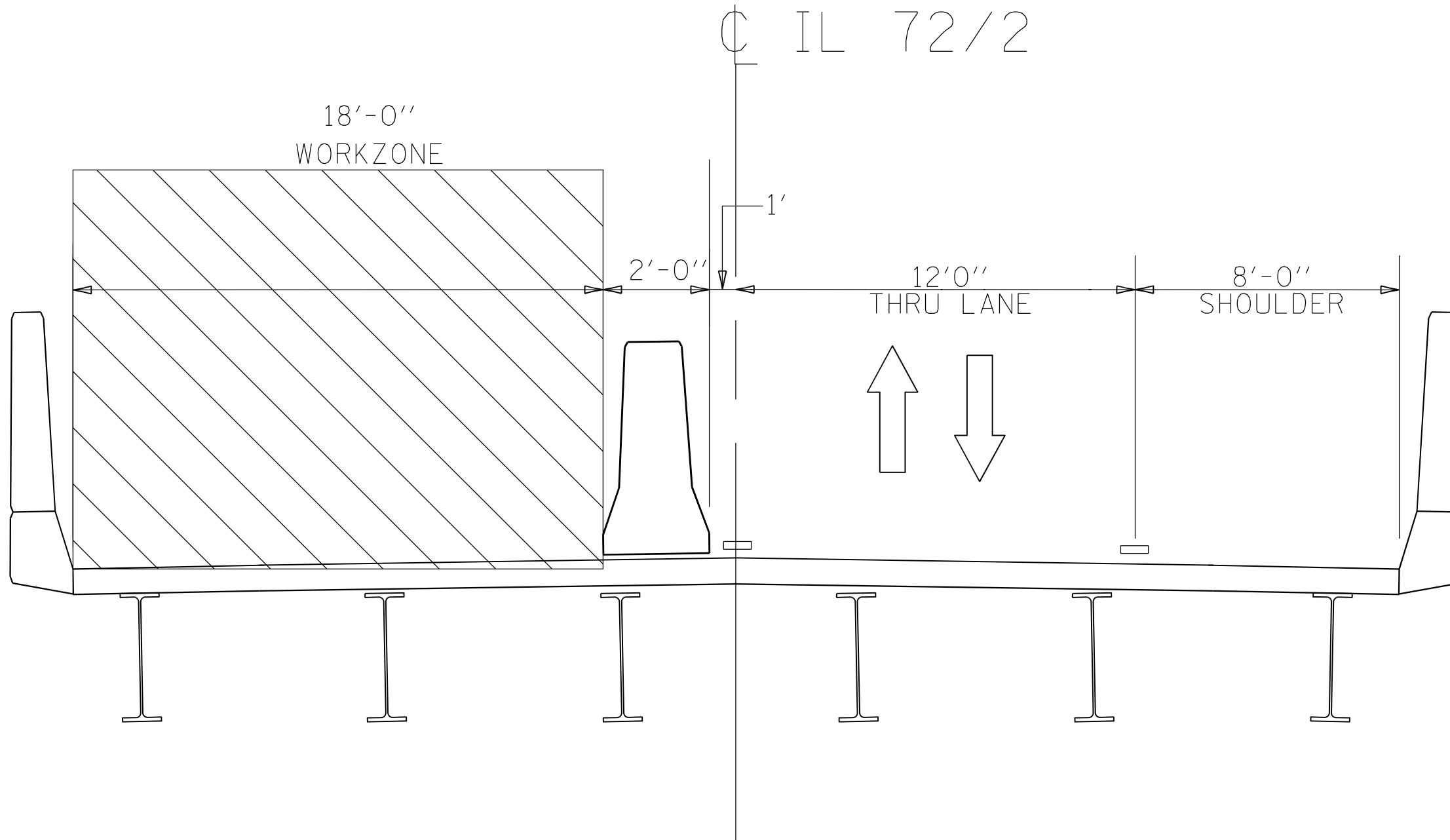

MODEL: Default
 FILE: \\nafe-pw-bentley.com\PW\DOT\Documents\DOT_Offices\District_2\Project\Operations\Bridges_Section\071-0040\64R38\CADD\64R38-511-cover.dgn

USER NAME = dssdd	DESIGNED - _____	REVISED - _____
	DRAWN - _____	REVISED - _____
PLOT SCALE = 40,0000 * / in.	CHECKED - _____	REVISED - _____
PLOT DATE = Feb-01-2022 01:52:53 PM	DATE - _____	REVISED - _____

STATE OF ILLINOIS
DEPARTMENT OF TRANSPORTATION

STAGING TYPICAL SN 071-0022			
SCALE: _____	SHEET _____	OF _____ SHEETS	STA. _____ TO STA. _____

F.A.P. RTE. 742 & 553	SECTION (378R-2)BP & (119B-1)BP	COUNTY OGLE	TOTAL SHEETS 12	SHEET NO. 4
CONTRACT NO. 64R38				
ILLINOIS FED. AID PROJECT				

STAGING PLAN SN 071-0022

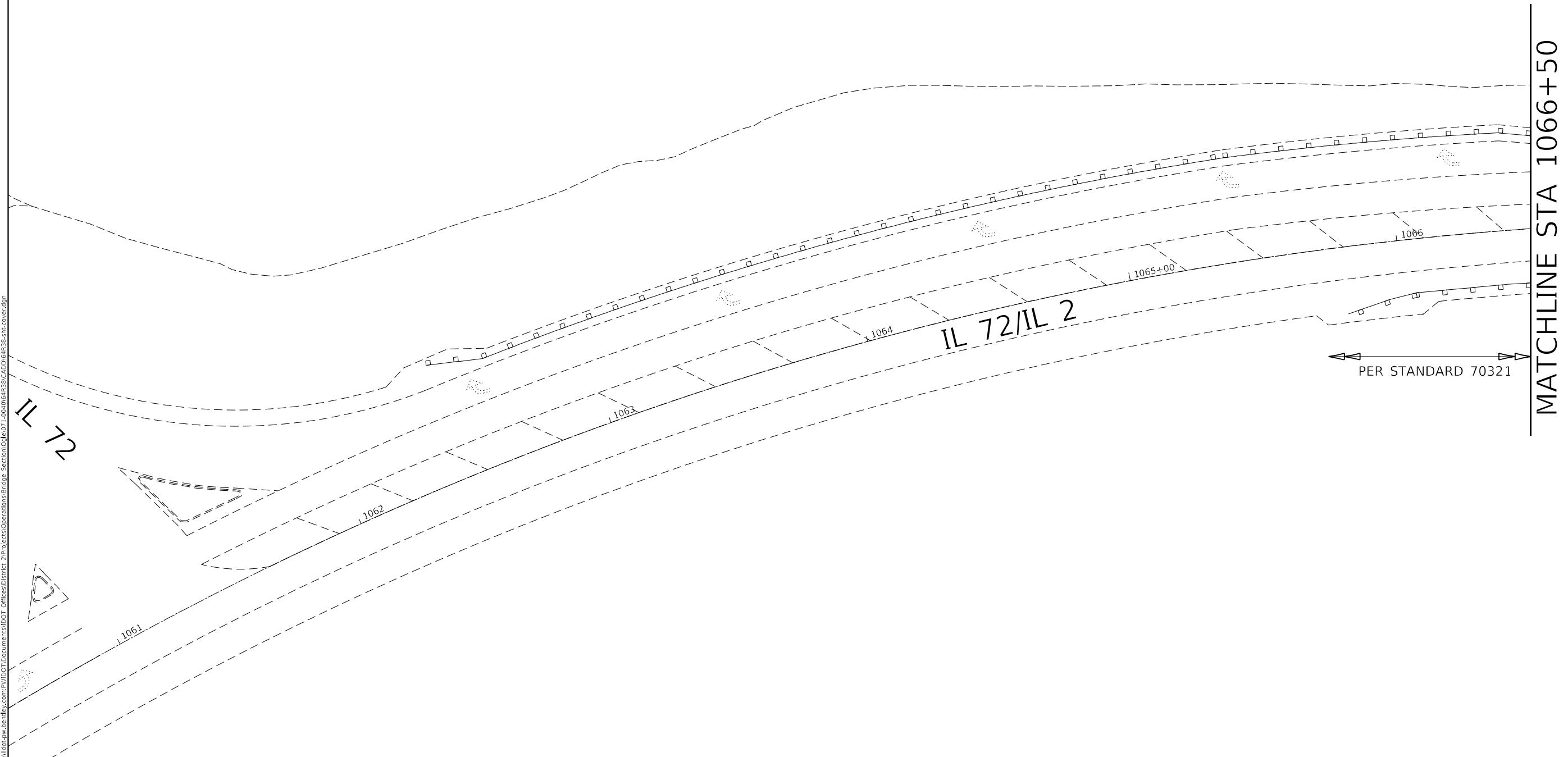

MODEL: Default
 FILE: \\nautilus.pw.usdnet.cw.bentley.com\PW\DOT\Documents\DOT_Offices\Director_2\Project\Operations\Bridges_Section\071-0040\64R38\CADD\64R38-511-cover.dgn

IL 72

IL 72/IL 2

MATCHLINE STA 1066+50

PER STANDARD 70321

USER NAME = drossdd	DESIGNED - _____	REVISED - _____
DRAWN - _____	REVISED - _____	
PLOT SCALE = 40,0000 * / in.	CHECKED - _____	REVISED - _____
PLOT DATE = Feb-01-2022 01:53:06 PM	DATE - _____	REVISED - _____

**STATE OF ILLINOIS
DEPARTMENT OF TRANSPORTATION**

**STAGING PLAN
SN 071-0022**

SCALE: _____ SHEET ____ OF ____ SHEETS STA. _____ TO STA. _____

F.A.P. RTE. 742 & 553	SECTION (378R-2)BP & (119B-1)BP	COUNTY OGLE	TOTAL SHEETS 12	SHEET NO. 5
ILLINOIS FED. AID PROJECT			CONTRACT NO. 64R38	

STAGING PLAN SN 071-0022

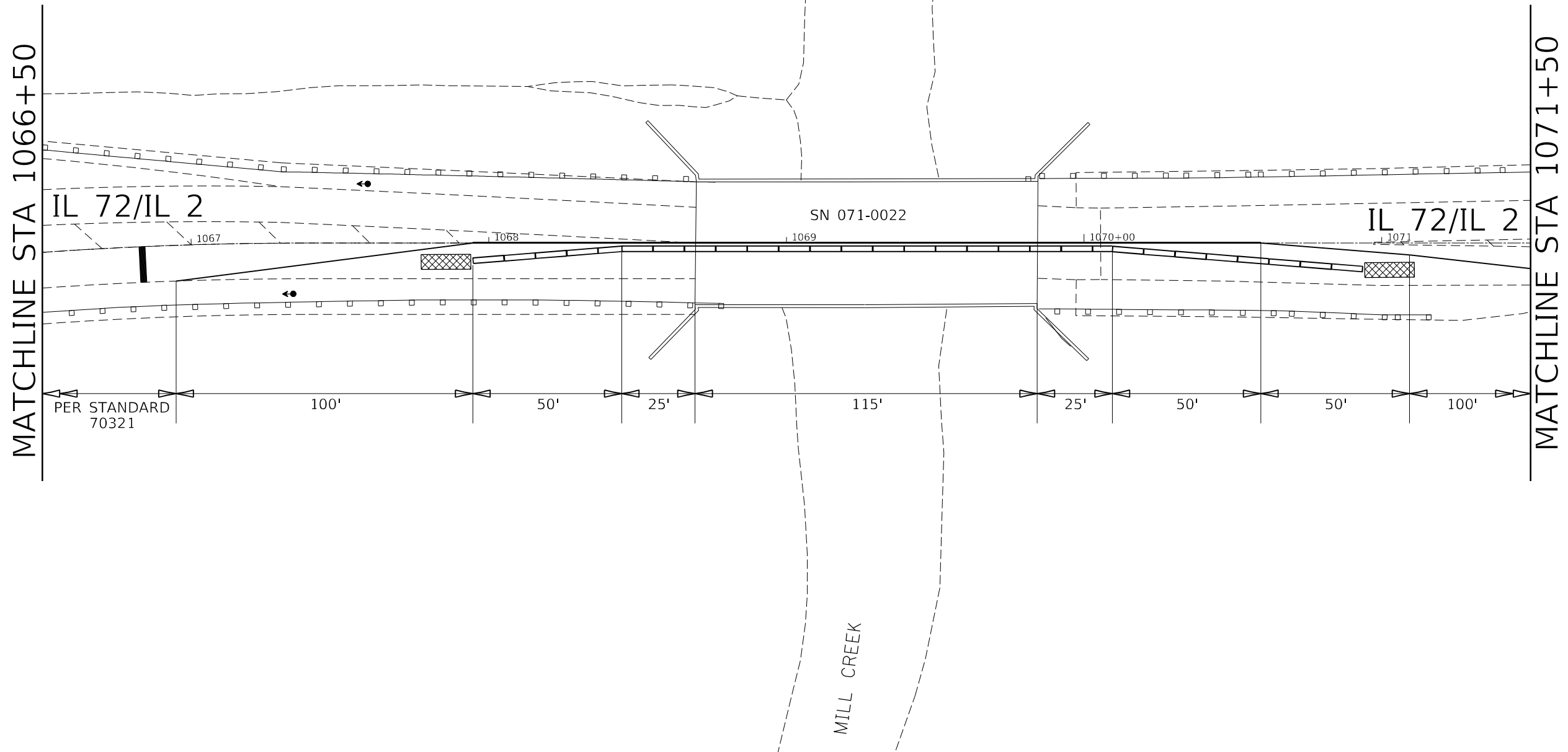

MODEL: Default
 FILE: \\naufc-pw-bentley.com\P\W\DOT\Documents\DOT Office\District 2\Project\Operations\Bridges - Section\071-0040\64R38\CADD\64R38-511-cover.dgn

USER NAME = drossd	DESIGNED - _____	REVISED - _____
	DRAWN - _____	REVISED - _____
PLOT SCALE = 40,0000 * / in.	CHECKED - _____	REVISED - _____
PLOT DATE = Feb-01-2022 01:53:13 PM	DATE - _____	REVISED - _____

STATE OF ILLINOIS
DEPARTMENT OF TRANSPORTATION

STAGING PLAN
SN 071-0022

SCALE: _____ SHEET ____ OF ____ SHEETS STA. _____ TO STA. _____

F.A.P. RTE. 742 & 553	SECTION (378R-2)BP & (119B-1)BP	COUNTY OGLE	TOTAL SHEETS 12	SHEET NO. 6
CONTRACT NO. 64R38				
ILLINOIS FED. AID PROJECT				

STAGING PLAN SN 071-0022

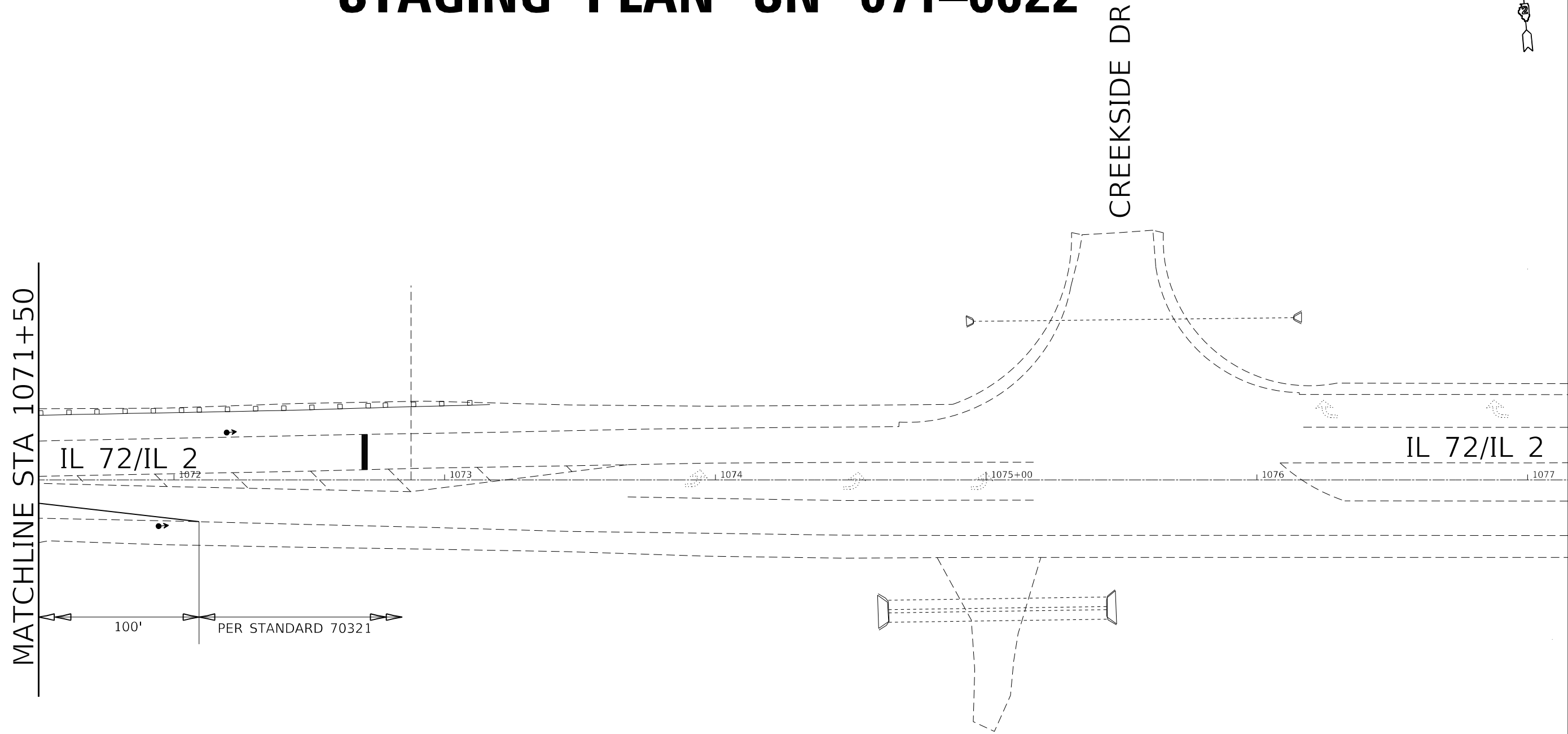

MODEL: Default
 FILE NAME: p:\ultra-cw-beadley.com\P\INDOT\Documents\INDOT_offices\District_2\Project\Operations\Bridges_Section\071-0040\64R38\CADD\64R38-sht-cover.dgn

USER NAME = drossid	DESIGNED - _____	REVISED - _____
	DRAWN - _____	REVISED - _____
PLOT SCALE = 40,0000 * / in.	CHECKED - _____	REVISED - _____
PLOT DATE = Feb-01-2022 01:53:22 PM	DATE - _____	REVISED - _____

**STATE OF ILLINOIS
 DEPARTMENT OF TRANSPORTATION**

**STAGING PLAN
 SN 071-0022**

SCALE: _____ SHEET ____ OF ____ SHEETS STA. _____ TO STA. _____

F.A.P. RTE. 742 & 553	SECTION (378R-2)BP & (119B-1)BP	COUNTY OGLE	TOTAL SHEETS 12	SHEET NO. 7
				CONTRACT NO. 64R38
ILLINOIS FED. AID PROJECT				

STAGING TYPICAL SN 071-0040

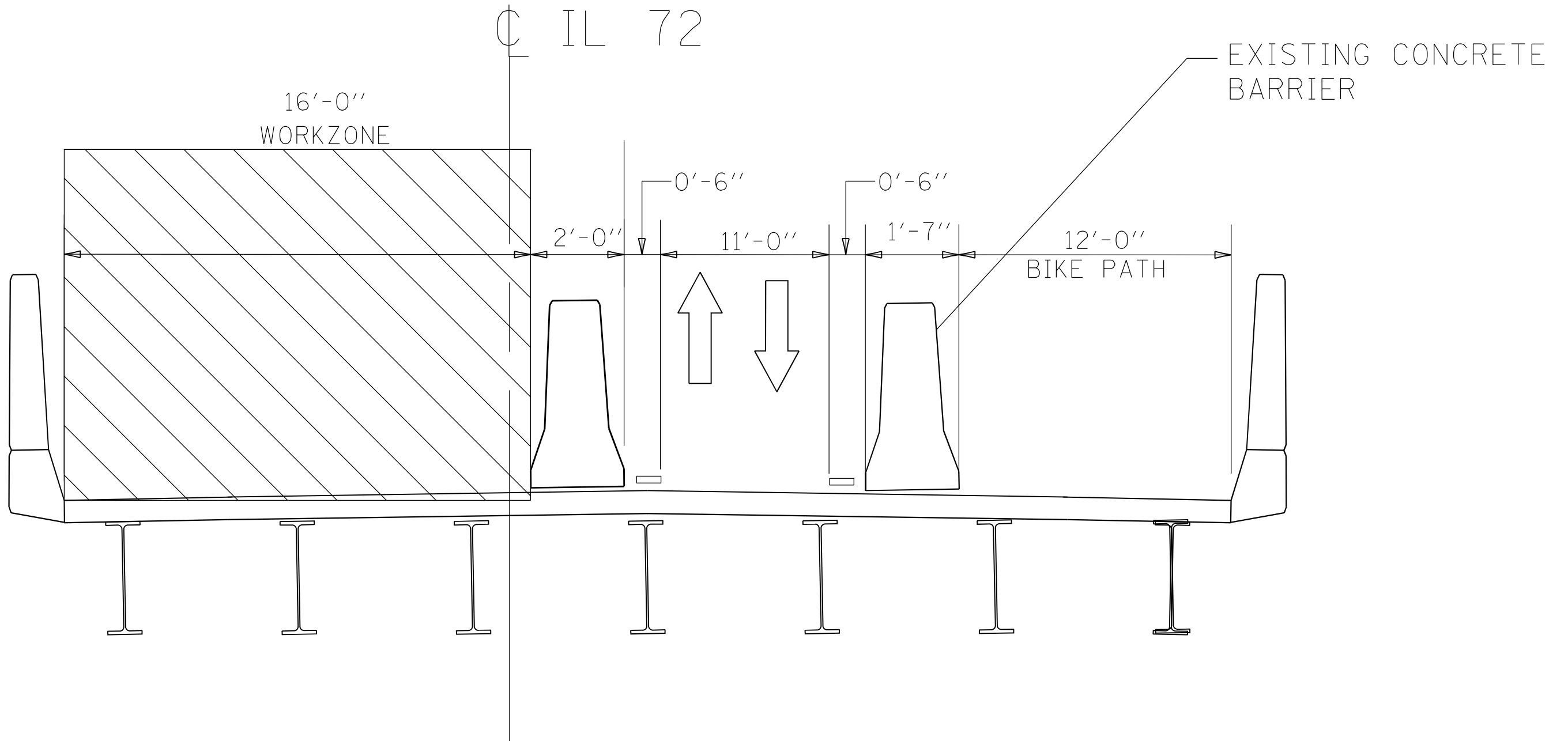

MODEL: Default
 FILE: \\nafe-pw-bentley.com\P\I\DOT\Documents\DOT_Offices\District_2\Project\Operations\Bridge_Section\071-0040\64R38-CADD\64R38-511-cover.dgn

USER NAME = dssdd	DESIGNED - _____	REVISED - _____
	DRAWN - _____	REVISED - _____
PLOT SCALE = 40,0000 * / in.	CHECKED - _____	REVISED - _____
PLOT DATE = Feb-01-2022 01:54:37 PM	DATE - _____	REVISED - _____

STATE OF ILLINOIS
DEPARTMENT OF TRANSPORTATION

STAGING TYPICAL
SN 071-0040

SCALE: _____ SHEET ____ OF ____ SHEETS STA. _____ TO STA. _____

F.A.P. RTE. 742 & 553	SECTION (378R-2)BP & (119B-1)BP	COUNTY OGLE	TOTAL SHEETS 12	SHEET NO. 8
CONTRACT NO. 64R38			ILLINOIS FED. AID PROJECT	

STAGING PLAN SN 071-0040

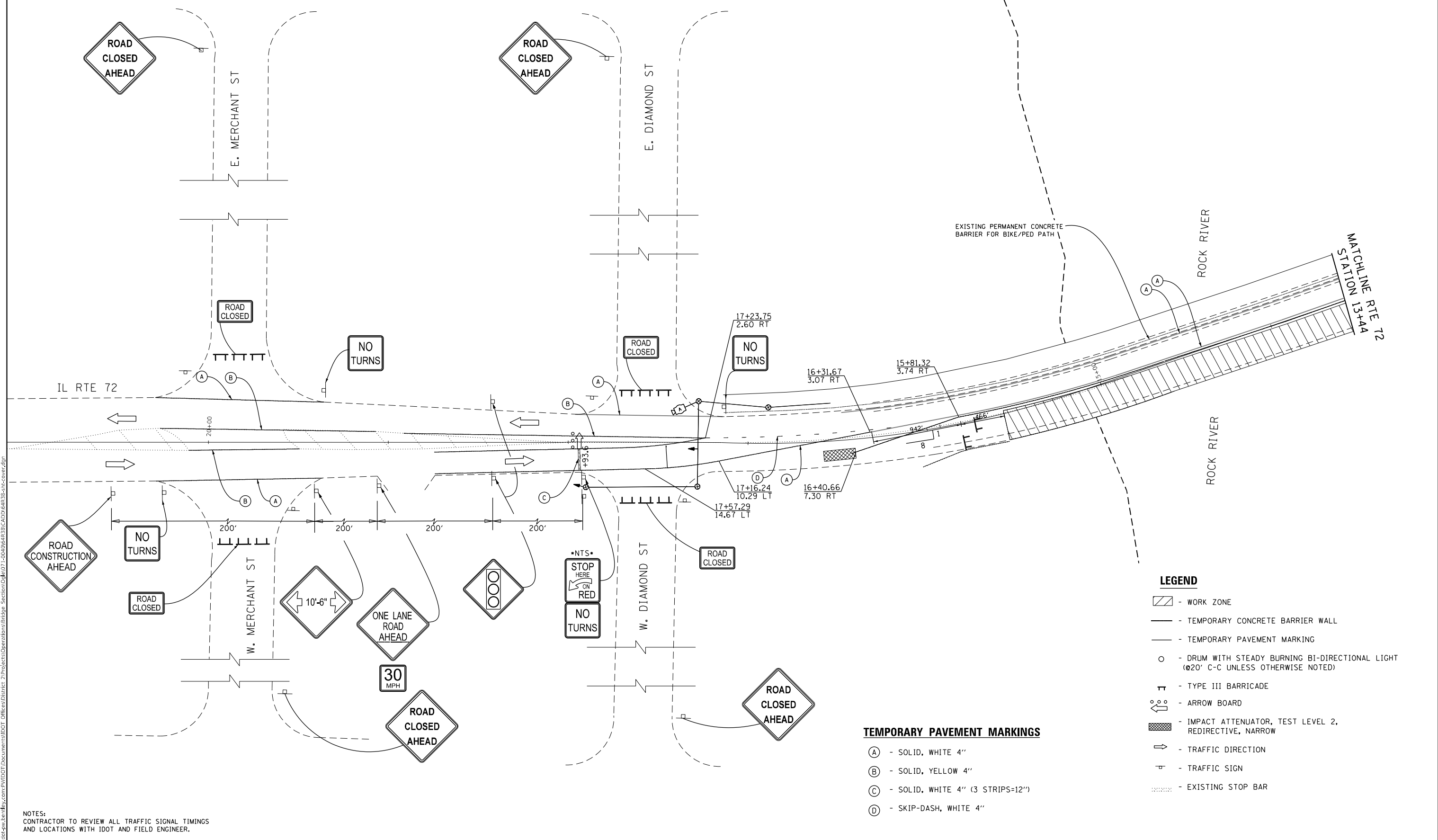

NOTES:
CONTRACTOR TO REVIEW ALL TRAFFIC SIGNAL TIMINGS
AND LOCATIONS WITH IDOT AND FIELD ENGINEER.

USER NAME = dlossdd	DESIGNED - _____	REVISED - _____
PLOT SCALE = 40,0000' / in.	CHECKED - _____	REVISED - _____
PLOT DATE = Feb-01-2022 01:54:45 PM	DATE - _____	REVISED - _____

STATE OF ILLINOIS
DEPARTMENT OF TRANSPORTATION

SCALE: _____		SHEET _____ OF _____ SHEETS	STA. _____ TO STA. _____
--------------	--	-----------------------------	--------------------------

STAGING PLAN
SN 071-0040

F.A.P. RTE. 742 & 553	SECTION (378R-2)BP & (119B-1)BP	COUNTY OGLE	TOTAL SHEETS 12	SHEET NO. 9
CONTRACT NO. 64R38				

ILLINOIS FED. AID PROJECT

MODEL: Default
 FILE: \\naufc-pw-backend.com\FW\DOT\Documents\1\DOT_Offices\Director_2\Project\Operations\Bridges - Section\071-0040\64R38-CADD\64R38-51-cover.dgn

STAGING PLAN SN 071-0040

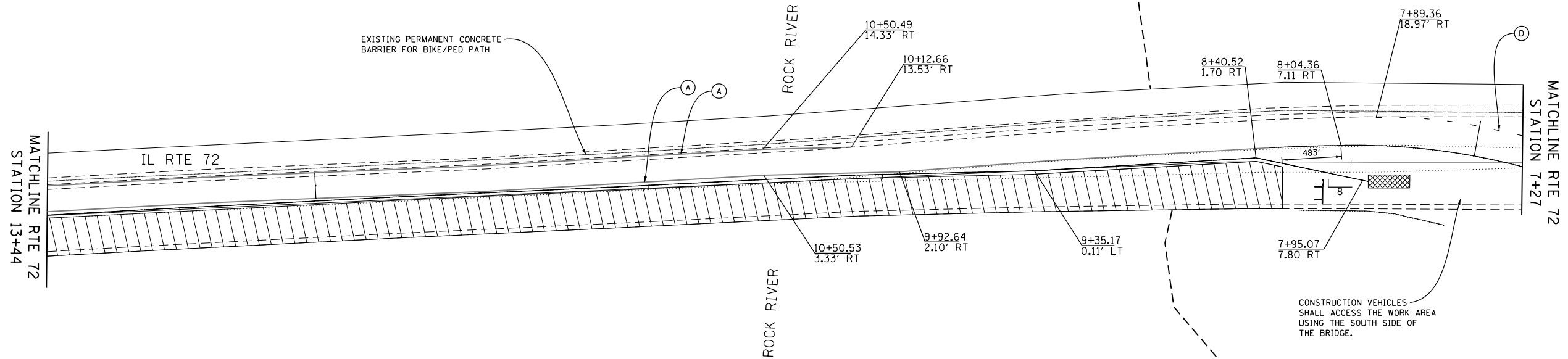
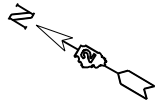

LEGEND

- WORK ZONE
- TEMPORARY CONCRETE BARRIER WALL
- TEMPORARY PAVEMENT MARKING
- DRUM WITH STEADY BURNING BI-DIRECTIONAL LIGHT (Ø20' C-C UNLESS OTHERWISE NOTED)
- TYPE III BARRICADE
- ARROW BOARD
- IMPACT ATTENUATOR, TEST LEVEL 2, REDIRECTIVE, NARROW
- TRAFFIC DIRECTION
- TRAFFIC SIGN
- EXISTING STOP BAR

TEMPORARY PAVEMENT MARKINGS

- (A) - SOLID, WHITE 4"
- (B) - SOLID, YELLOW 4"
- (C) - SOLID, WHITE 12"
- (D) - SKIP-DASH, WHITE 4"

MODEL: Default
 FILE: \\naufc-pw-bentley.com\P\W\DOT\Documents\DOT_offices\Dir\dir_2\Project\Operations\Bridges - Section\071-0040\071-0040-04R38-CADD\64R38-511-cover.dgn

USER NAME = drossd	DESIGNED - _____	REVISED - _____
DRAWN - _____	REVISOR - _____	REVISOR - _____
PLOT SCALE = 40,0000 * / in.	CHECKED - _____	REVISOR - _____
PLOT DATE = Feb-01-2022 01:54:54 PM	DATE - _____	REVISOR - _____

STATE OF ILLINOIS
DEPARTMENT OF TRANSPORTATION

STAGING PLAN
SN 071-0040

SCALE: _____ SHEET ____ OF ____ SHEETS STA. _____ TO STA. _____

F.A.P. RTE. 742 & 553	SECTION (378R-2)BP & (119B-1)BP	COUNTY OGLE	TOTAL SHEETS 12	SHEET NO. 10
CONTRACT NO. 64R38			ILLINOIS FED. AID PROJECT	

STAGING PLAN SN 071-0040

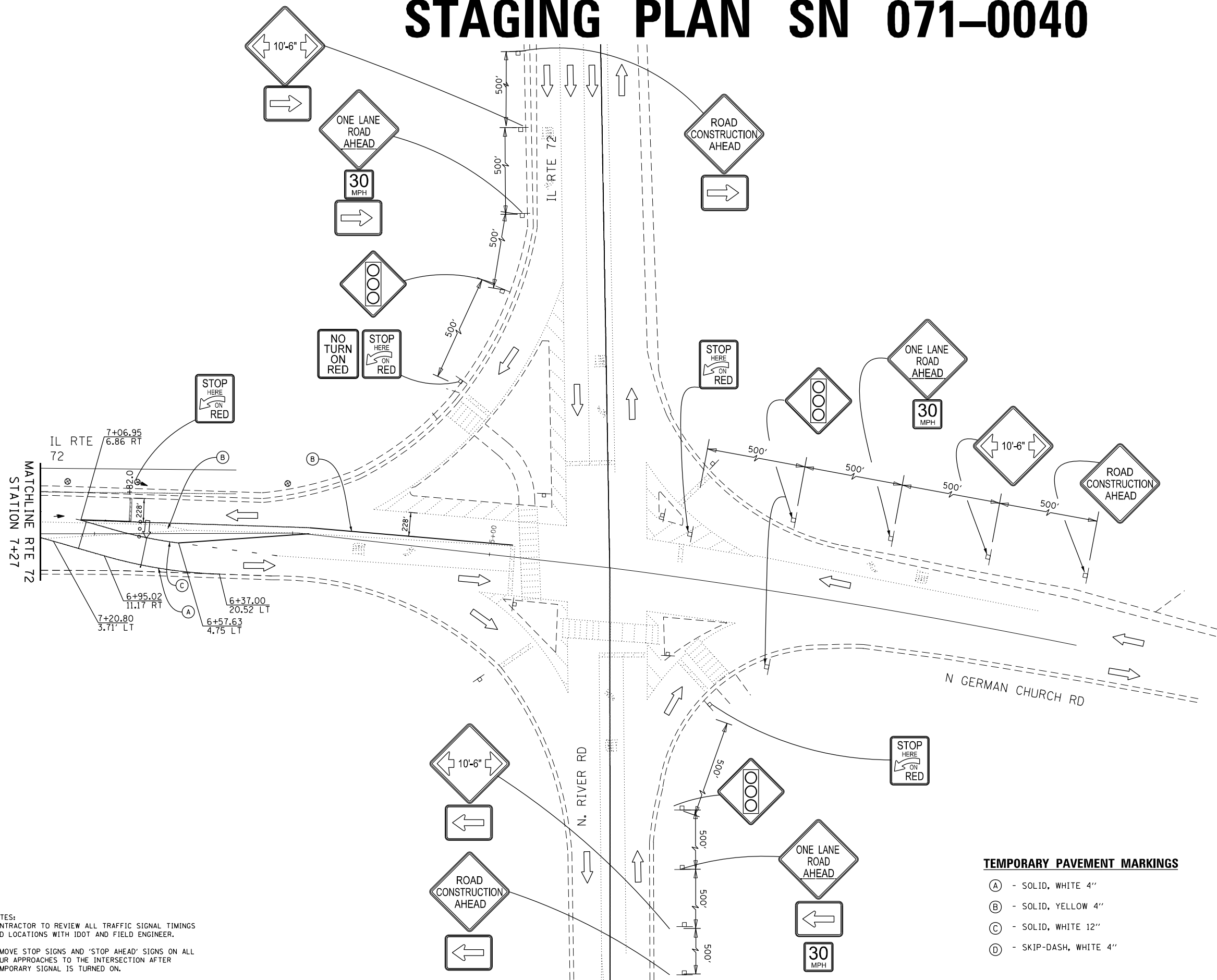
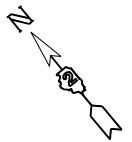

NOTES:
 CONTRACTOR TO REVIEW ALL TRAFFIC SIGNAL TIMINGS
 AND LOCATIONS WITH IDOT AND FIELD ENGINEER.
 REMOVE STOP SIGNS AND 'STOP AHEAD' SIGNS ON ALL
 FOUR APPROACHES TO THE INTERSECTION AFTER
 TEMPORARY SIGNAL IS TURNED ON.









- LEGEND**
- WORK ZONE
 - TEMPORARY CONCRETE BARRIER WALL
 - TEMPORARY PAVEMENT MARKING
 - DRUM WITH STEADY BURNING BI-DIRECTIONAL LIGHT (Ø20" C-C UNLESS OTHERWISE NOTED)
 - TYPE III BARRICADE
 - ARROW BOARD
 - IMPACT ATTENUATOR, TEST LEVEL 2, REDIRECTIVE, NARROW
 - TRAFFIC DIRECTION
 - TRAFFIC SIGN
 - EXISTING STOP BAR
- TEMPORARY PAVEMENT MARKINGS**
- (A) - SOLID, WHITE 4"
 - (B) - SOLID, YELLOW 4"
 - (C) - SOLID, WHITE 12"
 - (D) - SKIP-DASH, WHITE 4"

MODEL: Default
 FILE: \\nafe.pw.bea.fwy.com\P\IDOT\Documents\IDOT_Offices\Director_2\Projects\Operations\Bridges_Section\071-0040\64R38\CADD\64R38-516-cover.dgn

	USER NAME = drossod	DESIGNED - _____	REVISED - _____	STATE OF ILLINOIS DEPARTMENT OF TRANSPORTATION	STAGING PLAN SN 071-0040	F.A.P. RTE. 742 & 553	SECTION (378R-2)BP & (119B-1)BP	COUNTY OGLE	TOTAL SHEETS 12	SHEET NO. 11	
	PLOT SCALE = 40,0000' +/- in.	CHECKED - _____	REVISED - _____			CONTRACT NO. 64R38					
	PLOT DATE = Feb-01-2022 01:55:02 PM	DATE - _____	REVISED - _____			ILLINOIS FED. AID PROJECT					

TEMPORARY TRAFFIC SIGNAL INSTALLATION PLAN SN 071-0040

LEGEND

-  - TEMPORARY CONTROLLER WITH UPS
-  - TEMPORARY WOOD OR GROUND-MOUNTED METAL POST
-  - TEMPORARY SIGNAL HEAD
-  - AERIAL CABLE
-  - VIDEO DETECTION CAMERA
-  - SERVICE INSTALLATION - POLE MOUNTED
-  - PEDESTRIAN SIGNAL HEAD
-  - PEDESTRIAN PUSHBUTTON

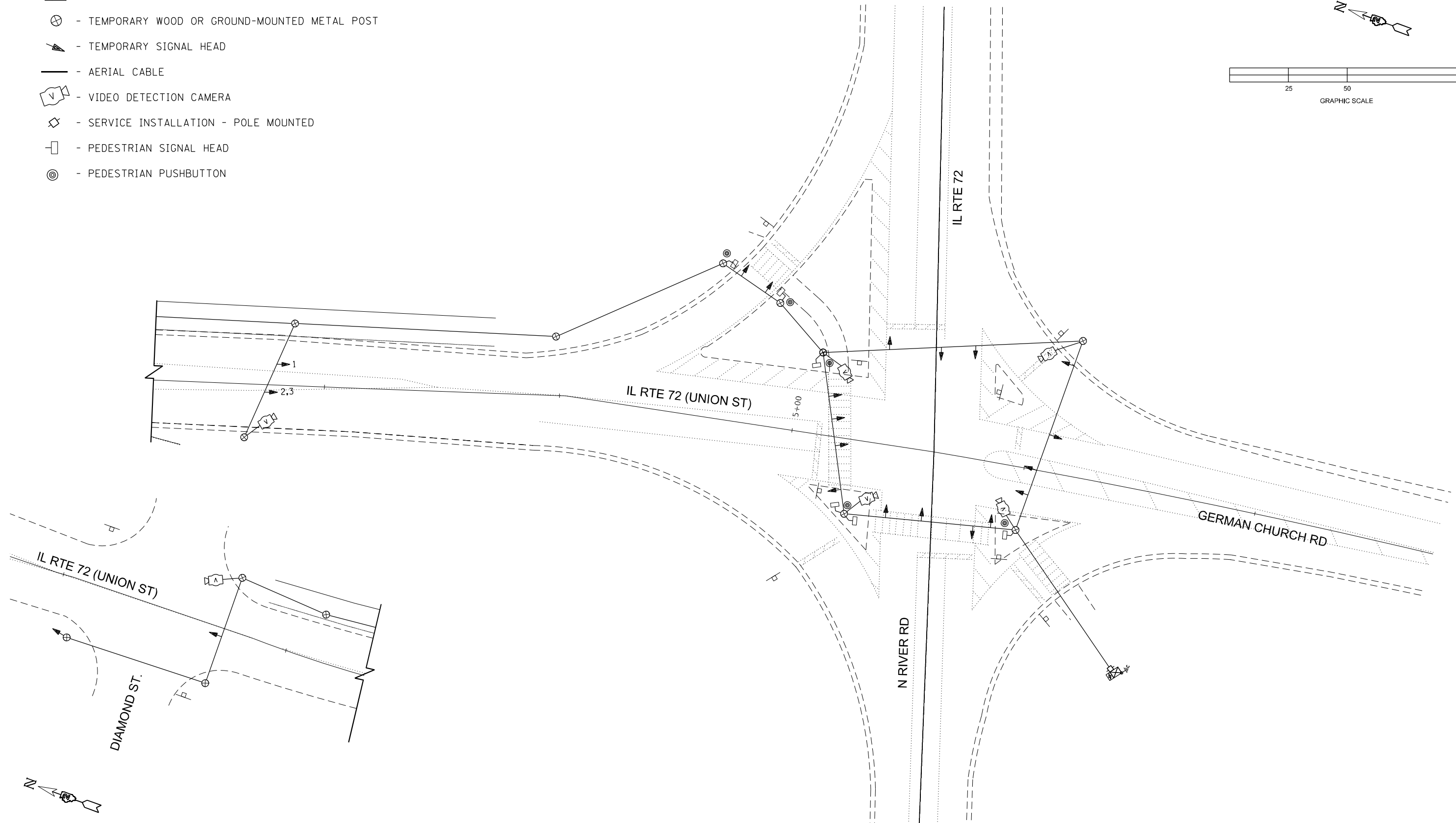
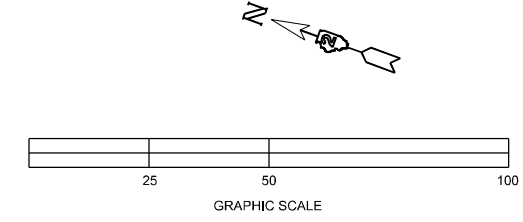

MODEL: Default
 FILE: \\naulc-pw-bentley.com\P\DOT\Documents\DOT Office\Director_2\Project\Operations\Bridg Section\071-0040\64R38\CADD\64R38-511-cover.dgn

USER NAME = dlossdd	DESIGNED - _____	REVISED - _____
PLOT SCALE = 40,0000 * / in.	DRAWN - _____	REVISED - _____
PLOT DATE = Feb-01-2022 01:56:07 PM	CHECKED - _____	REVISED - _____
	DATE - _____	REVISED - _____

STATE OF ILLINOIS
DEPARTMENT OF TRANSPORTATION

TEMPORARY TRAFFIC SIGNAL
INSTALLATION PLAN SN 071-0040

SCALE: _____ SHEET ____ OF ____ SHEETS STA. _____ TO STA. _____

F.A.P. RTE. 742 & 553	SECTION (378R-2)BP & (119B-1)BP	COUNTY OGLE	TOTAL SHEETS 12	SHEET NO. 12
CONTRACT NO. 64R38				
ILLINOIS FED. AID PROJECT				