

STATE OF ILLINOIS
DEPARTMENT OF TRANSPORTATION

F.A.I. RTE.	SECTION	COUNTY	TOTAL SHEETS	SHEET NO.
*	(68-5) RS	MONTGOMERY	30	1
		ILLINOIS	CONTRACT NO. 72M68	

* 55 5 (I 55 E FR RD)

D-96-021-21

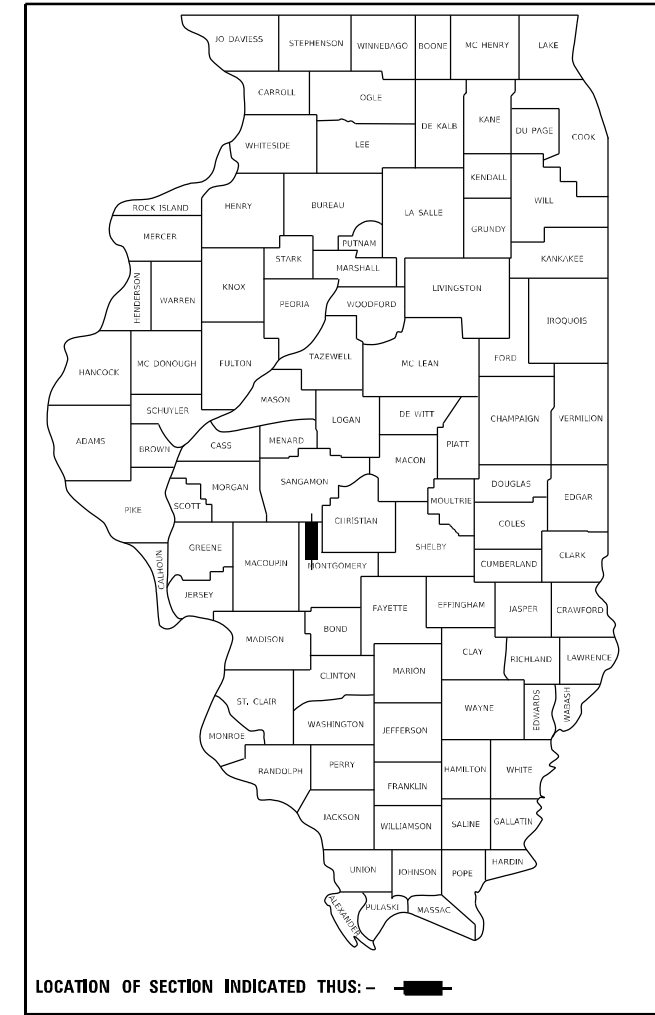

FUNCTIONAL CLASSIFICATION: LOCAL
ADT: 25 (2020)
MU: 4.0%
SU: 8.0%
PV: 88.0%

STATE OF ILLINOIS
DEPARTMENT OF TRANSPORTATION

SUBMITTED February 10 20 22

John P. Myer
REGIONAL ENGINEER

March 25 2022
[Signature]
ENGINEER OF DESIGN AND ENVIRONMENT

March 23 2022
Stephen M. Smith
DIRECTOR OF HIGHWAYS PROJECT IMPLEMENTATION

PRINTED BY THE AUTHORITY
OF THE STATE OF ILLINOIS

PROPOSED HIGHWAY PLANS

FAI ROUTE 55 (I-55 E FRONTAGE ROAD)
SECTION (68-5) RS
AGGREGATE BASE COURSE & CHIP SEAL
MONTGOMERY COUNTY

INDEX OF SHEETS

1	COVER SHEET
2	GENERAL NOTES
3-4	SUMMARY OF QUANTITIES
5-8	SCHEDULE OF QUANTITIES
9-14	TYPICAL SECTIONS
15-26	PLAN SHEETS
27	STAGING PLAN
28-29	BUTT JOINT DETAILS
30	ENTRANCES DETAILS

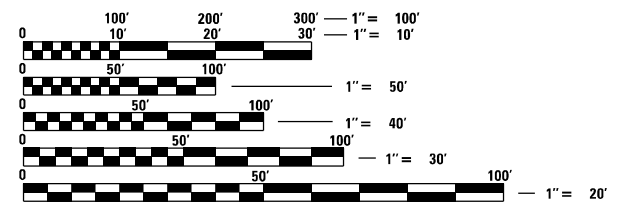
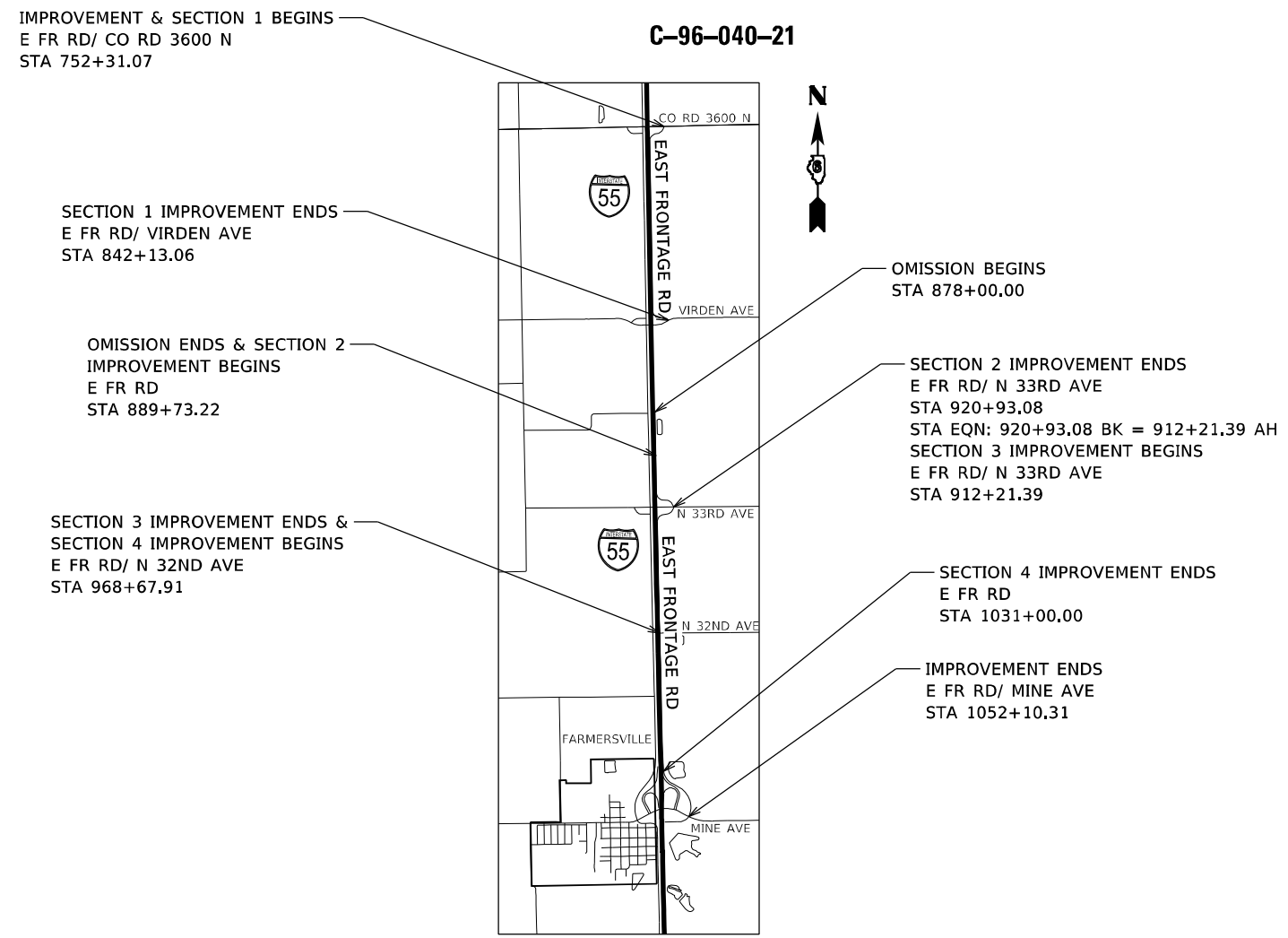

FULL SIZE PLANS HAVE BEEN PREPARED USING STANDARD ENGINEERING SCALES, REDUCED SIZED PLANS WILL NOT CONFORM TO STANDARD SCALES. IN MAKING MEASUREMENTS ON REDUCED PLANS, THE ABOVE SCALES MAY BE USED.

J.U.L.I.E.
JOINT UTILITY LOCATION INFORMATION FOR EXCAVATORS
1-800-892-0123
OR 811

PROJECT ENGINEER: JON KELLEY PH: 217-785-2739
PROJECT MANAGER: CLOYD JACK PH: 217-524-0064

GROSS LENGTH = 27,614.4 FT. = 5.23 MILES
NET LENGTH = 25,520.6 FT. = 4.83 MILE

CONTRACT NO. 72M68

GENERAL NOTES



1. THE CONTRACTOR SHALL NOTIFY THE DISTRICT 6 BUREAU OF OPERATIONS AT (217) 785-5306 THREE WEEKS PRIOR TO IMPLEMENTING ANY TRAFFIC CONTROL.
2. SEAL COAT AGGREGATE MAY BE CA-14, CA-15, CA-16, OR CA-20.
3. ALL AGGREGATE AND ENTRANCE WORK SHALL BE COMPLETE FOR A GIVEN SECTION PRIOR TO ANY BITUMINOUS TREATMENT APPLICATION.

HIGHWAY STANDARDS

001006	DECIMAL OF AN INCH AND OF A FOOT
000001-08	STANDARD SYMBOLS, ABBREVIATIONS, AND PATTERNS
630001-12	STEEL PLATE BEAM GUARDRAIL
630301-09	SHOULDER WIDENING FOR TYPE 1 (SPECIAL) GUARDRAIL TERMINALS
701001-02	OFF-ROAD OPERATIONS, 2L, 2W, MORE THAN 15' AWAY
701006-05	OFF-ROAD OPERATIONS, 2L, 2W, 15' TO 24" FROM PAVEMENT EDGE
701201-05	LANE CLOSURE, 2L, 2W, DAY ONLY, SPEED >= 45 MPH
701301-04	LANE CLOSURE, 2L, 2W, SHORT TIME OPERATIONS
701306-04	LANE CLOSURE, 2L, 2W, SLOW MOVING OPERATIONS DAY ONLY, SPEED >= 45 MPH
701311-03	LANE CLOSURE 2L, 2W MOVING OPERATIONS - DAY ONLY
701901-08	TRAFFIC CONTROL DEVICES
725001-01	OBJECT AND TERMINAL MARKERS
782006-01	GUARDRAIL AND BARRIER WALL REFLECTOR MOUNTING DETAILS
BLR 21-9	TYPICAL APPLICATION OF TRAFFIC CONTROL DEVICES FOR CONSTRUCTION ON RURAL LOCAL HIGHWAYS
BLR 22-7	TYPICAL APPLICATION OF TRAFFIC CONTROL DEVICES FOR CONSTRUCTION ON RURAL LOCAL HIGHWAYS (2L,2W RD CLOSED TO THRU TRAFFIC)
780001-05	TYPICAL PAVEMENT MARKINGS

RATES OF APPLICATION

BITUMINOUS MATERIALS (FOG SEAL): 0.05 LBS/SQ FT
 AGGREGATE BASE COURSE TYPE A: 2.05 TONS/CU YD

STATE OF ILLINOIS DEPARTMENT OF TRANSPORTATION DIVISION OF HIGHWAYS DISTRICT 6	
EXAMINED	January 24, 2022
	
ENGINEER OF OPERATIONS	
EXAMINED	February 9, 2022
	
ENGINEER OF PROJECT IMPLEMENTATION	
EXAMINED	January 27, 2022
	
ENGINEER OF PROGRAM DEVELOPMENT	

REV. - MS

MODEL: D:\p1\...
 FILE: M:\...
 PROJECT: ...

USER NAME = pasleyb	DESIGNED -	REVISED -
	DRAWN -	REVISED -
PLOT SCALE = 100.0000' / in.	CHECKED -	REVISED -
PLOT DATE = 2/9/2022	DATE -	REVISED -

**STATE OF ILLINOIS
DEPARTMENT OF TRANSPORTATION**

GENERAL NOTES

SCALE: SHEET OF SHEETS STA. TO STA.

F.A.I. RTE.	SECTION	COUNTY	TOTAL SHEETS	SHEET NO.
*	(68-5) RS	MONTGOMERY	30	2
			CONTRACT NO. 72M68	
		ILLINOIS FED. AID PROJECT		

*FAI 55 5 (I 55 E FR RD)

CODE	ITEM	UNIT	TOTAL	6-65720-0000	6-65740-0000
				100% STATE	100% STATE
				FRONTAGE ROAD	FRONTAGE ROAD
				0005	0005
				RURAL	RURAL
35100100	AGGREGATE BASE COURSE, TYPE A	TON	13094	5069	8025
40600982	HOT-MIX ASPHALT SURFACE REMOVAL - BUTT JOINT	SQ YD	1460	493	967
40600990	TEMPORARY RAMP	SQ YD	327	123	204
42300400	PORTLAND CEMENT CONCRETE DRIVEWAY PAVEMENT, 8 INCH	SQ YD	199	147.3	51.7
44000200	DRIVEWAY PAVEMENT REMOVAL	SQ YD	209	157.1	51.9
* 63000001	STEEL PLATE BEAM GUARDRAIL, TYPE A - 6 FOOT POSTS	FOOT	125	125	
* 63100167	TRAFFIC BARRIER TERMINAL, TYPE 1 (SPECIAL TANGENT)	EACH	2		2
63200310	GUARDRAIL REMOVAL	FOOT	225		225
67000400	ENGINEER'S FIELD OFFICE, TYPE A	CAL MO	12	4	8
67100100	MOBILIZATION	L SUM	1	0.3	0.7
70100450	TRAFFIC CONTROL AND PROTECTION, STANDARD 701201	L SUM	1	0.3	0.7
70100460	TRAFFIC CONTROL AND PROTECTION, STANDARD 701306	L SUM	1	0.3	0.7
70107025	CHANGEABLE MESSAGE SIGN	CAL DA	188		188
72501000	TERMINAL MARKER - DIRECT APPLIED	EACH	2		2
* 78001120	PAINT PAVEMENT MARKING - LINE 5"	FOOT	6517	2245	4272

* SPECIALTY ITEM

REV. - MS

MODEL: Default
 FILE: M:\MSA\Projects\72M68\CADD\Drawings\DOT\Office\Drawings\6\Projects\72M68\CADD\Drawings\72M68-shs-SOG.dgn

USER NAME = pasleye	DESIGNED -	REVISED -	STATE OF ILLINOIS DEPARTMENT OF TRANSPORTATION	SUMMARY OF QUANTITIES			F.A.I RTE.	SECTION	COUNTY	TOTAL SHEETS	SHEET NO.		
PLOT SCALE = 100.0000' / in.	DRAWN -	REVISED -		SCALE:	SHEET 1	OF 2	SHEETS	STA.	TO STA.	(68-5) R5	MONTGOMERY	30	3
PLOT DATE = 2/9/2022	CHECKED -	REVISED -								CONTRACT NO. 72M68			
	DATE -	REVISED -								ILLINOIS FED. AID PROJECT			

*FAI 55 5 (I 55 E FR RD)

CODE	ITEM	UNIT	TOTAL	CONSTRUCTION CODE	
				100% STATE	100% STATE
				FRONTAGE ROAD	FRONTAGE ROAD
				0005	0005
				RURAL	RURAL
* 78001180	PAINT PAVEMENT MARKING - LINE 24"	FOOT	41		41
78200005	GUARDRAIL REFLECTORS, TYPE A	EACH	5		5
X0300010	BITUMINOUS MATERIALS (FOG SEAL)	POUND	20969	8234	12735
X1500005	BITUMINOUS SURFACE TREATMENT, A2	SQ YD	39960	18297	21663
X1500004	BITUMINOUS SURFACE TREATMENT, A1	SQ YD	6611		6611
X7011800	TRAFFIC CONTROL AND PROTECTION, STANDARD BLR 21	L SUM	1	0.3	0.7
X7011801	TRAFFIC CONTROL AND PROTECTION, STANDARD BLR 22	L SUM	1	0.3	0.7

* SPECIALTY ITEM

REV. - MS

MODEL: Default
 FILE: M:\MSR_Plan\11800-21663.dwg
 PROJECT: \DOT\Projects\11800-21663\11800-21663.dwg
 USER: pasleyo

USER NAME = pasleyo	DESIGNED -	REVISED -	STATE OF ILLINOIS DEPARTMENT OF TRANSPORTATION	SUMMARY OF QUANTITIES				F.A.I RTE.	SECTION	COUNTY	TOTAL SHEETS	SHEET NO.	
PLOT SCALE = 100.0000' / in.	DRAWN -	REVISED -		SCALE:	SHEET 2	OF 2	SHEETS	STA.	TO STA.	(68-5) R5	MONTGOMERY	30	4
PLOT DATE = 2/9/2022	CHECKED -	REVISED -								CONTRACT NO. 72M68			
	DATE -	REVISED -								ILLINOIS FED. AID PROJECT			

*FAI 55 5 (I 55 E FR RD)

X1500004 - BITUMINOUS SURFACE TREATMENT, A1					
STATION		STATION	LENGTH (FT)	WIDTH (FT)	QUANTITY (SQ YD)
STA 1024+11.91	TO	STA 1050+65.00	2653.1	20	5896
STA 1050+65.00	TO	STA 1052+10.31	145.3	VARIABLE	714
TOTAL:					6610.08
USE:					6611

X1500005 - BITUMINOUS TREATMENT, A2					
STATION		STATION	LENGTH (FT)	WIDTH (FT)	QUANTITY (SQ YD)
STA 752+31.07	TO	STA 753+11.07	80	VARIABLE	270.5
STA 753+11.07	TO	STA 842+13.06	8902	18	17804.0
STA 841+33.06	TO	STA 842+13.06	80	VARIABLE	222.5
STA 889+73.22	TO	STA 920+13.08	3039.9	20	6755.2
STA 920+13.08	TO	STA 920+93.08	80	VARIABLE	187.7
STA EQN: 920+93.08 BK = 912+21.39					
STA 912+31.92	TO	STA 913+11.92	80	VARIABLE	241.0
STA 913+11.92	TO	STA 922+01.02	889.1	20	1975.8
STA 968+67.91	TO	STA 1024+11.91	5544	20	12320.0
STA 969+70.27 @ CO RD 3200 N			80	VARIABLE	183
TOTAL:					39959.56
USE:					39960

X0300010 - BITUMINOUS MATERIALS (FOG SEAL)							
BITUMINOUS MATERIALS FOG SEAL: .05 LBS/SQ FT							
STATION		STATION	LENGTH (FT)	WIDTH (FT)	AREA (SQ FT)	TREATMENT	QUANTITY (POUND)
STA 752+31.07	TO	STA 753+11.07	80.0	VARIABLE	2434.7	DESIGNED OVERLAY (A-2)	121.7
STA 753+11.07	TO	STA 842+13.06	8902.0	18	160236	DESIGNED OVERLAY (A-2)	8011.8
STA 841+33.06	TO	STA 842+13.06	80.0	VARIABLE	2002.3	DESIGNED OVERLAY (A-2)	100.1
STA 889+73.22	TO	STA 922+01.02	3227.8	20	64556	DESIGNED OVERLAY (A-2)	3227.8
STA 920+13.08	TO	STA 920+93.08	80.0	VARIABLE	1689.6	DESIGNED OVERLAY (A-2)	84.5
STA EQN: 920+93.08 BK = 912+21.39							
STA 912+31.92	TO	STA 913+11.92	80.0	VARIABLE	2169.1	DESIGNED OVERLAY (A-2)	108.5
STA 913+11.92	TO	STA 922+01.02	889.1	20	17782	DESIGNED OVERLAY (A-2)	889.1
STA 968+67.91	TO	STA 1024+11.91	5544.0	20	110880	DESIGNED OVERLAY (A-2)	5544.0
STA 969+70.27 @ CO RD 3200 N			80.0	VARIABLE	1645.3	DESIGNED OVERLAY (A-2)	82.3
STA 1024+11.91	TO	STA 1052+10.31	2798.4	20	55968	(A-1)	2798.4
TOTAL:							20968.1
USE:							20969

MODEL: C:\pilot\helen\helenley.com\PWIDOT\Documents\DOT Offices\Dist\rt_6\Project\SD672\68\CADData\CADsheets\672\68-sh-schedule.dgn
 FILE NAME: pw:\helen\helenley.com\PWIDOT\Documents\DOT Offices\Dist\rt_6\Project\SD672\68\CADData\CADsheets\672\68-sh-schedule.dgn

USER NAME = pasleyo	DESIGNED -	REVISED -
	DRAWN -	REVISED -
PLOT SCALE = 99.9495' / in.	CHECKED -	REVISED -
PLOT DATE = 2/9/2022	DATE -	REVISED -

**STATE OF ILLINOIS
DEPARTMENT OF TRANSPORTATION**

SCHEDULE OF QUANTITIES

SCALE: SHEET 2 OF 4 SHEETS STA. TO STA.

F.A.I RTE.	SECTION	COUNTY	TOTAL SHEETS	SHEET NO.
*	(68-5) R5	MONTGOMERY	30	6
CONTRACT NO. 72M68				
ILLINOIS FED. AID PROJECT				

*FAI 55 5 (I 55 E FR RD)

78001120 - PAINT PAVEMENT MARKING - LINE 5"				
YELLOW SKIP DASH CENTERLINE				
STATION		STATION	LENGTH (FOOT)	QUANTITY (FOOT)
STA 752+31.07	TO	STA 842+13.06	8982.0	2245
STA 889+73.22	TO	STA 920+81.81	3108.6	777
STA 912+31.92	TO	STA 1052+10.31	13978.4	3495
TOTAL:				6517

78001180-PAINT PAVEMENT MARKING - LINE 24"		
STOP BARS		
STATION	LENGTH (FT)	QUANTITY (FOOT)
STA 1051+83.51	26	26
STA 1051+84.91	15	15
TOTAL:		41

GUARDRAIL REPLACEMENT SCHEDULE						
LOCATION			63000001	63100167	63200310	78200005
STATION	TO	STATION	STEEL PLATE BEAM GUARDRAIL, TYPE A 6 FOOT POSTS	TRAFFIC BARRIER TERMINAL, TYPE 1 (SPECIAL TANGENT)	GUARDRAIL REMOVAL	GUARDRAIL REFLECTORS, TYPE A - BIDIRECTIONAL
			FOOT	EACH	FOOT	EACH
818+27.0	LT -	818+77.0	LT	1	50	1.0
818+77.0	LT -	820+00.0	LT	125.0	125.0	3.0
820+00.0	LT -	820+50.0	LT	1.0	50.0	1.0
TOTALS			125	2	225	5

40600982- HOT-MIX ASPHALT SURFACE REMOVAL - BUTT JOINT						
STATION		STATION	LENGTH (FT)	WIDTH (FT)	DEPTH (IN)	QUANTITY (SQ YD)
STA 752+31.07	TO	STA 753+11.07	80	VARIABLE	4	271
STA 841+33.06	TO	STA 842+13.06	80	VARIABLE	4	222
STA 889+73.22	TO	STA 890+53.22	80	20	4	178
STA 920+13.08	TO	STA 920+93.08	80	VARIABLE	4	188
STA EQN: 920+93.08 BK = 912+21.39						
STA 912+31.92	TO	STA 913+11.92	80	VARIABLE	4	241
STA 969+70.27 @ CO RD 3200 N			80	VARIABLE	4	183
STA 1023+31.91	TO	STA 1024+11.91	80	20	4	178
TOTAL:						1460

40600990- TEMPORARY RAMP				
TAPER RATE: 1:40				
STATION	LENGTH (FT)	WIDTH (FT)	DEPTH (IN)	QUANTITY (SQ YD)
STA 753+11.07	13.3	VARIABLE	4	24
STA 841+33.06	13.3	VARIABLE	4	23
STA 889+73.22	13.3	20	4	30
STA 920+13.08	13.3	VARIABLE	4	26
STA EQN: 920+93.08 BK = 912+21.39				
STA 913+11.92	13.3	VARIABLE	4	29
STA 969+70.27 @ CO RD 3200 N	13.3	VARIABLE	4	56
STA 1023+31.91	13.3	20	4	30
SUBTOTAL: FROM ENTRANCE SCHEDULE				110
TOTAL:				327

MODEL: Default
 FILE: M:\M&E -\p\11482-216-berkeley.com\PHWDOT\Documents\DOT Offices\Berkeley -\Projects\0672M68\CADD\DATA\CAD\Notes\0672M68-sh-sch-schedule.dgn

USER NAME = pasleyo	DESIGNED -	REVISED -
	DRAWN -	REVISED -
PLOT SCALE = 100.0000 ' / in.	CHECKED -	REVISED -
PLOT DATE = 2/9/2022	DATE -	REVISED -

**STATE OF ILLINOIS
DEPARTMENT OF TRANSPORTATION**

SCHEDULE OF QUANTITIES

SCALE: SHEET 3 OF 12 SHEETS STA. TO STA.

F.A.I RTE.	SECTION	COUNTY	TOTAL SHEETS	SHEET NO.
*	(68-5) R5	MONTGOMERY	30	7
CONTRACT NO. 72M68				
ILLINOIS FED. AID PROJECT				

ENTRANCE IMPROVEMENT SCHEDULE FOR RURAL / URBAN "PPP" PROJECTS									
LOCATION	TYPE OF ENTRANCE	EX MATERIAL TYPE	WIDTH	THICKNESS	LENGTH (FROM EDGE OF PVT TO LIMITS OF IMPROVEMENT)	PCC DRIVEWAY PAVEMENT, 8 INCH 42300400	DRIVEWAY PAVEMENT REMOVAL 44000200	AGGREGATE BASE COURSE, TYPE A 35100100	TEMPORARY RAMP 40600990
			FOOT	INCH	FOOT	SQ YD	SQ YD	TON	SQ YD
RT 755+17.03	PE	HMA	48.2	2.5	10	43.2	46.0		20.2
RT 758+57.45	PE	AGG	51	2.5	15			8.2	
LT 770+70.73	FE	AGG	28.9	2.5	8			1.7	
LT 783+04.91	FE	AGG	29.1	2.5	8			1.6	
LT 790+64.60	FE	AGG	27.3	2.5	8			1.6	
LT 798+45.75	FE	AGG	25.4	2.5	8			1.5	
LT 803+54.49	FE	EARTH	23.5	2.5	8			1.2	
LT 805+81.21	PE	CONC	61.2	8	10	52.8	47.0		28.9
LT 806+93.00	FE	EARTH	28	2.5	8			1.6	
LT 809+47.58	FE	EARTH	25.9	2.5	8			1.5	
LT 813+80.00	PE	AGG	43.8	2.5	15			6.8	
LT 815+31.42	PE	CONC	54.3	8	10	51.3	64.1		26.9
LT 822+73.81	PE	AGG	49.2	2.5	15			8.1	
LT 825+31.49	FE	EARTH	34.5	2.5	8			1.4	
LT 829+39.05	FE	EARTH	38.9	2.5	8			1.7	
LT 837+85.23	FE	EARTH	30.1	2.5	8			1.3	
LT 899+23.42	FE	AGG	36.2	2.5	8			1.5	
LT 908+62.67	FE	EARTH	34.3	2.5	8			1.4	
RT 912+91.18	FE	EARTH	21	2.5	8			1.1	
STA EQN 920+93.08 BK = 912+21.39 AH									
LT 920+18.86	FE	AGG	37.3	2.5	8			1.7	
RT 920+24.59	FE	AGG	34	2.5	8			1.4	
LT 943+36.96	FE	AGG	44.4	3	8			2.5	
LT 965+96.25	FE	AGG	32.7	3	8			1.6	
LT 970+58.49	PE	CONC	32	8	10	25.4	25.4		15.0
LT 974+88.25	FE	EARTH	36.2	2.5	8			1.5	
LT 983+37.26	FE	AGG	43.2	2.5	8			2.0	
LT 996+04.15	FE	AGG	48	2.5	8			2.3	
LT 1011+54.25	CE	AGG	65.2	2.5	15			11.9	
LT 1012+51.52	FE	AGG	70.1	2.5	8			3.8	
LT 1014+41.65	PE	HMA	37.5	8	10	26.2	26.2		18.2
LT 1017+13.54	PE	AGG	42	2.5	15			7.7	
LT 1019+72.72	PE	AGG	42.3	2.5	15			8.7	
LT 1022+72.07	PE	AGG	39.6	2.5	15			7.5	
LT 1035+88.24	FE	EARTH							
LT 1040+03.89	PE	AGG							
RT 1040+82.60	FE	AGG							
RT 1043+07.60	CE	CONC							
LT 1046+81.28	FE	AGG							
RT 1046+99.33	CE	CONC							
TOTAL =						199.0	208.8	94.7	109.2
USE:						199	209	95	110

MODEL: D:\default
 FILE: M:\M&E -\p\10468-24\benitey.com\PHWDOT\Documents\DOT Office\Dr\rtf_6\Projects\0672M68\CAD\Drawings\0672M68-sch-schedule.dgn

USER NAME = pasleyo	DESIGNED -	REVISED -	STATE OF ILLINOIS DEPARTMENT OF TRANSPORTATION	SCHEDULE OF QUANTITIES				F.A.I. RTE.	SECTION	COUNTY	TOTAL SHEETS	SHEET NO.	
PLOT SCALE = 100.0000 ' / in.	DRAWN -	REVISED -		SCALE:	SHEET 4	OF 4	SHEETS	STA.	TO STA.	(68-5) R5	MONTGOMERY	30	8
PLOT DATE = 2/9/2022	CHECKED -	REVISED -											
	DATE -	REVISED -											

*FAI 55 5 (I 55 E FR RD) ILLINOIS FED. AID PROJECT

LEGEND

- ① EXIST. AGGREGATE BASE COURSE, TYPE A 7"
- ② EXIST. BITUMINOUS SURFACE TREATMENT, A-3
- ③ PROP. AGGREGATE BASE COURSE, TYPE A 4" & VARIABLE DEPTH
- ④ PROP. AGGREGATE BASE COURSE, TYPE A 3" & VARIABLE DEPTH
- ⑤ PROP. BITUMINOUS SURFACE TREATMENT AND FOG SEAL, A-1
- ⑥ PROP. BITUMINOUS SURFACE TREATMENT AND FOG SEAL, A-2
- ⑦ PROP. PROP. AGGREGATE BASE COURSE, TYPE A (SHOULDER)

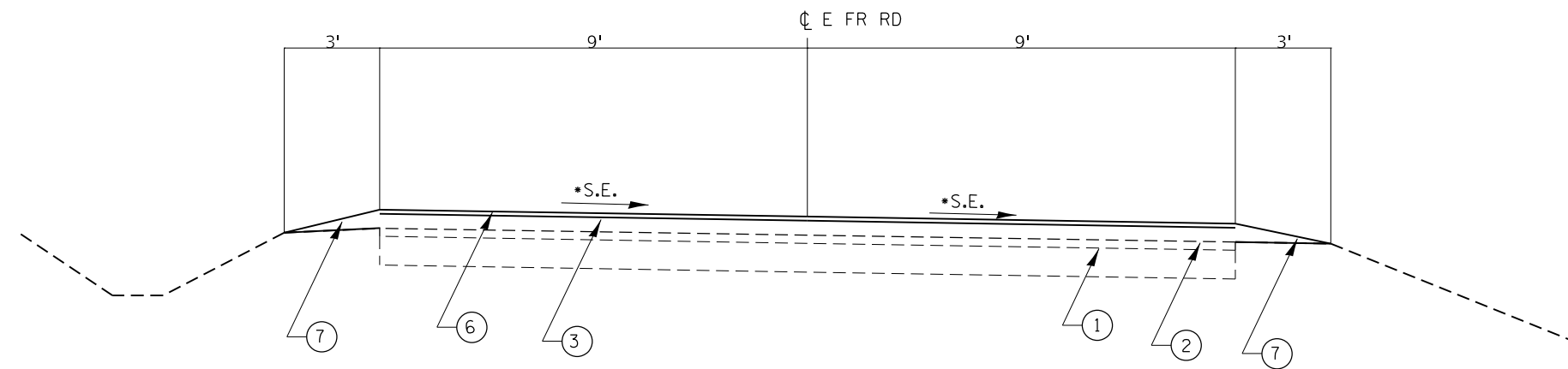

TYPICAL SECTION #1

STA. 752+31.07 TO STA. 755+94.76
 TRANSITION FROM TYP. SEC. #1 @ STA 755+94.76 TO TYP. SEC. #2 @ STA 758+14.17
 STA. 840+27.20 TO STA. 842+13.06
 STA. 916+74.32 TO STA. 920+81.81
 STA EQN: 920+93.08 BK = 912+21.39 AH
 STA. 912+31.92 TO STA. 916+40.65
 TRANSITION FROM TYP. SEC. #1 @ STA 755+94.76 TO TYP. SEC. #2 @ STA 758+14.17

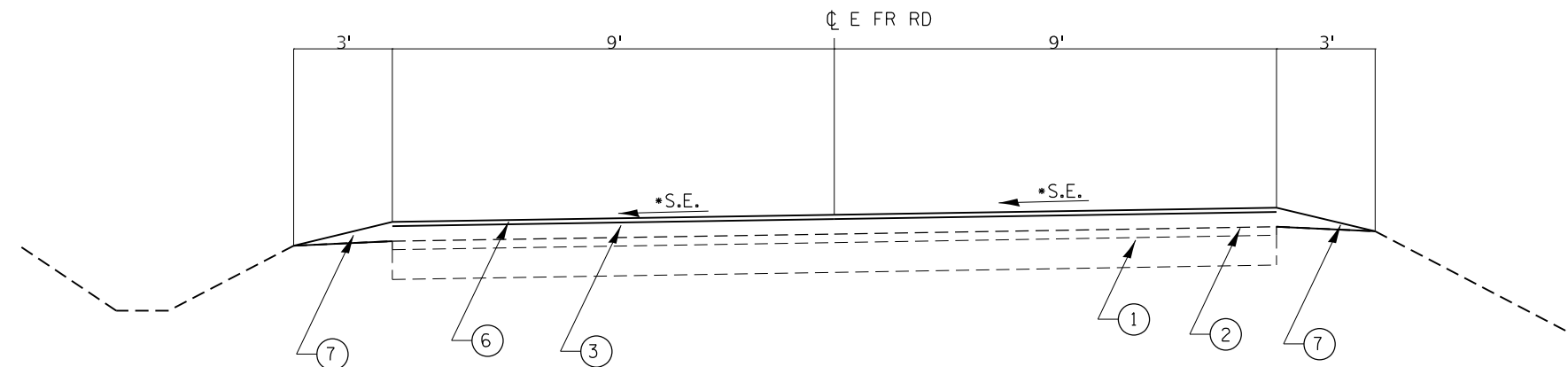

TYPICAL SECTION #2

STA. 758+14.17 TO STA. 761+25.60
 TRANSITION FROM TYP. SEC. #2 @ STA 761+25.60 TO TYP. SEC. #3 @ STA 762+33.60
 STA. 834+01.00 TO STA. 837+61.43
 TRANSITION FROM TYP. SEC. #2 @ STA 837+61.43 TO TYP. SEC. #3 @ STA 838+69.43
 STA. 911+00.32 TO STA. 914+58.08
 TRANSITION FROM TYP. SEC. #2 @ STA 914+58.08 TO TYP. SEC. #1 @ STA 916+74.32

NOTES

- MATCH EXISTING SUPERELEVATION
- PLACE AGG SHOULDER IN SAME LIFT AS AGG BASE COURSE

Model: Default
 File: M:\MSD\p\114826-216\114826-216.dwg
 Project: D:\Projects\114826-216\114826-216.dwg
 User: pasleyo

USER NAME = pasleyo	DESIGNED -	REVISED -	
	DRAWN -	REVISED -	
PLOT SCALE = 40.0000' / in.	CHECKED -	REVISED -	
PLOT DATE = 2/9/2022	DATE -	REVISED -	

**STATE OF ILLINOIS
DEPARTMENT OF TRANSPORTATION**

TYPICAL SECTIONS

SCALE: SHEET 1 OF 6 SHEETS STA. TO STA.

F.A.I. RTE.	SECTION	COUNTY	TOTAL SHEETS	SHEET NO.
*	(68-5) R5	MONTGOMERY	30	9
CONTRACT NO. 72M68				
ILLINOIS FED. AID PROJECT				

*FAI 55 5 (1 55 E FR RD)

LEGEND

- ① EXIST. AGGREGATE BASE COURSE, TYPE A 7"
- ② EXIST. BITUMINOUS SURFACE TREATMENT, A-3
- ③ PROP. AGGREGATE BASE COURSE, TYPE A 4" & VARIABLE DEPTH
- ④ PROP. AGGREGATE BASE COURSE, TYPE A 3" & VARIABLE DEPTH
- ⑤ PROP. BITUMINOUS SURFACE TREATMENT AND FOG SEAL, A-1
- ⑥ PROP. BITUMINOUS SURFACE TREATMENT AND FOG SEAL, A-2
- ⑦ PROP. PROP. AGGREGATE BASE COURSE, TYPE A (SHOULDER)

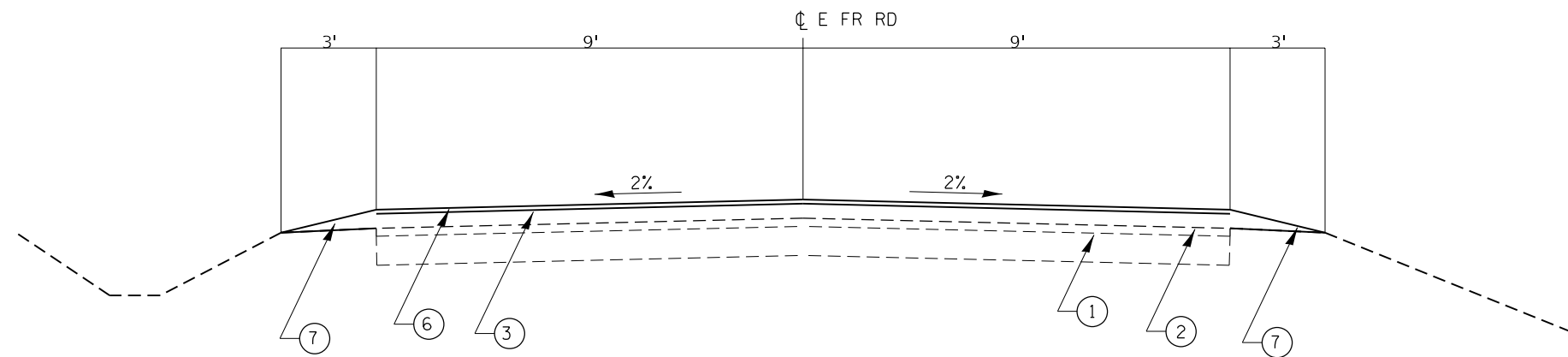

TYPICAL SECTION #3

STA. 762+33.60 TO STA. 832+93.00
 TRANSITION FROM TYP. SEC. #3 @ STA 832+93.00 TO TYP. SEC. #2 @ STA 834+01.00
 STA. 838+69.43 TO STA. 839+19.20
 TRANSITION FROM TYP. SEC. #3 @ STA 839+19.20 TO TYP. SEC. #1 @ STA 840+27.20
 STA. 889+73.22 TO STA. 909+92.32
 TRANSITION FROM TYP. SEC. #3 @ STA 909+92.32 TO TYP. SEC. #2 @ STA 911+00.32
 STA. 968+67.91 TO STA. 1024+11.91

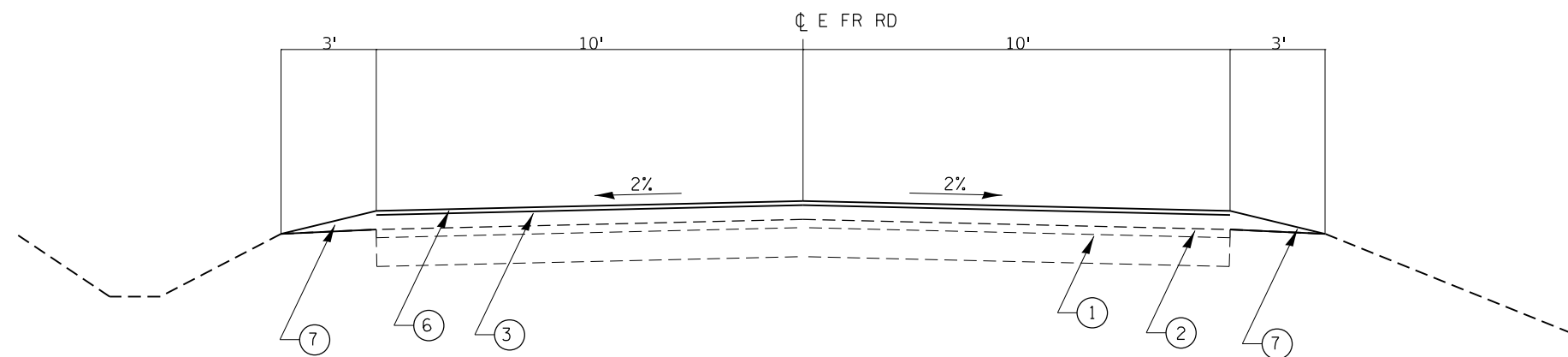

TYPICAL SECTION #4

STA. 889+73.22 TO STA. 909+92.32
 TRANSITION FROM TYP. SEC. #4 @ STA 909+92.32 TO TYP. SEC. #5 @ STA 911+00.32

NOTES

1. PLACE AGG SHOULDER IN SAME LIFT AS AGG SURFACE/BASE COURSE

MODEL: Default
 FILE: M:\MS_E_Producer\sw_bentley.com\PROJECTS\DOT\Office\Bentley_6\Projects\0672M68\CADD\DATA\CAD\Notes\0672M68-shc-typical.dgn

USER NAME = pasleyo	DESIGNED -	REVISED -	
	DRAWN -	REVISED -	
PLOT SCALE = 40,0000' / in.	CHECKED -	REVISED -	
PLOT DATE = 2/9/2022	DATE -	REVISED -	

**STATE OF ILLINOIS
DEPARTMENT OF TRANSPORTATION**

TYPICAL SECTIONS

SCALE: SHEET 2 OF 6 SHEETS STA. TO STA.

F.A.I. RTE.	SECTION	COUNTY	TOTAL SHEETS	SHEET NO.
*	(68-5) R5	MONTGOMERY	30	10
CONTRACT NO. 72M68				
ILLINOIS FED. AID PROJECT				

*FAI 55 5 (1 55 E FR RD)

LEGEND

- ① EXIST. AGGREGATE BASE COURSE, TYPE A 7"
- ② EXIST. BITUMINOUS SURFACE TREATMENT, A-3
- ③ PROP. AGGREGATE BASE COURSE, TYPE A 4" & VARIABLE DEPTH
- ④ PROP. AGGREGATE BASE COURSE, TYPE A 3" & VARIABLE DEPTH
- ⑤ PROP. BITUMINOUS SURFACE TREATMENT AND FOG SEAL, A-1
- ⑥ PROP. BITUMINOUS SURFACE TREATMENT AND FOG SEAL, A-2
- ⑦ PROP. PROP. AGGREGATE BASE COURSE, TYPE A (SHOULDER)

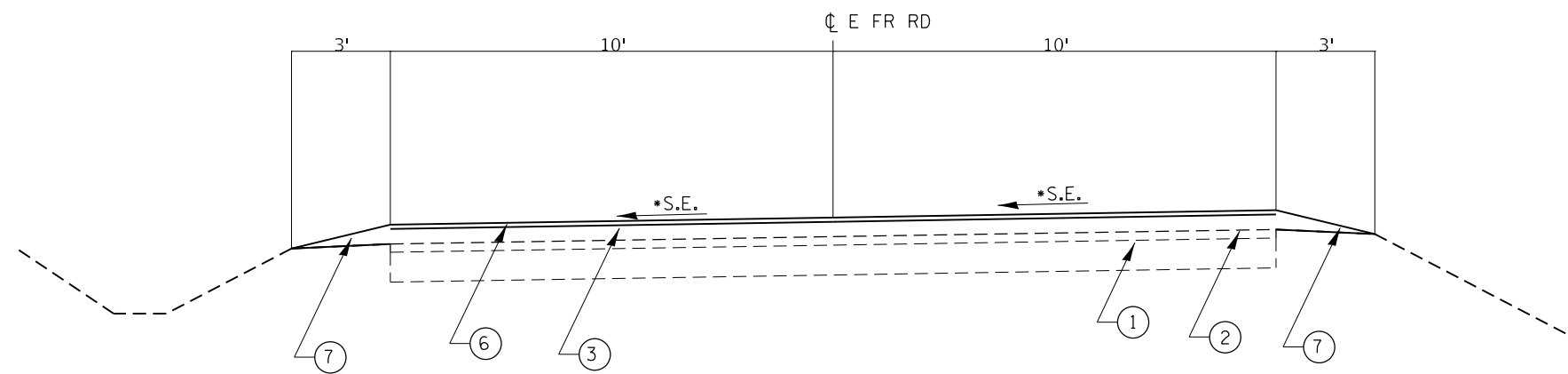

TYPICAL SECTION #5

STA. 911+00.32 TO STA. 914+58.08
 TRANSITION FROM TYP. SEC. #5 @ STA 914+58.08 TO TYP. SEC. #6 @ STA 916+74.32
 STA EQN: 920+93.08 BK = 912+21.39 AH
 STA. 918+57.18 TO STA. 922+01.02

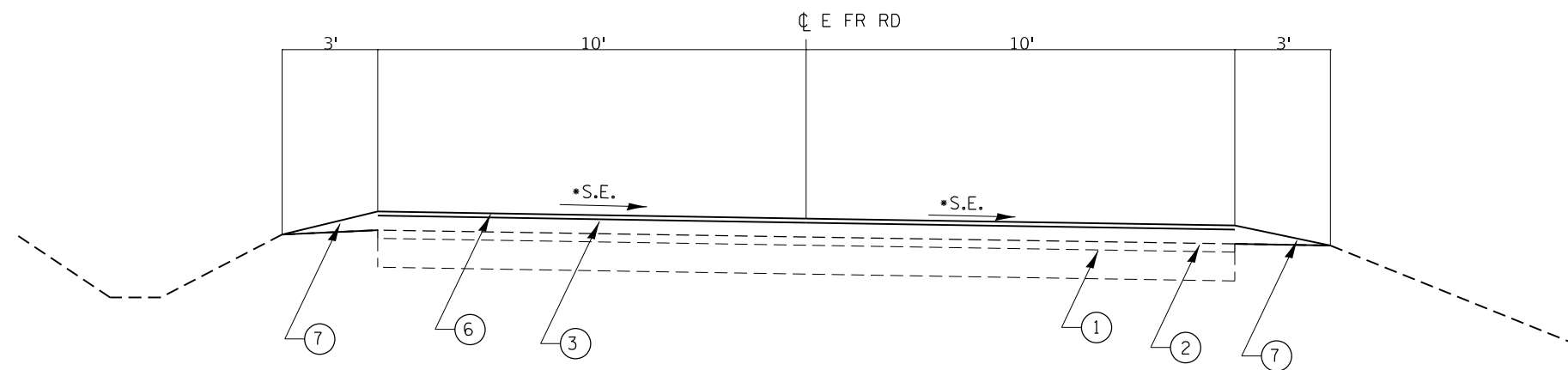

TYPICAL SECTION #6

STA. 916+74.32 TO STA. 920+81.81
 STA EQN: 920+93.08 BK = 912+21.39 AH
 STA. 912+31.92 TO STA. 916+40.65
 TRANSITION FROM TYP. SEC. #6 @ STA 916+40.65 TO TYP. SEC. #5 @ STA 918+57.18

NOTES

- MATCH EXISTING SUPERELEVATION
- PLACE AGG SHOULDER IN SAME LIFT AS AGG BASE COURSE

MODEL: Default
 FILE: \\mame-pc\public\civ\benlley.com\PHWDOT\Documents\DOT Offices\Bentley - 6\Projects\0672M68\CADD\Bentley\0672M68-shc-typical.dgn

USER NAME = pasleyo	DESIGNED -	REVISED -
	DRAWN -	REVISED -
PLOT SCALE = 40.0000' / in.	CHECKED -	REVISED -
PLOT DATE = 2/9/2022	DATE -	REVISED -

**STATE OF ILLINOIS
DEPARTMENT OF TRANSPORTATION**

TYPICAL SECTIONS

SCALE: SHEET 3 OF 6 SHEETS STA. TO STA.

F.A.I RTE.	SECTION	COUNTY	TOTAL SHEETS	SHEET NO.
*	(68-5) R5	MONTGOMERY	30	11
CONTRACT NO. 72M68			ILLINOIS FED. AID PROJECT	

*FAI 55 5 (1 55 E FR RD)

LEGEND

- ① EXIST. AGGREGATE BASE COURSE, TYPE A 7"
- ② EXIST. BITUMINOUS SURFACE TREATMENT, A-3
- ③ PROP. AGGREGATE BASE COURSE, TYPE A 4" & VARIABLE DEPTH
- ④ PROP. AGGREGATE BASE COURSE, TYPE A 3" & VARIABLE DEPTH
- ⑤ PROP. BITUMINOUS SURFACE TREATMENT AND FOG SEAL, A-1
- ⑥ PROP. BITUMINOUS SURFACE TREATMENT AND FOG SEAL, A-2
- ⑦ PROP. PROP. AGGREGATE BASE COURSE, TYPE A (SHOULDER)

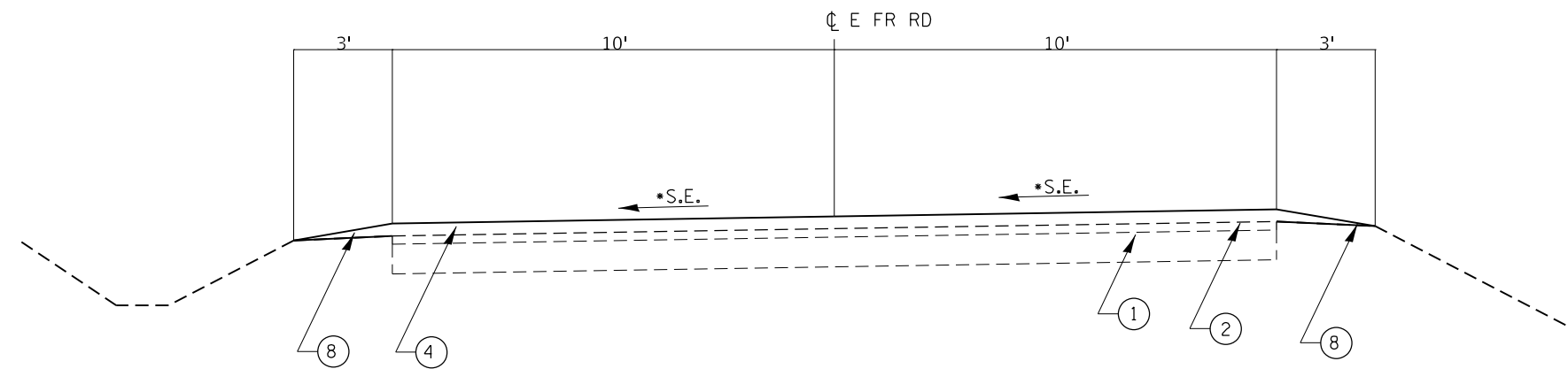

TYPICAL SECTION #7

STA. 922+01.02 TO STA. 922+11.26
 TRANSITION FROM TYP. SEC. #7 @ STA 922+11.26 TO TYP. SEC. #8 @ STA 923+19.26

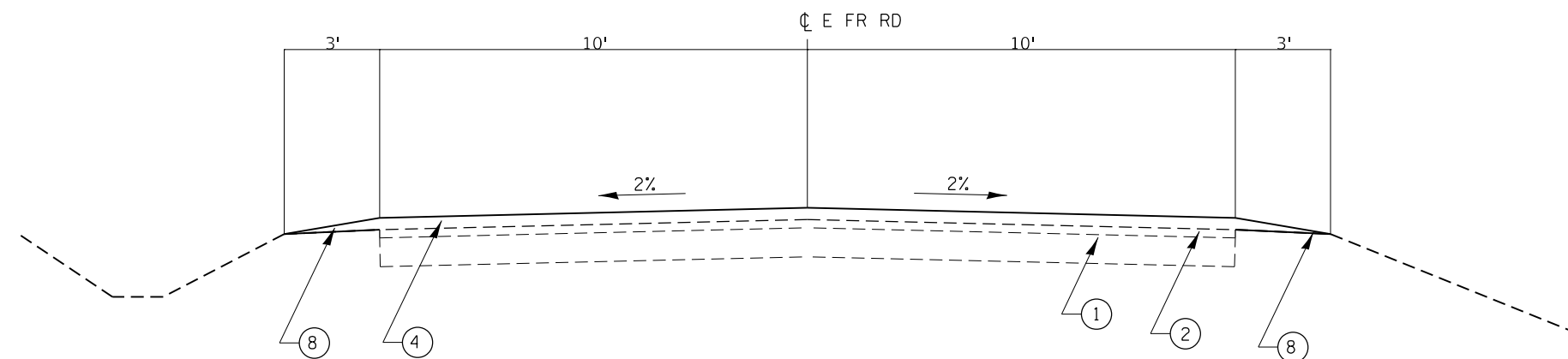

TYPICAL SECTION #8

STA. 923+19.26 TO STA. 968+67.91

NOTES

- MATCH EXISTING SUPERELEVATION
- PLACE AGG SHOULDER IN SAME LIFT AS AGG BASE COURSE

Model: Default
 File: \\mace-prod\laser-civ\benfley.com\PHWDOT\Documents\DOT Offices\Bentley - 6\Projects\DE72M68\CADD\Bentley\DE72M68-shc-typical.dgn

USER NAME = pasleyo	DESIGNED -	REVISED -
	DRAWN -	REVISED -
PLOT SCALE = 40.0000' / in.	CHECKED -	REVISED -
PLOT DATE = 2/9/2022	DATE -	REVISED -

**STATE OF ILLINOIS
DEPARTMENT OF TRANSPORTATION**

TYPICAL SECTIONS

SCALE: SHEET 4 OF 6 SHEETS STA. TO STA.

F.A.I. RTE.	SECTION	COUNTY	TOTAL SHEETS	SHEET NO.
*	(68-5) R5	MONTGOMERY	30	12
CONTRACT NO. 72M68				
		ILLINOIS	FED. AID PROJECT	

*FAI 55 5 (1 55 E FR RD)

LEGEND

- ① EXIST. AGGREGATE BASE COURSE, TYPE A 7"
- ② EXIST. BITUMINOUS SURFACE TREATMENT, A-3
- ③ PROP. AGGREGATE BASE COURSE, TYPE A 4" & VARIABLE DEPTH
- ④ PROP. AGGREGATE BASE COURSE, TYPE A 3" & VARIABLE DEPTH
- ⑤ PROP. BITUMINOUS SURFACE TREATMENT AND FOG SEAL, A-1
- ⑥ PROP. BITUMINOUS SURFACE TREATMENT AND FOG SEAL, A-2
- ⑦ PROP. PROP. AGGREGATE BASE COURSE, TYPE A (SHOULDER)

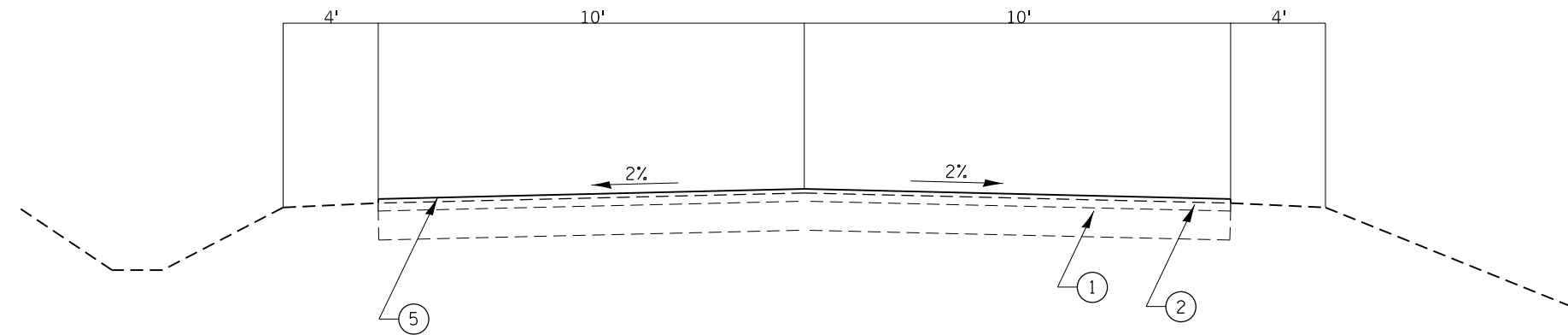

TYPICAL SECTION #9

STA. 1024+11.91 TO STA. 1026+32.81
 TRANSITION FROM TYP. SEC. #9 @ STA 1026+32.81 TO TYP. SEC. #10 @ STA 1027+91.87
 STA. 1035+35.65 TO STA. 1037+15.11
 TRANSITION FROM TYP. SEC. #9 @ STA 1037+15.11 TO TYP. SEC. #11 @ STA 1039+07.11

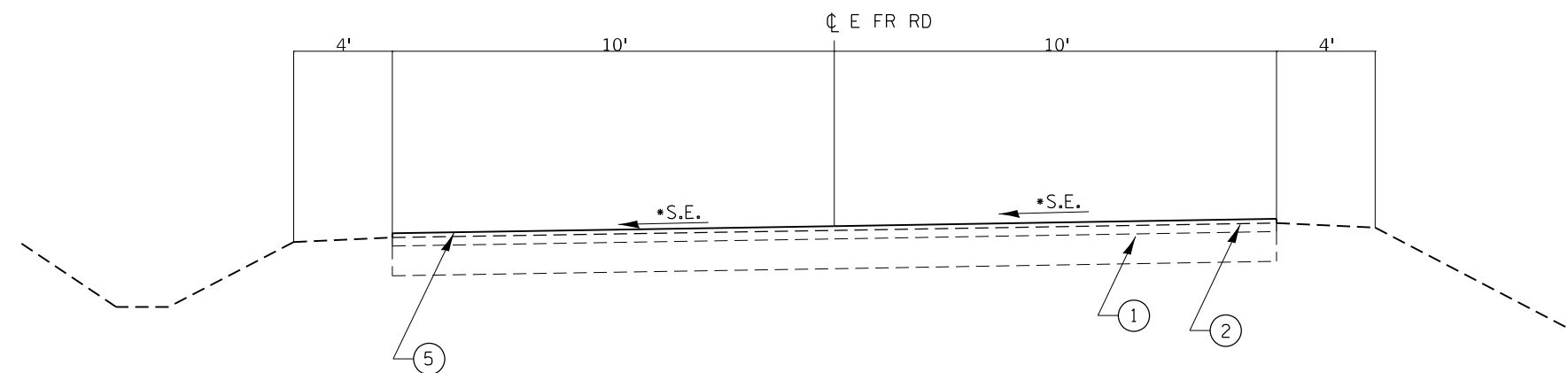

TYPICAL SECTION #10

STA. 1027+91.87 TO STA. 1033+76.75
 TRANSITION FROM TYP. SEC. #10 @ STA 1033+76.75 TO TYP. SEC. #9 @ STA 1035+35.65

NOTES

- MATCH EXISTING SUPERELEVATION
- PLACE AGG SHOULDER IN SAME LIFT AS AGG BASE COURSE

MODEL: Default
 FILE: M:\MS_E_Plan\Ildot-civil\benlley.com\HWIDOT\Documents\DOT Offices\Bentley 6\Projects\0672M68\CADD\Bentley\0672M68-shc-typical.dgn

	USER NAME = pasleyo	DESIGNED -	REVISED -	STATE OF ILLINOIS DEPARTMENT OF TRANSPORTATION	TYPICAL SECTIONS				F.A.I RTE.	SECTION	COUNTY	TOTAL SHEETS	SHEET NO.
		DRAWN -	REVISED -										
	PLOT SCALE = 40.0000' / in.	CHECKED -	REVISED -							(68-5) R5	MONTGOMERY	30	13
	PLOT DATE = 2/9/2022	DATE -	REVISED -			SCALE:	SHEET 5	OF 6	SHEETS	STA.	TO STA.	CONTRACT NO. 72M68	
										ILLINOIS FED. AID PROJECT		*FAI 55 5 (1 55 E FR RD)	

LEGEND

- ① EXIST. AGGREGATE BASE COURSE, TYPE A 7"
- ② EXIST. BITUMINOUS SURFACE TREATMENT, A-3
- ③ PROP. AGGREGATE BASE COURSE, TYPE A 4" & VARIABLE DEPTH
- ④ PROP. AGGREGATE BASE COURSE, TYPE A 3" & VARIABLE DEPTH
- ⑤ PROP. BITUMINOUS SURFACE TREATMENT AND FOG SEAL, A-1
- ⑥ PROP. BITUMINOUS SURFACE TREATMENT AND FOG SEAL, A-2
- ⑦ PROP. PROP. AGGREGATE BASE COURSE, TYPE A (SHOULDER)

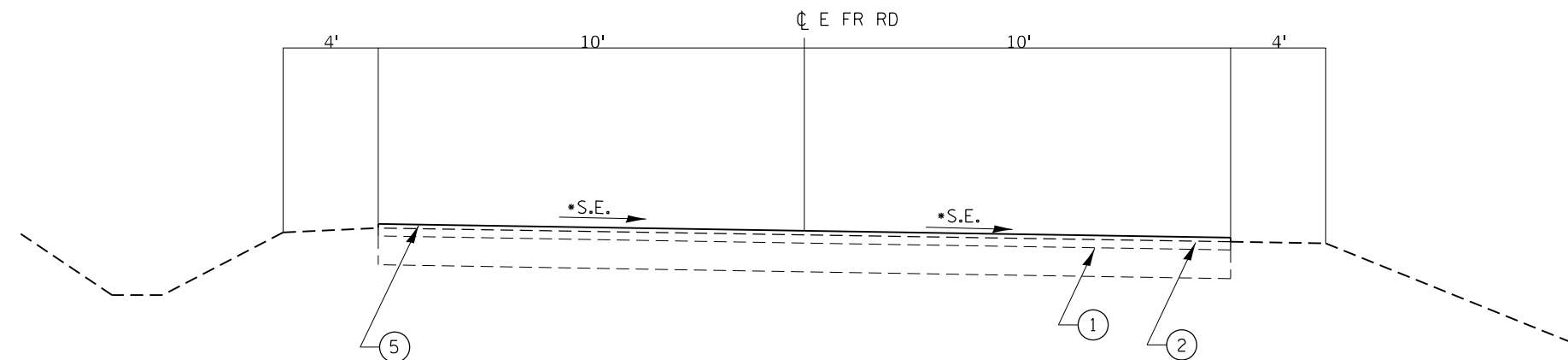

TYPICAL SECTION #11

STA. 1039+07.11 TO STA. 1052+10.31

NOTES

- MATCH EXISTING SUPERELEVATION
- PLACE AGG SHOULDER IN SAME LIFT AS AGG BASE COURSE

MODEL: Default
 FILE: M:\MS_E_Plan\Roads\sw_bentley.com\PROJECTS\DOT Offices\Bentley_6\Projects\0672M68\CAD\DATA\CAD\Layers\0672M68-shc-typical.dgn

USER NAME = pasleyo	DESIGNED -	REVISED -
	DRAWN -	REVISED -
PLOT SCALE = 40.0000 ' / in.	CHECKED -	REVISED -
PLOT DATE = 2/9/2022	DATE -	REVISED -

**STATE OF ILLINOIS
DEPARTMENT OF TRANSPORTATION**

TYPICAL SECTIONS

SCALE: SHEET 6 OF 6 SHEETS STA. TO STA.

F.A.I. RTE.	SECTION	COUNTY	TOTAL SHEETS	SHEET NO.
*	(68-5) R5	MONTGOMERY	30	14
CONTRACT NO. 72M68				
		ILLINOIS	FED. AID PROJECT	

*FAI 55 5 (I 55 E FR RD)

HMA SURFACE REMOVAL - BUTT JOINT

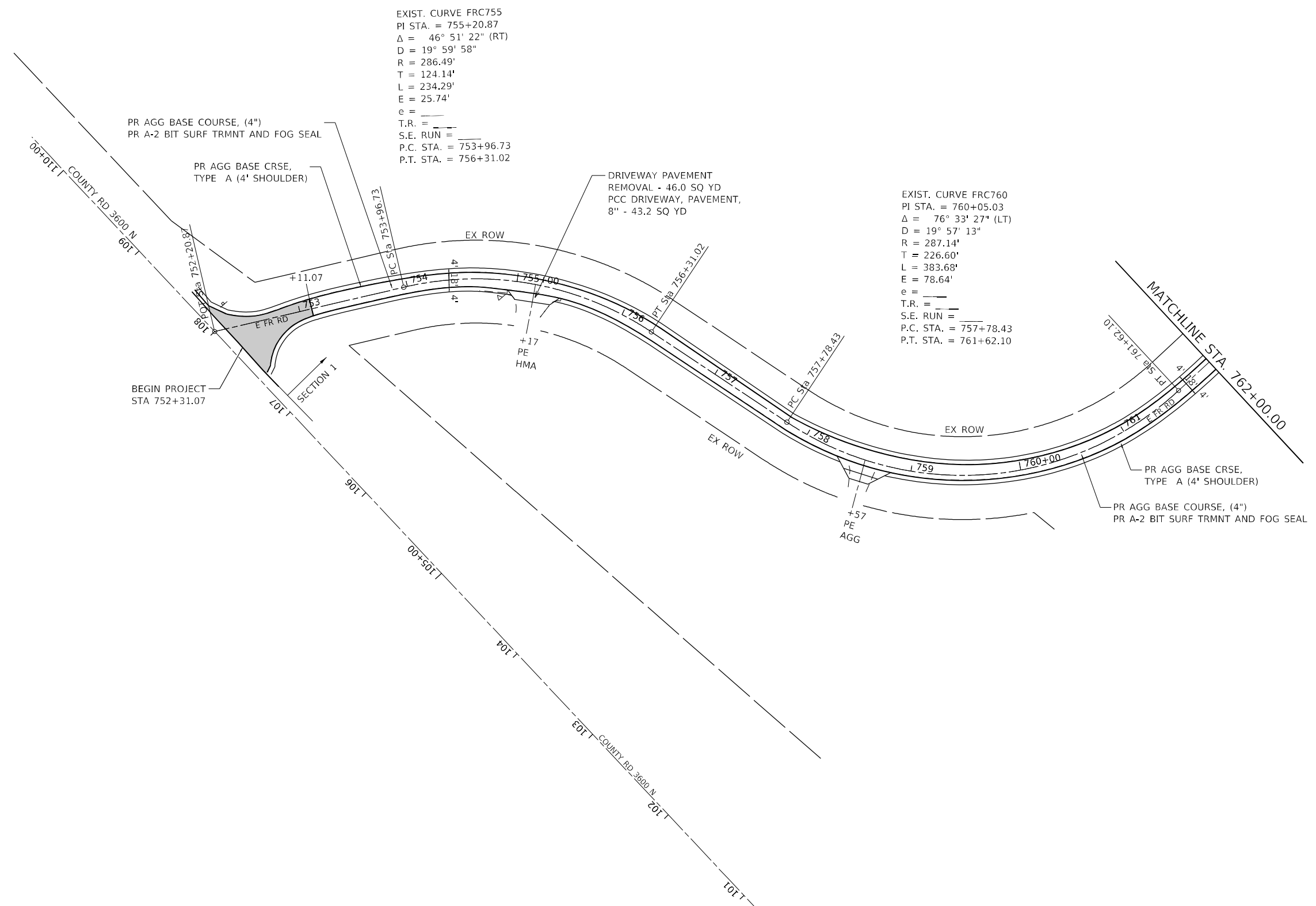
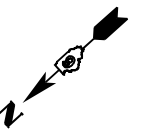

EXIST. CURVE FRC755
 PI STA. = 755+20.87
 $\Delta = 46^\circ 51' 22''$ (RT)
 $D = 19^\circ 59' 58''$
 $R = 286.49'$
 $T = 124.14'$
 $L = 234.29'$
 $E = 25.74'$
 $e = \text{---}$
 $T.R. = \text{---}$
 $S.E. RUN = \text{---}$
 $P.C. STA. = 753+96.73$
 $P.T. STA. = 756+31.02$

EXIST. CURVE FRC760
 PI STA. = 760+05.03
 $\Delta = 76^\circ 33' 27''$ (LT)
 $D = 19^\circ 57' 13''$
 $R = 287.14'$
 $T = 226.60'$
 $L = 383.68'$
 $E = 78.64'$
 $e = \text{---}$
 $T.R. = \text{---}$
 $S.E. RUN = \text{---}$
 $P.C. STA. = 757+78.43$
 $P.T. STA. = 761+62.10$

MODEL: Default
 FILE: hma15.ctb
 PLOT DATE: 2/9/2022
 PROJECT: I:\Projects\DOT\Projects\DOT - Office\District 6\Projects\DOT\Documents\DOT - Office\District 6\Projects\DOT\72M68\h15.ctb

USER NAME = caraballoj	DESIGNED -	REVISED -
	DRAWN -	REVISED -
PLOT SCALE = 100,0000' / in.	CHECKED -	REVISED -
PLOT DATE = 2/9/2022	DATE -	REVISED -

STATE OF ILLINOIS
DEPARTMENT OF TRANSPORTATION

PLAN SHEET			
SCALE:	SHEET 1	OF 12 SHEETS	STA. TO STA.

F.A.I. RTE.	SECTION	COUNTY	TOTAL SHEETS	SHEET NO.
*	(68-5) RS	MONTGOMERY	30	15
CONTRACT NO. 72M68				
ILLINOIS FED. AID PROJECT				

*FAI 55 5 (I 55 E FR RD)

MATCHLINE STA. 762+00.00

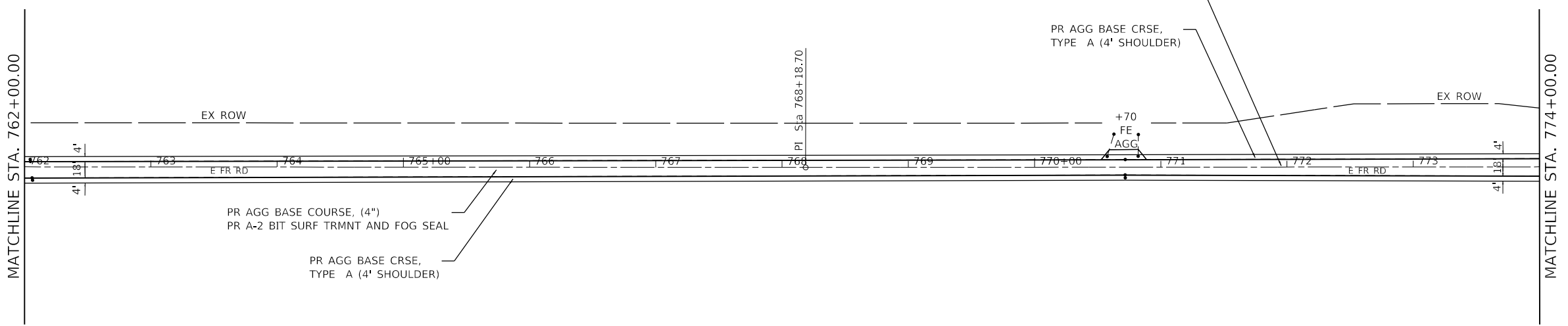

MATCHLINE STA. 774+00.00

MATCHLINE STA. 774+00.00

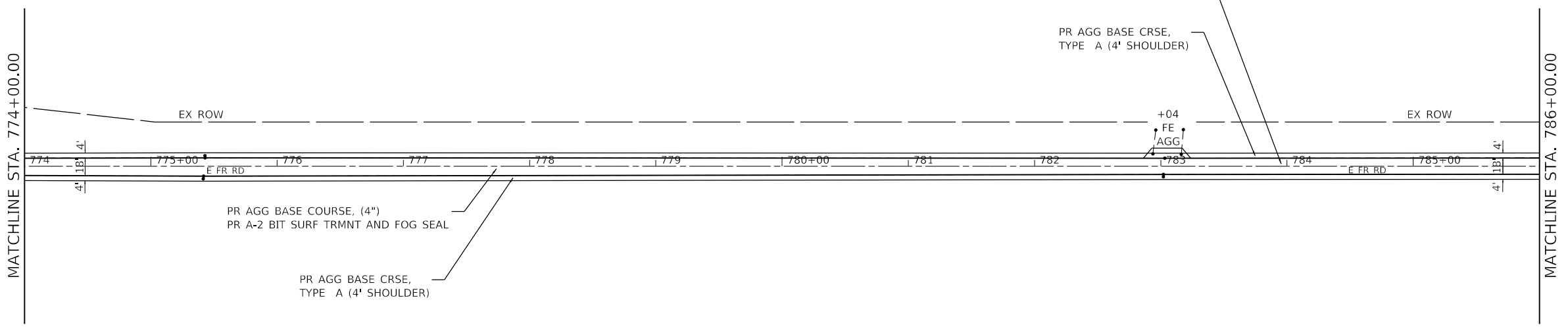

MATCHLINE STA. 786+00.00

MODEL: Default
FILE: MainE:\p\11482-civ\benlley.com\HWIDOT\Documents\DOT Offices\Bentley 6\Projects\DE72M68\CADD\Bentley\DE72M68-shc-plan2.dgn

USER NAME = pasleyo	DESIGNED -	REVISED -
	DRAWN -	REVISED -
PLOT SCALE = 100,0000 ' / in.	CHECKED -	REVISED -
PLOT DATE = 2/9/2022	DATE -	REVISED -

**STATE OF ILLINOIS
DEPARTMENT OF TRANSPORTATION**

PLAN SHEET			
SCALE:	SHEET 2	OF 12 SHEETS	STA. TO STA.

F.A.I. RTE.	SECTION	COUNTY	TOTAL SHEETS	SHEET NO.
*	(68-5) R5	MONTGOMERY	30	16
CONTRACT NO. 72M68				
ILLINOIS FED. AID PROJECT				

*FAI 55 5 (I 55 E FR RD)

MATCHLINE STA. 786+00.00

MATCHLINE STA. 798+00.00

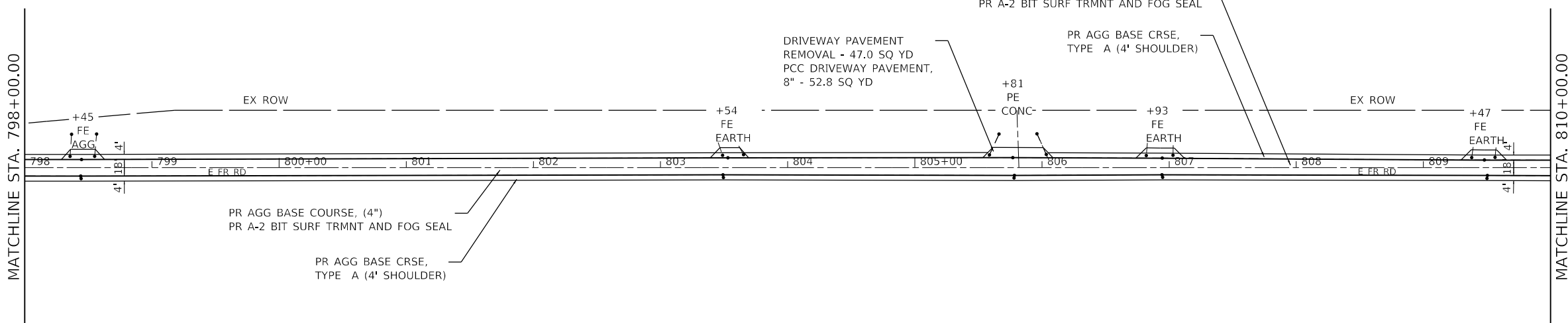
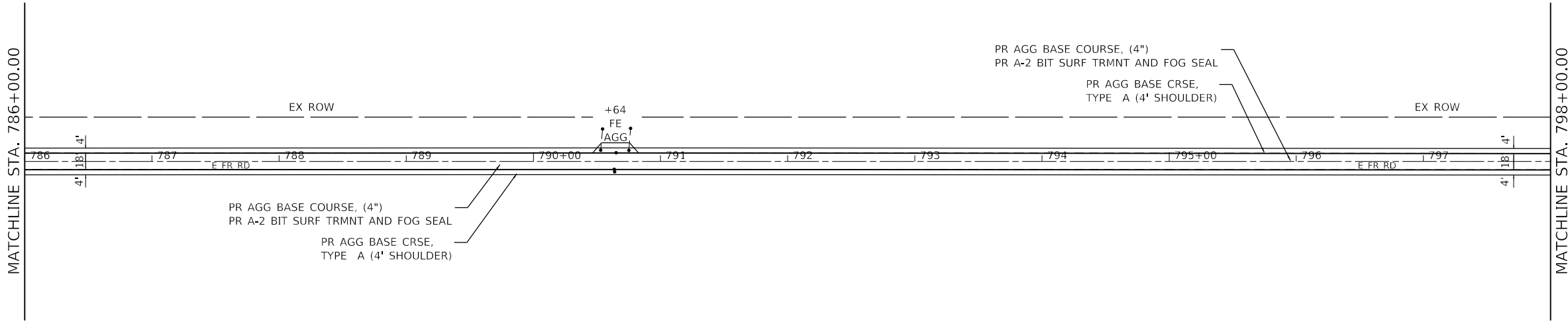

MODEL: Default
 FILE: MainE:proj\illides-civ\benlley.com\HWIDOT\Documents\DOT Offices\Drfrfr: 6\Projects\DE72M68\CADD\Drawings\DE72M68-sh-Plan2.dwg

USER NAME = pasleyo	DESIGNED -	REVISED -
PLOT SCALE = 100.0000' / in.	DRAWN -	REVISED -
PLOT DATE = 2/9/2022	CHECKED -	REVISED -
	DATE -	REVISED -

**STATE OF ILLINOIS
DEPARTMENT OF TRANSPORTATION**

PLAN SHEET			
SCALE:	SHEET 3	OF 12 SHEETS	STA. TO STA.

F.A.I RTE.	SECTION	COUNTY	TOTAL SHEETS	SHEET NO.
*	(68-5) R5	MONTGOMERY	30	17
CONTRACT NO. 72M68				
ILLINOIS FED. AID PROJECT				

*FAI 55 5 (I 55 E FR RD)

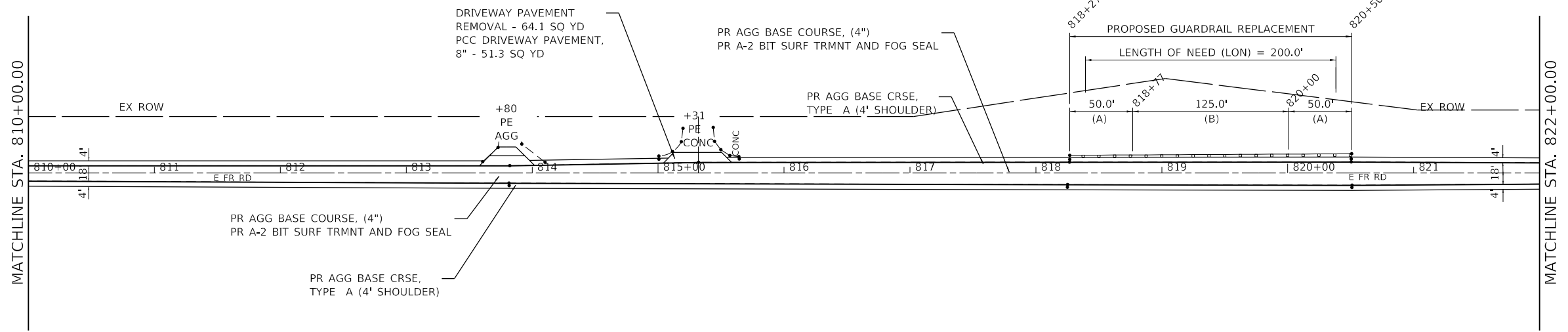

LEGEND

- (A) = PAY LIMITS FOR PROPOSED TRAFFIC BARRIER TERMINAL, TYPE 1 (SPECIAL) TANGENT
- (B) = PAY LIMITS FOR PROPOSED STEEL PLATE BEAM GUARDRAIL, TYPE A, 6 FOOT POSTS

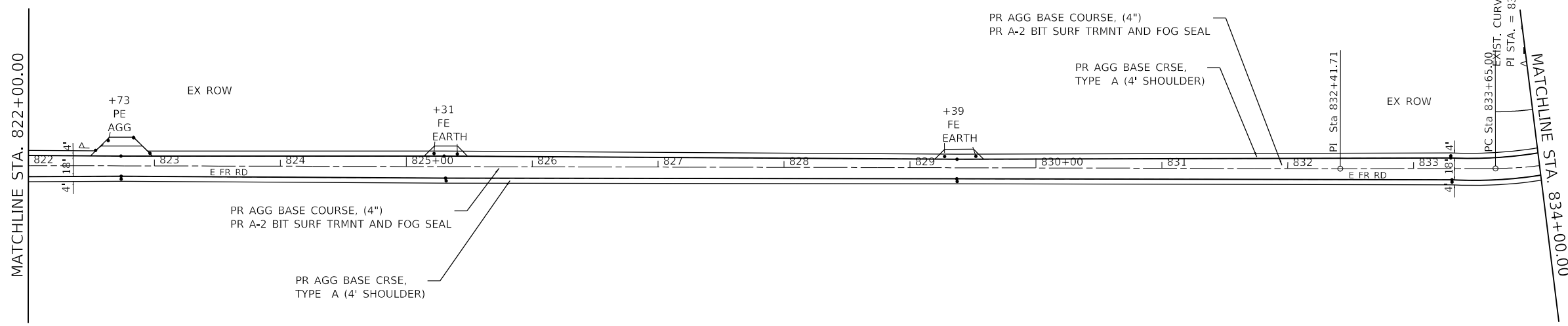

MODEL: Default
 FILE: MainE_PlanSheet.dwg
 C:\Users\pasleyo\Documents\DOT\Office\Drawings\6\Projects\0672M68\CADD\Drawings\0672M68-Plan.dwg

USER NAME = pasleyo	DESIGNED -	REVISED -
	DRAWN -	REVISED -
PLOT SCALE = 100.0000 ' / in.	CHECKED -	REVISED -
PLOT DATE = 2/9/2022	DATE -	REVISED -

**STATE OF ILLINOIS
 DEPARTMENT OF TRANSPORTATION**

PLAN SHEET

SCALE: SHEET 4 OF 12 SHEETS STA. TO STA.

F.A.I. RTE.	SECTION	COUNTY	TOTAL SHEETS	SHEET NO.
*	(68-5) R5	MONTGOMERY	30	18
CONTRACT NO. 72M68				
ILLINOIS FED. AID PROJECT				

*FAI 55 5 (I 55 E FR RD)

HMA SURFACE REMOVAL - BUTT JOINT



EXIST. CURVE 4452344521
 PI STA. = 840+67.96
 $\Delta = 30^\circ 00' 00''$ (RT)
 D = 20° 00' 02"
 R = 286.47'
 T = 76.76'
 L = 150.00'
 E = 10.11'
 e = _____
 T.R. = _____
 S.E. RUN = _____
 P.C. STA. = 839+91.20
 P.T. STA. = 841+41.19

EXIST. CURVE 4452644524
 PI STA. = 836+34.42
 $\Delta = 86^\circ 29' 06''$ (LT)
 D = 20° 00' 00"
 R = 286.48'
 T = 269.42'
 L = 432.42'
 E = 106.79'
 e = _____
 T.R. = _____
 S.E. RUN = _____
 P.C. STA. = 833+65.00
 P.T. STA. = 837+97.43

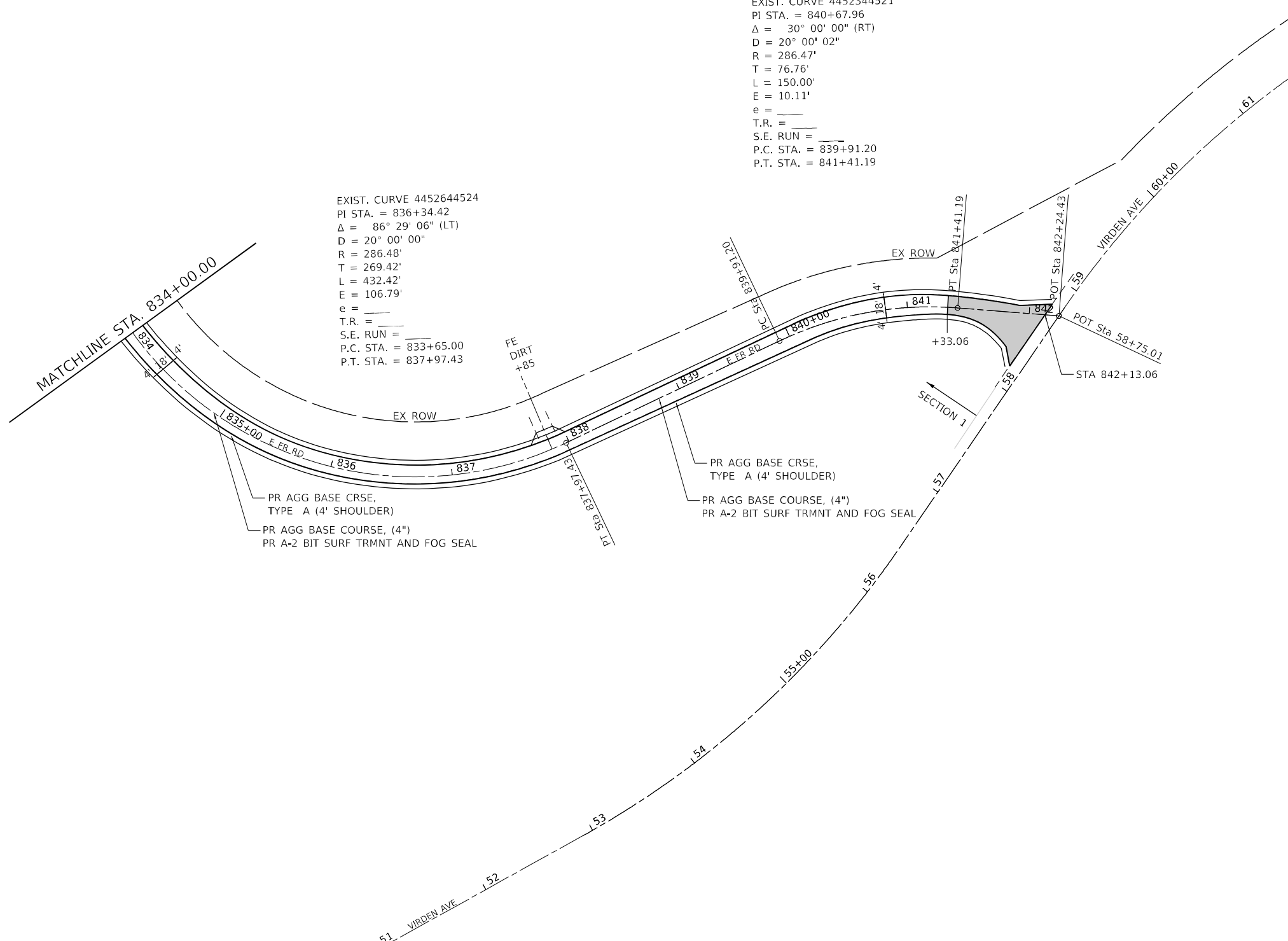

MODEL: Default
 FILE: hma155_5_155_e_fr_rd.dwg
 PROJECT: I:\DOT\Documents\DOT Office\District 6\Projects\0672\68-5\h155_5_155_e_fr_rd.dwg

USER NAME = caraballoj	DESIGNED -	REVISED -
	DRAWN -	REVISED -
PLOT SCALE = 100,0000' / in.	CHECKED -	REVISED -
PLOT DATE = 2/9/2022	DATE -	REVISED -

**STATE OF ILLINOIS
 DEPARTMENT OF TRANSPORTATION**

PLAN SHEET

SCALE: SHEET 5 OF 12 SHEETS STA. TO STA.

F.A.I. RTE.	SECTION	COUNTY	TOTAL SHEETS	SHEET NO.
*	(68-5) RS	MONTGOMERY	30	19
CONTRACT NO. 72M68				
ILLINOIS FED. AID PROJECT				

*FAI 55 5 (I 55 E FR RD)

HMA SURFACE REMOVAL - BUTT JOINT

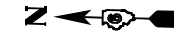

MATCHLINE STA. 886+00.00

MATCHLINE STA. 898+00.00

SECTION 2

EX ROW

EX ROW

886 887 888 889 890+00 E FR RD 891 892 893 894 895+00 896 E FR RD 897

+73 +53

PR AGG BASE COURSE, (4")
PR A-2 BIT SURF TRMNT
PR AGG BASE CRSE,
TYPE A (4' SHOULDER)

PR AGG BASE COURSE, (4")
PR A-2 BIT SURF TRMNT AND FOG SEAL
PR AGG BASE CRSE,
TYPE A (4' SHOULDER)

MATCHLINE STA. 898+00.00

MATCHLINE STA. 910+00.00

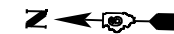

+23
FE
AGG

EX ROW

EX ROW

898 899 E FR RD 900+00 901 902 903 904 905+00 906 907 908 E FR RD 909

Pl. Sta 905+12.70

PR AGG BASE COURSE, (4")
PR A-2 BIT SURF TRMNT AND FOG SEAL

PR AGG BASE CRSE,
TYPE A (4' SHOULDER)

PR AGG BASE COURSE, (4")
PR A-2 BIT SURF TRMNT AND FOG SEAL

PR AGG BASE CRSE,
TYPE A (4' SHOULDER)

+62
FE
AGG

MODEL: Default
FILE NAME: p:\project-aw-bee\paw.com\p\w\DOT\Documents\DOT Office\District 6\Project\0672\68\CADD\DATA\CAD\pawees\0672\68-5-sh-Plan2.dwg

USER NAME = caraballoj	DESIGNED -	REVISED -
	DRAWN -	REVISED -
PLOT SCALE = 100,0000' / in.	CHECKED -	REVISED -
PLOT DATE = 2/9/2022	DATE -	REVISED -

STATE OF ILLINOIS
DEPARTMENT OF TRANSPORTATION

PLAN SHEET

SCALE: SHEET 6 OF 12 SHEETS STA. TO STA.

F.A.I RTE.	SECTION	COUNTY	TOTAL SHEETS	SHEET NO.
*	(68-5) RS	MONTGOMERY	30	20
CONTRACT NO. 72M68				
ILLINOIS FED. AID PROJECT				

*FAI 55 5 (I 55 E FR RD)



- HMA SURFACE REMOVAL - BUTT JOINT
- AGG. BASE COURSE TRANSITION - 4" TO 3"

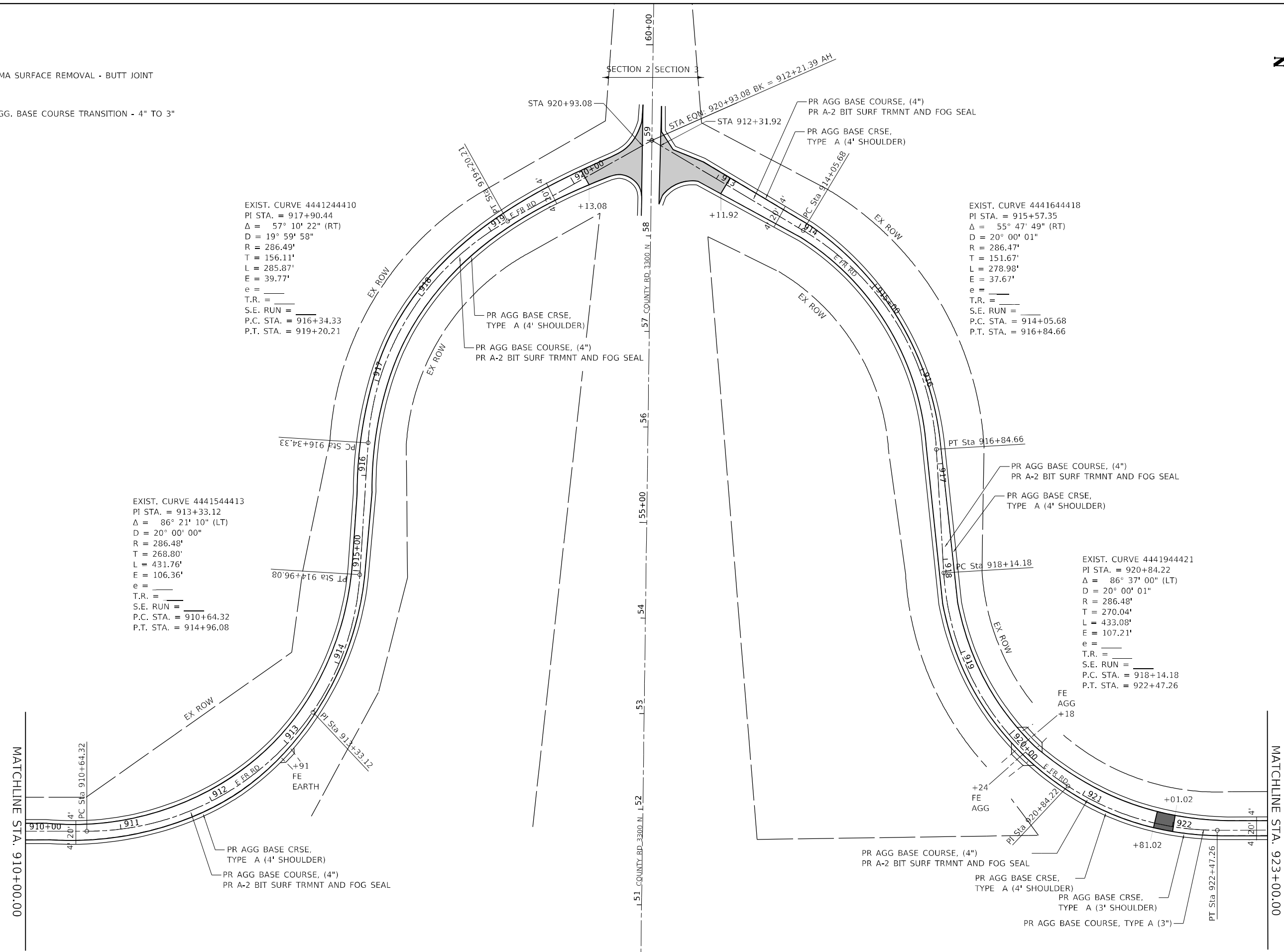

EXIST. CURVE 4441244410
 PI STA. = 917+90.44
 $\Delta = 57^\circ 10' 22''$ (RT)
 $D = 19^\circ 59' 58''$
 $R = 286.49'$
 $T = 156.11'$
 $L = 285.87'$
 $E = 39.77'$
 $e = \text{---}$
 $T.R. = \text{---}$
 $S.E. RUN = \text{---}$
 P.C. STA. = 916+34.33
 P.T. STA. = 919+20.21

EXIST. CURVE 4441544413
 PI STA. = 913+33.12
 $\Delta = 86^\circ 21' 10''$ (LT)
 $D = 20^\circ 00' 00''$
 $R = 286.48'$
 $T = 268.80'$
 $L = 431.76'$
 $E = 106.36'$
 $e = \text{---}$
 $T.R. = \text{---}$
 $S.E. RUN = \text{---}$
 P.C. STA. = 910+64.32
 P.T. STA. = 914+96.08

EXIST. CURVE 4441644418
 PI STA. = 915+57.35
 $\Delta = 55^\circ 47' 49''$ (RT)
 $D = 20^\circ 00' 01''$
 $R = 286.47'$
 $T = 151.67'$
 $L = 278.98'$
 $E = 37.67'$
 $e = \text{---}$
 $T.R. = \text{---}$
 $S.E. RUN = \text{---}$
 P.C. STA. = 914+05.68
 P.T. STA. = 916+84.66

EXIST. CURVE 4441944421
 PI STA. = 920+84.22
 $\Delta = 86^\circ 37' 00''$ (LT)
 $D = 20^\circ 00' 01''$
 $R = 286.48'$
 $T = 270.04'$
 $L = 433.08'$
 $E = 107.21'$
 $e = \text{---}$
 $T.R. = \text{---}$
 $S.E. RUN = \text{---}$
 P.C. STA. = 918+14.18
 P.T. STA. = 922+47.26

USER NAME = caraballoj	DESIGNED -	REVISED -
DRAWN -	REVISED -	
PLOT SCALE = 100,0000' / in.	CHECKED -	REVISED -
PLOT DATE = 2/9/2022	DATE -	REVISED -

**STATE OF ILLINOIS
 DEPARTMENT OF TRANSPORTATION**

PLAN SHEET			
SCALE:	SHEET 7	OF 12 SHEETS	STA. TO STA.

F.A.I. RTE.	SECTION	COUNTY	TOTAL SHEETS	SHEET NO.
	(68-5) RS	MONTGOMERY	30	21
CONTRACT NO. 72M68			ILLINOIS FED. AID PROJECT	

1FAI 55 5 (I 55 E FR RD)

MODEL: Default
 FILE NAME: p:\projects\paw_bentley.com\p\dot\Documents\DOT_office\District_6\Projects\0672\68\CAD\Drawings\0672\68-5-21-plan1.dgn

- HMA SURFACE REMOVAL - BUTT JOINT
- AGG. BASE COURSE TRANSITION - 4" TO 3"

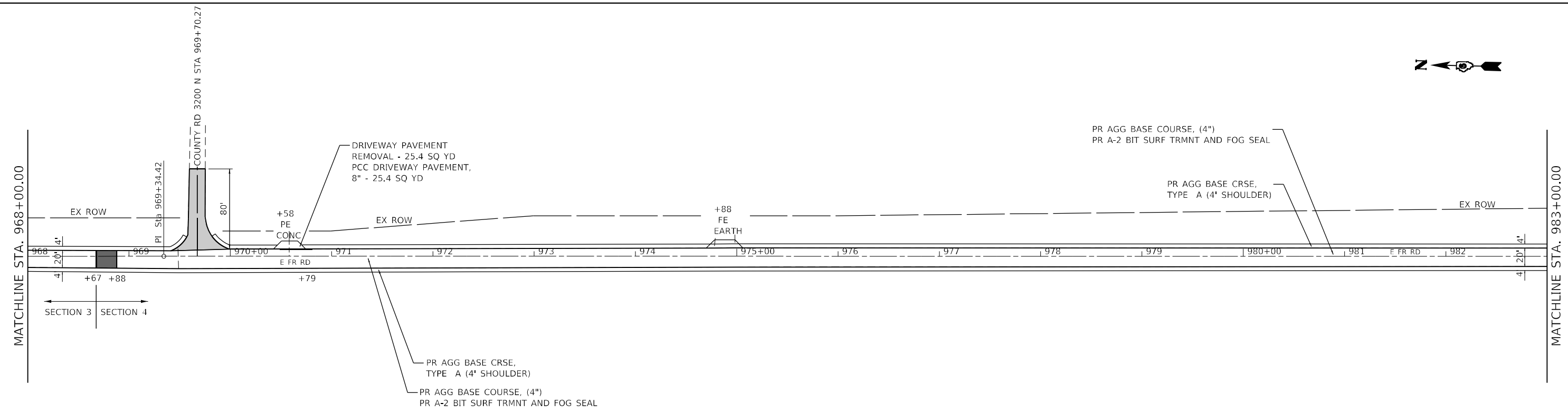
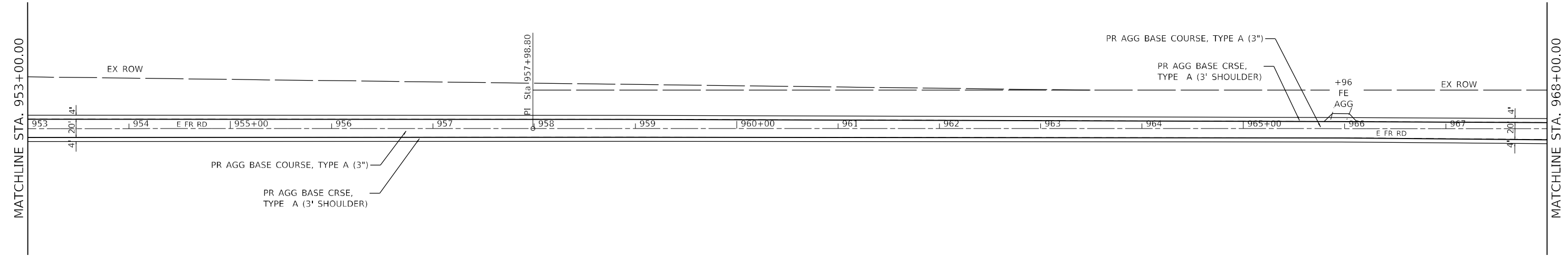

MODEL: Default
 FILE: Mainfile.pia
 SUBJECT: new_bentley.com:PIV\DOT\Documents\DOT_Offices\District_6\Projects\0672\68\CAD\Drawings\0672\68-5-111-Plan2.dwg

USER NAME = caraballoj	DESIGNED -	REVISED -
	DRAWN -	REVISED -
PLOT SCALE = 100,0000' / in.	CHECKED -	REVISED -
PLOT DATE = 2/9/2022	DATE -	REVISED -

**STATE OF ILLINOIS
DEPARTMENT OF TRANSPORTATION**

PLAN SHEET			
SCALE:	SHEET 9	OF 12 SHEETS	STA. TO STA.

F.A.I. RTE.	SECTION	COUNTY	TOTAL SHEETS	SHEET NO.
*	(68-5) RS	MONTGOMERY	30	23
CONTRACT NO. 72M68				
ILLINOIS FED. AID PROJECT				

*FAI 55 5 (I 55 E FR RD)

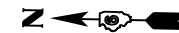

MATCHLINE STA. 983+00.00

MATCHLINE STA. 998+00.00

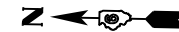
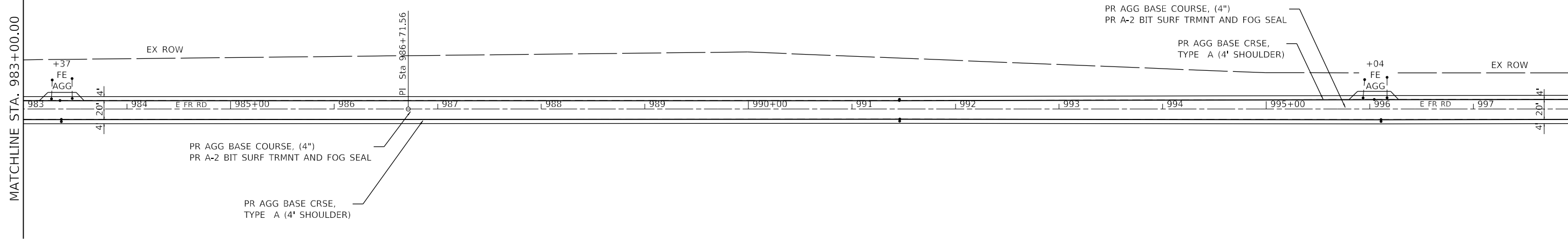

MATCHLINE STA. 998+00.00

MATCHLINE STA. 1013+00.00

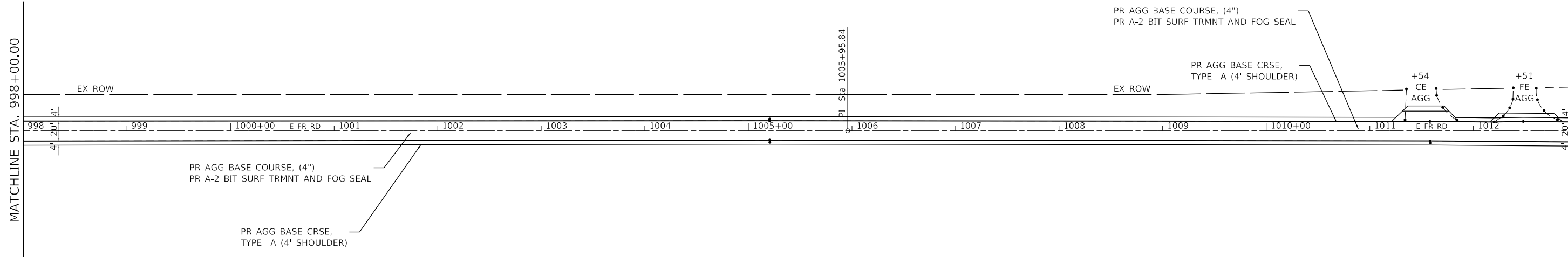

Model: Default
File: Main: p:\bldg-civ-bentley.com\pwwd\DOT\Documents\DOT Offices\Bentley 6\Projects\0672M68\CADD\Drawings\0672M68-shd-plan2.dwg

USER NAME = pasleyo	DESIGNED -	REVISED -
PLOT SCALE = 100,0000 ' / in.	DRAWN -	REVISED -
PLOT DATE = 2/9/2022	CHECKED -	REVISED -
	DATE -	REVISED -

**STATE OF ILLINOIS
DEPARTMENT OF TRANSPORTATION**

PLAN SHEET

SCALE: SHEET 10 OF 12 SHEETS STA. TO STA.

F.A.I. RTE.	SECTION	COUNTY	TOTAL SHEETS	SHEET NO.
*	(68-5) RS	MONTGOMERY	30	24
CONTRACT NO. 72M68				
ILLINOIS FED. AID PROJECT				

*FAI 55 5 (I 55 E FR RD)

EXIST. CURVE EFR1018
 PI STA. = 1018+32.18
 $\Delta = 1^\circ 08' 45''$ (LT)
 $D = 0^\circ 20' 00''$
 $R = 17,189.66'$
 $T = 171.89'$
 $L = 343.77'$
 $E = 0.86'$
 $e =$
 $T.R. =$
 $S.E. RUN =$
 P.C. STA. = 1016+60.29
 P.T. STA. = 1020+04.06

HMA SURFACE REMOVAL - BUTT JOINT

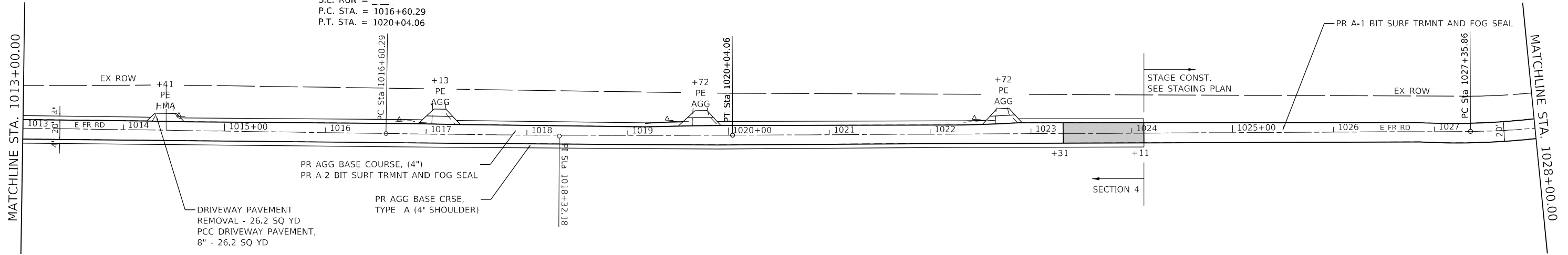

EXIST. CURVE EFR1031
 PI STA. = 1031+13.63
 $\Delta = 57^\circ 31' 19''$ (LT)
 $D = 8^\circ 19' 29''$
 $R = 688.27'$
 $T = 377.77'$
 $L = 690.99'$
 $E = 96.86'$
 $e =$
 $T.R. =$
 $S.E. RUN =$
 P.C. STA. = 1027+35.86
 P.T. STA. = 1034+26.85

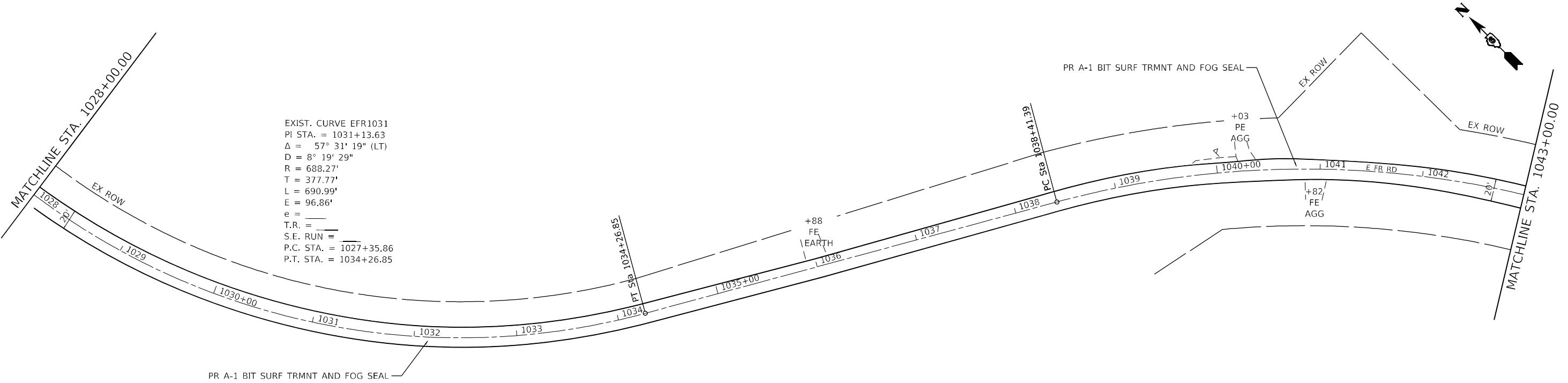
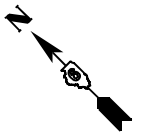

MODEL: Default
 FILE: Mainfile.pwd\ultra-cad\ultra-cad\pavement\DOT\Office\Director_E\Project\10672\68\CAD\pavement\DOT\10672\68-shr-plan2.dwg

USER NAME = caraballoj	DESIGNED -	REVISED -
PLOT SCALE = 100,0000' / in.	DRAWN -	REVISED -
PLOT DATE = 2/9/2022	CHECKED -	REVISED -
	DATE -	REVISED -

**STATE OF ILLINOIS
 DEPARTMENT OF TRANSPORTATION**

PLAN SHEET			
SCALE:	SHEET 11	OF 12 SHEETS	STA. TO STA.

F.A.I. RTE.	SECTION	COUNTY	TOTAL SHEETS	SHEET NO.
*	(68-5) RS	MONTGOMERY	30	25
CONTRACT NO. 72M68				
ILLINOIS FED. AID PROJECT				

*FAI 55 5 (I 55 E FR RD)



EXIST. CURVE EFR1044
 PI STA. = 1044+64.64
 $\Delta = 68^\circ 01' 02''$ (RT)
 $D = 6^\circ 12' 10''$
 $R = 923.71'$
 $T = 623.25'$
 $L = 1,096.56'$
 $E = 190.60'$
 $e = \text{---}$
 $T.R. = \text{---}$
 $S.E. RUN = \text{---}$
 $P.C. STA. = 1038+41.39$
 $P.T. STA. = 1049+37.94$

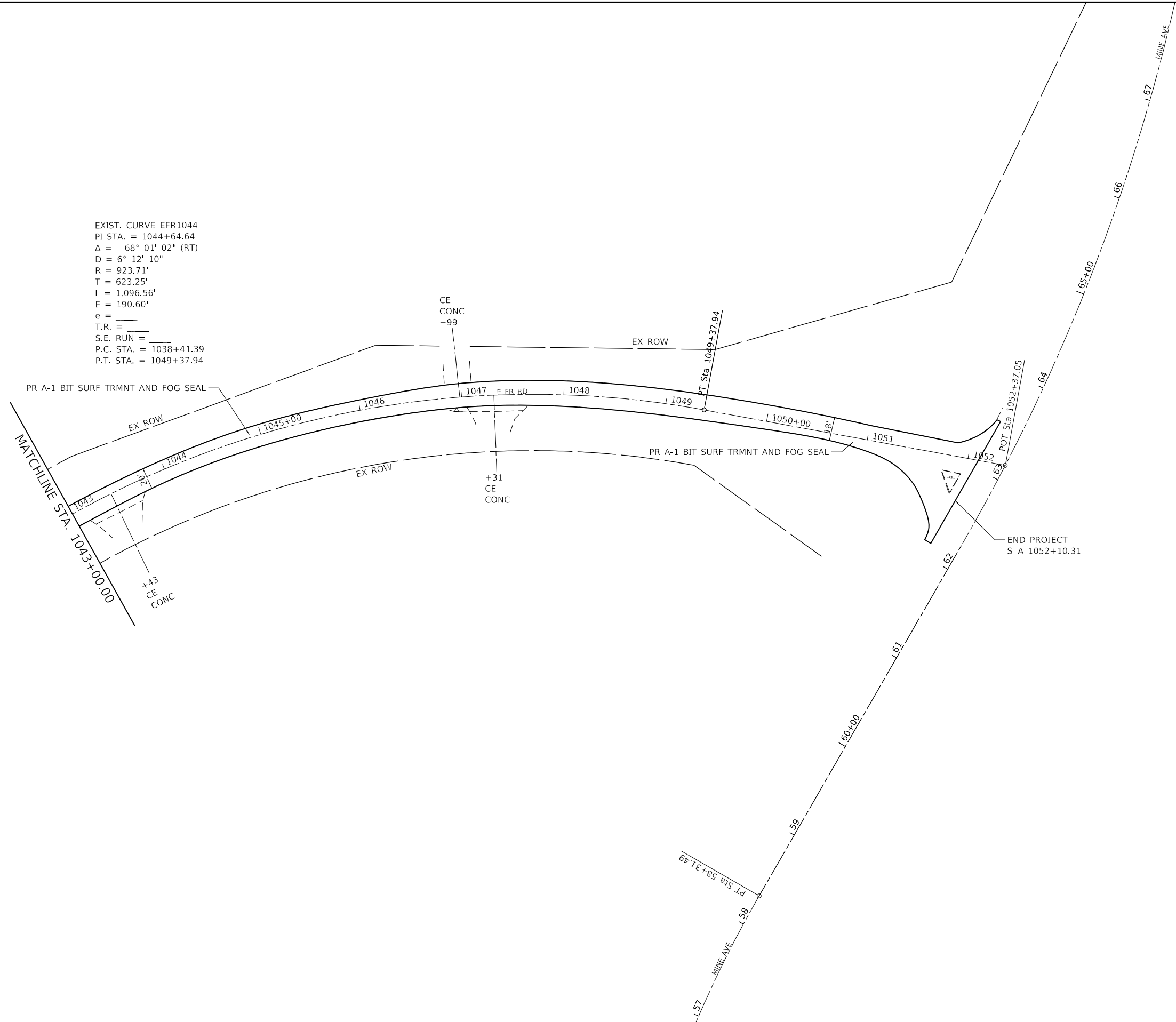

MODEL: Default
 FILE: MainE: p:\projects\72m68\72m68\cadd\data\CAD\dwg\72m68\72m68-sht-plan1.dwg

USER NAME = pasleyo	DESIGNED -	REVISED -
	DRAWN -	REVISED -
PLOT SCALE = 100,0000 ' / in.	CHECKED -	REVISED -
PLOT DATE = 2/9/2022	DATE -	REVISED -

**STATE OF ILLINOIS
 DEPARTMENT OF TRANSPORTATION**

PLAN SHEET

SCALE: SHEET 12 OF 12 SHEETS STA. TO STA.

F.A.I. RTE.	SECTION	COUNTY	TOTAL SHEETS	SHEET NO.
*	(68-5) R5	MONTGOMERY	30	26
CONTRACT NO. 72M68				
		ILLINOIS	FED. AID PROJECT	

*FAI 55 5 (I 55 E FR RD)

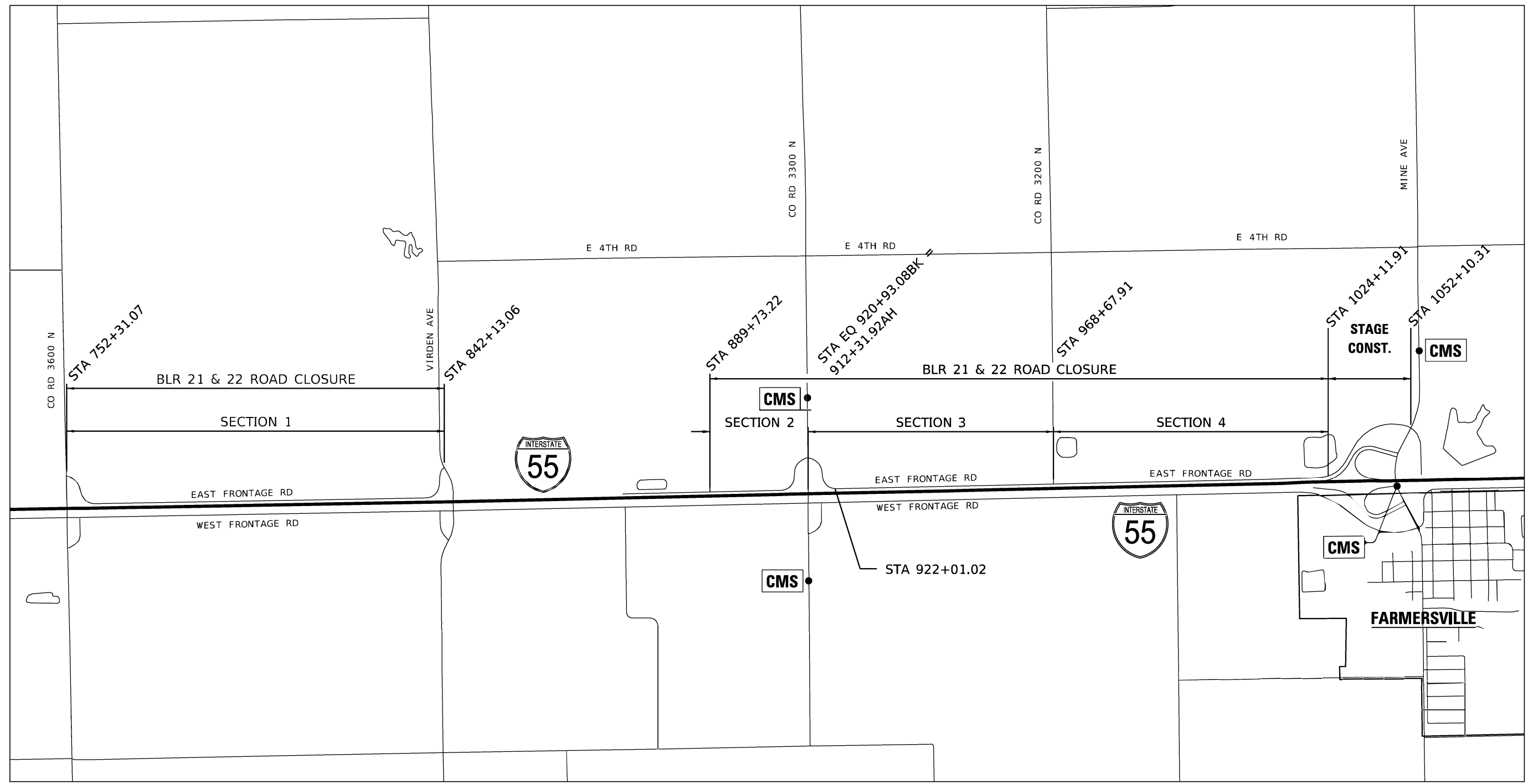

NOTES

FOUR CHANGEABLE MESSAGE SIGNS ARE REQUIRED TO BE PLACED ONE WEEK PRIOR TO THE START OF CONSTRUCTION WORK, AND THROUGH THE DURATION OF THE CLOSURE FOR SECTIONS 2-4.

LEGEND

CMS CHANGEABLE MESSAGE SIGN

MODEL: Default
FILE: Mainfile.pxl\ldot-cw_bentley.com\p\id\DOT\Documents\DOT_Offices\Districts\B\Projects\0727M68\CAD\Sheet\0727M68-shc-staging.dgn

USER NAME = caraballoj	DESIGNED -	REVISED -
	DRAWN -	REVISED -
PLOT SCALE = 100.0000' / in.	CHECKED -	REVISED -
PLOT DATE = 2/9/2022	DATE -	REVISED -

**STATE OF ILLINOIS
DEPARTMENT OF TRANSPORTATION**

STAGING PLAN

SCALE: SHEET OF SHEETS STA. TO STA.

F.A.I. RTE.	SECTION	COUNTY	TOTAL SHEETS	SHEET NO.
*	(68-5) RS	MONTGOMERY	30	27
CONTRACT NO. 72M68				
		ILLINOIS	FED. AID PROJECT	

*FAI 55 5 (I 55 E FR RD)

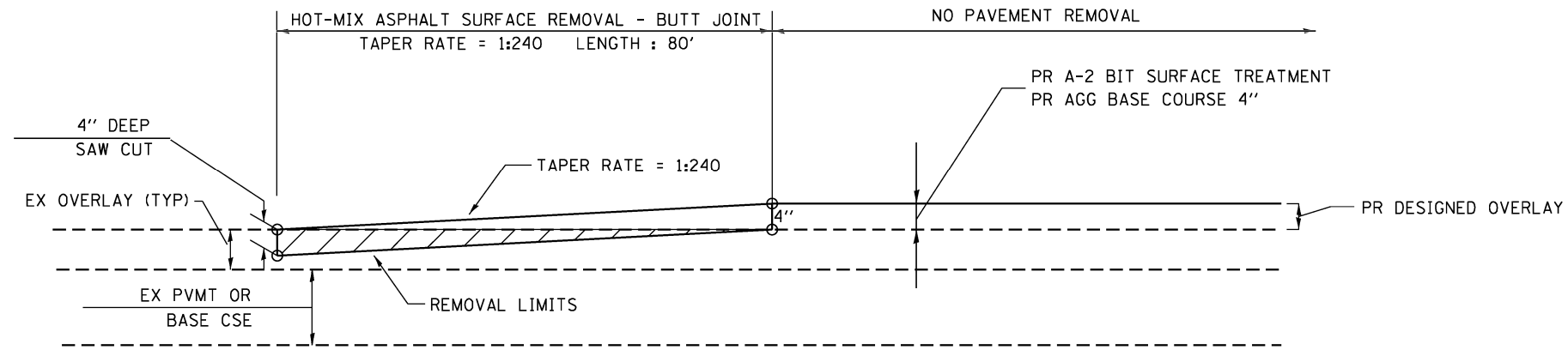

BUTT JOINT DETAIL #1
 STA. 752+31.07 TO STA. 753+11.07
 STA. 889+73.22 TO STA. 890+53.22
 STA. 912+31.92 TO STA. 913+11.92

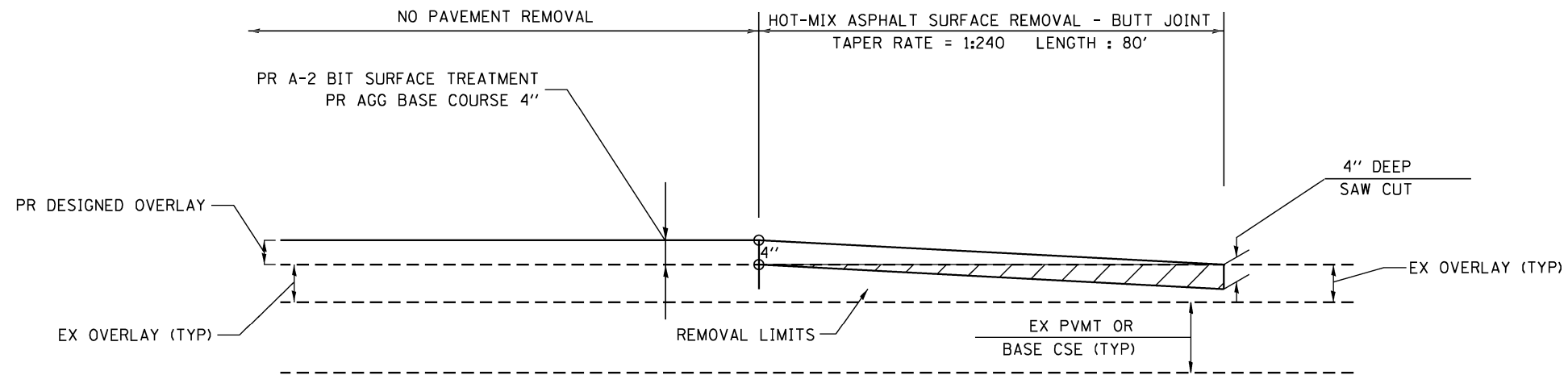

BUTT JOINT DETAIL #2
 STA. 841+33.06 TO STA. 842+13.06
 STA. 920+13.08 TO STA. 920+93.08
 STA. 969+70.27 (CO RD 3200 N)

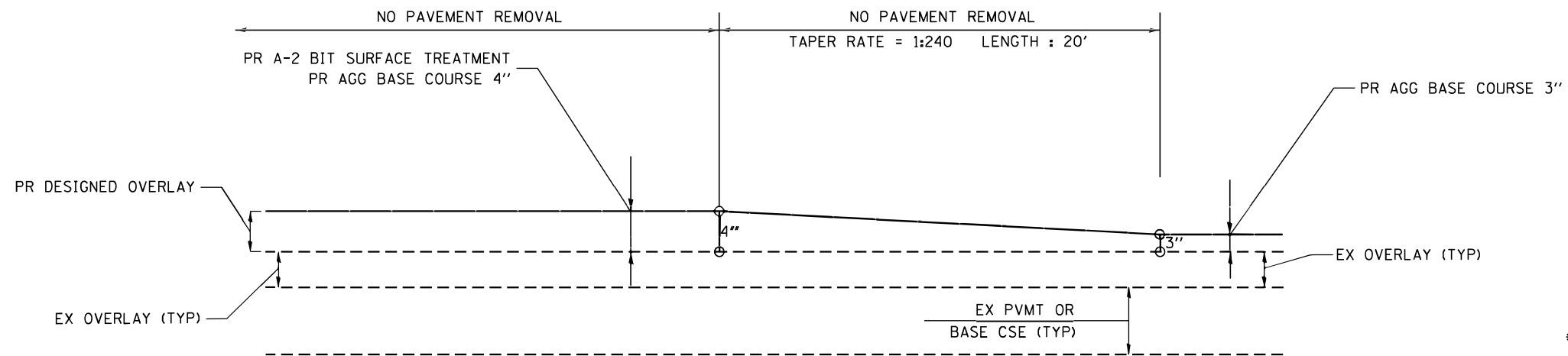

BUTT JOINT DETAIL #3
 STA. 921+81.02 TO STA. 922+01.02

* SAW CUT IS INCLUDED IN THE COST OF HMA SURFACE REMOVAL - BUTT JOINT, AND IS NOT TO BE PAID SEPARATELY.

FILE NAME =	USER NAME = caraballoj	DESIGNED -	REVISED -	STATE OF ILLINOIS DEPARTMENT OF TRANSPORTATION	BUTT JOINT DETAILS			F.A.I. RTE.	SECTION	COUNTY	TOTAL SHEETS	SHEET NO.
pw:\ildot-pw.bentley.com:PWIDOT\Documents\IDOT\Offices\District 6\Projects\672M68\CADDData\CADsheets\DRAWN-sh-Butt Joint details.dgn	PLOT SCALE = 100.0000' / in.	CHECKED -	REVISED -					*	(68-5) RS	MONTGOMERY	30	28
Default	PLOT DATE = 2/9/2022	DATE -	REVISED -		SCALE:	SHEET 1	OF 2 SHEETS	STA.	TO STA.	ILLINOIS FED. AID PROJECT	CONTRACT NO. 72M68	

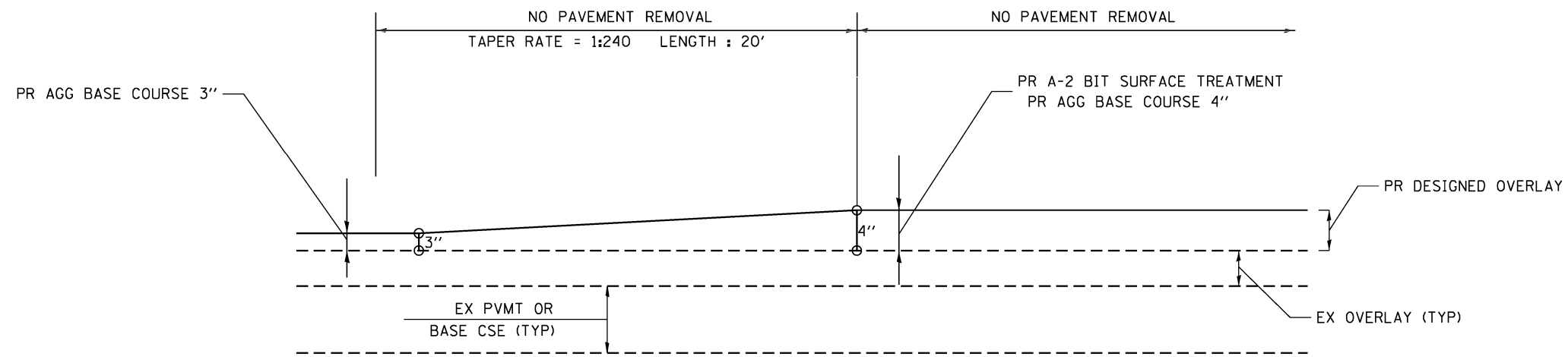

BUTT JOINT DETAIL #4
 STA. 968+67.91 TO STA. 968+87.91

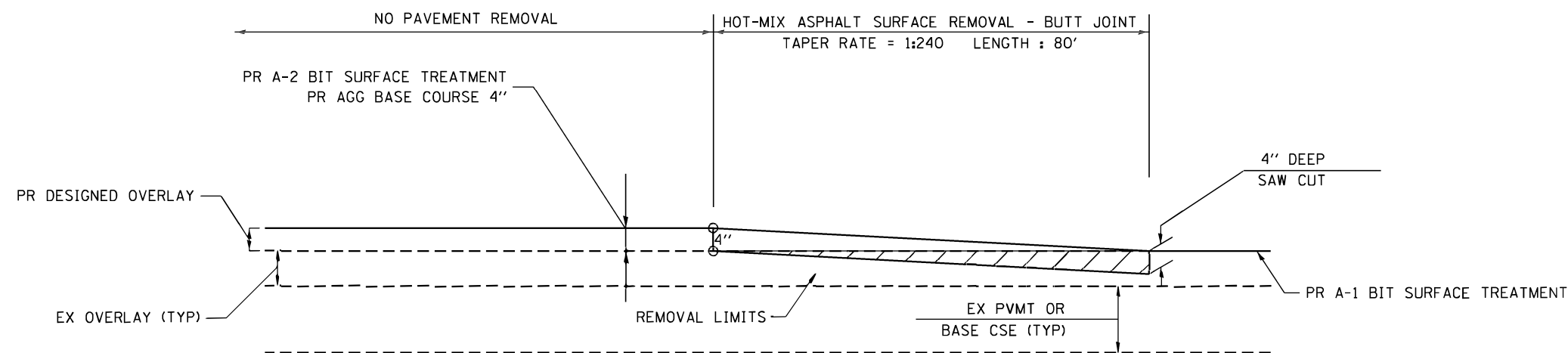

BUTT JOINT DETAIL #5
 STA. 1023+31.91 TO STA. 1024+11.91

* SAW CUT IS INCLUDED IN THE COST OF HMA SURFACE REMOVAL - BUTT JOINT, AND IS NOT TO BE PAID SEPARATELY.

FILE NAME =	USER NAME = caraballoj	DESIGNED -	REVISED -	STATE OF ILLINOIS DEPARTMENT OF TRANSPORTATION	BUTT JOINT DETAILS			F.A.I. RTE.	SECTION	COUNTY	TOTAL SHEETS	SHEET NO.
pw:\ildot-pw.bentley.com:PWIDOT\Documents\IDO	Offices\District 6\Projects\1672M68\CADData\CADsheets\DRAWN-shit-Butt Joint details.dgn	DRAWN -	REVISED -					*	(68-5) RS	MONTGOMERY	30	29
Default	PLOT SCALE = 100.0000 ' / in.	CHECKED -	REVISED -		SCALE: SHEET 1 OF 2 SHEETS STA. TO STA.			ILLINOIS FED. AID PROJECT				
	PLOT DATE = 2/9/2022	DATE -	REVISED -		CONTRACT NO. 72M68							

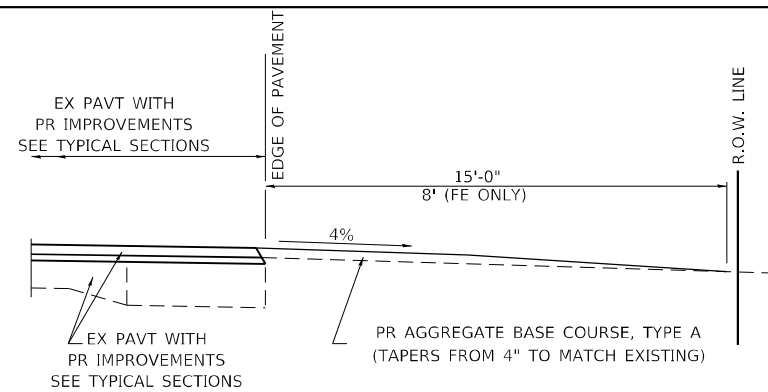

SECTION A-A FOR EX EARTH/AGGREGATE FE, PE, & CE

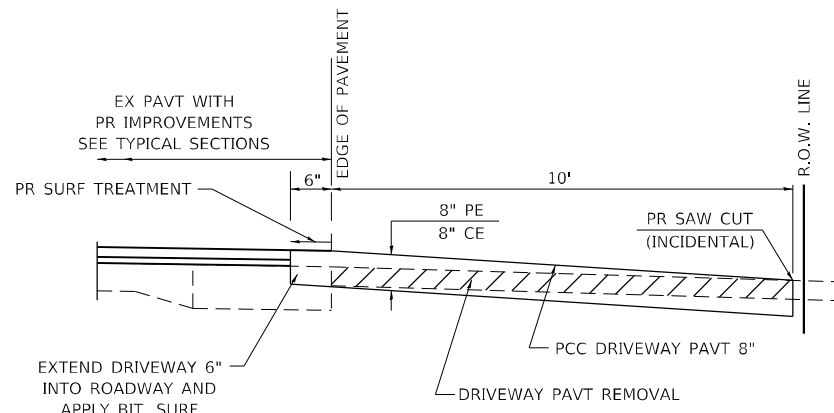

SECTION A-A FOR EX HMA PE & CE

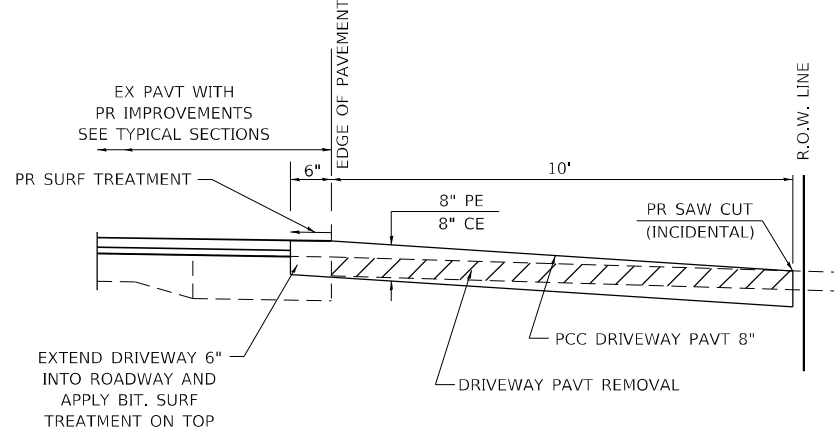

SECTION A-A FOR EX P.C. CONC. PE & CE

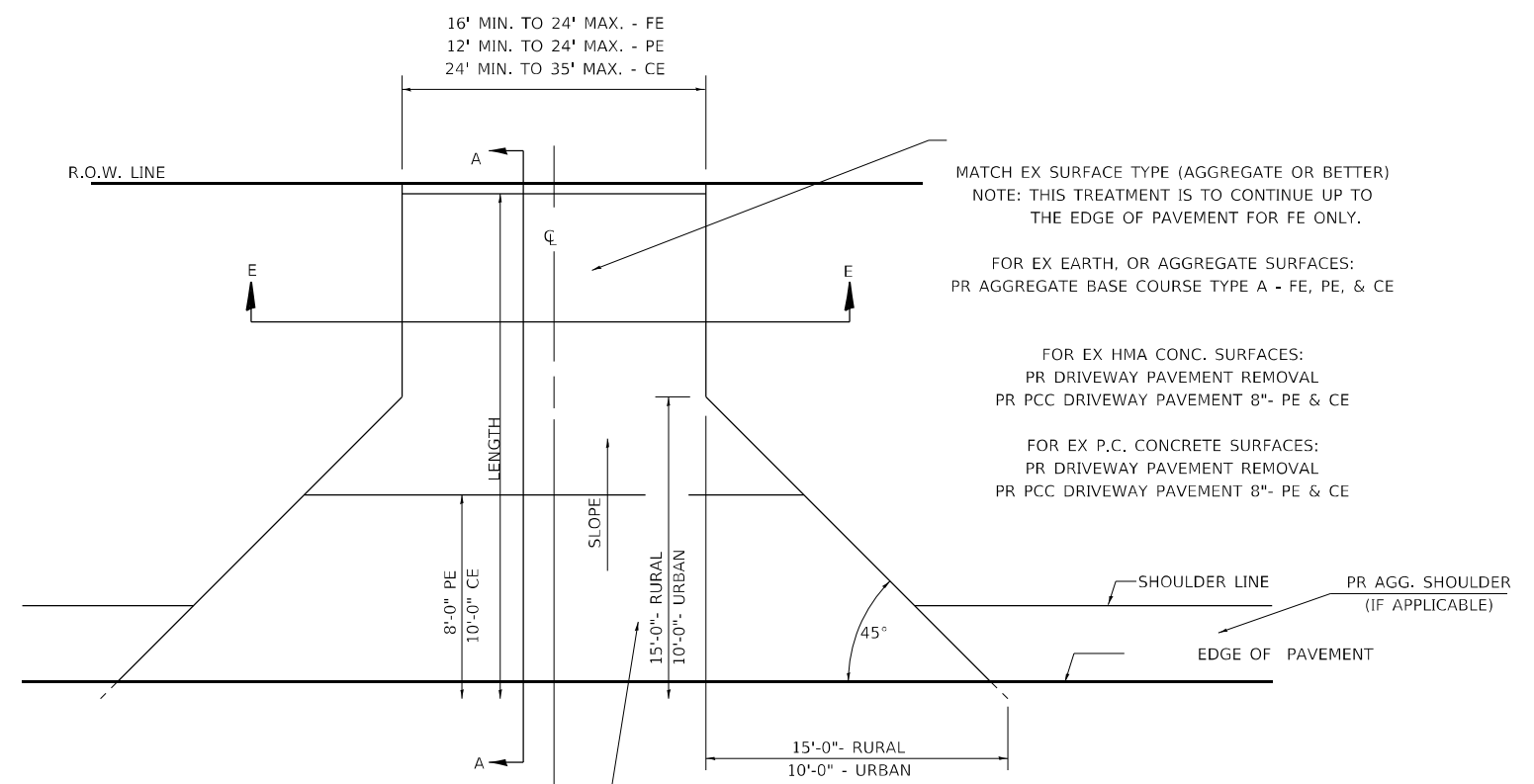

FOR EX EARTH, AGGREGATE, OR HMA CONC SURFACES:
PR DRIVEWAY PAVEMENT REMOVAL (IF APPLICABLE)

FOR EX EARTH, OR AGGREGATE SURFACES:
PR AGGREGATE BASE COURSE TYPE A - FE, PE, & CE

FOR EX HMA CONC. SURFACES:
PR DRIVEWAY PAVEMENT REMOVAL
PR PCC DRIVEWAY PAVEMENT 8" - PE & CE

FOR EX P.C. CONCRETE SURFACES:
PR DRIVEWAY PAVEMENT REMOVAL
PR PCC DRIVEWAY PAVEMENT 8" - PE & CE

GENERAL NOTES:

THE RESIDENT ENGINEER WILL DETERMINE THE EXACT TYPE OF IMPROVEMENT TO BE COMPLETED FOR ALL ENTRANCES, SIDEROADS AND MAILBOX TURNOUTS ON THIS PROJECT.

THE PLAN DETAILS AND SCHEDULES SHOULD BE USED AS A GUIDE FOR THE ENGINEER TO IMPLEMENT THE FINAL DESIGN. THE ENGINEER MAY DECIDE TO SALVAGE PORTIONS OF THE EXISTING ENTRANCE PAVEMENT STRUCTURE; THEREFORE, REDUCING PAY ITEM QUANTITIES. NO ADDITIONAL PAYMENT WILL BE ALLOWED FOR THIS REDUCTION IN QUANTITIES.

ANY WORK THE ENGINEER REQUIRES WHICH IS NOT COVERED BY A PAY ITEM CONTAINED IN THE PLANS WILL BE PAID FOR IN ACCORDANCE WITH ARTICLE 109.04 OF THE STANDARD SPECIFICATIONS.

HMA CONCRETE REQUIRED TO CONSTRUCT THE ENTRANCES SHALL BE IN ACCORDANCE WITH THE APPLICABLE PORTIONS OF SECTION 406 AND 408 OF THE STANDARD SPECIFICATIONS AND AS DIRECTED BY THE ENGINEER.

WHEN THE HMA CONCRETE PROPOSED FOR THE IMPROVEMENT IS THICKER THAN 3 INCHES AND REQUIRE PLACEMENT IN MORE THAN ONE LIFT. THE BOTTOM LIFT(S) SHALL MEET THE REQUIREMENTS OF HMA BASE COURSE IN SECTION 406 OF THE STANDARD SPECIFICATIONS AND THE TOP LIFT OF 2 INCHES SHALL MEET THE REQUIREMENTS OF HMA CONCRETE SURFACE COURSE, SUPERPAVE.

THIS WORK WILL BE PAID FOR IN ACCORDANCE WITH SECTIONS 351, 358, 408, 423 AND 440 OF THE STANDARD SPECIFICATIONS.

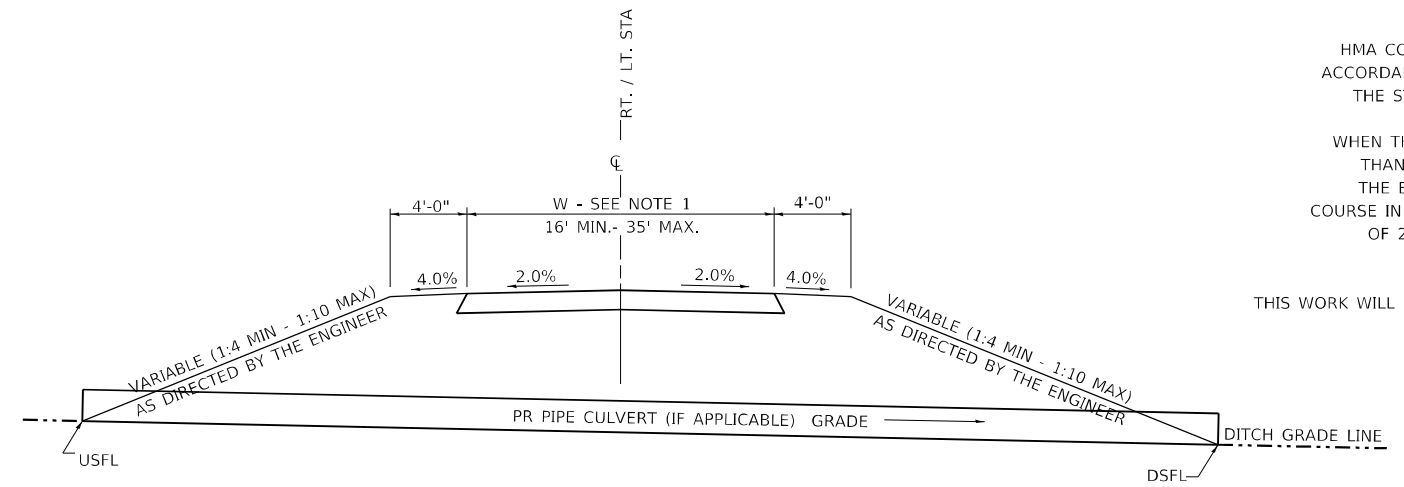

SECTION E-E ENTRANCE TYPICAL SECTION

NOTE 1: WIDTH OF ENTRANCE MAY BE INCREASED AT THE PIPE CULVERT DUE TO THE DITCHLINE BEING LOCATED IN THE ENTRANCE FLARE AREA.

ALL DIMENSIONS ARE IN INCHES UNLESS OTHERWISE SHOWN.

MODEL: D:\default... FILE: 240123... PROJECT: 2022... DISTRICT: 6... COUNTY: MONTGOMERY... CONTRACT: 72M68

USER NAME = caraballoj	DESIGNED -	REVISED - 2/19/03 (JCN)
	DRAWN - CADD	REVISED - 4/01/04 (JCN)
PLOT SCALE = 40,0000 */ in.	CHECKED - JCN	REVISED - 8/01/07 (JCN)
PLOT DATE = 2/9/2022	DATE - FEBRUARY 23, 1999	REVISED - 01/2013

**STATE OF ILLINOIS
DEPARTMENT OF TRANSPORTATION**

**DISTRICT 6 DETAILS FOR RURAL/URBAN ENTRANCE &
MAILBOX TURNOUT W/O CONC GUTTER (3R - PROJECTS)**

SCALE:	SHEET	OF	SHEETS	STA.	TO	STA.
--------	-------	----	--------	------	----	------

F.A.I. RTE.	SECTION	COUNTY	TOTAL SHEETS	SHEET NO.
*	(68-5) RS	MONTGOMERY	30	30
			CONTRACT NO. 72M68	
		ILLINOIS	FED. AID PROJECT	