

STATE OF ILLINOIS
DEPARTMENT OF TRANSPORTATION

F.A. RTE	SECTION	COUNTY	TOTAL SHEETS	SHEET NO.
VAR	2021 056 SW	WILL	113	1
ILLINOIS CONTRACT NO. 62N87				

* 113 + 1 = 114 TOTAL SHEETS
* 114 + 1 = 115 TOTAL SHEETS

FOR INDEX OF SHEETS, SEE SHEET NO. 2

THIS PROJECT IS LOCATED IN THE CITY OF JOLIET

**PROPOSED
HIGHWAY PLANS**
VARIOUS ROUTES
VARIOUS LOCATIONS (JOLIET AREA)
SECTION: 2021-056-SW
ADA IMPROVEMENTS
WILL COUNTY
C-91-160-21

TRAFFIC DATA:

FOR TRAFFIC DATA,
SEE SHEETS No 6-13

PROJECT LOCATION:

FOR LOCATION MAPS,
SEE SHEETS No 6-13

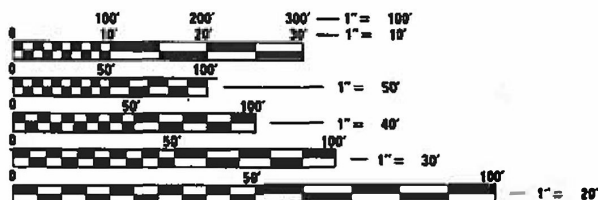

FULL SIZE PLANS HAVE BEEN PREPARED USING STANDARD ENGINEERING SCALES. REDUCED SIZED PLANS WILL NOT CONFORM TO STANDARD SCALES. IN MAKING MEASUREMENTS ON REDUCED PLANS, THE ABOVE SCALES MAY BE USED.

J.U.L.I.E.
JOINT UTILITY LOCATION INFORMATION FOR EXCAVATION
1-800-892-0123
OR 811

PROJECT ENGINEER: VESELIN VELICHKOV (847) 705-4432
PROJECT MANAGER: FAWAD AQUEEL

CONTRACT NO. 62N87

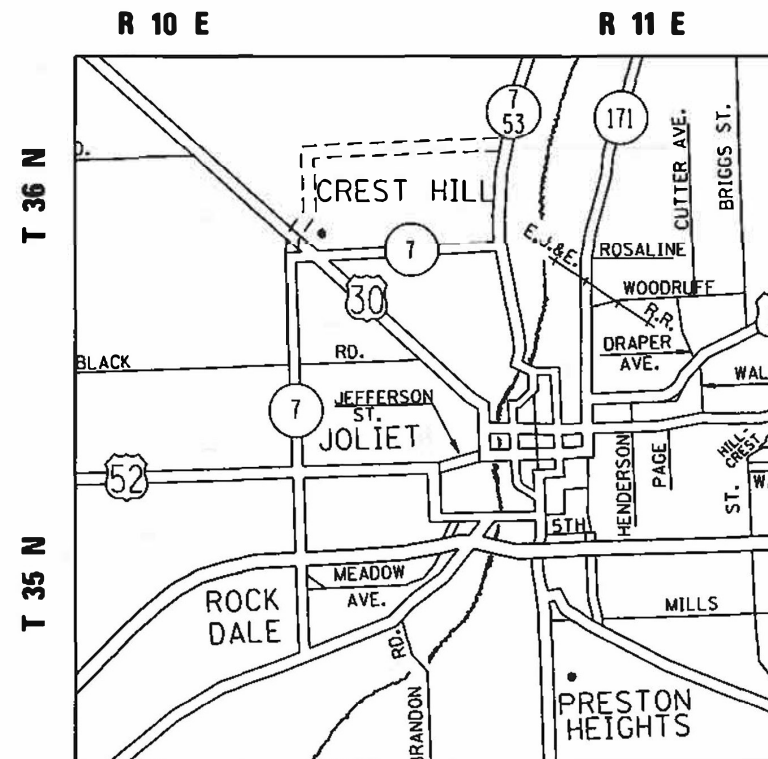

JOLIET TOWNSHIP

GROSS LENGTH & NET LENGTH = NA (SPOT IMPROVEMENTS)

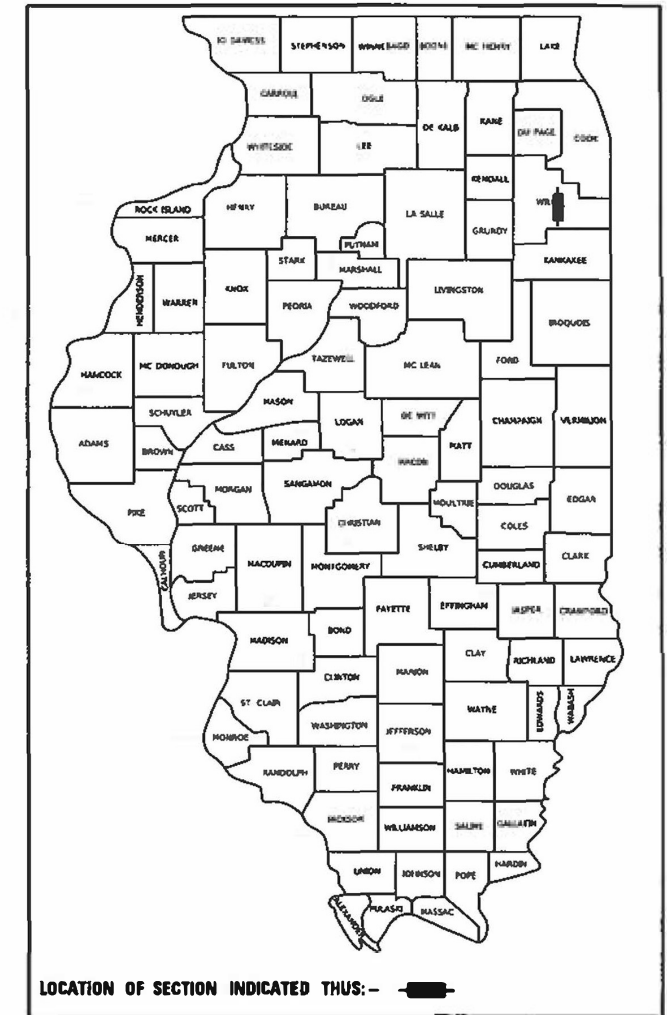

LOCATION OF SECTION INDICATED THIS: -

LOCATION MAP
(NOT TO SCALE)

STATE OF ILLINOIS
DEPARTMENT OF TRANSPORTATION

SUBMITTED October 18, 2021
Jose Rios LOB
REGIONAL ENGINEER

March 25, 2022
[Signature]
ENGINEER OF DESIGN AND ENVIRONMENT

March 22, 2022
[Signature]
DIRECTOR OF HIGHWAYS PROJECT IMPLEMENTATION

PRINTED BY THE AUTHORITY
OF THE STATE OF ILLINOIS

SUMMARY OF QUANTITIES			CONSTRUCTION TYPE CODE				
CODE NO	ITEM	UNIT	TOTAL QUANTITIES URBAN	100% STATE 0021			
20200100	EARTH EXCAVATION	CU YD	130	130			
20200200	ROCK EXCAVATION	CU YD	33	33			
21101615	TOPSOIL FURNISH AND PLACE, 4"	SO YD	874	874			
25000400	NITROGEN FERTILIZER NUTRIENT	POUND	11	11			
25000500	PHOSPHORUS FERTILIZER NUTRIENT	POUND	11	11			
25000600	POTASSIUM FERTILIZER NUTRIENT	POUND	11	11			
25200110	SODDING, SALT TOLERANT	SO YD	874	874			
25200200	SUPPLEMENTAL WATERING	UNIT	9	9			
28000500	INLET PIPE PROTECTION	EACH	15	15			
35400400	PORTLAND CEMENT CONCRETE BASE COURSE WIDENING, 9"	SQ YD	55	55			
40604062	HOT-MIX ASPHALT SURFACE COURSE, IL-9.5, MIX "D", N70	TON	28	28			
42001300	PROTECTIVE COAT	SO YD	2400	2400			
42400100	PORTLAND CEMENT CONCRETE SIDEWALK 4 INCH	SO FT	3154	3154			
42400200	PORTLAND CEMENT CONCRETE SIDEWALK 5 INCH	SO FT	13109	13109			
42400800	DETECTABLE WARNINGS	SO FT	1600	1600			

SUMMARY OF QUANTITIES			CONSTRUCTION TYPE CODE				
CODE NO	ITEM	UNIT	TOTAL QUANTITIES URBAN	100% STATE 0021			
44000100	PAVEMENT REMOVAL	SO YD	55	55			
44000600	SIDEWALK REMOVAL	SO FT	16263	16263			
60255500	MANHOLES TO BE ADJUSTED	EACH	1	1			
60260100	INLETS TO BE ADJUSTED	EACH	14	14			
60260300	INLETS TO BE ADJUSTED WITH NEW TYPE 1 FRAME, OPEN LID	EACH	27	27			
60250200	CATCH BASINS TO BE ADJUSTED	EACH	2	2			
60266600	VALVE BOXES TO BE ADJUSTED	EACH	3	3			
60600605	CONCRETE CURB, TYPE B	FOOT	105	105			
* 66900200	NON-SPECIAL WASTE DISPOSAL	CU YD	170	170			
* 66900530	SOIL DISPOSAL ANALYSIS	EACH	10	10			
* 66901001	REGULATED SUBSTANCES PRE-CONSTRUCTION PLAN	LSUM	1	1			
* 66901003	REGULATED SUBSTANCES FINAL CONSTRUCTION REPORT	LSUM	1	1			
* 66901006	REGULATED SUBSTANCES MONITORING	CAL DA	20	20			
67000400	ENGINEER'S FIELD OFFICE, TYPE A	CAL MO	12	12			
67100100	MOBILIZATION	L SUM	1	1			

REVISÉ SHEET 4/13/2022

* = SPECIALTY ITEMS

FILE NAME =	USER NAME = qqr/rtm	DESIGNED -	REVISED -
pw:\idat-pw\benley.com\PIW007\Documents\1007 - Office\District\Projects\DI1372\NCAD\Design\DI1372-st-500.dwg		DRAWN -	REVISED -
		CHECKED -	REVISED -
		DATE -	REVISED -

**STATE OF ILLINOIS
DEPARTMENT OF TRANSPORTATION**

**VARIOUS LOCATIONS (JOLIET TOWNSHIP)
SUMMARY OF QUANTITIES**

F.A. RTÉ.	SECTION	COUNTY	TOTAL SHEETS	SHEET NO.
VAR.	2021-056-SW	WILL	113	4
FED. ROAD DIST. NO. 1 ILLINOIS FED. AID PROJECT			CONTRACT NO. 62N87	

SCALE: SHEET NO. OF SHEETS STA. TO STA.

SUMMARY OF QUANTITIES			CONSTRUCTION TYPE CODE				
CODE NO	ITEM	UNIT	TOTAL QUANTITIES URBAN	100% STATE 0021			
70102625	TRAFFIC CONTROL AND PROTECTION, STANDARD 701606	L SUM	1	1			
70102630	TRAFFIC CONTROL AND PROTECTION, STANDARD 701601	L SUM	1	1			
70102635	TRAFFIC CONTROL AND PROTECTION, STANDARD 701701	L SUM	1	1			
70102640	TRAFFIC CONTROL AND PROTECTION, STANDARD 701801	L SUM	1	1			
72400500	RELOCATE SIGN PANEL ASSEMBLY - TYPE A	EACH	3	3			
72400710	RELOCATE SIGN PANEL - TYPE 1	EACH	4	4			
* 78000400	THERMOPLASTIC PAVEMENT MARKING - LINE 6"	FOOT	5890	5890			
* 78000600	THERMOPLASTIC PAVEMENT MARKING - LINE 12"	FOOT	880	880			
* 78000650	THERMOPLASTIC PAVEMENT MARKING - LINE 24"	FOOT	1460	1460			
* 78009006	MODIFIED URETHANE PAVEMENT MARKING - LINE 6"	FOOT	85	85			
* 78009024	MODIFIED URETHANE PAVEMENT MARKING - LINE 24"	FOOT	15	15			
78300202	PAVEMENT MARKING REMOVAL - WATER BLASTING	SQ FT	6820	6820			
* 85000200	MAINTENANCE OF EXISTING TRAFFIC SIGNAL INSTALLATION	EACH	3	3			

SUMMARY OF QUANTITIES			CONSTRUCTION TYPE CODE				
CODE NO	ITEM	UNIT	TOTAL QUANTITIES URBAN	100% STATE 0021			
* 88600600	DETECTOR LOOP REPLACEMENT	FOOT	910	910			
* 89500400	RELOCATE EXISTING PEDESTRIAN PUSH-BUTTON	EACH	24	24			
* 89502376	REBUILD EXISTING HANDHOLE	EACH	4	4			⚠
X0320050	CONSTRUCTION LAYOUT (SPECIAL)	L SUM	1	1			
X0327611	REMOVE AND REINSTALL BRICK PAVER	SQ FT	3154	3154			⚠
78300202	PAVEMENT MARKING REMOVAL - WATER BLASTING	SQ FT	6820	6820			
X4406230	PARTIAL DEPTH REMOVAL, TYPE II, 3"	SQ YD	196	196			
X4421000	PARTIAL DEPTH PATCHING	TON	17	17			
X5537800	STORM SEWERS TO BE CLEANED 12"	FOOT	740	740			
Z0004562	COMBINATION CONCRETE CURB AND GUTTER REMOVAL AND REPLACEMENT	FOOT	2744	2744			⚠
Z0018500	DRAINAGE STRUCTURES TO BE CLEANED	EACH	37	37			
Z0030850	TEMPORARY INFORMATION SIGNING	SQ FT	312	312			
Z0012450	CONCRETE STEPS	CU YD	1	1			
Z0012455	CONCRETE STEPS REMOVAL	EACH	1	1			
Z0076604	TRAINEES - TRAINING PROGRAM GRADUATE	HOURS	500	500			

* = SPECIALTY ITEMS
⚠ REVISED SHEET 4/13/2022

FILE NAME =	USER NAME = qqr/rtm	DESIGNED -	REVISED -
pw\N\dot-pw\benley.com\PI\DOT\Documents\1007 - Office\District 1\Projects\DI\372\CAAD\Design\DI\372-st-500.dwg		DRAWN -	REVISED -
		CHECKED -	REVISED -
		DATE -	REVISED -

**STATE OF ILLINOIS
DEPARTMENT OF TRANSPORTATION**

**VARIOUS LOCATIONS (JOLIET TOWNSHIP)
SUMMARY OF QUANTITIES**

SCALE: SHEET NO. OF SHEETS STA. TO STA.

F.A. RTÉ.	SECTION	COUNTY	TOTAL SHEETS	SHEET NO.
VAR.	2021-056-SW	WILL	113	5
FED. ROAD DIST. NO. 1 (ILLINOIS) FED. AID PROJECT			CONTRACT NO. 62N87	

1

ID	LOCATION	CORNER	20200100 EARTH EXCAVATION	21101615 TOPSOIL FURNISH AND PLACE 4"	25000400 NITROGEN FERTILIZER NUTRIENT	25000500 PHOSPHORUS FERTILIZER NUTRIENT	25000600 POTASSIUM FERTILIZER NUTRIENT	25200110 SODDING, SALT TOLERANT	25200200 SUPPLEMENTAL WATERING	42400200 PORTLAND CEMENT CONCRETE SIDEWALK 5 INCH	42400800 DETECTABLE WARNINGS	44000600 SIDEWALK REMOVAL	42400100 PORTLAND CEMENT CONCRETE SIDEWALK 4 INCH	44000100 PAVEMENT REMOVAL	35400400 PCC BASE COURSE WIDENING, 9"	40604062 HOT-MIX ASPHALT SURFACE COURSE, IL-9.5, MIX "D", N70	60250200 CATCH BASINS TO BE ADJUSTED	60255500 MANHOLES TO BE ADJUSTED	60260100 INLETS TO BE ADJUSTED	60260300 INLETS TO BE ADJUSTED WITH NEW TYPE 1 FRAME, OPEN LID	72400500 RELOCATE SIGN PANEL ASSEMBLY - TYPE A	89500400 RELOCATE EXISTING PEDESTRIAN PUSH-BUTTON	X4406230 PARTIAL DEPTH REMOVAL, TYPE II, 3"	X4421000 PARTIAL DEPTH PATCHING	X8140115 HANDHOLE TO BE ADJUSTED	Z0004562 COMBINATION CONCRETE CURB AND GUTTER REMOVAL AND REPLACEMENT	Z0012450 CONCRETE STEPS	Z0012455 CONCRETE STEP REMOVAL			
			CU YD	SQ YD	POUND	POUND	POUND	SQ YD	UNIT	SQ FT	SQ FT	SQ FT	SQ FT	SQ YD	SQ YD	TON	EACH	EACH	EACH	EACH	EACH	EACH	SQ YD	TON		FOOT	CU YD	EACH			
1	US 6/52 - McDonough St. at Water Street	NE	1.7	11.1	0.14	0.14	0.14	11.13	0.11	167	10	167		3.9	3.9	0.44													29		
2	US 6/52 - McDonough St. at Water Street	NW	0.9	6.3	0.08	0.08	0.08	6.27	0.06	94	10	94				0.78							7.0	0.6					13		
3	US 6/52 - McDonough St. at Water Street	SE	1.5	10.0	0.12	0.12	0.12	10.00	0.10	150	14	150		2.0	2.0	0.20													27		
4	US 6/52 - McDonough St. at Water Street	SW	2.2	14.3	0.18	0.18	0.18	14.33	0.14	215	12	215																	42		
5	US 6/52 - McDonough St at Des Plaines Street	NE	1.4	9.0	0.11	0.11	0.11	9.00	0.09	135	20	135																	25		
6	US 6/52 - McDonough St at Des Plaines Street	NW	1.6	10.3	0.13	0.13	0.13	10.33	0.10	155	20	155																	30		
7	US 6/52 - McDonough St at Des Plaines Street	SE	1.8	11.9	0.15	0.15	0.15	11.93	0.12	179	20	179		0.9	0.9	0.10													30		
8	US 6/52 - McDonough St at Des Plaines Street	SW	1.2	7.7	0.10	0.10	0.10	7.67	0.08	115	20	115							1	1									30		
9	US 6/52 - McDonough St at Joliet Street	NE	1.1	7.6	0.09	0.09	0.09	7.60	0.08	114	20	114																	26		
10	US 6/52 - McDonough St at Joliet Street	NW	1.1	7.6	0.09	0.09	0.09	7.60	0.08	114	20	114																	29		
11	US 6/52 - McDonough St at Joliet Street	SE	1.1	7.2	0.09	0.09	0.09	7.20	0.07	108	20	108									1								26		
12	US 6/52 - McDonough St at Joliet Street	SW	3.8	25.1	0.31	0.31	0.31	25.07	0.25	376	20	376																	39		
13	US 6/52 - McDonough St at Ottawa Street	NE	1.6	10.4	0.13	0.13	0.13	10.40	0.10	156	20	156																	26		
14	US 6/52 - McDonough St at Ottawa Street	NW	1.5	9.9	0.12	0.12	0.12	9.93	0.10	149	20	149																	24		
15	US 6/52 - McDonough St at Ottawa Street	SE	1.3	8.9	0.11	0.11	0.11	8.87	0.09	133	20	133																	26		
16	US 6/52 - McDonough St at Ottawa Street	SW	1.5	10.0	0.12	0.12	0.12	10.00	0.10	150	20	150																	25		
17	US 52 - Doris Ave. at South Chicago St.	NE	2.4	16.1	0.20	0.20	0.20	16.07	0.16	241	10	241																	14		
18	US 52 - Doris Ave. at South Chicago St.	NW	0.9	6.1	0.08	0.08	0.08	6.13	0.06	92	10	92																	13		
19	US Route 30 (Jefferson Street) at Scott Street	NE	0.6	4.2	0.05	0.05	0.05	4.20	0.04	63	26	315	252																38		
20	US Route 30 (Jefferson Street) at Scott Street	NW	0.4	2.9	0.04	0.04	0.04	2.93	0.03	44	34	219	175						1										29		
21	US Route 30 (Jefferson Street) at Scott Street	SE	0.5	3.1	0.04	0.04	0.04	3.07	0.03	46	24	228	182																36		
22	US Route 30 (Jefferson Street) at Scott Street	SW	0.6	3.8	0.05	0.05	0.05	3.80	0.04	57	28	286	229			0.78			2			1	7.0	0.6	2				35		
23	US 6 at IL Route 30	NE	1.5	9.7	0.12	0.12	0.12	9.73	0.10	146	9	146		1.2	1.2	0.13													34		
24	US 6 at IL Route 30	SE	2.0	13.6	0.17	0.17	0.17	13.60	0.14	204	18	204		1.5	1.5	0.16													42		
25	US 6 at Benton Street	NE	1.9	12.6	0.16	0.16	0.16	12.60	0.13	189	20	189										2							31		
26	US 6 at Benton Street	SE	1.6	10.7	0.13	0.13	0.13	10.67	0.11	160	10	160										2							29		
27	US 6 at Catalpa	NE	0.9	5.9	0.07	0.07	0.07	5.87	0.06	88	8	88		2.2	2.2	0.25						1							31		
28	US 6 at Catalpa	SE	0.7	4.5	0.06	0.06	0.06	4.53	0.05	68	8	68										1							23		
29	US 6 at Clay Street	NE	0.9	5.8	0.07	0.07	0.07	5.80	0.06	87	22	134	47									1							31		
30	US 6 at Clay Street	NW	1.4	9.6	0.12	0.12	0.12	9.60	0.10	144	20	222	78						1										37		
31	US 6 at Clay Street	SW	1.5	10.0	0.12	0.12	0.12	10.00	0.10	150	23	231	81									2							32		
32	US 6 at Parks Avenue	NE	1.0	6.5	0.08	0.08	0.08	6.47	0.06	97	13	97																	24		
33	US 6 at Parks Avenue	NW	4.3	28.7	0.36	0.36	0.36	28.71	0.29	431	20	431		8.7	8.7	0.97						1							47	1	1
34	US 6 at Parks Avenue	SE	1.5	9.9	0.12	0.12	0.12	9.93	0.10	149	20	149				0.78							7.0	0.6					29		
35	US 6 at Parks Avenue	SW	2.5	16.9	0.21	0.21	0.21	16.87	0.17	253	16	253																	24		
36	US 6 at Youngs Avenue	NW	2.8	18.6	0.23	0.23	0.23	18.60	0.19	279	20	279		5.9	5.9	1.44							7.0	0.6					58		
37	US 6 at Youngs Avenue	SE	1.4	9.2	0.11	0.11	0.11	9.20	0.09	138	20	138				0.78						1	7.0	0.6					37		
38	US 6 at Youngs Avenue	SW	1.1	7.1	0.09	0.09	0.09	7.13	0.07	107	18	107										1							26		
39	US 6 at Willard Street	SE	1.1	7.0	0.09	0.09	0.09	7.00	0.07	105	12	105										1							14		
40	US 6 at Willard Street	SW	0.9	6.3	0.08	0.08	0.08	6.27	0.06	94	10	94										1							12		
41	US 6 at Garnsey Avenue	NW	2.2	14.9	0.19	0.19	0.19	14.93	0.15	224	20	224				0.78						1	7.0	0.6					24		
42	US 6 at Landau Street	NE	2.0	13.3	0.17	0.17	0.17	13.33	0.13	200	20	200		0.5	0.5	0.05													30		
43	US 6 at Landau Street	NW	2.0	13.3	0.17	0.17	0.17	13.33	0.13	200	10	200																	51		
44	US 6 at Henderson Avenue	NE	2.6	17.2	0.21	0.21	0.21	17.20	0.17	258	35	258				0.78			1	1			7.0	0.6	1				35		
45	US 6 at Henderson Avenue	NW	0.4	2.5	0.03	0.03	0.03	2.53	0.03	38	18	189	151	1.1	1.1	0.90							7.0	0.6	1				30		
46	US 6 at Henderson Avenue	SE	0.4	2.5	0.03	0.03	0.03	2.53	0.03	38	17	189	151			0.78							7.0	0.6					28		
47	US 6 at Henderson Avenue	SW	0.2	1.3	0.02	0.02	0.02	1.33	0.01	20	16	98	78									1							22		
SUB-TOTAL =			69.2	461.3	5.7	5.7	5.7	461.3	4.6	6919.7	841.0	8343.7	1424.0	27.9	27.9	10.1	2.0	4.0	7.0	8.0	2.0	8.0	63.0	5.4	4.0	1393.0	1.0	1.0			

MODEL: Default
 FILE: \\paw-bentley.com\paw\DOT\Documents\DOT_Offices\Bharat_1\Projects\011372\IC\00Data\Des\pm\011372-1-act-detailed.dgn

1 REVISÉ ENTIRE SHEET 4/13/2022

USER NAME = qarutnm	DESIGNED -	REVISED -
	DRAWN -	REVISED -
PLOT SCALE = 100,0000' / in.	CHECKED -	REVISED -
PLOT DATE = 4/11/2022	DATE -	REVISED -

**STATE OF ILLINOIS
DEPARTMENT OF TRANSPORTATION**

VARIOUS LOCATIONS (JOLIET TOWNSHIP) SCHEDULE OF QUANTITIES (1 OF 2)			
SCALE:	SHEET	OF	SHEETS
	STA.	TO	STA.

F.A. RTE.	SECTION	COUNTY	TOTAL SHEETS	SHEET NO.
VAR	2021-056-SW	WILL	113	14
CONTRACT NO. 62N87				
ILLINOIS		FED. AID PROJECT		

1

ID	LOCATION	CORNER	20200100	21101615	25000400	25000500	25000600	25200110	25200200	42400200	42400800	44000600	42400100	44000100	35400400	40604062	60250200	60255500	60260100	60260300	72400500	89500400	X4406230	X4421000	X8140115	Z0004562	Z0012450	Z0012455
			EARTH EXCAVATION	TOPSOIL FURNISH AND PLACE, 4"	NITROGEN FERTILIZER NUTRIENT	PHOSPHORUS FERTILIZER NUTRIENT	POTASSIUM FERTILIZER NUTRIENT	SODDING, SALT TOLERANT	SUPPLEMENTAL WATERING	PORTLAND CEMENT CONCRETE SIDEWALK 5 INCH	DETECTABLE WARNINGS	SIDEWALK REMOVAL	PORTLAND CEMENT CONCRETE SIDEWALK 4 INCH	PAVEMENT REMOVAL	PCC BASE COURSE WIDENING, 9"	HOT-MIX ASPHALT SURFACE COURSE, IL-9.5, MIX "D", N70	CATCH BASINS TO BE ADJUSTED	MANHOLES TO BE ADJUSTED	INLETS TO BE ADJUSTED	INLETS TO BE ADJUSTED WITH NEW TYPE 1 FRAME, OPEN LID	RELOCATE SIGN PANEL ASSEMBLY - TYPE A	RELOCATE EXISTING PEDESTRIAN PUSH-BUTTON	PARTIAL DEPTH REMOVAL, TYPE II, 3"	PARTIAL DEPTH PATCHING	HANDHOLE TO BE ADJUSTED	COMBINATION CONCRETE CURB AND GUTTER REMOVAL AND REPLACEMENT	CONCRETE STEPS	CONCRETE STEP REMOVAL
			CU YD	SQ YD	POUND	POUND	POUND	SQ YD	UNIT	SQ FT	SQ FT	SQ FT	SQ FT	SQ YD	SQ YD	TON	EACH	EACH	EACH	EACH	EACH	EACH	SQ YD	TON		FOOT	CU YD	EACH
48	US 6 at Abe Street	NE	0.6	3.8	0.05	0.05	0.05	3.80	0.04	57	10	57																14
49	US 6 at Abe Street	NW	1.4	9.3	0.11	0.11	0.11	9.27	0.09	139	10	139									1							20
50	US 6 at Ridgewood	SE	1.0	6.4	0.08	0.08	0.08	6.40	0.06	96	10	96			0.78								7.0	0.6				11
51	US 6 at Ridgewood	SW	0.7	4.9	0.06	0.06	0.06	4.87	0.05	73	10	73							1									18
52	IL Route 171 (Collins St.) at Jackson Street	NE	0.6	3.8	0.05	0.05	0.05	3.80	0.04	57	20	287	230															34
53	IL Route 171 (Collins St.) at Jackson Street	SE	0.4	2.7	0.03	0.03	0.03	2.67	0.03	40	22	202	162															32
54	IL Route 171 - Archer Ave. at Ohio Street	NE	1.5	10.1	0.13	0.13	0.13	10.13	0.10	152	20	234	82	0.4	0.4	0.04				2								37
55	IL Route 171 - Archer Ave. at Ohio Street	NW	1.8	11.9	0.15	0.15	0.15	11.93	0.12	179	31	276	97	10.4	10.4	1.16			1	1								54
56	IL Route 171 - Archer Ave. at Ohio Street	SE	1.1	7.1	0.09	0.09	0.09	7.13	0.07	107	25	164	57															22
57	IL Route 171 - Archer Ave. at Ohio Street	SW	1.0	6.4	0.08	0.08	0.08	6.40	0.06	96	20	148	52			0.78							7.0	0.6				28
58	IL Route 171 - Archer Ave. at Irving Street	NE	1.1	7.1	0.09	0.09	0.09	7.07	0.07	106	20	163	57							2						1		30
59	IL Route 171 - Archer Ave. at Irving Street	SE	1.1	7.5	0.09	0.09	0.09	7.47	0.07	112	27	173	61													1		25
60	IL Route 171 - Archer Ave. at Irving Street	SW	1.3	8.7	0.11	0.11	0.11	8.73	0.09	131	20	202	71													1		24
61	US Route 6 at Walnut Avenue	NE	1.4	9.2	0.11	0.11	0.11	9.20	0.09	138	10	138				0.78							7.0	0.6				32
62	US 30 (Cass St.) at Algonquin Street	NE	0.5	3.1	0.04	0.04	0.04	3.13	0.03	47	21	47				0.78							7.0	0.6				26
63	IL 171 (Collins Street) at Liberty Street	NE	1.0	6.3	0.08	0.08	0.08	6.33	0.06	95	24	147	52							2								28
64	IL 171 (Collins Street) at Liberty Street	NW	0.9	6.1	0.08	0.08	0.08	6.07	0.06	91	27	140	49							1								22
65	IL 171 (Collins Street) at Liberty Street	SE	1.6	10.9	0.14	0.14	0.14	10.93	0.11	164	23	253	89							2								25
66	IL 171 (Collins Street) at Liberty Street	SW	1.3	8.5	0.10	0.10	0.10	8.47	0.08	127	20	196	69							1								23
67	IL 171 (Collins Street) at Columbia Street	SE	0.4	2.3	0.03	0.03	0.03	2.33	0.02	35	28	176	141	7.6	7.6	0.85									1			42
68	IL 171 (Collins Street) at Elwood Street	NE	0.4	2.7	0.03	0.03	0.03	2.67	0.03	40	15	200	160							2								27
69	IL 171 (Collins Street) at Elwood Street	SE	0.4	2.6	0.03	0.03	0.03	2.60	0.03	39	10	199	160	0.7	0.7	0.07				2								23
70	IL 171 (Collins Street) at Ward Avenue	NE	1.2	8.1	0.10	0.10	0.10	8.13	0.08	122	25	188	66							1								28
71	IL 171 (Collins Street) at Ward Avenue	SE	1.4	9.2	0.11	0.11	0.11	9.20	0.09	138	19	213	75							1								30
72	IL 171 (Collins Street) at Chase Avenue	NE	1.8	11.7	0.14	0.14	0.14	11.67	0.12	175	10	175										1						26
73	IL 171 (Collins Street) at Chase Avenue	SE	3.4	22.5	0.28	0.28	0.28	22.53	0.23	338	10	338								1								32
74	IL 171 (Collins Street) at Williamson Avenue	NE	0.5	3.1	0.04	0.04	0.04	3.13	0.03	47	10	47				0.78							7.0	0.6				20
75	IL 171 (Collins Street) at Williamson Avenue	SE	0.5	3.5	0.04	0.04	0.04	3.53	0.04	53	10	53																30
76	IL 171 (Collins Street) at Bruce Street	NW	0.6	3.7	0.05	0.05	0.05	3.67	0.04	55	14	55				0.78							7.0	0.6				15
77	IL 171 (Collins Street) at Bruce Street	SW	0.6	3.7	0.05	0.05	0.05	3.73	0.04	56	15	56				0.78							7.0	0.6				16
78	IL 171 (Collins Street) at Gross Street	NW	0.4	2.9	0.04	0.04	0.04	2.87	0.03	43	10	43				0.78							7.0	0.6				19
79	IL 171 (Collins Street) at Gross Street	SW	0.4	2.7	0.03	0.03	0.03	2.67	0.03	40	10	40																25
80	IL 171 (Collins Street) at Woodruff Road	NE	0.8	5.3	0.07	0.07	0.07	5.33	0.05	80	10	80													1			7
81	IL 171 (Collins Street) at Woodruff Road	NW	1.3	8.8	0.11	0.11	0.11	8.80	0.09	132	20	132				0.78				1			1	7.0	0.6			12
82	IL 171 (Collins Street) at Woodruff Road	SW	0.4	2.9	0.04	0.04	0.04	2.93	0.03	44	10	44				0.78							1	7.0	0.6			6
83	IL 171 (Collins Street) at Riley Avenue	NE	0.7	4.9	0.06	0.06	0.06	4.93	0.05	74	10	74				0.78							2					14
84	IL 171 (Collins Street) at Riley Avenue	SE	0.4	2.5	0.03	0.03	0.03	2.47	0.02	37	10	37				0.78							7.0	0.6				9
85	I-55 (Frontage Road) at Black Road	SE	2.2	14.7	0.18	0.18	0.18	14.67	0.15	220	10	220														1		15
86	I-55 (Frontage Road) at Black Road	SW	0.9	5.7	0.07	0.07	0.07	5.73	0.06	86	10	86				0.78							1	7.0	0.6			11
87	IL Route 7 (Larkin Ave) at McDonough St	NE	3.5	23.5	0.29	0.29	0.29	23.47	0.23	352	20	352				0.78							1	7.0	0.6			41
88	IL Route 7 (Larkin Ave) at McDonough St	NW	1.8	11.9	0.15	0.15	0.15	11.87	0.12	178	24	178				0.78							1	7.0	0.6			32
89	IL Route 7 (Larkin Ave) at McDonough St	SE	6.0	40.2	0.50	0.50	0.50	40.20	0.40	603	20	603				0.78							1	7.0	0.6			97
90	IL Route 7 (Larkin Ave) at McDonough St	SW	2.1	14.2	0.18	0.18	0.18	14.20	0.14	213	20	213											1					49
91	IL Route 7 (Larkin Ave) at US Route 52	NE	5.9	39.3	0.49	0.49	0.49	39.33	0.39	590	18	590		4.7	4.7	1.31							1	7.0	0.6			125
92	IL Route 7 (Larkin Ave) at US Route 52	NW	2.1	13.8	0.17	0.17	0.17	13.80	0.14	207	9	207		2.6	2.6	1.08							1	7.0	0.6			55
93	IL Route 7 (Larkin Ave) at US Route 52	SE	1.9	12.3	0.15	0.15	0.15	12.33	0.12	185	11	185											1	7.0	0.6			40
SUB-TOTAL =			131	874	11	11	11	874	9	13109	1599	16263	3154	54	54	27	2	4	15	27	4	24	196	17	4	2744	1	1

MODEL: Default
 FILE: \\paw.bentley.com\paw\dwg\13721\UC000000.dwg
 PROJECT: 13721\UC000000.dwg
 USER: qarutnm
 PLOT SCALE: 100.0000' / in.
 PLOT DATE: 4/11/2022

USER NAME = qarutnm	DESIGNED -	REVISED -
	DRAWN -	REVISED -
PLOT SCALE = 100.0000' / in.	CHECKED -	REVISED -
PLOT DATE = 4/11/2022	DATE -	REVISED -

**STATE OF ILLINOIS
 DEPARTMENT OF TRANSPORTATION**

**VARIOUS LOCATIONS (JOLIET TOWNSHIP)
 SCHEDULE OF QUANTITIES (2 OF 2)**

SCALE: SHEET OF SHEETS STA. TO STA.

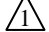

REVISED ENTIRE SHEET 4/13/2022

F.A. RTE.	SECTION	COUNTY	TOTAL SHEETS	SHEET NO.
	2021-056-SW	WILL	113	14A
CONTRACT NO. 62N87				
ILLINOIS		FED. AID PROJECT		

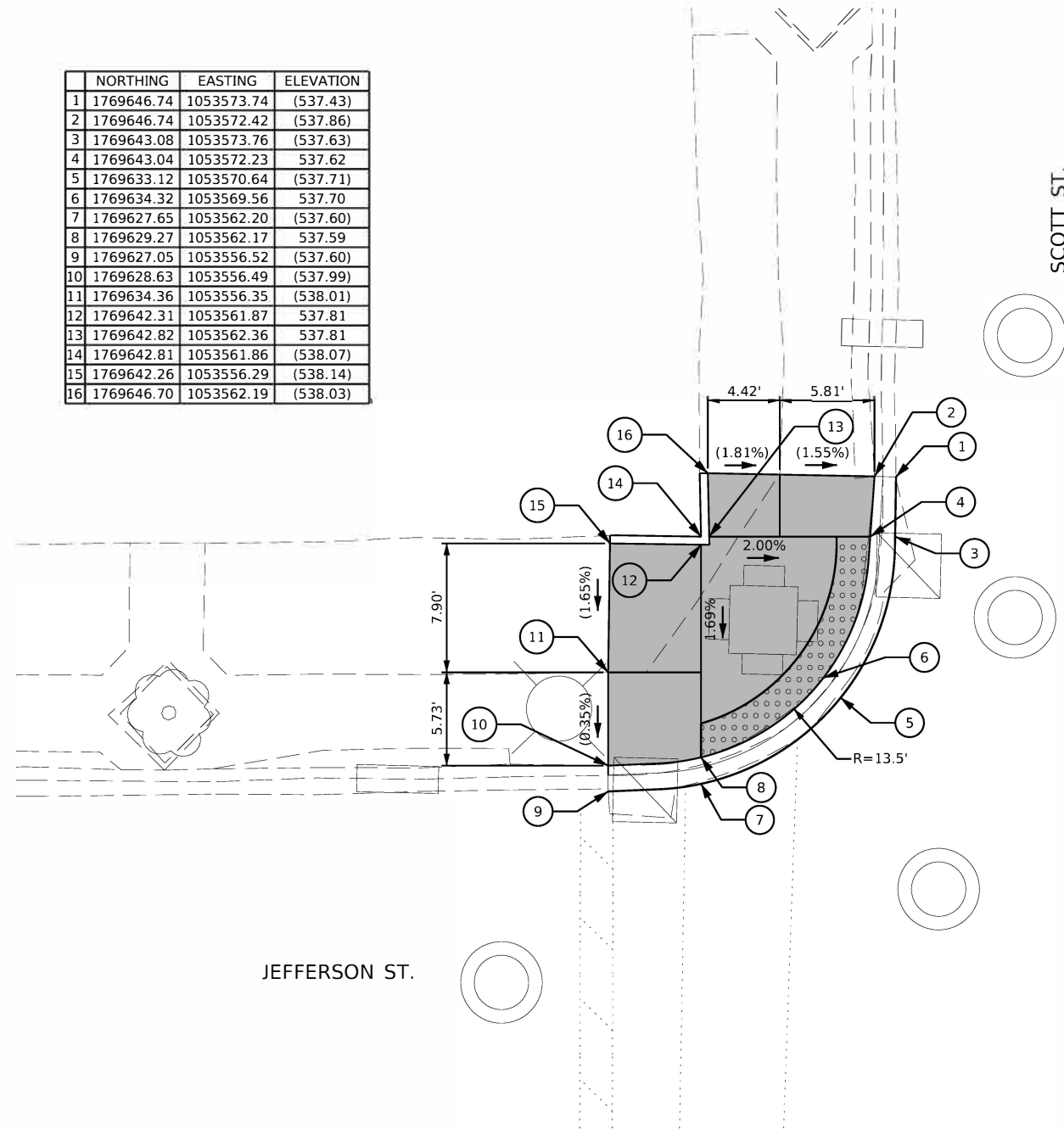
	NORTHING	EASTING	ELEVATION
1	1769646.74	1053573.74	(537.43)
2	1769646.74	1053572.42	(537.86)
3	1769643.08	1053573.76	(537.63)
4	1769643.04	1053572.23	537.62
5	1769633.12	1053570.64	(537.71)
6	1769634.32	1053569.56	537.70
7	1769627.65	1053562.20	(537.60)
8	1769629.27	1053562.17	537.59
9	1769627.05	1053556.52	(537.60)
10	1769628.63	1053556.49	(537.99)
11	1769634.36	1053556.35	(538.01)
12	1769642.31	1053561.87	537.81
13	1769642.82	1053562.36	537.81
14	1769642.81	1053561.86	(538.07)
15	1769642.26	1053556.29	(538.14)
16	1769646.70	1053562.19	(538.03)

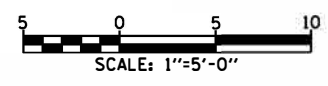
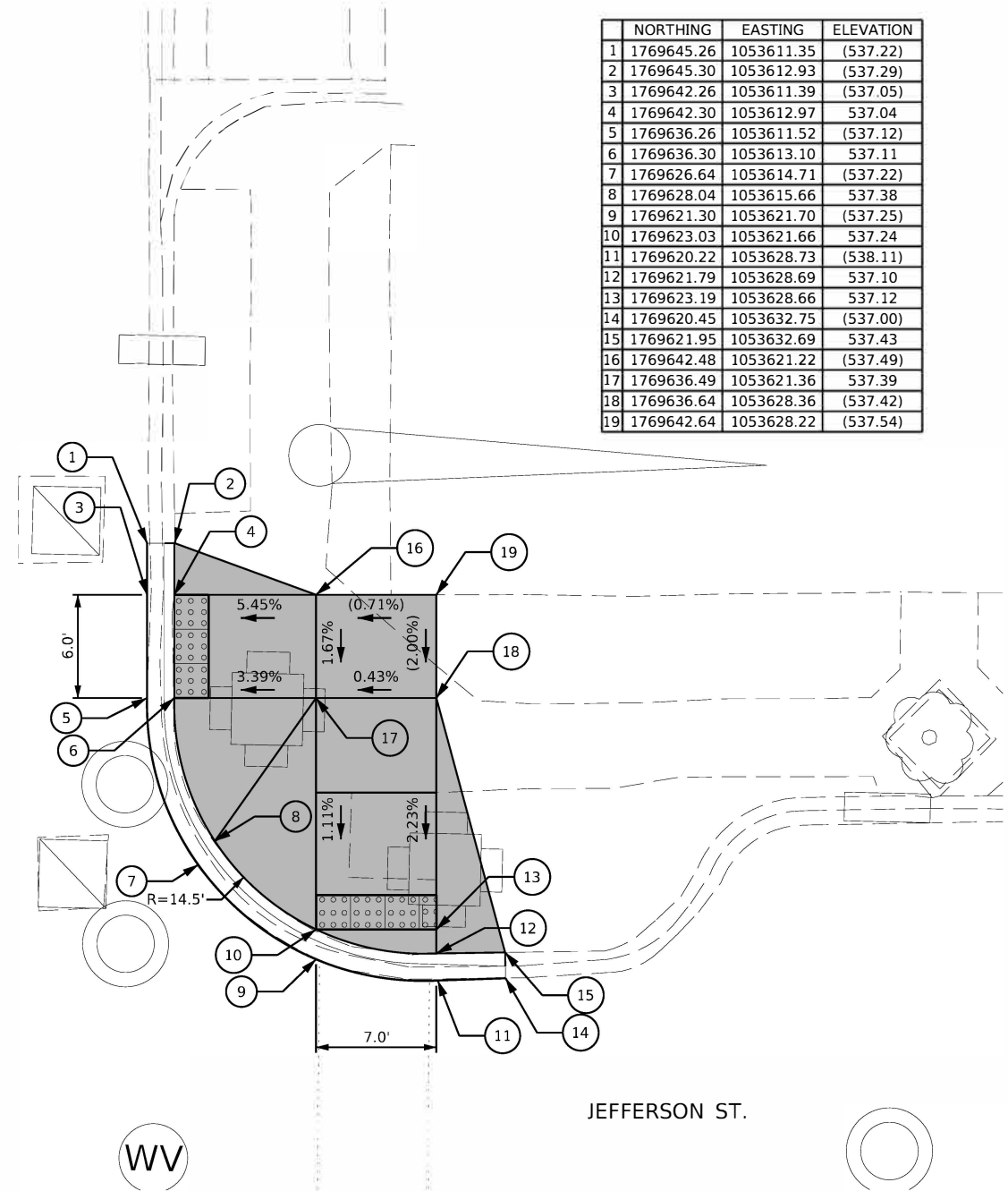

	NORTHING	EASTING	ELEVATION
1	1769645.26	1053611.35	(537.22)
2	1769645.30	1053612.93	(537.29)
3	1769642.26	1053611.39	(537.05)
4	1769642.30	1053612.97	537.04
5	1769636.26	1053611.52	(537.12)
6	1769636.30	1053613.10	537.11
7	1769626.64	1053614.71	(537.22)
8	1769628.04	1053615.66	537.38
9	1769621.30	1053621.70	(537.25)
10	1769623.03	1053621.66	537.24
11	1769620.22	1053628.73	(538.11)
12	1769621.79	1053628.69	537.10
13	1769623.19	1053628.66	537.12
14	1769620.45	1053632.75	(537.00)
15	1769621.95	1053632.69	537.43
16	1769642.48	1053621.22	(537.49)
17	1769636.49	1053621.36	537.39
18	1769636.64	1053628.36	(537.42)
19	1769642.64	1053628.22	(537.54)



REFERENCE BENCHMARK ELEVATION: 537.26

BENCHMARK 207: CUT SQUARE AT SOUTHWEST CORNER OF CONCRETE TRAFFIC SIGNAL CONTROL BOX FOUNDATION AT SOUTHEAST CORNER OF SCOTT ST. AND JEFFERSON ST.

LEGEND	
	DETECTABLE WARNINGS
	PCC SIDEWALK, 5 INCH
	EXISTING ELEVATION / SLOPE
	CONCRETE CURB, TYPE B
	COMBINATION CONCRETE CURB AND GUTTER

MODEL: SHORLNAME; FILE: NAME: L13762_03CAD\13762\ADA 01 Ramps 1 & 2.dgn

USER NAME = weldin ghdf	DESIGNED - WME	RL VISITED / APPROVED BY / DATE
	DRAWN - WME	REVISER -
PLOT SCALE = 1:10	CHECKED - CEL	REVISER -
PLOT DATE = 4/8/2022	DATE = 04/08/22	REVISER -

STATE OF ILLINOIS
DEPARTMENT OF TRANSPORTATION

JOLIET TOWNSHIP - ADA IMPROVEMENTS
VARIOUS LOCATIONS (JOLIET TOWNSHIP)

SCALE: SHEET OF SHEETS STA. TO STA.

F.A. RTE.	SECTION	COUNTY	TOTAL SHEETS	SHEET NO.
VAR	2021-056-SW	WILL	113	30

CONTRACT NO. 62N87

ILLINOIS FED. AID PROJECT

REVISOR'S MARK: REVISED ENTIRE SHEET 4/13/2022



JEFFERSON ST.

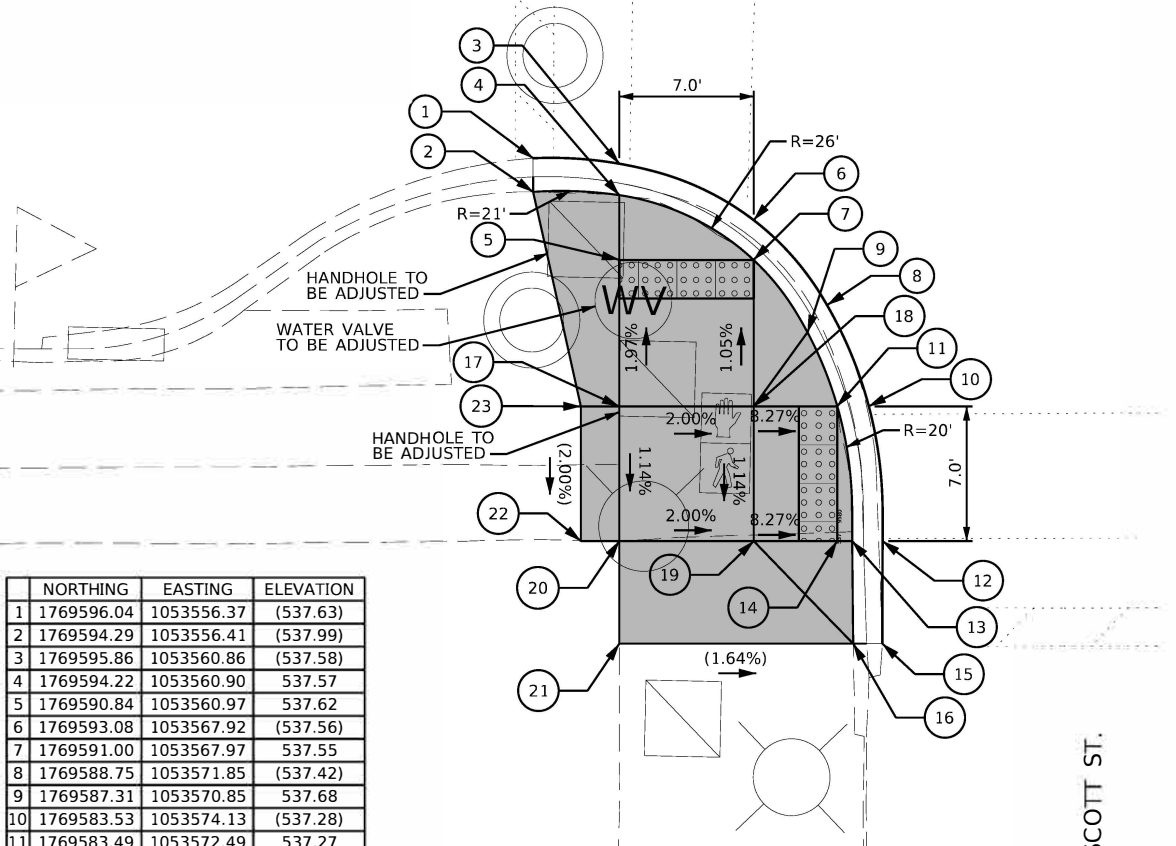

	NORTHING	EASTING	ELEVATION
1	1769596.04	1053556.37	(537.63)
2	1769594.29	1053556.41	(537.99)
3	1769595.86	1053560.86	(537.58)
4	1769594.22	1053560.90	537.57
5	1769590.84	1053560.97	537.62
6	1769593.08	1053567.92	(537.56)
7	1769591.00	1053567.97	537.55
8	1769588.75	1053571.85	(537.42)
9	1769587.31	1053570.85	537.68
10	1769583.53	1053574.13	(537.28)
11	1769583.49	1053572.49	537.27
12	1769576.55	1053575.01	(537.19)
13	1769576.51	1053573.42	537.18
14	1769576.50	1053572.65	537.19
15	1769571.21	1053575.12	(536.93)
16	1769571.18	1053573.60	(537.49)
17	1769583.24	1053561.14	537.77
18	1769583.40	1053568.14	537.63
19	1769576.40	1053568.30	537.55
20	1769576.24	1053561.30	537.69
21	1769570.90	1053561.42	(537.69)
22	1769576.20	1053559.30	(537.77)
23	1769583.19	1053559.14	(537.91)

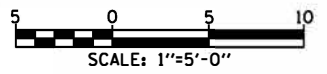

JEFFERSON ST.

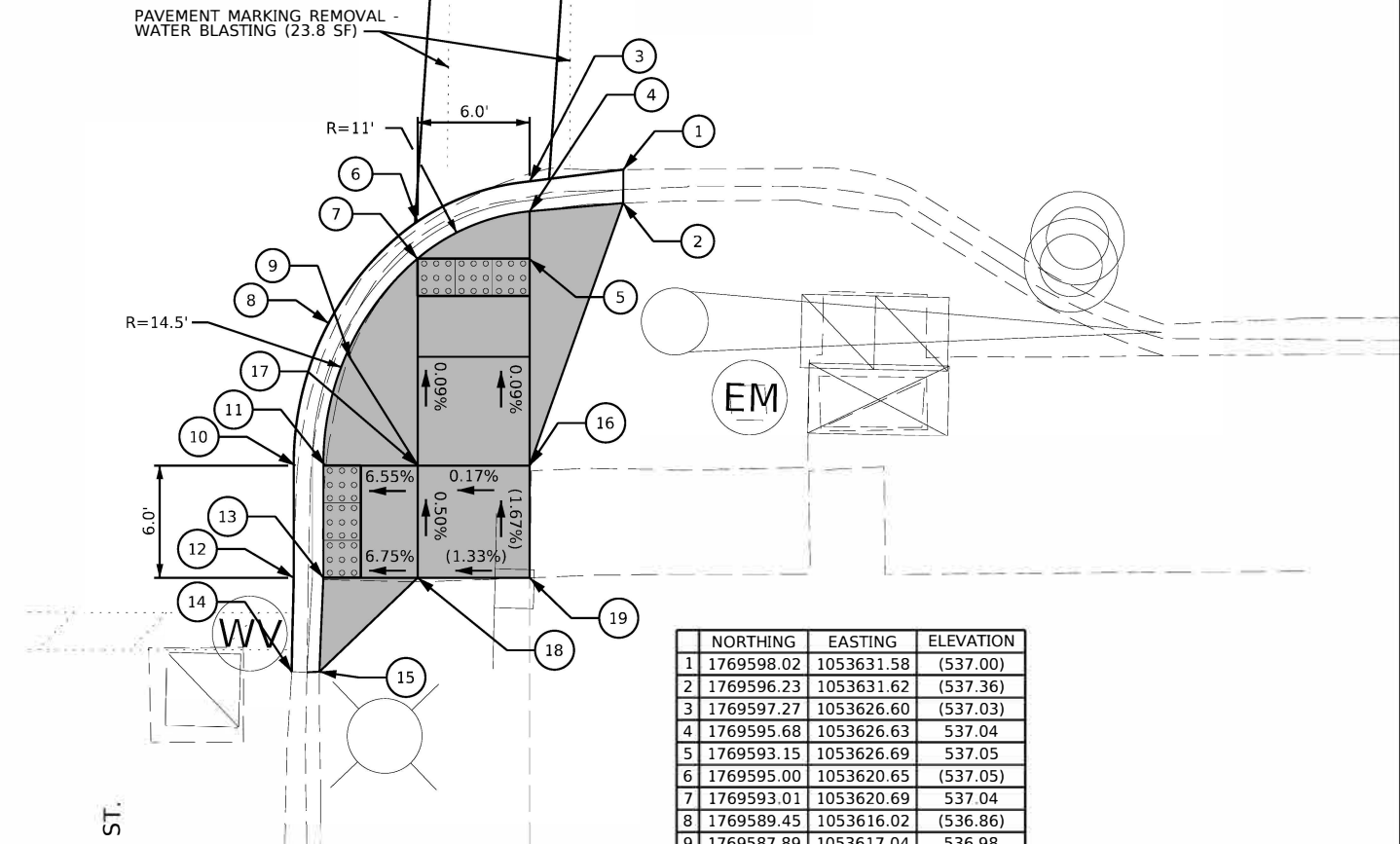

	NORTHING	EASTING	ELEVATION
1	1769598.02	1053631.58	(537.00)
2	1769596.23	1053631.62	(537.36)
3	1769597.27	1053626.60	(537.03)
4	1769595.68	1053626.63	537.04
5	1769593.15	1053626.69	537.05
6	1769595.00	1053620.65	(537.05)
7	1769593.01	1053620.69	537.04
8	1769589.45	1053616.02	(536.86)
9	1769587.89	1053617.04	536.98
10	1769581.79	1053614.32	(536.73)
11	1769581.83	1053615.90	536.72
12	1769575.79	1053614.45	(536.67)
13	1769575.83	1053616.04	536.74
14	1769570.76	1053614.46	(536.59)
15	1769570.79	1053615.94	(536.98)
16	1769582.07	1053626.94	(537.06)
17	1769581.94	1053620.94	537.05
18	1769575.94	1053621.08	(537.08)
19	1769576.08	1053627.07	(537.16)

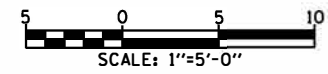

LEGEND

- DETECTABLE WARNINGS
- PCC SIDEWALK, 5 INCH
- () EXISTING ELEVATION / SLOPE
- CONCRETE CURB, TYPE B
- COMBINATION CONCRETE CURB AND GUTTER

REFERENCE BENCHMARK ELEVATION: 537.26

BENCHMARK 207: CUT SQUARE AT SOUTHWEST CORNER OF CONCRETE TRAFFIC SIGNAL CONTROL BOX FOUNDATION AT SOUTHEAST CORNER OF SCOTT ST. AND JEFFERSON ST.

MODEL: s40DELNAME
FILE: NAME: L37162_03\CAD\USHS\ADA_Ramps\G2\N87_ADA_02_Ramps_3 & 4.dgn

USER NAME = weldringhoff	DESIGNED - WME	REVISED ADDENDUM A 04/08/22
PLOT SCALE = 1:10	DRAWN - WME	REVISED -
PLOT DATE = 4/8/2022	CHECKED - CEL	REVISED -
	DATE - 04/08/22	REVISED -

**STATE OF ILLINOIS
DEPARTMENT OF TRANSPORTATION**

**JOLIET TOWNSHIP - ADA IMPROVEMENTS
VARIOUS LOCATIONS (JOLIET TOWNSHIP)**

SCALE: SHEET OF SHEETS STA. TO STA.

REVISED ENTIRE SHEET 4/13/2022

F.A. RTE.	SECTION	COUNTY	TOTAL SHEETS	SHEET NO.
VAR	2021-056-SW	WILL	113	31
CONTRACT NO. 62N87				
ILLINOIS FED. AID PROJECT				

	NORTHING	EASTING	ELEVATION
1	1772072.81	1056274.33	(547.09)
2	1772072.77	1056272.63	547.52
3	1772068.38	1056272.28	(547.10)
4	1772068.35	1056270.40	547.20
5	1772068.30	1056266.11	547.29
6	1772063.33	1056268.49	(547.17)
7	1772063.30	1056266.17	547.21
8	1772060.16	1056264.82	(547.19)
9	1772061.33	1056263.73	547.50
10	1772058.40	1056262.02	(547.23)
11	1772060.21	1056262.00	547.30
12	1772056.31	1056257.05	(547.29)
13	1772057.97	1056257.03	547.30
14	1772060.15	1056257.00	547.34
15	1772055.40	1056252.89	(547.30)
16	1772057.00	1056252.87	547.69
17	1772054.71	1056233.09	(547.39)
18	1772056.29	1056233.07	(547.78)
19	1772072.58	1056262.68	(547.93)
20	1772068.26	1056262.73	547.57
21	1772063.25	1056261.96	547.51
22	1772062.41	1056256.97	547.53
23	1772060.83	1056233.04	(547.78)
24	1772072.48	1056256.85	(548.01*)
25	1772068.19	1056256.90	547.65*
26	1772068.13	1056252.72	(547.98*)
27	1772067.90	1056232.98	(547.90)

* ELEVATIONS ARE AT TOP OF SIDEWALK (BENEATH CONCRETE STEPS)

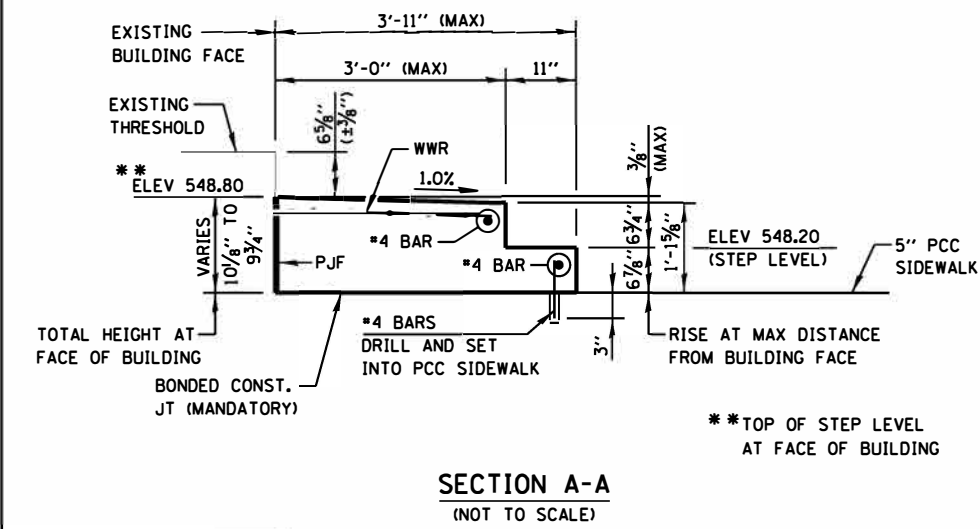
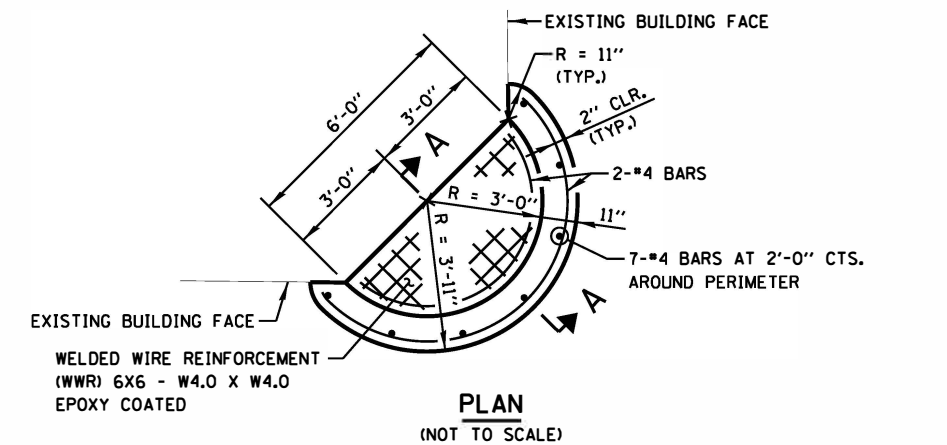
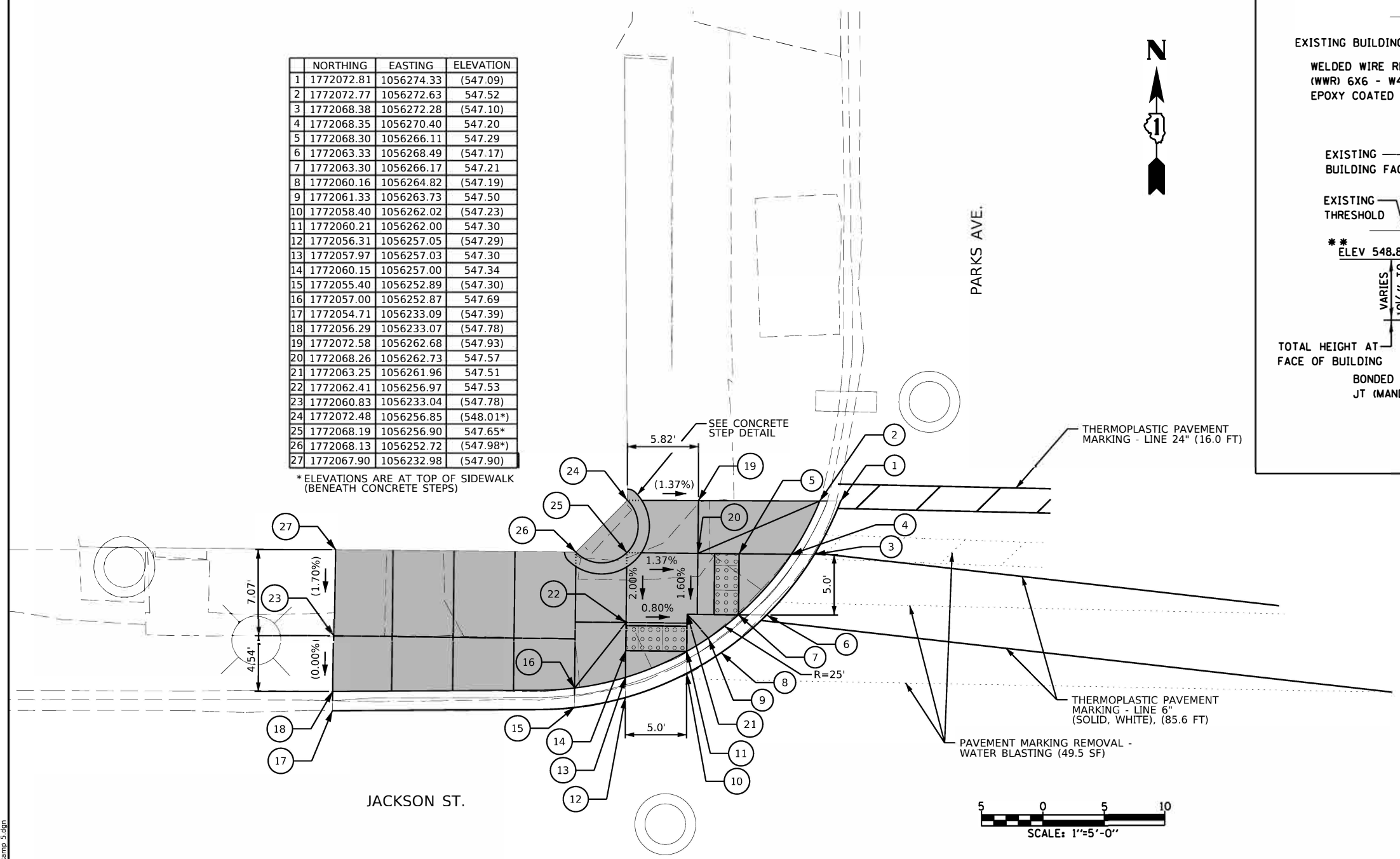

CONCRETE STEP DETAIL

NOTES

- ALL REINFORCEMENT BARS AND WELDED WIRE REINFORCEMENT (WWR) USED IN THE CONCRETE STEPS SHALL BE EPOXY COATED.
- REINFORCEMENT BARS AND WELDED WIRE REINFORCEMENT SHALL BE INCLUDED IN THE COST OF "CONCRETE STEPS".
- #4 BARS SHALL BE PREFABRICATED RADIALLY. WITH THE EXCEPTION OF MINOR ADJUSTMENTS, BENDING OF THE BARS IN THE FIELD WILL NOT BE ALLOWED.
- DRILL AND SET #4 BARS ACCORDING TO ARTICLE 509.06 OF THE STANDARD SPECIFICATIONS. DRILLED HOLES SHALL BE ROUGHENED OR SCORED PER MANUFACTURER'S RECOMMENDATIONS. MAX DEPTH OF HOLE SHALL NOT EXCEED 3". THE COST OF DRILLING AND SETTING BARS SHALL BE INCLUDED IN THE COST OF "CONCRETE STEPS".
- APPLY TWO (2) COATS OF PROTECTIVE COAT TO ALL EXPOSED SURFACES OF THE CONCRETE STEP ACCORDING TO ARTICLE 503.19 OF THE STANDARD SPECIFICATIONS.

REFERENCE BENCHMARK ELEVATION: 549.10
 BENCHMARK 200: CUT SQUARE AT NORTHEAST CORNER OF CONCRETE RAMP FOR NORTHEASTERN ENTRANCE TO CRYBABIES TAP.

LEGEND	
	DETECTABLE WARNINGS
	PCC SIDEWALK, 5 INCH
	() EXISTING ELEVATION / SLOPE
	CONCRETE CURB, TYPE B
	COMBINATION CONCRETE CURB AND GUTTER

STATE OF ILLINOIS
 DEPARTMENT OF TRANSPORTATION

JOLIET TOWNSHIP - ADA IMPROVEMENTS
 VARIOUS LOCATIONS (JOLIET TOWNSHIP)

REVISED ENTIRE SHEET 4/13/2022

USER NAME = weldringhoff	DESIGNED - WME	REVISED - ADDENDUM A 04/08/22
PLOT SCALE = 1:10	CHECKED - CEL	REVISED -
PLOT DATE = 4/8/2022	DATE - 04/08/22	REVISED -

SCALE: SHEET OF SHEETS STA. TO STA.

F.A. RTE.	SECTION	COUNTY	TOTAL SHEETS	SHEET NO.
VAR	2021-056-SW	WILL	113	42A
CONTRACT NO. 62N87				

MODEL: #MODELNAME
 FILE: NAME: L17762_03\CAD\Sheet\ADA_Ramp\62N87_ADA_03_Ramp_5.dgn

	NORTHING	EASTING	ELEVATION
1	1772110.91	1057922.93	(546.76)
2	1772110.87	1057921.33	(547.12)
3	1772110.36	1057921.26	(547.14)
4	1772102.60	1057920.99	(546.92)
5	1772102.57	1057919.32	546.94
6	1772096.62	1057917.82	(547.15)
7	1772097.83	1057916.76	547.14
8	1772092.42	1057912.88	(547.12)
9	1772094.24	1057912.84	547.11
10	1772090.14	1057905.28	(547.27)
11	1772091.72	1057905.23	(547.68)
12	1772116.57	1057917.34	(547.72)
13	1772110.00	1057917.62	547.21
14	1772097.32	1057905.07	(547.60)
15	1772116.42	1057912.96	(547.80)
16	1772116.40	1057912.46	(547.81)
17	1772102.43	1057913.15	547.06
18	1772101.92	1057912.66	547.06
19	1772102.42	1057912.65	(547.62)
20	1772101.89	1057905.17	(547.68)
21	1772102.39	1057905.18	(537.69)

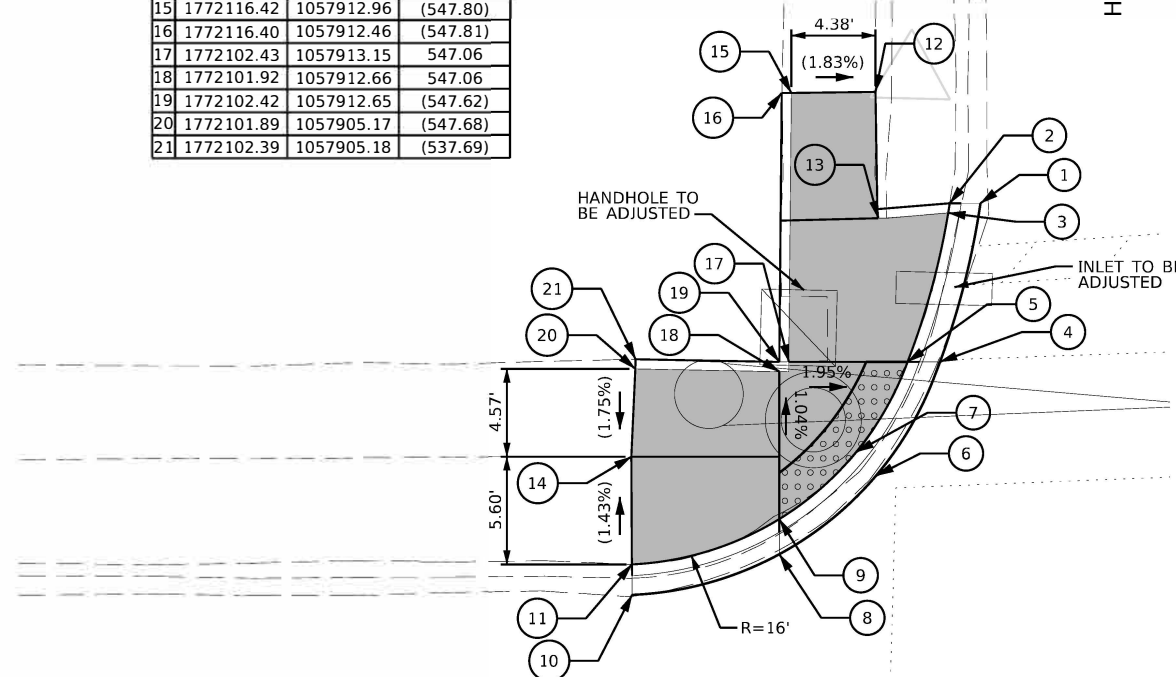

	NORTHING	EASTING	ELEVATION
1	1772109.04	1057951.07	(547.00)
2	1772109.07	1057952.69	(547.40)
3	1772105.54	1057950.54	(547.09)
4	1772105.57	1057952.14	547.08
5	1772095.83	1057953.99	(547.30)
6	1772097.00	1057955.05	547.29
7	1772092.11	1057963.89	(547.36)
8	1772094.20	1057963.84	547.31
9	1772092.32	1057970.90	(547.41)
10	1772094.37	1057970.85	547.59
11	1772092.53	1057976.08	(547.48)
12	1772094.79	1057976.03	(547.80)
13	1772113.54	1057956.06	(547.73)
14	1772105.73	1057960.28	547.24
15	1772101.00	1057963.67	547.33
16	1772100.50	1057970.70	547.69
17	1772100.63	1057975.88	(547.87)
18	1772113.73	1057912.66	(547.81)
19	1772113.76	1057960.62	(547.82)
20	1772102.85	1057960.33	547.30
21	1772103.38	1057960.82	(547.92)
22	1772103.06	1057963.06	547.35
23	1772103.59	1057963.53	(547.87)
24	1772101.50	1057963.66	(547.93)
25	1772101.13	1057966.19	547.47
26	1772101.60	1057965.65	(547.89)
27	1772103.66	1057966.01	547.52
28	1772104.18	1057965.47	(547.88)
29	1772102.86	1057970.64	547.74
30	1772103.36	1057970.63	(547.86)
31	1772102.99	1057975.83	(547.88)
32	1772103.49	1057975.81	(547.88)

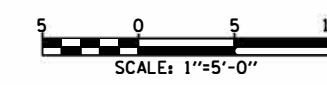
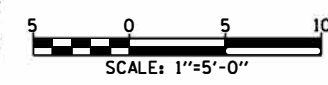
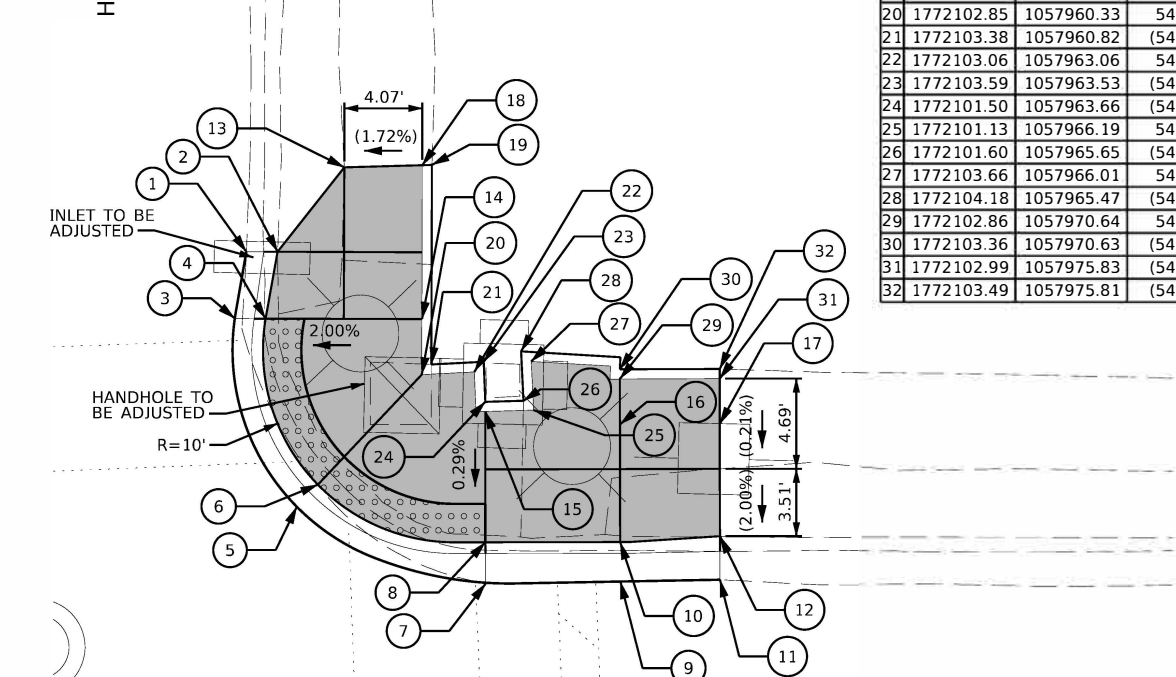

REFERENCE BENCHMARK ELEVATION: 548.59

BENCHMARK 209: CUT SQUARE AT NORTHWEST CORNER OF CONCRETE TRAFFIC SIGNAL CONTROL BOX FOUNDATION AT SOUTHEAST CORNER OF HENDERSON AVE. AND JACKSON ST.

LEGEND	
	DETECTABLE WARNINGS
	CONCRETE CURB, TYPE B
	PCC SIDEWALK, 5 INCH
	COMBINATION CONCRETE CURB AND GUTTER
	EXISTING ELEVATION / SLOPE

MODEL: s:\MODEL\NAMES FILE NAME: L:\7162_03\CAD\Sheet\ADA_Ramp\62N87_ADA 04 Ramp 6 & 7.dwg

USER NAME = weldir_nighoff	DESIGNED - WME	REVISED - ADDENDUM A 04/08/22
PLOT SCALE = 1:10	CHECKED - CEL	REVISED -
PLOT DATE = 4/8/2022	DATE = 04/08/22	REVISED -

STATE OF ILLINOIS
DEPARTMENT OF TRANSPORTATION

JOLIET TOWNSHIP - ADA IMPROVEMENTS
VARIOUS LOCATIONS (JOLIET TOWNSHIP)

SCALE: SHEET OF SHEETS STA. TO STA.

REVISD ENTIRE SHEET 4/13/2022				
F.A. RTE.	SECTION	COUNTY	TOTAL SHEETS	SHEET NO.
VAR	2021-056-SW	WILL	113	55
			CONTRACT NO. 62N87	
ILLINOIS FED. AID PROJECT				



JACKSON ST.

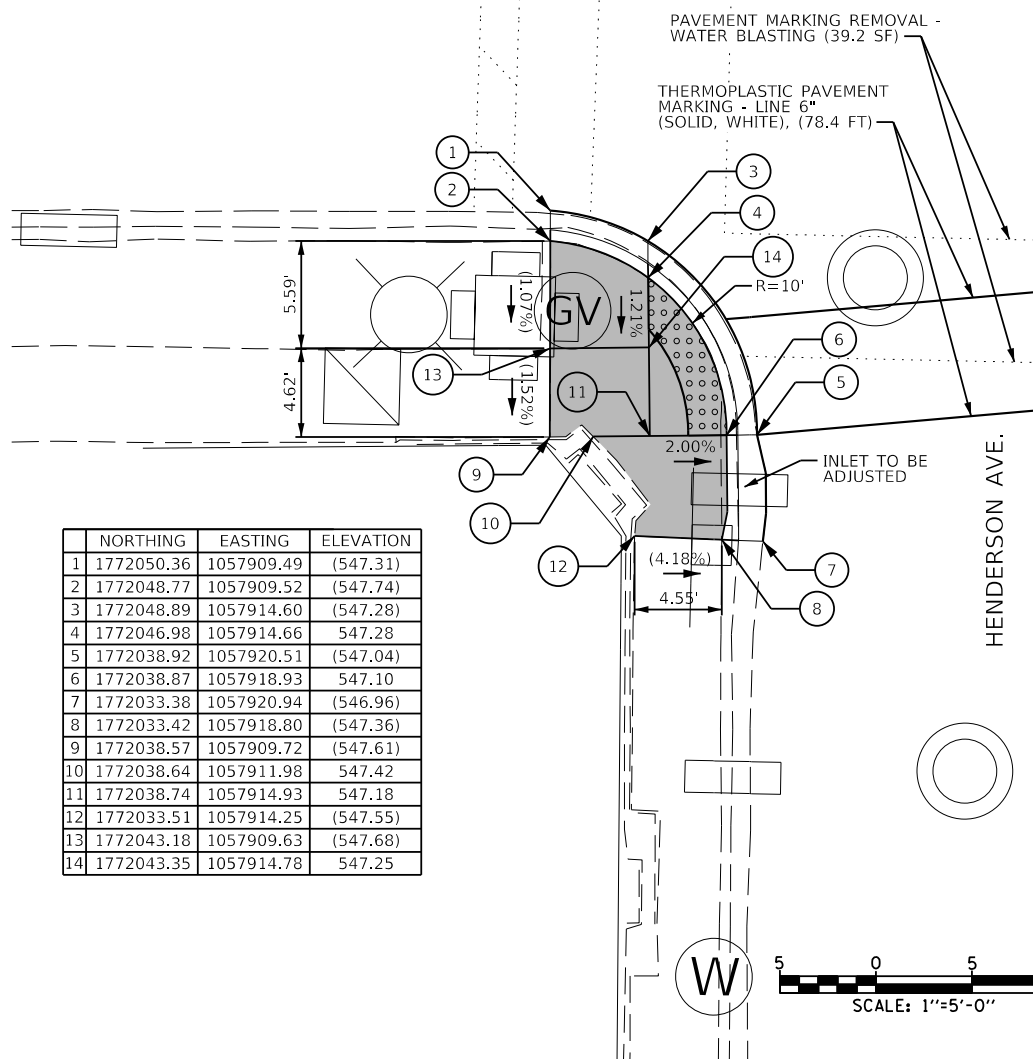

	NORTHING	EASTING	ELEVATION
1	1772050.36	1057909.49	(547.31)
2	1772048.77	1057909.52	(547.74)
3	1772048.89	1057914.60	(547.28)
4	1772046.98	1057914.66	547.28
5	1772038.92	1057920.51	(547.04)
6	1772038.87	1057918.93	547.10
7	1772033.38	1057920.94	(546.96)
8	1772033.42	1057918.80	(547.36)
9	1772038.57	1057909.72	(547.61)
10	1772038.64	1057911.98	547.42
11	1772038.74	1057914.93	547.18
12	1772033.51	1057914.25	(547.55)
13	1772043.18	1057909.63	(547.68)
14	1772043.35	1057914.78	547.25

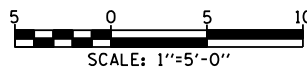

JACKSON ST.

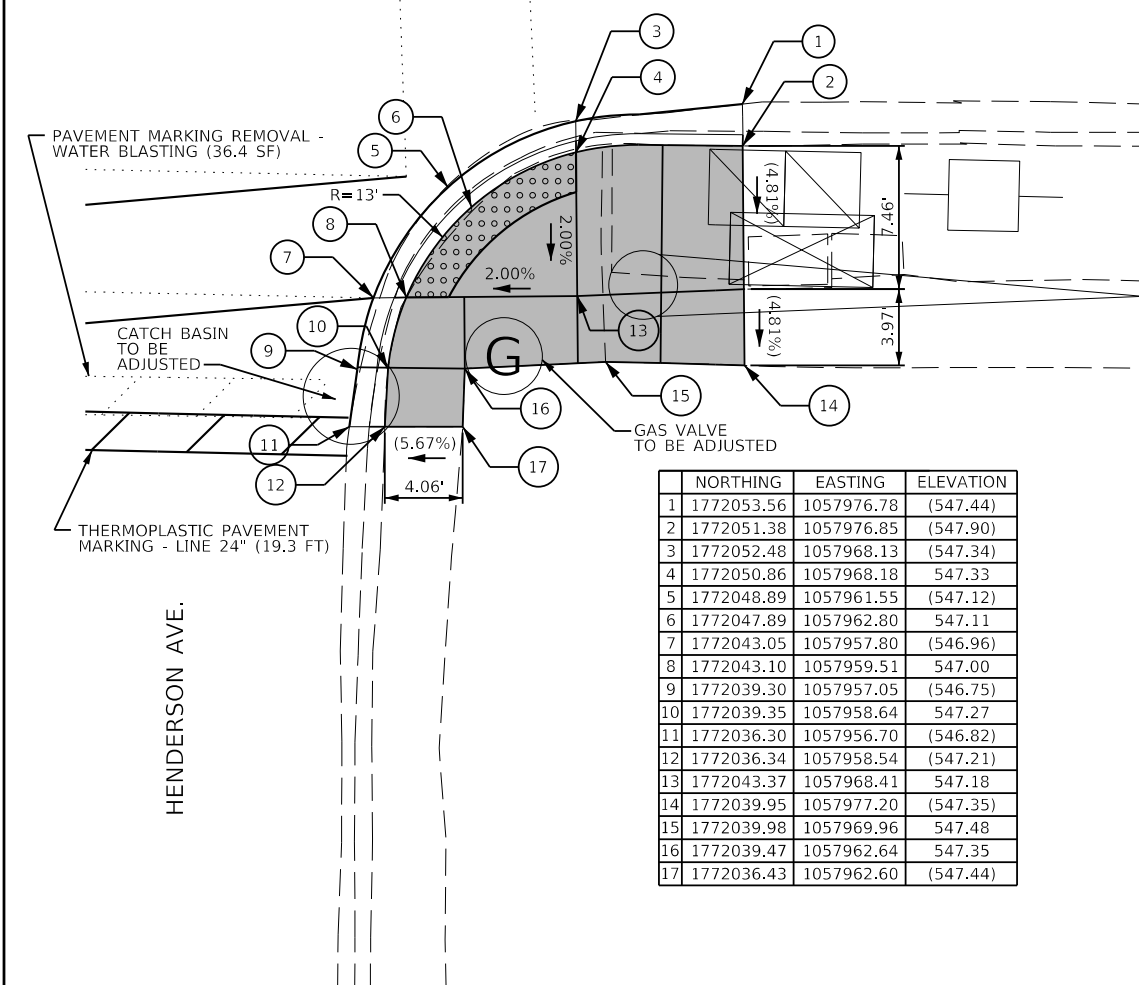

	NORTHING	EASTING	ELEVATION
1	1772053.56	1057976.78	(547.44)
2	1772051.38	1057976.85	(547.90)
3	1772052.48	1057968.13	(547.34)
4	1772050.86	1057968.18	547.33
5	1772048.89	1057961.55	(547.12)
6	1772047.89	1057962.80	547.11
7	1772043.05	1057957.80	(546.96)
8	1772043.10	1057959.51	547.00
9	1772039.30	1057957.05	(546.75)
10	1772039.35	1057958.64	547.27
11	1772036.30	1057956.70	(546.82)
12	1772036.34	1057958.54	(547.21)
13	1772043.37	1057968.41	547.18
14	1772039.95	1057977.20	(547.35)
15	1772039.98	1057969.96	547.48
16	1772039.47	1057962.64	547.35
17	1772036.43	1057962.60	(547.44)

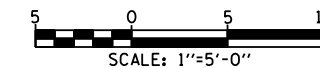

MODEL: 4400BENMARKS
FILE NAME: L21762_03\CAD\Sheet\ADA_Ramps\62N87_ADA_05_Ramps_8 & 9.dwg

REFERENCE BENCHMARK ELEVATION: 548.59

BENCHMARK 209: CUT SQUARE AT NORTHWEST CORNER OF CONCRETE TRAFFIC SIGNAL CONTROL BOX FOUNDATION AT SOUTHEAST CORNER OF HENDERSON AVE. AND JACKSON ST.



DETECTABLE WARNINGS



PCC SIDEWALK, 5 INCH



EXISTING ELEVATION / SLOPE

LEGEND



CONCRETE CURB, TYPE B



COMBINATION CONCRETE CURB AND GUTTER

USER NAME = weldringhoff	DESIGNED - WME	REVISED ADDENDUM A 04/08/22
PLOT SCALE = 1:10	DRAWN - WME	REVISED -
PLOT DATE = 4/8/2022	CHECKED - CEL	REVISED -
	DATE - 04/08/22	REVISED -

**STATE OF ILLINOIS
DEPARTMENT OF TRANSPORTATION**

**JOLIET TOWNSHIP - ADA IMPROVEMENTS
VARIOUS LOCATIONS (JOLIET TOWNSHIP)**

SCALE: SHEET OF SHEETS STA. TO STA.

REVISED ENTIRE SHEET 4/13/2022

F.A. RTE.	SECTION	COUNTY	TOTAL SHEETS	SHEET NO.
VAR	2021-056-SW	WILL	113	56
CONTRACT NO. 62N87			ILLINOIS FED. AID PROJECT	



	NORTHING	EASTING	ELEVATION
1	1777140.23	1055645.19	(553.21)
2	1777141.70	1055646.04	(553.23)
3	1777139.81	1055645.52	(553.19)
4	1777141.28	1055646.37	553.18
5	1777136.11	1055649.16	(553.10)
6	1777137.50	1055649.97	553.09
7	1777138.79	1055650.70	553.12
8	1777135.14	1055650.34	(553.03)
9	1777136.53	1055651.13	(553.20)
10	1777151.65	1055651.75	(554.04)
11	1777151.16	1055652.05	553.93
12	1777146.11	1055654.91	553.82
13	1777145.62	1055655.21	(553.94)
14	1777151.94	1055657.58	(554.23)
15	1777145.75	1055657.88	(554.00)
16	1777151.44	1055657.61	(554.15)
17	1777146.25	1055657.86	(554.02)

	NORTHING	EASTING	ELEVATION
1	1777135.78	1055599.75	(553.47)
2	1777135.75	1055598.16	553.46
3	1777130.75	1055599.74	(553.42)
4	1777130.75	1055598.27	553.41
5	1777114.28	1055593.56	(553.61)
6	1777116.38	1055593.43	553.66
7	1777111.80	1055588.59	(553.72)
8	1777113.42	1055588.57	553.71
9	1777116.41	1055588.54	553.73
10	1777135.75	1055593.34	(553.78)
11	1777130.75	1055593.34	(553.75)
12	1777130.76	1055588.35	(553.77)
13	1777135.76	1055588.36	(553.85)

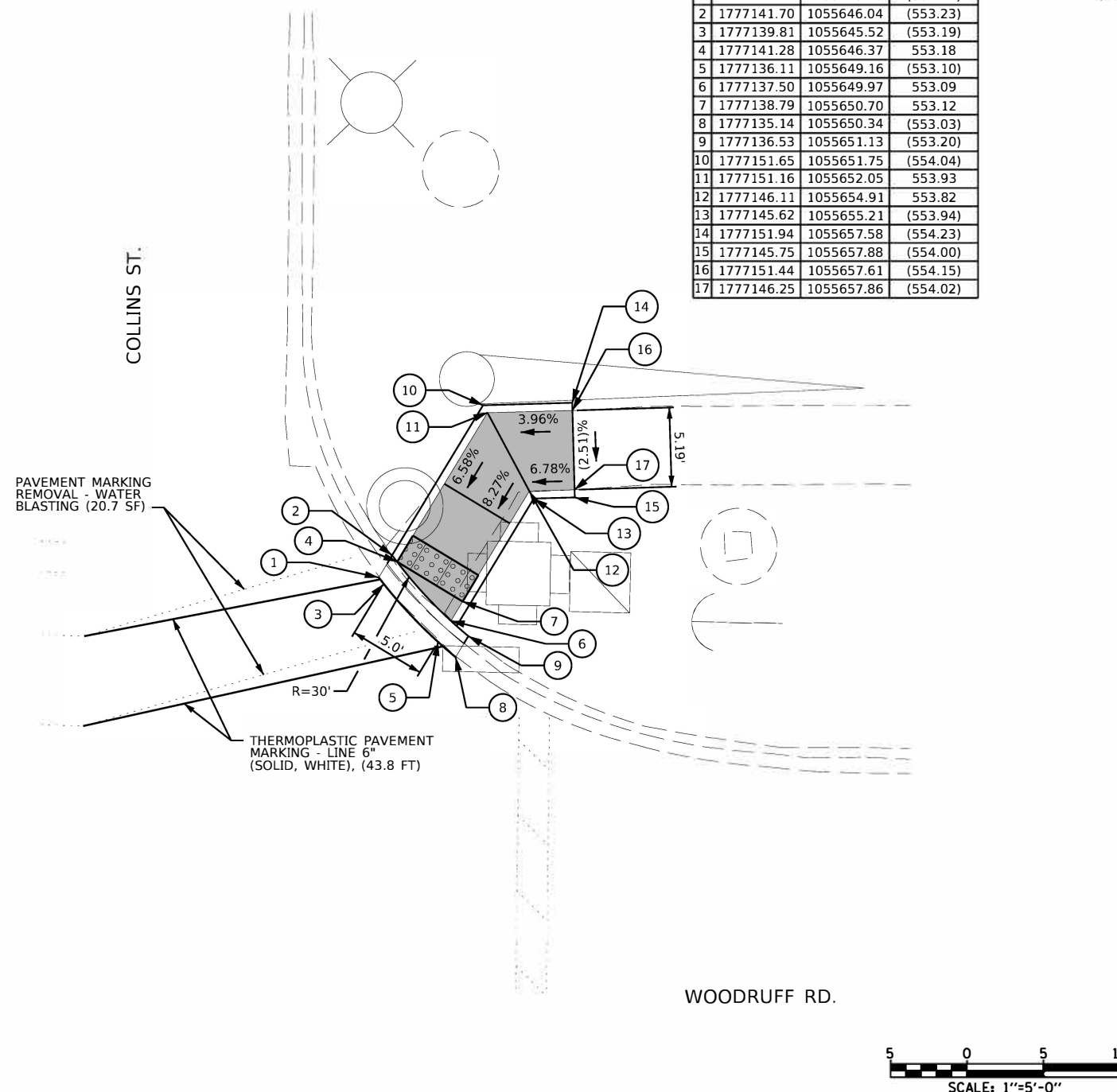
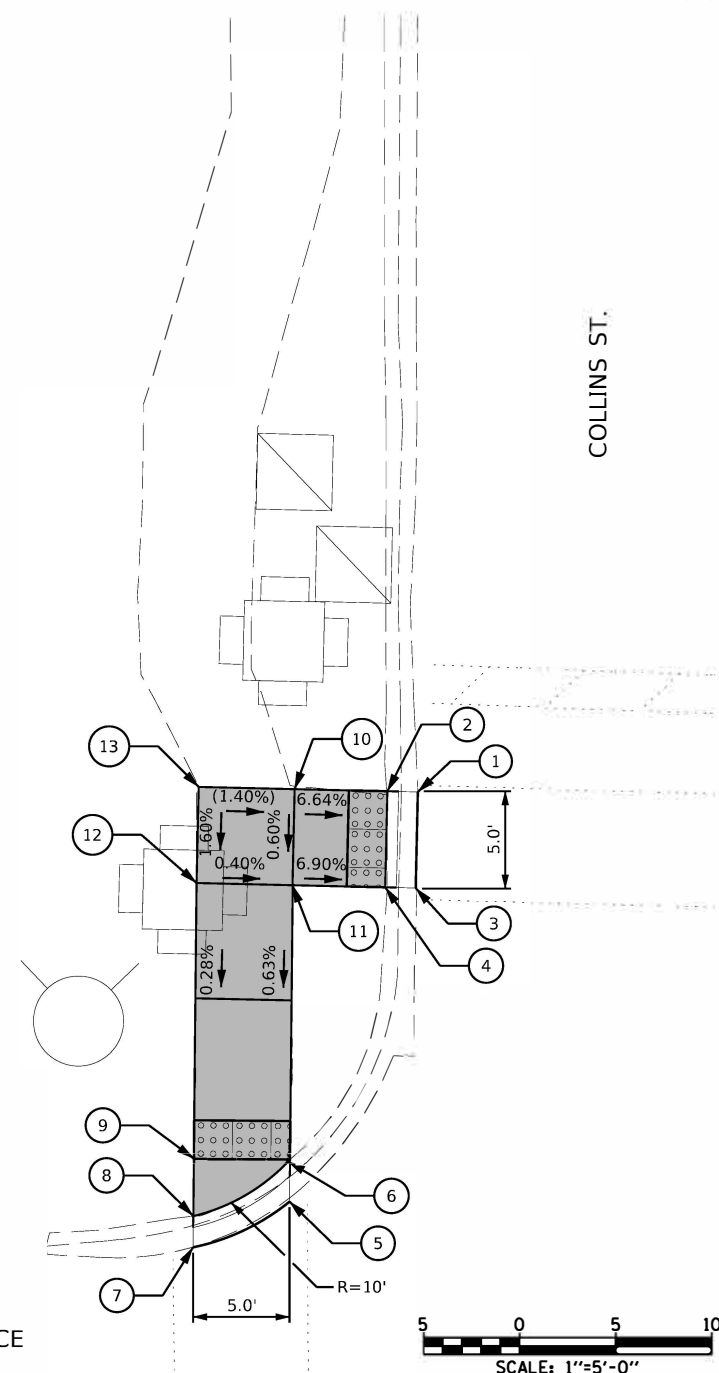

PAVEMENT MARKING REMOVAL - WATER BLASTING (20.7 SF)

THERMOPLASTIC PAVEMENT MARKING - LINE 6" (SOLID, WHITE), (43.8 FT)

PRIVATE ENTRANCE

WOODRUFF RD.

LEGEND

	DETECTABLE WARNINGS		CONCRETE CURB, TYPE B
	PCC SIDEWALK, 5 INCH		COMBINATION CONCRETE CURB AND GUTTER
()	EXISTING ELEVATION / SLOPE		

REFERENCE BENCHMARK ELEVATION: 554.18

BENCHMARK 210: CUT SQUARE AT NORTHEAST CORNER OF TRAFFIC SIGNAL CONTROL BOX FOUNDATION AT SOUTHEAST CORNER OF COLLINS ST. AND WOODRUFF RD.

MODEL: 4MODELNAME; FILE: NAME: L17762_03\CAD\Drawings\ADA_Ramps\22\87_ADA_06_Ramps_10 & 11.dgn

USER NAME = weldringhoff	DESIGNED - WME	REVISED ADDENDUM A 04/08/22
DRAWN - WME	CHECKED - CEL	REVISED -
PLOT SCALE = 1:10	DATE - 04/08/22	REVISED -
PLOT DATE = 4/8/2022		

STATE OF ILLINOIS
DEPARTMENT OF TRANSPORTATION

JOLIET TOWNSHIP - ADA IMPROVEMENTS
VARIOUS LOCATIONS (JOLIET TOWNSHIP)

SCALE: SHEET OF SHEETS STA. TO STA.

REVISED ENTIRE SHEET 4/13/2022

F.A. RTE.	SECTION	COUNTY	TOTAL SHEETS	SHEET NO.
VAR	2021-056-SW	WILL	113	91
			CONTRACT NO. 62N87	
ILLINOIS FED. AID PROJECT				



PRIVATE ENTRANCE

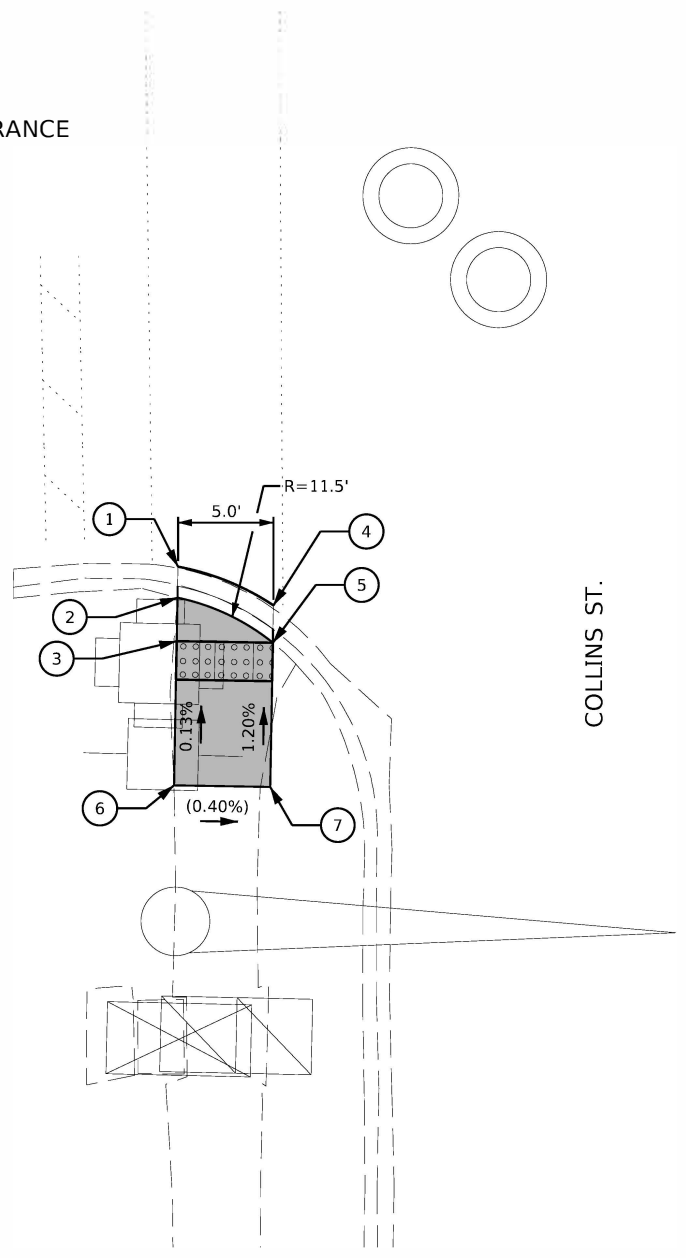

	NORTHING	EASTING	ELEVATION
1	1777080.92	1055589.97	(553.64)
2	1777079.32	1055589.98	553.63
3	1777077.06	1055589.99	553.65
4	1777079.02	1055594.98	(553.47)
5	1777077.08	1055594.99	553.55
6	1777069.55	1055590.02	(553.66)
7	1777069.57	1055595.02	(553.64)

COLLINS ST.

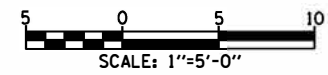

REFERENCE BENCHMARK ELEVATION: 554.18

BENCHMARK 210: CUT SQUARE AT NORTHEAST CORNER OF TRAFFIC SIGNAL CONTROL BOX FOUNDATAION AT SOUTHEAST CORNER OF COLLINS ST. AND WOODRUFF RD.

LEGEND			
	DETECTABLE WARNINGS		CONCRETE CURB, TYPE B
	PCC SIDEWALK, 5 INCH		COMBINATION CONCRETE CURB AND GUTTER
()	EXISTING ELEVATION / SLOPE		

REVISED ENTIRE SHEET 4/13/2022

MODEL: 4\MODEL\MAMES FILE: NAME: L17762_03\CAD\USheets\ADA_Ramps\62N87_ADA_Ramp_12.dgn

USER NAME = weldringhoff	DESIGNED - WME	REVISED ADDENDUM A 04/08/22
	DRAWN - WME	REVISED -
PLOT SCALE = 1:10	CHECKED - CEL	REVISED -
PLOT DATE = 4/8/2022	DATE - 04/08/22	REVISED -

**STATE OF ILLINOIS
DEPARTMENT OF TRANSPORTATION**

**JOLIET TOWNSHIP - ADA IMPROVEMENTS
VARIOUS LOCATIONS (JOLIET TOWNSHIP)**

SCALE: SHEET OF SHEETS STA. TO STA.

F.A. RTE.	SECTION	COUNTY	TOTAL SHEETS	SHEET NO.
VAR	2021-056-SW	WILL	113	92
CONTRACT NO. 62N87				

ILLINOIS FED. AID PROJECT