

TEMPORARY PAVEMENT

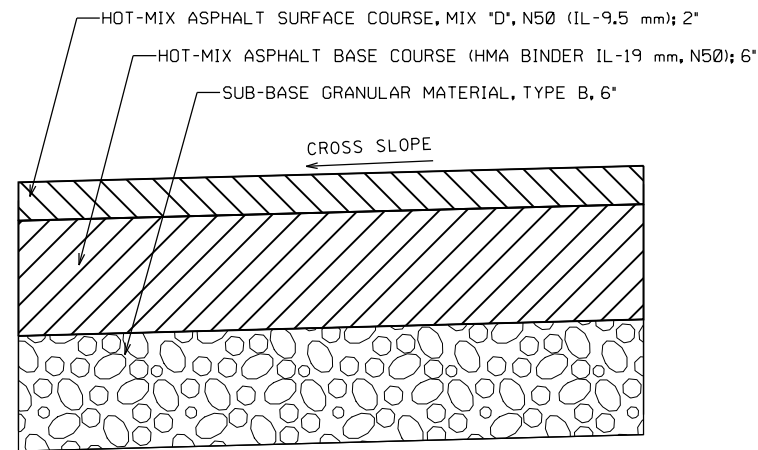

HMA DRIVEWAYS, 8"

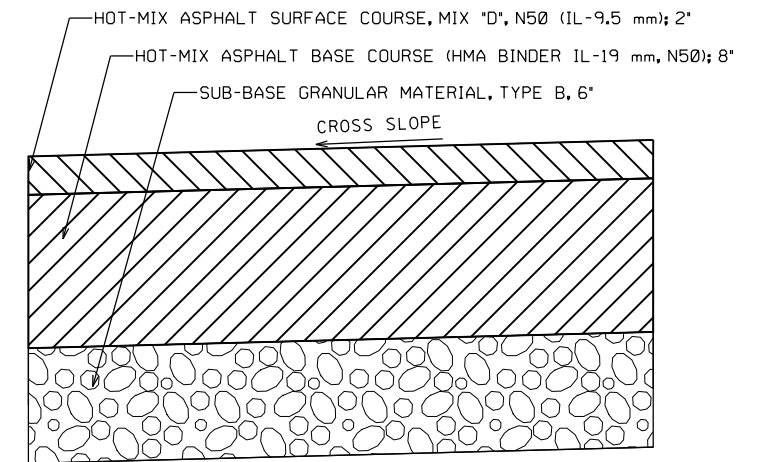

HMA DRIVEWAYS, 10"

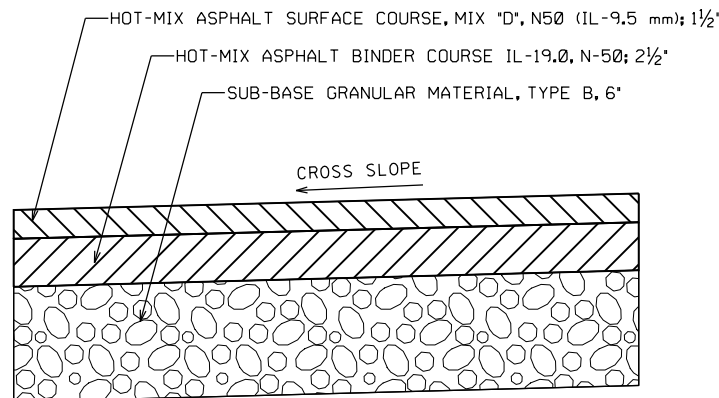

HMA SHARED-USE PATH, 4"

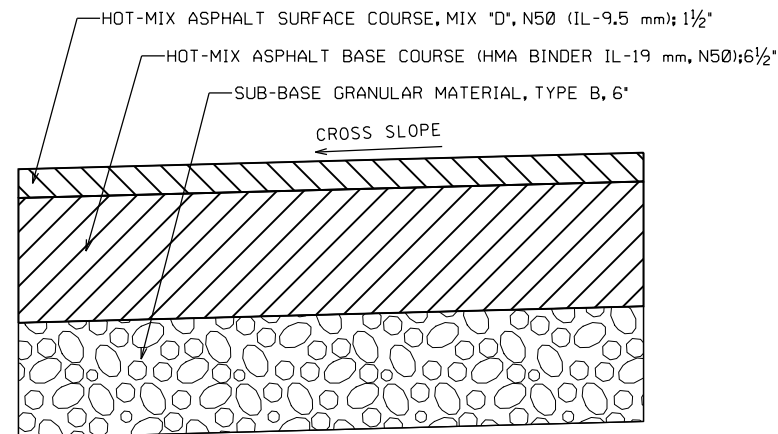

HMA SHARED-USE PATH, 8"

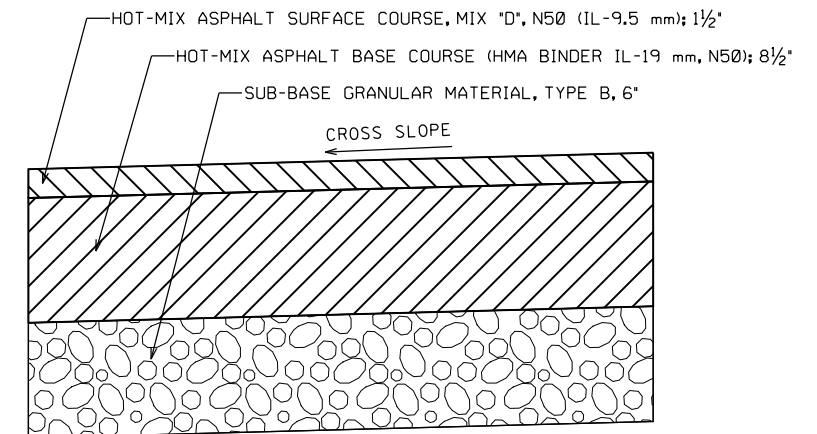

HMA SHARED-USE PATH, 10"

HOT-MIX ASPHALT MIXTURE REQUIREMENTS		
MIXTURE TYPE	AIR VOIDS @ NDES	QMP
HOT-MIX ASPHALT DRIVEWAY PAVEMENT, 8" (PRIVATE/FIELD ENTRANCE) HOT-MIX ASPHALT SURFACE COURSE, MIX "D", N50 (IL-9.5 mm); 2" HOT-MIX ASPHALT BASE COURSE, (HMA BINDER IL-19.0) 6"	4% @ 50 Gyr. 4% @ 50 Gyr.	QC/OA QC/OA
HOT-MIX ASPHALT DRIVEWAY PAVEMENT, 10" (COMMERCIAL ENTRANCE) HOT-MIX ASPHALT SURFACE COURSE, MIX "D", N50 (IL-9.5 mm); 2" HOT-MIX ASPHALT BASE COURSE, (HMA BINDER IL-19.0) 8"	4% @ 50 Gyr. 4% @ 50 Gyr.	QC/OA QC/OA
HOT-MIX ASPHALT SHARED-USE PATH, 4" HOT-MIX ASPHALT SURFACE COURSE, MIX "D", N50 (IL-9.5 mm); 1 1/2" HOT-MIX ASPHALT BINDER COURSE IL-19.0, N-50; 2 1/2"	4% @ 50 Gyr. 4% @ 50 Gyr.	QC/OA QC/OA
HOT-MIX ASPHALT SHARED-USE PATH, 8" HOT-MIX ASPHALT SURFACE COURSE, MIX "D", N50 (IL-9.5 mm); 1 1/2" HOT-MIX ASPHALT BASE COURSE, (HMA BINDER IL-19.0) 6 1/2"	4% @ 50 Gyr. 4% @ 50 Gyr.	QC/OA QC/OA
HOT-MIX ASPHALT SHARED-USE PATH, 10" HOT-MIX ASPHALT SURFACE COURSE, MIX "D", N50 (IL-9.5 mm); 1 1/2" HOT-MIX ASPHALT BASE COURSE, (HMA BINDER IL-19.0) 8 1/2"	4% @ 50 Gyr. 4% @ 50 Gyr.	QC/OA QC/OA
TEMPORARY PAVEMENT HOT-MIX ASPHALT SURFACE COURSE, MIX "D", N70 (IL-9.5 mm); 2" HMA BINDER COURSE IL-19.0 mm, N70; 6"	4% @ 70 Gyr. 4% @ 70 Gyr.	QC/OA QC/OA

QMP DESIGNATION: QUALITY CONTROL/QUALITY ASSURANCE (QC/OA);  
QUALITY CONTROL FOR PERFORMANCE (QCP)

NOTES:

THE UNIT WEIGHT USED TO CALCULATE ALL HOT-MIX ASPHALT SURFACE MIXTURES IS 112 LBS/SQ YD/IN.

FOR NON-POLYMERIZED HMA THE AC TYPE SHALL BE PG 64-22 UNLESS MODIFIED BY RECLAIMED MATERIALS SPECIFICATIONS.

PCC TEMPORARY PAVEMENT SHALL CONSIST OF CLASS PV CONCRETE MEETING THE REQUIREMENTS OF ART. 1020 OF THE STANDARD SPECIFICATIONS; THICKNESS SHALL BE 8".

TEMPORARY PCC PAVEMENT DOES NOT REQUIRE DOWEL BARS.

ALL TEMPORARY PAVEMENT SHALL BE PROVIDED OVER 6" SUBBASE GRANULAR MATERIAL TYP B.

THE AGGREGATE GRADATION FOR THE AGGREGATE SUBGRADE IMPROVEMENT 12" LOWER LIFT SHALL BE CS 1 OR RR 1.

MODEL NAME

FILE NAME = P:\P-1A\2024-80 IDOT Wood Street Ph. II\DRAWING\2024 Sheets\016072-ah-typical.dgn

USER NAME = alone	DESIGNED - JC	REVISED - ACL 4/12/2022
PLOT SCALE = 10.0000' / in.	DRAWN - AGL	REVISED -
PLOT DATE = 4/12/2022	CHECKED - AJP	REVISED -
	DATE - 09/27/2018	REVISED -

F.A.U. RTÉ.	SECTION	COUNTY	TOTAL SHEETS	SHEET NO.
2857	2021-118-R	COOK	557	36
CONTRACT NO. 62P45				
ILLINOIS FED. AID PROJECT				

PLAN	SURVEYED	BY	DATE
	PLOTTED		
	GRADES CHECKED		
	STRUCTURE NOTATIONS CHECKED		
	NOTE BOOK NO.		
	FILE NAME		

PROFILE	SURVEYED	BY	DATE
	PLOTTED		
	GRADES CHECKED		
	STRUCTURE NOTATIONS CHECKED		
	NOTE BOOK NO.		
	FILE NAME		

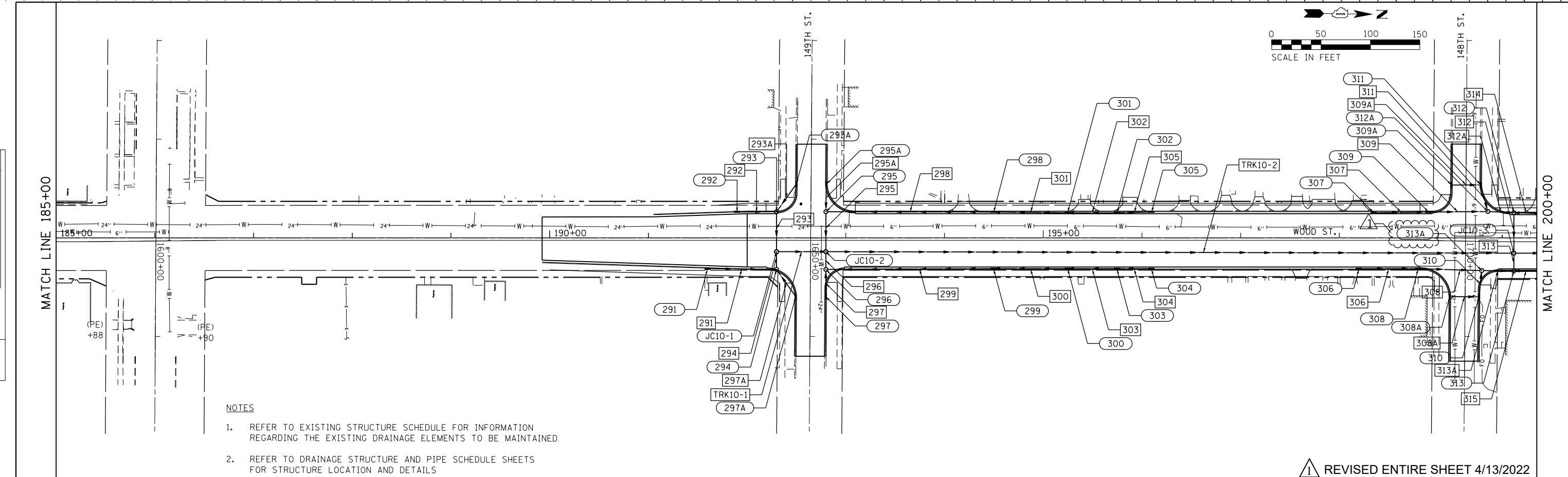

- NOTES**
- REFER TO EXISTING STRUCTURE SCHEDULE FOR INFORMATION REGARDING THE EXISTING DRAINAGE ELEMENTS TO BE MAINTAINED
  - REFER TO DRAINAGE STRUCTURE AND PIPE SCHEDULE SHEETS FOR STRUCTURE LOCATION AND DETAILS

REVISD ENTIRE SHEET 4/13/2022

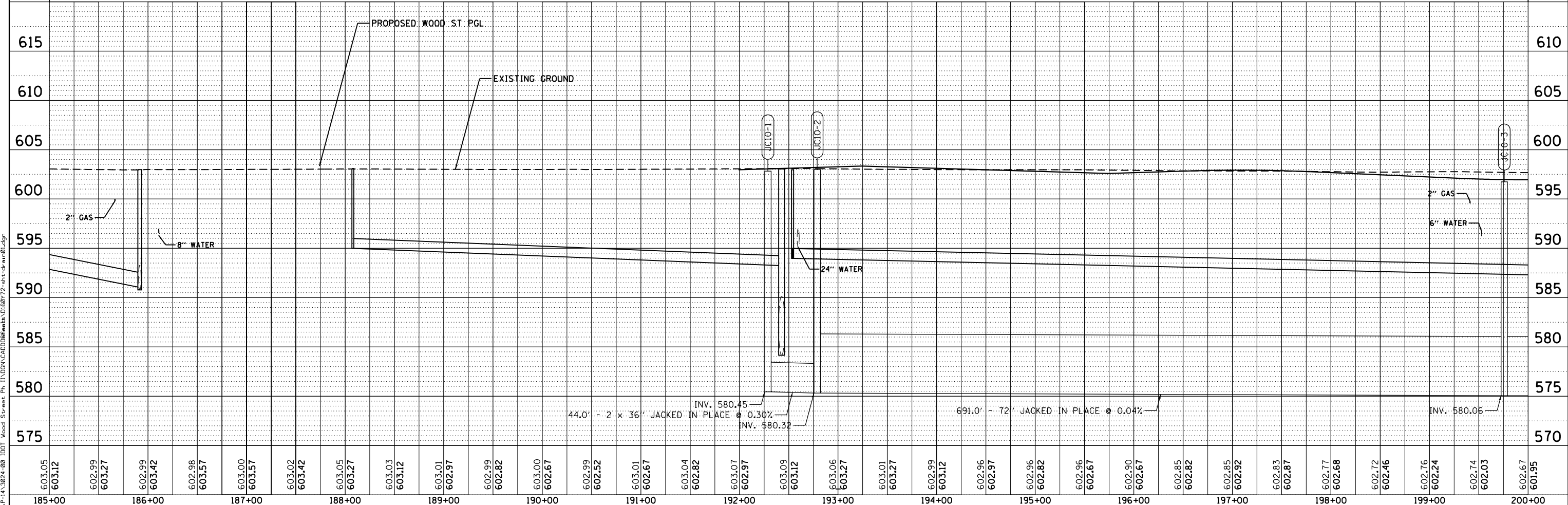

603.05	603.12	602.99	603.27	602.99	603.42	602.98	603.57	603.00	603.57	603.02	603.42	603.05	603.27	603.03	603.12	603.01	602.97	602.99	602.82	603.00	602.67	602.99	602.52	603.01	602.67	603.04	602.82	603.07	602.97	603.09	603.12	603.06	603.27	603.01	603.27	602.99	603.12	602.96	602.97	602.96	602.82	602.96	602.67	602.90	602.67	602.85	602.82	602.85	602.92	602.83	602.87	602.77	602.68	602.72	602.46	602.76	602.24	602.74	602.03	602.67	601.95
185+00	186+00	187+00	188+00	189+00	190+00	191+00	192+00	193+00	194+00	195+00	196+00	197+00	198+00	199+00	200+00																																														

**INFRASTRUCTURE ENGINEERING INCORPORATED**  
 1 South Wacker | Suite 3650 | Chicago, IL 60606  
 773.445.9861 | 773.445.9861 | www.infraeng.com

USER NAME = alone	DESIGNED - JP	REVISED -  ACL 4/12/2022
	DRAWN - AK	REVISED -
PLOT SCALE = 100.0000' / 1"	CHECKED - NB	REVISED -
PLOT DATE = 4/12/2022	DATE - 09/27/2018	REVISED -

**STATE OF ILLINOIS  
DEPARTMENT OF TRANSPORTATION**

**DRAINAGE PLAN AND PROFILE  
WOOD STREET/ASHLAND AVENUE**

SCALE: 1"=50'    SHEET 1 OF 6 SHEETS    STA. 185+00 TO STA. 200+00

F.A.U. RTE. 2857	SECTION 2021-118-R	COUNTY COOK	TOTAL SHEETS 557	SHEET NO. 118
CONTRACT NO. 62P45			ILLINOIS FED. AID PROJECT	

STRUCTURE NO.	ALIGNMENT	LOCATION		TYPE	RIM ELEV	INVERT DIRECTION								COMMENTS	PIPE NO.	TYPE	SIZE INCH	LENGTH FEET	SLOPE %	TBF CU YD	CLSM CU YD	COMMENTS
		STATION	OFFSET			N	NE	E	SE	S	SW	W	NW									
291	WOOD ST. (EXIST)	191+60	31.50 RT	INL. TY-B W/ TY-3 F&G	602.19	596.67				596.92					291	STORM SEW CL A 2	18	67	0.30%	59.53		
292	WOOD ST. (EXIST)	191+90	26.50 LT	INL. TY-B W/ TY-3 F&G	602.28	596.66				596.66					292	STORM SEW CL A 2	18	37	0.30%	31.18		
293	WOOD ST. (EXIST)	192+30	26.50 LT	CB. TY-A 4' DIA W/ TY-1 FR & CLID	602.40				596.55	596.55				597.53	293	STORM SEW 2 WAT MN	18	37	0.30%	35.10		
294	WOOD ST. (EXIST)	192+30	32.00 RT	CB. TY-A 4' DIA W/ TY-1 FR & CLID	602.39		597.37			596.47			596.47		294	STORM SEW 2 WAT MN	18	14	0.30%	13.16		
295	WOOD ST. (EXIST)	192+80	26.50 LT	CB. TY-A 4' DIA W/ TY-1 FR & CLID	602.55	596.54			596.54				597.55		295	STORM SEW CL A 2	15	37	0.32%	35.46		
296	WOOD ST. (EXIST)	192+80	32.00 RT	CB. TY-A 4' DIA W/ TY-1 FR & CLID	602.54	596.46			597.39				596.46		296	STORM SEW CL A 2	15	14	0.32%	13.30		
297	WOOD ST. (EXIST)	192+80	59.46 RT	INL. TY-A W/ TY-3 F&G	601.62								597.50		297	STORM SEW CL A 2	12	25	0.44%	17.44		
298	WOOD ST. (EXIST)	194+50	26.50 LT	INL. TY-B W/ TY-3 F&G	602.31	597.08				597.08					298	STORM SEW 2 WAT MN	15	167	0.33%	146.41		
299	WOOD ST. (EXIST)	194+50	31.50 RT	INL. TY-B W/ TY-3 F&G	602.31	597.25				597.00					299	STORM SEW CL A 2	15	167	0.32%	146.42		
300	WOOD ST. (EXIST)	195+25	31.50 RT	INL. TY-B W/ TY-3 F&G	602.08	597.57				597.57					300	STORM SEW CL A 2	12	72	0.44%	49.76		
301	WOOD ST. (EXIST)	195+25	25.50 LT	INL. TY-B W/ TY-1 FR & OLID	602.14	597.57				597.32					301	STORM SEW 2 WAT MN	15	72	0.32%	53.27		
302	WOOD ST. (EXIST)	195+75	25.50 LT	INL. TY-B W/ TY-1 FR & OLID	601.99	597.77				597.77					302	STORM SEW 2 WAT MN	12	47	0.44%	29.39		
303	WOOD ST. (EXIST)	195+75	31.50 RT	INL. TY-B W/ TY-3 F&G	601.93	597.77				597.77					303	STORM SEW CL A 2	12	47	0.44%	29.39		
304	WOOD ST. (EXIST)	196+10	31.50 RT	INL. TY-A W/ TY-3 F&G	602.04					597.91					304	STORM SEW CL A 2	12	33	0.44%	11.58		
305	WOOD ST. (EXIST)	196+10	26.50 LT	INL. TY-A W/ TY-3 F&G	602.04					597.91					305	STORM SEW 2 WAT MN	12	33	0.44%	11.59		
306	WOOD ST. (EXIST)	198+20	31.50 RT	INL. TY-A W/ TY-3 F&G	601.93	597.81									306	STORM SEW CL A 2	12	58	0.46%	20.63		
307	WOOD ST. (EXIST)	198+35	25.50 LT	INL. TY-A W/ TY-1 FR & OLID	601.92	597.80									307	STORM SEW 2 WAT MN	12	54	0.60%	19.03		
308	WOOD ST. (EXIST)	198+80	31.50 RT	INL. TY-B W/ TY-3 F&G	601.67	597.54				597.54					308	STORM SEW 2 WAT MN	12	61	0.44%	21.87		
309	WOOD ST. (EXIST)	198+90	26.43 LT	INL. TY-B W/ TY-3 F&G	601.61	597.48				597.48					309	STORM SEW 2 WAT MN	12	57	0.44%	20.28		
310	WOOD ST. (EXIST)	199+42	59.73 RT	INL. TY-B W/ TY-3 F&G	601.17					596.91			588.97		310	STORM SEW CL A 2	12	24	0.44%	14.34		
311	WOOD ST. (EXIST)	199+44	53.64 LT	INL. TY-B W/ TY-3 F&G	601.43					596.90					311	STORM SEW 2 WAT MN	12	25	0.44%	15.09		
312	WOOD ST. (EXIST)	199+77	25.50 LT	CB. TY-A 4' DIA W/ TY-1 FR & CLID	601.30	596.56				589.06					312	STORM SEW 2 WAT MN	18	37	0.30%	30.26		
313	WOOD ST. (EXIST)	199+77	33.50 RT	CB. TY-A 4' DIA W/ TY-1 FR & CLID	601.30	596.61				588.74			588.74		313	STORM SEW CL A 2	18	14	0.30%	11.19		
314	WOOD ST. (EXIST)	200+01	25.00 LT	INL. TY-B W/ TY-1 FR & OLID	601.29	596.87				596.62					314	STORM SEW CL A 2	15	21	0.33%	13.74		
315	WOOD ST. (EXIST)	200+01	33.50 RT	INL. TY-B W/ TY-3 F&G	601.28	596.92				596.67					315	STORM SEW CL A 2	15	21	0.32%	13.05		
316	WOOD ST. (EXIST)	200+45	25.50 LT	INL. TY-B W/ TY-3 F&G	601.34	597.05				597.05					316	STORM SEW CL A 2	12	41	0.44%	15.39		
317	WOOD ST. (EXIST)	200+45	32.50 RT	INL. TY-B W/ TY-1 FR & OLID	601.34	597.10				597.10					317	STORM SEW CL A 2	12	41	0.44%	15.39		
318	WOOD ST. (EXIST)	201+15	25.50 LT	INL. TY-B W/ TY-3 F&G	601.55	597.34				597.34					318	STORM SEW CL A 2	12	67	0.44%	24.07		
319	WOOD ST. (EXIST)	201+35	33.50 RT	INL. TY-B W/ TY-3 F&G	601.61	597.48				597.48					319	STORM SEW CL A 2	12	87	0.44%	31.31		
320	WOOD ST. (EXIST)	201+75	32.50 RT	INL. TY-A W/ TY-1 FR & OLID	601.79					597.66					320	STORM SEW CL A 2	12	38	0.48%	13.40		
321	WOOD ST. (EXIST)	201+80	25.50 LT	INL. TY-A W/ TY-3 F&G	601.74					597.62					321	STORM SEW CL A 2	12	63	0.44%	22.44		
322	WOOD ST. (EXIST)	203+75	25.50 LT	INL. TY-A W/ TY-3 F&G	601.76	597.63									322	STORM SEW CL A 2	12	23	0.44%	7.97		
323	WOOD ST. (EXIST)	203+75	33.50 RT	INL. TY-A W/ TY-3 F&G	601.76	597.63									323	STORM SEW CL A 2	12	23	0.44%	7.97		
324	WOOD ST. (EXIST)	204+00	32.50 RT	INL. TY-B W/ TY-1 FR & OLID	601.74	597.53				597.53					324	STORM SEW CL A 2	12	27	0.44%	10.15		
325	WOOD ST. (EXIST)	204+00	24.50 LT	INL. TY-B W/ TY-1 FR & OLID	601.74	597.53				597.53					325	STORM SEW CL A 2	12	27	0.44%	10.15		
326	WOOD ST. (EXIST)	204+30	24.50 LT	INL. TY-B W/ TY-1 FR & OLID	601.83	597.42				597.42												

MODEL NAME

FILE NAME = P:\P-1A\2024-80 IDOT Wood Street Ph II\DWG\CADD Sheets\016072-ah-t-drainschedule.dgn

REVISED SHEET 4/13/2022

<p><b>INFRASTRUCTURE ENGINEERING</b> 1 South Wacker   Suite 2550   Chicago, IL 60606 P 312.435.4900   F 312.435.4994   www.infrastructure-eng.com</p>	USER NAME = alone	DESIGNED - JP	REVISED -  ACL 4/12/2022	<b>STATE OF ILLINOIS</b> <b>DEPARTMENT OF TRANSPORTATION</b>	<b>DRAINAGE STRUCTURE AND PIPE SCHEDULE</b> <b>WOOD STREET/ASHLAND AVENUE</b>	F.A.U. RTE. = 2857	SECTION = 2021-118-R	COUNTY = COOK	TOTAL SHEETS = 557	SHEET NO. = 124
	PLOT SCALE = 2.0000' / in.	CHECKED - NB	REVISED -			CONTRACT NO. 62P45				
	PLOT DATE = 4/12/2022	DATE = 09/27/2018	REVISED -			ILLINOIS FED. AID PROJECT				

FILE NAME = P:\P-1A\2024-00 IDOT Wood Street Ph. I:\DGN\CADD Sheets\016072-ash-cd-armsched.dgn  
 \$MODEL\_NAME\$

STRUCTURE NO.	ALIGNMENT	LOCATION		TYPE	RIM ELEV	INVERT DIRECTION								COMMENTS	PIPE NO.	TYPE	SIZE INCH	LENGTH FEET	SLOPE %	TBF CU YD	CLSM CU YD	COMMENTS	
		STATION	OFFSET			N	NE	E	SE	S	SW	W	NW										
327	WOOD ST. (EXIST)	204+30	32.50 RT	INL. TY-B W/ TY-1 FR & OLID	601.83	597.42				597.42						326	STORM SEW CL A 2	12	32	0.44%	19.91		
328	WOOD ST. (EXIST)	204+65	24.50 LT	INL. TY-B W/ TY-1 FR & OLID	601.94	597.03				597.28						327	STORM SEW CL A 2	12	32	0.44%	19.91		
329	WOOD ST. (EXIST)	204+65	32.50 RT	INL. TY-B W/ TY-1 FR & OLID	601.94	597.03				597.28						328	STORM SEW CL A 2	15	38	0.33%	27.25		
330	WOOD ST. (EXIST)	205+05	33.50 RT	INL. TY-B W/ TY-3 F&G	602.02	596.91				596.91						329	STORM SEW CL A 2	15	38	0.32%	27.20		
331	WOOD ST. (EXIST)	205+05	24.78 LT	INL. TY-B W/ TY-1 FR & OLID	602.13	596.91				596.91						330	PARTIAL STORM SEW CL A 2 / WAT MN	15	115	0.32%	100.60		PARTIAL WAT MN, SEE TABLE
332	WOOD ST. (EXIST)	206+21	76.46 RT	INL. TY-A W/ TY-3 F&G	602.09								589.01			331	PARTIAL STORM SEW CL A 2 / WAT MN	15	128	0.33%	107.63		PARTIAL WAT MN, SEE TABLE
333	WOOD ST. (EXIST)	206+25	62.97 LT	INL. TY-A W/ TY-3 F&G	602.27								589.03			332	STORM SEW CL A 2	12	37	0.44%	23.88		
334	WOOD ST. (EXIST)	206+36	25.50 LT	CB. TY-A 4' DIA W/ TY-1 FR & CLID	602.39	588.87				596.49			588.87			333	STORM SEW 2 WAT MN	12	36	0.44%	13.55		
335	WOOD ST. (EXIST)	206+60	37.37 RT	INL. TY-B W/ TY-3 F&G	602.42	588.75				588.75						334	STORM SEW 2 WAT MN	18	51	0.30%	50.55		
336	WOOD ST. (EXIST)	206+90	25.50 LT	INL. TY-B W/ TY-3 F&G	602.59	588.72				588.72						335	STORM SEW CL A 2	18	69	0.30%	73.90		
337	WOOD ST. (EXIST)	207+20	24.50 LT	INL. TY-B W/ TY-1 FR & OLID	602.80	588.64				588.64						336	STORM SEW 2 WAT MN	18	28	0.30%	27.78		
338	WOOD ST. (EXIST)	207+32	33.50 RT	CB. TY-A 4' DIA W/ TY-1 FR & CLID	602.94	598.82				588.54			588.54			337	STORM SEW 2 WAT MN	24	9	0.30%	9.76		
339	WOOD ST. (EXIST)	207+32	25.50 LT	CB. TY-A 4' DIA W/ TY-1 FR & CLID	602.88	596.53		588.61		588.61						338	STORM SEW CL A 2	18	14	0.30%	15.62		
340	WOOD ST. (EXIST)	207+65	32.50 RT	INL. TY-A W/ TY-1 FR & OLID	603.20					599.08						339	STORM SEW CL A 2	24	37	0.30%	47.23		
341	WOOD ST. (EXIST)	208+73	99.03 LT	INL. TY-A W/ TY-3 F&G	601.40				597.28							340	STORM SEW CL A 2	12	31	0.87%	10.69		
342	WOOD ST. (EXIST)	209+15	25.50 LT	INL. TY-A W/ TY-3 F&G	605.05					600.92						341	PARTIAL STORM SEW CL A 2 / WAT MN	12	90	0.44%	90.99		PARTIAL WAT MN, SEE TABLE
343	WOOD ST. (EXIST)	210+79	25.28 LT	INL. TY-A W/ TY-1 FR & OLID	603.46	599.34										342	STORM SEW 2 WAT MN	12	98	1.15%	34.94		
344	WOOD ST. (EXIST)	210+80	32.71 RT	INL. TY-A W/ TY-3 F&G	603.40	599.28										343	STORM SEW CL A 2	12	93	1.51%	33.30		
345	WOOD ST. (EXIST)	211+65	31.23 RT	INL. TY-B W/ TY-3 F&G	602.16	598.04				598.04						344	STORM SEW CL A 2	12	83	1.50%	29.68		
346	WOOD ST. (EXIST)	211+74	27.94 LT	INL. TY-B W/ TY-3 F&G	602.06	597.94				597.94						345	STORM SEW CL A 2	12	37	0.88%	13.21		
347	WOOD ST. (EXIST)	212+05	30.53 RT	INL. TY-B W/ TY-3 F&G	601.84	597.48				597.72						346	STORM SEW CL A 2	12	36	0.76%	12.67		
348	WOOD ST. (EXIST)	212+14	30.37 RT	CB. TY-A 4' DIA W/ TY-1 FR & CLID	601.79	596.96				597.22			596.46			347	STORM SEW CL A 2	12	6	4.85%	3.16		
349	WOOD ST. (EXIST)	212+13	28.62 LT	CB. TY-A 4' DIA W/ TY-3 F&G	601.79	597.19		596.44		597.67						348	STORM SEW CL A 2	24	14	0.30%	11.96		
350	WOOD ST. (EXIST)	212+30	30.09 RT	INL. TY-B W/ TY-3 F&G	601.74	597.00				597.00						349	STORM SEW CL A 2	24	38	0.30%	32.85		
351	WOOD ST. (EXIST)	212+52	29.71 RT	INL. TY-B W/ TY-3 F&G	601.71	597.06				597.06						350	STORM SEW CL A 2	18	13	0.30%	8.21		
352	WOOD ST. (EXIST)	212+51	29.28 LT	INL. TY-B W/ TY-3 F&G	601.71	597.30				597.30						351	STORM SEW CL A 2	18	19	0.30%	12.38		
353	WOOD ST. (EXIST)	212+75	29.31 RT	INL. TY-B W/ TY-3 F&G	601.74	597.12				597.12						352	STORM SEW CL A 2	15	35	0.33%	21.57		
354	WOOD ST. (EXIST)	212+74	29.68 LT	INL. TY-B W/ TY-3 F&G	601.74	597.36				597.36						353	STORM SEW CL A 2	18	21	0.30%	12.88		
355	WOOD ST. (EXIST)	213+10	28.69 RT	INL. TY-B W/ TY-3 F&G	601.86	597.49				597.24						354	STORM SEW CL A 2	15	21	0.33%	7.92		
356	WOOD ST. (EXIST)	213+49	30.99 LT	INL. TY-B W/ TY-3 F&G	602.00	597.85				597.60						355	STORM SEW CL A 2	18	32	0.37%	20.38		
357	WOOD ST. (EXIST)	213+65	27.74 RT	INL. TY-B W/ TY-3 F&G	602.05	597.68				597.68						356	STORM SEW CL A 2	15	72	0.32%	28.46		
358	WOOD ST. (EXIST)	214+05	26.04 RT	INL. TY-B W/ TY-1 FR & OLID	602.26	598.14				597.89						357	STORM SEW CL A 2	15	52	0.37%	20.50		
359	WOOD ST. (EXIST)	214+04	31.95 LT	INL. TY-B W/ TY-3 F&G	602.20	598.08				598.08						358	STORM SEW CL A 2	15	38	0.57%	14.53		
360	WOOD ST. (EXIST)	214+55	25.16 RT	INL. TY-B W/ TY-1 FR & OLID	602.56	598.44				598.44						359	STORM SEW CL A 2	12	52	0.44%	18.64		
361	WOOD ST. (EXIST)	215+09	32.79 LT	INL. TY-A W/ TY-1 FR & OLID	602.89					598.77						360	STORM SEW CL A 2	12	47	0.64%	16.83		
362	WOOD ST. (EXIST)	215+15	25.12 RT	INL. TY-A W/ TY-3 F&G	602.86					598.74						361	STORM SEW CL A 2	12	103	0.67%	36.92		
363	WOOD ST. (EXIST)	217+40	34.50 LT	INL. TY-A W/ TY-3 F&G	602.74	598.62										362	STORM SEW CL A 2	12	58	0.52%	20.63		
364	WOOD ST. (EXIST)	217+50	24.50 RT	INL. TY-A W/ TY-3 F&G	602.68	598.56										363	STORM SEW CL A 2	12	48	0.63%	17.01		
365	WOOD ST. (EXIST)	217+90	34.50 LT	INL. TY-B W/ TY-3 F&G	602.44	598.32				598.32						364	STORM SEW CL A 2	12	83	0.62%	29.68		
366	WOOD ST. (EXIST)	218+35	24.50 RT	INL. TY-B W/ TY-3 F&G	602.17	598.05				598.05						365	STORM SEW CL A 2	12	47	0.64%	16.83		
367	WOOD ST. (EXIST)	218+40	34.50 LT	INL. TY-B W/ TY-3 F&G	602.14	597.77				598.02						366	STORM SEW CL A 2	12	47	0.57%	16.83		
368	WOOD ST. (EXIST)	218+75	34.50 LT	INL. TY-B W/ TY-3 F&G	601.93	597.56				597.56						367	STORM SEW CL A 2	15	32	0.66%	12.54		
369	WOOD ST. (EXIST)	218+85	24.50 RT	INL. TY-B W/ TY-3 F&G	601.90	597.53				597.78						368	STORM SEW CL A 2	15	23	0.35%	8.76		
370	WOOD ST. (EXIST)	219+01	24.50 RT	CB. TY-A 4' DIA W/ TY-1 FR & CLID	601.86	594.98				597.48			594.48			369	STORM SEW CL A 2	15	13	0.38%	4.76		
371	WOOD ST. (EXIST)	219+01	34.50 LT	CB. TY-A 4' DIA W/ TY-1 FR & CLID	601.86	594.66		594.66		597.48						370	STORM SEW CL A 2	24	14	0.30%	17.47		
372	WOOD ST. (EXIST)	219+10	34.50 LT	INL. TY-B W/ TY-3 F&G	601.83	595.18				594.68						371	STORM SEW CL A 2	24	37	0.30%	47.23		
373	WOOD ST. (EXIST)	219+35	24.50 RT	INL. TY-B W/ TY-3 F&G	601.75	595.07				595.07						372	STORM SEW CL A 2	24	6	0.30%	5.86		
374	WOOD ST. (EXIST)	219+50	34.50 LT	INL. TY-B W/ TY-3 F&G	601.71	595.29				595.29						373	STORM SEW CL A 2	18	31	0.30%	31.50		
375	WOOD ST. (EXIST)	219+75	24.50 RT	INL. TY-B W/ TY-3 F&G	601.63	595.43				595.18						374	STORM SEW CL A 2	18	37	0.30%	36.90		
376	WOOD ST. (EXIST)	219+90	34.50 LT	INL. TY-B W/ TY-3 F&G	601.59	595.40				595.40						375	STORM SEW CL A 2	18	37	0.30%	36.90		
377	WOOD ST. (EXIST)	220+10	24.50 RT	INL. TY-B W/ TY-3 F&G	601.53	595.54				595.54						376	STORM SEW CL A 2	18	37	0.30%	35.59		
378	WOOD ST. (EXIST)	220+25	34.50 LT	INL. TY-B W/ TY-3 F&G	601.48	595.50				595.50						377	STORM SEW CL A 2	15	32	0.33%	28.85		
379	WOOD ST. (EXIST)	220+50	24.50 RT	INL. TY-B W/ TY-3 F&G	601.41	595.66				595.66						378	STORM SEW CL A 2	18	32	0.32%	29.55		
380	WOOD ST. (EXIST)	220+60	34.50 LT	INL. TY-B W/ TY-3 F&G	601.38	595.85				595.60						379	STORM SEW CL A 2	15	37	0.33%	32.19		
381	WOOD ST. (EXIST)	220+95	24.50 RT	INL. TY-B W/ TY-3 F&G	601.27	596.04				595.79						380	STORM SEW CL A 2	18	32	0.30%	28.41		
382	WOOD ST. (EXIST)	220+95	34.50 LT	INL. TY-B W/ TY-3 F&G	601.27	595.95				595.95						381	STORM SEW CL A 2	15	42	0.33%	35.19		
383	WOOD ST. (EXIST)	221+30	34.50 LT	INL. TY-B W/ TY-3 F&G	601.17	596.31				596.06						382	STORM SEW CL A 2	15	32	0.33%	25.61		
384	WOOD ST. (EXIST)	221+45	24.50 RT	INL. TY-B W/ TY-3 F&G	601.12	596.25				596.25													

REVISED SHEET 4/13/2022

**INFRASTRUCTURE ENGINEERING**  
 1 South Wacker | Suite 3550 | Chicago, IL 60606  
 P 312.435.5590 | F 312.435.5594 | www.infrastructureeng.com

USER NAME = alone	DESIGNED - JP	REVISED - ACL 4/12/2022
PLOT SCALE = 2.0000' / in.	DRAWN - AK	REVISED -
PLOT DATE = 4/12/2022	CHECKED - NB	REVISED -
	DATE - 09/27/2018	REVISED -

**STATE OF ILLINOIS**  
**DEPARTMENT OF TRANSPORTATION**

**DRAINAGE STRUCTURE AND PIPE SCHEDULE**  
**WOOD STREET/ASHLAND AVENUE**

F.A.U. RE.	SECTION	COUNTY	TOTAL SHEETS	SHEET NO.
2857	2021-118-R	COOK	557	125
CONTRACT NO. 62P45				
ILLINOIS FED. AID PROJECT				

STRUCTURE NO.	ALIGNMENT	LOCATION		TYPE	RIM ELEV	INVERT DIRECTION								COMMENTS	PIPE NO.	TYPE	SIZE INCH	LENGTH FEET	SLOPE %	TBF CU YD	CLSM CU YD	COMMENTS
		STATION	OFFSET			N	NE	E	SE	S	SW	W	NW									
293A	WOOD ST. (EXIST)	192+50	54.51 LT	INL. TY-A W/ TY-3 F&G	601.79				597.67						293A	STORM SEW CL A 2	12	32	0.44%	20.56		
295A	WOOD ST. (EXIST)	192+81	54.53 LT	INL. TY-A W/ TY-3 F&G	601.78			597.66							295A	STORM SEW 2 WAT MN	12	26	0.44%	17.08		
297A	WOOD ST. (EXIST)	192+49	59.53 RT	INL. TY-A W/ TY-3 F&G	601.63							597.51			297A	STORM SEW 2 WAT MN	12	31	0.44%	21.01		
308A	WOOD ST. (EXIST)	199+12	59.54 RT	INL. TY-A W/ TY-3 F&G	601.15	597.03									308A	STORM SEW 2 WAT MN	12	27	0.44%	9.59		
309A	WOOD ST. (EXIST)	199+13	53.58 LT	INL. TY-A W/ TY-3 F&G	601.14	597.02									309A	STORM SEW 2 WAT MN	12	28	0.44%	16.87		
312A	WOOD ST. (EXIST)	199+50	26.71 LT	CB. TY-A 4' DIA W/ TY-1 FR & CLID	601.47	589.16			597.23			589.41			312A	STORM SEW 2 WAT MN	15	23	0.44%	15.58		
313A	WOOD ST. (EXIST)	199+44	33.17 RT	CB. TY-A 4' DIA W/ TY-1 FR & CLID	601.50	588.87		588.87	597.27						313A	STORM SEW CL A 2	15	29	0.44%	19.97		
332A	WOOD ST. (EXIST)	206+23	37.00 RT	CB. TY-A 4' DIA W/ TY-1 FR & CLID	602.67	588.85		588.85	596.53						332A	STORM SEW CL A 2	18	34	0.30%	32.10		
339A	WOOD ST. (EXIST)	208+15	26.50 LT	CB. TY-A 4' DIA W/ TY-1 FR & CLID	603.93	599.80			596.88			596.88			339A	STORM SEW 2 WAT MN	12	80	0.44%	79.84		
OUT4	WOOD ST. (EXIST)	271+54	28.82 RT	REUSE EXIST. MH. & ADJUST TO GRADE	581.66							575.18										

STRUCTURE NO.	ALIGNMENT	LOCATION		TYPE	RIM ELEV	INVERT DIRECTION								COMMENTS	PIPE NO.	TYPE	SIZE INCH	LENGTH FEET	SLOPE %	TBF CU YD	CLSM CU YD	COMMENTS
		STATION	OFFSET			N	NE	E	SE	S	SW	W	NW									
JC10-1	WOOD ST. (EXIST)	192+30	14.00 RT	SP. MH. W/ TY-1 FR & CLID	602.83	580.45		596.43		580.45		596.44			TRK10-1	STORM SEWERS JKD 36	36	87	0.30%	0.00		
JC10-2	WOOD ST. (EXIST)	192+80	14.00 RT	SP. MH. W/ TY-1 FR & CLID	602.98	580.32		596.41		580.32		596.42			TRK10-2	STORM SEWERS JKD 72	72	691	0.04%	0.00		
JC10-3	WOOD ST. (EXIST)	199+77	15.50 RT	SP. MH. W/ TY-1 FR & CLID	601.74	580.06		588.90		580.06		588.90			TRK10-3	STORM SEWERS JKD 72	72	749	0.04%	0.00		
JC11-1	WOOD ST. (EXIST)	207+32	15.50 RT	SP. MH. W/ TY-1 FR & CLID	603.26	579.79		588.50		579.79		588.50			TRK11-1	STORM SEWERS JKD 72	72	476	0.04%	0.00		
JC13-1	WOOD ST. (EXIST)	212+14	12.37 RT	SP. MH. W/ TY-1 FR & CLID	602.23	579.62		596.42		579.62		596.33			TRK13-1	STORM SEWERS JKD 72	72	681	0.04%	0.00		
JC13-2	WOOD ST. (EXIST)	219+01	6.50 RT	SP. MH. W/ TY-1 FR & CLID	602.30	579.37		594.44		579.37		594.55			TRK13-2	STORM SEWERS JKD 72	72	744	0.04%	0.00		
JC14-1	WOOD ST. (EXIST)	226+51	9.00 RT	SP. MH. W/ TY-1 FR & CLID	600.90	579.10		594.25		579.10		594.31										

MODEL NAME

FILE NAME = P:\P-1A\2024-80\_IDOT\_Wood\_Street\_Ph\_1\IN\DN\CADD\_Sheets\016072-sh-t-drain\structure.dgn

PIPE NO.	TYPE	SIZE INCH	LENGTH FEET	ALIGNMENT	BEGIN STA.	END STA.
330	STORM SEW 2 WAT MN	15	54	WOOD ST. (EXIST)	205+67	206+21
331	STORM SEW 2 WAT MN	15	54	WOOD ST. (EXIST)	205+62	206+34
341	STORM SEW 2 WAT MN	12	36	WOOD ST. (EXIST)	208+09	208+33
630	STORM SEW 2 WAT MN	12	54	WOOD ST. (EXIST)	274+62	275+16

\* STORM SEWER WATER MAIN QUALITY PIPE IS AT PROPOSED PIPE ALIGNMENT AND PROFILE ELEVATIONS AT THE "BEGIN" AND "END" STATIONS SHOWN IN THE PARTIAL STORM SEWER WATER MAIN QUALITY PIPE TABLE

<p><b>INFRASTRUCTURE ENGINEERING</b> 1 South Wacker   Suite 2550   Chicago, IL 60606 P 312.435.9900   F 312.435.9594   www.infrastructure-engineering.com</p>	USER NAME = alone	DESIGNED - JP	REVISED -  ACL 4/12/2022
	PLOT SCALE = 2.0000' / in.	DRAWN - AK	REVISED -
	PLOT DATE = 4/12/2022	CHECKED - NB	REVISED -
		DATE - 09/27/2018	REVISED -

**STATE OF ILLINOIS  
DEPARTMENT OF TRANSPORTATION**

**DRAINAGE STRUCTURE AND PIPE SCHEDULE  
WOOD STREET/ASHLAND AVENUE**

F.A.U. RTE.	SECTION	COUNTY	TOTAL SHEETS	SHEET NO.
2857	2021-118-R	COOK	557	128
CONTRACT NO. 62P45				
ILLINOIS FED. AID PROJECT				

**REVISED SHEET 4/13/2022**