

LEGEND

- - - REMOVAL LIMITS (PVT, DRV, C&G AND MEDIANS)
- ✕ TREE REMOVAL
- ⊙ TREE PRUNING & TREE ROOT PRUNING

NOTES:
 1. ALL SURFACES ARE PCC UNLESS OTHERWISE NOTED.

CURVE 22ND
 PI STA. = 213+22.20
 $\Delta = 26^\circ 55' 34''$ (RT)
 D = 1° 30' 00"
 R = 3,819.64'
 T = 914.41'
 L = 1,795.04'
 E = 107.93'
 e = 2.08%
 T.R. = 93'
 S.E. RUN = 93'
 P.C. STA. = 204+07.78
 P.T. STA. = 222+02.83
 FOR SUPERELEVATION DETAILS SEE SHEET NO. 39 TO 41.

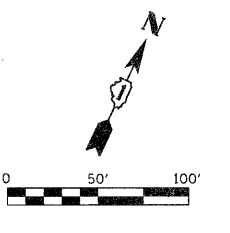
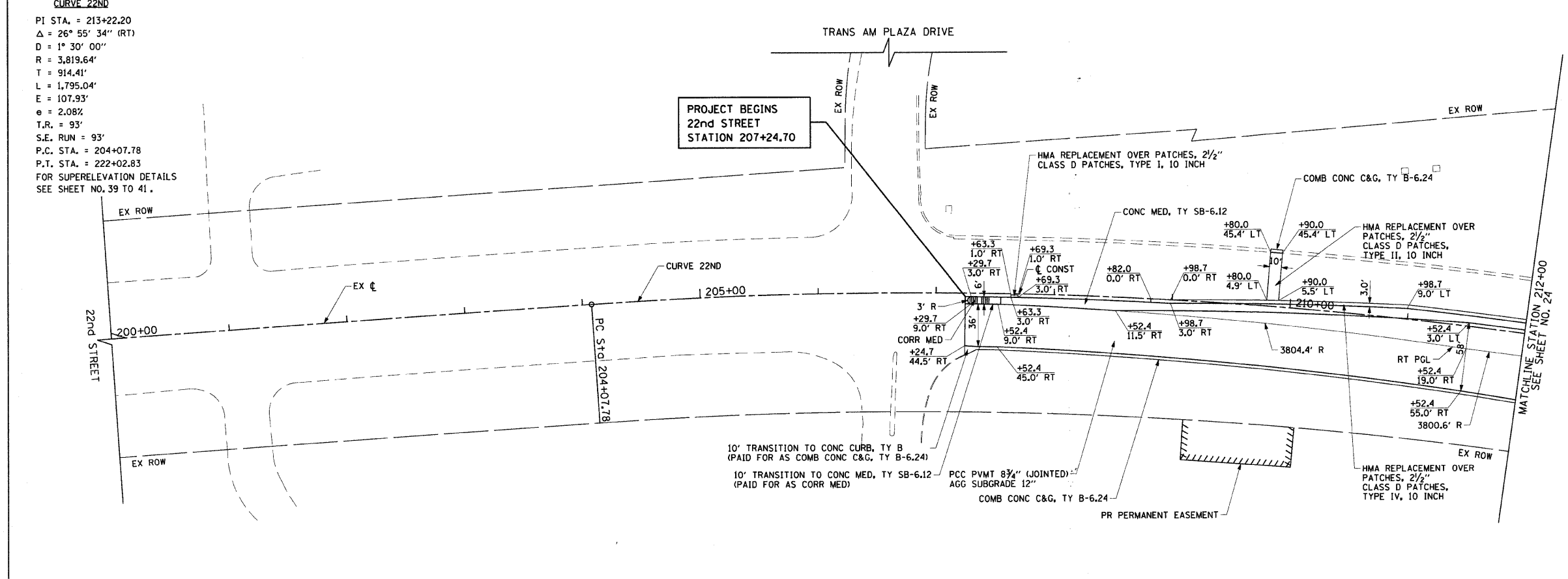

- NOTES:**
1. ALL ENTRANCES ARE COMMERCIAL ENTRANCES.
 2. ALL DRIVEWAY RADII ARE 30' UNLESS OTHERWISE NOTED.
 3. FOR DRIVEWAY DETAILS SEE SHEET NO. 250 AND 251.
 4. FOR CONCRETE MEDIAN TRANSITION DETAILS SEE SHEET NO. 164.
 5. FOR RIGHT-OF-WAY INFORMATION SEE PLAT SHEET NO. 145 TO 156.
 6. ALL SIDEWALK RAMP MUST BE ADA COMPLIANT (STANDARD 424001)

FILE NAME = g:\ch07\0061\road\SHEETS\0160012-SHT-PL	USER NAME = BAW\jart	DESIGNED - JMG	REVISED -	STATE OF ILLINOIS DEPARTMENT OF TRANSPORTATION	22nd STREET REMOVAL PLAN AND ROADWAY PLAN	F.A.U. RTE. = 1453	SECTION = 55WRS	COUNTY = DuPAGE	TOTAL SHEETS = 362	SHEET NO. = 23	
PLT SCALE = 50.0000 / IN.	CHECKED - JRH	REVISIED -	SCALE: 1"=50'			SHEET NO. 23 OF 362 SHEETS	STA. 200+00 TO STA. 212+00	CONTRACT NO. 60D12		FED. ROAD DIST. NO. 7 ILLINOIS FED. AID PROJECT	
PLDT DATE = 8/5/2009	DATE = 07/24/2009	REVISIED -									