

STATION	OFFSET	ELEVATION
A	255+22.4 55.0' LT	696.26
B	255+38.5 65.0' LT	695.08
C	255+40.5 65.0' LT	694.95
D	255+40.5 67.2' LT	694.82
E	255+49.9 93.0' LT	693.37
F	255+49.9 117.9' LT	691.84
G	255+49.2 120.0' LT	691.70*
H	255+88.8 120.0' LT	691.88*
I	255+88.8 95.0' LT	693.35
J	256+08.0 67.0' LT	695.35
K	255+69.4 120.0' LT	691.79*
L	255+15.2 67.0' RT	696.07
M	255+36.4 83.5' RT	695.58
N	255+42.7 105.0' RT	695.34*
O	255+88.3 105.0' RT	695.03*
P	256+15.8 67.0' RT	695.39
Q	255+65.5 105.0' RT	695.20*
R	255+14.6 15.0' LT	697.29
S	255+14.6 9.0' LT	697.23
T	255+22.4 15.0' LT	697.24
U	255+22.4 9.0' LT	697.19
V	256+02.4 9.0' RT	696.64
W	256+02.4 15.0' RT	696.67
X	256+18.8 9.0' RT	696.50
Y	256+18.8 15.0' RT	696.56
Z	255+42.7 70.1' LT	694.59
AA	255+46.2 76.1' LT	694.45
AB	255+96.5 76.1' LT	694.70
AC	256+02.0 70.1' LT	694.88
AD	255+69.4 70.1' LT	694.89
AE	255+69.4 76.1' LT	694.77

*MATCH EXISTING ELEVATION

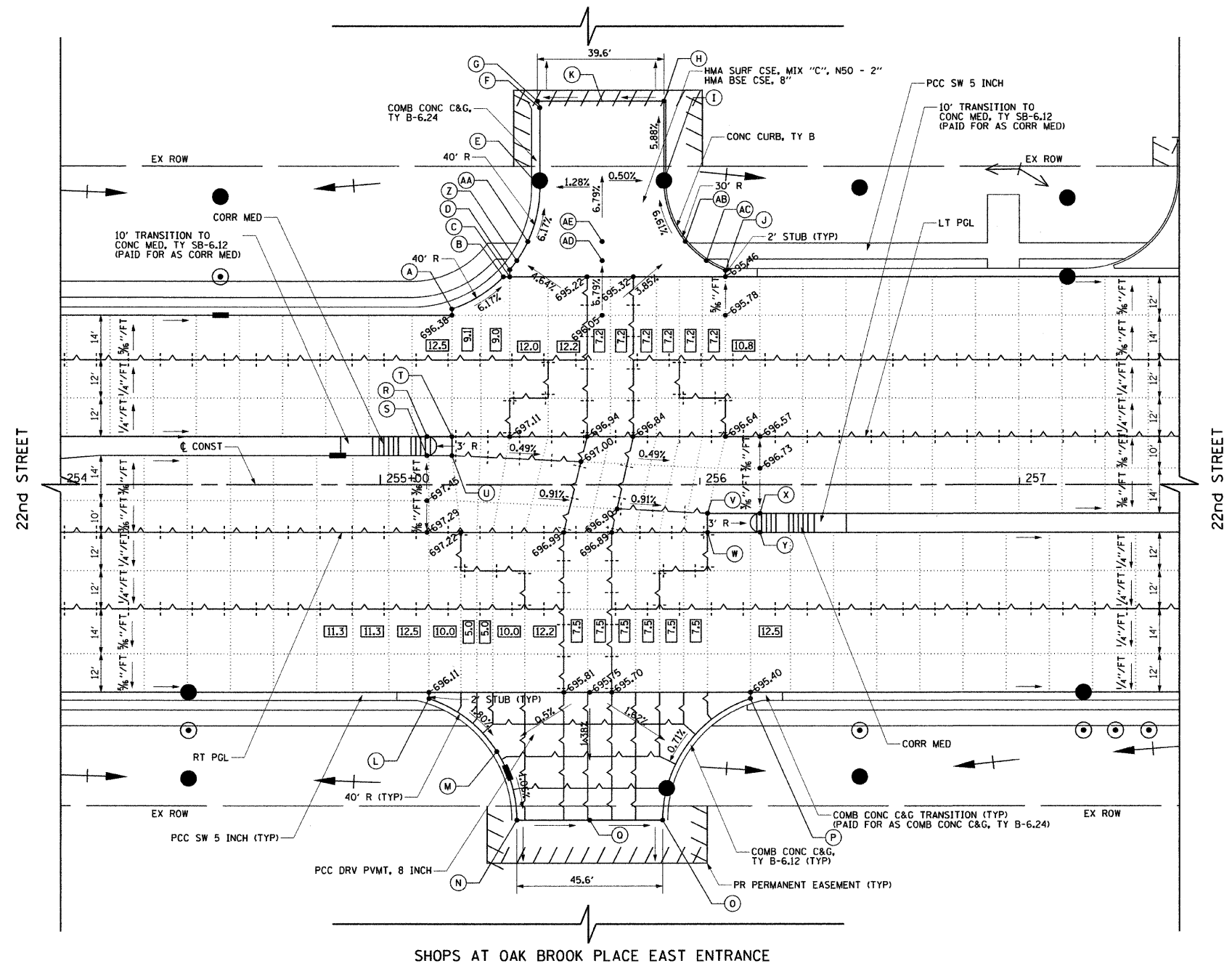

- LEGEND**
- CONSTRUCTION JOINT
 - LONGITUDINAL CONSTRUCTION JOINT NO. 6 X 2' LONG DEFORMED TIE BARS GROUDED-IN PLACE (EPOXY COATED) AT 2' C-C. (STANDARD 420001-07)
 - TRANSVERSE CONSTRUCTION JOINT 1'-6" LONG DOWEL BARS (EPOXY COATED) AT 1' C-C (STANDARD 420101-04)
 - SAWED JOINT
 - LONGITUDINAL SAWED JOINT NO. 6 X 2'-6" LONG DEFORMED TIE BARS (EPOXY COATED) AT 2'-6" C-C (STANDARD 420001-07)
 - TRANSVERSE CONSTRUCTION JOINT 1'-6" LONG DOWEL BARS (EPOXY COATED) AT 1' C-C (STANDARD 420001-07)
 - SAWED/CONSTRUCTION JOINT WITHOUT BARS
 - PAVEMENT SEPARATION JOINT (DOT DISTRICT 1 STANDARD DETAIL BD52) (PAID FOR AS SLEEPER SLAB)
 - 12.5 LENGTH (IN FEET) OF PAVEMENT PANEL (BETWEEN TRANSVERSE JOINTS) IF DIFFERENT THAN 13.5'

- NOTES:**
1. ADDITIONAL SAWED CONTRACTION JOINTS MAY BE REQUIRED IN THE FIELD, AS DIRECTED BY THE ENGINEER. EXACT LOCATIONS TO BE VERIFIED IN THE FIELD AND APPROVED BY THE ENGINEER.
 2. ALL TRANSVERSE JOINTS SHALL BE A MAXIMUM OF 13.5 FEET UNLESS OTHERWISE NOTED. SEE STANDARD 420101-04 FOR ADDITIONAL INFORMATION.
 3. PAVEMENT ROUNDOFFS FOR MANHOLES AND VALVE VAULTS SHALL BE CONSTRUCTED IN ACCORDANCE WITH STANDARD 420111-02.
 4. ALL ELEVATIONS NOT SHOWN SHALL FOLLOW THE TYPICAL SECTIONS AND PROFILES.
 5. PROPOSED ISLANDS SHALL BE CONSTRUCTED IN ACCORDANCE WITH STANDARD 606301-04.
 6. ALL SIDEWALK RAMP MUST BE ADA COMPLIANT (STANDARD 424001-05).

FILE NAME = g:\ch07\0061\road\sheet\0160012-SHT-INT-PRSEC4.dgn

USER NAME = jmgolemba
 PLOT SCALE = 20.0000" / IN.
 PLOT DATE = 12/15/2009

DESIGNED - JLV
 DRAWN - BAW
 CHECKED - JRH
 DATE - 07/24/2009

REVISED -
 REVISED -
 REVISED -
 REVISED -

**STATE OF ILLINOIS
 DEPARTMENT OF TRANSPORTATION**

**22nd STREET INTERSECTION PAVING PLAN
 AT SHOPS AT OAK BROOK PLACE EAST ENTRANCE**
 SCALE: 1"=20' SHEET NO. 160 OF 362 SHEETS STA. 254+00 TO STA. 257+50

F.A. RTE.	SECTION	COUNTY	TOTAL SHEETS	SHEET NO.
1453	55WRS	DUPAGE	362	160
CONTRACT NO. 60D12			FED. ROAD DIST. NO. 7 ILLINOIS FED. AID PROJECT	