

DATE	
BY	
FINAL SURVEY	
SURVEYED	
PLOTTED	
NOTE BOOK	
REPLATE	
AREAS	
CHECKED	
NO.	

DATE	
BY	
ORIGINAL SURVEY	
SURVEYED	
PLOTTED	
NOTE BOOK	
REPLATE	
AREAS	
CHECKED	
NO.	

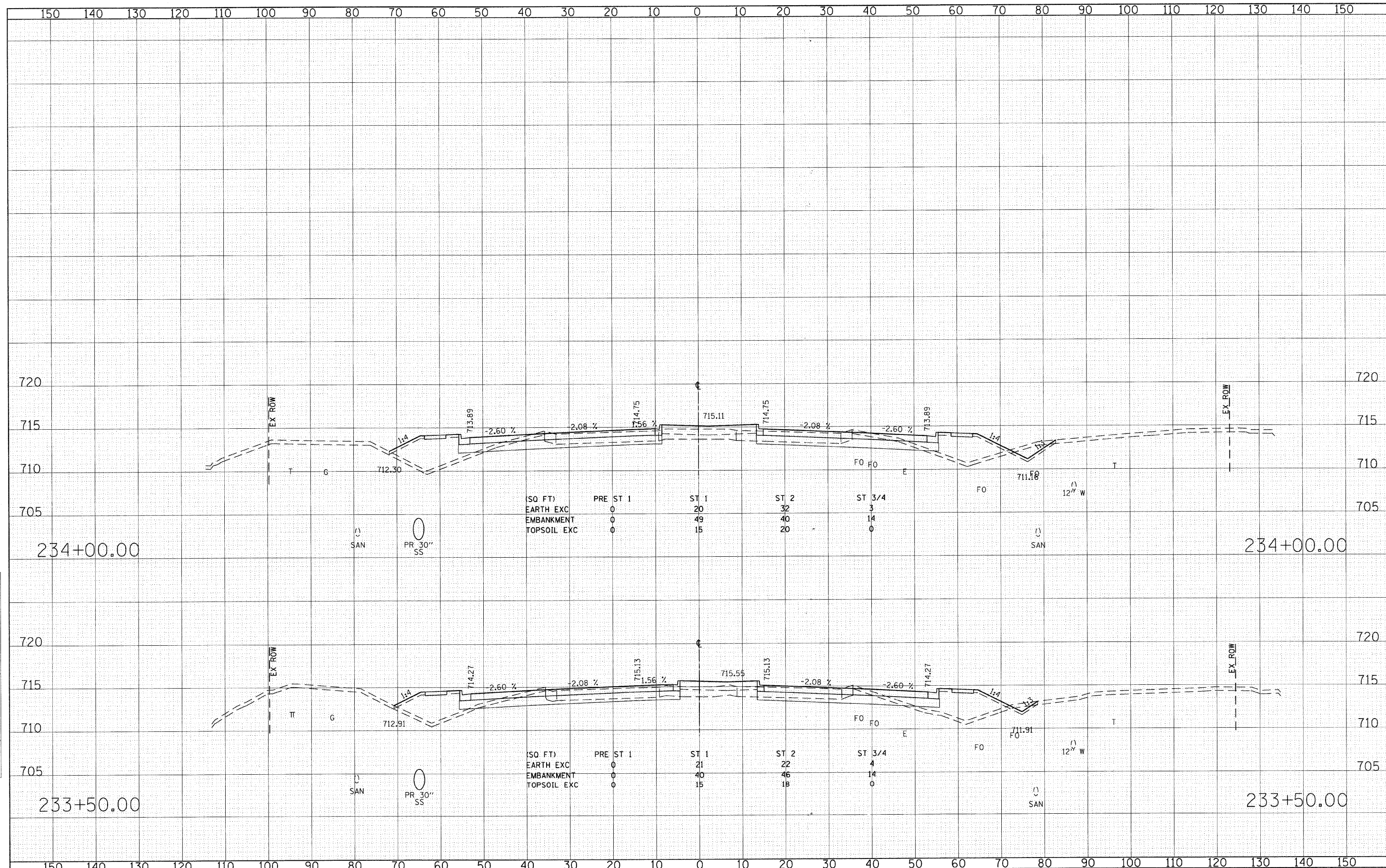

FILE NAME = g:\ch07\0061\road\sheet\0160012-SHT-XSSHT1.dwg	USER NAME = BAW\jort	DESIGNED - JMG	REVISED -	STATE OF ILLINOIS DEPARTMENT OF TRANSPORTATION	CROSS SECTIONS - 22nd STREET			F.A. RATE	SECTION	COUNTY	TOTAL SHEETS	SHEET NO.
		DRAWN - JMG	REVISED -		SCALE: HORIZ: 1"=10'	SHEET NO. 300 OF 362 SHEETS	STA. 233+50.00 TO STA. 234+00.00	1453	55WRS	DuPAGE	362	300
		CHECKED - JRH	REVISED -					CONTRACT NO. 60D12				
		DATE - 01/24/2009	REVISED -		FED. ROAD DIST. NO. 7 ILLINOIS FED. AID PROJECT							