

DATE	
BY	
FINAL SURVEY	SURVEYED
NOTE BOOK	PLOTTED
NO.	REMARKS
	AREAS CHECKED

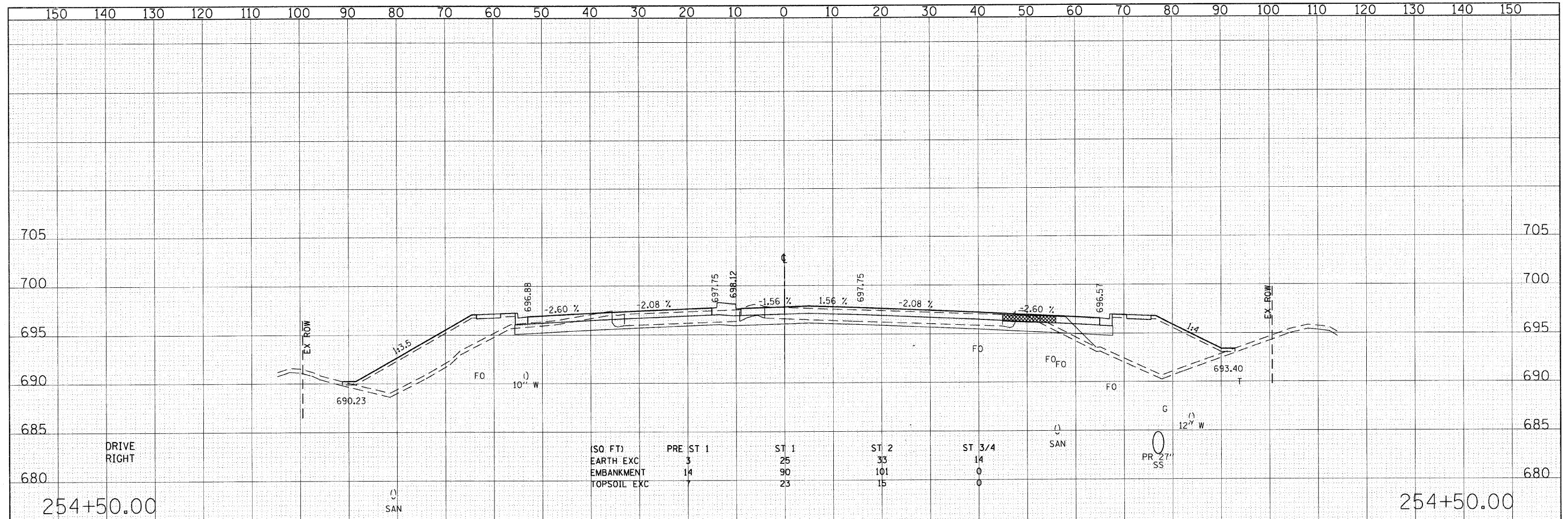

DATE	
BY	
ORIGINAL SURVEY	SURVEYED
NOTE BOOK	PLOTTED
NO.	REMARKS
	AREAS CHECKED

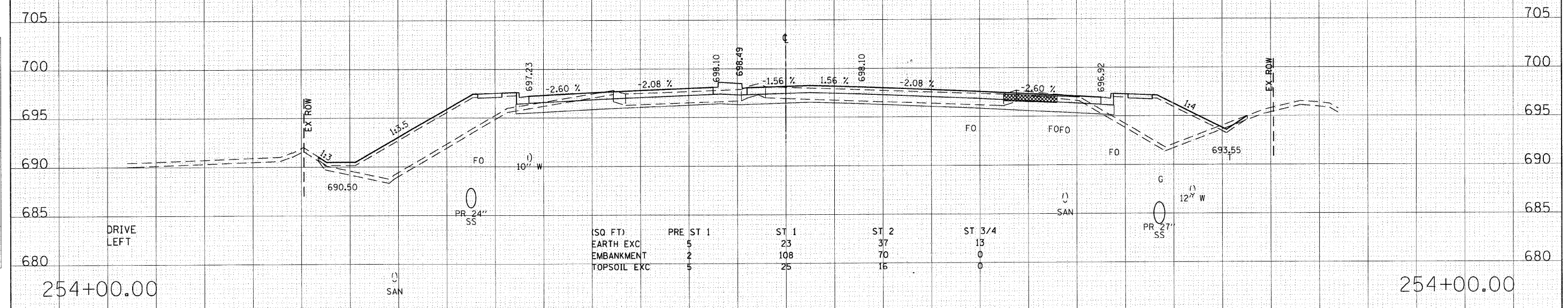

FILE NAME = g:\ch\07\0061\road\sheet\DIG\012-SHT-XSST1.dgn	USER NAME = BAm1tart	DESIGNED - JMG	REVISED -	STATE OF ILLINOIS DEPARTMENT OF TRANSPORTATION	CROSS SECTIONS - 22nd STREET			F.A. RTE. 1453	SECTION 55WRS	COUNTY DuPAGE	TOTAL SHEETS 362	SHEET NO. 322
PLT SCALE = 10.0000' / IN.	CHECKED - JRH	REVISED -	SCALE: HORIZ: 1"=10'		SHEET NO. 322 OF 362 SHEETS	STA. 254+00.00	TO STA. 254+50.00	FED. ROAD DIST. NO. 7 ILLINOIS FED. AID PROJECT				
PLT DATE = 8/5/2009	DATE - 07/24/2009	REVISED -										