

STATE OF ILLINOIS  
DEPARTMENT OF TRANSPORTATION

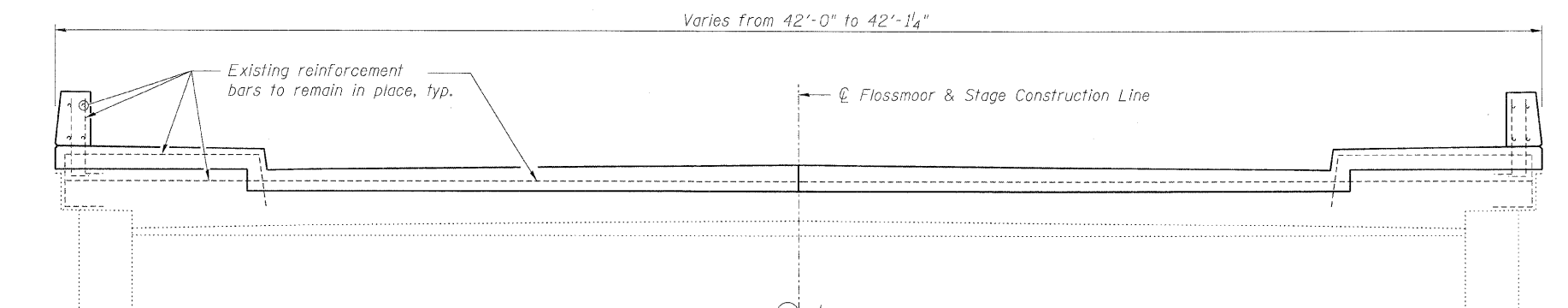

SECTION A-A

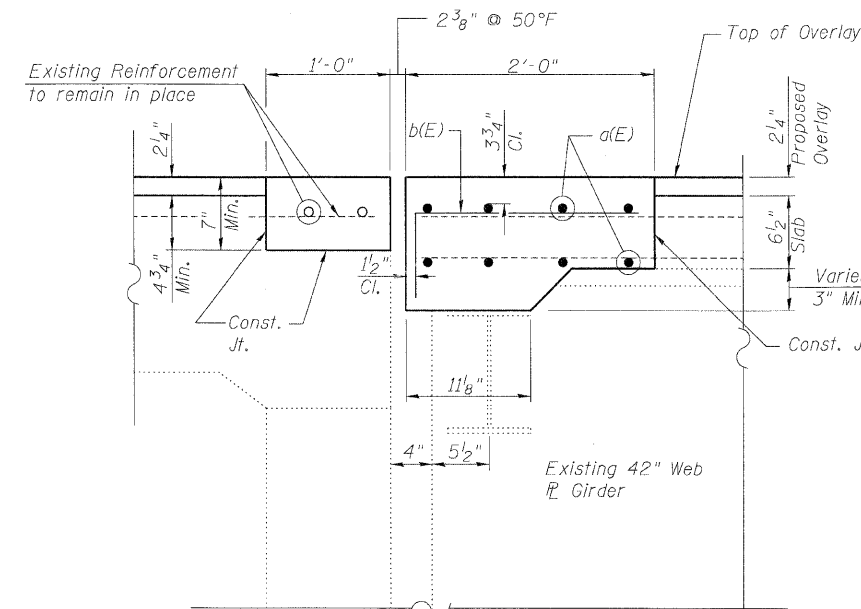

SECTION C-C

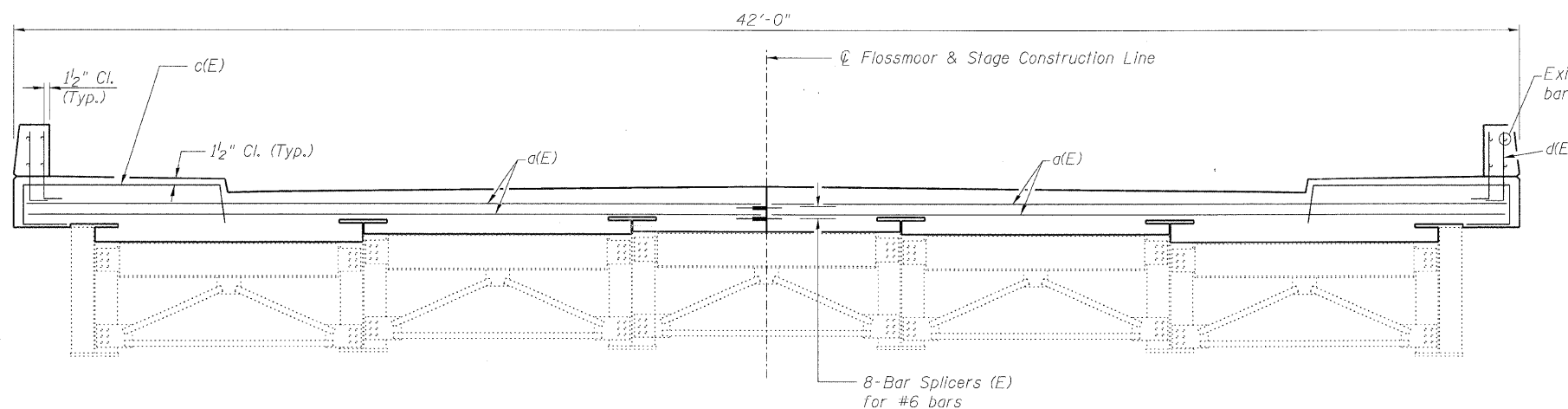

SECTION B-B

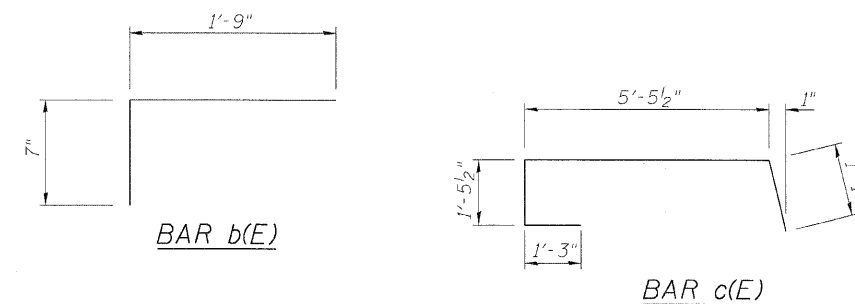

BAR b(E)

BAR c(E)

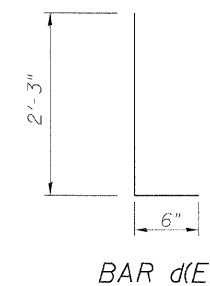

BAR d(E)

BILL OF MATERIAL

| Bar                              | No. | Size | Length | Shape    |      |
|----------------------------------|-----|------|--------|----------|------|
| d(E)                             | 32  | #6   | 20'-9" | —        |      |
| b(E)                             | 84  | #5   | 2'-4"  | ┌        |      |
| c(E)                             | 8   | #4   | 9'-3"  | ┌        |      |
| d(E)                             | 24  | #5   | 2'-9"  | ┌        |      |
| Reinforcement Bars, Epoxy Coated |     |      |        | Pound    | 1320 |
| Concrete Superstructure          |     |      |        | Cu. Yds. | 9.6  |

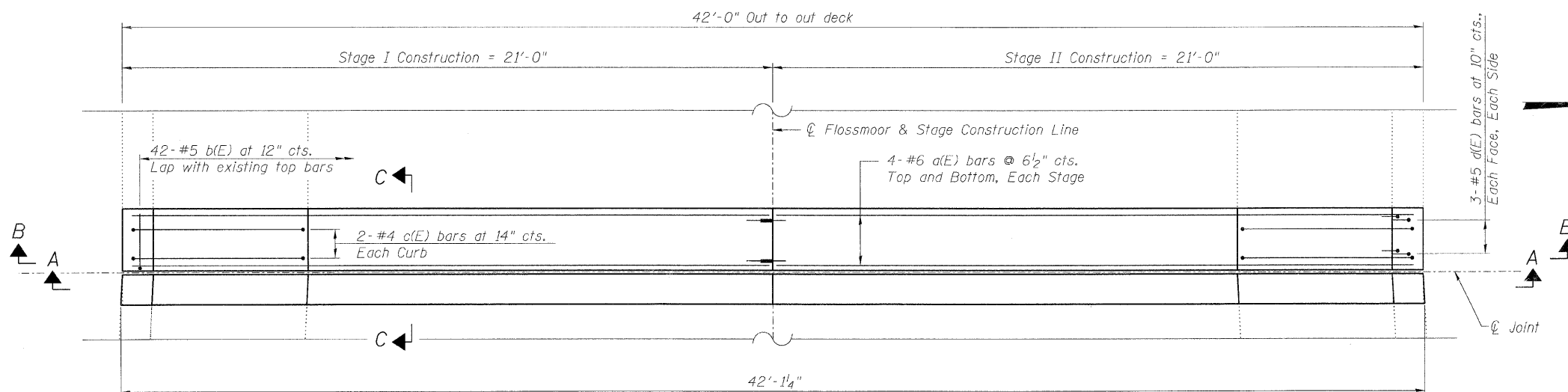

PLAN

(East abutment shown, west abutment mirrored about  $\text{C}$  Joint)

|   |             |             |                    |        |              |           |
|---|-------------|-------------|--------------------|--------|--------------|-----------|
| <p>LIN ENGINEERING, LTD.<br/>Consulting Engineers<br/>Chatham, Illinois</p> | SHEET NO. 6 | F.A.I. RTE. | SECTION            | COUNTY | TOTAL SHEETS | SHEET NO. |
|   | 10 SHEETS   | 57          | 0607-1007 HB-I     | COOK   | 29           | 13        |
|   |             |             | CONTRACT NO. 60J26 |        |              |           |
| FED. ROAD DIST. NO. ILLINOIS FED. AID PROJECT                               |             |             |                    |        |              |           |