

F.A.I. RTE.	SECTION	COUNTY	TOTAL SHEETS	SHEET NO.
290	2009-1151	DUPAGE	27	1
FED. ROAD DIST. NO.	ILLINOIS	CONTRACT NO. 60J34		

**INDEX OF SHEETS**

SHEET NO.	DESCRIPTION
1	COVER SHEET
2	GENERAL NOTES, SUMMARY OF QUANTITIES & HMA REQUIREMENTS
3	DETOUR PLAN
4	ROADWAY & PAVEMENT MARKING PLAN
5	ROADWAY DETAILS
6-24	STRUCTURAL PLANS
25-27	DISTRICT 1 DETAILS

**IDOT STANDARDS**

STD. NO.	DESCRIPTION
000001-05	STANDARD SYMBOLS, ABBREVIATIONS AND PATTERNS
630001-08	STEEL PLATE BEAM GUARDRAIL
635011-02	REFLECTOR MARKER AND MOUNTING DETAILS
701901-01	TRAFFIC CONTROL DEVICES
704001-06	TEMPORARY CONCRETE BARRIER

**DISTRICT 1 DETAILS** - INCLUDED AS PLAN SHEETS 25-27.

DETAIL	DESCRIPTION
TC-11	TYPICAL APPLICATIONS RAISED REFLECTIVE PAVEMENT MARKERS (SNOW-PLOW RESISTANT)
TC-13	DISTRICT ONE TYPICAL PAVEMENT MARKINGS
TC-17	TRAFFIC CONTROL DETAILS FOR FREEWAY SHOULDER CLOSURES PARTIAL RAMP CLOSURES

**TRAFFIC DATA**

ADT = 12,200 VEHICLES  
POSTED SPEED LIMIT = 30 MPH

**PROJECT LOCATED IN THE VILLAGE OF ITASCA**

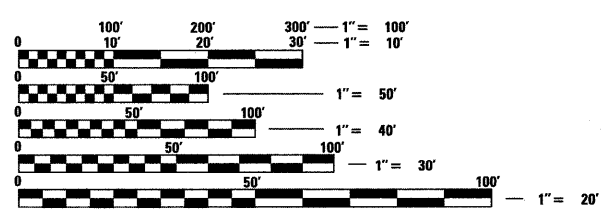

FULL SIZE PLANS HAVE BEEN PREPARED USING STANDARD ENGINEERING SCALES. REDUCED SIZED PLANS WILL NOT CONFORM TO STANDARD SCALES. IN MAKING MEASUREMENTS ON REDUCED PLANS, THE ABOVE SCALES MAY BE USED.

**J.U.L.I.E.**  
JOINT UTILITY LOCATION INFORMATION FOR EXCAVATION  
1-800-892-0123  
OR 811

**PROJECT ENGINEER: CRAIG BAUER (847) 705-4265**  
**PROJECT MANAGER: LONG TRAN (847) 705-4232**

**CONTRACT NO. 60J34**

**STATE OF ILLINOIS**  
**DEPARTMENT OF TRANSPORTATION**  
**DIVISION OF HIGHWAYS**  
**PROPOSED**  
**HIGHWAY PLANS**

**FAI-290 (I-290 / EISENHOWER EXPRESSWAY)**  
**SECTION 2009-1151**  
**AT BLOOMINGDALE ROAD**  
**BRIDGE DECK OVERLAY & JOINT REPAIRS**  
**DUPAGE COUNTY**  
**C-91-224-10**

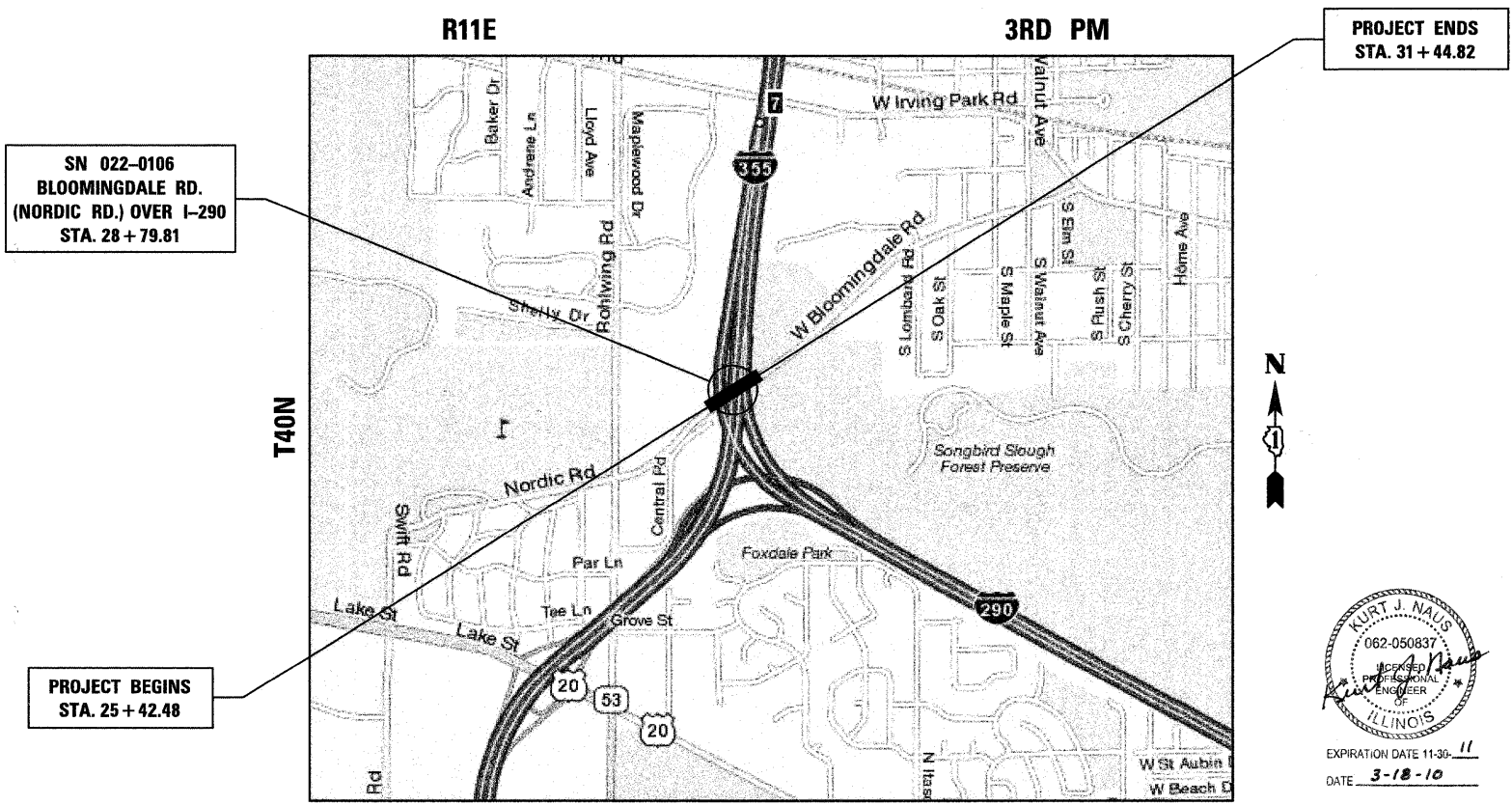

**STATE OF ILLINOIS**  
**DEPARTMENT OF TRANSPORTATION**  
**DIVISION OF HIGHWAYS**

SUBMITTED MARCH 18, 2010

Diana M. O'Keefe  
DEPUTY DIRECTOR OF HIGHWAYS, REGION ENGINEER

April 9, 2010

Scott E. Stitt, P.E.  
Acting ENGINEER OF DESIGN AND ENVIRONMENT

April 9, 2010

Christine M. Reed  
DIRECTOR OF HIGHWAYS, CHIEF ENGINEER

**PRINTED BY THE AUTHORITY**  
**OF THE STATE OF ILLINOIS**

**benesch**  
alfred benesch & company  
Engineers • Surveyors • Planners  
205 North Michigan Avenue, Suite 2400  
Chicago, Illinois 60601  
312-565-0450

**ADDISON TOWNSHIP**  
**LAYOUT MAP**  
**SCALE: 1 IN = 0.2 MI**  
**GROSS LENGTH OF PROJECT = 602.34 LIN FT = 0.114 MILES**  
**NET LENGTH OF PROJECT = 602.34 LIN FT = 0.114 MILES**