

NOTE FOR ALL SIDE STREETS:
 RESURFACING LIMITS ARE AT THE RADIUS RETURNS UNLESS OTHERWISE NOTED
 -PROPOSED HOT-MIX ASPHALT SURFACE REMOVAL 2-1/4"
 -PROPOSED HOT-MIX ASPHALT SURFACE COURSE, MIX "D", N 70, 1-1/2"
 -PROPOSED POLYMERIZED LEVELING BINDER (MACHINE METHOD), IL-4.75, N50, 3/4"

NOTE:
 -FOR RAISED REFLECTIVE PAVEMENT MARKERS, REFER TO TYPICAL APPLICATIONS REISED REFLECTIVE PAVEMENT MARKERS (SNOW PLOW RESISTANT) AND DISTRICT TYPICAL PAVEMENT MARKINGS

LEGEND

- ① THERMOPLASTIC PAVEMENT MARKING LINE, 4", DOUBLE YELLOW CENTERLINE 11" C-C
- ② THERMOPLASTIC PAVEMENT MARKING LINE, 6", WHITE LEFT TURN LANE
- ③ THERMOPLASTIC PAVEMENT MARKING LINE, 4", SKIP DASH YELLOW LANE LINE 10'-40'
- ④ THERMOPLASTIC PAVEMENT MARKING LINE, 12", YELLOW DIAGONAL 45° 75' CTRS.
- ⑤ THERMOPLASTIC PAVEMENT MARKING LINE, 12", WHITE DIAGONAL 45° 8' CTRS.
- ⑥ THERMOPLASTIC PAVEMENT MARKING LINE, 6", WHITE DOTTED 2'-6'
- ⑦ THERMOPLASTIC PAVEMENT MARKING LINE, 24", WHITE SOLID STOP BAR
- ⑧ THERMOPLASTIC PAVEMENT MARKING LINE, LETTERS & SYMBOLS, SQ. YD.
- ⑨ THERMOPLASTIC PAVEMENT MARKING LINE, 4", WHITE EDGE LINE

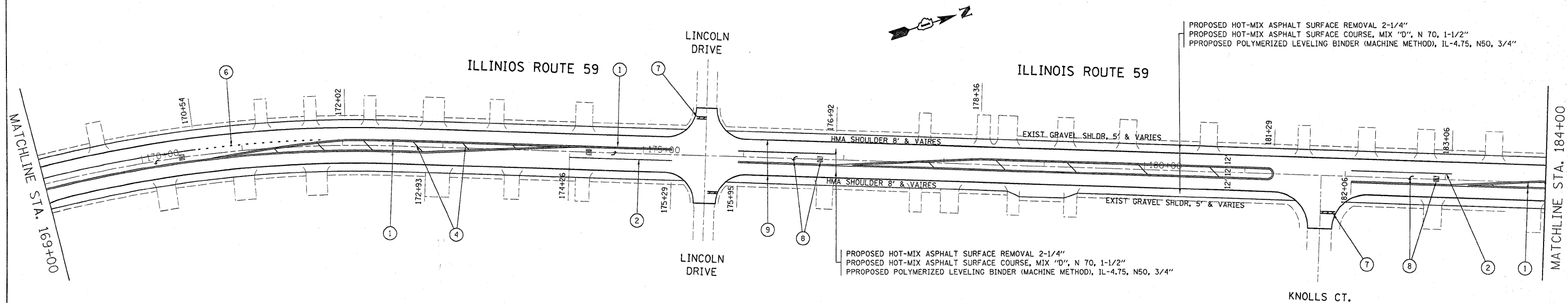
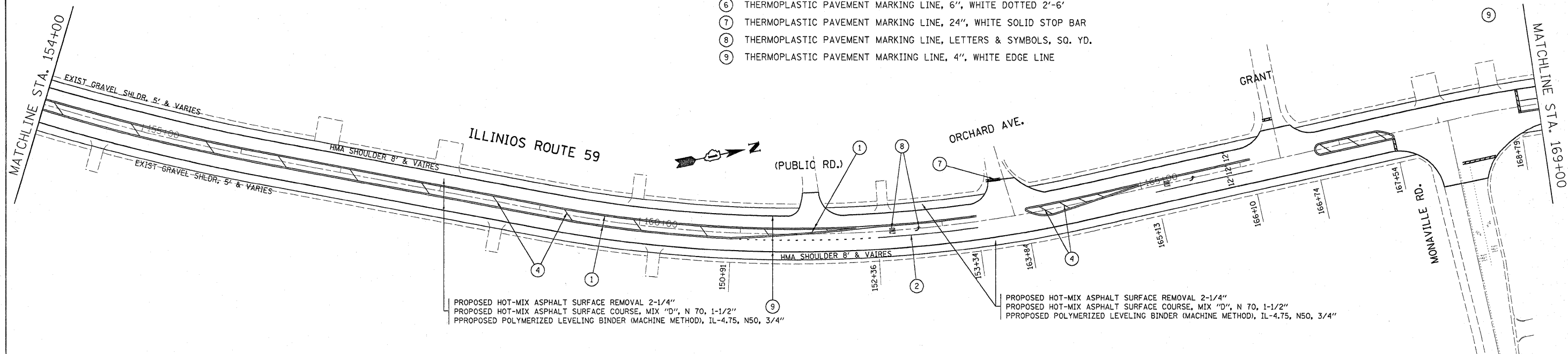

FILE NAME =	USER NAME = bgunsh	DESIGNED -	REVISED -
c:\pwork\pwork\dot\bgunsh\d0180500\0124110-shr-plan.dgn		DRAWN -	REVISED -
PLOT SCALE = 50.0000' / 1" IN.		CHECKED -	REVISED -
PLOT DATE = 2/3/2010		DATE -	REVISED -

STATE OF ILLINOIS
 DEPARTMENT OF TRANSPORTATION

IL. ROUTE 59
 ROADWAY PLANS

SCALE: SHEET NO. OF SHEETS STA. TO STA.

F.A.P. RTE.	SECTION	COUNTY	TOTAL SHEETS	SHEET NO.
104	106 RS-5	LAKE	31	14
CONTRACT NO. 60J51				
ILLINOIS FED. AID PROJECT				