

- NOTES:
1. AREA REFLECTIVE CRACK CONTROL TO BE USED OVER ENTIRE AREA AFTER LEVELING BINDER HAS BEEN PLACED.
  2. PROPOSED GRADE LINE PROFILE 1" ABOVE EXISTING GRADE LINE PROFILE.

SCALE:  
 HORIZONTAL 1" = 20'  
 VERTICAL 1" = 5'

**MILL AVENUE**

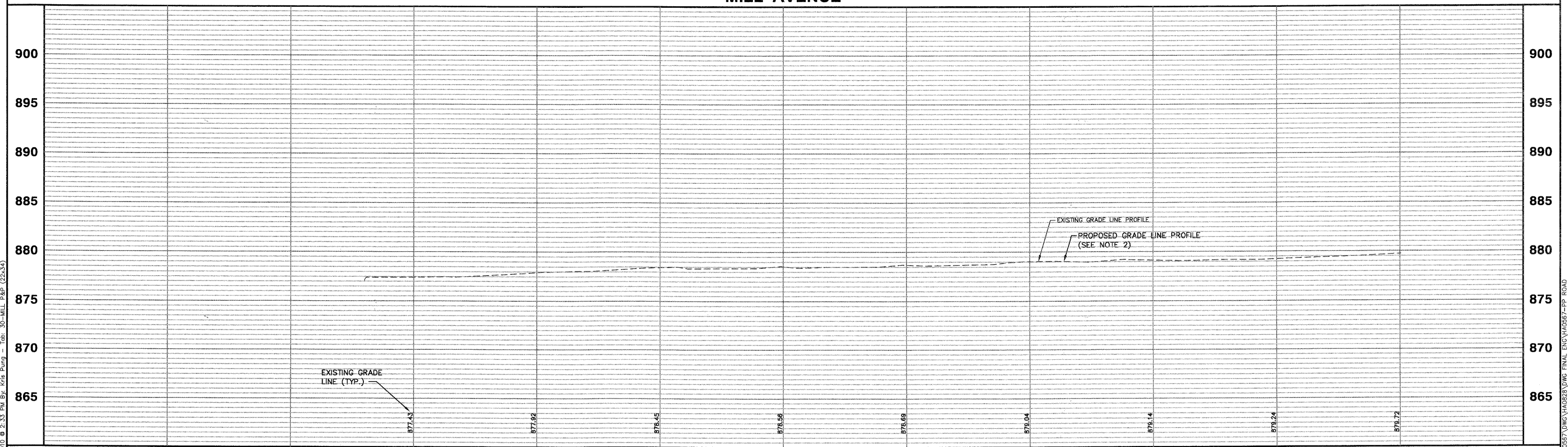

100+00		101+00		102+00		103+00		104+00		105+00				
FILE NAME	USER NAME = #USER#	DESIGNED - JAM, SWM	REVISED - 12/02/09	<b>STATE OF ILLINOIS DEPARTMENT OF TRANSPORTATION</b>				<b>PROPOSED MILL AVENUE PLAN AND PROFILE</b>		F.A. RTE.	SECTION	COUNTY	TOTAL SHEETS	SHEET NO.
#FILE#		DRAWN - KKP	REVISED - 01/22/10							N/A	06-00015-00-PV	KANE	97	30
	PLOT SCALE = #SCALE#	CHECKED - JAM	REVISED - 02/03/10							PROJECT NO. HPP-1468(004)	JOB NO. C-91-175-06	CONTRACT NO. 63406		
	PLOT DATE = #DATE#	DATE - 10/16/09	REVISED -							SCALE: 1"=20'	SHEET NO. 27 OF 92 SHEETS	STA. N/A TO STA. N/A	FED. ROAD DIST. NO. ILLINOIS FED. AID PROJECT	

Plotted: February 1, 2010 @ 2:33 PM By: Kris Pung - Tab: 30-MILL P&P (22x34)

Path: \\SUSKPCG\H4055\DWG\H4022A.DWG FINAL ENG\H4055-PP.ROAD