

- NOTES:
1. AREA REFLECTIVE CRACK CONTROL TO BE USED OVER ENTIRE AREA AFTER LEVELING BINDER HAS BEEN PLACED.
 2. PROPOSED GRADE LINE PROFILE 1" ABOVE EXISTING GRADE LINE PROFILE.
 3. CONTRACTOR SHALL TAPER LEVELING BINDER AT ALL DRIVEWAYS SO THAT PROPOSED PAVEMENT MATCHES EXISTING TOP OF DRIVEWAY.

SCALE:
 HORIZONTAL 1" = 20'
 VERTICAL 1" = 5'

INDUSTRIAL DRIVE

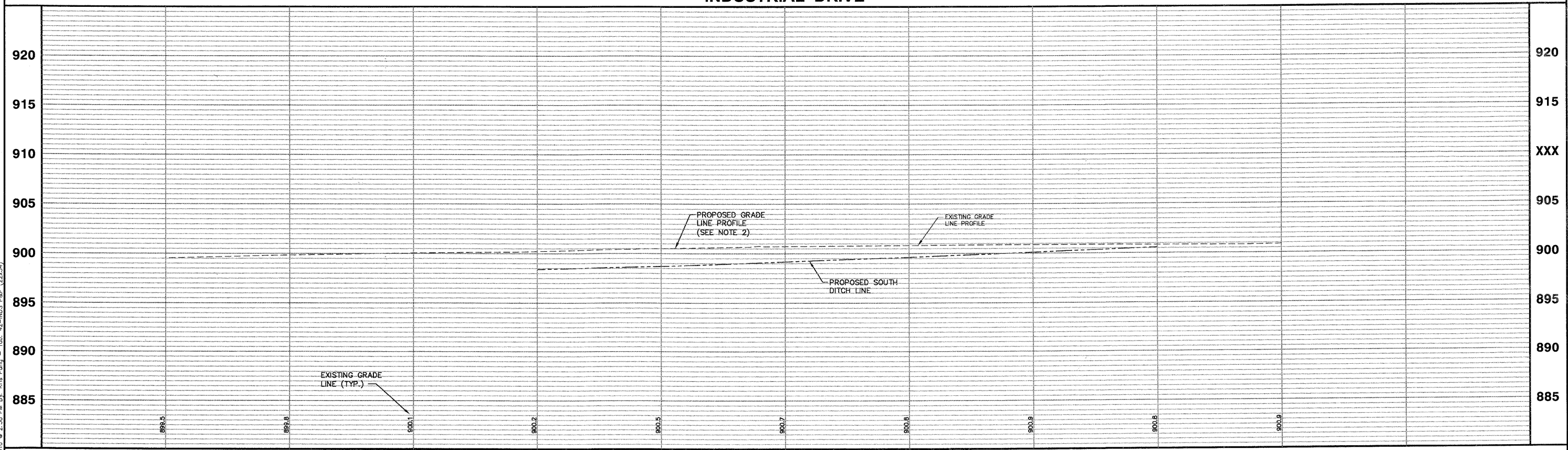

Plotted: February 1, 2010 @ 2:38 PM By: Kris Pung - Tab: 42-INDS P&P (22x34)
 Copyright © 2010 ENGINEERING ENTERPRISES, INC.

Path: \\S05KPC01\IA0597\DWG\IA0238\DWG_FINAL\ENC\IA0238-PP-ROAD

FILE NAME *FILEL*		USER NAME = *USER*	DESIGNED - JAM, SWM DRAWN - KKP CHECKED - JAM DATE - 10/16/09	REVISED - 12/02/09 REVISED - 01/22/10 REVISED - 02/03/10 REVISED -	STATE OF ILLINOIS DEPARTMENT OF TRANSPORTATION	PROPOSED INDUSTRIAL DRIVE PLAN AND PROFILE			F.A. RTE. N/A	SECTION 06-00015-00-PV	COUNTY KANE	TOTAL SHEETS 97	SHEET NO. 42
PLOT SCALE = *SCALE* PLOT DATE = *DATE*		DATE - 10/16/09	PROJECT NO. HPP-1468(004) SHEET NO. 39 OF 92 SHEETS	JOB NO. C-91-175-06 STA. N/A TO STA. N/A		FED. ROAD DIST. NO. - [ILLINOIS] FED. AID PROJECT	Contract No. 63406						