

F.A. RTE.	SECTION	COUNTY	TOTAL SHEETS	SHEET NO.
301	177-2 (-1A, B-1, VB-1)	STEPHENSON	386	62
STA.	580+00	TO STA.	594+00	
FED. ROAD DIST. NO.	ILLINOIS	FED. AID PROJECT		
P-92-029-02				PLN-13 OF 32
CONTRACT #64799				

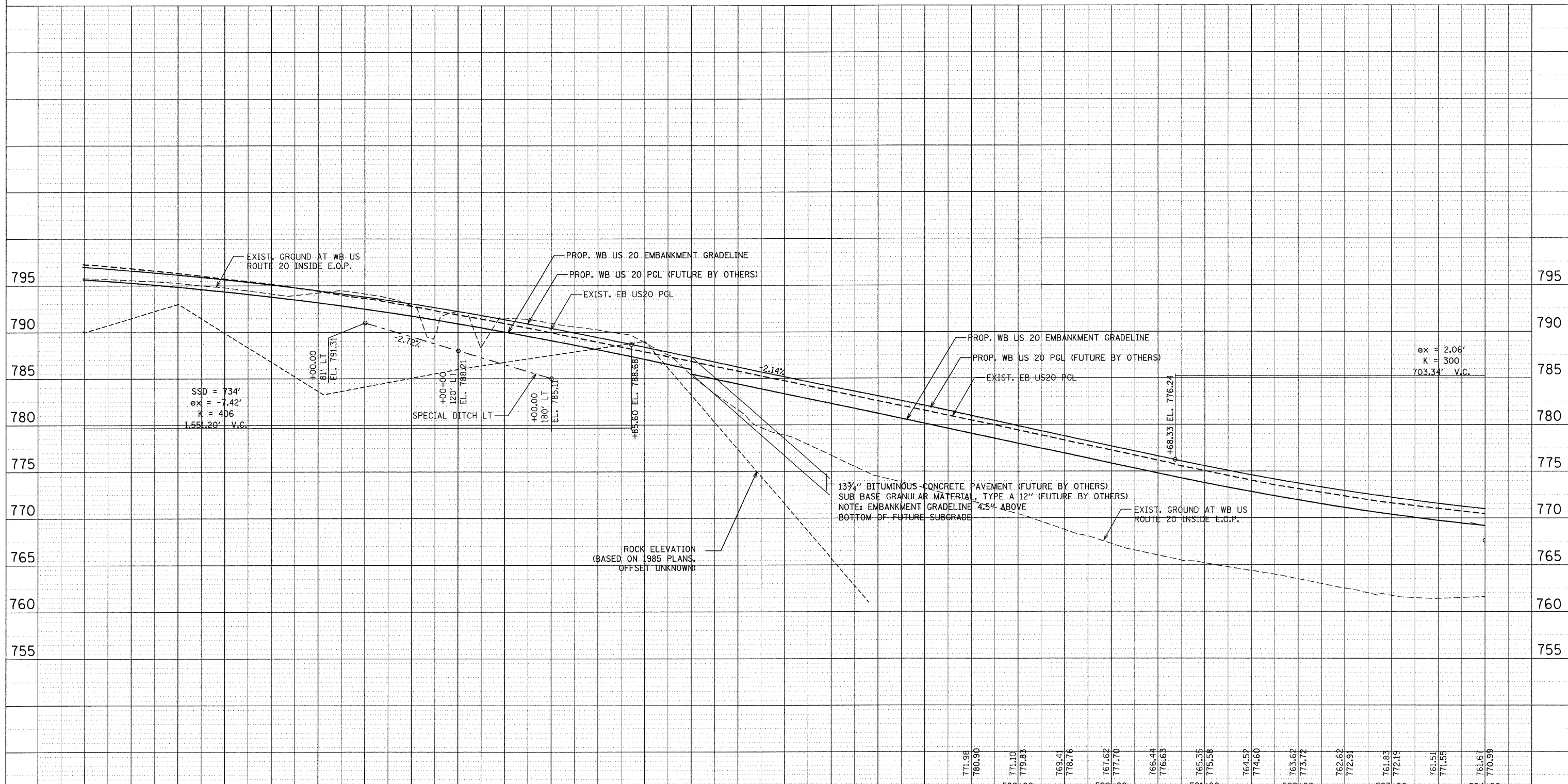

Station	EXIST. GROUND ELEV.	PROP. WB US20 EMBANKMENT PGL ELEV.
579+00	795.66	796.95
580+00	795.44	796.58
581+00	795.10	796.14
582+00	794.63	795.64
583+00	793.97	795.08
584+00	794.09	794.46
585+00	793.88	793.77
586+00	792.58	793.02
587+00	792.17	792.22
588+00	791.33	791.35
589+00	790.78	790.42
590+00	790.05	789.42
591+00	788.74	788.37
592+00	785.35	787.30
593+00	781.64	786.24
594+00	779.02	785.17
	776.88	784.10
	774.64	783.03
	773.38	781.97
	771.98	780.90
	771.10	779.83
	769.41	778.76
	767.62	777.70
	766.44	776.63
	765.35	775.58
	764.52	774.60
	763.62	773.72
	762.62	772.91
	761.83	772.19
	761.51	771.55
	761.67	770.99

100FT (HORIZ.)  
10FT (VERT.)

GRAPHIC SCALE IN FEET

**PARSONS BRINCKERHOFF**

REVISIONS	
NAME	DATE

ILLINOIS DEPARTMENT OF TRANSPORTATION  
F.A.P. ROUTE 301 (US RTE. 20)  
FROM BOLTON ROAD TO WEST OF IL RTE. 26

**PROFILE  
WESTBOUND U.S. ROUTE 20**

SCALE: VERT. 1"=50'  
HORIZ. 1"=50'

DATE: 01-22-10

DRAWN BY RMH  
CHECKED BY DM