

F.A.P. RTE.	SECTION	COUNTY	TOTAL SHEETS	SHEET NO.
301	177-2 (-1A, B-1, VB-1)	STEPHENSON	386	128
STA.	TO STA.			
576+00	591+00			
FED. ROAD DIST. NO.	ILLINOIS	FED. AID PROJECT		
P-92-029-02 CONTRACT #64799			PVMRK-01 OF 07	

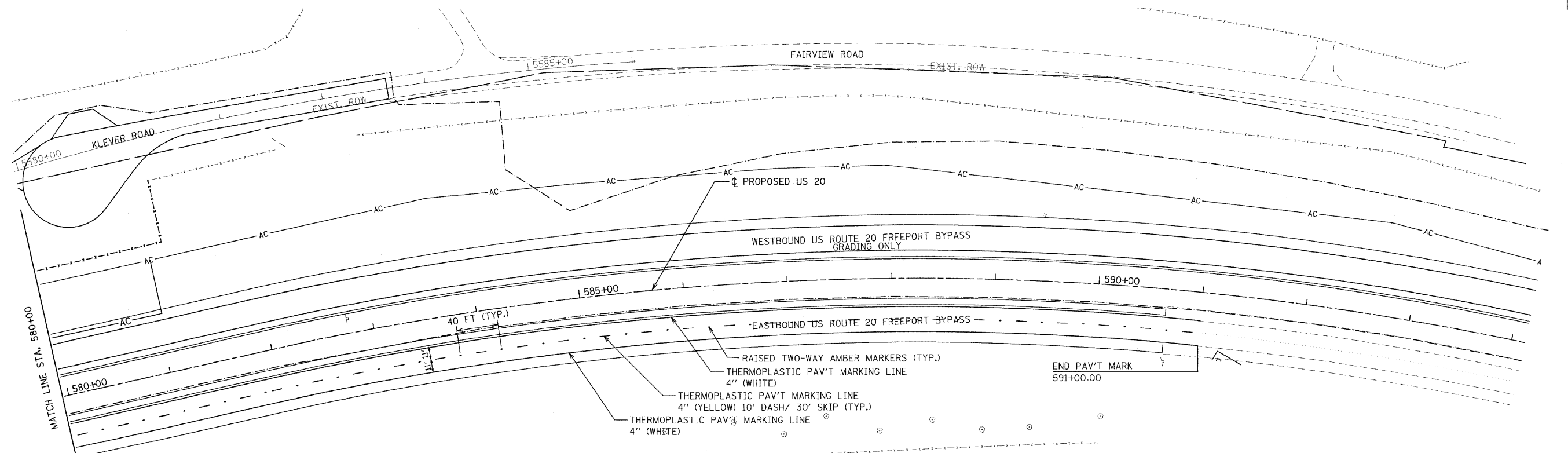

MATCH LINE STA 580+00

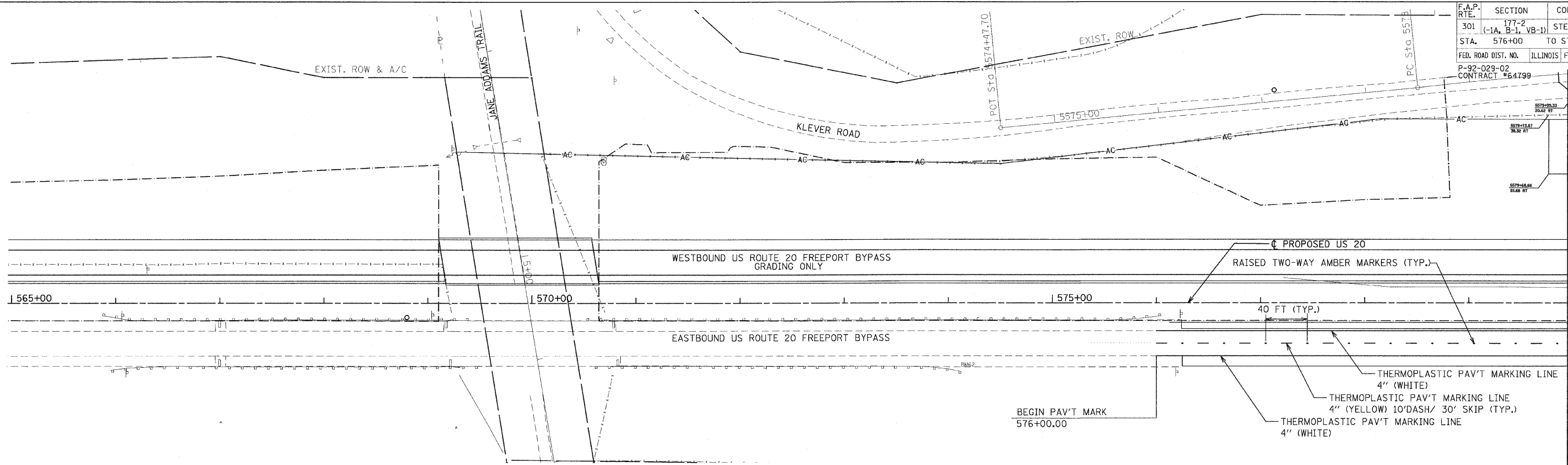

NOTE:
ALL PERMANENT SIGNING SHALL BE FURNISHED AND INSTALLED BY IDOT. THE CONTRACTOR SHALL BE RESPONSIBLE FOR ALL PAVEMENT MARKING WORK AS SHOWN IN THE PLANS.

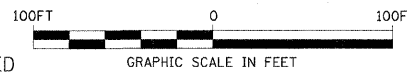

REVISIONS	
NAME	DATE

ILLINOIS DEPARTMENT OF TRANSPORTATION
F.A.P. ROUTE 301 (US RTE. 20)
FROM BOLTON ROAD TO WEST OF IL RTE. 26
PAVEMENT MARKING PLANS
U.S. ROUTE 20

SCALE: 1"=50'
DATE: 01-22-10
DRAWN BY SJV
CHECKED BY RMH