

STATE OF ILLINOIS  
DEPARTMENT OF TRANSPORTATION

ROUTE NO.	SECTION	COUNTY	TOTAL SHEETS	SHEET NO.	SHEET NO. 16
FAP 301	177-2	STEPHENSON	386	156	47 SHEETS
FED. ROAD DIST. NO. 7	ILLINOIS	FED. AID PROJECT-			

Contract No. 64799

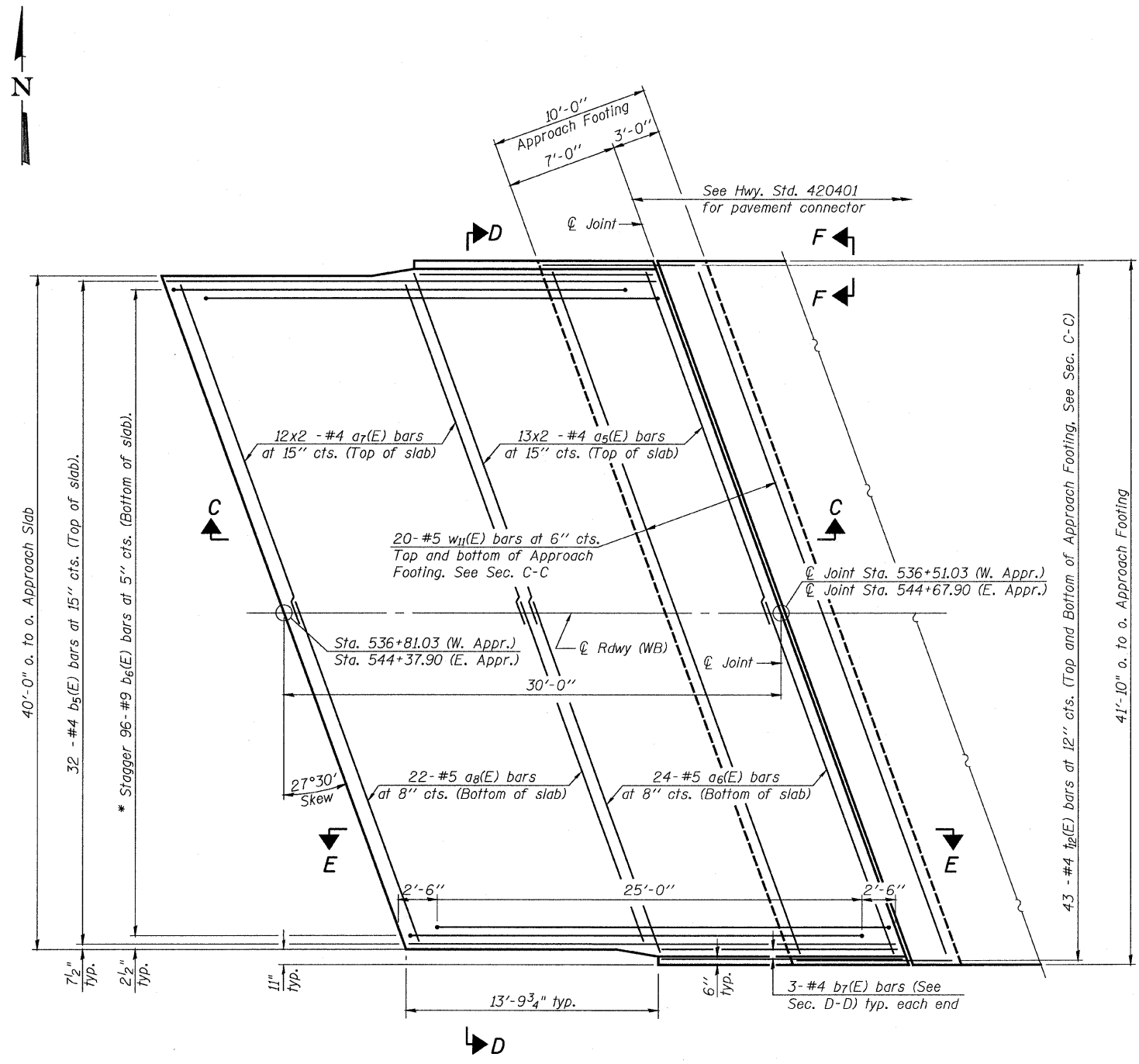

\* Tilt #9 b<sub>6</sub>(E) bars as required to maintain clearance.

Notes:

1. See Sheet No. 17 for Sections C-C & D-D.
2. See Sheet No. 1 for bridge approach pavement drain locations and Standard 609006 for drain details. See Roadway Plans for quantities.
3. a<sub>5</sub>(E) thru a<sub>8</sub>(E) bar spacings measured along  $\phi$  Rdwy.
4. Bars indicated thus 12 x 2 - #4 etc. indicates 12 lines of bars with 2 lengths per line.
5. Field cut reinforcement to clear approach pavement drains.

**MINIMUM BAR LAP**

#4 Bars = 1'-8"

\*\*\* Cost included with Concrete Superstructure.

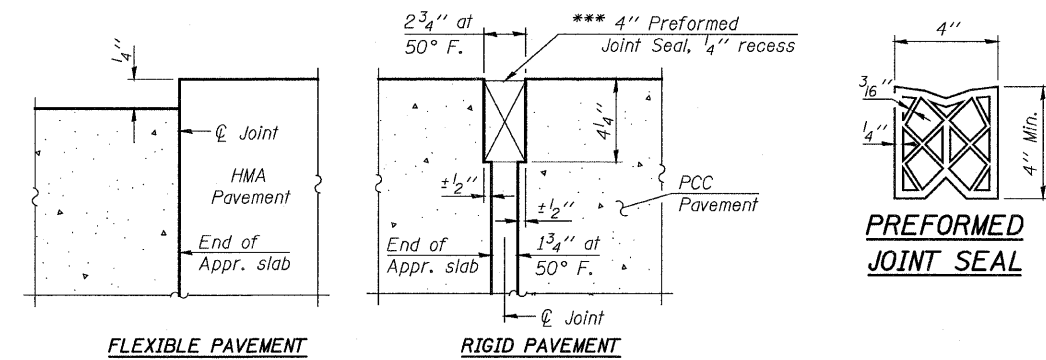

**DETAIL A**

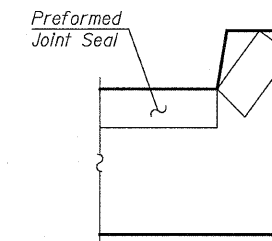

**VIEW F-F**

Angle Preformed Joint Seal at 45° at curbs when req'd for drainage.

DESIGNED	H.ALKHATIB
CHECKED	S.CHELBIAN
DRAWN	H.ALKHATIB
CHECKED	J.GRAINAWI



**BRIDGE APPROACH SLAB  
DETAILS I**  
F.A.P. ROUTE 301 SECTION 177-2B-1  
STEPHENSON COUNTY  
STATION 540+65.71  
STRUCTURE NO. 089-0082

FOR INFORMATION ONLY