

STATE OF ILLINOIS
DEPARTMENT OF TRANSPORTATION
DIVISION OF HIGHWAYS
PROPOSED
HIGHWAY PLANS

FAP 681 (IL 116 & US45)
SECTION (117, 118)RS-3

3P MILLING AND RESURFACING
IROQUOIS COUNTY

C-93-066-09

F.A.P. RTE.	SECTION	COUNTY	TOTAL SHEETS	SHEET NO.
681	(117, 118)RS-3	IROQUOIS	11	1
		ILLINOIS	CONTRACT NO. 66931	

INDEX OF SHEETS

1	COVER SHEET
2	GENERAL NOTES AND LOCATION MAP
3	SUMMARY OF QUANTITIES
4	TYPICAL SECTIONS
5-6	SCHEDULES
7	SCHEMATIC
8-11	DETAILS

STANDARDS

000001-05	STANDARD SYMBOLS, ABBREVIATIONS AND PATTERNS
001006	DECIMAL OF AN INCH AND OF A FOOT
406201-01	MAILBOX TURNOUT
667101-01	PERMANENT SURVEY MARKERS
701001-02	OFF-ROAD OPERATIONS 2L, 2W, MORE THAN 15' (4.5 m) AWAY
701006-03	OFF-ROAD OPERATIONS 2L, 2W, 15' (4.5 m) TO 24" (600 mm) FROM PAVEMENT EDGE
701011-02	OFF-ROAD MOVING OPERATIONS 2L, 2W, DAY ONLY
701201-03	LANE CLOSURE, 2L, 2W, DAY ONLY, FOR SPEEDS ≥ 45 MPH
701301-03	LANE CLOSURE, 2L, 2W, SHORT TIME OPERATIONS
701306-02	LANE CLOSURE, 2L, 2W, SLOW MOVING OPERATIONS DAY ONLY, FOR SPEEDS ≥ 45 MPH
701311-03	LANE CLOSURE, 2L, 2W, MOVING OPERATIONS - DAY ONLY
701901-01	TRAFFIC CONTROL DEVICES

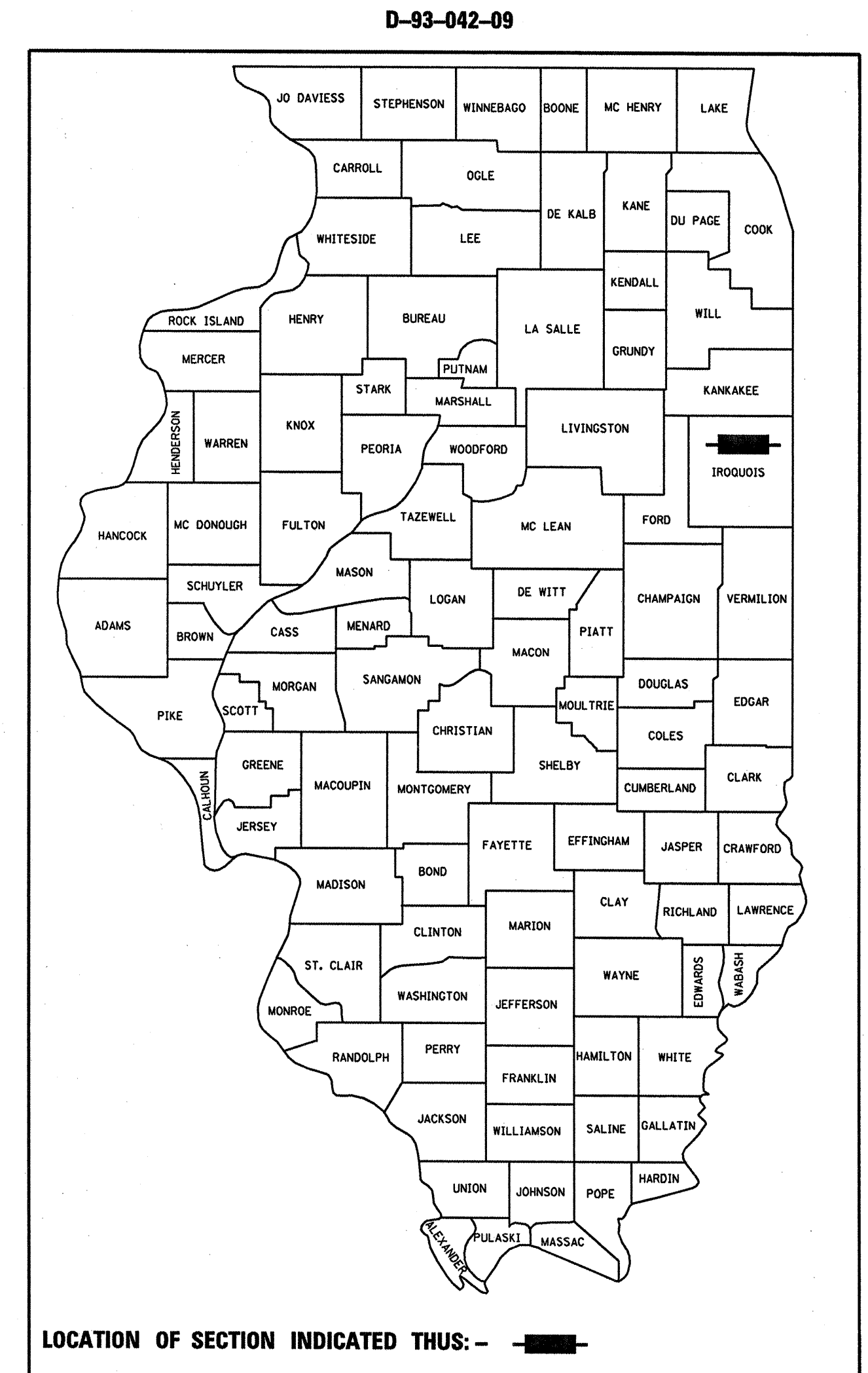

FUNCTIONAL CLASSIFICATION – MINOR ARTERIAL
 2007 ADT = 2,200
 P.V. = 85.2%
 S.U. = 9.1%
 M.U. = 5.7%

STATE OF ILLINOIS
 DEPARTMENT OF TRANSPORTATION
 DIVISION OF HIGHWAYS

SUBMITTED 01/29 2010
Sergio F. Luna
 DEPUTY DIRECTOR OF HIGHWAYS, REGION ENGINEER

March 19, 2010
Scott E. Stitt, P.E.
 ACTING ENGINEER OF DESIGN AND ENVIRONMENT

March 19, 2010
Christine M. Reed
 DIRECTOR OF HIGHWAYS, CHIEF ENGINEER

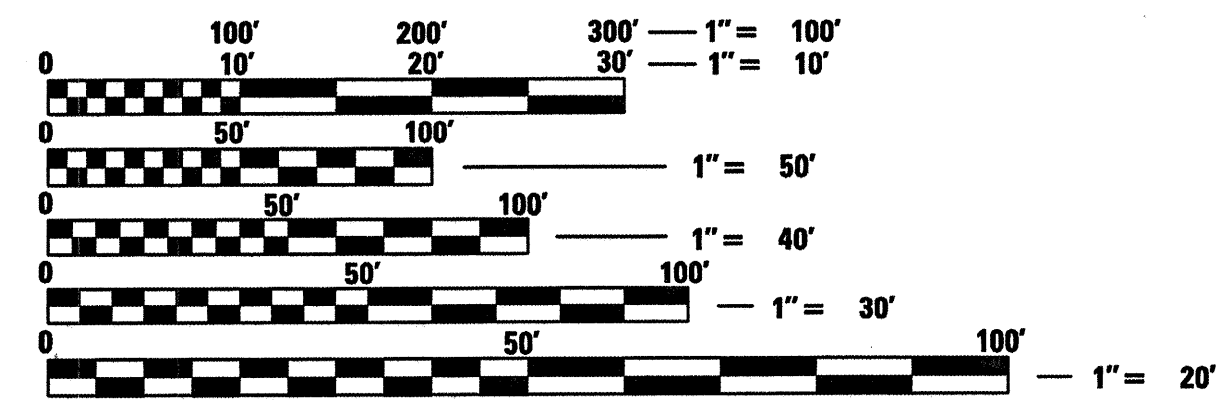
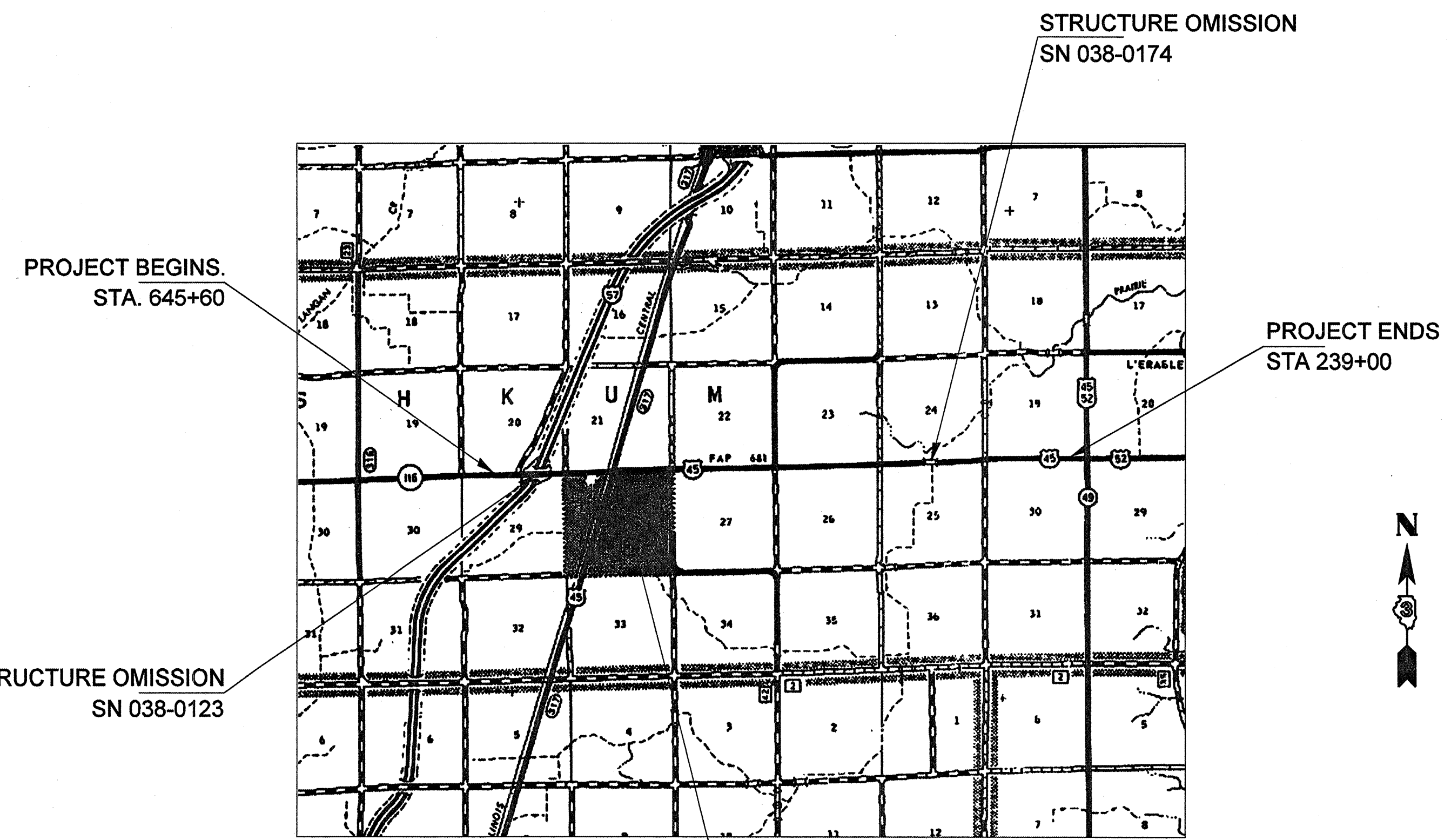

FULL SIZE PLANS HAVE BEEN PREPARED USING STANDARD ENGINEERING SCALES. REDUCED SIZED PLANS WILL NOT CONFORM TO STANDARD SCALES. IN MAKING MEASUREMENTS ON REDUCED PLANS, THE ABOVE SCALES MAY BE USED.

J.U.L.I.E.
 JOINT UTILITY LOCATION INFORMATION FOR EXCAVATION
 1-800-892-0123
 OR 811

PROJECT ENGINEER: JOE KANNEL
UNIT CHEIF: PAT BRABOY /NATHAN SELL
TOWNSHIP: ASHKUM
CONTRACT NO. 66931

STA. EQUATION
 IL 116 STA. 698+02 = 0+00 US 45

GROSS LENGTH = 29,172 FT. = 5.53 MILE
 NET LENGTH = 28,822 FT. = 5.26 MILE

PRINTED BY THE AUTHORITY
OF THE STATE OF ILLINOIS

GENERAL NOTES

(Revised May 13, 2009)

THE THICKNESS OF HMA SHOWN ON THE PLANS IS THE NOMINAL THICKNESS. DEVIATIONS FROM THE NOMINAL THICKNESS WILL BE PERMITTED WHEN SUCH DEVIATIONS OCCUR DUE TO IRREGULARITIES IN THE EXISTING SURFACE OR BASE ON WHICH THE HMA IS PLACED.

THE HMA SURFACE OF ALL MAILBOX TURNOUTS, PRIVATE ENTRANCES, COMMERCIAL ENTRANCES, AND SIDE ROADS SHALL BE MADE NEATLY, IN A WORKMANLIKE MANNER, AND SHALL ACCURATELY CONFORM TO THE SHAPES AND DIMENSIONS SHOWN ON THE PLAN DETAILS. IF REQUIRED BY THE ENGINEER, THE CONTRACTOR SHALL BE REQUIRED TO SAW CUT THE HMA SURFACE TO CONFORM TO THE SHAPES AND DIMENSIONS SHOWN ON THE PLAN DETAILS. THIS WORK SHALL BE INCLUDED IN THE COST OF THE HMA SURFACE.

THE ENGINEER WILL BE THE SOLE JUDGE CONCERNING CURING TIME FOR THE VARIOUS HMA LIFTS.

SEEDING SHALL NOT BE PERMITTED AT ANY TIME WHEN THE GROUND IS FROZEN, WET, OR IN AN UNTILLABLE CONDITION. LOCATIONS TO BE SEEDED WILL BE DETERMINED BY THE ENGINEER.

THE FINISHED EARTHWORK SHALL HAVE A VEGETATION SUSTAINING SOIL COVERING THE TOP FOUR INCHES IN AREAS TO BE SEEDED OR SODDED. THE VEGETATION SUSTAINING SOIL REQUIRED WILL NOT BE PAID FOR SEPARATELY BUT SHALL BE INCLUDED IN THE COST OF FURNISHED EXCAVATION.

ABANDONED UNDERGROUND UTILITIES THAT CONFLICT WITH CONSTRUCTION SHALL BE DISPOSED OF OUTSIDE THE LIMITS OF THE RIGHT OF WAY ACCORDING TO ARTICLE 202.03 OF THE STANDARD SPECIFICATIONS AND AS DIRECTED BY THE ENGINEER. THIS WORK WILL NOT BE PAID FOR SEPARATELY, BUT SHALL BE INCLUDED IN THE COST OF EARTH EXCAVATION.

ANY REFERENCE TO A STANDARD IN THESE PLANS SHALL BE INTERPRETED TO MEAN THE EDITION AS INDICATED BY THE SUBNUMBER SHOWN IN THE LIST OF STANDARDS OR THE COPY INCLUDED IN THESE PLANS.

THE FOLLOWING RATES OF APPLICATION HAVE BEEN USED IN CALCULATING PLAN QUANTITIES:

GRANULAR MATERIALS	2.05	TONS / CU YD
BIT MATERIALS (PRIME COAT) ON AGGREGATE BASES	0.375	GAL / SQ YD
BITUMINOUS MATERIALS (PRIME COAT)	0.08	GAL / SQ YD
FOR ADDITIONAL HMA LIFTS "FOG COAT"	0.05	GAL / SQ YD
AGGREGATE PRIME COAT	0.002	TONS / SQ YD
HMA RESURFACING	112	LBS / SQ YD / IN
SHORT TERM PAVEMENT MARKING	10	FT / 100 FT OF APPLICATION
MIX FOR CRACKS, JTS & FLGWYS	0.0003	TONS / SQ YD
LEVEL BINDER (HAND METHOD)	0.0005	TONS / SQ YD

ALL DAMAGE TO DEPARTMENT OWNED UNDERGROUND FACILITIES, CAUSED BY THE CONTRACTOR SHALL BE REPAIRED TO THE SATISFACTION OF THE DEPARTMENT AT THE CONTRACTOR'S EXPENSE. THIS SHALL INCLUDE ALL TEMPORARY REPAIRS REQUIRED TO KEEP THE FACILITY OPERATIONAL WHILE MATERIAL IS BEING OBTAINED TO MAKE PERMANENT REPAIRS. SPLICING OF ELECTRIC CABLE SHALL NOT BE ALLOWED. ELECTRIC CABLE SHALL BE REPLACED FROM POLE TO POLE OR CONTROLLER.

MEMBERS OF JULIE KNOWN TO BE WITHIN THE LIMITS OF THE IMPROVEMENT ARE:

NON-MEMBERS OF JULIE KNOWN TO BE WITHIN THE LIMITS OF THE IMPROVEMENT ARE:

THE CONTRACTOR SHALL CONTACT JULIE AT LEAST 48 HOURS PRIOR TO EXCAVATION TO DETERMINE WHICH UTILITIES ARE IN THE AREA.

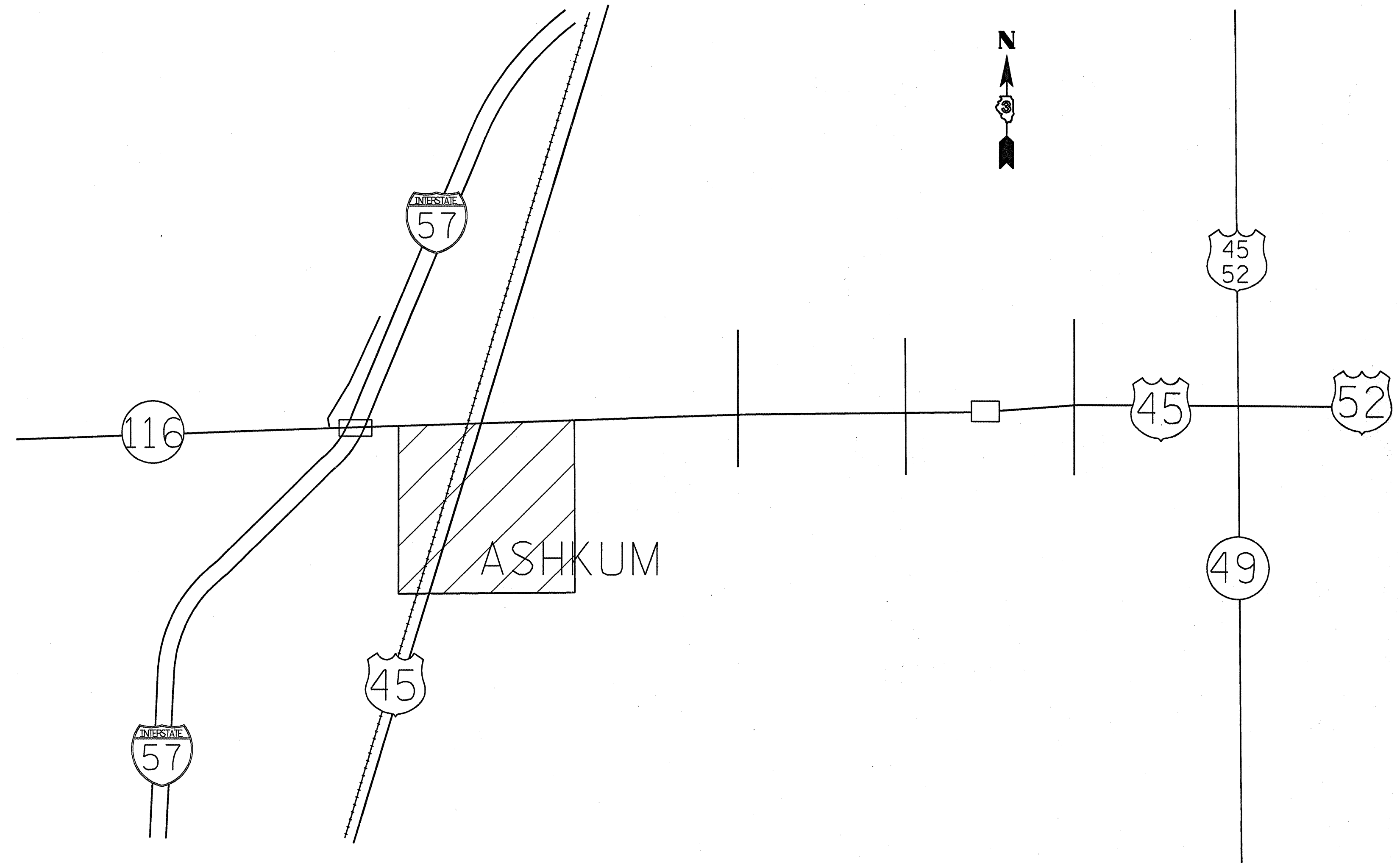

- COMMITMENTS:
 1. TIE POINTS FOR SURVEY MARKERS
 2. STRUCTURE NO. 038-0175 IS RESTRICTED TO LEGAL LOADS ONLY.

STATE OF ILLINOIS
 DEPARTMENT OF TRANSPORTATION
 DISTRICT THREE

PREPARED BY: David Brown
 Acting DISTRICT STUDIES & PLANS ENGINEER

DATE: _____

EXAMINED BY: Heidi Jung
 DISTRICT CONSTRUCTION ENGINEER

Wayne Phillips
 DISTRICT MATERIALS ENGINEER

James A. Shuck
 DISTRICT OPERATIONS ENGINEER

FILE NAME =	USER NAME = sellnr	DESIGNED -	REVISED -
ct:\pwork\PWIDOT\SELLNR\d0119889\d366%31-sht-cover.dgn		DRAWN -	REVISED -
	PLOT SCALE = 50.0638' / IN.	CHECKED -	REVISED -
	PLOT DATE = Jan 29, 2010 - 11:36:06 AM	DATE -	REVISED -

STATE OF ILLINOIS
 DEPARTMENT OF TRANSPORTATION

GENERAL NOTES

SCALE: _____ SHEET NO. ____ OF ____ SHEETS STA. _____ TO STA. _____

F.A.P. RTE.	SECTION	COUNTY	TOTAL SHEETS	SHEET NO.
681	(117, 118)RS-3	IROQUOIS	11	2
CONTRACT NO. 66931				
ILLINOIS FED. AID PROJECT				

SUMMARY OF QUANTITIES

100% STATE
1000

CODE NO.	CONSTRUCTION CODE TYPE: ITEM	100% STATE 1000		
		UNIT	TOTAL QUANTITY	RDWY QUANTITY
20400800	FURNISHED EXCAVATION	CU YD	40	40
40600100	BITUMINOUS MATERIALS (PRIME COAT)	GALLON	11760	11760
40600300	AGGREGATE (PRIME COAT)	TON	187	187
40600400	MIXTURE FOR CRACKS, JOINTS, AND FLANGEWAYS	TON	26	26
40600535	LEVELING BINDER (HAND METHOD), N70	TON	43	43
40600635	LEVELING BINDER (MACHINE METHOD), N70	TON	3694	3694
40600895	CONSTRUCTING TEST STRIP	EACH	1	1
40600982	HOT-MIX ASPHALT SURFACE REMOVAL - BUTT JOINT	SQ YD	6298	6298
40600990	TEMPORARY RAMP	SQ YD	307	307
40603340	HOT-MIX ASPHALT SURFACE COURSE, MIX "D", N70	TON	7566	7566
40800050	INCIDENTAL HOT-MIX ASPHALT SURFACING	TON	818	818
44000155	HOT-MIX ASPHALT SURFACE REMOVAL, 1 1/2"	SQ YD	70348	70348
44000158	HOT-MIX ASPHALT SURFACE REMOVAL, 2 1/4"	SQ YD	17099	17099
48101200	AGGREGATE SHOULDERS, TYPE B	TON	420	420
66700095	PERMANENT SURVEY MARKERS	EACH	3	3
67100100	MOBILIZATION	L SUM	1	1
70100450	TRAFFIC CONTROL AND PROTECTION, STANDARD 701201	L SUM	1	1
70100460	TRAFFIC CONTROL AND PROTECTION, STANDARD 701306	L SUM	1	1
70102620	TRAFFIC CONTROL AND PROTECTION, STANDARD 701501	L SUM	1	1
70300100	SHORT-TERM PAVEMENT MARKING	FOOT	10101	10101
70300210	TEMPORARY PAVEMENT MARKING - LETTERS AND SYMBOLS	SQ FT	184	184
70300220	TEMPORARY PAVEMENT MARKING - LINE 4"	FOOT	63896	63896
70300240	TEMPORARY PAVEMENT MARKING - LINE 6"	FOOT	6880	6880
70300250	TEMPORARY PAVEMENT MARKING - LINE 8"	FOOT	590	590
70300260	TEMPORARY PAVEMENT MARKING - LINE 12"	FOOT	151	151
70300280	TEMPORARY PAVEMENT MARKING - LINE 24"	FOOT	376	376
70301000	WORK ZONE PAVEMENT MARKING REMOVAL	SQ FT	3333	3333
* 78000100	THERMOPLASTIC PAVEMENT MARKING - LETTERS AND SYMBOLS	SQ FT	184	184
* 78000200	THERMOPLASTIC PAVEMENT MARKING - LINE 4"	FOOT	22296	22296
* 78000400	THERMOPLASTIC PAVEMENT MARKING - LINE 6"	FOOT	1680	1680
* 78000500	THERMOPLASTIC PAVEMENT MARKING - LINE 8"	FOOT	590	590
* 78000600	THERMOPLASTIC PAVEMENT MARKING - LINE 12"	FOOT	151	151
* 78000650	THERMOPLASTIC PAVEMENT MARKING - LINE 24"	FOOT	376	376
* 78001110	PAINT PAVEMENT MARKING - LINE 4"	FOOT	41600	41600
* 7800 1130	PAINT PAVEMENT MARKING - LINE 6"	FOOT	5200	5200
* 78100100	RAISED REFLECTIVE PAVEMENT MARKER	EACH	413	413
78300200	RAISED REFLECTIVE PAVEMENT MARKER REMOVAL	EACH	413	413
X0322729	MATERIAL TRANSFER DEVICE	TON	7566	7566
Z0048665	RAILROAD PROTECTIVE LIABILITY INSURANCE	L SUM	1	1

* Specialty Items

FILE NAME =	USER NAME = sellnr	DESIGNED - ___	REVISED - _____
cr\pw\work\PWIDOT\SELLNR\d0119889\d366931-shs-cover.dgn		DRAWN - ___	REVISED - _____
	PLOT SCALE = 50.0638' / IN.	CHECKED - ___	REVISED - _____
	PLOT DATE = Jan 29, 2010 - 11:36:30 AM	DATE - _____	REVISED - _____

**STATE OF ILLINOIS
DEPARTMENT OF TRANSPORTATION**

SUMMARY			
SCALE: _____	SHEET NO. ___ OF ___ SHEETS	STA. _____	TO STA. _____

F.A.P. RTE.	SECTION	COUNTY	TOTAL SHEETS	SHEET NO.
681	(117,118)RS-3	IROQUIOS	11	3
CONTRACT NO. 66931				
ILLINOIS FED. AID PROJECT				

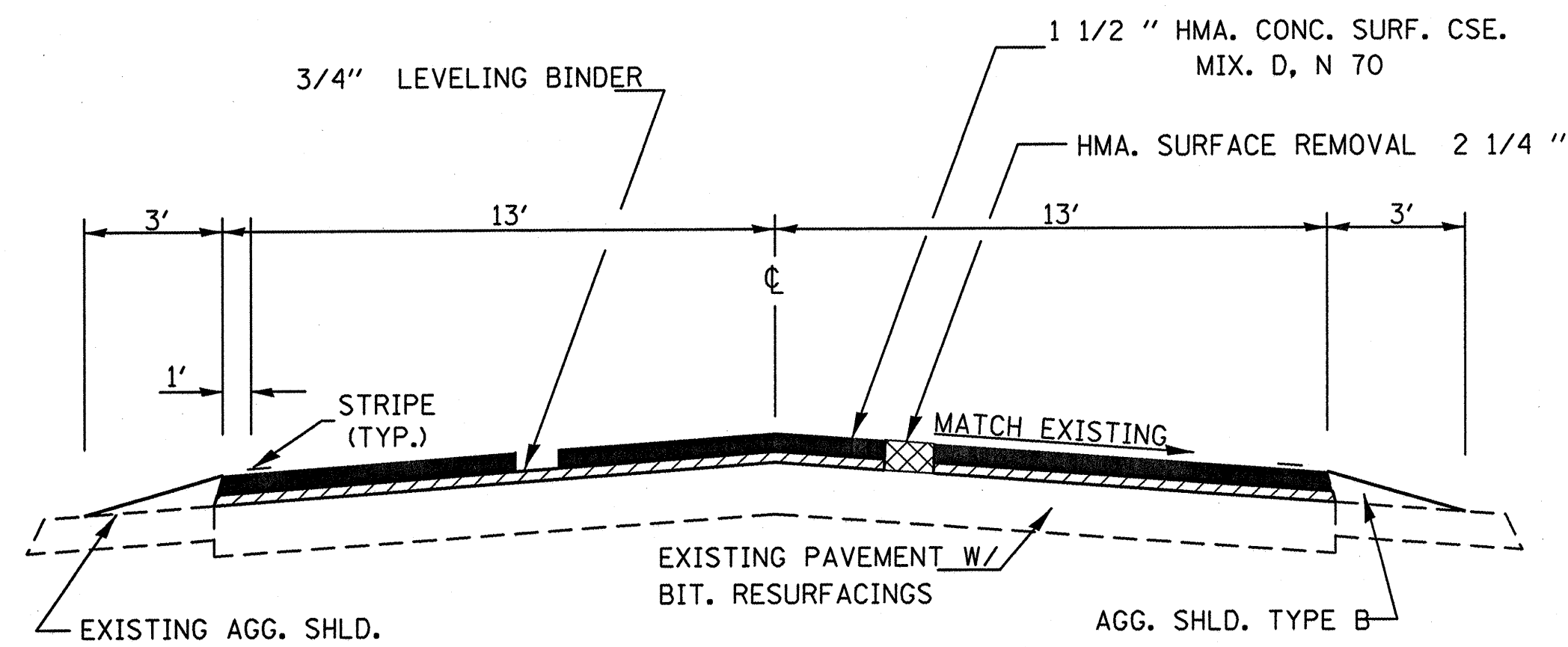

TYPICAL SECTION

STA. 645+60 - 696+35

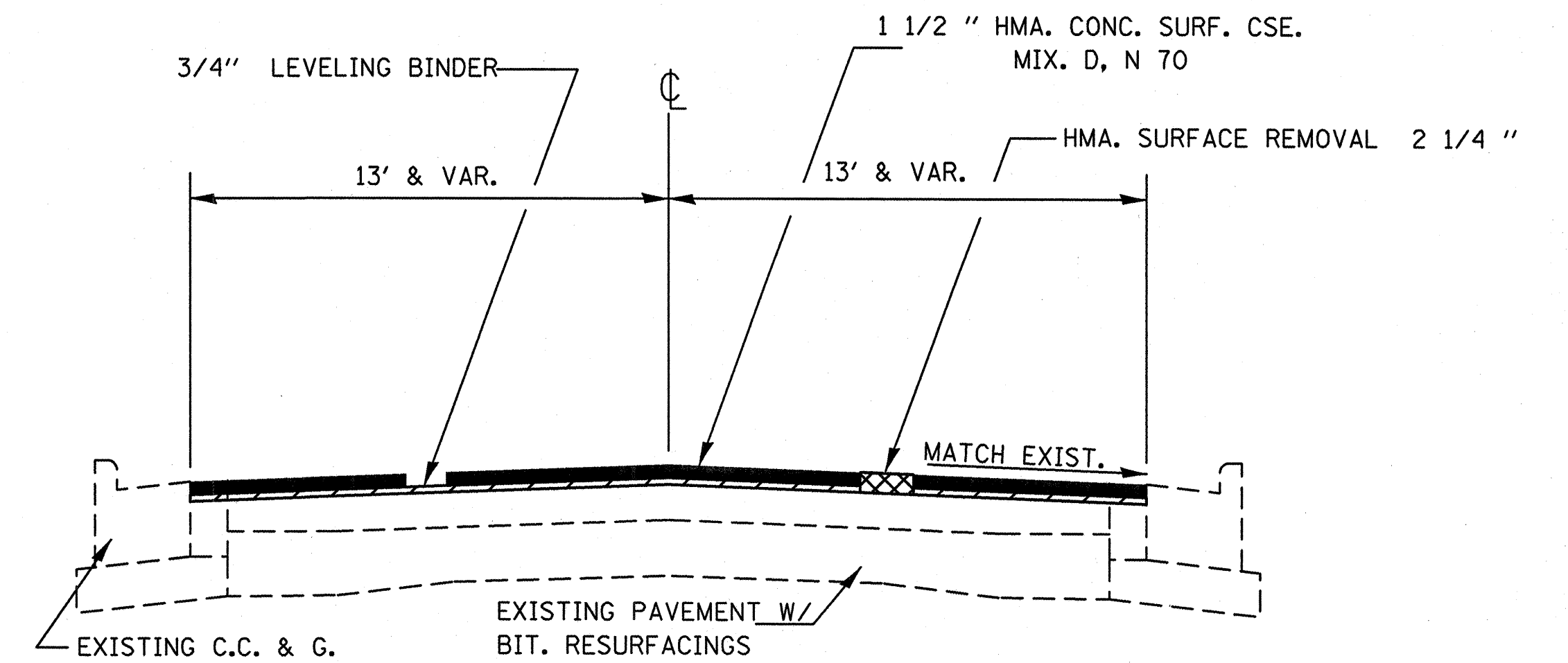

TYPICAL SECTION

STA. 696+77 - 698+02
STA. 0+00 - 1+80

	HMA LEVEL BINDER	HMA SURFACE
PG GRADE	PG64-22	PG64-22
DESIGN AIR VOIDS	4% @ N70	4% @ N70
MIXTURE COMPOSITION	IL 9.5	IL 12.5 OR IL 9.5
FRICTION AGGREGATE		MIXTURE D
DENSITY CONTROL LIMITS	SATISFACTION OF ENGINEER	CORRELATION

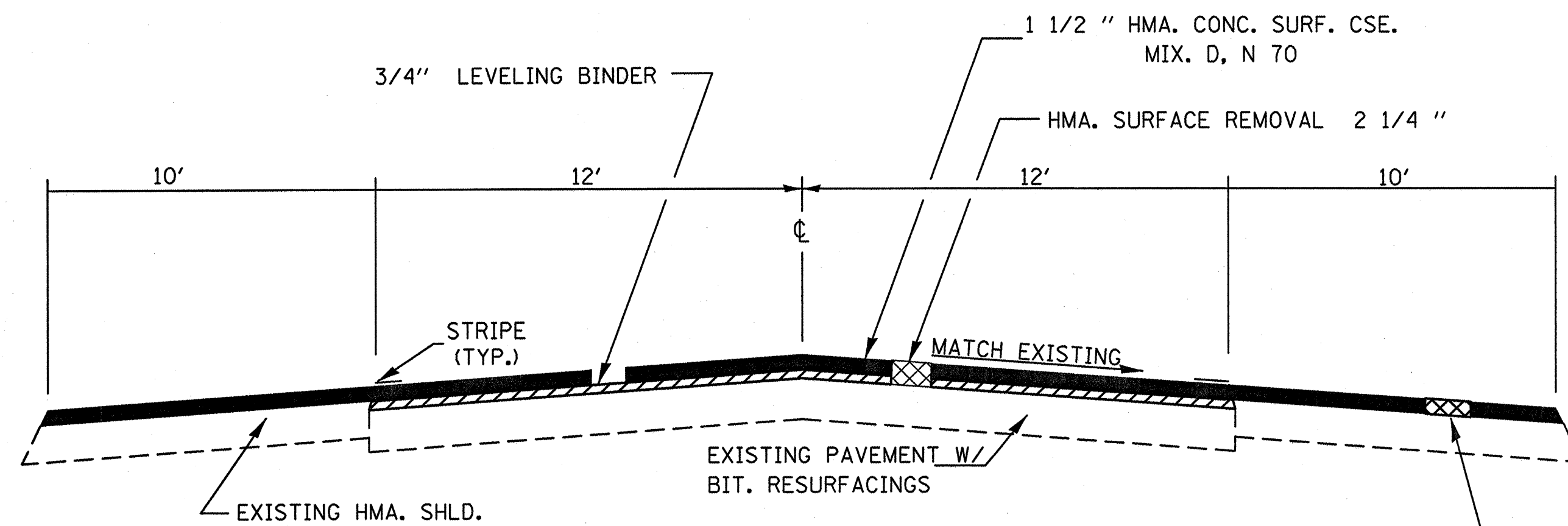

TYPICAL SECTION

STA. 651+24 - 667+36

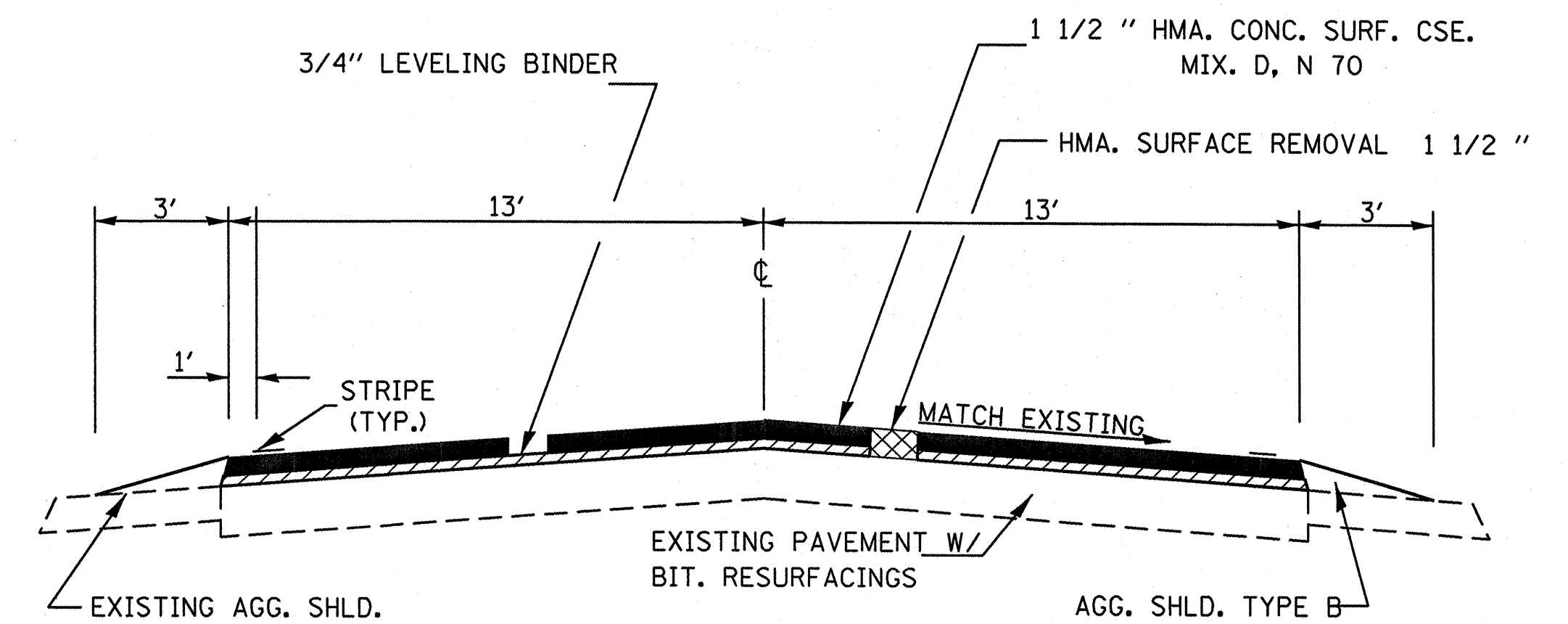

TYPICAL SECTION

STA. 1+80 - 239+00

FILE NAME =	USER NAME = sellnr	DESIGNED -	REVISED -
ct:\pw_work\p\idot\sellnr\d0119889\d36693	shd-details.dgn	DRAWN -	REVISED -
	PLOT SCALE = 49.9974' / IN.	CHECKED -	REVISED -
	PLOT DATE = Jan 29, 2010 - 11:37:43 AM	DATE -	REVISED -

**STATE OF ILLINOIS
DEPARTMENT OF TRANSPORTATION**

TYPICAL SECTIONS

SCALE: _____ SHEET NO. ____ OF ____ SHEETS STA. _____ TO STA. _____

F.A.P. RTE.	SECTION	COUNTY	TOTAL SHEETS	SHEET NO.
681	(117,118)RS-3	IROQUOIS	11	4
			CONTRACT NO. 66931	
ILLINOIS FED. AID PROJECT				

MAINLINE													
LOCATION	WIDTH	LENGTH	AREA	HMA SURF REM 1 1/2"	HMA SURF REM 2 1/4"	HMA LEVEL BIND (HM)	LEVEL BINDER (MM) N70	HMA SC MIX "D" N70	MIX CR JTS FLANGEWYS	BIT MATLS PR CT	AGG PR CT	TEMP RAMP	AGG SHLD TY B
STATION	FT	FT	SQ YD	SQ YD	SQ YD	TON	TON	TON	TON	GAL	TON	SQ YD	TON
645+60 TO 651+24	+26	564	1629.3		1629.3	0.8	68.4	136.9	0.5	211.8	3.3	12.0	42.8
651+24 TO 658+20 *	+24	696.0	1856.0	972.2	1856.0	0.9	78.0	237.6	0.6	319.1	5.7	12.0	52.8
BRIDGE OMISSION													
658+20 TO 660+85 (SN 038-0123)													
660+85 TO 667+36 *	+24	651.0	1736.0	1096.7	1736.0	0.9	72.9	237.9	0.5	313.4	5.7	12.0	49.4
667+36 TO 696+35	+26	2899.0	8374.9		8374.9	4.2	351.7	703.5	2.5	1088.7	16.7	12.0	220.1
696+35 TO 696+77 (RR CROSS.)	VAR.	VAR.	70.0		70.0		2.9	5.9					
BRIDGE OMISSION													
IL 116 / US 45 INTERSECTION													
696+77 TO 1+80**	VAR.	305.0	3432.0		3432.0	1.7	144.1	288.3	1.0	446.2	6.9	48.0	23.2
										0.0			
1+80 TO 163+11	+26	16131.0	46600.7	46600.7		23.3	1957.2	3914.5	14.0	6058.1	93.2	12.0	1224.8
163+11 TO 163+96 (SN 038-0175)													
BRIDGE OMISSION													
163+96 TO 239+00	+26	7504.0	21678.2	21678.2		10.8	910.5	1821.0	6.5	2818.2	43.4	12.0	569.7
TOTALS			85377.1	70347.8	17098.2	42.7	3693.4	7565.8	25.6	11255.4	174.8	120.0	419.4

* QUANTITY INCLUDED FOR HMA REMOVAL 1 1/2" AND HMA SC MIX "D" N70 TO RESURFACE EXISTING 10' SHOULDERS

** QUANTITY INCLUDES NORTH AND SOUTH LEGS OF INTERSECTION. STATION EQUATION IL 116 STA. 698+02 = 0+00 US 45

MATERIAL TRANSFER DEVICE REQUIRED FOR SURFACE COURSE

PAVEMENT MARKING SCHEDULE											
STA. TO STA.	THERMOPLASTIC PAVEMENT MARKING							PAINT PVT MARKING		RAISED REFL PVT MK REM	RAISED REFL PAVT MARK
	4" WHT	4" YELL	6" YELL	8" WHT	12" WHT	24" WHT	LTRS & SYM	4" WHT	6" YELL		
	FT	FT	FT	FT	FT	FT	SQ FT	FT	FT		
645+60 TO 650+48	976	448	120							6	6
650+48 TO 674+50	4804	3617	180							30	30
674+50 TO 696 +35	4370	500	550				39	61.2		27	27
IL 116/ US 45 INTERSECTION		388	100	300			233	122.4		35	35
1+80 TO 31+00	5840	507	730							297	297
31+00 TO 239+00									41600	5200	
RAMP A	192										
RAMP B	226			145	81	54				9	9
RAMP C	232			145	70	50				9	9
RAMP D	196										
SUBTOTALS	16836	5460	1680	590	151	376	183.6	183.6	41600	5200	413
TOTALS		22296	1680	590	151	376	183.6	183.6	41600	5200	413

NOTE: THE FOLLOWING NO PASSING ZONES SHOULD BE FIELD VERIFIED BY THE ENGINEER PRIOR TO RESURFACING

EB: STA. 646+00 TO 667+65
EB STA. 691+35 TO 697+47

WB STA. 651+00 TO 670+00
WB STA. 0+43 TO 5+50

TEMPORARY PAVEMENT MARKING SCHEDULE									
STA. TO STA.	TEMPORARY PAVEMENT MARKING							SHORT TERM PAVT MARK	WORK ZONE PAVT MARK REM.
	4" WHT	4" YELL	6" YELL	8" WHT	12" WHT	24" WHT	LTRS & SYM		
	FT	FT	FT	FT	FT	FT	SQ FT		
645+60 TO 650+48	976	448	120					150	50
650+48 TO 674+50	4804	3617	180					720	238
674+50 TO 696 +35	4370	500	550				39	61.2	218
IL 116/ US 45 INTERSECTION		388	100	300			233	122.4	173
1+80 TO 239+00	47440	507	5930					7110	2346
RAMP A	192								
RAMP B	226			145	81	54		486	160
RAMP C	232			145	70	50		450	149
RAMP D	196								
SUBTOTALS	58436	5460	6880	590	151	376	183.6	10101	3333
TOTALS		63896	6880	590	151	376	183.6	10101	3333

NOTE: THE FOLLOWING NO PASSING ZONES SHOULD BE FIELD VERIFIED BY THE ENGINEER PRIOR TO RESURFACING

EB: STA. 646+00 TO 667+65
EB STA. 691+35 TO 697+47

WB STA. 651+00 TO 670+00
WB STA. 0+43 TO 5+50

FILE NAME =	USER NAME = sellnr	DESIGNED -	REVISED -	STATE OF ILLINOIS DEPARTMENT OF TRANSPORTATION	SCHEDULES			F.A.P. RTE.	SECTION	COUNTY	TOTAL SHEETS	SHEET NO.
c:\pwork\pwork\sellnr\d0119889\d36693	-sht-details.dgn	DRAWN -	REVISED -		SCALE: _____	SHEET NO. _____ OF _____ SHEETS	STA. _____ TO STA. _____	681	(117,118)RS-3	IROQUOIS	11	5
	PLOT SCALE = 50.1606 ' / IN.	CHECKED -	REVISED -					CONTRACT NO. 66931				
	PLOT DATE = Jan 29, 2010 - 11:37:56 AM	DATE -	REVISED -					ILLINOIS FED. AID PROJECT				

SIDE ROAD & ENTRANCES									
LOCATION	STATION	RT/LT	INCIDENTAL	BIT	HMA	TEMP.	FURN.	AGG	
			HMA SURF	MATLS PR CT	SURF REM. BUTT JT.	RAMP	EX*	PR CT	
			TON	GAL	SQ YD	SQ YD	CU YD	TON	
CE	646+28	LT	17.5	11.1	138.8			0.3	
CE	647+28	LT	17.5	11.1	138.8			0.3	
CE	647+98	RT	21.0	13.4	167.0			0.3	
TR 69-A	650+48	LT	61.6	39.1	488.6	22.2	2.0	1.0	
RAMP A	652+80	R	80.4	51.0	638.0	7.1	2.0	1.3	
RAMP B	653+42	LT	87.6	55.6	695.0	7.1	2.0	1.4	
RAMP C	665+73	RT	87.6	55.6	695.0	7.1	2.0	1.4	
RAMP D	666+25	LT	80.4	51.0	638.0	7.1	2.0	1.3	
900 E	674+50	RT/LT	62.5	39.7	496.0	23.1	4.0	1.0	
CE	678+02	RT	4.0	2.5	31.7			0.1	
CE	680+63	RT	2.7	1.7	21.5			0.0	
MBT	687+30	RT	0.9	0.6	7.2			0.0	
PE	687+61	LT	3.5	2.2	27.5			0.1	
CE	688+90	LT	6.1	3.9	48.4			0.1	
CE	690+90	LT	5.5	3.5	43.5			0.1	
MICHIGAN ST	695+10	RT	19.3	12.2	153.1	11.6	2.0	0.3	
PE	695+60	LT	4.5	2.9	35.9			0.1	
CE	696+00	LT	5.0	3.2	39.5			0.1	
CE	2+30	RT	NO WORK - BEHIND CCC & G						
CE	2+90	RT	4.2	2.6	33.0			0.1	
CE	3+80	RT	5.0	3.2	39.5			0.1	
2ND ST	6+00	RT	16.0	10.2	127.1	10.7	2.0	0.3	
PE/MBT	7+50	RT	3.5	2.2	27.5			0.1	
CE	8+52	RT	6.5	4.1	51.4			0.1	
PE	9+42	RT	4.2	2.7	33.6			0.1	
PE	11+00	LT	3.7	2.4	29.4			0.1	
3RD ST	11+02	RT	3.7	2.4	29.7	10.7	2.0	0.1	
PE/MBT	12+61	RT	3.7	2.4	29.4			0.1	
PE	15+25	RT	3.3	2.1	26.4			0.1	
4TH ST	15+78	RT	17.6	11.2	139.7	10.7	2.0	0.3	
PE	18+42	RT	3.6	2.3	28.7			0.1	
5TH ST	21+06	RT	15.3	9.7	121.6	10.7	2.0	0.2	
1000 E	30+56	RT/LT	24.5	15.5	194.1	14.6	4.0	0.4	
PE	54+60	RT	4.2	2.7	33.5			0.1	
MBT	54+60	LT	4.2	2.7	33.5			0.1	
PE	57+40	RT	2.8	1.8	22.2			0.0	
PE	59+60	LT	3.2	2.0	25.1			0.1	
MBT	60+50	LT	3.0	1.9	24.2			0.0	
1100E	83+89	RT/LT	22.2	14.1	176.5	14.6	4.0	0.4	
PE	105+54	RT	3.1	2.0	24.8			0.0	
MBT	105+54	LT	3.0	1.9	23.9			0.0	
PE	115+57	RT	2.8	1.8	22.5			0.0	
MBT	115+57	LT	5.1	3.3	40.7			0.1	
1200 E	136+69	RT/LT	24.1	15.3	191.6	14.6	4.0	0.4	
CE/MBT	155+17	RT	5.2	3.3	41.3			0.1	
PE	156+75	LT	3.4	2.2	27.0			0.1	
1300 E	190+54	RT/LT	24.7	15.7	196.4	14.6	4.0	0.4	
			817.3	503.8	6297.8	186.5	40.0	13.0	

PERMANENT SURVEY MARKERS, TYPE 1	
LOCATION	EACH
30+27	1
83+60	1
136+80	1
TOTAL	3

SEE COMMITMENT FILE FOR TIE POINTS

*PLACE FURNISHED EX AROUND SIDERAOD RADI. THIS AREA TO BE SEEDED, FERILIZED AND MULCHED- NOT PAID FOR SEPERATELY BUT INCLUDED IN THE COST OF FURNISHED EXCAVATION

FILE NAME =	USER NAME = sellnr	DESIGNED -	REVISED -	STATE OF ILLINOIS DEPARTMENT OF TRANSPORTATION	SCHEDULES			F.A.P. RTE. *	SECTION	COUNTY	TOTAL SHEETS	SHEET NO.
es:\pw\work\p\idot\sellnr\d0119889\d3693	-sht-details.dgn	DRAWN -	REVISED -		681	(117,118)RS-3	IROQUOIS	11	6			
	PLOT SCALE = 50,1606' / IN.	CHECKED -	REVISED -		SCALE: _____ SHEET NO. ___ OF ___ SHEETS STA. _____ TO STA. _____			CONTRACT NO. 66931				
	PLOT DATE = Jan 29, 2010 - 11:38:11 AM	DATE -	REVISED -		ILLINOIS FED. AID PROJECT							

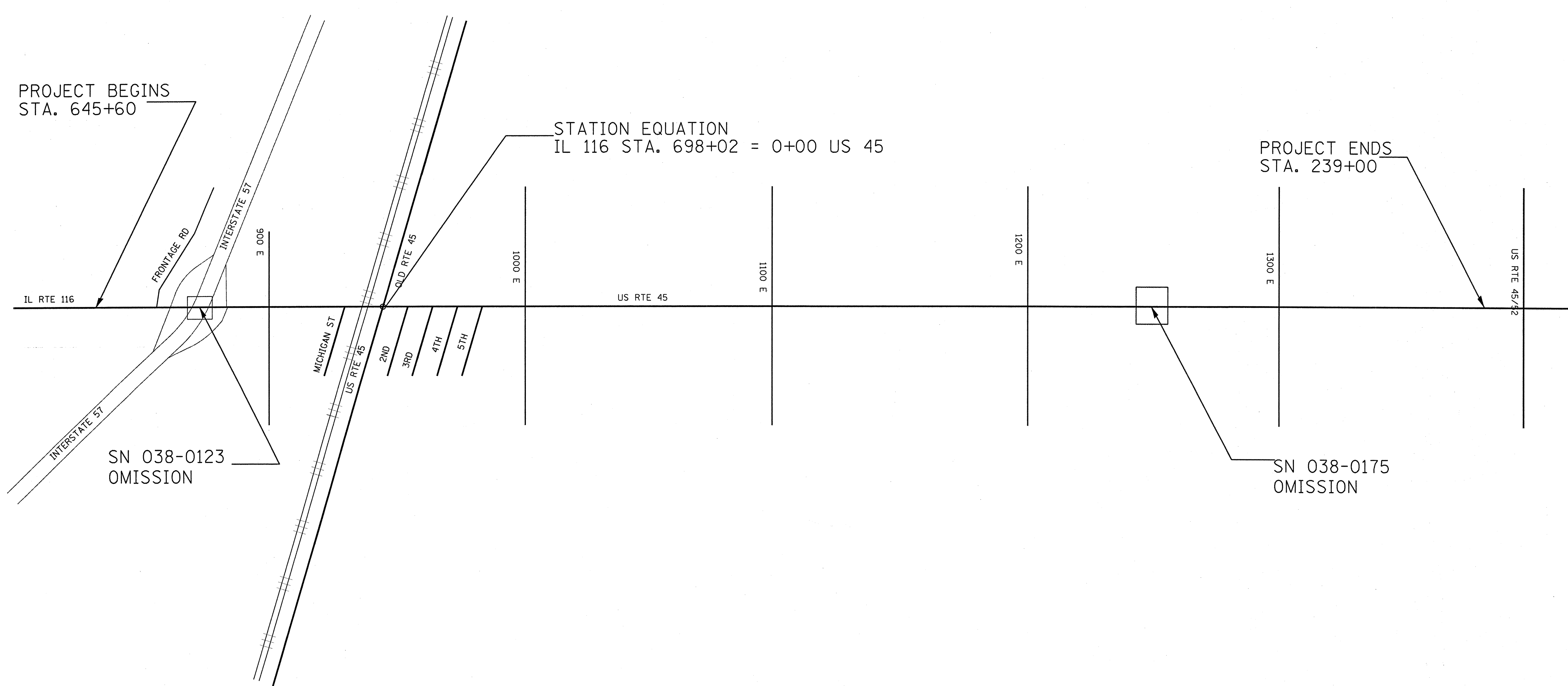

PROJECT BEGINS
STA. 645+60

STATION EQUATION
IL 116 STA. 698+02 = 0+00 US 45

PROJECT ENDS
STA. 239+00

SN 038-0123
OMISSION

SN 038-0175
OMISSION

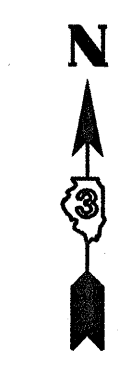

FILE NAME = c:\pr\work\p\dot\sellnr\d0119889\d36693	USER NAME = sellnr	DESIGNED -	REVISED -	STATE OF ILLINOIS DEPARTMENT OF TRANSPORTATION	SCHEMATIC		F.A.P. RTE.	SECTION	COUNTY	TOTAL SHEETS	SHEET NO.	
	-sht-details.dgn	DRAWN -	REVISED -				681	(117,118)RS-3	IROQUOIS	11	7	
PLOT SCALE = 50.1606' / IN.	CHECKED -	REVISED -	REVISED -		SCALE: _____	SHEET NO. ____ OF ____ SHEETS	STA. _____ TO STA. _____	ILLINOIS FED. AID PROJECT				
PLOT DATE = Jan 29, 2010 - 11:38:21 AM	DATE -	REVISED -	REVISED -		CONTRACT NO. 66931							

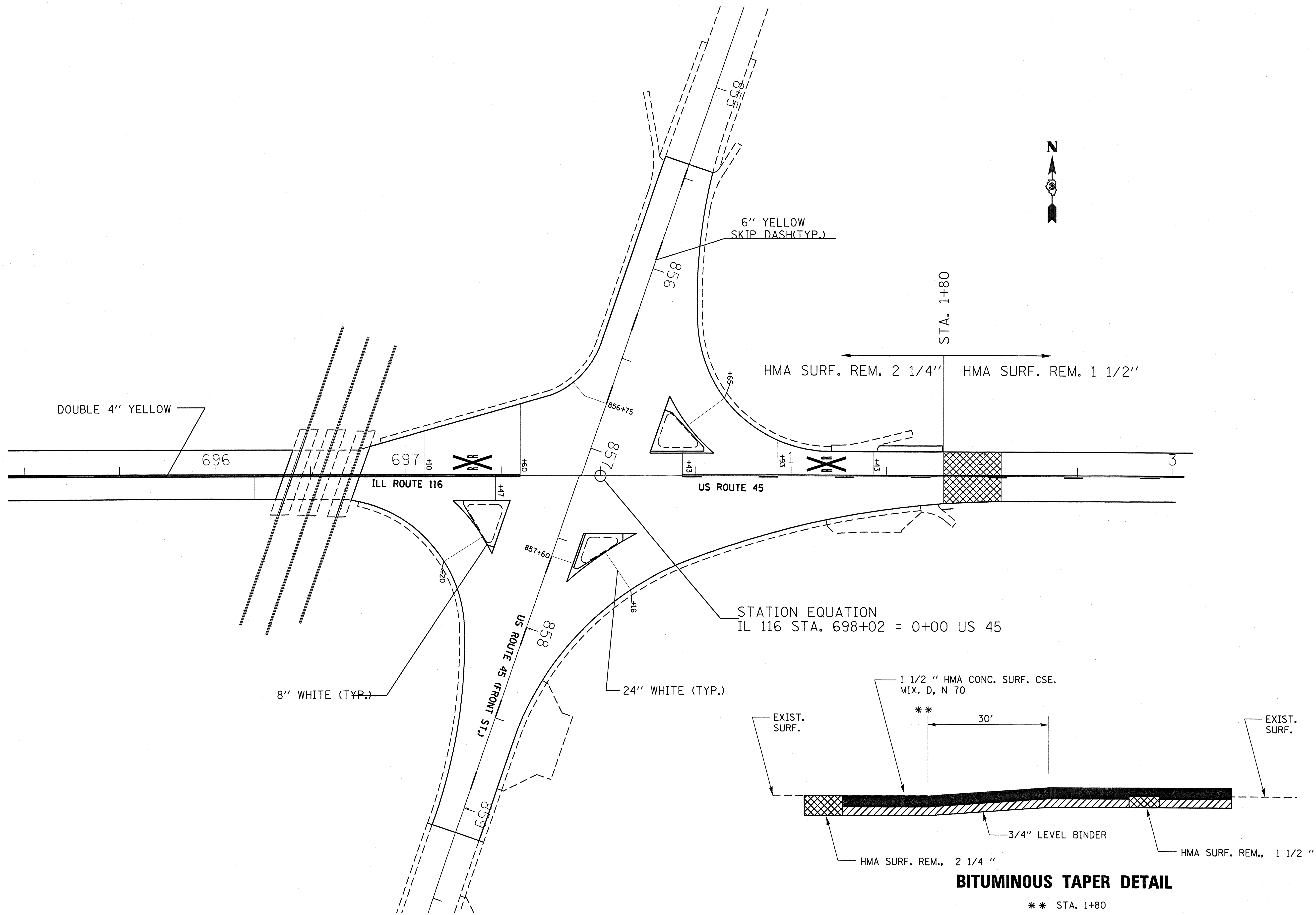

STATION EQUATION
 IL 116 STA. 698+02 = 0+00 US 45

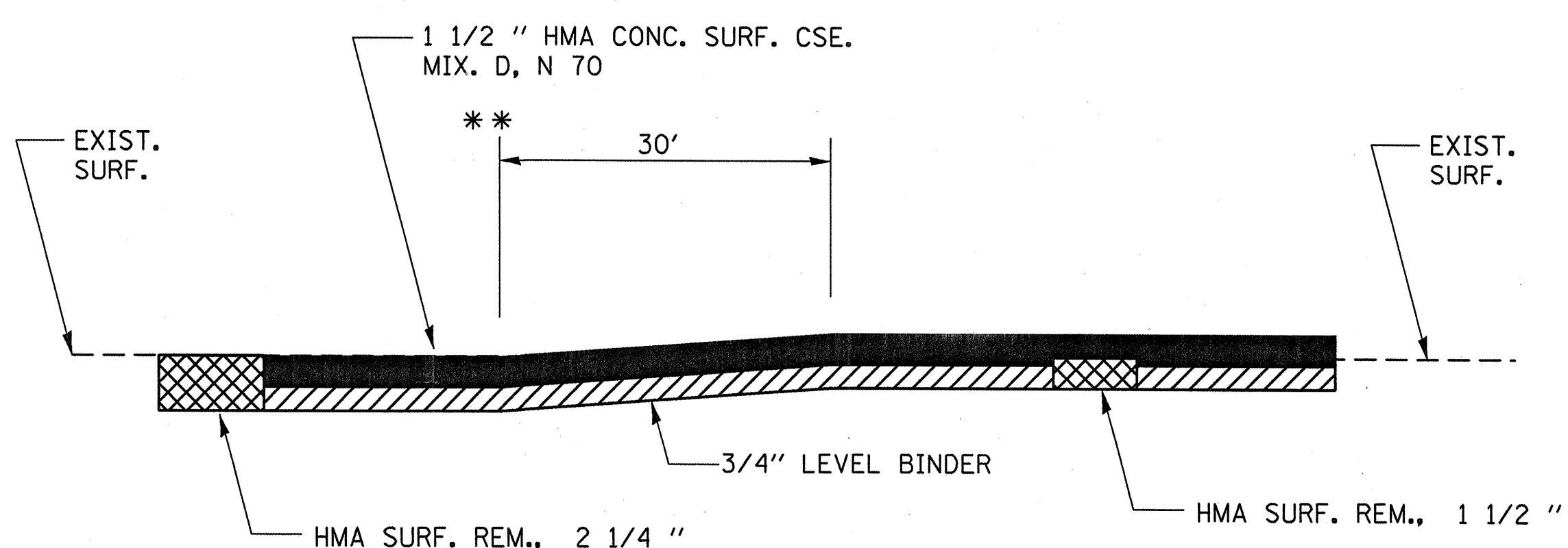

BITUMINOUS TAPER DETAIL

** STA. 1+80

FILE NAME =	USER NAME = sellnr	DESIGNED -	REVISD -	STATE OF ILLINOIS DEPARTMENT OF TRANSPORTATION	DETAILS			F.A.P. RTE:	SECTION	COUNTY	TOTAL SHEETS	SHEET NO.
ct:\pw_work\pwidot\sellnr\d0119889\d36693	-sht-details.dgn	DRAWN -	REVISD -		681	(117,118)RS-3	IROQUOIS	11	8			
PLOT SCALE = 50.1606' / IN.	CHECKED -	REVISD -	REVISD -		SCALE: _____ SHEET NO. ___ OF ___ SHEETS STA. _____ TO STA. _____			CONTRACT NO. 66931				
PLOT DATE = Jan 29, 2010 - 11:38:37 AM	DATE -	REVISD -	REVISD -		ILLINOIS FED. AID PROJECT							

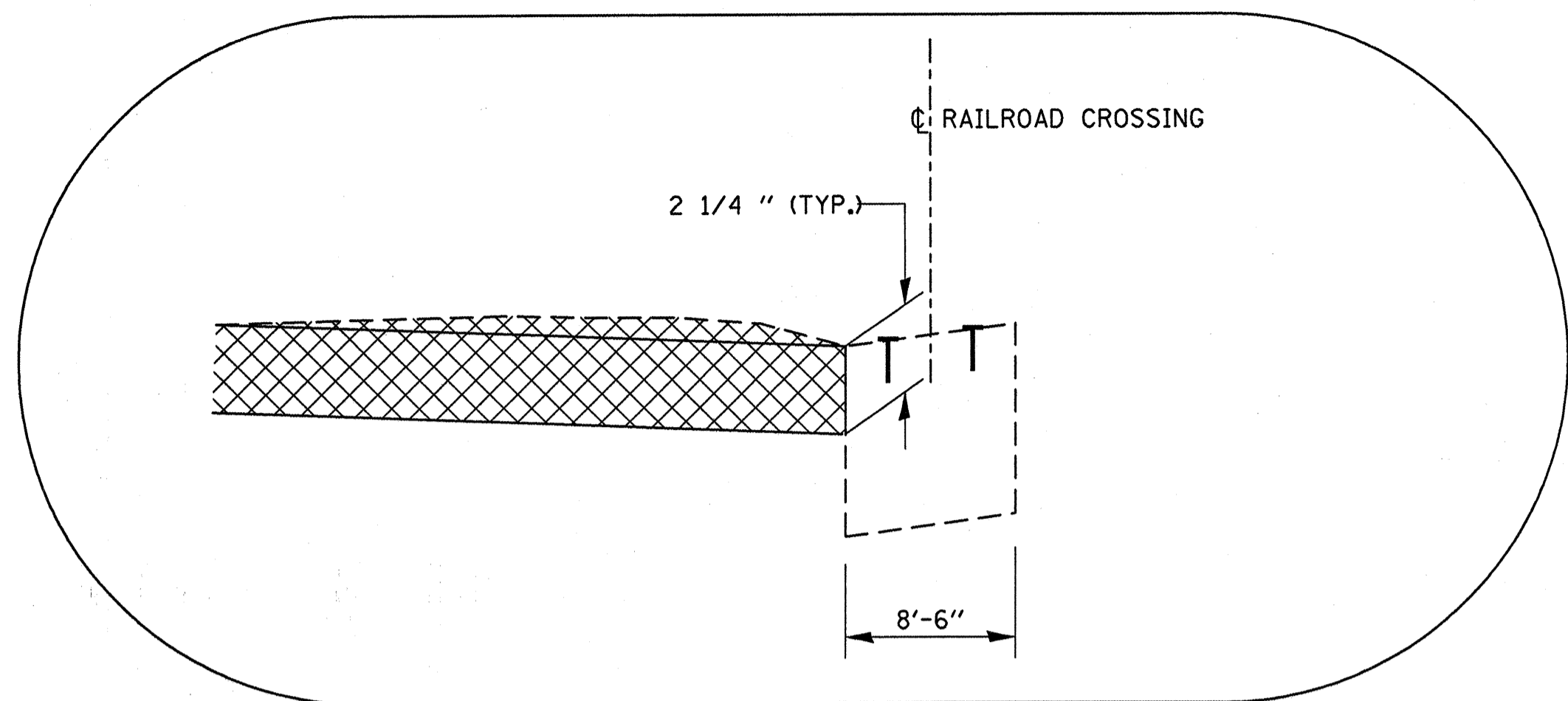

DETAIL A

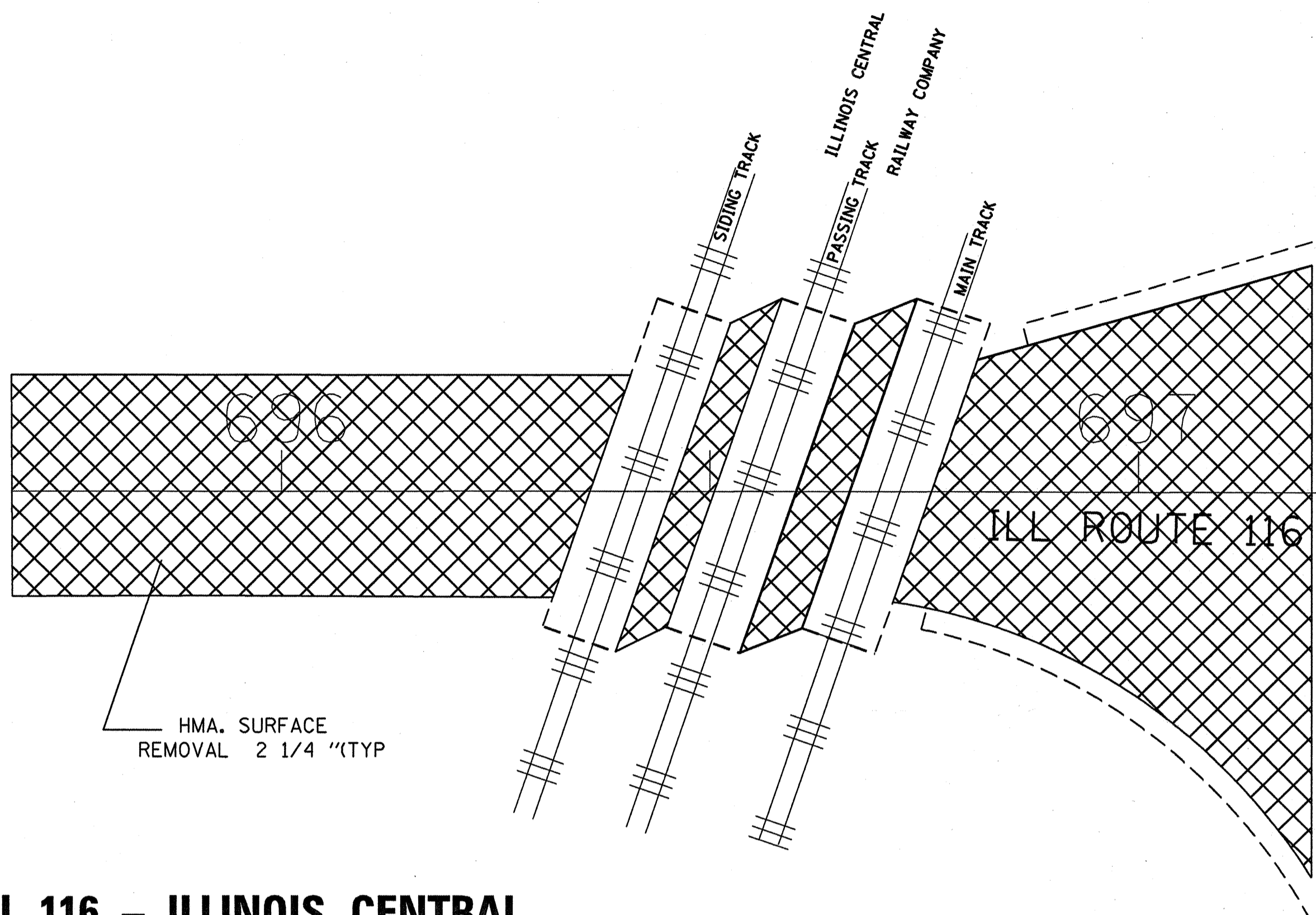

PLAN VIEW AT IL 116 - ILLINOIS CENTRAL RAILWAY COMPANY GRADE CROSSING

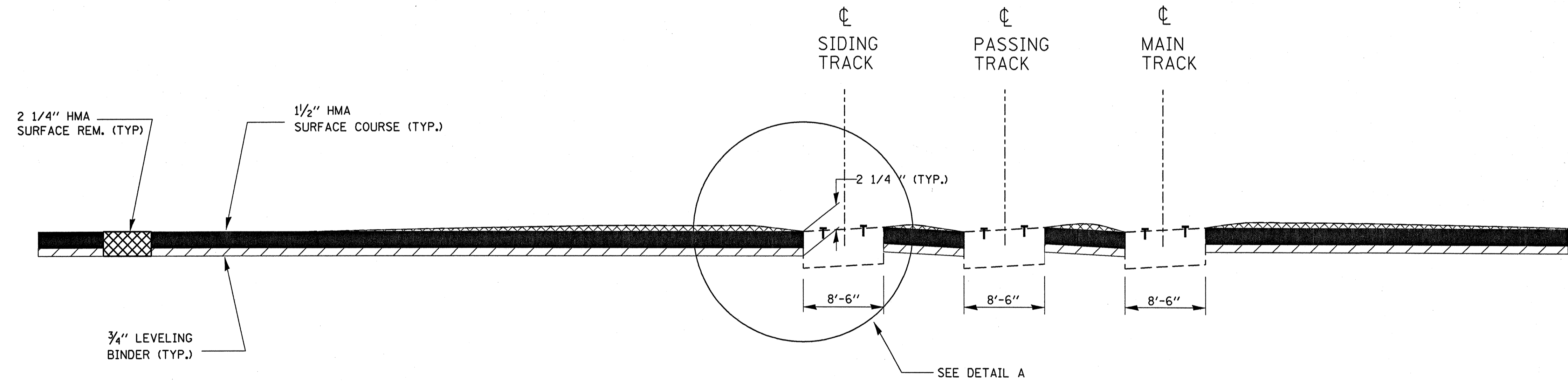

HMA SURFACE REMOVAL DETAIL AT THE IL 116 / ILLINOIS CENTRAL RAILWAY COMPANY GRADE CROSSING

FILE NAME =	USER NAME = sellnr	DESIGNED -	REVISD -	STATE OF ILLINOIS DEPARTMENT OF TRANSPORTATION	DETAILS			F.A.P. RTE.	SECTION	COUNTY	TOTAL SHEETS	SHEET NO.
ca\pw_work\p\pidot\sellnr\d0119889\d36693	-sht-details.dgn	DRAWN -	REVISD -		681	(117,118)RS-3	IROQUOIS	11	9			
	PLOT SCALE = 50.1606' / IN.	CHECKED -	REVISD -		SCALE: _____ SHEET NO. ___ OF ___ SHEETS			STA. _____ TO STA. _____		CONTRACT NO. 66931		
	PLOT DATE = Jan 29, 2010 - 11:38:52 AM	DATE -	REVISD -		ILLINOIS FED. AID PROJECT							

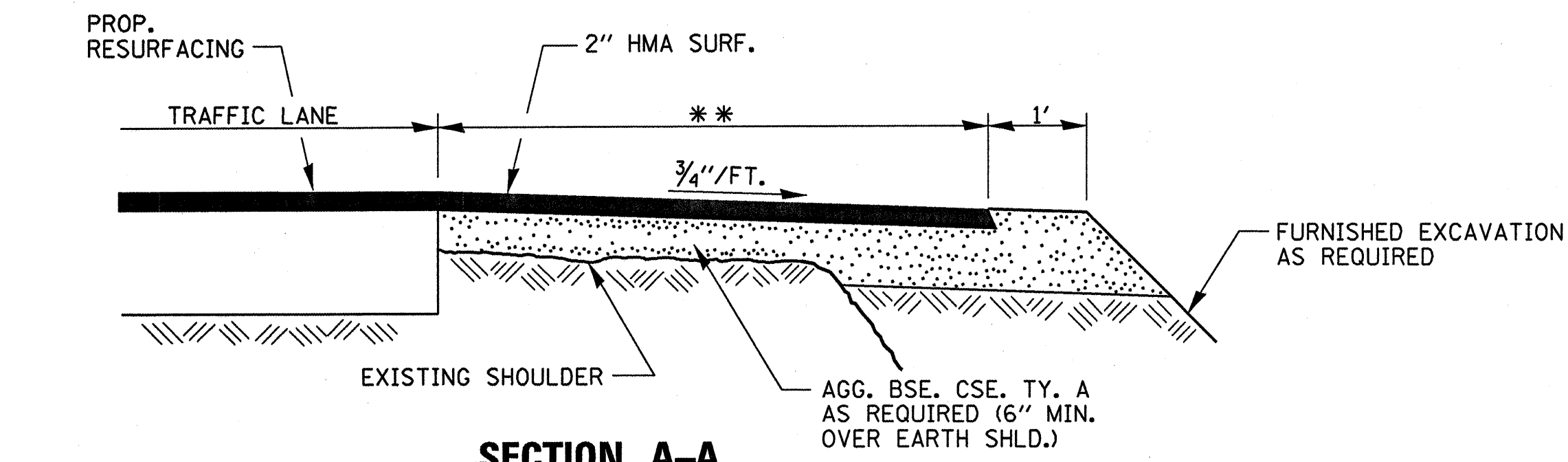
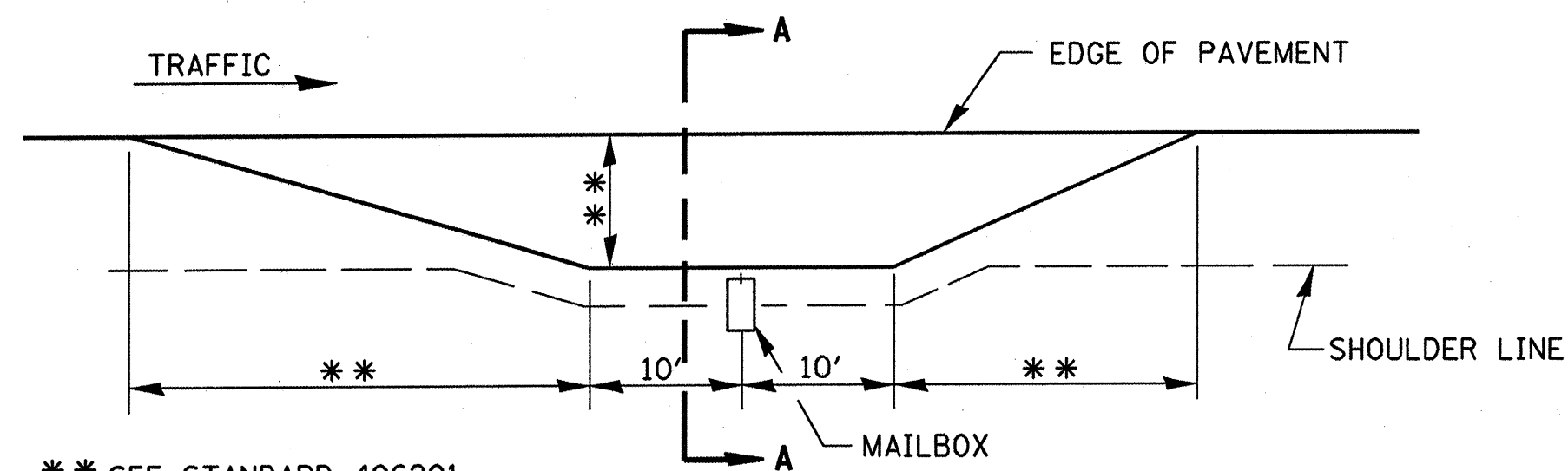

RURAL MAILBOX TURNOUT DETAILS

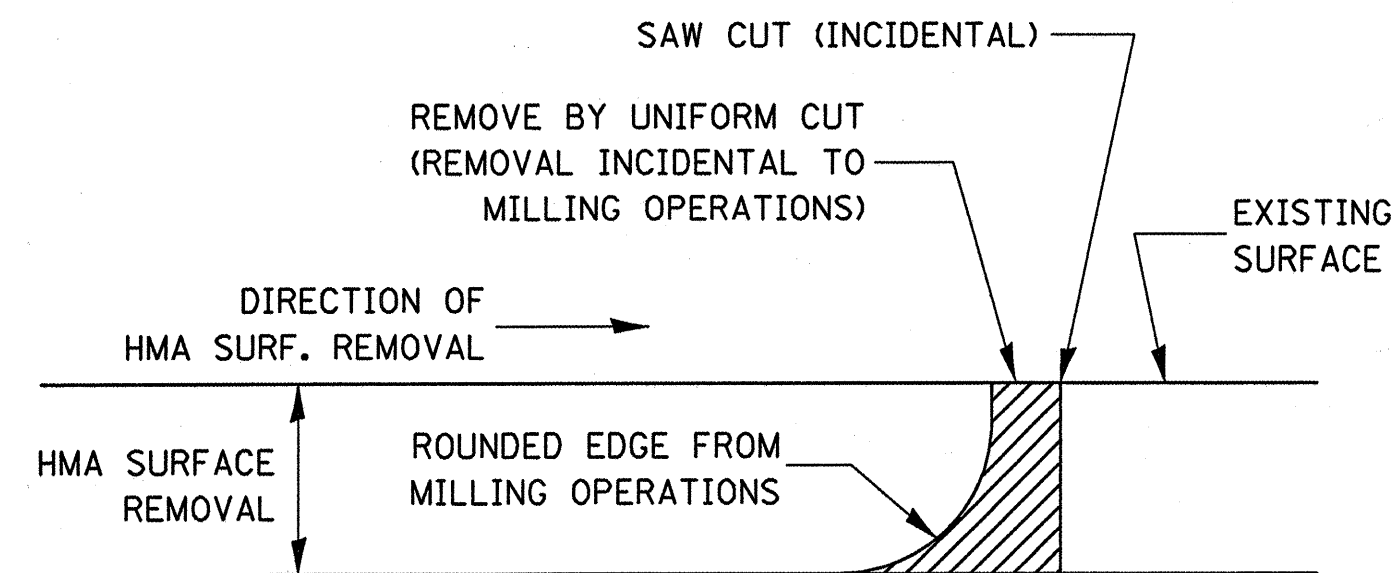

NOTE:
WHEN MILLING OPERATIONS PRODUCE A ROUNDED EDGE, THEN A SAW CUT SHALL BE USED TO MANUFACTURE A PERPENDICULAR EDGE AS SHOWN IN THE DETAIL. THE ENGINEER SHALL BE THE SOLE JUDGE CONCERNING THE USE OF THIS DETAIL

HMA DETAIL AT BUTT JOINTS

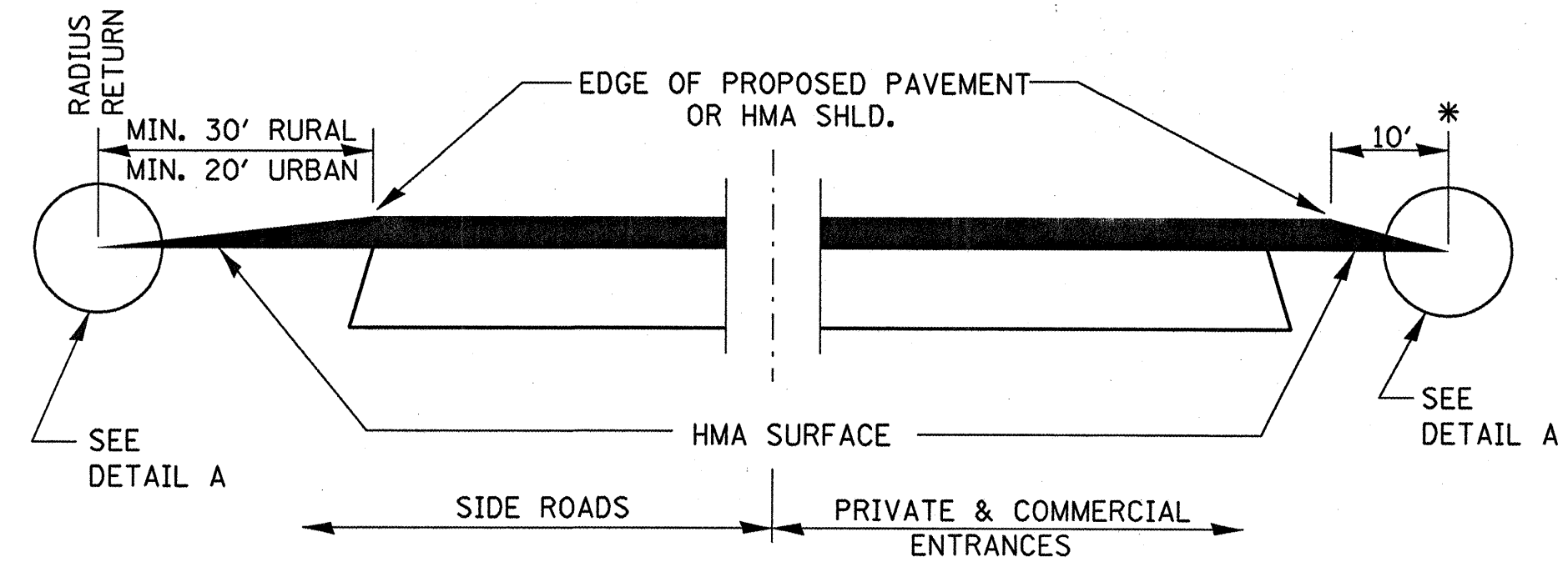

**SECTION A-A
DETAILS AT ENTRANCES & SIDE ROADS**

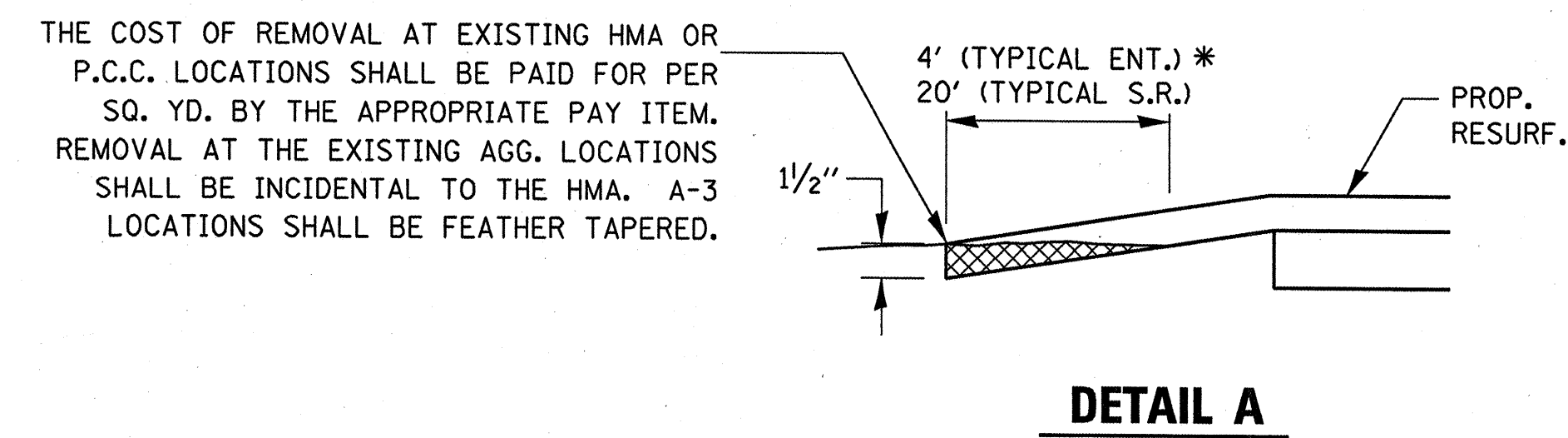
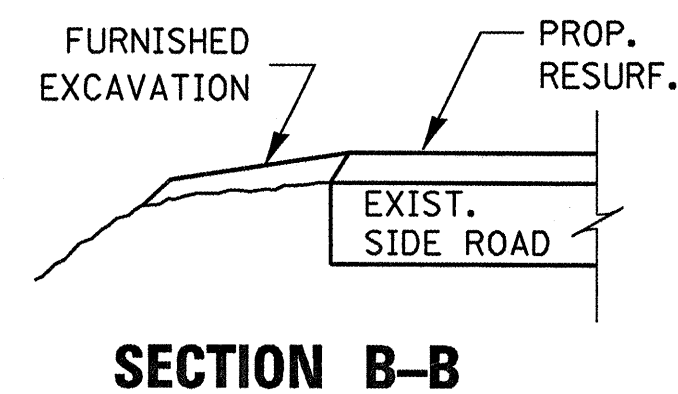

THE COST OF REMOVAL AT EXISTING HMA OR P.C.C. LOCATIONS SHALL BE PAID FOR PER SQ. YD. BY THE APPROPRIATE PAY ITEM. REMOVAL AT THE EXISTING AGG. LOCATIONS SHALL BE INCIDENTAL TO THE HMA. A-3 LOCATIONS SHALL BE FEATHER TAPERED.

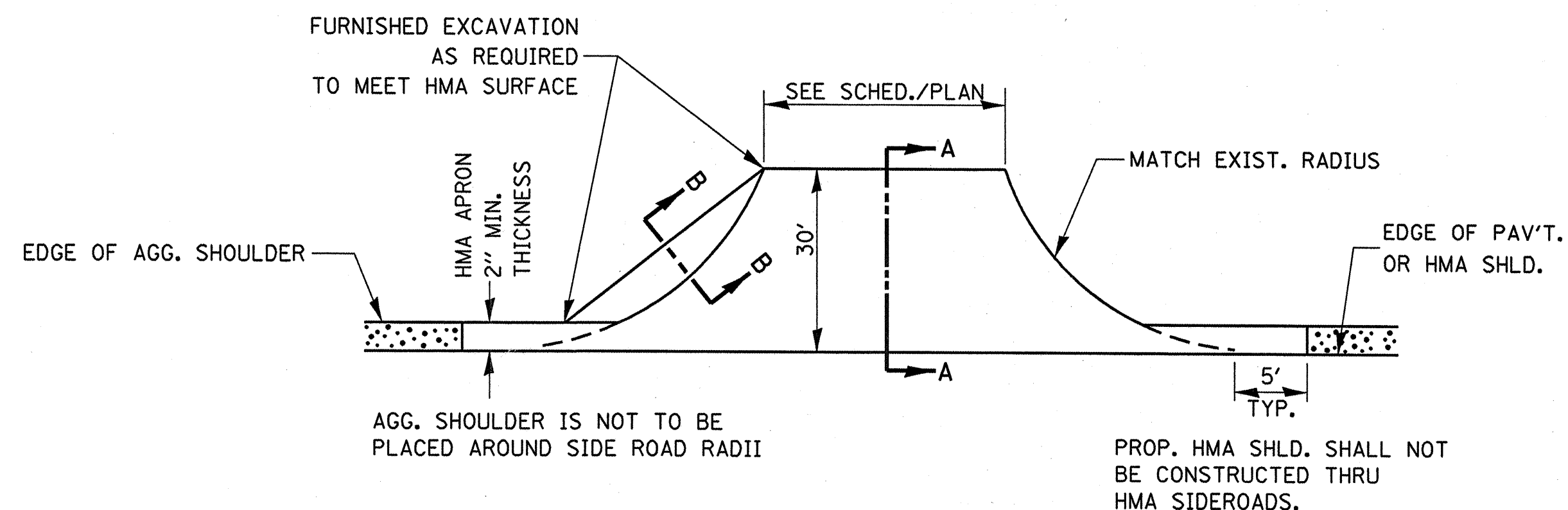

PLAN AT SIDE ROADS

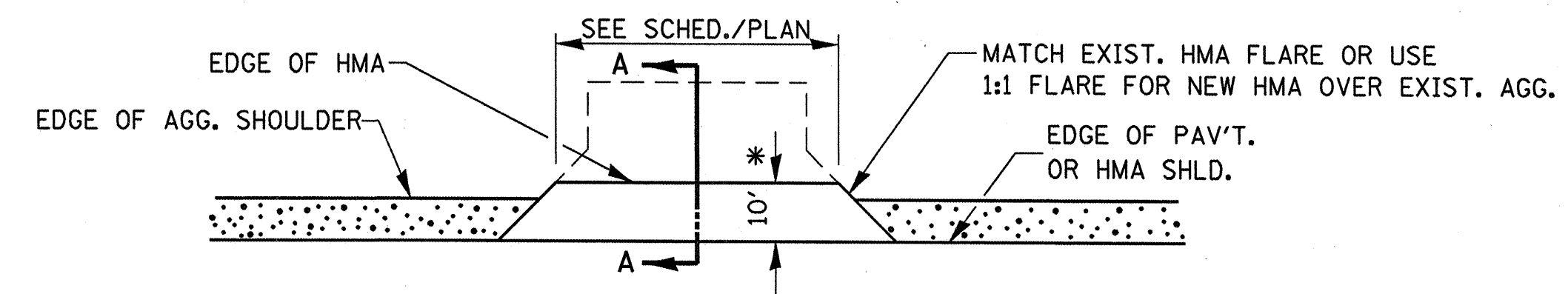

PLAN AT PRIVATE & COMMERCIAL ENTRANCES

(DO NOT RESURFACE FIELD ENTRANCES)

* PROPOSED HMA RESURFACING AT PUBLIC EDUCATIONAL FACILITY ENTRANCES SHALL BE EXTENDED TO THE RIGHT-OF-WAY LIMITS.

FILE NAME =	USER NAME = sellnr	DESIGNED -	REVISED -
ct\pwork\pwork\sellnr\d0119889\d36693	-sht-details.dgn	DRAWN -	REVISED -
	PLOT SCALE = 50.1605' / IN.	CHECKED -	REVISED -
	PLOT DATE = Jan 29, 2010 - 11:39:27 AM	DATE -	REVISED -

STATE OF ILLINOIS
DEPARTMENT OF TRANSPORTATION

DETAILS		F.A.P. RTE.	SECTION	COUNTY	TOTAL SHEETS	SHEET NO.
SCALE: _____	SHEET NO. ___ OF ___ SHEETS	681	(117.118)RS-3	IROQUOIS	11	10
STA. _____ TO STA. _____		CONTRACT NO. 66931				

[ILLINOIS] FED. AID PROJECT

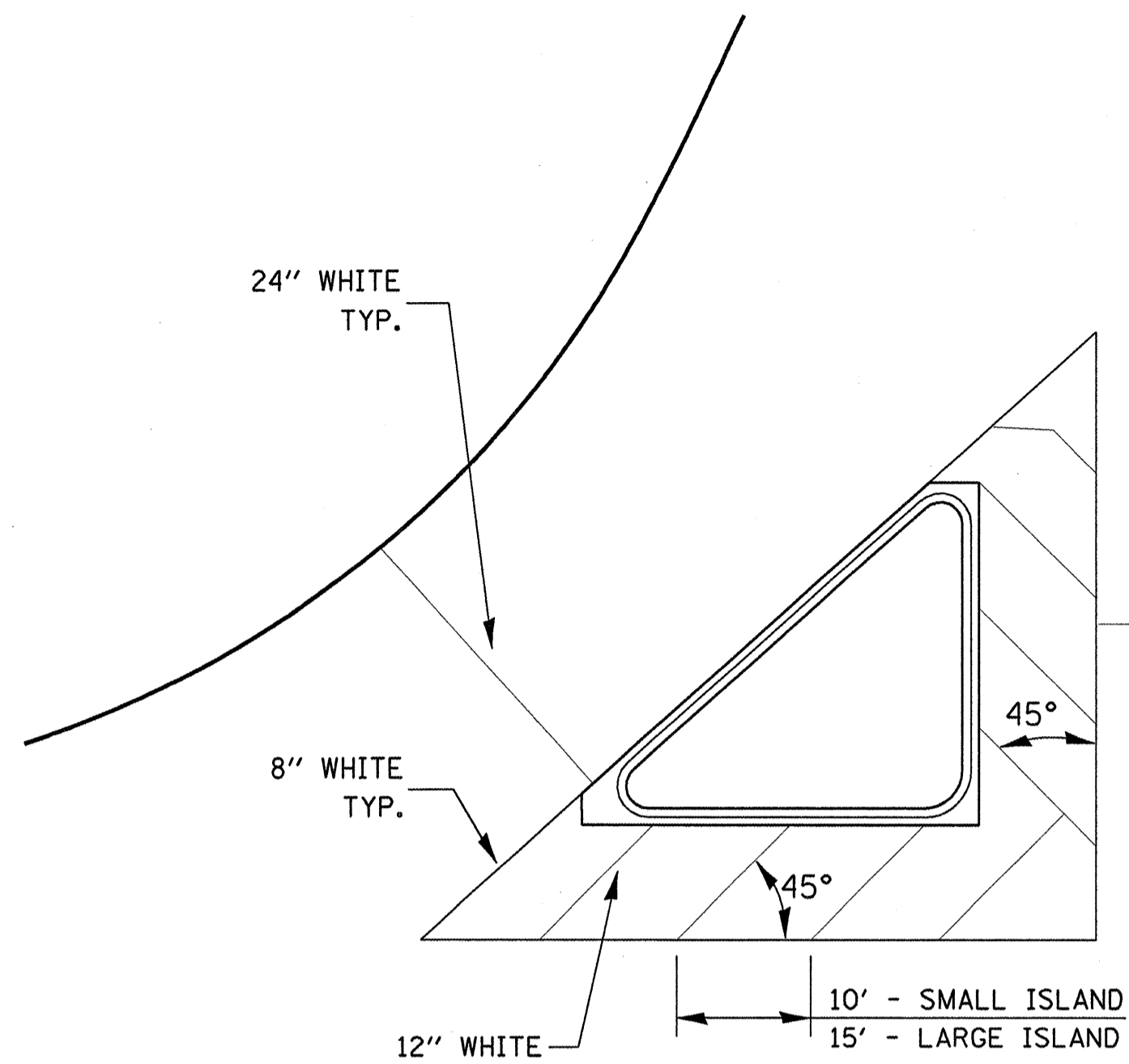

TYPICAL ISLAND

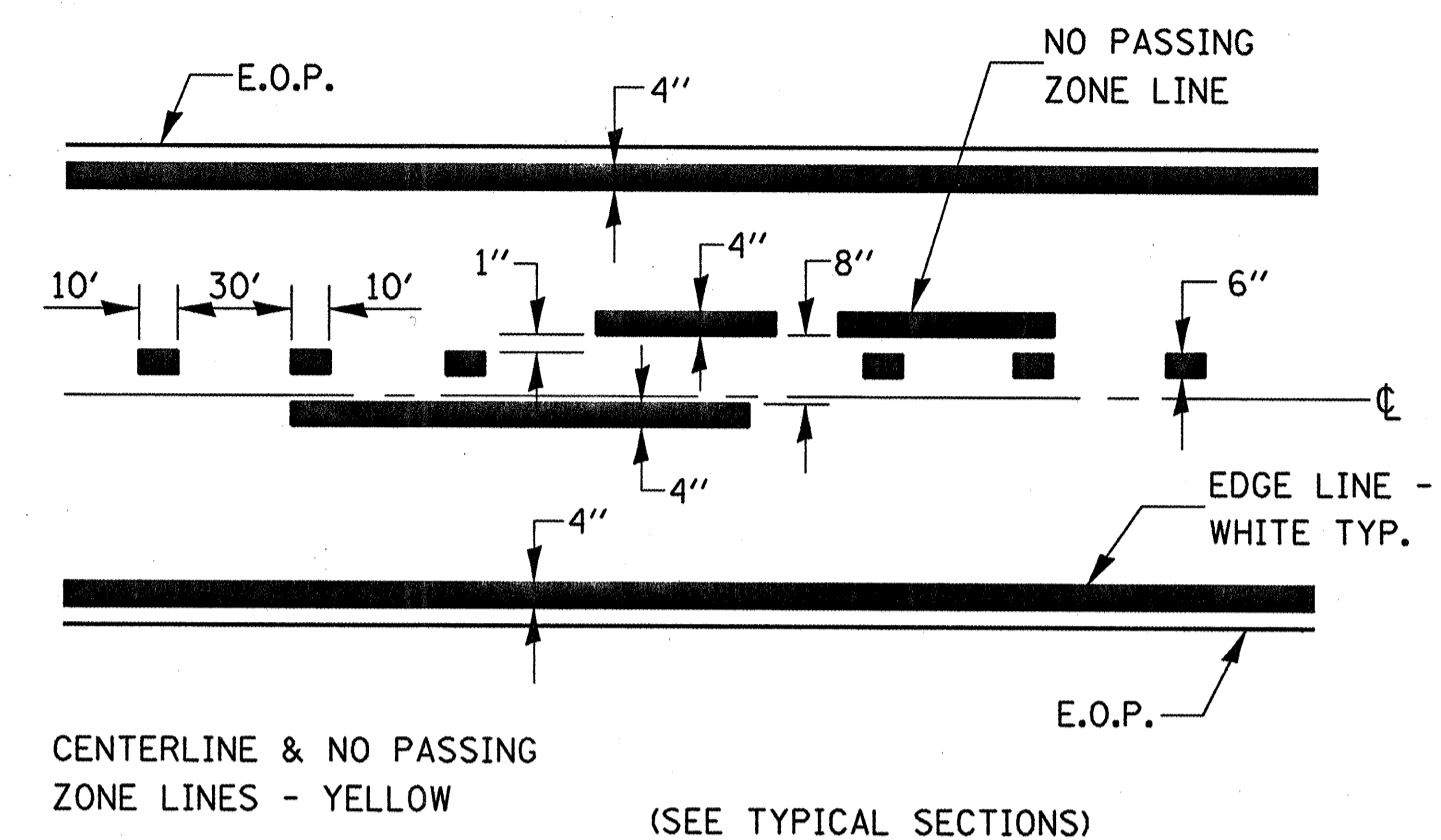

PAVEMENT MARKING

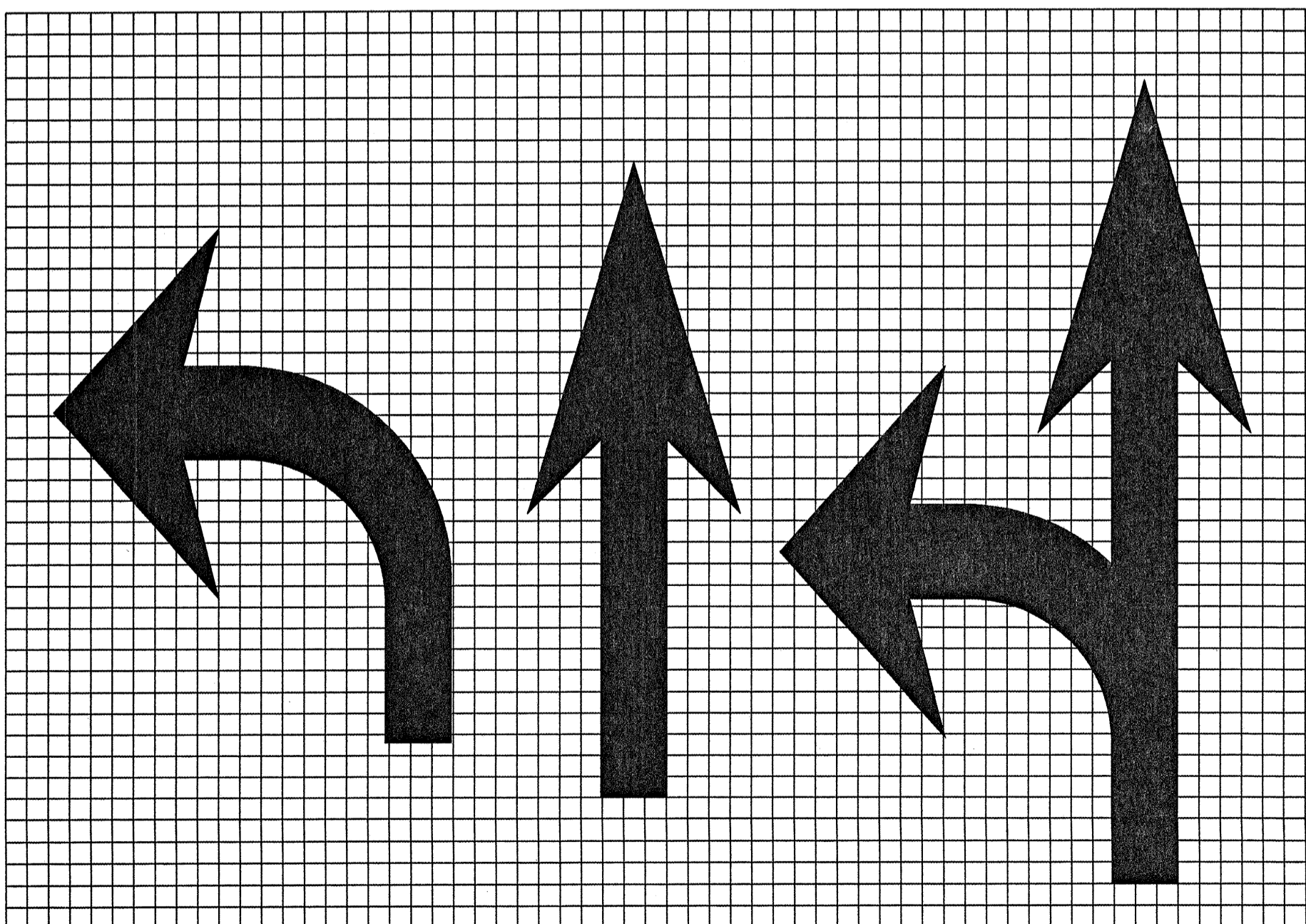

LEGEND HEIGHT	ARROW SIZE	a
6'	SMALL	2.9
8'	LARGE	3.8

THE SPACE BETWEEN ADJACENT LETTERS OR NUMERALS SHOULD BE APPROXIMATELY 3' FOR 6' LEGEND AND 4' FOR 8' LEGEND.

LETTER AND ARROW GRID SCALE

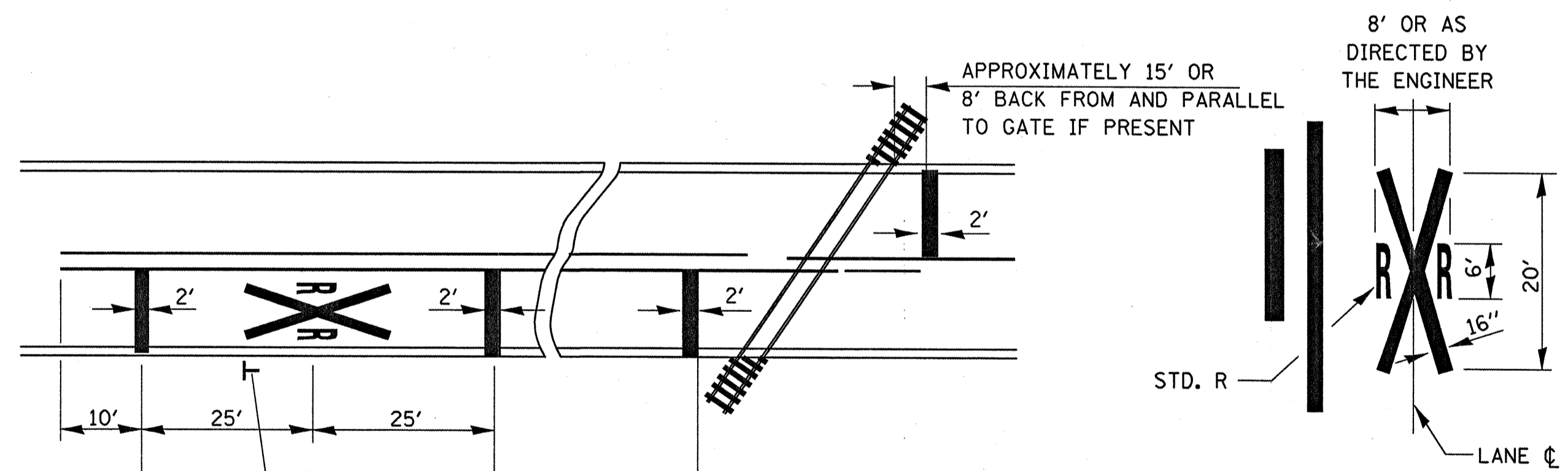

* MINIMUM DISTANCE
400' FOR 55 MPH
250' FOR 45 MPH
100' FOR 35 MPH OR LESS

PAVEMENT MARKINGS AT RAILROAD-HIGHWAY GRADE CROSSING

NOTES:
THE TRANSVERSE SPREAD OF THE "X" MAY VARY ACCORDING TO LANE WIDTH.

ON MULTI-LANE ROADS, THE STOP LINES SHALL EXTEND ACROSS ALL APPROACH LANES AND SEPARATE RXR SYMBOLS SHALL BE PLACED ADJACENT TO EACH OTHER IN EACH LANE.

WHEN THE PAVEMENT MARKING SYMBOL IS USED, A PORTION OF THE SYMBOL SHOULD BE LOCATED DIRECTLY ADJACENT TO THE ADVANCE WARNING SIGN (W10-1).