

EXIST. CURVE C5
 PI STA. = 274+13.80
 $\Delta = 36^{\circ} 06' 58''$ (LT)
 $D = 1^{\circ} 30' 00''$
 $R = 3,819.72'$
 $T = 1,245.38'$
 $L = 2,407.74'$
 $E = 197.90'$
 EX & PR S.E. = 5.2% (70 MPH DESIGN)
 $T.R. = 39.50'$
 $S.E. RUN = 234.00'$
 $P.C. STA. = 261+68.42$
 $P.T. STA. = 285+76.16$
 S.E. ATTAINED:
 STA 259+72.92 TO STA 262+46.42
 STA 285+01.16 TO STA 1+78.71

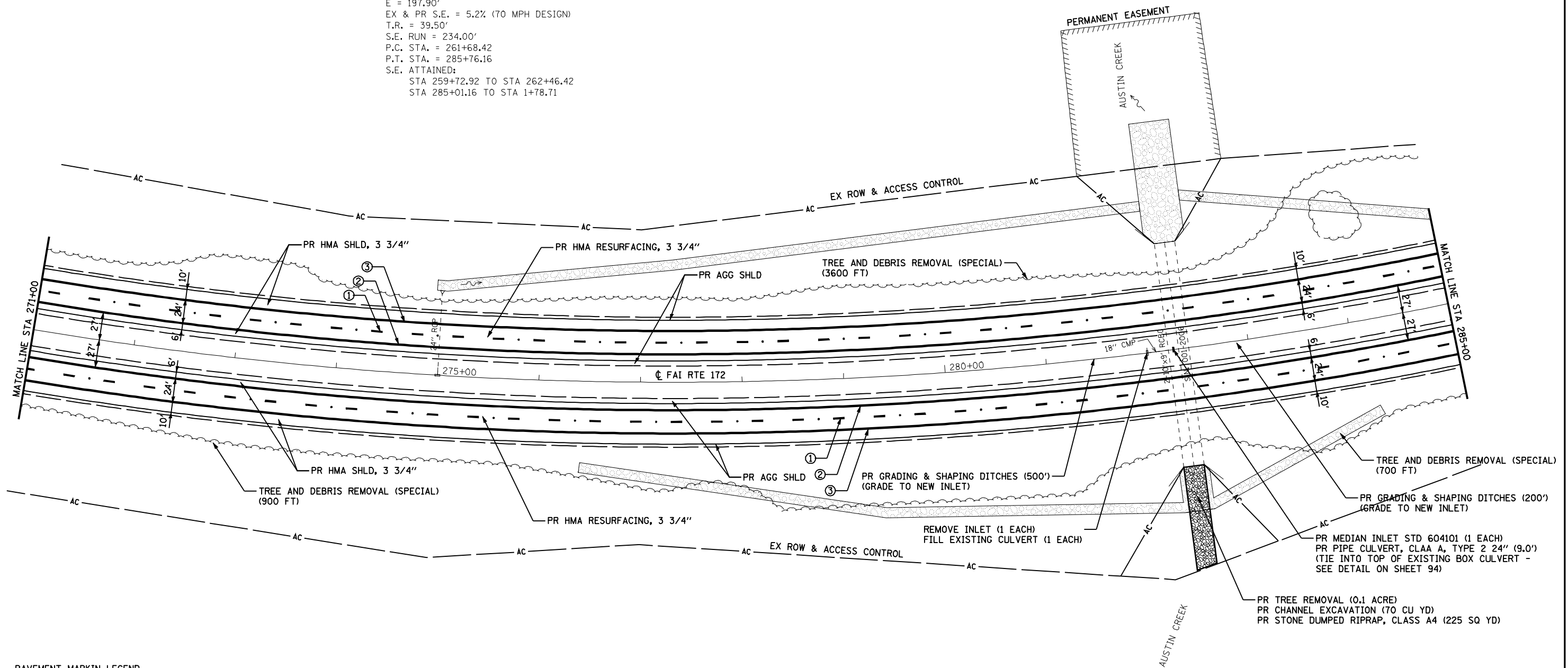

PAVEMENT MARKIN LEGEND

- ① PR PREFORMED PLASTIC PAVEMENT MARKING, TYPE B (INLAID), LINE 5" (30' SKIP, 10' DASH WHITE)
- ② PR URETHANE PAVEMENT MARKING, LINE 5" (SOLID YELLOW)
- ③ PR URETHANE PAVEMENT MARKING, LINE 5" (SOLID WHITE)
- ④ PR URETHANE PAVEMENT MARKING, LINE 6" (SOLID WHITE)
- ⑤ PR PREFORMED PLASTIC PAVEMENT MARKING, TYPE B (INLAID), LINE 6" (6' SKIP, 2' DASH WHITE)
- ⑥ PR PREFORMED PLASTIC PAVEMENT MARKING, TYPE B (INLAID), LINE 8" (SOLID WHITE)
- ⑦ PR PREFORMED PLASTIC PAVEMENT MARKING, TYPE B (INLAID), LINE 12" (SOLID WHITE)
- ⑧ PR PREFORMED PLASTIC PAVEMENT MARKING, TYPE B (INLAID), LINE 12" (SOLID YELLOW)
- ⑨ PR PREFORMED PLASTIC PAVEMENT MARKING, TYPE B (INLAID), LINE 24" (SOLID WHITE)
- ⑩ PR PREFORMED PLASTIC PAVEMENT MARKING, TYPE B (INLAID), LETTERS AND SYMBOLS (SOLID WHITE)
- ▷ PR RAISED REFLECTIVE PAVEMENT MARKERS, ONE-WAY CRYSTAL
- ▶ PR RAISED REFLECTIVE PAVEMENT MARKERS, ONE-WAY AMBER
- ◆ PR RAISED REFLECTIVE PAVEMENT MARKERS, TWO-WAY AMBER

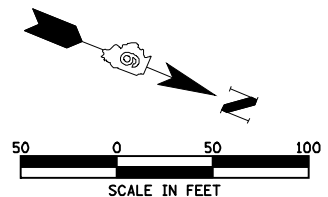

FILE NAME =	USER NAME = laughlinr1	DESIGNED -	REVISED -
es:\pwork\PIWIDOT\LAUGHLINRL\0182983\058_Plan.dgn		DRAWN -	REVISED -
PLOT SCALE = 100.0000' / IN.		CHECKED -	REVISED -
PLOT DATE = Feb-01-2010 09:35:54AM		DATE -	REVISED -

**STATE OF ILLINOIS
 DEPARTMENT OF TRANSPORTATION**

FAI RTE 172 PLAN

SCALE: 1"=50' SHEET NO. 20 OF 52 SHEETS STA. 271+00 TO STA. 285+00

F.A.I. RTE.	SECTION	COUNTY	TOTAL SHEETS	SHEET NO.
172	1-(1,2,3,4,5)RS	ADAMS	165	58
CONTRACT NO. 72A09				
FED. ROAD DIST. NO. ILLINOIS FED. AID PROJECT				