

Notes:  
 Hatched areas indicate concrete removal.  
 For Sections A-A & B-B, bar details & Bill of Material see sheet No. 9 of 17.

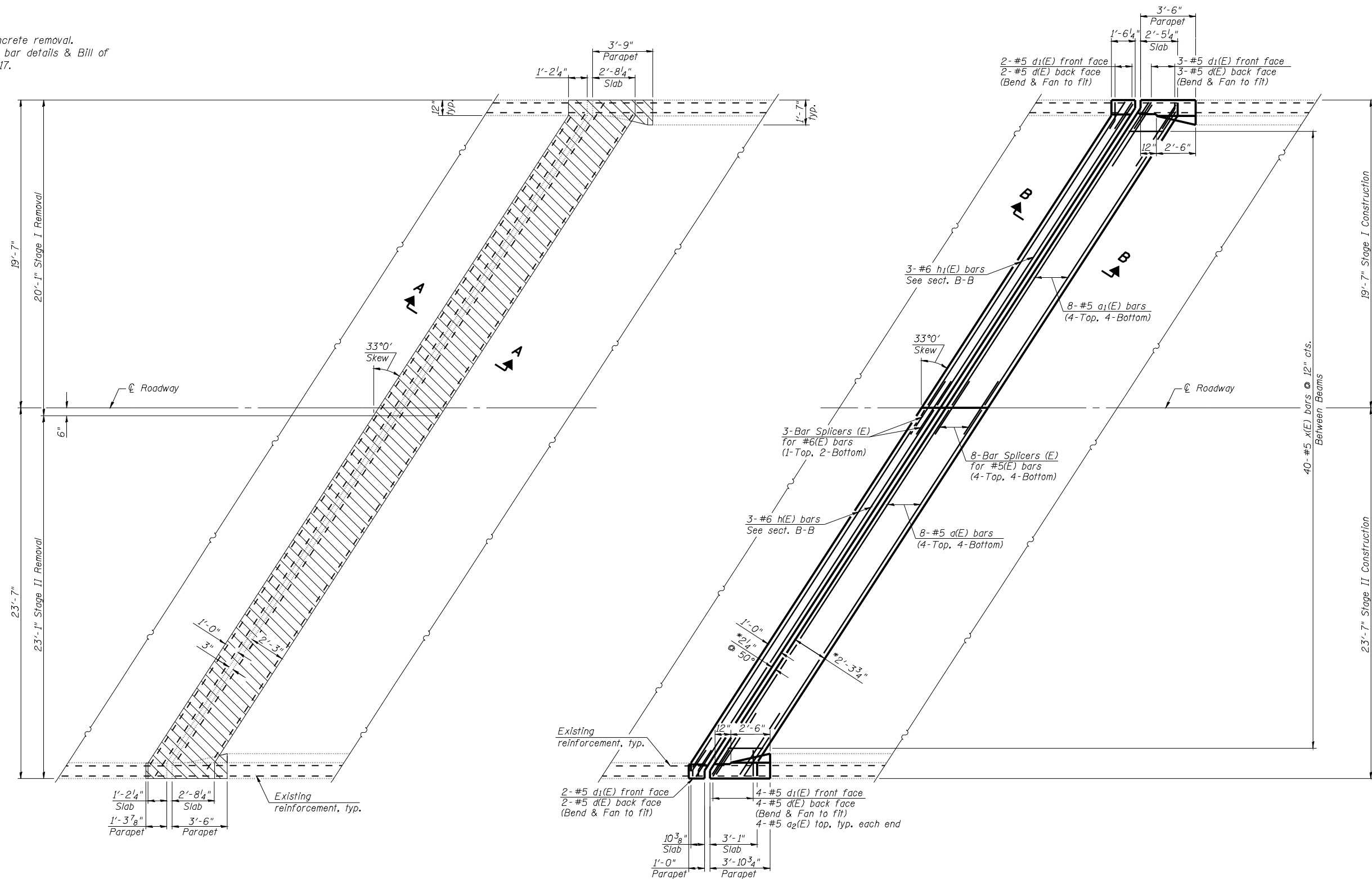

**PARTIAL REMOVAL PLAN**  
 (South Abutment SN 001-0055)

**PARTIAL PROPOSED PLAN**  
 (South Abutment SN 001-0055)

**SUPERSTRUCTURE DETAILS**  
**FAI 172 OVER BURTON CREEK**  
**SN 001-0055 & 0056**

DESIGNED	KTH
CHECKED	ADL
DRAWN	KTH
CHECKED	ADL

**KLINGNER & ASSOCIATES, P.C.**  
 Engineers - Architects - Surveyors  
 150 North 21st Street, Quincy, IL 62450  
 4300 Park Grand Road, Harrisburg, MO 63503  
 400 N. 4th Street, Suite 100, Burlington, IL 62506  
 111 W. 8th Street, Galesburg, IL 62541  
 Internet Address: www.klingner.com  
 Ph: 618/223-3519 Fax: 618/223-3883  
 Ph: 618/223-0020 Fax: 618/223-0802  
 Ph: 618/753-9536 Fax: 618/752-3805  
 Ph: 618/942-4842 Fax: 618/942-3701

STATE OF ILLINOIS DESIGN FIRM # 1842738

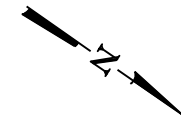

SHEET NO. 5	F.A. RTE.	SECTION	COUNTY	TOTAL SHEETS	SHEET NO.
	172	1-4B	ADAMS	165	123
16 SHEETS	CONTRACT NO. 72A09				
FED. ROAD DIST. NO.		ILLINOIS FED. AID PROJECT			