

Notes:
 Hatched areas indicate concrete removal.
 For Sections B-B & C-C, bar details & Bill of Material see sheet No. 9 of 17.
 Care shall be taken to not damage the name plates.

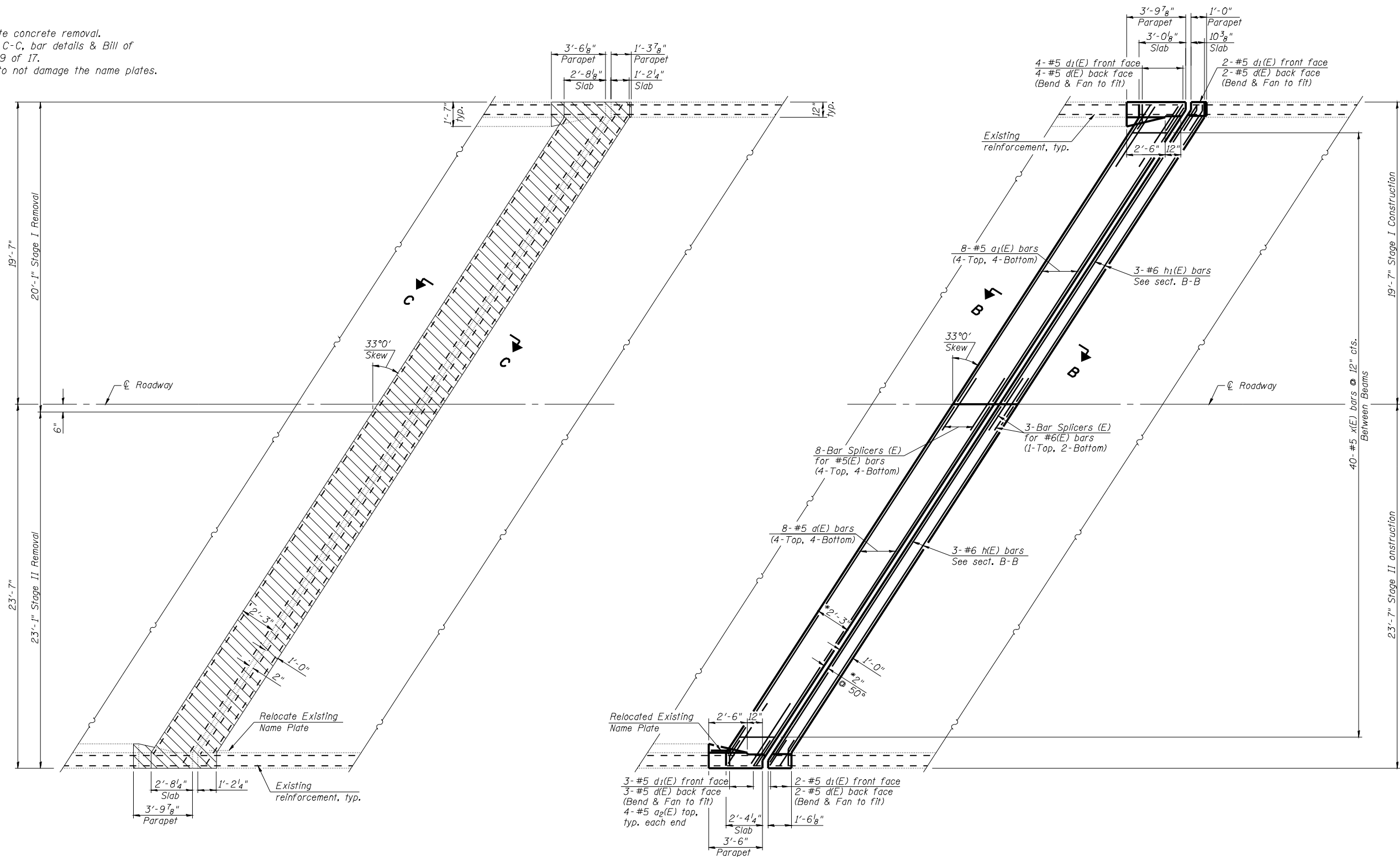

PARTIAL REMOVAL PLAN
 (North Abutment SN 001-0055)

PARTIAL PROPOSED PLAN
 (North Abutment SN 001-0055)

SUPERSTRUCTURE DETAILS
FAI 172 OVER BURTON CREEK
SN 001-0055 & 0056

DESIGNED	KTH
CHECKED	ADL
DRAWN	KTH
CHECKED	ADL

KLINGNER & ASSOCIATES, P.C.
 Engineers • Architects • Surveyors
 155 North 21st Street, Quincy, IL 62422
 408 Park Street, Suite 100, Burlington, IL 62018
 111 West 1st Street, Suite 100, Galena, IL 62421
 Phone: (618) 221-3838 • Fax: (618) 221-3882
 Phone: (618) 753-9536 • Fax: (618) 752-3885
 Phone: (618) 942-4842 • Fax: (618) 942-3788
 www.klingner.com
 STATE OF ILLINOIS DESIGN FIRM # 1842738

SHEET NO. 6 16 SHEETS	F.A. RTE.	SECTION	COUNTY	TOTAL SHEETS	SHEET NO.
	172	1-4B	ADAMS	165	124
FED. ROAD DIST. NO.			ILLINOIS FED. AID PROJECT		
CONTRACT NO. 72A09					