

Notes:  
 Hatched areas indicate concrete removal.  
 For Sections A-A & B-B, bar details & Bill of Material see sheet No. 9 of 17.  
 Care shall be taken to not damage the name plates.

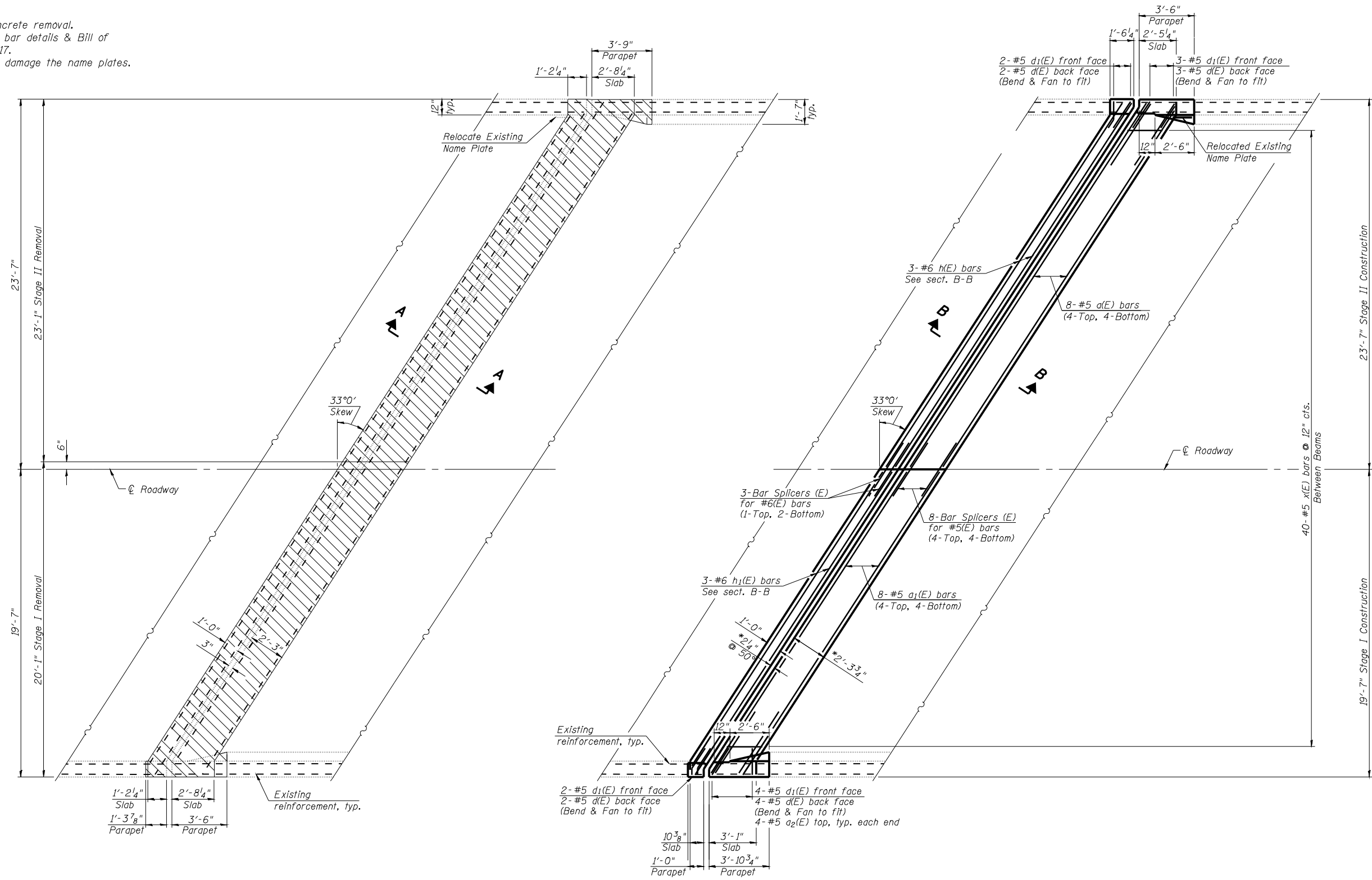

DESIGNED	KTH
CHECKED	ADL
DRAWN	KTH
CHECKED	ADL

**KLINGNER & ASSOCIATES, P.C.**  
 Engineers - Architects - Surveyors  
 1515 North 21st Street, Barrington, IL 60010  
 4800 Park Forest Road, Park Forest, IL 60466  
 400 N. 4th Street, Suite 100, Burlington, IL 60109  
 1110 W. Pearson Street, Galesburg, IL 61601  
 Internet Address: www.klingner.com  
 Ph: (815) 221-3010 Fax: (815) 221-3003  
 Ph: (815) 221-0020 Fax: (815) 221-0012  
 Ph: (815) 753-9536 Fax: (815) 752-3005  
 Ph: (815) 942-4042 Fax: (815) 942-3701

STATE OF ILLINOIS DESIGN FIRM # 1842738

**PARTIAL REMOVAL PLAN**  
 (South Abutment SN 001-0056)

**PARTIAL PROPOSED PLAN**  
 (South Abutment SN 001-0056)

**SUPERSTRUCTURE DETAILS**  
**FAI 172 OVER BURTON CREEK**  
**SN 001-0055 & 0056**

SHEET NO. 7 16 SHEETS	F.A. RTE.	SECTION	COUNTY	TOTAL SHEETS	SHEET NO.
	172	1-4B	ADAMS	165	125
FED. ROAD DIST. NO.			ILLINOIS FED. AID PROJECT		
CONTRACT NO. 72A09					