

STAGE I CONSTRUCTION
 (Looking North SN 001-0063)

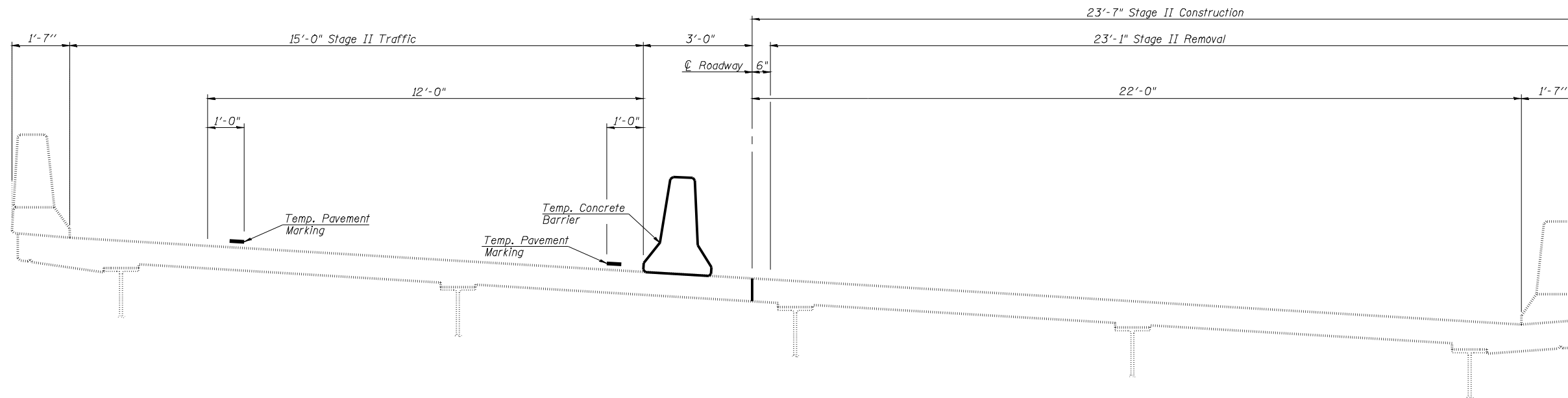

STAGE II CONSTRUCTION
 (Looking North SN 001-0063)

DESIGNED	KTH
CHECKED	ADL
DRAWN	KTH
CHECKED	ADL

KLINGNER & ASSOCIATES, P.C.
 Engineers - Architects - Surveyors
 45 North 21st Street, Barrington, IL
 4300 Park Forest Road, Forest Park, IL
 400 N. Ash Street, Suite 100, Burlington, IL
 411 W. 11th Street, Galena, IL
 Ph: (815) 221-3838 Fax: (815) 221-3883
 Ph: (815) 221-3838 Fax: (815) 221-3883
 Ph: (815) 221-3838 Fax: (815) 221-3883
 Ph: (815) 221-3838 Fax: (815) 221-3883
 STATE OF ILLINOIS DESIGN FIRM # 1842738

STAGING
FAI 172 OVER MILL CREEK
SN 001-0062 & 0063

SHEET NO. 4 17 SHEETS	F.A. RTE.	SECTION	COUNTY	TOTAL SHEETS	SHEET NO.
	172	1-4B-1	ADAMS	165	138
FED. ROAD DIST. NO.			ILLINOIS FED. AID PROJECT		
CONTRACT NO. 72A09					