

SEC 22, T7N, R6W, 3RD PM

EXIST. CURVE I55N-5  
 PI STA. = 755+56.46  
 $\Delta = 21^\circ 48' 40''$  (LT)  
 $D = 1^\circ 00' 00''$   
 $R = 5,729.58'$   
 $T = 1,103.92'$   
 $L = 2,181.11'$   
 $E = 105.38'$   
 $e = 2.8\%$   
 $T.R. = 46'$   
 $S.E. RUN = 126'$   
 $P.C. STA. = 744+52.54$   
 $P.T. STA. = 766+33.65$

SN 059-0043  
 STA 755+89.61 (FAI 55)  
 STA 50+00.00 (N&W RR)

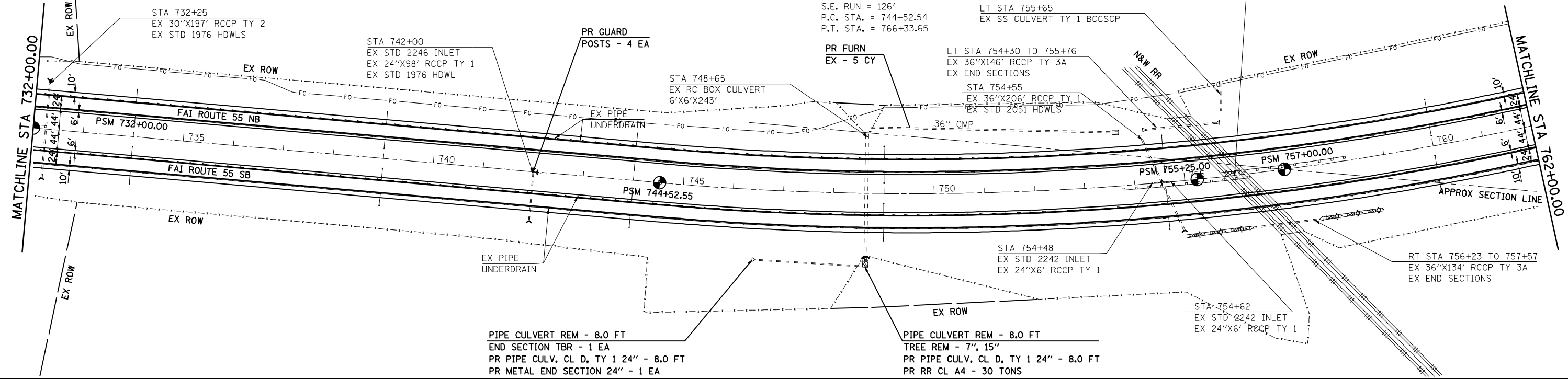

SEC 22, T7N, R6W, 3RD PM

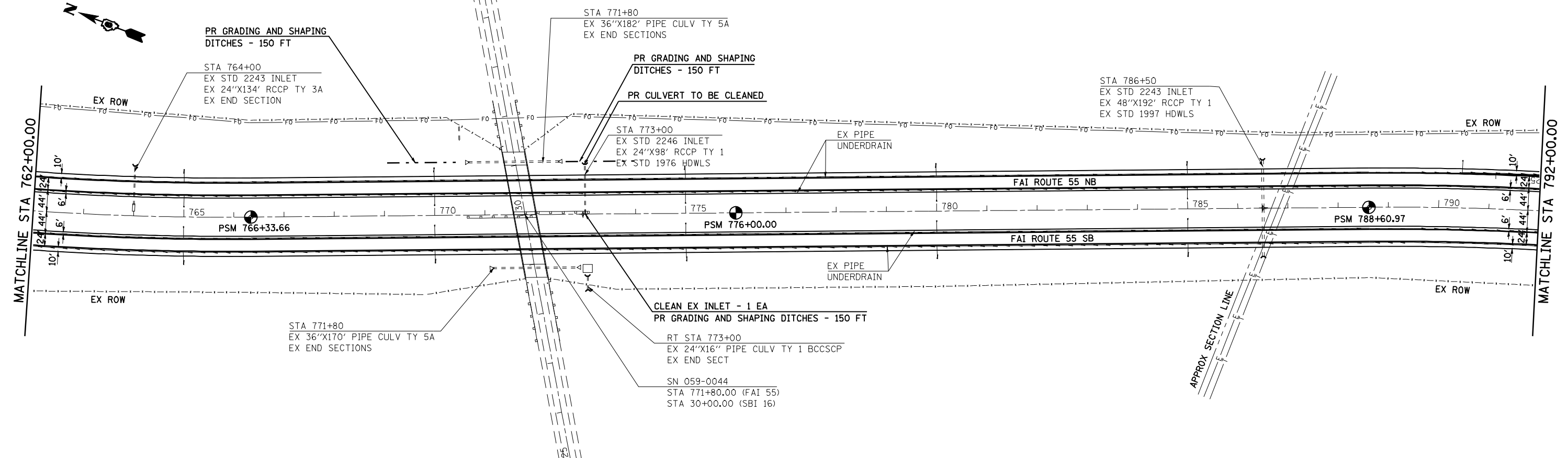

FILE NAME =	USER NAME = laughlinr1	DESIGNED -	REVISED -	<b>STATE OF ILLINOIS DEPARTMENT OF TRANSPORTATION</b>	<b>PLAN SHEETS</b>			F.A.I. RTE.	SECTION	COUNTY	TOTAL SHEETS	SHEET NO.
es:\pwwork\pwwid00\LAUGHLINRL\dms25312\0672460-shr-plan100.dgn		DRAWN -	REVISED -		55	59RS-2, BR	MACOUPIN	100	28			
PLOT SCALE = 200.0000' / IN.		CHECKED -	REVISED -		CONTRACT NO. 72A60							
PLOT DATE = Mar-26-2010 11:08:53AM		DATE -	REVISED -		ILLINOIS FED. AID PROJECT							

SCALE: 1" = 100' SHEET NO. OF SHEETS STA. 732+00.00 TO STA. 792+00.00