

F.A.S. RTE.	SECTION	COUNTY	TOTAL SHEETS	SHEET NO.
2701	(103,104)RS-4	ILLINOIS	9	1
CONTRACT NO. 74134				

• Effingham, Fayette, & Clay

D-97-007-06

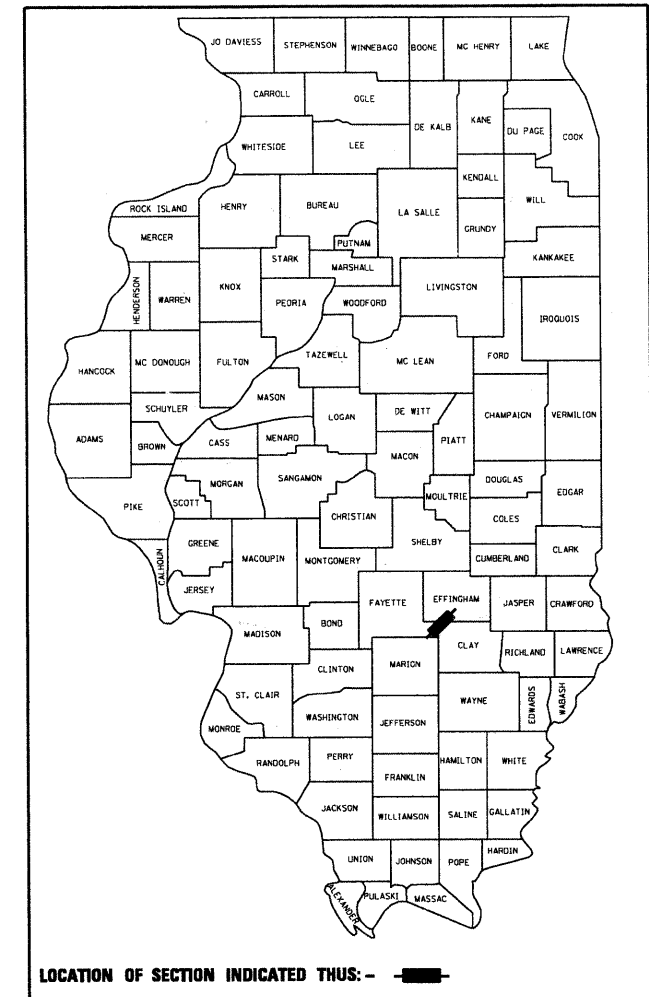

LOCATION OF SECTION INDICATED THUS: — ■ —

STATE OF ILLINOIS  
DEPARTMENT OF TRANSPORTATION  
DIVISION OF HIGHWAYS

**PROPOSED  
HIGHWAY PLANS**

FAS ROUTE 2701 (IL 37)  
SECTION (103,104)RS-4

HMA RESURFACING  
FAYETTE, EFFINGHAM & CLAY COUNTIES

C-97-009-06

FOR INDEX OF SHEETS, SEE SHEET NO. 2

BRIDGE OMISSION  
579+79 TO 581+51

2008 ADT = 1400

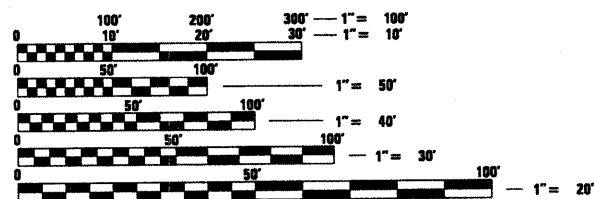

FULL SIZE PLANS HAVE BEEN PREPARED USING STANDARD ENGINEERING SCALES. REDUCED SIZED PLANS WILL NOT CONFORM TO STANDARD SCALES. IN MAKING MEASUREMENTS ON REDUCED PLANS, THE ABOVE SCALES MAY BE USED.

J.U.L.I.E.  
JOINT UTILITY LOCATION INFORMATION FOR EXCAVATION  
1-800-892-0123  
OR 811

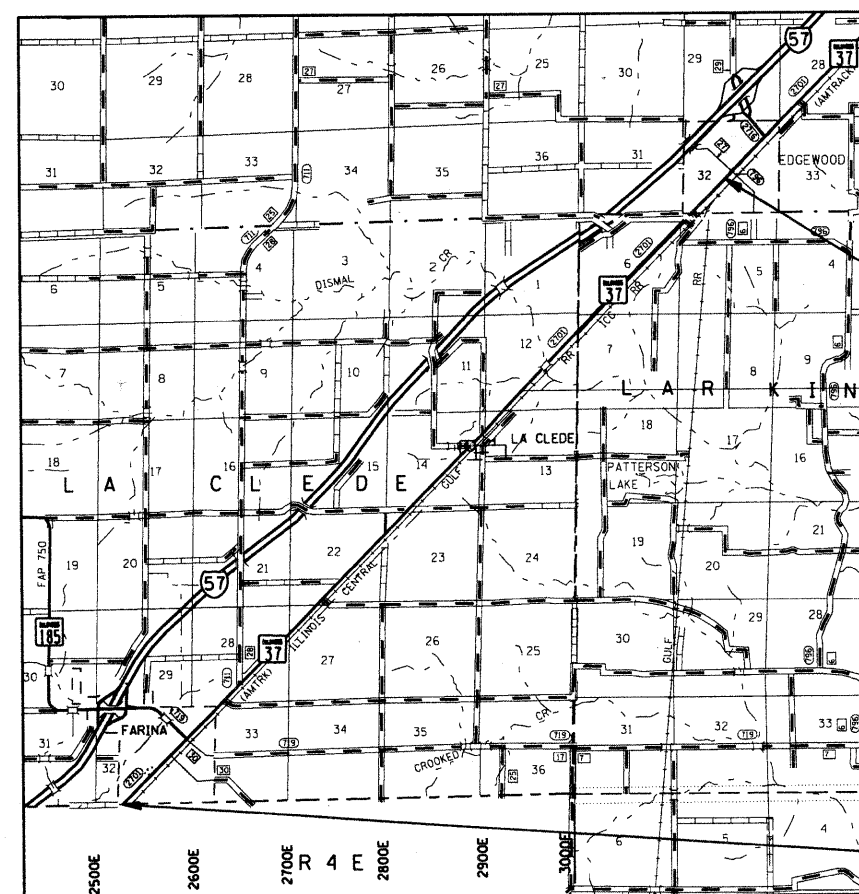

PROJECT ENDS  
STA 725+80

PROJECT BEGINS  
STA 241+50

GROSS LENGTH = 48,430 FT. = 9.172 MILE  
NET LENGTH = 48,258 FT. = 9.140 MILE

PROJECT ENGINEER: MARK DAUGHERTY  
PROJECT MANAGER: SOLOMON DZAKUMA

CONTRACT NO. 74134

STATE OF ILLINOIS  
DEPARTMENT OF TRANSPORTATION  
DIVISION OF HIGHWAYS

SUBMITTED January 26, 2010

Scott L. Dinkels  
DEPUTY DIRECTOR OF HIGHWAYS, REGION ENGINEER

March 19, 2010  
Scott E. Stitt, P.E.  
ENGINEER OF DESIGN AND ENVIRONMENT

March 19, 2010  
Christine M. Reed  
DIRECTOR OF HIGHWAYS, CHIEF ENGINEER

PRINTED BY THE AUTHORITY  
OF THE STATE OF ILLINOIS