

**STATE OF ILLINOIS
DEPARTMENT OF TRANSPORTATION
DIVISION OF HIGHWAYS**

**PROPOSED
HIGHWAY PLANS**

**FAS ROUTE 1669 (OLD ROUTE 316, LERNA ROAD)
SECTION (7,6) & (5,4)RS-2
PROJECT: --
BITUMINOUS RESURFACING
COLES COUNTY**

C-97-067-09

FOR INDEX OF SHEETS, SEE SHEET NO. 2

PAVING OMISSIONS:

- STA 294+28 TO STA 295+19: SN 015-0070
- STA 349+78 TO STA 350+18: SN 015-0068
- STA 410+92 TO STA 411+58: SN 015-0069
- STA 550+04 TO STA 550+84: RR UNDERPASS

STATION EQUATIONS:

- STA 32+00 BK = STA 148+48 AH
- STA 564+48 BK = STA 20+69.5 AH

ADT (2009) = 3,750

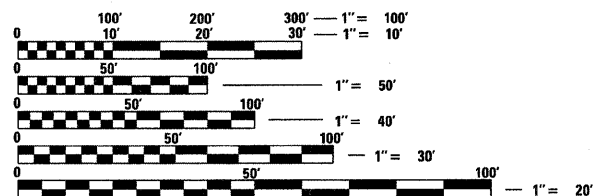

FULL SIZE PLANS HAVE BEEN PREPARED USING STANDARD ENGINEERING SCALES. REDUCED SIZED PLANS WILL NOT CONFORM TO STANDARD SCALES. IN MAKING MEASUREMENTS ON REDUCED PLANS, THE ABOVE SCALES MAY BE USED.

J.U.L.I.E.
JOINT UTILITY LOCATION INFORMATION FOR EXCAVATION
1-800-892-0123
OR 811

PROJECT ENGINEER: MARK DAUGHERTY
PROJECT MANAGER: BRIAN J. BIERMAN

CONTRACT NO. 74382

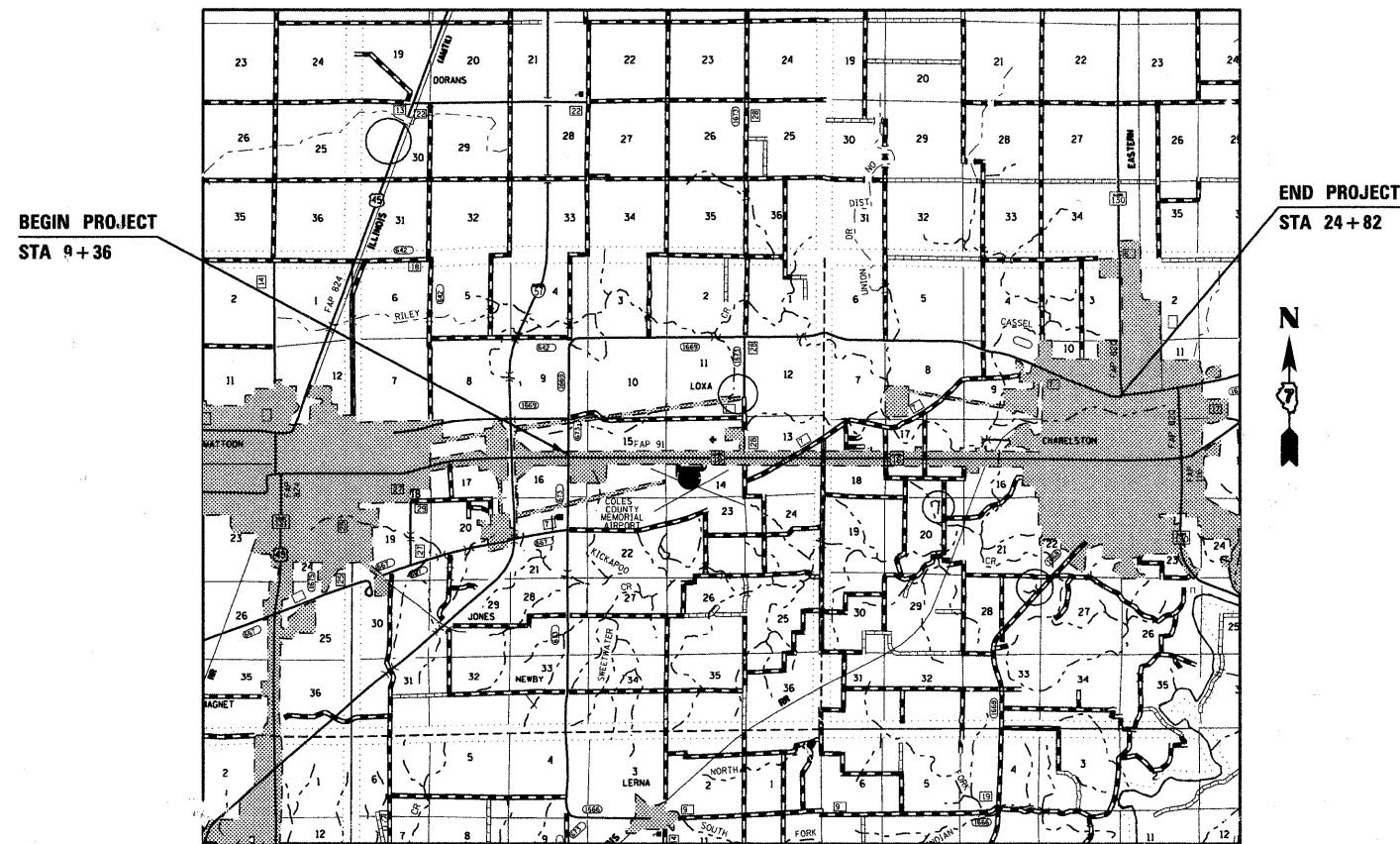

GROSS LENGTH = 44,277 FT. = 8.39 MILE
NET LENGTH = 44,000 FT. = 8.33 MILE

F.A.S. RTE.	SECTION	COUNTY	TOTAL SHEETS	SHEET NO.
1669	(7,6) & (5,4)RS-2	COLES	14	1
		ILLINOIS	CONTRACT NO. 74382	

D-97-038-09

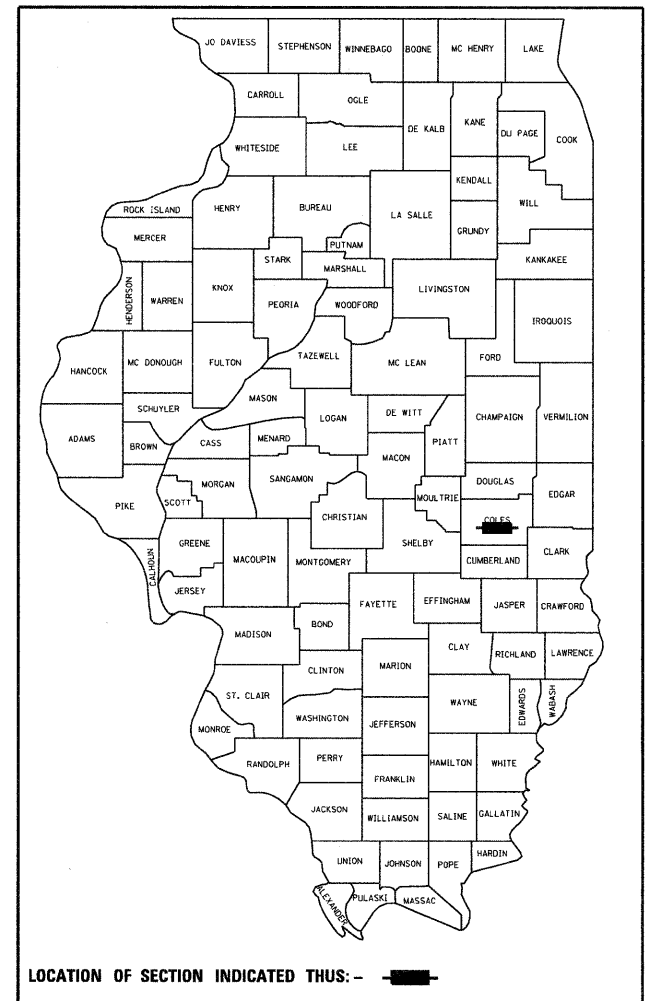

STATE OF ILLINOIS
DEPARTMENT OF TRANSPORTATION
DIVISION OF HIGHWAYS

SUBMITTED March 19 2010
Rogan J. Driskell
DEPUTY DIRECTOR OF HIGHWAYS, REGION ENGINEER

April 9 2010
Scott E. Still, P.E./e
acting ENGINEER OF DESIGN AND ENVIRONMENT

April 9 2010
Christine M. Reed/e
DIRECTOR OF HIGHWAYS, CHIEF ENGINEER

**PRINTED BY THE AUTHORITY
OF THE STATE OF ILLINOIS**