

**STATE OF ILLINOIS**  
**DEPARTMENT OF TRANSPORTATION**  
**DIVISION OF HIGHWAYS**

**PROPOSED**  
**HIGHWAY PLANS**

**FAS ROUTE 1669 (OLD ROUTE 316, LERNA ROAD)**  
**SECTION (7,6) & (5,4)RS-2**  
**PROJECT: --**  
**BITUMINOUS RESURFACING**  
**COLES COUNTY**

C-97-067-09

FOR INDEX OF SHEETS, SEE SHEET NO. 2

**PAVING OMISSIONS:**

- STA 294+28 TO STA 295+19: SN 015-0070
- STA 349+78 TO STA 350+18: SN 015-0068
- STA 410+92 TO STA 411+58: SN 015-0069
- STA 550+04 TO STA 550+84: RR UNDERPASS

**STATION EQUATIONS:**

- STA 32+00 BK = STA 148+48 AH
- STA 564+48 BK = STA 20+69.5 AH

ADT (2009) = 3,750

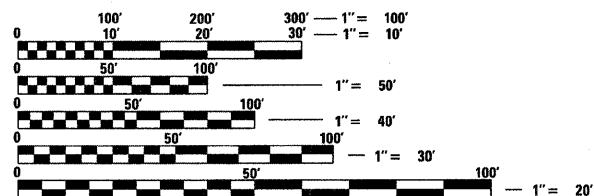

FULL SIZE PLANS HAVE BEEN PREPARED USING STANDARD ENGINEERING SCALES. REDUCED SIZED PLANS WILL NOT CONFORM TO STANDARD SCALES. IN MAKING MEASUREMENTS ON REDUCED PLANS, THE ABOVE SCALES MAY BE USED.

J.U.L.I.E.  
 JOINT UTILITY LOCATION INFORMATION FOR EXCAVATION  
 1-800-892-0123  
 OR 811

PROJECT ENGINEER: MARK DAUGHERTY  
 PROJECT MANAGER: BRIAN J. BIERMAN

CONTRACT NO. 74382

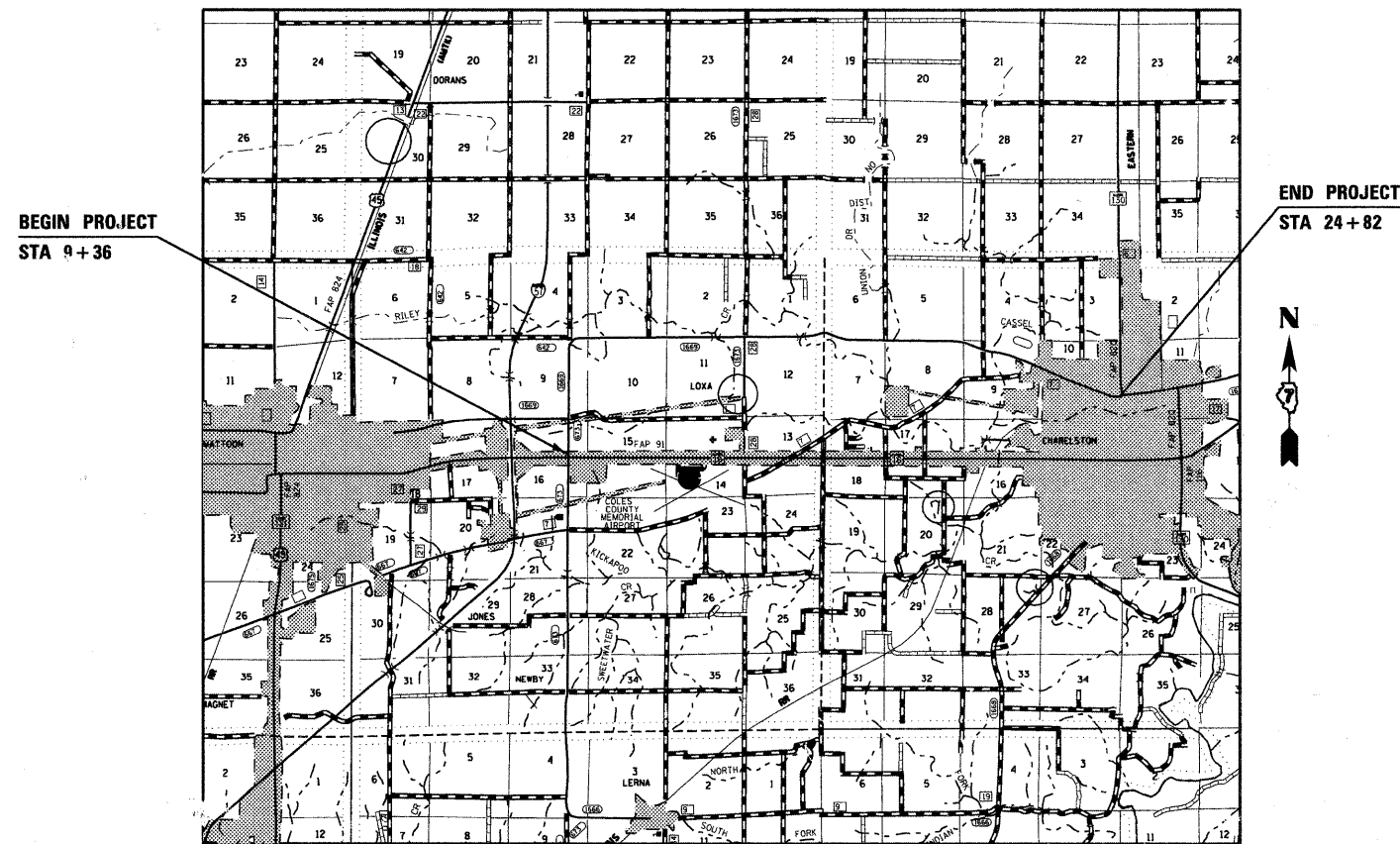

GROSS LENGTH = 44,277 FT. = 8.39 MILE  
 NET LENGTH = 44,000 FT. = 8.33 MILE

F.A.S. RTE.	SECTION	COUNTY	TOTAL SHEETS	SHEET NO.
1669	(7,6) & (5,4)RS-2	COLES	14	1
		ILLINOIS	CONTRACT NO. 74382	

D-97-038-09

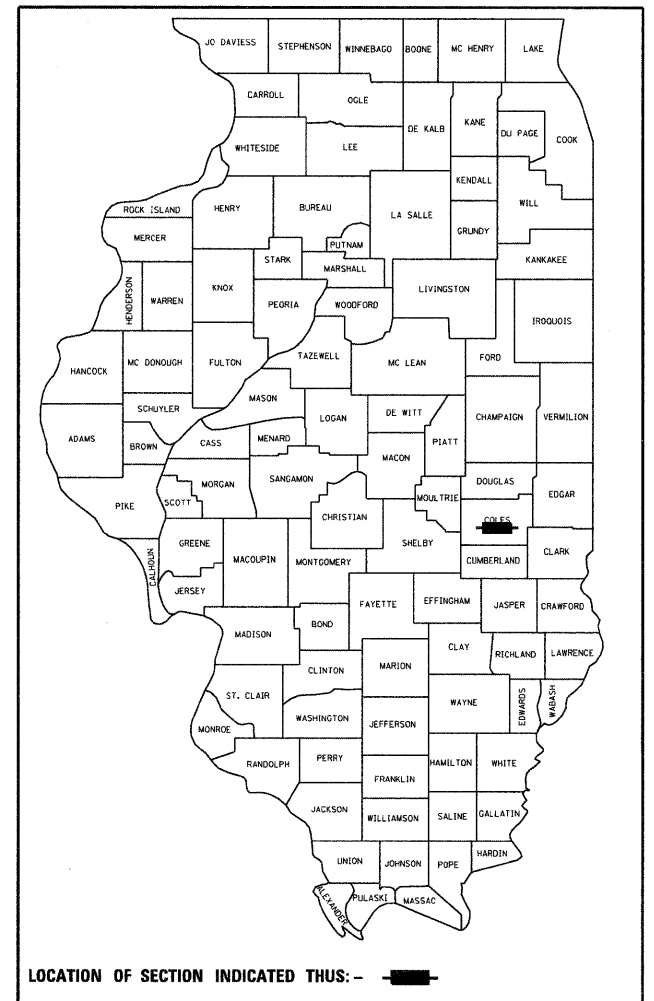

LOCATION OF SECTION INDICATED THUS: - [black rectangle] -

STATE OF ILLINOIS  
 DEPARTMENT OF TRANSPORTATION  
 DIVISION OF HIGHWAYS

SUBMITTED March 19 2010  
Rogan J. Driskell  
 DEPUTY DIRECTOR OF HIGHWAYS, REGION ENGINEER

April 9 2010  
Scott E. Still, P.E./e  
 acting ENGINEER OF DESIGN AND ENVIRONMENT

April 9 2010  
Christine M. Reed/e  
 DIRECTOR OF HIGHWAYS, CHIEF ENGINEER

**PRINTED BY THE AUTHORITY**  
**OF THE STATE OF ILLINOIS**

**GENERAL NOTES**

THE PROPOSED PROJECT IS ON LERNA ROAD/OLD 316 AND BEGINS JUST NORTH OF IL 16, APPROXIMATELY 500 FEET SOUTH OF BUXTON DRIVE, AND ENDS JUST WEST OF 4TH STREET IN CHARLESTON PRIOR TO THE TURN LANE.

THE CONTRACTOR SHALL PROVIDE INTERNET ACCESS TO THE BITUMINOUS PLANT QUALITY CONTROL LAB SO THAT BITUMINOUS PLANT REPORTS CAN BE E-MAILED TO THE DISTRICT HEADQUARTERS. THIS WORK WILL NOT BE PAID FOR SEPARATELY BUT SHALL BE INCLUDED IN THE UNIT PRICES FOR OTHER ITEMS IN THE CONTRACT.

FOR THE PAY ITEM BITUMINOUS MATERIALS (PRIME COAT), THE CONTRACTOR SHALL USE EITHER RC-70, SS-1H, OR SS-1HP APPLIED AT THE RATE DIRECTED BY THE ENGINEER.

THE COST OF REMOVAL OF THE TEMPORARY RAMP SHALL BE INCLUDED IN THE UNIT PRICE FOR TEMPORARY RAMP.

THE TOTAL QUANTITY OF PAINT PAVEMENT MARKING - LINE 4" CONSISTS OF 31,255 FEET OF YELLOW AND 82,055 FEET OF WHITE.

THE TOTAL QUANTITY OF THERMOPLASTIC PAVEMENT MARKING - LINE 4" CONSISTS OF 3,146 FEET OF YELLOW.

THE TOTAL QUANTITY OF THERMOPLASTIC PAVEMENT MARKING - LINE 6" CONSISTS OF 283 FEET OF WHITE.

THE TOTAL QUANTITY OF THERMOPLASTIC PAVEMENT MARKING - LINE 12" CONSISTS OF 70 FEET OF YELLOW.

THE TOTAL QUANTITY OF THERMOPLASTIC PAVEMENT MARKING - LETTERS AND SYMBOLS CONSISTS OF 166 SQUARE FEET OF WHITE.

THE TOTAL QUANTITY OF RAISED REFLECTIVE PAVEMENT MARKERS IS 541 TWO-WAY AMBER, 47 ONE-WAY AMBER AND 6 ONE-WAY CRYSTAL.

SHORT-TERM PAVEMENT MARKING ON THE MILLED SURFACE SHALL BE PAINT. ALL OTHER SHORT-TERM PAVEMENT MARKINGS SHALL BE TAPE.

THE ACTUAL LOCATIONS AND QUANTITY OF PAVEMENT PATCHES SHALL BE DETERMINED BY THE RESIDENT ENGINEER.

THE MATERIAL USED FOR AGGREGATE SURFACE COURSE, TYPE B SHALL BE CRUSHED STONE OR CRUSHED CONCRETE.

THE MATERIAL USED FOR AGGREGATE SHOULDERS, TYPE B SHALL BE CRUSHED STONE, CRUSHED CONCRETE, OR RAP.

THE LOCATIONS AND/OR DEPTHS OF UNDERGROUND UTILITIES SHOWN HAVE BEEN TAKEN FROM INFORMATION FURNISHED BY THE UTILITY OWNERS AND MUST BE CONSIDERED APPROXIMATE. FIELD MARKINGS OF FACILITIES IN CRITICAL AREAS MAY BE OBTAINED BY PROVIDING A MINIMUM OF 96 HOURS ADVANCE NOTICE THROUGH THE J.U.L.I.E. SYSTEM BY CALLING 800-892-0123.

QUANTITIES OF BITUMINOUS CONCRETE SURFACE COURSE WERE CALCULATED USING THE FACTOR 112 LBS/SQ YD/INCH. THE FOLLOWING MIXTURE REQUIREMENTS ARE APPLICABLE TO THIS PROJECT:

MIXTURE USE(S):	SURFACE COURSE (1 1/2")	MIXTURE USE(S):	LEVEL BINDER (3/4")
AC/PG:	PG 64-22	AC/PG:	PG 64-22
DESIGN AIR VOIDS:	4.0% @ NDESIGN = 70	DESIGN AIR VOIDS:	4.0% @ NDESIGN = 70
MIXTURE COMPOSITION:		MIXTURE COMPOSITION:	
(GRADATION MIXTURE)	IL-9.5	(GRADATION MIXTURE)	IL-9.5
FRICTION AGGREGATE:	MIXTURE C	FRICTION AGGREGATE:	N/A

MIXTURE USE(S):	INCIDENTAL SURFACE	MIXTURE USE(S):	CLASS D PATCHING (11" & 13")
AC/PG:	PG 64-22	AC/PG:	PG 64-22
DESIGN AIR VOIDS:	4.0% @ NDESIGN = 70	DESIGN AIR VOIDS:	4.0% @ NDESIGN = 70
MIXTURE COMPOSITION:		MIXTURE COMPOSITION:	
(GRADATION MIXTURE)	IL-9.5	(GRADATION MIXTURE)	IL-19.0
FRICTION AGGREGATE:	MIXTURE C	FRICTION AGGREGATE:	N/A

MIXTURE USE(S):	HOT-MIX ASPHALT SHOULDERS (8")
AC/PG:	PG 64-22
DESIGN AIR VOIDS:	4.0% @ NDESIGN = 30
MIXTURE COMPOSITION:	
(GRADATION MIXTURE)	IL-19.0L
FRICTION AGGREGATE:	N/A

**INDEX OF SHEETS**

SHEET NO	TITLE
1	COVER SHEET
2	GENERAL NOTES, INDEX OF SHEETS, LIST OF STANDARDS
3	SUMMARY OF QUANTITIES
4	LOCATION MAP
5	SCHEDULES
6-7	TYPICAL SECTIONS
8	MILLING AND HMA SHOULDER DETAILS
9-10	ENTRANCE SCHEDULE
11-14	PAVEMENT MARKING DETAILS

THE FOLLOWING STANDARDS ARE A PART OF THESE PLANS AND ARE INCLUDED FOLLOWING THE LAST NUMBERED SHEET OF THE PLANS.

STD. NO.	DESCRIPTION
000001-05	STANDARD SYMBOLS, ABBREVIATIONS AND PATTERNS
001006	DECIMAL OF AN INCH AND OF A FOOT
442201-03	CLASS C AND D PATCHES
482011-03	HMA SHLD. STRIPS/SHLDS. WITH RESURFACING OR WIDENING AND RESURFACING PROJECTS
630001-08	STEEL PLATE BEAM GUARDRAIL
630101-08	GUARDRAIL MOUNTED ON EXISTING CULVERTS
630301-05	SHOULDER WIDENING FOR TYPE 1 (SPECIAL) GUARDRAIL TERMINALS
635006-03	REFLECTOR AND TERMINAL MARKER PLACEMENT
667101-01	PERMANENT SURVEY MARKERS
701006-03	OFF-RD OPERATIONS, 2L, 2W, 15' TO 24" FROM PAVEMENT EDGE
701011-02	OFF-RD MOVING OPERATIONS, 2L, 2W, DAY ONLY
701301-03	LANE CLOSURE, 2L, 2W, SHORT TIME OPERATIONS
701306-02	LANE CLOSURE, 2L, 2W, SLOW MOVING OPERATIONS DAY ONLY, FOR SPEEDS >= 45 MPH
701311-03	LANE CLOSURE, 2L, 2W MOVING OPERATIONS-DAY ONLY
701326-03	LANE CLOSURE, 2L, 2W, PAVEMENT WIDENING, FOR SPEEDS >= 45 MPH
701336-05	LANE CLOSURE, 2L, 2W, WORK AREAS IN SERIES, FOR SPEEDS >= 45 MPH
701901-01	TRAFFIC CONTROL DEVICES
780001-02	TYPICAL PAVEMENT MARKINGS
781001-03	TYPICAL APPLICATIONS RAISED REFLECTIVE PAVEMENT MARKERS

SUMMARY OF QUANTITIES			100% STATE	CONSTRUCTION TYPE CODE		
CODE NO	ITEM	UNIT	TOTAL QUANTITIES	RURAL 1000	URBAN 1000	
40200800	AGGREGATE SURFACE COURSE, TYPE B	TON	58	51	7	
40600100	BITUMINOUS MATERIALS (PRIME COAT)	GALLON	11043	9341	1702	
40600300	AGGREGATE (PRIME COAT)	TON	221	187	34	
40600635	LEVELING BINDER (MACHINE METHOD), N70	TON	4638	3923	715	
40600895	CONSTRUCTING TEST STRIP	EACH	1	1		
40600982	HOT-MIX ASPHALT SURFACE REMOVAL - BUTT JOINT	SQ YD	630	630		
40600990	TEMPORARY RAMP	SQ YD	407	288	119	
40603315	HOT-MIX ASPHALT SURFACE COURSE, MIX "C", N70	TON	9276	7847	1429	
40800050	INCIDENTAL HOT-MIX ASPHALT SURFACING	TON	251	152	99	
44000151	HOT-MIX ASPHALT SURFACE REMOVAL, 1/2"	SQ YD	96962	88260	8702	
44000158	HOT-MIX ASPHALT SURFACE REMOVAL, 2 1/4"	SQ YD	12840	4527	8313	
44004250	PAVED SHOULDER REMOVAL	SQ YD	2427	2427		
44201777	CLASS D PATCHES, TYPE II, 11 INCH	SQ YD	278		278	
44201781	CLASS D PATCHES, TYPE III, 11 INCH	SQ YD	32		32	
44201783	CLASS D PATCHES, TYPE IV, 11 INCH	SQ YD	64		64	
44201798	CLASS D PATCHES, TYPE I, 13 INCH	SQ YD	941	828	113	
44201803	CLASS D PATCHES, TYPE II, 13 INCH	SQ YD	1273	1175	98	
44201807	CLASS D PATCHES, TYPE III, 13 INCH	SQ YD	393	393		
44201809	CLASS D PATCHES, TYPE IV, 13 INCH	SQ YD	700	700		
48101200	AGGREGATE SHOULDERS, TYPE B	TON	1570	1447	123	
48203029	HOT-MIX ASPHALT SHOULDERS, 8"	SQ YD	2427	2427		
*63000001	STEEL PLATE BEAM GUARD RAIL, TYPE A, 6 FOOT POSTS	FOOT	425	425		
*63000025	STEEL PLATE BEAM GUARD RAIL, ATTACHED TO STRUCTURES	FOOT	25	25		
*63100167	TRAFFIC BARRIER TERMINAL, TYPE 1 (SPECIAL) TANGENT	EACH	4	4		
63200310	GUARDRAIL REMOVAL	FOOT	200	200		
66700205	PERMANENT SURVEY MARKERS, TYPE I	EACH	2		2	
67000500	ENGINEER'S FIELD OFFICE, TYPE B	CAL MO	6	3	3	
67100100	MOBILIZATION	L SUM	1	0.5	0.5	
70100460	TRAFFIC CONTROL AND PROTECTION, STANDARD 701306	L SUM	1	0.5	0.5	
70100500	TRAFFIC CONTROL AND PROTECTION, STANDARD 701326	L SUM	1	1		
70100600	TRAFFIC CONTROL AND PROTECTION, STANDARD 701336	L SUM	1	0.5	0.5	

SUMMARY OF QUANTITIES			100% STATE	CONSTRUCTION TYPE CODE		
CODE NO	ITEM	UNIT	TOTAL QUANTITIES	RURAL 1000	URBAN 1000	
70300100	SHORT-TERM PAVEMENT MARKING	FOOT	17545	15022	2523	
70300210	TEMPORARY PAVEMENT MARKING, LETTERS AND SYMBOLS	SQ FT	166		166	
70300220	TEMPORARY PAVEMENT MARKING LINE 4"	FOOT	116456	104021	12435	
70300240	TEMPORARY PAVEMENT MARKING LINE 6"	FOOT	283		283	
70300260	TEMPORARY PAVEMENT MARKING LINE 12"	FOOT	70		70	
70301000	WORK ZONE PAVEMENT MARKING REMOVAL	SQ FT	1462	1252	210	
*78000100	THERMOPLASTIC PAVEMENT MARKING - LETTERS AND SYMBOLS	SQ FT	166		166	
*78000200	THERMOPLASTIC PAVEMENT MARKING - LINE 4"	FOOT	3146		3146	
*78000400	THERMOPLASTIC PAVEMENT MARKING - LINE 6"	FOOT	283		283	
*78000600	THERMOPLASTIC PAVEMENT MARKING - LINE 12"	FOOT	70		70	
*78001110	PAINT PAVEMENT MARKING - LINE 4"	FOOT	113310	104021	9289	
78100100	RAISED REFLECTIVE PAVEMENT MARKER	EACH	594	469	125	
*78200410	GUARDRAIL MARKERS, TYPE A	EACH	10	10		
*78201000	TERMINAL MARKER - DIRECT APPLIED	EACH	4	4		
Z0025500	FURNISHING AND INSTALLING PROPERTY MARKERS	EACH	8	8		
	<i>*Specialty Items</i>					

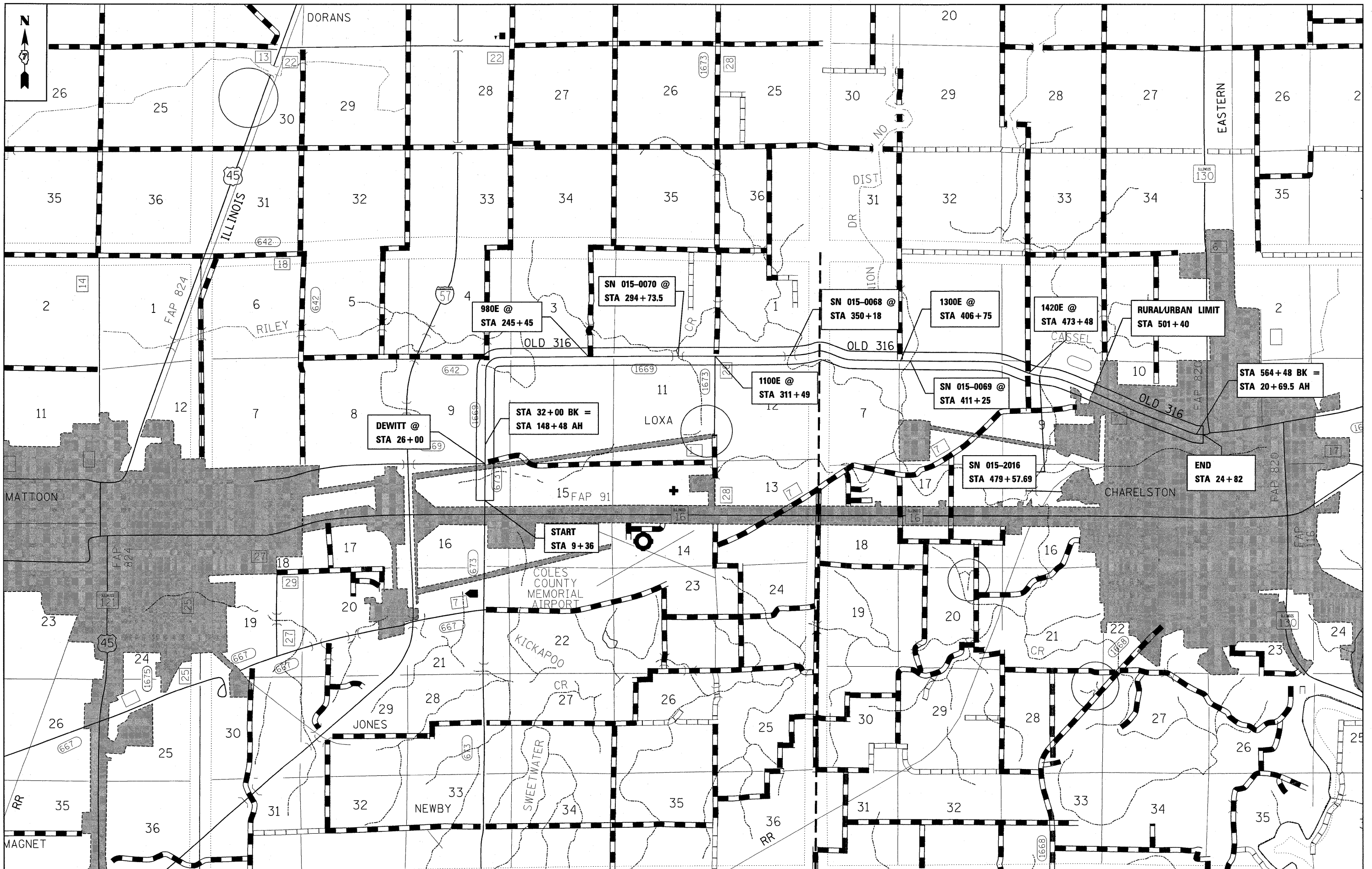

FILE NAME =  
 ci:\pw\work\NPWIDOT\TEASLEYCK\0140949\07

USER NAME = teasleyck  
 74382-ah-cover.dgn  
 PLOT SCALE = 50,0000' / IN.  
 PLOT DATE = 3/19/2010

DESIGNED -  
 DRAWN -  
 CHECKED -  
 DATE -

REVISED -  
 REVISED -  
 REVISED -  
 REVISED -

**STATE OF ILLINOIS  
 DEPARTMENT OF TRANSPORTATION**

**LOCATION MAP**

SCALE: SHEET NO. OF SHEETS STA. TO STA.

F.A.S. RTE.	SECTION	COUNTY	TOTAL SHEETS	SHEET NO.
1669	(7,6) & (5,4)RS-2	Coles	14	4
CONTRACT NO. 74382				
ILLINOIS FED. AID PROJECT				

**GUARDRAIL SCHEDULE**

STATION TO STATION				STEEL PLATE BEAM GUARD RAIL, TYPE A, 6 FOOT POSTS	STEEL PLATE BEAM GUARD RAIL, ATTACHED TO STRUCTURES	TRAFFIC BARRIER TERMINAL TYPE 1, SPECIAL (TANGENT)	GUARDRAIL REMOVAL	GUARDRAIL MARKER, TYPE A	TERMINAL MARKER - DIRECT APPLIED
				FT	FT	EACH	FT	EACH	EACH
LT STA 16+93.1	TO	LT STA 17+43.1		0	0	1	0	1	1
LT STA 17+43.1	TO	LT STA 18+08.8		65.7	0	0	19	1	0
LT STA 18+08.8	TO	LT STA 18+21.3		0	12.5	0	13	0	0
LT STA 18+21.3	TO	LT STA 19+68.1		146.8	0	0	69	2	0
LT STA 19+68.1	TO	LT STA 20+18.1		0	0	1	0	1	1
RT STA 16+11.9	TO	RT STA 16+61.9		0	0	1	0	1	1
RT STA 16+61.9	TO	RT STA 18+08.8		146.9	0	0	59	2	0
RT STA 18+08.8	TO	RT STA 18+21.3		0	12.5	0	13	0	0
RT STA 18+21.3	TO	RT STA 18+86.9		65.6	0	0	29	1	0
RT STA 18+86.9	TO	RT STA 19+36.9		0	0	1	0	1	1
TOTALS:				425	25	4	200	10	4

**PAVEMENT SCHEDULE**

STATION TO STATION				LENGTH	WIDTH	BITUMINOUS MATERIALS (PRIME COAT)	AGGREGATE (PRIME COAT)	LEVELING BINDER (MACHINE METHOD), N70	HOT-MIX ASPHALT SURFACE REMOVAL - BUTT JOINT	TEMPORARY RAMP	HOT-MIX ASPHALT SURFACE, MIX "C", N70	HOT-MIX ASPHALT SURFACE REMOVAL, 1/2"	HOT-MIX ASPHALT SURFACE REMOVAL, 2 1/4"	AGGREGATE SHOULDERS, TYPE B
				FT	FT	GAL	TON	TON	SQ YD	SQ YD	TON	SQ YD	SQ YD	TON
STA 9+36	TO	STA 23+75		1439	30	479.5	10	202	117	53	403	4680	0	58
STA 23+75	TO	STA 31+45		770	23	197	4	83	0	0	165	1968	0	26
STA 31+45	TO	STA 32+00		55	22	13.5	0	6	0	0	11	134	0	2
STA 148+48	TO	STA 501+40		35292	22	8650.5	174	3631	513	235	7268	81478	4527	1360
STA 501+40	TO	STA 539+05		3765	22	920.5	18	387	0	0	773	8702	501.1	123
STA 539+05	TO	STA 542+30		325	22-33	99.5	2	42	0	0	83	0	993	0
STA 542+30	TO	STA 545+41		311	33	114	2	48	0	0	96	0	1140	0
STA 545+41	TO	STA 548+44		303	33-22	92.5	2	39	0	0	78	0	926	0
STA 548+44	TO	STA 564+48		1604	22	372.5	7	156	0	78	313	0	3725	0
STA 20+69.5	TO	STA 23+10		240.5	22	59	1	25	0	0	49	0	588	0
STA 23+10	TO	STA 24+82		172	23	44	1	19	0	41	37	0	440	0
TOTALS:				11043	221	4638	630	407	9276	96962	12840	1570		

**HOT-MIX ASPHALT SHOULDER**

STATION TO STATION				LENGTH	WIDTH	PAVED SHOULDER REMOVAL	HOT-MIX ASPHALT SHOULDERS, 8"
				FT	FT	SQ YD	SQ YD
RT STA 186+50	TO	STA 201+00		1450	4	644	644
RT STA 363+50	TO	STA 388+65		2515	3	838	838
LT STA 372+50	TO	STA 388+65		1615	4	718	718
RT STA 488+50	TO	STA 493+60		510	4	227	227
TOTALS:				2427		2427	

**STRIPING SCHEDULE**

STATION TO STATION				SHORT-TERM PAVEMENT MARKING	TEMPORARY PAINT PAVEMENT MARKING, LETTERS AND SYMBOLS	TEMPORARY PAINT PAVEMENT MARKING LINE 4"	TEMPORARY PAINT PAVEMENT MARKING LINE 6"	TEMPORARY PAINT PAVEMENT MARKING 12"	WORK ZONE PAVEMENT MARKING REMOVAL	THERMOPLASTIC PAVEMENT MARKING - LETTERS AND SYMBOLS	THERMOPLASTIC PAVEMENT MARKING - LINE 4"	THERMOPLASTIC PAVEMENT MARKING - LINE 6"	THERMOPLASTIC PAVEMENT MARKING - LINE 12"	PAINT PAVEMENT MARKING - LINE 4"	RAISED REFLECTIVE PAVEMENT MARKER
				FT	SQ FT	FT	FT	FT	SQ FT	SQ FT	FT	FT	FT	FT	FT
STA 9+36	TO	STA 32+00		905	0	5001	0	0	75	0	0	0	0	5001	28
STA 148+48	TO	STA 501+40		14116	0	99020	0	0	1176	0	0	0	0	99020	441
STA 501+40	TO	STA 538+85		1497	0	8104	0	0	125	0	0	0	0	8104	47
STA 538+85	TO	STA 548+82		235	166	3836	239	70	20	166	3146	239	70	690	53
STA 548+82	TO	STA 564+48		627	0	392	44	0	52	0	0	44	0	392	20
STA 20+69.5	TO	STA 24+82		165	0	103	0	0	14	0	0	0	0	103	5
TOTALS:				17545	166	116456	283	70	1462	166	3146	283	70	113310	594

**FURNISHING AND INSTALLING PROPERTY MARKERS**

STATION	OFFSET	DESCRIPTION	EACH
206+48	0.0'	VAULT - ALUMINUM DISK 1.0' DEEP	1
232+60	RT 7.0'	VAULT - ALUMINUM DISK 1.0' DEEP	1
258+87	RT 11.9'	IRON PIN IN CONCRETE OFF PAVEMENT	1
285+27	RT 11.0'	BRASS DISK IN CONCRETE OFF PAVEMENT	1
311+60	RT 18.0'	VAULT OFF PAVEMENT ON SIDEROAD 1100E	1
324+80	RT 8.9'	MAG NAIL	1
380+43	RT 5.8'	PK NAIL	1
433+00	RT 12.7'	BENT PIN OFF PAVEMENT	1
TOTAL:			8

**PERMANENT SURVEY MARKERS, TYPE I**

STA	DESCRIPTION	EACH
24+88.42	P. O. T. - IRON PIN	1
28+85.77	P. I. - BRASS MONUMENT	1
TOTAL:		2



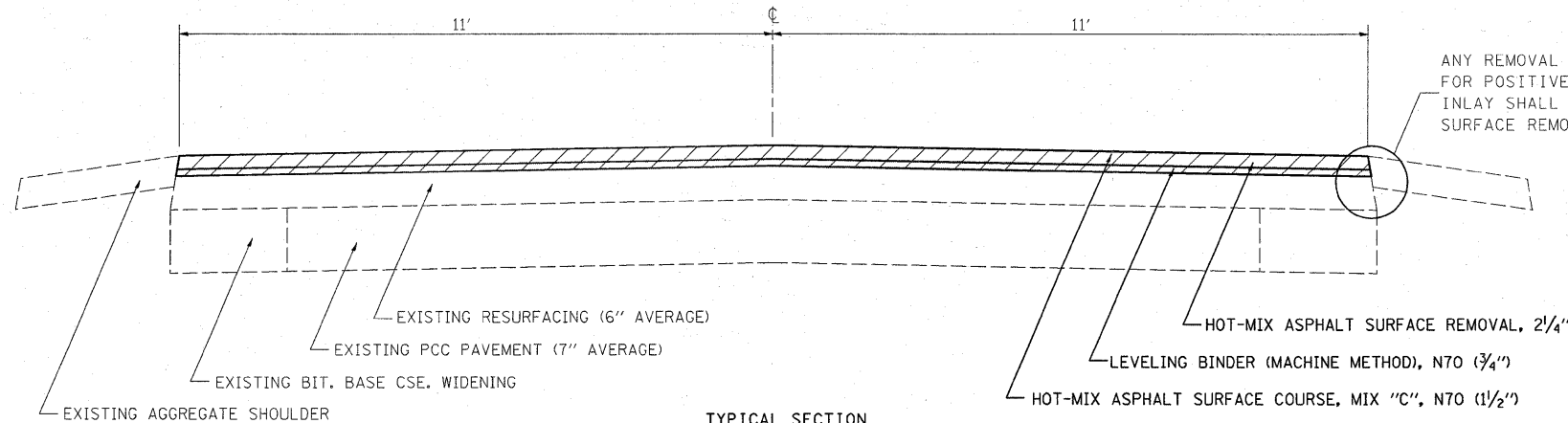

ANY REMOVAL OF EXISTING AGGREGATE SHOULDER TO ALLOW FOR POSITIVE DRAINAGE AND CONSTRUCTION OF THE BITUMINOUS INLAY SHALL BE INCLUDED IN THE COST OF HOT-MIX ASPHALT SURFACE REMOVAL, 2 1/4\".

**TYPICAL SECTION**  
 STA 330+38 TO STA 332+26  
 STA 340+65 TO STA 345+15  
 STA 398+92 TO STA 399+99  
 STA 474+00 TO STA 478+85  
 STA 484+00 TO STA 488+60  
 STA 498+19 TO STA 499+81

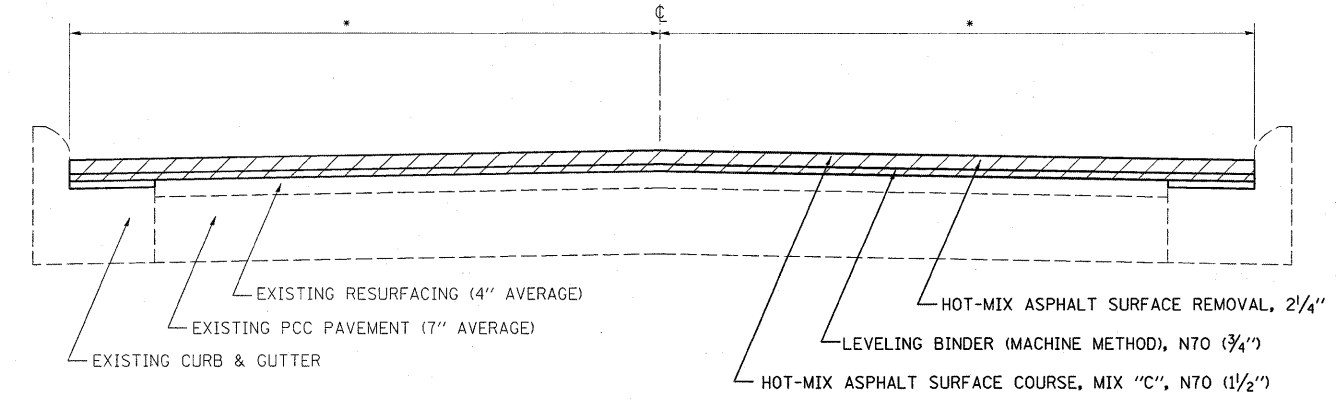

**TYPICAL SECTION**  
 STA 538+85 TO STA 539+05: \* = 11'  
 STA 539+05 TO STA 542+30: \* = 11' - 16.5'  
 STA 542+30 TO STA 545+41: \* = 16.5'  
 STA 545+41 TO STA 548+44: \* = 16.5' - 11'  
 STA 548+44 TO STA 550+04: \* = 11'  
 STA 550+84 TO STA 564+48: \* = 11'  
 STA 20+69.5 TO STA 23+10: \* = 11'

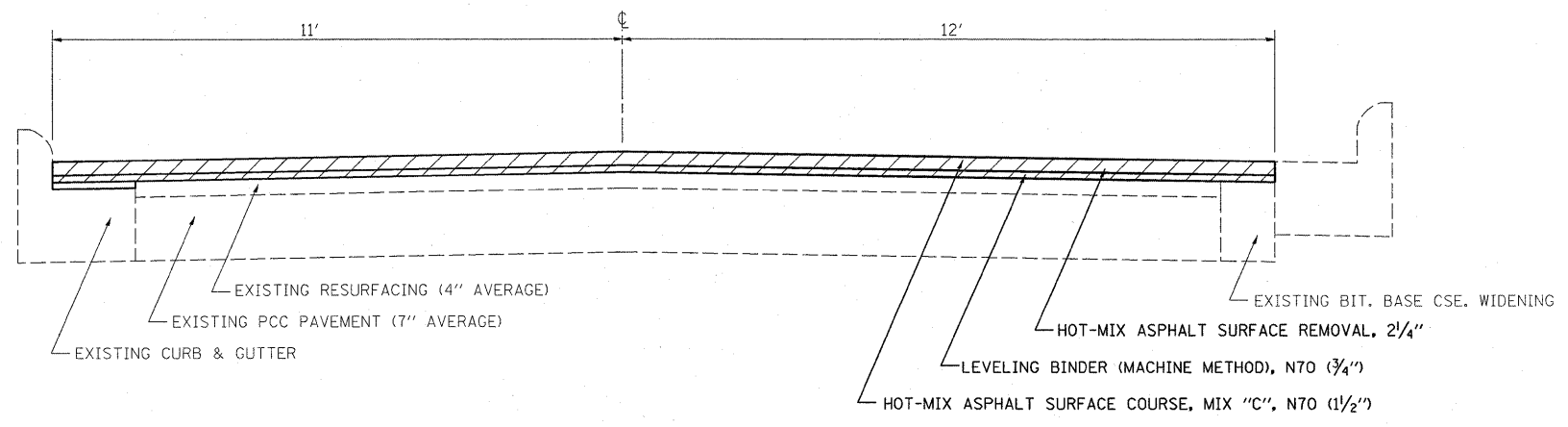

**TYPICAL SECTION**  
 STA 23+10 TO STA 24+82

FILE NAME = c:\pw_work\pwidot\TEASLEYCK\08140949\074382-shr-typico1.dgn	USER NAME = teasleyck	DESIGNED -	REVISED -	<b>STATE OF ILLINOIS DEPARTMENT OF TRANSPORTATION</b>	<b>TYPICAL SECTIONS</b>				F.A.S. RTE. 1669	SECTION (7,6) & (5,4)RS-2	COUNTY Coles	TOTAL SHEETS 14	SHEET NO. 7
	PLOT SCALE = 50.0000' / IN.	CHECKED -	REVISED -						CONTRACT NO. 74382				
	PLOT DATE = 3/19/2010	DATE -	REVISED -		SCALE:	SHEET NO.	OF SHEETS	STA.	TO STA.	ILLINOIS FED. AID PROJECT			

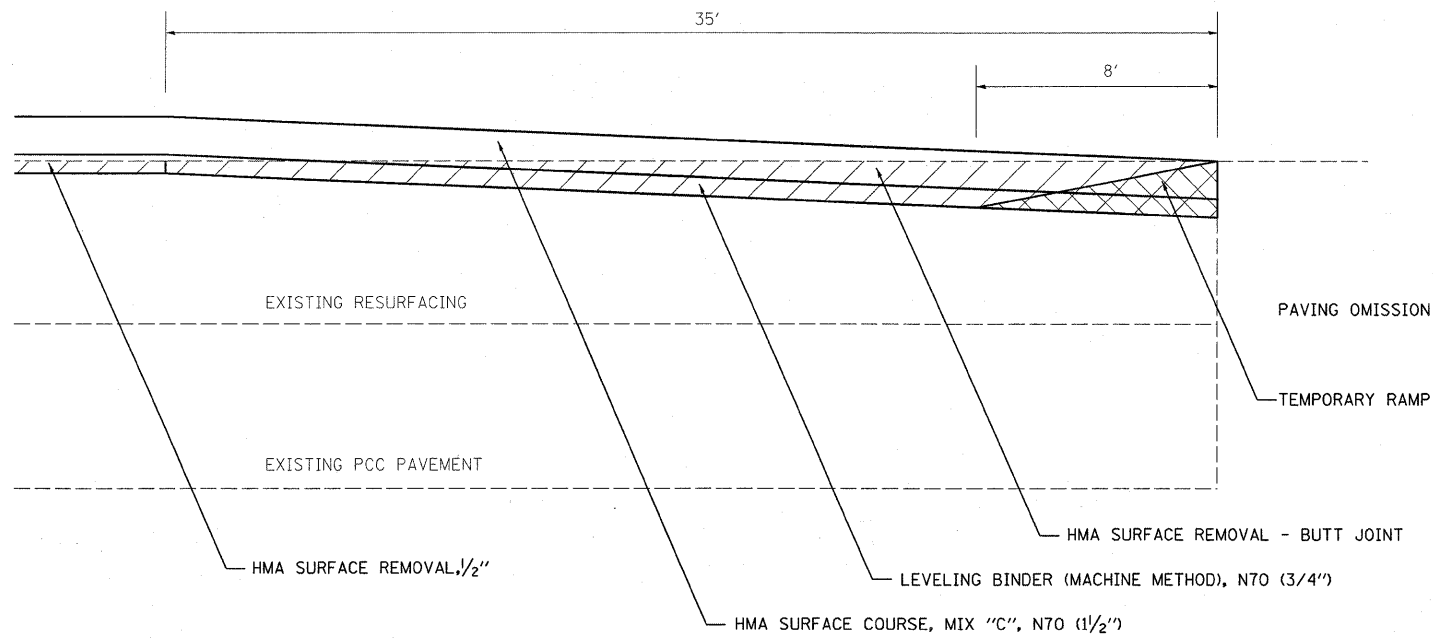

**BUTT JOINT DETAIL**  
 STA 9+36 TO STA 9+71  
 STA 293+93 TO STA 294+28  
 STA 295+19 TO STA 295+54  
 STA 349+43 TO STA 349+78  
 STA 350+18 TO STA 350+53  
 STA 410+57 TO STA 410+92  
 STA 411+58 TO STA 411+93

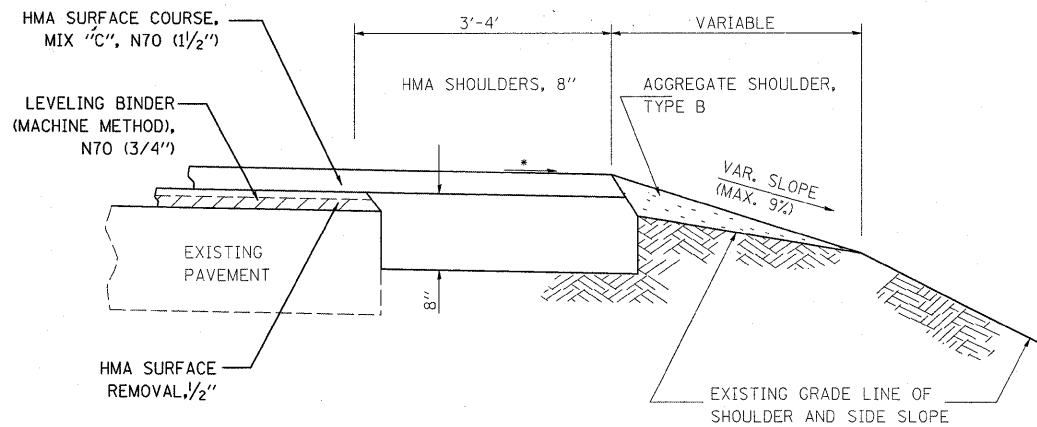
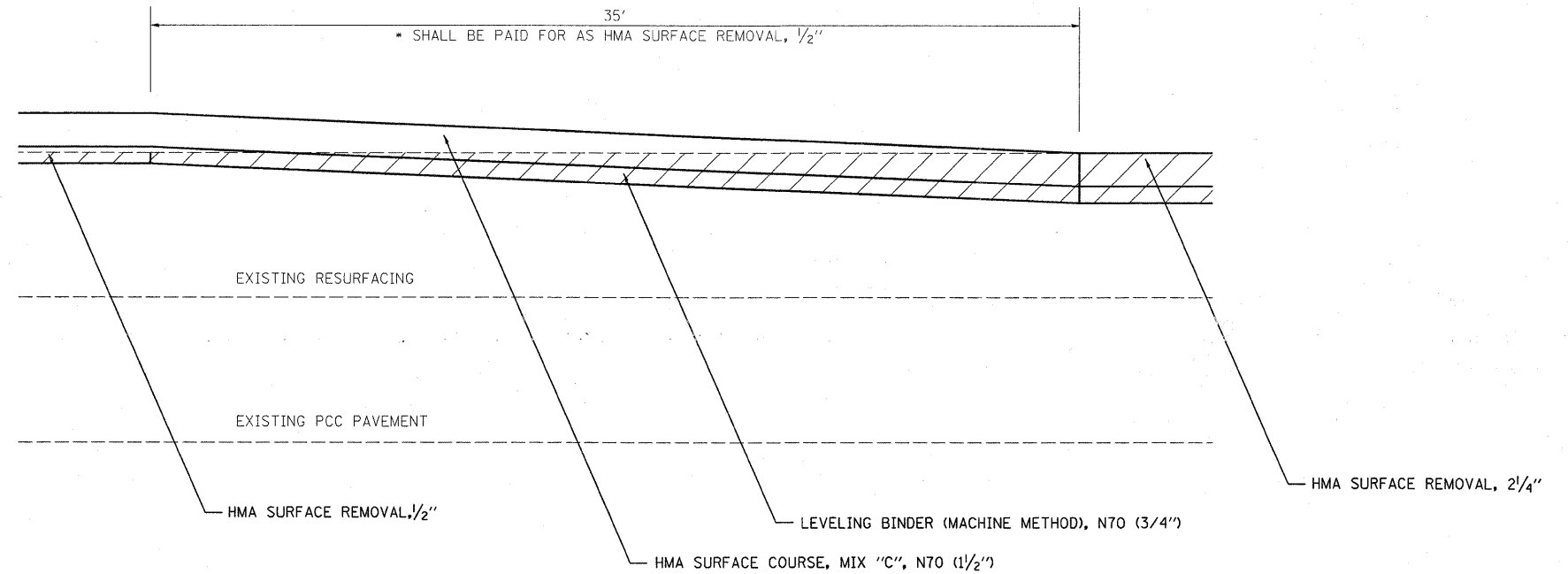

• 4% MINIMUM OR MATCH EXISTING SUPERELEVATION

**HMA SHOULDER AND AGGREGATE WEDGE WITH RESURFACING**

**MILLING TRANSITION DETAIL**

- STA 330+03 TO STA 330+38
- STA 332+26 TO STA 332+61
- STA 340+30 TO STA 340+65
- STA 345+15 TO STA 345+50
- STA 398+57 TO STA 398+92
- STA 399+99 TO STA 400+34
- STA 473+65 TO STA 474+00
- STA 478+85 TO STA 479+20
- STA 483+65 TO STA 484+00
- STA 488+60 TO STA 488+95
- STA 497+84 TO STA 498+19
- STA 499+81 TO STA 500+16
- STA 521+35 TO STA 521+70
- STA 523+55 TO STA 523+90

FILE NAME =	USER NAME = teasleyck	DESIGNED -	REVISED -
cs:\pw\work\NPWIDOT\TEASLEYCK\08140949\074382-sht-details.dgn		DRAWN -	REVISED -
	PLOT SCALE = 50.0000' / IN.	CHECKED -	REVISED -
	PLOT DATE = 3/19/2010	DATE -	REVISED -

**STATE OF ILLINOIS  
DEPARTMENT OF TRANSPORTATION**

MILLING AND HMA SHOULDER DETAILS				
SCALE:	SHEET NO.	OF SHEETS	STA.	TO STA.

F.A.S. RTE.	SECTION	COUNTY	TOTAL SHEETS	SHEET NO.
1669	(7,6) & (5,4)RS-2	Coles	14	8
CONTRACT NO. 74382				
ILLINOIS FED. AID PROJECT				



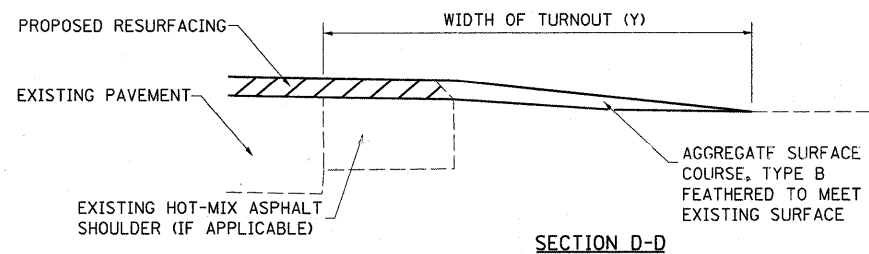
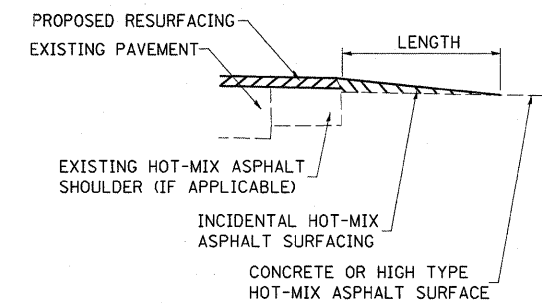
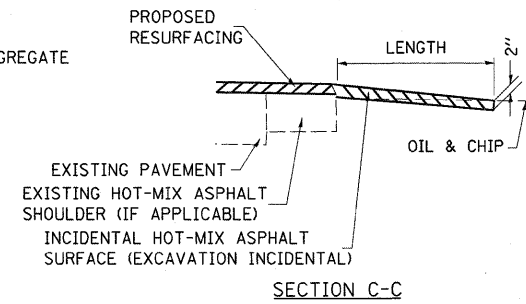
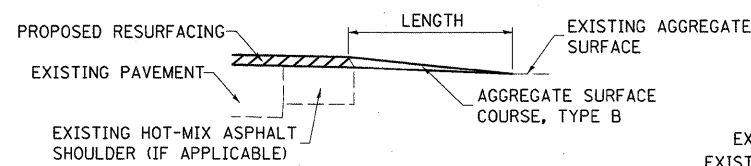
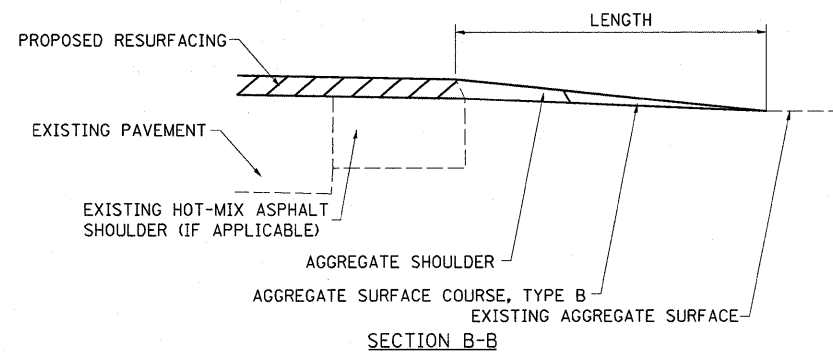
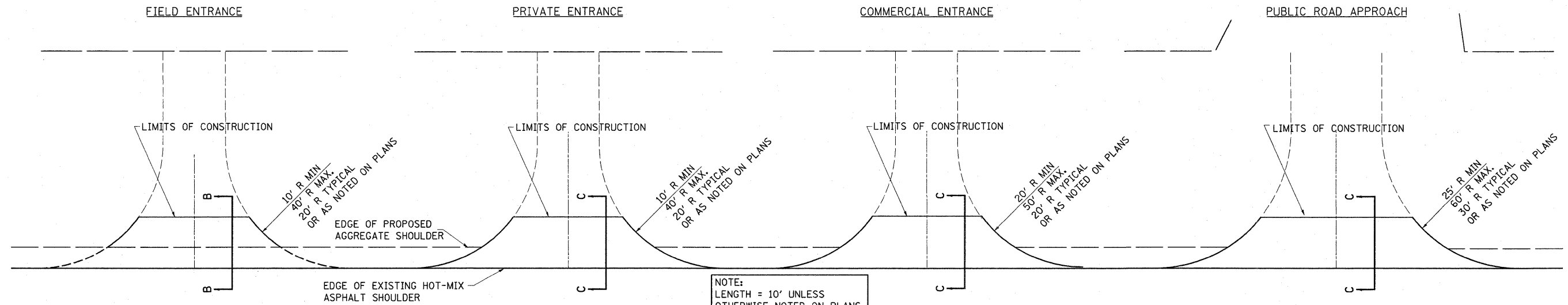

**TYPICAL SECTION AT MAILBOX TURNOUT**

NOTE: SEE STANDARD 406201 FOR MAILBOX TURNOUT DETAILS

**NOTES**

THE COST OF THE ASPHALT MATERIALS, AND AGGREGATE (PRIME COAT) FOR ENTRANCES AND PUBLIC ROADS AND APPROACHES SHALL BE INCLUDED IN THE PAY ITEM INCIDENTAL HOT-MIX ASPHALT SURFACING.

THE COST OF EXCAVATION IS INCLUDED IN THE PAY ITEM INCIDENTAL HOT-MIX ASPHALT SURFACING.

IF THERE IS NOT EXISTING HOT-MIX ASPHALT SHOULDER THEN THE ENTRANCE TAPER STARTS AT THE EDGE OF EXISTING PAVEMENT.

THE COST OF THE BITUMINOUS MATERIALS AND AGGREGATE (PRIME COAT) FOR ENTRANCES AND PUBLIC ROAD APPROACHES SHALL BE INCLUDED IN THE PAY ITEM INCIDENTAL HOT-MIX ASPHALT SURFACING.

SIDE	STATION	TYPE	INCIDENTAL HOT-MIX ASPHALT SURFACING	
			TON	TON
LT	12+93	FE	0.6	1.2
RT	12+60	FE	0.6	1.2
RT	14+07	PRA	1.4	
LT	22+93	PRA	2.7	
RT	23+04	FE	0.5	1.0
LT	23+68	FE		0.9
RT	23+68	FE	0.9	
LT	26+00	PRA	10.5	
RT	26+00	PRA	5.0	
LT	181+98	FE		1.8
RT	183+98	MBT		7.1
LT	212+76	FE	0.4	0.7
RT	212+76	FE	1.6	
RT	221+38	FE	0.5	0.9
LT	231+44	PE	2.0	
LT	232+05	PE	1.9	
RT	232+50	CE	1.1	
RT	232+50	CE		1.1
RT	239+50	FE		1.1
LT	245+78	PRA	2.8	
RT	246+75	PE	2.8	

SIDE	STATION	TYPE	INCIDENTAL HOT-MIX ASPHALT SURFACING	
			TON	TON
RT	256+36	FE		1.1
LT	257+75	PE	1.5	
LT	270+08	PE	1.2	
RT	270+08	MBT	2.5	
LT	297+45	PE	2.1	
RT	298+15	MBT	1.0	
LT	298+94	PE		2.3
RT	305+40	FE	1.1	
LT	310+60	CE	2.8	
RT	311+60	MBT		1.9
LT	312+10	PRA	4.7	
RT	312+10	PRA	4.1	
RT	337+90	FE	0.3	0.6
RT	339+93	FE		0.9
LT	345+00	PE	4.7	
RT	351+55	FE		1.5
LT	358+05	PE		5.2
LT	359+40	FE		2.6
LT	372+82	PE	3.5	
RT	377+35	PE	1.5	
RT	378+63	PE	1.9	

SIDE	STATION	TYPE	INCIDENTAL HOT-MIX ASPHALT SURFACING	
			TON	TON
RT	380+76	PE	3.2	
RT	383+56	CE	4.7	
RT	384+90	PE	1.5	
RT	386+00	CE	3.5	
LT	387+70	PE	5.1	
RT	388+00	FE		1.7
LT	396+00	MBT	1.2	
RT	396+00	PE	2.2	
LT	406+50	PRA	3.4	
LT	410+54	PE	2.4	
LT	416+90	PE	3.5	
RT	420+28	PRA	4.4	
LT	420+00	PE	4.4	
RT	430+40	PE	1.9	
LT	430+62	MBT	0.9	
LT	435+25	PE	1.8	
LT	447+75	PE	2.9	
LT	450+42	PE		2.6
LT	453+72	PE		2.1
LT	458+85	PE		1.7
RT	459+96	CE	1.9	

SIDE	STATION	TYPE	INCIDENTAL HOT-MIX ASPHALT SURFACING	
			TON	TON
LT	460+00	PE	2.8	
LT	460+92	PE		1.2
RT	461+42	CE	1.7	
LT	463+07	PE	1.4	
LT	465+50	PE		2.7
LT	468+18	PE		1.3
LT	468+83	PE	2.5	
LT	469+65	PE		4.9
RT	469+92	CE	2.5	
RT	471+20	CE	1.6	
RT	472+62	CE	2.5	
LT	473+52	PRA	3.5	
RT	473+62	PRA	3.7	
LT	489+10	CE	3.0	
LT	491+70	CE	1.9	
RT	493+70	PE	1.2	
LT	496+23	CE	2.8	
LT	500+50	CE	2.4	
RT	501+10	PE	1.1	
LT	501+80	CE	4.7	
LT	502+30	MBT		2.9

SIDE	STATION	TYPE	INCIDENTAL HOT-MIX ASPHALT SURFACING	
			TON	TON
LT	502+92	CE	5.2	
LT	504+78	PE	2.1	
LT	505+25	PE	2.5	
RT	505+53	PE	1.6	
LT	506+62	PE		0.9
RT	507+15	PE	1.2	
LT	507+83	PE	1.1	
RT	508+82	CE	2.9	
RT	511+33	CE	3.4	
RT	511+85	CE		3.9
LT	512+16	PE	1.6	
RT	513+03	CE	3.7	
RT	515+00	PRA	5.3	
LT	515+30	PRA	3.2	
RT	517+22	CE	3.1	
RT	520+80	CE	7.5	
RT	523+10	CE	4.0	
RT	524+35	CE	3.1	
RT	525+05	CE	2.6	
RT	525+92	CE	2.6	
RT	526+70	CE	3.0	

FE=FIELD ENTRANCE PRA - PUBLIC ROAD APPROACH  
 PE=PRIVATE ENTRANCE MBT - MAILBOX TURNOUT  
 CE=COMMERCIAL ENTRANCE

FILE NAME =	USER NAME = teasleyck	DESIGNED - 08-03-99	REVISED - 03-13-07
ci:\pw\work\NVIDOT\TEASLEYCK\d0140949\0	74382_sht_details.dgn	DRAWN -	REVISED -
	PLOT SCALE = 50.0000' / IN.	CHECKED -	REVISED -
	PLOT DATE = 3/19/2010	DATE -	REVISED -

**STATE OF ILLINOIS  
DEPARTMENT OF TRANSPORTATION**

**RURAL ENTRANCE SCHEDULE AND MAILBOX TURNOUT DETAILS  
WITH SHOULDERS**

SCALE:	SHEET NO. OF SHEETS	STA. TO STA.
--------	---------------------	--------------

F.A.S. RTE.	SECTION	COUNTY	TOTAL SHEETS	SHEET NO.
1669	(7,6) & (5,4)RS-2	Coles	14	9
FED. ROAD DIST. NO.			ILLINOIS FED. AID PROJECT	
			CONTRACT NO. 74382	

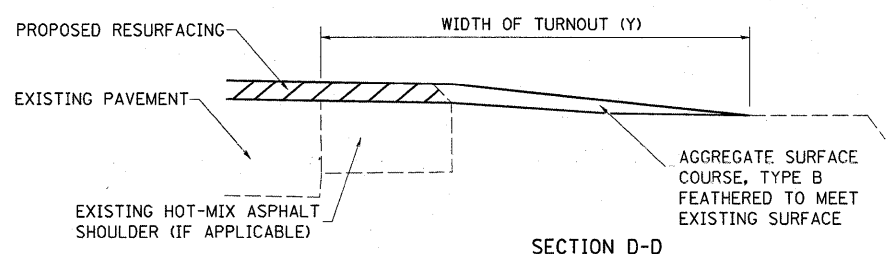
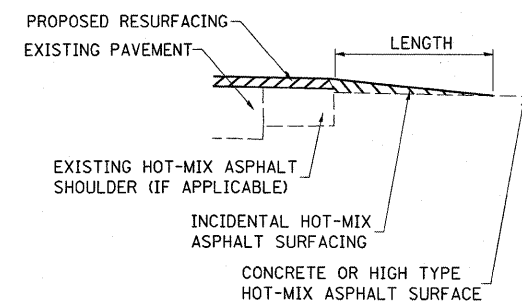
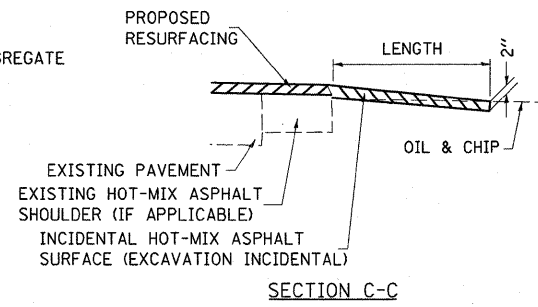
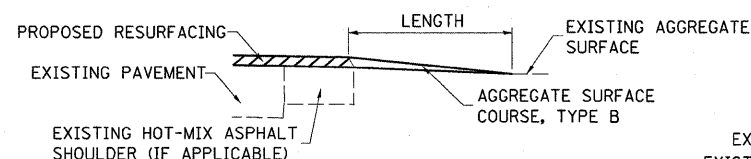
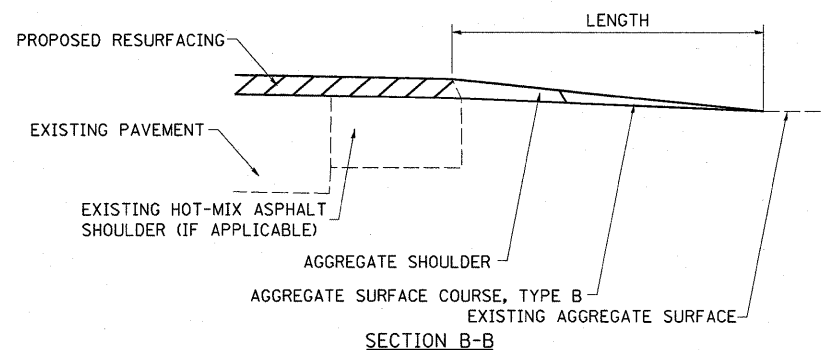
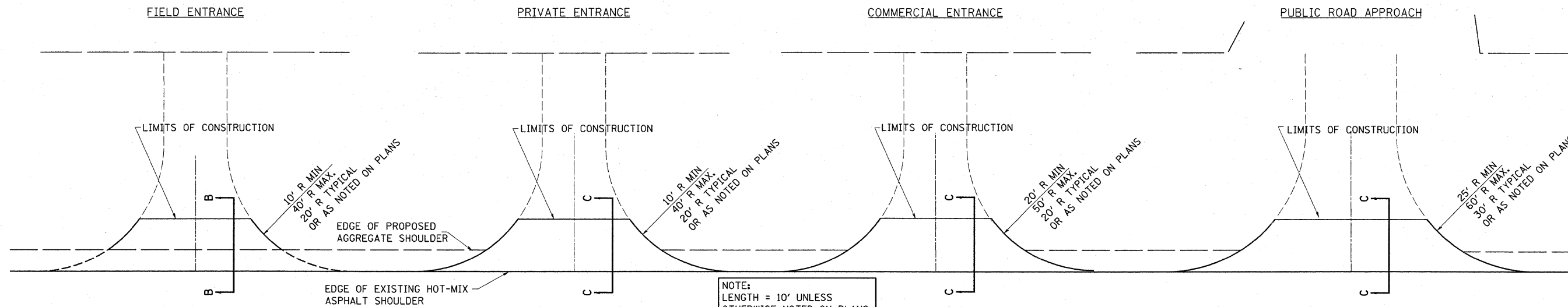

**TYPICAL SECTION AT MAILBOX TURNOUT**  
NOTE: SEE STANDARD 406201 FOR MAILBOX TURNOUT DETAILS

**NOTES**

THE COST OF THE ASPHALT MATERIALS, AND AGGREGATE (PRIME COAT) FOR ENTRANCES AND PUBLIC ROADS AND APPROACHES SHALL BE INCLUDED IN THE PAY ITEM INCIDENTAL HOT-MIX ASPHALT SURFACING.

THE COST OF EXCAVATION IS INCLUDED IN THE PAY ITEM INCIDENTAL HOT-MIX ASPHALT SURFACING.

IF THERE IS NOT EXISTING HOT-MIX ASPHALT SHOULDER THEN THE ENTRANCE TAPER STARTS AT THE EDGE OF EXISTING PAVEMENT.

THE COST OF THE BITUMINOUS MATERIALS AND AGGREGATE (PRIME COAT) FOR ENTRANCES AND PUBLIC ROAD APPROACHES SHALL BE INCLUDED IN THE PAY ITEM INCIDENTAL HOT-MIX ASPHALT SURFACING.

SIDE	STATION	TYPE	INCIDENTAL HOT-MIX ASPHALT SURFACING	AGGREGATE SURFACE COURSE, TYPE B
			TON	TON
RT	527+83	CE	2.4	
RT	529+06	CE	2.6	
RT	529+65	CE	2.1	
LT	531+05	CE	5.0	
RT	531+40	CE	3.1	
RT	532+10	CE	3.1	
LT	532+25	MBT	0.9	
LT	532+75	PE	2.4	
RT	533+15	CE	2.8	
LT	533+80	CE	6.8	
LT	538+70	CE	2.5	
TOTALS			251	58

SIDE	STATION	TYPE	INCIDENTAL HOT-MIX ASPHALT SURFACING	AGGREGATE SURFACE COURSE, TYPE B
			TON	TON

SIDE	STATION	TYPE	INCIDENTAL HOT-MIX ASPHALT SURFACING	AGGREGATE SURFACE COURSE, TYPE B
			TON	TON

SIDE	STATION	TYPE	INCIDENTAL HOT-MIX ASPHALT SURFACING	AGGREGATE SURFACE COURSE, TYPE B
			TON	TON

SIDE	STATION	TYPE	INCIDENTAL HOT-MIX ASPHALT SURFACING	AGGREGATE SURFACE COURSE, TYPE B
			TON	TON

FE=FIELD ENTRANCE PRA - PUBLIC ROAD APPROACH  
PE=PRIVATE ENTRANCE MBT - MAILBOX TURNOUT  
CE=COMMERCIAL ENTRANCE

FILE NAME =	USER NAME = teasleyck	DESIGNED - 08-03-99	REVISED - 03-13-07
es:\pw\work\PW\DOT\TEASLEYCK\d8140949\DOT\74382-sht-details.dgn		DRAWN -	REVISED -
		CHECKED -	REVISED -
		DATE - 3/19/2010	REVISED -

**STATE OF ILLINOIS  
DEPARTMENT OF TRANSPORTATION**

**RURAL ENTRANCE SCHEDULE AND MAILBOX TURNOUT DETAILS  
WITH SHOULDERS**

F.A.S. RTE.	SECTION	COUNTY	TOTAL SHEETS	SHEET NO.
1669	(7,6) & (5,4)RS-2	Coles	14	10
FED. ROAD DIST. NO. ILLINOIS FED. AID PROJECT			CONTRACT NO. 74382	

SCALE: SHEET NO. OF SHEETS STA. TO STA.

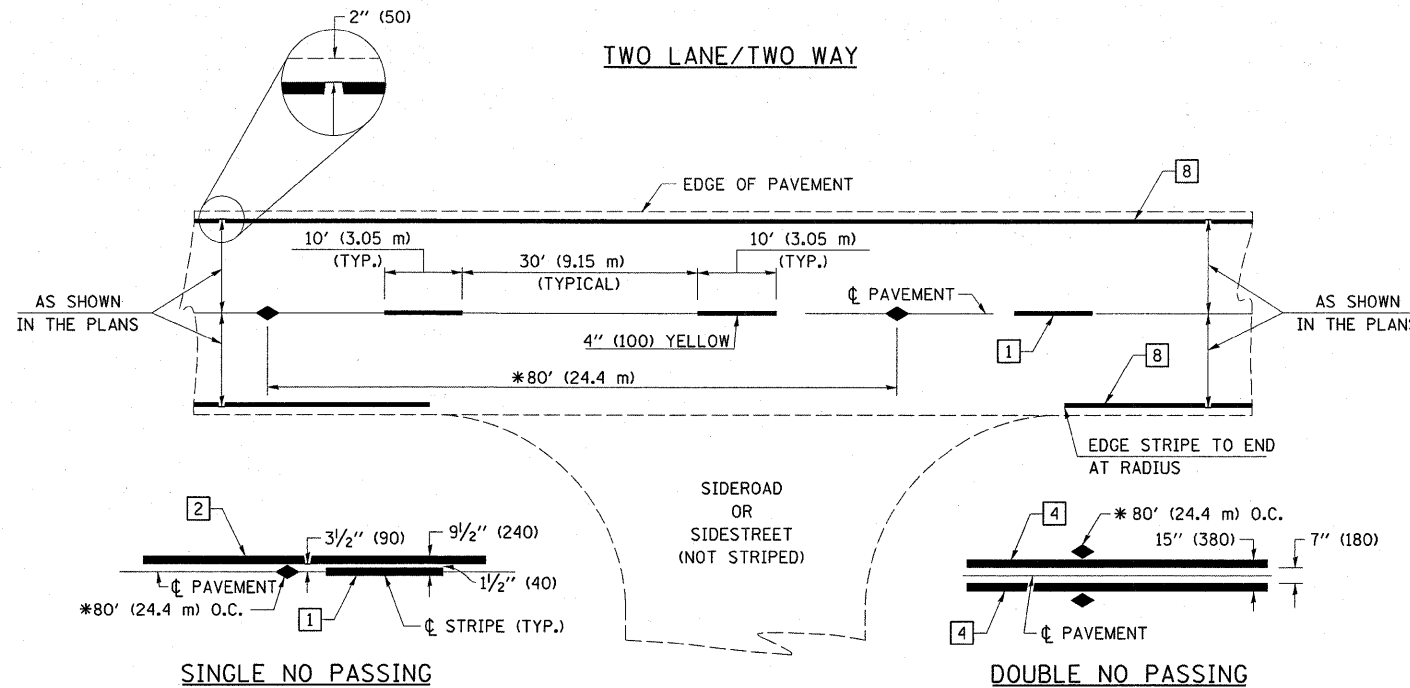

\* REDUCE TO 40' (12.2 m) O.C. ON CURVES WITH POSTED OR ADVISORY SPEEDS OF 45 mph (70 km/h) OR LESS.

**PAVEMENT MARKING LEGEND**

- 1 4" (100) SKIP-DASH (YELLOW)
- 2 4" (100) SOLID (YELLOW)
- 3 12" (300) DIAGONAL (YELLOW)
- 4 4" (100) DOUBLE YELLOW (NARROW)
- 5 RESERVED
- 6 RESERVED
- 7 6" (150) SKIP-DASH (WHITE)
- 8 4" (100) SOLID (WHITE)
- 9 12" (300) DIAGONAL (WHITE)
- 10 6" (150) SOLID (WHITE)
- 11 24" (600) STOP BAR (WHITE)
- 12 8" (200) SOLID (WHITE)
- 13 6" (100) LANE LINE EXTENSIONS (WHITE)
- 14 4" (100) PARKING WHITE

**TYPICAL PAVEMENT MARKERS LEGEND**

- ◆ TWO-WAY AMBER MARKER
- ▶ ONE-WAY AMBER MARKER
- ▷ ONE-WAY CRYSTAL MARKER

**RAISED REFLECTIVE PAVEMENT MARKERS**

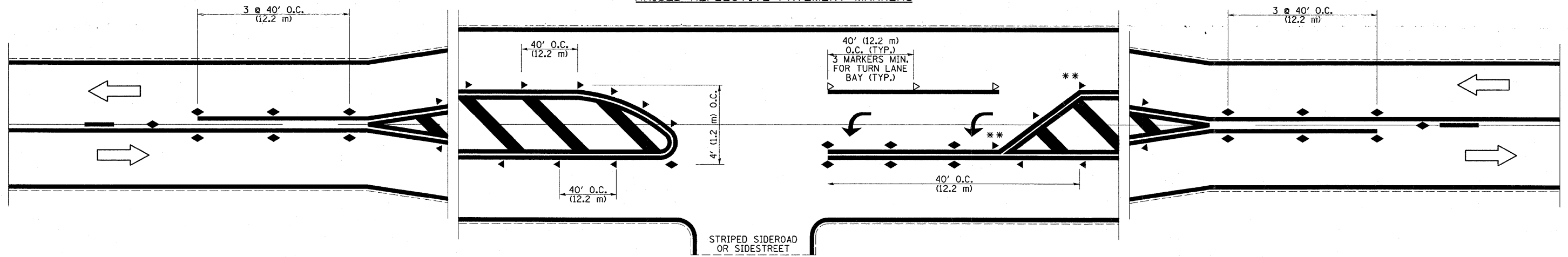

\*\* REDUCE SPACING IF NECESSARY TO ASSURE MARKERS AT CORNER POINTS.

NOT TO SCALE  
Note: All dimensions are in INCHES (millimeters) unless otherwise shown.

FILE NAME =	USER NAME = teasleyck	DESIGNED -	REVISED -	<b>STATE OF ILLINOIS DEPARTMENT OF TRANSPORTATION</b>	<b>PAVEMENT MARKING AND RAISED REFLECTIVE PAVEMENT MARKERS (RURAL &amp; URBAN APPLICATIONS)</b>	F.A.S. RTE.	SECTION	COUNTY	TOTAL SHEETS	SHEET NO.
ci:\pw_work\NPWIDOT\TEASLEYCK\08140949\074382-shr-details.dgn	74382-shr-details.dgn	DRAWN -	REVISED -			1669	(7,6) & (5,4)RS-2	Coles	14	11
PLOT SCALE = 50,0000 "/>										
PLOT DATE = 3/19/2010	DATE -	REVISED -	REVISED -			ILLINOIS FED. AID PROJECT				

**DISTRICT 7 DETAIL NO. 7800001**

F.A.S. RTE.	SECTION	COUNTY	TOTAL SHEETS	SHEET NO.
1669	(7,6) & (5,4)RS-2	Coles	14	11
CONTRACT NO. 74382				

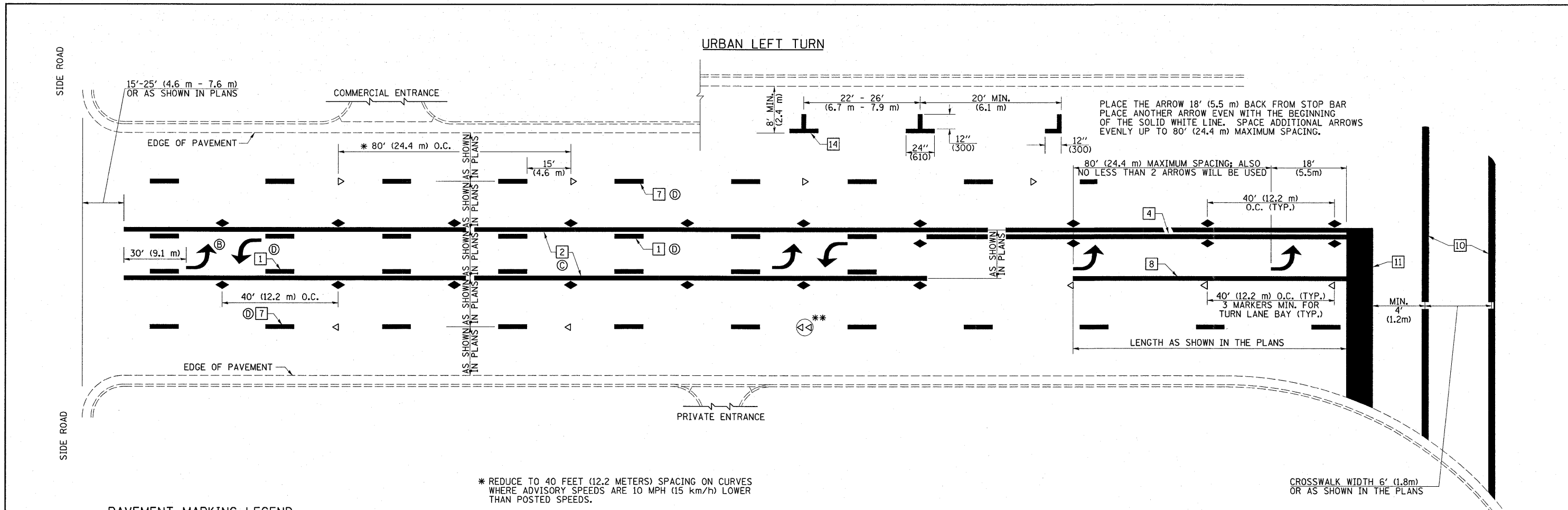

**PAVEMENT MARKING LEGEND**

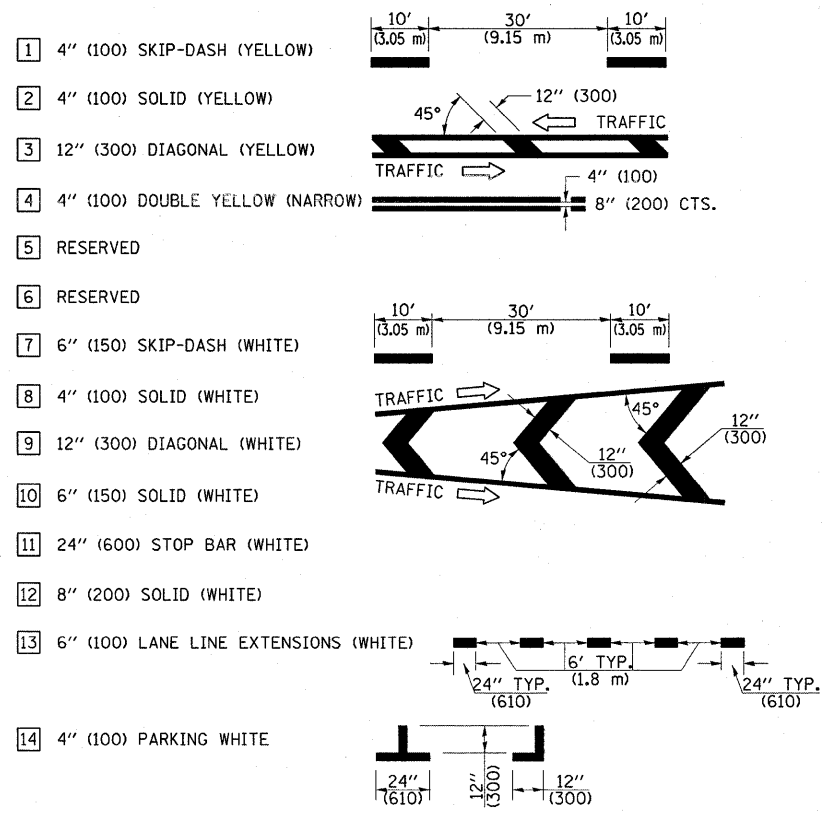

\* REDUCE TO 40 FEET (12.2 METERS) SPACING ON CURVES WHERE ADVISORY SPEEDS ARE 10 MPH (15 km/h) LOWER THAN POSTED SPEEDS.

\*\* DOUBLE LANE LINE MARKERS SHALL BE SPECIFIED AND SPACED AS SHOWN IN HIGHWAY STANDARD 781001 FOR MULTI-LANE DIVIDED AND UNDIVIDED HIGHWAYS.

**GENERAL NOTES**

- (B) TURN ARROW PAIRS SHALL BE PLACED AT 250' (75 m) INTERVALS AND SHALL BE EVENLY SPACED BETWEEN BOTH ENDS OF THE BIDIRECTIONAL LEFT TURN LANE. USE A MINIMUM OF TWO PAIRS PER BLOCK.
- (C) THE SOLID YELLOW PAVEMENT MARKINGS [2] SHOULD GENERALLY START OR END NEAR THE RADIUS POINT OF EACH STREET RETURN EXCEPT WHERE ONE OR BOTH ENDS WOULD INCLUDE STOP BARS.
- (D) THE SKIP-DASH PAVEMENT MARKINGS [1] OR [7] SHOULD BE CENTERED BETWEEN BOTH ENDS OF EACH CITY BLOCK AND SHALL BE PLACED SO THEY LINE UP ACROSS FROM EACH OTHER.
- (E) USE LARGE ARROW SIZE FOR BOTH RURAL AND URBAN LOCATIONS. (SEE LAST PAGE OF SECTION 780x FOR SYMBOLS TABLE)

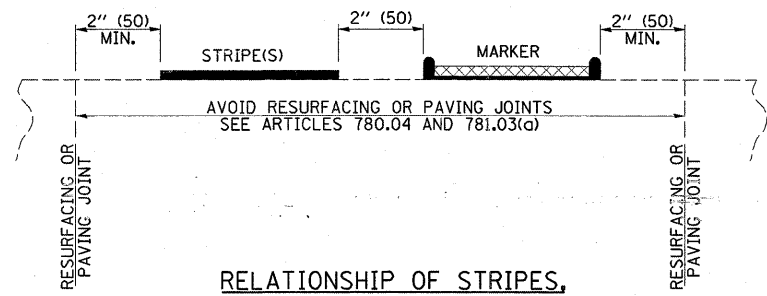

**RELATIONSHIP OF STRIPES, MARKERS AND JOINTS**

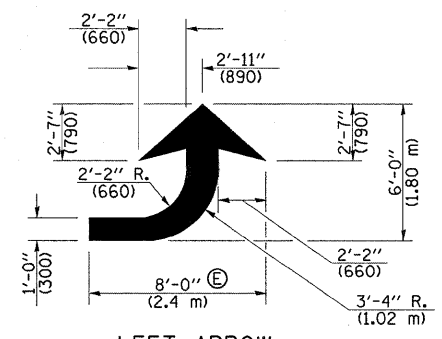

**LEFT ARROW**  
REVERSE FOR RIGHT ARROW  
AREA = 15.6 SQ. FT. (1.47 m<sup>2</sup>)  
(WHITE)

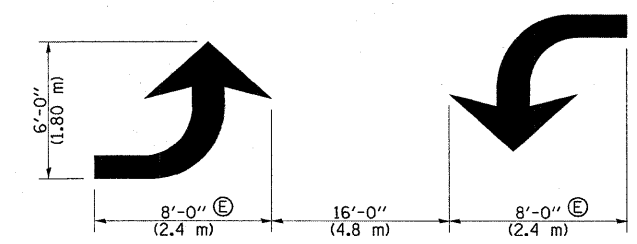

**TYPICAL DOUBLE TURN ARROWS (WHITE)**

NOT TO SCALE

Note: All dimensions are in INCHES (millimeters) unless otherwise shown.

FILE NAME =	USER NAME = teasleyck	DESIGNED -	REVISED -
ct:\pw_work\PWIDOT\TEASLEYCK\08140949\74382-sht-details.dgn		DRAWN -	REVISED -
	PLOT SCALE = 50.0000' / IN.	CHECKED -	REVISED -
	PLOT DATE = 3/19/2010	DATE -	REVISED -

**STATE OF ILLINOIS  
DEPARTMENT OF TRANSPORTATION**

**PAVEMENT MARKING AND RAISED REFLECTIVE PAVEMENT MARKERS  
(RURAL & URBAN APPLICATIONS)**

SCALE: SHEET NO. 2 OF 4 SHEETS STA. TO STA.

<b>DISTRICT 7 DETAIL NO. 7800001</b>				
F.A.S. RTE. 1669	SECTION (7,6) & (5,4)RS-2	COUNTY Coles	TOTAL SHEETS 14	SHEET NO. 12
CONTRACT NO. 74382				
ILLINOIS FED. AID PROJECT				

**ISLAND**

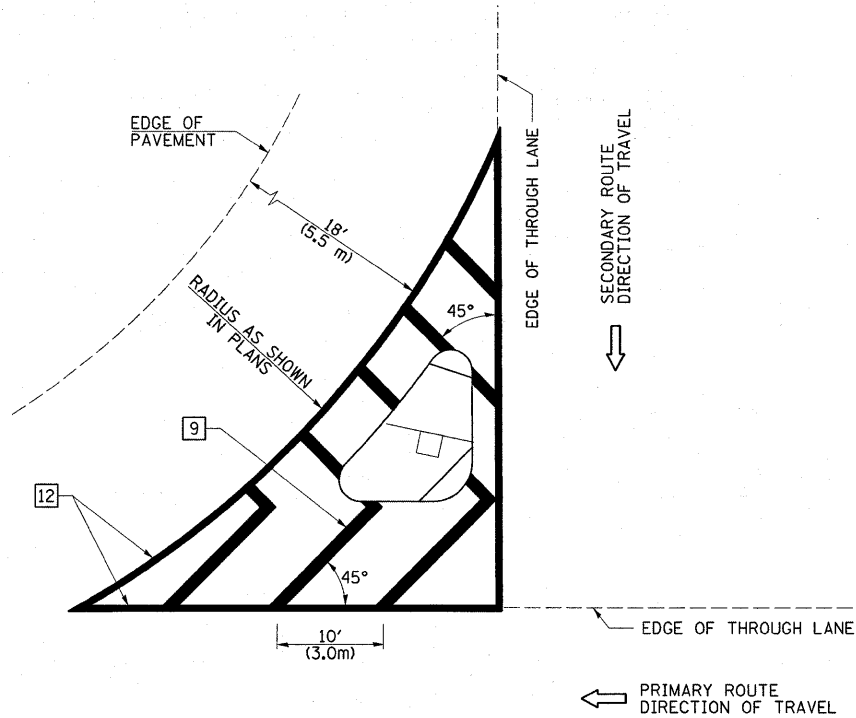

**GENERAL NOTES**

1. RAISED AND CORRUGATED MEDIANS SHALL BE OUTLINED WITH [2] IF PRESENT.
2. SOME OF THE INFORMATION INCLUDED WITH THIS DETAIL MAY NOT BE APPLICABLE TO THIS IMPROVEMENT.
3. PAVEMENT MARKINGS ARE TO BE EXTENDED THROUGH OMISSIONS WHEN APPLICABLE.
4. FINAL PAVEMENT MARKINGS SHALL BE IN PLACE PRIOR TO PLACING ANY RAISED REFLECTIVE PAVEMENT MARKERS.
5. THE FOLLOWING CRITERIA SHALL BE USED FOR SELECTING THE DIAGONAL PAVEMENT MARKING SPACING:

< 30 MPH (< 50 km/h)	15' (4.5 m)
30-45 MPH (50-75 km/h)	20' (6.0 m)
> 45 MPH (> 75 km/h)	30' (9.0 m)

**PAVEMENT MARKING LEGEND**

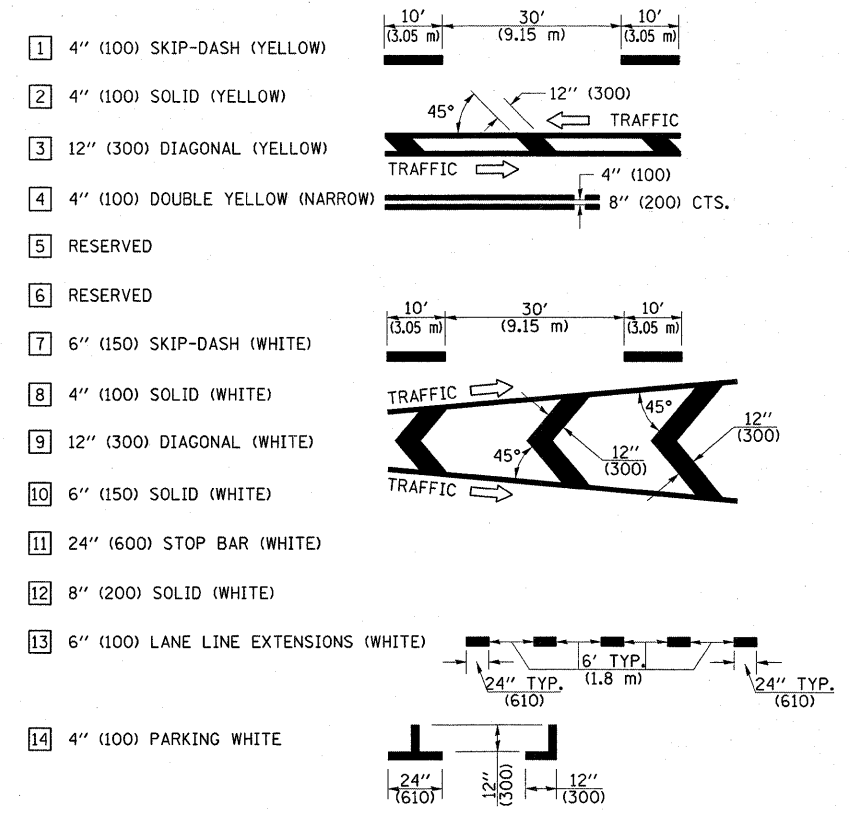

**RURAL LEFT TURN STRIPING**

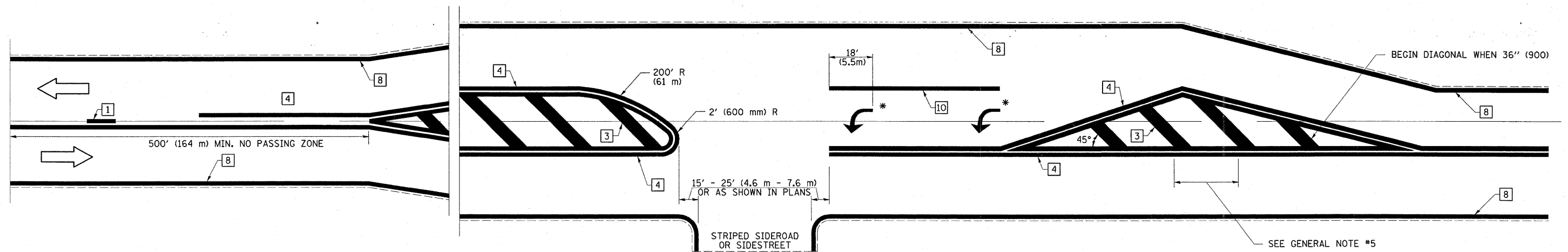

\* PLACE AN ARROW 18' (5.5 m) BACK FROM STOP BAR. PLACE ANOTHER ARROW EVEN WITH THE BEGINNING OF THE SOLID WHITE LINE. SPACE ADDITIONAL ARROWS EVENLY UP TO 80' (24.4 m) MAXIMUM SPACING. USE MINIMUM OF 2 ARROWS.

NOT TO SCALE

Note: All dimensions are in INCHES (millimeters) unless otherwise shown.

**DISTRICT 7 DETAIL NO. 7800001**

FILE NAME =	USER NAME = teasleyck	DESIGNED -	REVISED -	<b>STATE OF ILLINOIS DEPARTMENT OF TRANSPORTATION</b>	<b>PAVEMENT MARKING AND RAISED REFLECTIVE PAVEMENT MARKERS (RURAL &amp; URBAN APPLICATIONS)</b>	F.A.S. RTE.	SECTION	COUNTY	TOTAL SHEETS	SHEET NO.	
74382-sht-details.dgn		DRAWN -	REVISED -			1669	(7,6) & (5,4)RS-2	Coles	14	13	
PLOT SCALE = 50.0000 / IN.		CHECKED -	REVISED -			CONTRACT NO. 74382					
PLOT DATE = 3/19/2010		DATE -	REVISED -			ILLINOIS FED. AID PROJECT					

PAVEMENT MARKINGS AT RAILROAD-HIGHWAY GRADE CROSSING

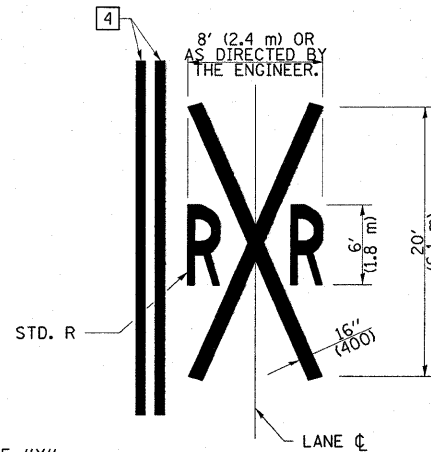
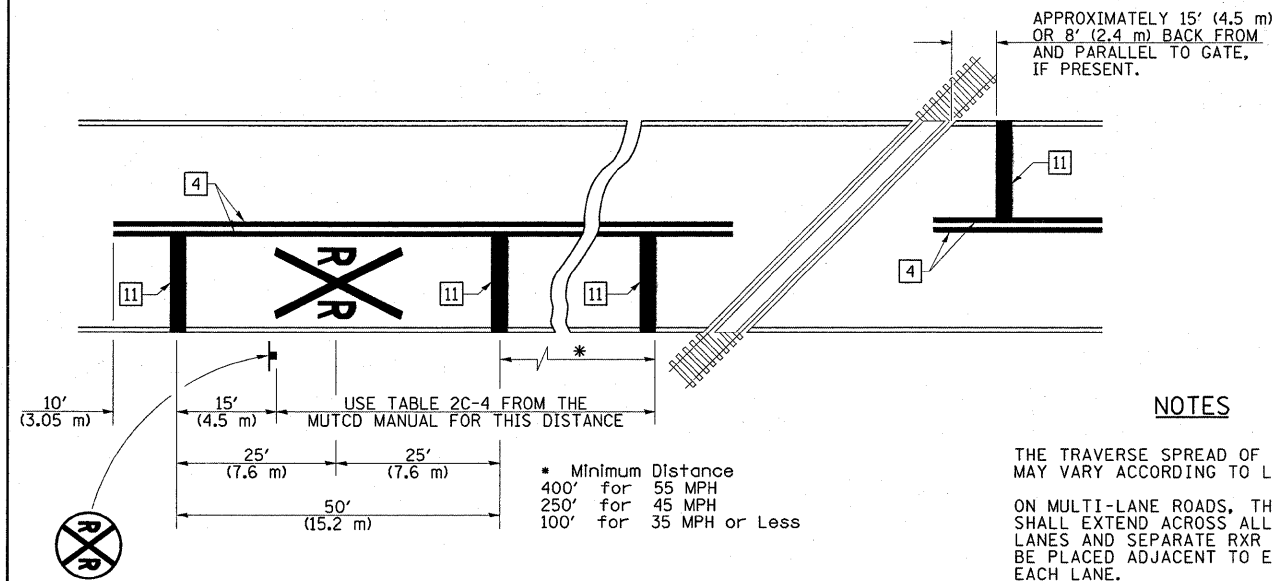

NOTES

THE TRAVERSE SPREAD OF THE "X" MAY VARY ACCORDING TO LANE WIDTH.

ON MULTI-LANE ROADS, THE STOP LINES SHALL EXTEND ACROSS ALL APPROACH LANES AND SEPARATE RXR SYMBOLS SHALL BE PLACED ADJACENT TO EACH OTHER IN EACH LANE.

WHEN THE PAVEMENT MARKING SYMBOL IS USED, A PORTION OF THE SYMBOL SHOULD BE LOCATED DIRECTLY ADJACENT TO THE ADVANCE WARNING SIGN (W10-1) AS PLACED BY TABLE 11-1, CONDITION B OF THE MUTCD.

PAVEMENT MARKING LEGEND

- 1 4" (100) SKIP-DASH (YELLOW)
- 2 4" (100) SOLID (YELLOW)
- 3 12" (300) DIAGONAL (YELLOW)
- 4 4" (100) DOUBLE YELLOW (NARROW)
- 5 RESERVED
- 6 RESERVED
- 7 6" (150) SKIP-DASH (WHITE)
- 8 4" (100) SOLID (WHITE)
- 9 12" (300) DIAGONAL (WHITE)
- 10 6" (150) SOLID (WHITE)
- 11 24" (600) STOP BAR (WHITE)
- 12 8" (200) SOLID (WHITE)
- 13 6" (100) LANE LINE EXTENSIONS (WHITE)
- 14 4" (100) PARKING WHITE

RAILROAD CROSSING WITH INTERCONNECT ONLY

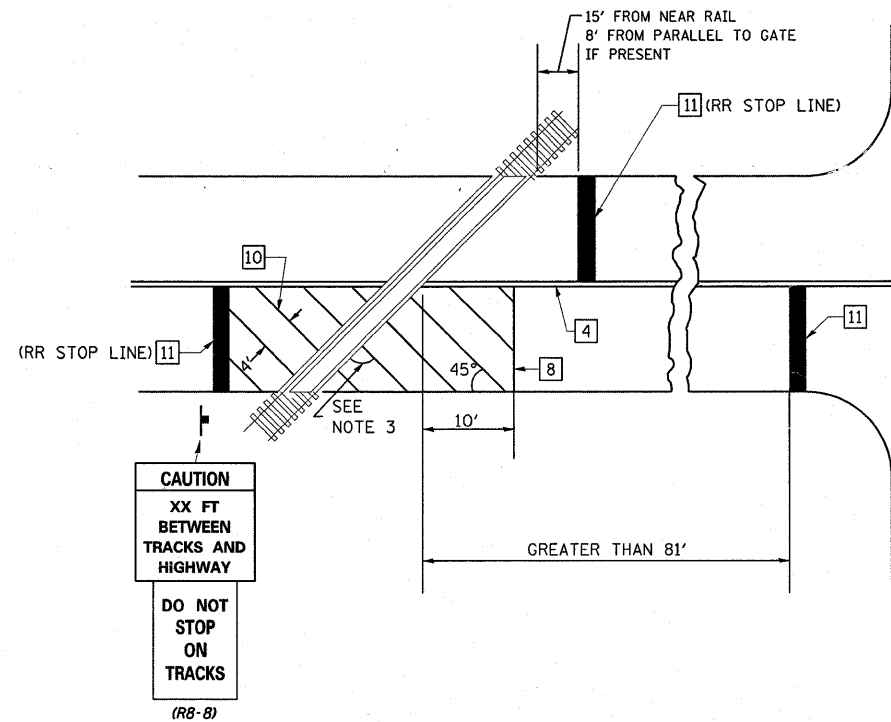

RAILROAD CROSSING WITH INTERCONNECT AND PRE-SIGNALS

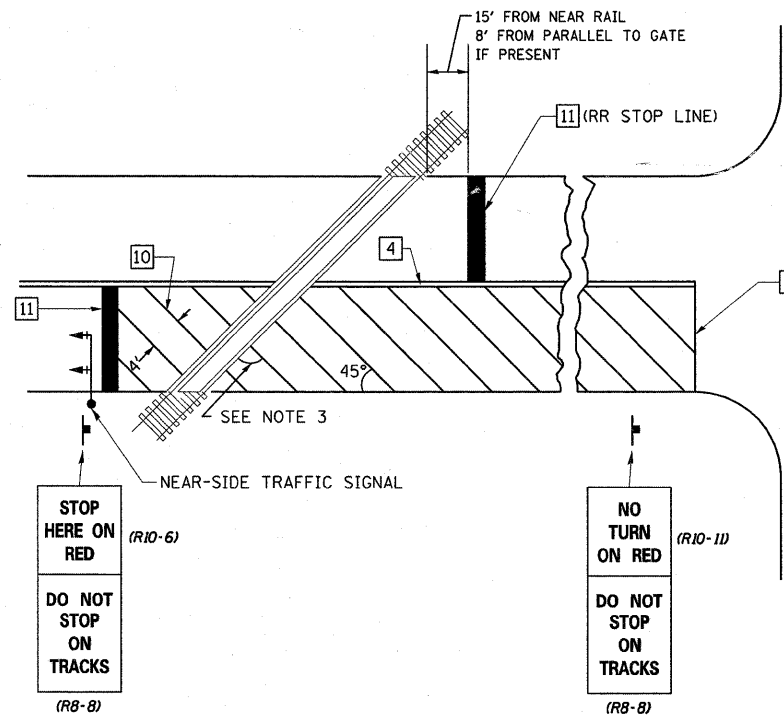

GENERAL NOTES

1. SUPPLEMENTAL PAVEMENT MARKINGS TO BE INSTALLED ONLY ON APPROACHES TO INTERSECTIONS CONTROLLED BY TRAFFIC SIGNALS WHICH ARE INTERCONNECTED WITH THE RAILROAD WARNING SIGNALS.
2. EXTEND PAVEMENT MARKINGS TO THE INTERSECTION ONLY WHERE NEAR-SIDE TRAFFIC SIGNALS ARE USED.
3. WHERE THE ANGLE BETWEEN THE DIAGONAL PAVEMENT MARKINGS AND THE TRACK WOULD BE LESS THAN 20°, THE PAVEMENT MARKINGS SHOULD BE PLACED IN THE OPPOSITE DIRECTION FROM THAT SHOWN.

SUPPLEMENTAL PAVEMENT MARKING TREATMENT FOR RAILROAD-HIGHWAY GRADE CROSSING

NOT TO SCALE

Note: All dimensions are in INCHES (millimeters) unless otherwise shown.

DISTRICT 7 DETAIL NO. 7800001

FILE NAME =	USER NAME = teasleyck	DESIGNED -	REVISED -	<b>STATE OF ILLINOIS DEPARTMENT OF TRANSPORTATION</b>	<b>PAVEMENT MARKING AND RAISED REFLECTIVE PAVEMENT MARKERS (RURAL &amp; URBAN APPLICATIONS)</b>	F.A.S. RTE.	SECTION	COUNTY	TOTAL SHEETS	SHEET NO.	
ct:\pw_work\VP\IDOT\TEASLEYCK\08140949\0774382-sht-detail.dgn	PLLOT SCALE = 50.0000' / IN.	DRAWN -	REVISED -			1669	(7,6) & (5,4)RS-2	Coles	14	14	
PLLOT DATE = 3/19/2010	DATE -	CHECKED -	REVISED -			CONTRACT NO. 74382					
						ILLINOIS FED. AID PROJECT					