

PI STA. = 9+49.38
 $\Delta = 41^\circ 51' 29''$ (LT)
 $D = 63^\circ 39' 43''$
 $R = 90.00'$
 $T = 34.42'$
 $L = 65.75'$
 $E = 6.36'$
 $e =$
 $T.R. =$
 $S.E. RUN =$
 $P.C. STA. = 9+14.96$
 $P.T. STA. = 9+80.71$

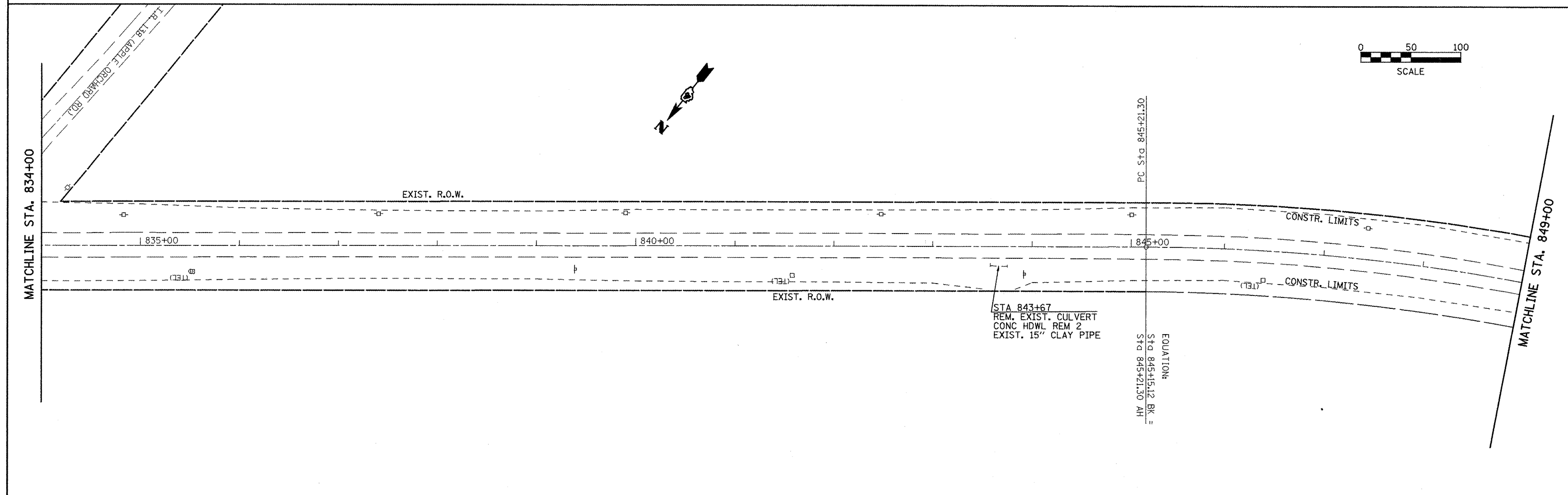
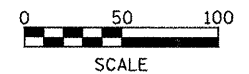

FILE NAME = plan01.dgn	USER NAME = jochumsjg	DESIGNED - KJH	REVISED -	STATE OF ILLINOIS DEPARTMENT OF TRANSPORTATION	EXISTING AND REMOVAL	F.A.P. RTE. = 317	SECTION = 16W-2,RS-4;17W-1,RS-3	COUNTY = FULTON	TOTAL SHEETS = 240	SHEET NO. = 41
	PLOT SCALE = 1/8" = 100.0000' / IN.	CHECKED - KJH	REVISED -			CONTRACT NO. 88703				
	PLOT DATE = 3/12/2010	DATE -	REVISED -			FED. ROAD DIST. NO. ILLINOIS FED. AID PROJECT				