

DATE: _____
 BY: _____
 SURVEYED: _____
 PLAN: _____
 NOTE BOOK: _____
 NO. _____
 PART OF WAY CHECKED: _____
 PADD FILE NAME: _____

DATE: _____
 BY: _____
 SURVEYED: _____
 PROFILE: _____
 NOTE BOOK: _____
 NO. _____
 GRADES CHECKED: _____
 STRUCTURE NOTATIONS: _____

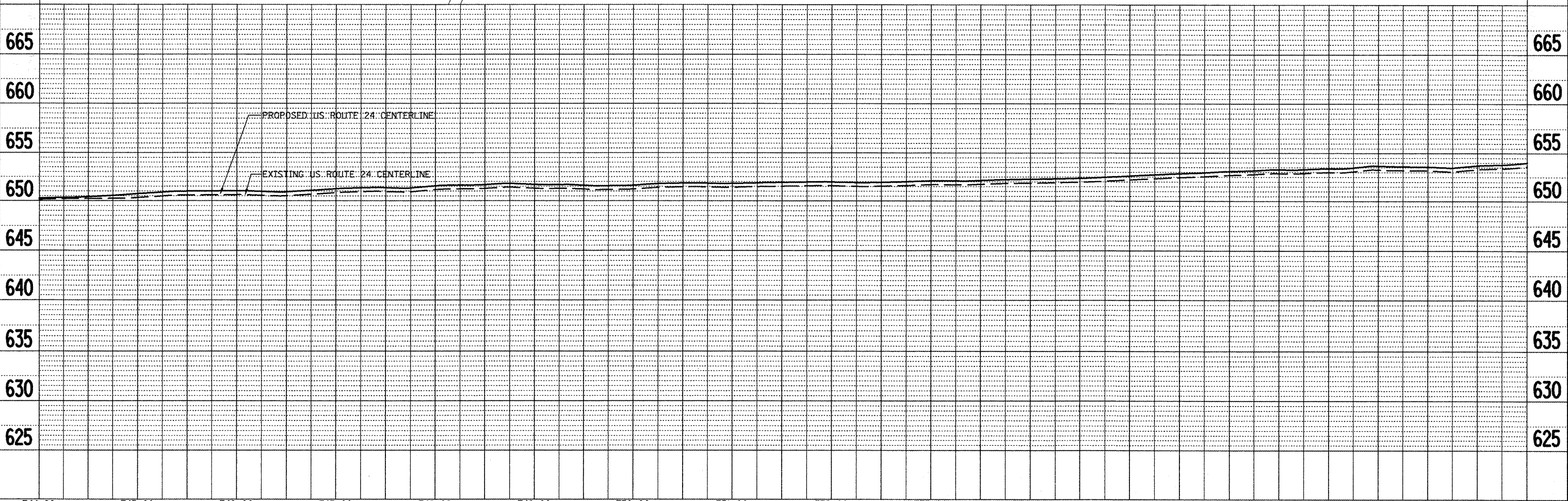
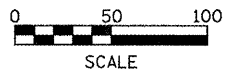
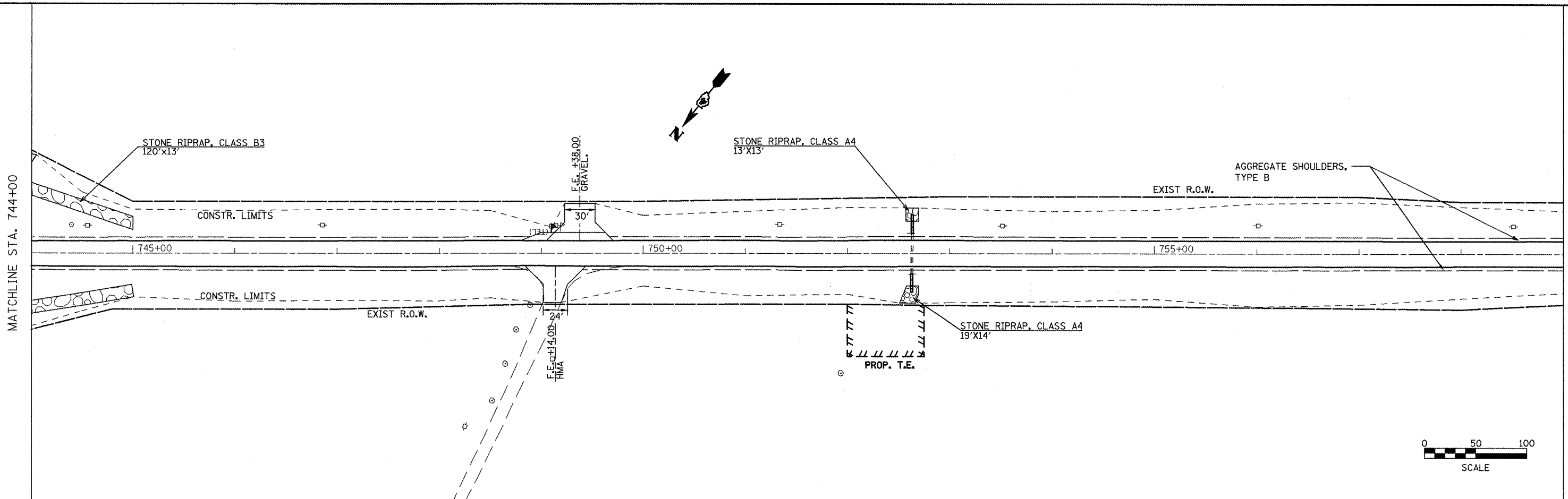

744+00	745+00	746+00	747+00	748+00	749+00	750+00	751+00	752+00	753+00	754+00	755+00	756+00	757+00	758+00	759+00							
FILE NAME = plan01.dgn	USER NAME = jochuma.jg	DESIGNED -	REVISIED -	STATE OF ILLINOIS DEPARTMENT OF TRANSPORTATION												PLAN AND PROFILE		F.A.P. RTE. 317	SECTION 16W-2,RS-4;17W-1,RS-3	COUNTY FULTON	TOTAL SHEETS 240	SHEET NO. 48
PLOT SCALE = 100.0000' / IN.	CHECKED -	REVISIED -	SCALE:															SHEET NO. 6 OF 14 SHEETS	STA. 744+00	TO STA. 759+00	CONTRACT NO. 88703	
PLOT DATE = 3/12/2018	DATE -	REVISIED -	FED. ROAD DIST. NO.													ILLINOIS FED. AID PROJECT						