

DATE: _____
 BY: _____
 SURVEYED: _____
 PLANNED: _____
 CHECKED: _____
 DATE: _____
 NO. _____

DATE: _____
 BY: _____
 SURVEYED: _____
 PROFILE: _____
 CHECKED: _____
 DATE: _____
 NO. _____

US 24 STA & OFFSET		
A	+79.71	106.60' LT
B	+92.04	122.34' LT
C	+43.98	158.91' LT
D	+35.56	189.31' LT
E	+95.45	94.27' LT
F	+07.78	110.01' LT
G	+50.28	139.93' LT
H	+21.28	163.49' LT

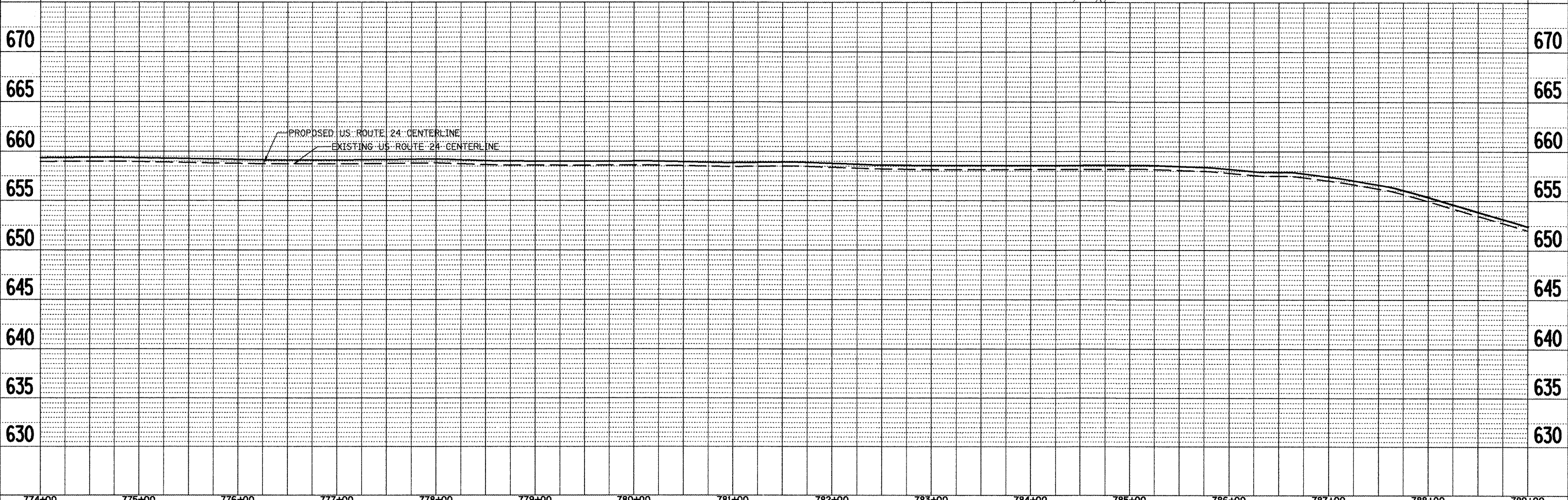
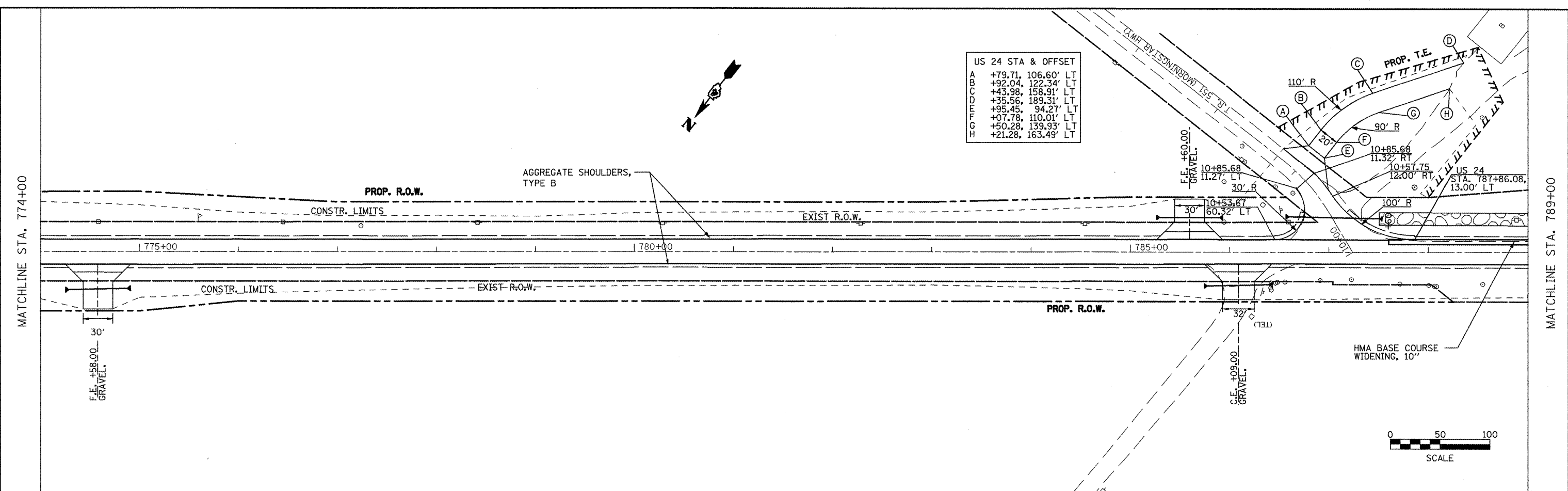

774+00	775+00	776+00	777+00	778+00	779+00	780+00	781+00	782+00	783+00	784+00	785+00	786+00	787+00	788+00	789+00
--------	--------	--------	--------	--------	--------	--------	--------	--------	--------	--------	--------	--------	--------	--------	--------

STATE OF ILLINOIS
 DEPARTMENT OF TRANSPORTATION

PLAN AND PROFILE

F.A.P. RTE.	SECTION	COUNTY	TOTAL SHEETS	SHEET NO.
317	16W-2,RS-4;17W-1,RS-3	FULTON	240	50
CONTRACT NO. 88703				

SCALE: SHEET NO. 8 OF 14 SHEETS STA. 774+00 TO STA. 789+00

FED. ROAD DIST. NO. ILLINOIS FED. AID PROJECT