

PLAN SURVEYED BY DATE
 PLOTTED BY
 CHECKED BY
 NOTE BOOK NO.
 STRUCTURE NOTATION CHFD

PROFILE SURVEYED BY DATE
 PLOTTED BY
 CHECKED BY
 NOTE BOOK NO.
 STRUCTURE NOTATION CHFD

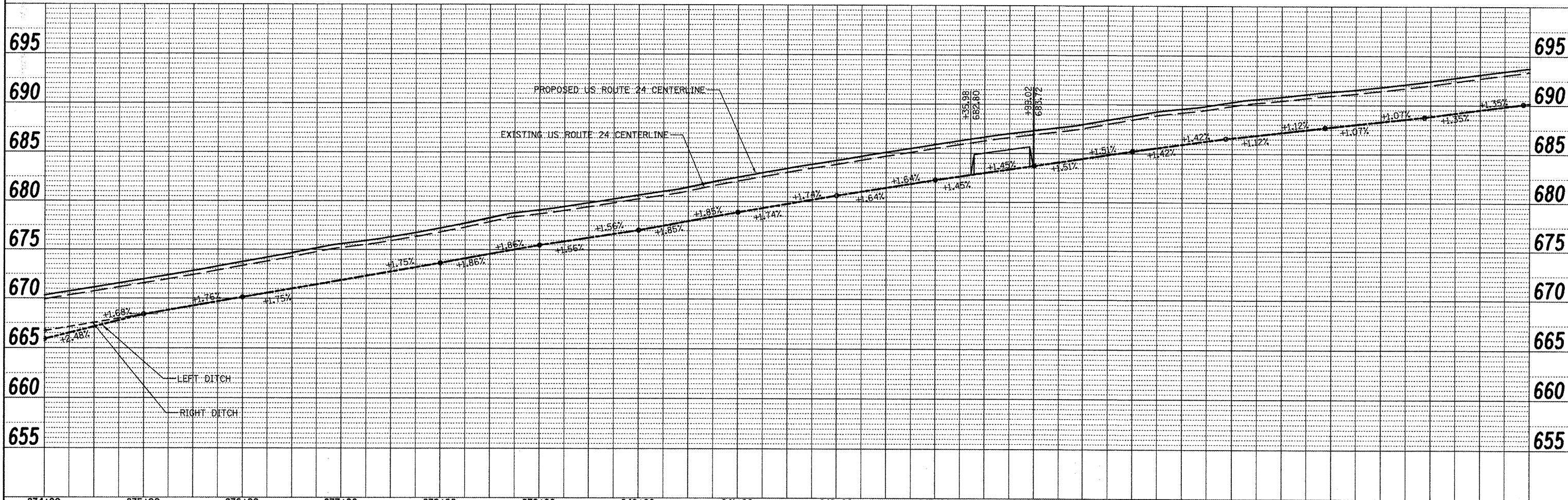
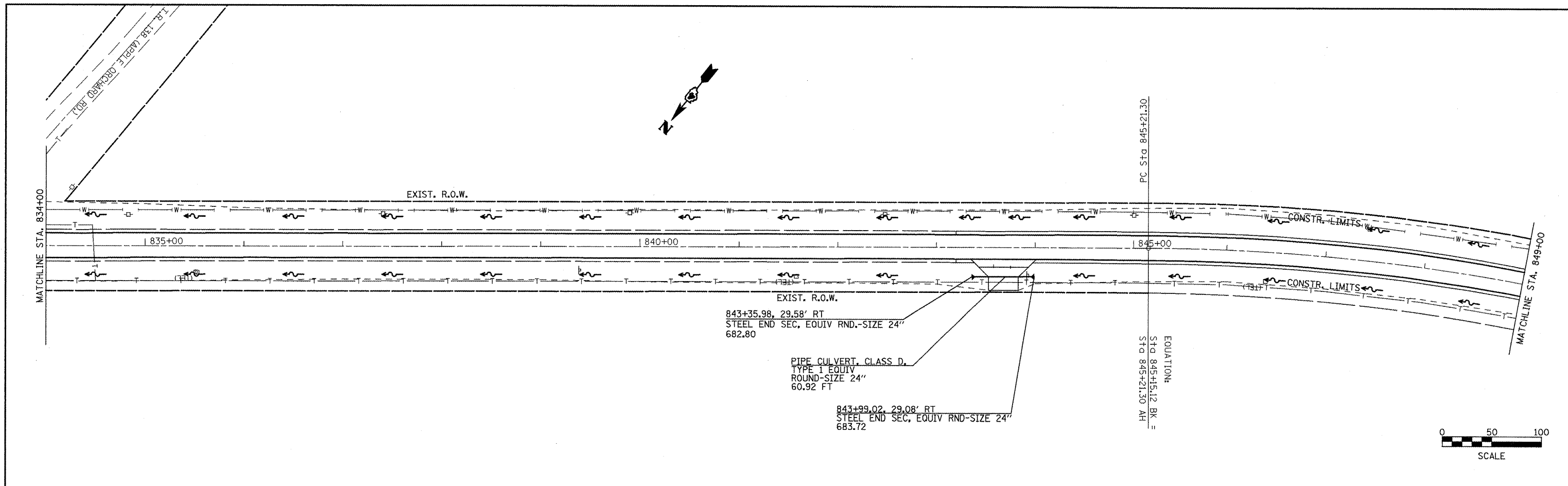

834+00	835+00	836+00	837+00	838+00	839+00	840+00	841+00	842+00	843+00	844+00	845+00	846+00	847+00	848+00	849+00
FILE NAME = plan01.dgn	USER NAME = joehumjg	DESIGNED - KJH	REVISED -	DESIGNED - KJH	REVISED -	DESIGNED - KJH	REVISED -	DESIGNED - KJH	REVISED -	DESIGNED - KJH	REVISED -	DESIGNED - KJH	REVISED -	DESIGNED - KJH	REVISED -
PLOT SCALE = 100.0000' / IN.		CHECKED - KJH	REVISED -	CHECKED - KJH	REVISED -	CHECKED - KJH	REVISED -	CHECKED - KJH	REVISED -	CHECKED - KJH	REVISED -	CHECKED - KJH	REVISED -	CHECKED - KJH	REVISED -
PLOT DATE = 3/12/2010		DATE -	REVISED -	DATE -	REVISED -	DATE -	REVISED -	DATE -	REVISED -	DATE -	REVISED -	DATE -	REVISED -	DATE -	REVISED -
STATE OF ILLINOIS DEPARTMENT OF TRANSPORTATION										DRAINAGE AND UTILITIES					
SCALE:										SHEET NO. 12 OF 14 SHEETS STA. 834+00 TO STA. 849+00					
F.A.P. RTE. 317		SECTION 16W-2,RS-4,17W-1,RS-3			COUNTY FULTON		TOTAL SHEETS 240		SHEET NO. 79		CONTRACT NO. 88703				
FED. ROAD DIST. NO. ILLINOIS FED. AID PROJECT															