

FINAL SURVEY	DATE
SURVEYED	BY
PLOTTED	
NOTE BOOK	
TEMPLATE	
AREAS CHECKED	

ORIGINAL SURVEY	DATE
SURVEYED	BY
PLOTTED	
NOTE BOOK	
TEMPLATE	
AREAS CHECKED	

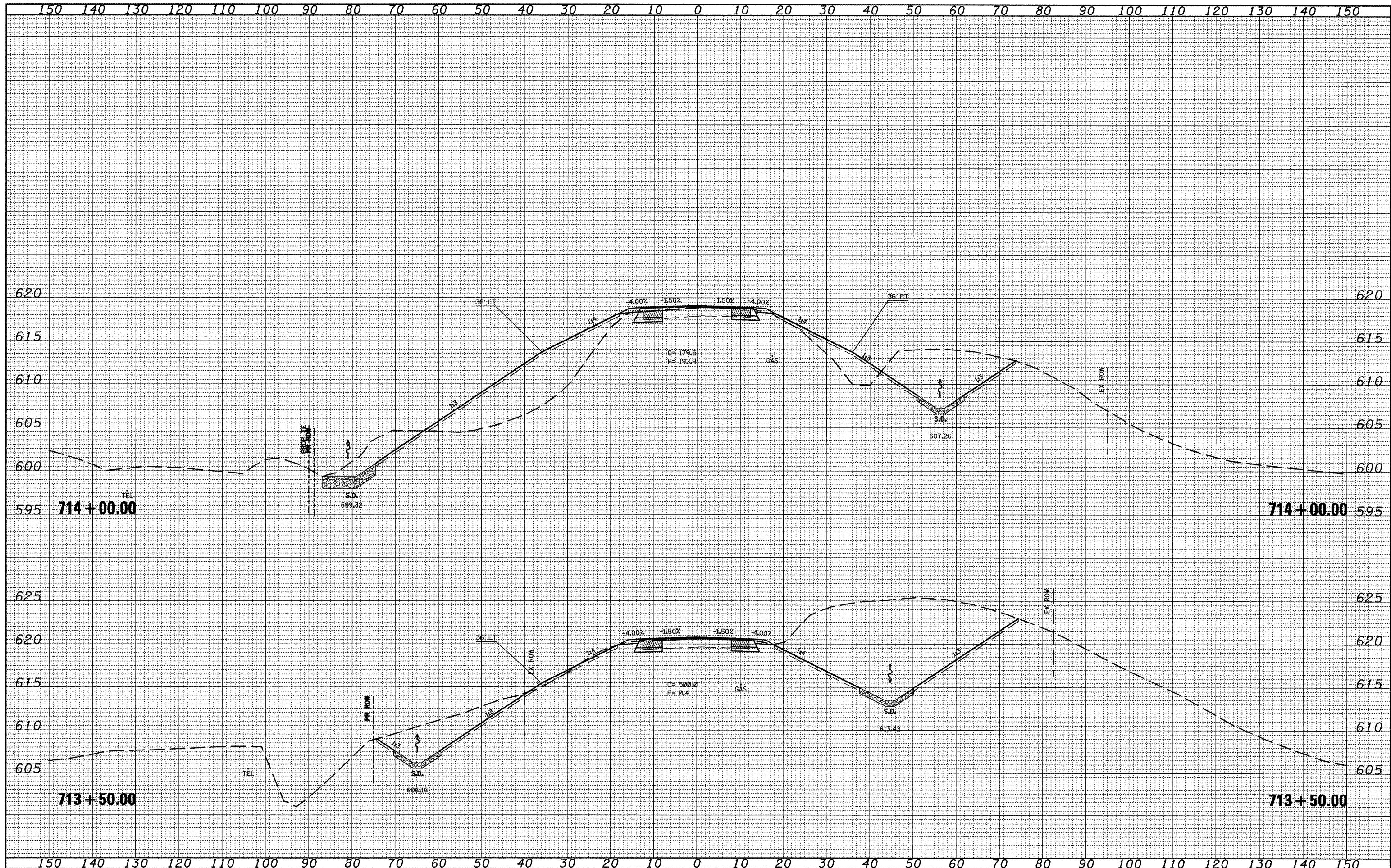

FILE NAME = xsec_sheet.dgn
 USER NAME = jochuma.jg

DESIGNED -
 DRAWN -
 CHECKED -
 DATE -

REVISIED -
 REVISIED -
 REVISIED -
 REVISIED -

STATE OF ILLINOIS
 DEPARTMENT OF TRANSPORTATION

CROSS SECTIONS
 SCALE: SHEET NO. OF SHEETS STA. 713+50.00 TO STA. 714+00.00

F.A.A.P. RTE. 317	SECTION 16W-2,RS-4+17W-1,RS-3	COUNTY FULTON	TOTAL SHEETS 240	SHEET NO. 173
CONTRACT NO. 88703				
ILLINOIS FED. AID PROJECT				